

PROPOSED G.T.SHEET MAP PLAN FOR COMPENSATORY AFFORESTATION ON PROPOSED 6.35 HA. NON FOREST LAND FOR DIVERSION OF CONSTRUCTION OF ROAD (EXISTING SIKAR-HARSH ROAD KM 8/750 TO KM 15/100) IN VILLAGE-SHYAM NAGAR .TEHSIL-NEEM KA THANA ,DISTT.-SIKAR(RAJ.)

APPLIED BY:- EXECUTIVE ENGINEER,PWD, DN. -SIKAR  
(Proposal No.-FP/RJ/ROAD/29601/2017)

G.T.SHEET NO.- 45 M/13

SCALE- 1 CM.= 500 METER

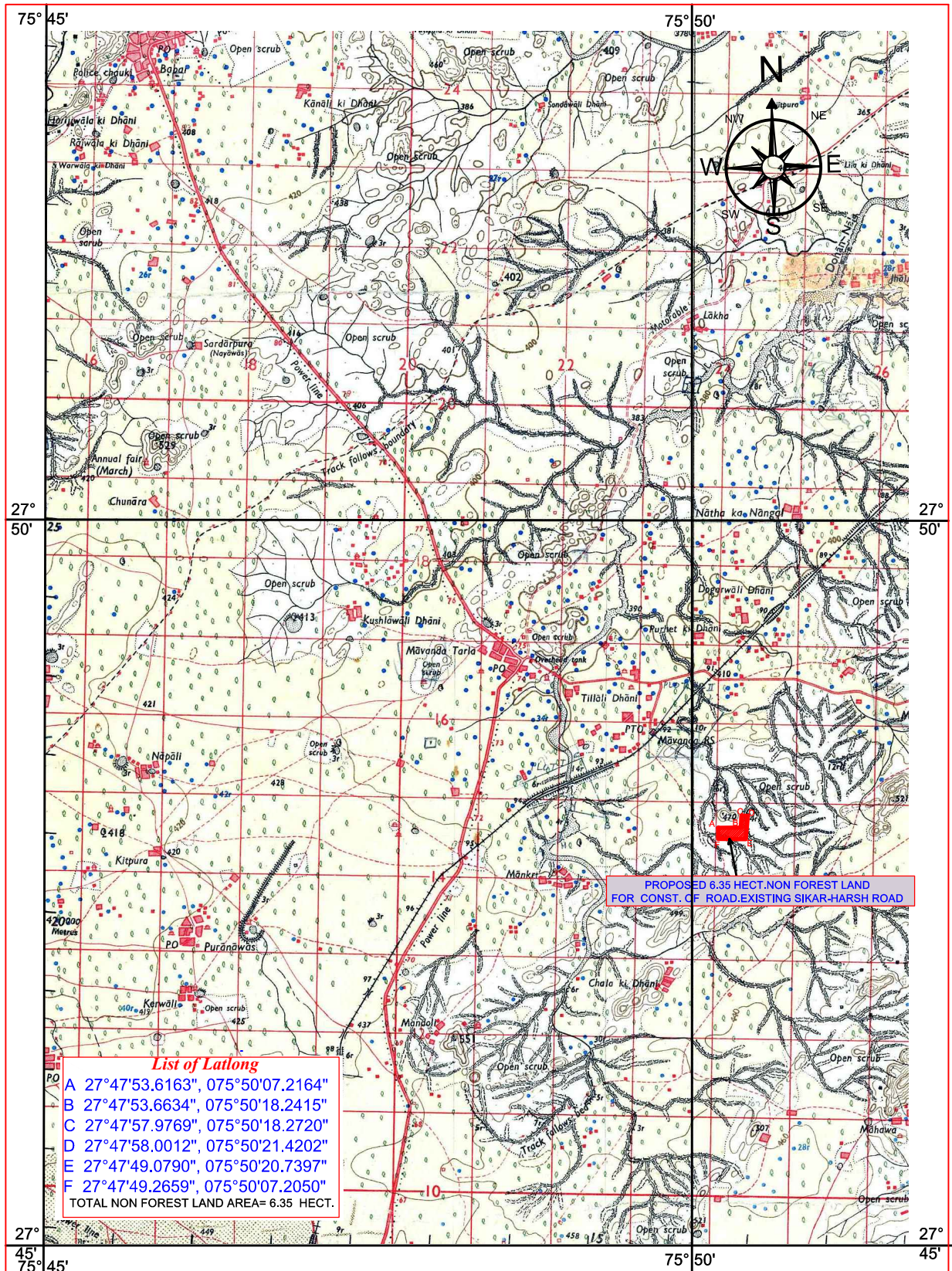

*(Signature)*

(Prahlad Singh)  
Executive Engineer  
P.W.D. Div. Sikar

SIGN OF APPLICANT.