



Boulevard Road, Near Lalit Grand Palace, Srinagar –
190001 Tel/Fax No: 0194-2501069
Manda - Hills (Near Ashoka Hotel) Jammu – 180005,
Tel/Fax: 0191-2572570
Website: www.jkwildlife.com
Email: jkwildlife78@gmail.com
jkwildlife72@gmail.com

GOVERNMENT OF JAMMU & KASHMIR
OFFICE OF THE PR. CHIEF CONSERVATOR OF FORESTS (WILDLIFE)/
CHIEF WILDLIFE WARDEN

Subject: Diversion of 5.9312 Ha of forest land in Marwah Forest Division for the construction of a road from Ikhala Block boundary Kishtwar to Lopara, District Kishtwar, UT of Jammu and Kashmir (Proposal No. FP/JK/Road/51130/2020) reg.

The animal passage plan for Wildlife proposed with respect to road project mentioned in the subject, as prepared by the User Agency in consultation with Divisional Forest Officer, Marwah Forest Division and Wildlife Warden, Chenab Division, Kishtwar has been examined and found to have the necessary components i.e under passes, speed breakers and provision for sign boards/ cautionary warning signs. The said animal passage plan for Wildlife is as such approved subject to following conditions:-

1. Divisional Forest Officer, Marwah Forest Division, shall ensure that under passes as specified in the animal passage plan are constructed by the user Agency.
2. No harm to any Wildlife species shall be done, if found accidentally in the project area.
3. The User Agency shall construct speed breakers at critical Wildlife passage areas to be specified by the concerned Wildlife Warden.
4. Divisional Forest Officer, Marwah Forest Division shall ensure that adequate number of sign boards and cautionary warning signs are installed by the User Agency along the road stretch.
5. Divisional Forest Officer, Marwah Forest Division, shall ensure that all the provisions made in the animal passage plan are strictly executed by the User Agency.
6. The User Agency shall be responsible for obtaining requisite clearances under any other law in vogue.

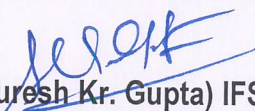

(Suresh Kr. Gupta) IFS
Pr.Chief Conservator of Forests (Wildlife)/
Chief Wildlife Warden, J&K

No. WLP/Tech/2022-23/ 525-30,

Dated 24-09.2022

Copy for information and necessary action to the:-

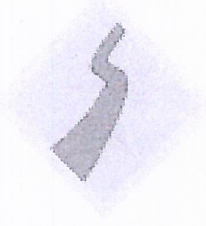
1. Chief Conservator of Forest (FCA), Nodal Officer in the of Pr. Chief Conservator of Forests & HoFF.
This is in reference to his office No: PCCF/FCA/3218/4544 dated: 19-09-2022.
2. Regional Wildlife Warden, Jammu.
3. Chief Engineer, PMGSY, Jammu.
4. Divisional Forest Officer, Marwah Forest Division.
5. Wildlife Warden, Chenab Division, Kishtwar.
6. Executive Engineer, PMGSY Division, Marwah.



PRADHAN MANTRI
GRAM SADAK YOJANA

**DETAILS OF UNDER PASSES/OVERPASSES PROPOSED
FOR THE SAFE PASSAGE OF WILD ANIMALS**

On

Ikhala Block Boundary Kishtwar to lopara Road
part -II

Package No:- JK04-167

Length: - 13.00kms

Length of Road in forest Area: - 9.60 kms

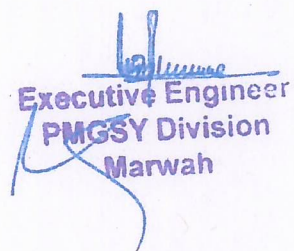
Executive Engineer
PMGSY Division
Marwah

**Details of Under passes proposed for safe passage of wild Animals in forest Land on Ikhala
Block Boundary Kishtwar to Lopara Part-II Road**

1. INTRODUCTION

The rural road network required for providing the 'basic access' to all villages/ habitations is termed as the Core Network. Basic access is defined as one all-weather road access from each village/ habitation to the nearby Market Centre or Rural Business Hub (RBH) and essential social and economic services.

A Core Network comprises of Through Routes and Link Routes. Through routes are the ones which collect traffic from several link roads or a long chain of habitations and lead it to a market centre or a higher category road, i.e. the District Roads or the State or National Highways. Link Routes are the roads connecting a single habitation or a group of habitations to Through Roads or District Roads leading to Market Centres. Link Routes generally have dead ends terminating on habitations, while Through Routes arise from the confluence of two or more Link Routes and emerge on to a major road or to a Market Centre.

The Core Network may not represent the most convenient or economic route for all purposes. However, since studies show 85-90% of rural trips are to market centres, the Core Network is likely to be a cost-effective conceptual frame work for investment and management purposes, particularly in the context of scarce resources.

The sub-project Road takes off from Ikhala being the Block Boundary of Kishtwar and is aimed to connect firstly the Block & Tehsil Dachhan of the District Kishtwar and secondly the Sub Division Marwah directly with District headquarter Kishtwar which is devoid of Road connectivity since the dawn of independence. The forest clearance for part-1st of length 22.00 kms has been sanctioned whereas the 2nd part of length 13.00 kms of Sub project is awaited for which proposal moved. The Sub-project will directly connect the whole Sub-Division of Marwah having a population of more than 30000 by all weather connectivity. The habitations which get connected and benefited will be Hanzal, Teller, Chanjer, Deherna, Nowpachi

Hanzal is situated on the right bank of River Marsudhar and towards east side of block Marwah.

Presently Hanzal is connected with a bridle track having deep ascends and descends and remains mostly cut off during winter season. All the essential commodities are to be carried upto Hanzal by head load or ponies resulting in backwardness of the area both socially as well as economically.

Mostly the people are illiterate and unemployed due to lack of education facilities in the vicinity of the area

The Block Marwah is spreaded over a vast hilly area having many beautiful tourist spots, pastures and meadows having great exploration of Tourism potential. The construction of road shall boost tourism sector in the area in general and the whole block shall come up at par with the famous

Tourist resorts and shall improve the socio-economical condition of the down trodden and poverty stricken populace of the block.

This road will increase the intensity of tourism in the area similar as Phalgam in Kashmir. The road shall also provide accessibility to school, High school, Health Centre etc. The road construction has been proposed with a formation width of 6.0M except , except at valley/zig points where construction of R/walls are inevitable from geometrical constraints and at horizontal curves, extra widening has been proposed ranging from 0.60 to 0.90 Mtr. depending upon the radius of horizontal curve and as per IRC specification.

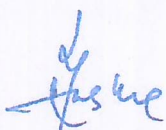
Wildlife Warden
Chenab Division
Kishtwar

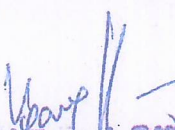
Divisional Forest Officer
Marwah Forest Division
H. Q. Kishtwar

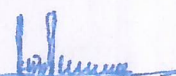
Executive Eng.
PMGSY Division
Marwah

**Details of Under passes proposed for safe passage of wild Animals in forest Land on Ikhala
Block Boundary Kishtwar to Lopara Part-II Road**

2. Objectives of Animal Passage plan Study

The objectives of animal passage plan are:

- ❖ To incorporate the needs of wildlife into transportation projects.
- ❖ To maintain the habitat connectivity.
- ❖ To aid in the reduction of human wildlife conflict, improving awareness, safety and reducing collisions.

1. Project Location and Technical Details:

Project:	Construction of Motorable Road from Ikhala Block Boundary Kishtwar to Lopara Part-II
Proposal No.	FP/JK/ROAD/51130/2020
Project Proponent:	Marwah & Dachhan Forest Range
Project Cost:	4294.00 lacs
Details of Forest Area involved:	5.9312 Ha

1. **Justification for Proposed route & alternative examined:** The The present proposed road alignment is only feasible for Construction of Motorable Road from Ikhala Block Boundary Kishtwar to Lopara Part-II. There is no possibility of alternate alignment for the project road. Hence, the diversion of the Forest is the only choice to construct the road.

2. Area Details Falling in Forest area

Part- 1

- (i) Total Length of the Road: 13000m
- (ii) Total Length of the Road in Forest Area:- 9600m
- (iii) Width of the Road: 6.00m
- (iv) Area in forest land 5.9312Ha.

3. Major Activities involved in the execution of Project:

A	Earthwork in excavation in Hilly area
1	Earthwork in cutting
2	Earthwork in filling
B	CD Works

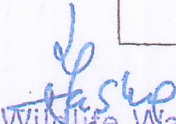

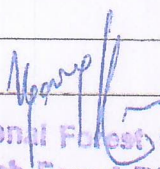
Wildlife Warden
Chenab Division

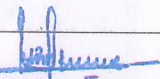

Divisional Forest Officer
Marwah Forest Division

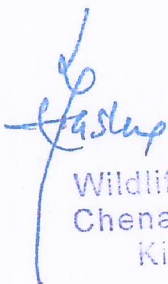

Executive Engineer
PMGSY Division

**Details of Under passes proposed for safe passage of wild Animals in forest Land on Ikhala
Block Boundary Kishtwar to Lopara Part-II Road**

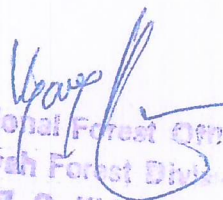
B	CD Works
4	Construction of 2.0m Span RCC Culvert
5	Construction of 3.0m Span RCC Culvert
6	Construction of 6.0m Span RCC Culvert
C	Construction of Semi Pucca Walling
7	R/Wall Ht. 2.00 m
8	R/Wall Ht. 3.00 m
9	R/Wall Ht. 4.00 m
10	R/Wall Ht. 2.50 m
11	Parapet
12	Pucca Drain
D	Providing & Fixing of Signage and Boards
13	Citizen & Main Information Board
14	Logo Board
15	Road Sign Boards
16	Km Stone
17	200 m Stones
18	5 Km Stones

Wildlife Warden
Chenab Division
Kishtwar

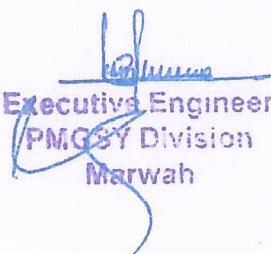
Divisional Forest Officer
Marwah Forest Division
H. Q. Kishtwar

Executive Engineer
PMOSY Division
Marwah

**Details of Under passes proposed for safe passage of wild Animals in forest Land on Ikhala
Block Boundary Kishtwar to Lopara Part-II Road**

Proposed mitigation measures: In addition to proposed action plan following measures could be undertaken in view of projected increase in traffic load which could facilitates the animals to cross the road:

- Creation of barriers
- To provide RCC Box culverts/Animal Underpass at various strategic point, so that along with water various wildlife can also pass through the culvert to reach the other side of the road
- The culvert floor must be naturalized so that small vegetation can grow and give the underneath area a natural passage look.
- Noise barriers shall be installed near the underpasses for effective use of underpasses
- The culvert height shall accommodate animals like Black bear , Leopard, Muskdeer etc
- The hydrological importance shall also be kept in mind while deciding on the relocation / modification of the culverts.
- During Construction period no construction work shall be allowed after night fall.
- Special care should be taken to ensure that the animal movement is not restricted due to the construction work
- Workers & local populace should be made aware through awareness workshops about the importance of wildlife and biodiversity and special attention paid that no poaching and hunting takes place
- Creation of rumble strip on stretches which are passing through longer forest patches.
- Pipe culverts shall be avoided and be replaced with box culverts if located in places having good forest patches on both side with larger and continuous patch size to save the smaller wild animals from road accidents. Culvert floor shall be planted with indigenous plant and grass species.
- No labour camps should be allowed at the construction sites. Arrangements should be made to bring in the labour during the working hours and drop them after that. No fire or cooking should be allowed at the construction site.
- No stocking and dumping of construction material other than the designated sites duly agreed by the Forest Department.
- Construction workers and local communities should be sensitized about importance of wildlife conservation and do's and don'ts through awareness workshops/meeting with full involvement of local Forest personnel. Workers should be made aware of provision of legal penalties to stop poaching and wood cutting.
- Vehicle speed limit should not be more than 30-40 km/hr. in the animal prone stretch warning signage shall be installed at every 25 m in entire project road. Night traffic should be controlled through barriers at appropriate locations to be decided by the project authorities and local forest department. Random checking by the Flying Squad of Transport Authority.

Wildlife Warden
Chenab Division
Kishtwar

Divisional Forest Officer
Marwah Forest Division
H. O. Kishtwar

Executive Engineer
PMGSY Division
Marwah

Details of Under passes proposed for safe passage of wild Animals in forest Land on Ikhala
Block Boundary Kishtwar to Lopara Part-II Road

Abstract of Proposed action plan for safe passage of wild Animals

S.No	Name of Particulars	Amount (Rs in Lacs)
1	Provision for construction of B/walls & R/walls in addition to the already proposed in Project	20.00
2	Construction of 03mtr Span RCC Culvert/Animal Passage including Approach Track 08No's	133.44
3	Road Studs /Speed Breakers on 20 stretches	3.00
4	Provision for construction of Parapets	5.00
5	Provision for P/F Sign boards /Cautionary warning signs at every 20 to 25mtrs of Road Stretch	10.00
	G-Total	171.44

Say Rs.171.44

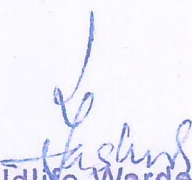
Wildlife Warden
Chenab Division
Kishtwar

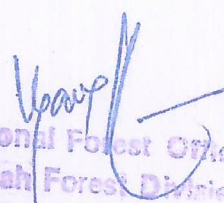
Divisional Forest Officer
Marwah Forest Division
H. Q. Kishtwar

Executive Engineer
PMGSY Division
Marwah

Details of Under passes proposed for safe passage of wild Animals in forest Land on Ikhala Block Boundary Kishtwar to Lopara Part-II Road

DETAILED ESTIMATE FOR CONSTRUCTION OF 03MTR SPAN RCC CULVERT / ANIMAL PASSAGE FOR SAFE PASSAGE OF ANIMALS IN FOREST AREA ON Ikhala Block Boundary Kishtwar to Lopara Part-II					
S. No.	Description	Unit	App. Quantity	Rate	Amount
1	Earth work in excavation by mechanical means (hydraulic excavator) in trenches for foundations, drains, pipes, cables etc. (not exceeding 1.5 m in width) and for shafts, wells, cesspits and the like not exceeding 10 sqm on plan, including dressing of sides and ramming of bottoms lift upto 1.5 m, including getting out excavated earth and disposal of surplus excavated earth as directed, within a lead of 50 metres: 70% all kinds of soil & 30 % ordinary rock	cum	380.05	317.43	120639.00
	Abutment = $7.50 \times 8.60 \times 4.30 = 277.35$ cum				
	Wing wall = $4 \text{ nos} \times 2.50 \times 1.40 \times 3.80 = 53.20$ cum				
	Approaches = $2 \text{ nos} \times 1/2 \times 1.60 \times 2.50 \times 3.00 = 12.00$ cum				
	Approach for culvert to wild animals $1/2 \times 1.50 \times 2.50 \times 5.00 \times 4 \text{ Nos} = 37.50$ cum				
	Total = 350.05 cum				
2	Providing and laying in position cement concrete of specified grade including curing but excluding the cost of centring and shuttering. All work upto plinth level with: 1:3:6 (1 cement : 3 coarse sand : 6 graded stone aggregate 20 mm nominal size)	cum	29.12	4943.40	143951.00
	Abutment step I = $8.60 \times 7.00 \times 0.20 = 12.04$ cum				
	Step II = $8.00 \times 7.00 \times 0.20 = 11.20$ cum				
	Wing wall = $4 \text{ nos} \times 1.40 \times 2.50 \times 0.40 = 1.16$ cum				
	Approaches = $2 \text{ nos} \times 3.00 \times 1.60 \times 0.20 = 1.92$ cum				
	Bottom Inside = $2.00 \times 7.00 \times 0.10 = 2.80$ cum				
3	Total = 29.12 cum				
	Providing and laying in position cement concrete of specified grade including curing but excluding the cost of centring and shuttering. All work upto plinth level with: 1:2:4 (1 cement : 2 coarse sand : 4 graded stone aggregate 20 mm nominal size)				
	Abutments 2nd step = $2 \text{ nos} \times 6.50 \times 7.20 \times 0.80 = 37.44$ cum				
	2nd step = $2 \text{ nos} \times (0.60+2.00)/2 \times 7.00 \times 3.00 = 54.60$ cum				
	Dirt wall = $2 \text{ nos} \times 7.00 \times 0.30 \times 0.30 = 1.26$ cum				
	Wing wall 1 st step = $4 \text{ nos} \times 2.50 \times 1.20 \times 0.80 = 9.60$ cum				

**Details of Under passes proposed for safe passage of wild Animals in forest Land on Ikhala
Block Boundary Kishtwar to Lopara Part-II Road**

	2 nd step 4 nos x $(0.60+1.20)/2 \times 2.50 \times 2.90 = 26.10$ cum	cum	136.51	5877.45	802330.00
	Bottom inside = $3.00 \times 7.00 \times 0.10 = 2.10$ cum				
	Parapet Over culvert $2 \times 3.40 \times 0.60 \times 0.40 = 1.63$ cum				
	Over approaches & wing wall = 2 sides x 4 nos x 1.50 $x(0.45+0.60)/2 \times 0.60 = 3.78$ cum				
	T = 136.51 M³				
4	Providing and laying in position specified grade of reinforced cement concrete including curing but excluding the cost of centering, shuttering, finishing and reinforcement. All works upto plinth level in 1:1½:3 (1 cement : 1½ coarse sand : 3 graded stone aggregate 20 mm nominal size)	cum	7.56	8953.95	67692.00
	Slab = $1 \times 7.00 \times 3.60 \times 0.30 = 7.56$ cum				
	Total = 7.56 cum				
5	Steel reinforcement for R.C.C. work including straightening, cutting, bending, placing in position and binding all complete upto plinth level Mild steel and medium tensile steel bars Qty. vide item no. 4 = 7.56 @ 150 kgs / cum = 1134.00 kgs	kg	1134	78.55	89075.00
	Total = 1134.00 kgs				
6	Random Rubble masonry with hard stone in foundation and plinth including leveling up with cement concrete 1:6:12 (1 Cement : 6 coarse sand : 12 graded stone aggregate 20mm nominal size) upto plinth level and curing complete with: Cement mortar 1:6 (1 Cement : 6 coarse sand) Nallah	cum	64.00	4400.5	281632.00
	$2 \text{ nos} \times 2.50 \times (0.60 + 1.60)/2 \times 3.00 = 16.50$ cum				
	Approaches for wild animals				
	$0.60+1.30/2 \times 2.50 \times 5 \text{ Nos} \times 4 \text{ Nos} = 47.50$ cum				
	Net Total = 64.00 cum				
7	Back filling with stones behind abutment, wing wall and return wall complete as per drawing and technical specification clause 1204.3.8	cum	6.00	527.00	3162.00
	$2 \times 2.50 \times \frac{1}{2} \times 1.20 \times 2.00 = 6.00$ cum				
	Total = 6.00 cum				
8	carriage of stone av. Distance 1 km by M.T		64.00	139.71	8941.00
9	Carriage of sand av. Distance 33.00 km by M.T		102.24	462.14	47249.00
10	Carriage of aggr. av. Distance of 35 km by MT		155.85	479.42	74717.00
11	Carriage of steel Distance of 44 km by M.T		1.134	495.31	561.00

**Details of Under passes proposed for safe passage of wild Animals in forest Land on Ikhala
Block Boundary Kishtwar to Lopara Part-II Road**

12	Carriage of cement Distance of 44 km by M.T		57.87	495.31	28644.00
			Total =		1668593.00
			Grand Total =		16.68lacs

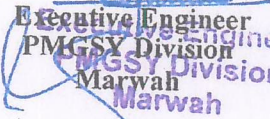
Executive Engineer
PMGSY Division
Marwah

Details of Under passes proposed for safe passage of wild Animals in forest Land on Ikhala Block Boundary Kishtwar t
Part-II Road

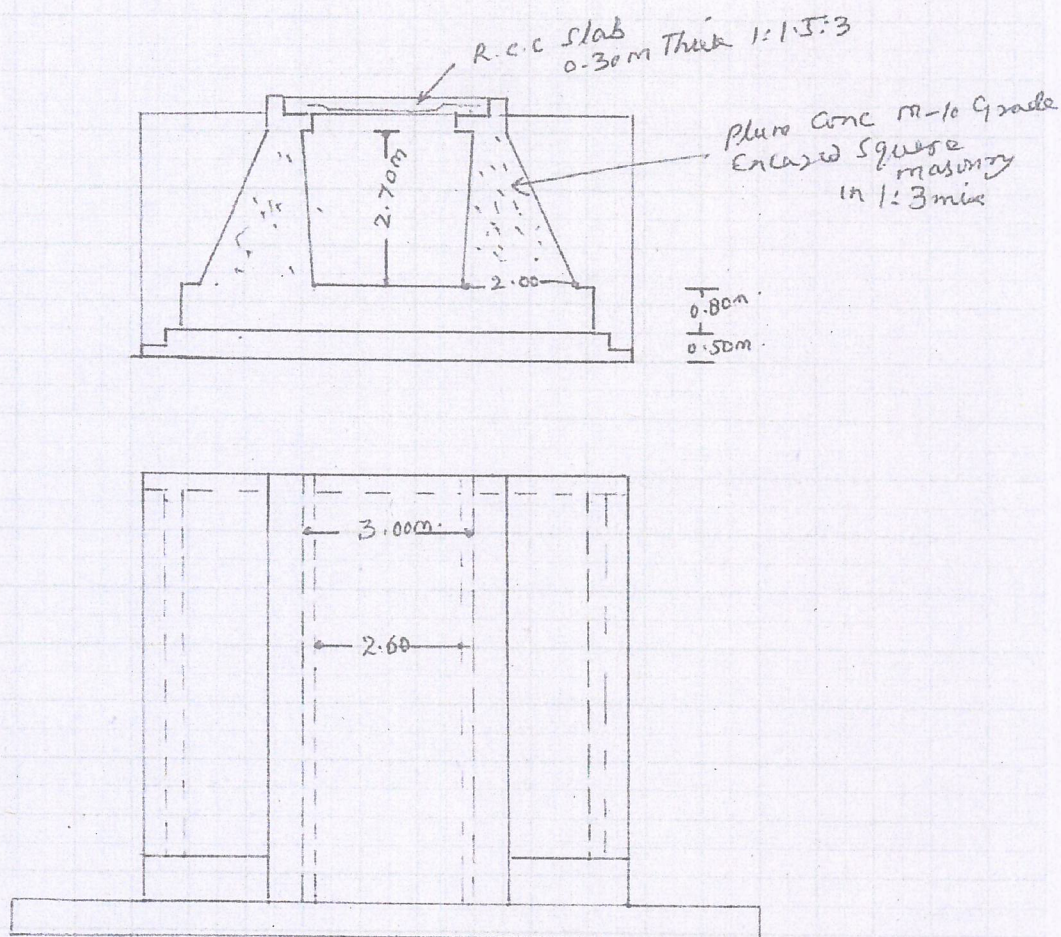

PLAN
3m span R.C.C. Culvert.

Wildlife Warden
Chenab Division
Kishtwar

Divisional Forest Officer
Marwah Forest Division
H. Q. Kishtwar

Executive Engineer
PWGSY Division
Marwah

Details of Under passes proposed for safe passage of wild Animals in forest Land on Ikhala
Block Boundary Kishtwar to Lopara Part-II Road

Provision of Safety Features

Cautionary / Warning Sign Boards such as Over Hanging Signage will be provided at start and at the end of each stretch of Wildlife area / Forest area

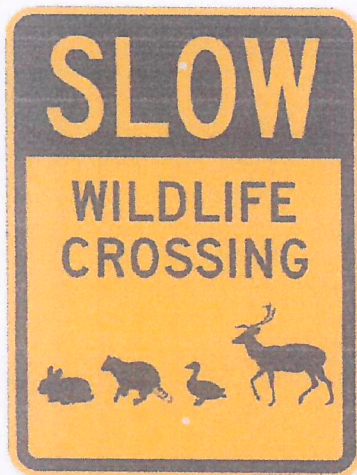

[Signature]
Wildlife Warden
Chenab Division
Kishtwar

[Signature]
Divisional Forest Officer
Marwah Forest Division
H. Q. Kishtwar

[Signature]
Executive Engineer
PWSY Division
Marwah

**Details of Under passes proposed for safe passage of wild Animals in forest Land on Ikhala
Block Boundary Kishtwar to Lopara Part-II Road**

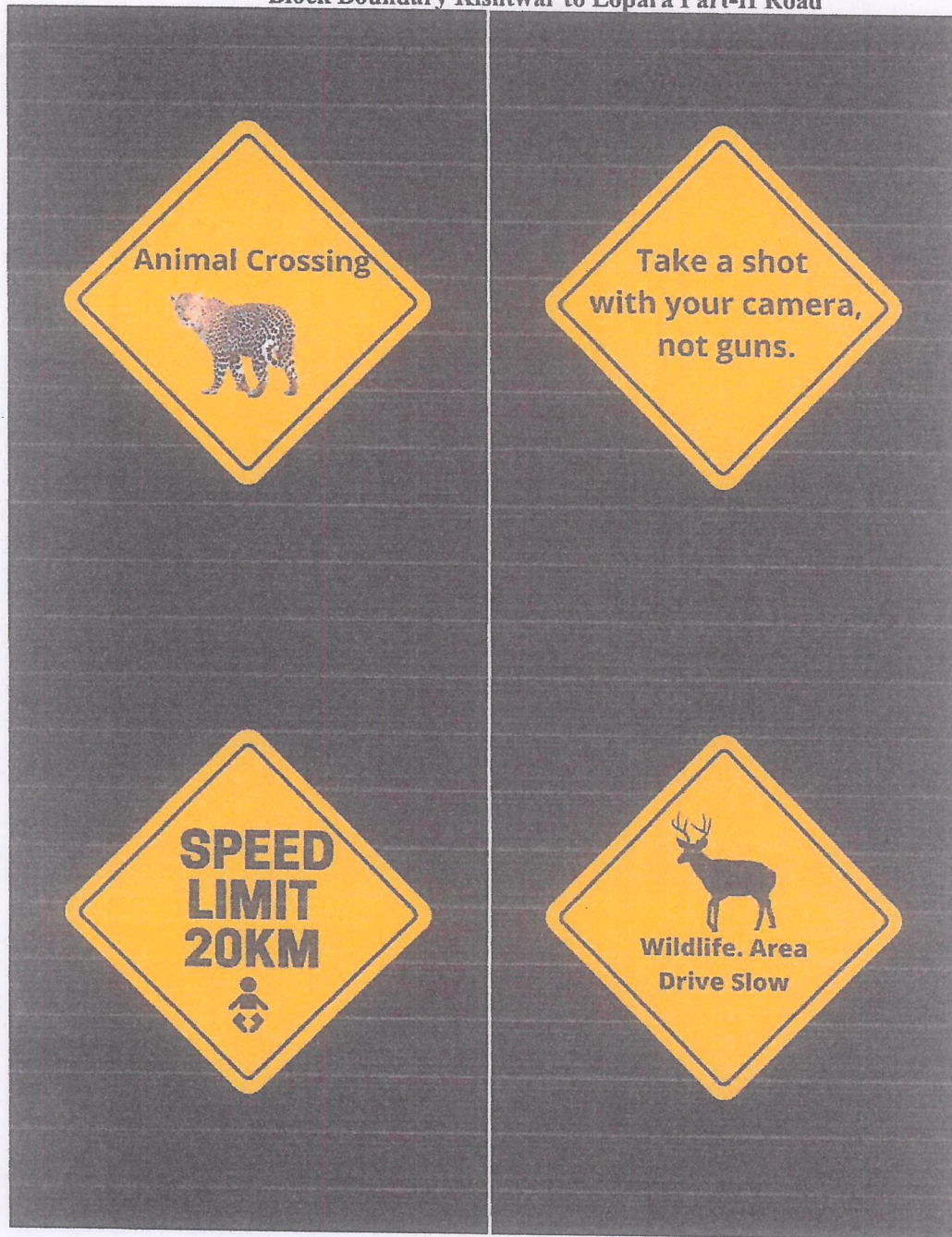

Hasnain
Wildlife Warden
Chenab Division
Kishtwar

Naresh
Divisional Forest Officer
Marwah Forest Division
H. O. Kishtwar

Naresh
Executive Engineer
PMGSY Division
Marwah

Details of Under passes proposed for safe passage of wild Animals in forest Land on Ikhala Block Boundary Kishtwar to Lopara Part-II Road

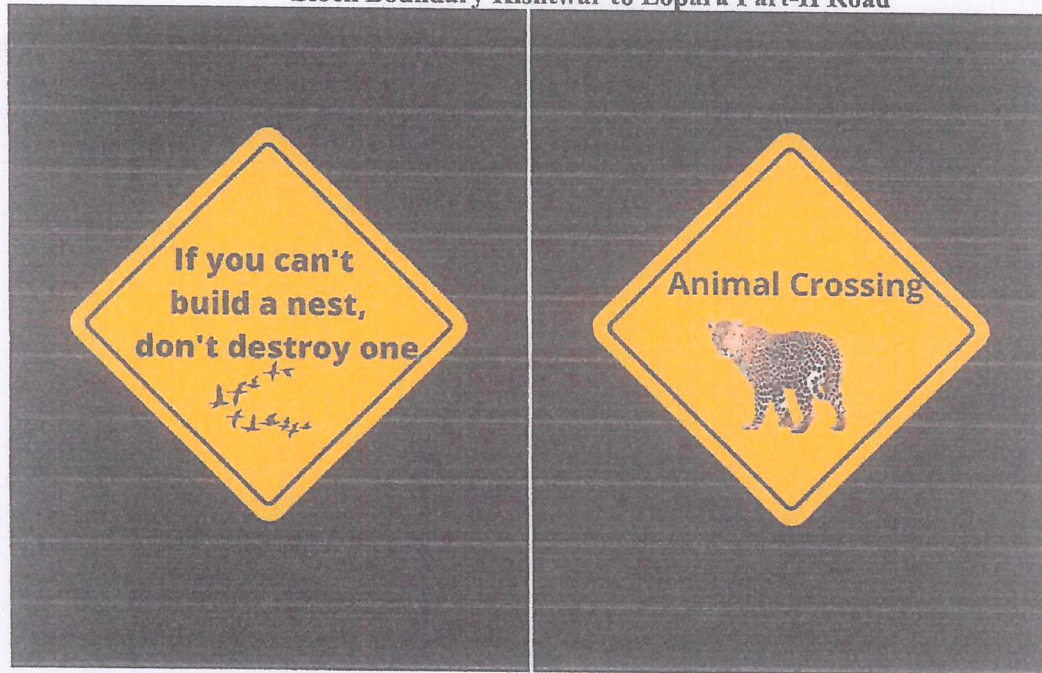

- Road Studs / Speed Breakers will be provided at the start and at the end of each stretch of Wildlife Area / Forest Area.

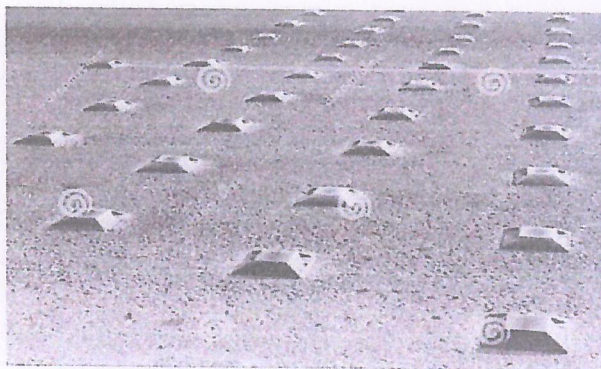
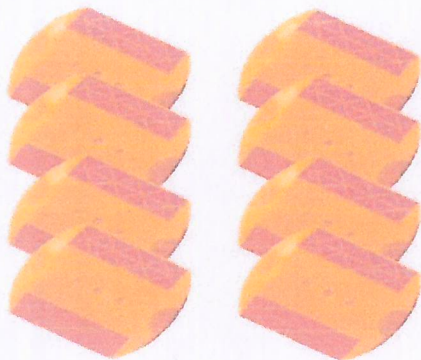

[Signature]
Wildlife Warden
Chenab Division
Kishtwar

[Signature]
Divisional Forest Officer
Kishtwar Forest Division
H. O, Kishtwar

[Signature]
Executive Engineer
PMGSY Division
Marwah

**GPS MAP FOR CONSTRUCTION OF ROAD FROM IKHALA BLOCK BOUNDARY KISHTWAR TO LOPARA
(PART-II) UNDER PACKAGE NO. JKO4-167, PHASE-X, STAGE-I, LENGTH=13.00KM PIU- MARWAH,
DISTRICT KISHTWAR.**

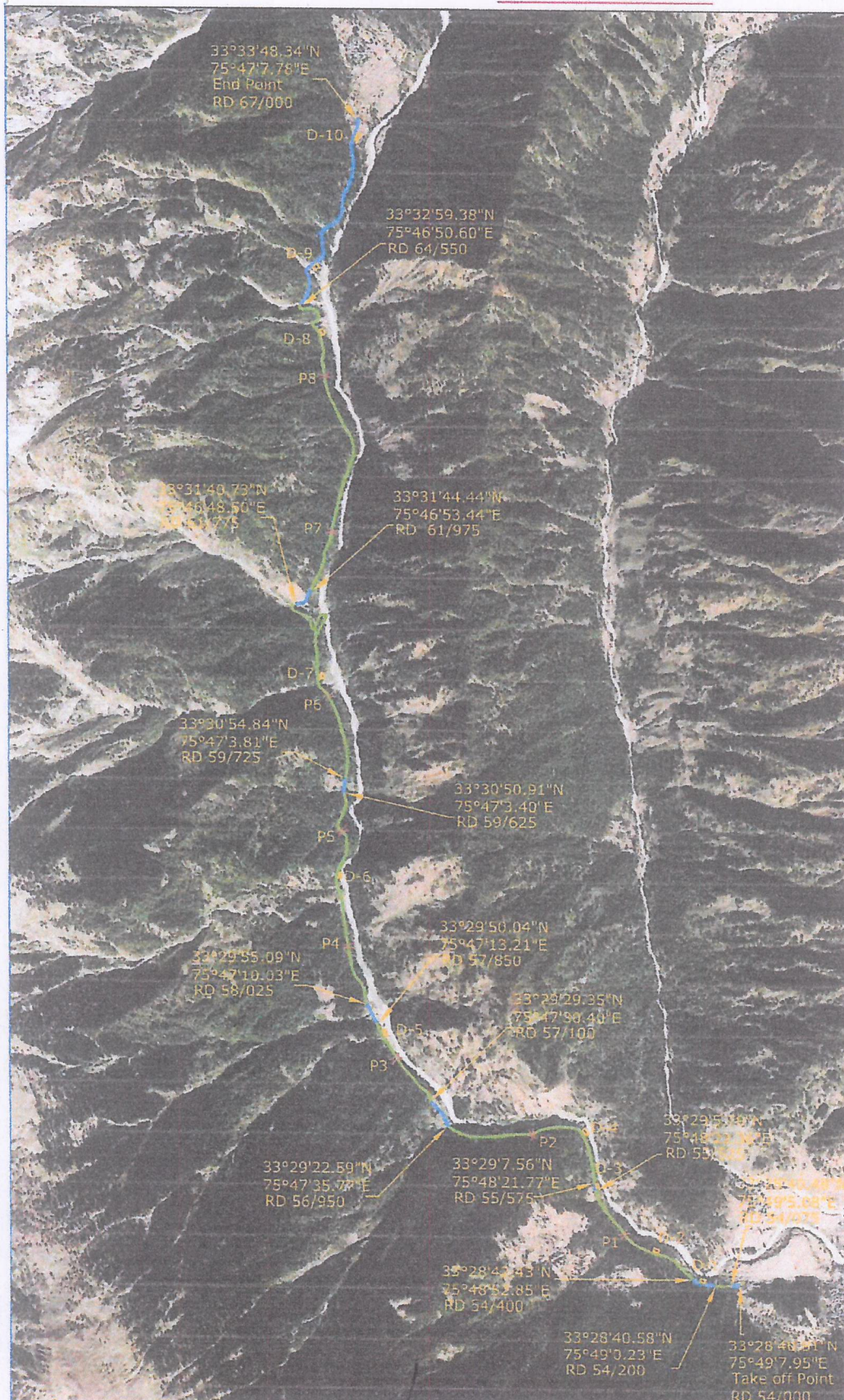

GPS COORDINATES PASSAGE SITE		
P-1	33°28'55.17"N	75°48'30.64"E
P-2	33°29'21.84"N	75°48'9.82"E
P-3	33°29'41.74"N	75°47'18.88"E
P-4	33°30'9.86"N	75°47'4.54"E
P-5	33°30'40.89"N	75°47'2.35"E
P-6	33°31'19.67"N	75°46'55.75"E
P-7	33°32'4.68"N	75°47'0.88"E
P-8	33°32'49.39"N	75°46'57.26"E

SCALE:- 1:40000

GPS COORDINATES DUMPING SITE		
ID	LATITUDE	LONGITUDE
D-1.	33°28'40.58"N	75°49'0.23"E
D-2.	33°28'49.40"N	75°48'41.55"E
D-3.	33°29'5.79"N	75°48'22.36"E
D-4.	33°29'19.83"N	75°48'18.82"E
D-5.	33°29'47.04"N	75°47'14.88"E
D-6.	33°30'28.84"N	75°47'1.12"E
D-7.	33°31'21.20"N	75°46'55.84"E
D-8.	33°32'51.86"N	75°46'56.43"E
D-9.	33°33'9.67"N	75°46'54.25"E
D-10.	33°33'41.51"N	75°47'7.03"E

LEGEND:-

1.	FOREST LAND	
2.	REVENUE LAND	
3.	DUMPING POINT	
4.	PASSAGE SITE	

Wildlife Warden
Chenab Division
Kishtwar

Divisional Forest Officer
Kishtwar

Executive
PWSY Division

GEO REFERENCE MAP FOR CONSTRUCTION OF ROAD FROM IKHALA BLOCK BOUNDARY KISHTWAR TO LOPARA (PART-II) UNDER PACKAGE NO. JKO4-167, PHASE-X, STAGE-I, LENGTH=13.00KM PIU- MARWAH, DISTRICT KISHTWAR.



SCALE:- 1:40000

GPS COORDINATES

ID	LATITUDE	LONGITUDE
1.	33°28'40.91"N	75°49'7.95"E
2.	33°28'40.48"N	75°49'5.08"E
3.	33°28'40.58"N	75°49'0.23"E
4.	33°28'42.43"N	75°48'52.85"E
5.	33°28'49.40"N	75°48'41.55"E
6.	33°29'5.79"N	75°48'22.36"E
7.	33°29'7.56"N	75°48'21.77"E
8.	33°29'19.83"N	75°48'18.82"E
9.	33°29'22.59"N	75°47'35.77"E
10.	33°29'29.35"N	75°47'30.40"E
11.	33°29'47.04"N	75°47'14.88"E
12.	33°29'50.04"N	75°47'13.21"E
13.	33°29'55.09"N	75°47'10.03"E
14.	33°30'28.84"N	75°47'1.12"E
15.	33°30'50.91"N	75°47'3.40"E
16.	33°30'54.84"N	75°47'3.81"E
17.	33°31'21.20"N	75°46'55.84"E
18.	33°31'40.73"N	75°46'48.50"E
19.	33°31'44.44"N	75°46'53.44"E
20.	33°32'51.86"N	75°46'56.43"E
21.	33°32'59.38"N	75°46'50.60"E
22.	33°33'9.67"N	75°46'54.25"E
23.	33°33'41.51"N	75°47'7.03"E
24.	33°33'48.34"N	75°47'7.78"E

GPS COORDINATES PASSAGE SITE

P-1	33°28'55.17"N	75°48'30.64"E
P-2	33°29'21.84"N	75°48'9.82"E
P-3	33°29'41.74"N	75°47'18.88"E
P-4	33°30'9.86"N	75°47'4.54"E
P-5	33°30'40.89"N	75°47'2.35"E
P-6	33°31'19.67"N	75°46'55.75"E
P-7	33°32'4.68"N	75°47'0.88"E
P-8	33°32'49.39"N	75°46'57.26"E

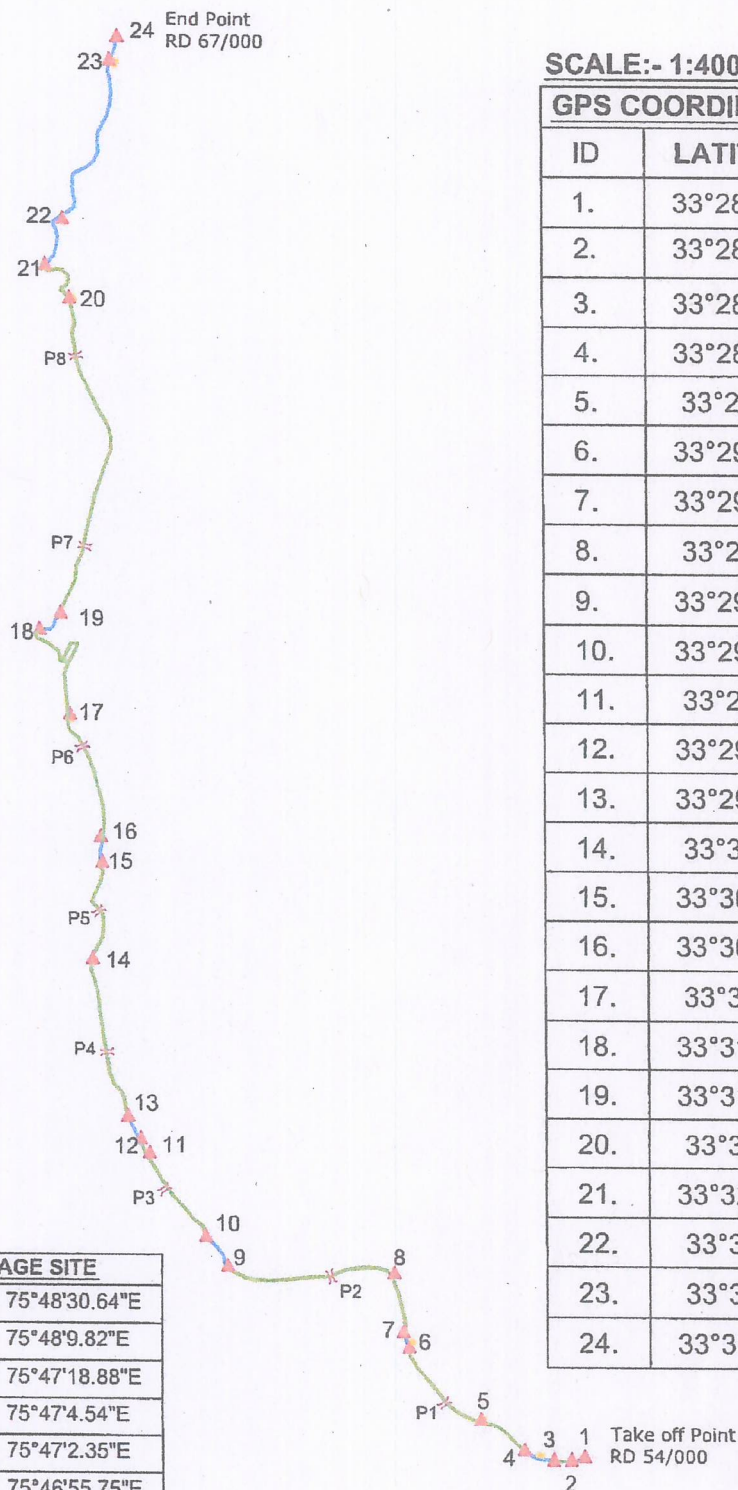

LEGEND:-

1.	FOREST LAND	
2.	REVENUE LAND	
3.	DUMPING POINT	
4.	PASSAGE SITE	

Wildlife Warden
Chenab Division
Kishtwar

Executive Engineer
PMGSY Division
Marwah

Divisional Forest Officer
Kishtwar

**PLAN SHOWING THE DRAWINGS OF APPROACH PATH WALLING AND 3MTR SPAN RCC CULVERT FOR
SAFE PASSAGE OF WILD ANIMALS IN FOREST LAND ON IKHALA BLOCK BOUNDARY KISHTWAR TO
LOPARA ROAD PART-II**

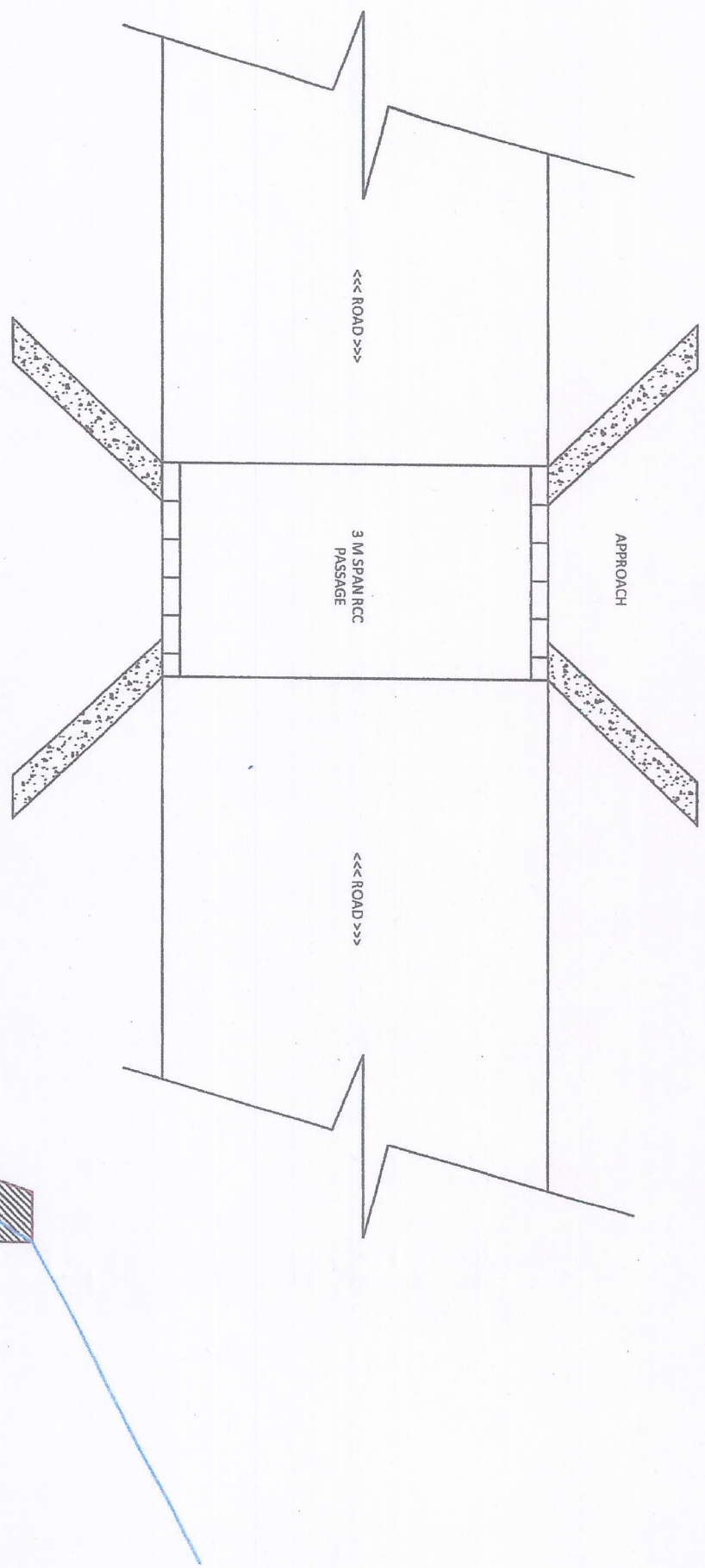

[Signature]
Wildlife Warden
Chenab Division
Kishtwar

[Signature]
Divisional Forest Officer
Marwah Forest Division
H. O. Kishtwar

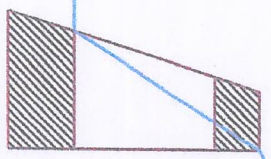

X-SECTION OF APPROACH WALL TO
CULVERT FOR PASSING WILD ANIMALS

[Signature]
Executive Engineer
P.W.D. Division
Kishtwar

LAYOUT PLAN FOR CONSTRUCTION OF ROAD FROM IKHALA BLOCK BOUNDARY KISHTWAR TO LOPARA (PART-II)
UNDER PACKAGE NO. JKO4-167, PHASE-X, STAGE-I, LENGTH=13.00KM PIU- MARWAH, DISTRICT KISHTWAR.

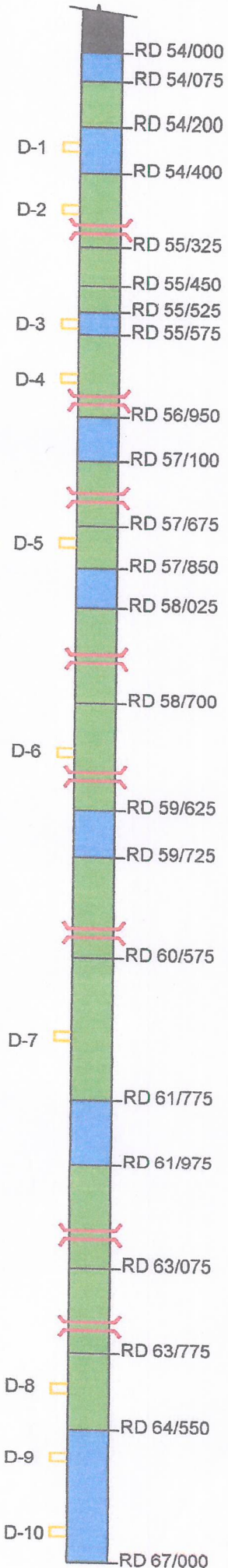

FOREST AREA DETAILS

		LENGTH X WIDTH	AREA
RD 54/075	TO	54/200	750 M ²
RD 54/400	TO	55/325	5550 M ²
RD 55/325	TO	55/450	750 M ²
RD 55/450	TO	55/525	450 M ²
RD 55/575	TO	56/950	8250 M ²
RD 57/100	TO	57/675	3450 M ²
RD 57/675	TO	57/850	1050 M ²
RD 58/025	TO	58/700	4050 M ²
RD 58/700	TO	59/625	5550 M ²
RD 59/625	TO	60/575	5100 M ²
RD 60/575	TO	61/775	7200 M ²
RD 61/775	TO	63/075	6600 M ²
RD 63/075	TO	63/775	4200 M ²
RD 63/775	TO	64/550	4650 M ²
TOTAL			57600 M² - A

DUMPING AREA DETAILS IN FOREST LAND

$$\frac{6}{6} = \frac{1712 \text{ M}^2 - B}{1712 \text{ M}^2 - B}$$

$$\text{TOTAL AREA} = A + B = 57600 \text{ M}^2 + 1712 \text{ M}^2 = 59312 \text{ M}^2 \text{ OR } 5.9312 \text{ HECTARES}$$

LEGEND:-

1.	FOREST LAND	
2.	STATE / PRIVATE LAND	
3.	OTHER ROAD	
4.	DUMPING POINT	
5.	PASSAGE SITE	

Executive Engineer
PHASE I Division
MARWAH

Wildlife Warden
Chenab Division
Kishtwar

Officer Forest Officer
Marwah Forest Division
MARWAH

**PLAN SHOWING THE DRAWINGS OF APPROACH PATH WALLING AND 3MTR SPAN RCC CULVERT FOR
SAFE PASSAGE OF WILD ANIMALS IN FOREST LAND ON IKHALA BLOCK BOUNDARY KISHTWAR TO
LOPARA ROAD PART-II**

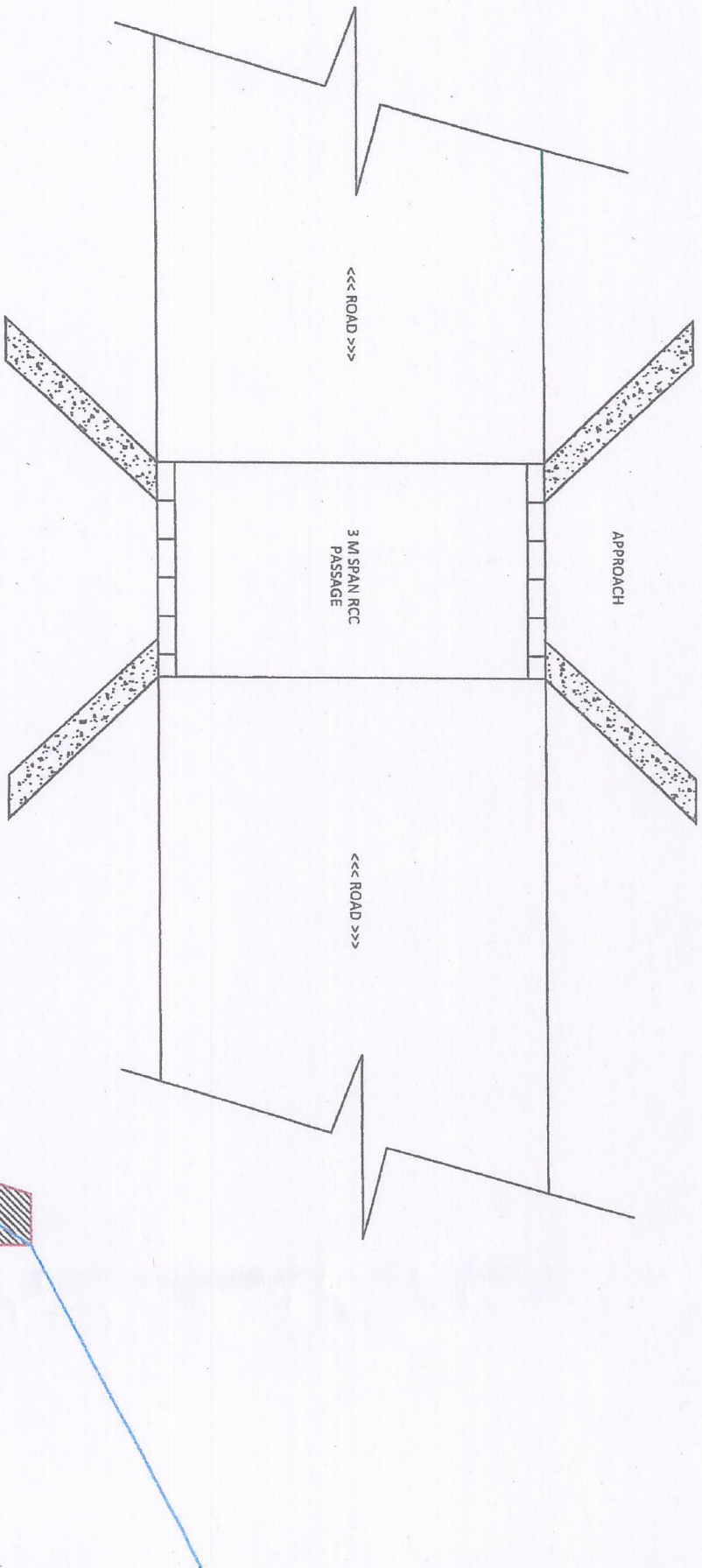

[Signature]
Wildlife Warden
Chenab Division
Kishtwar

[Signature]
Additional Forest Officer
Marwah Forest Division
H. O. Kishtwar

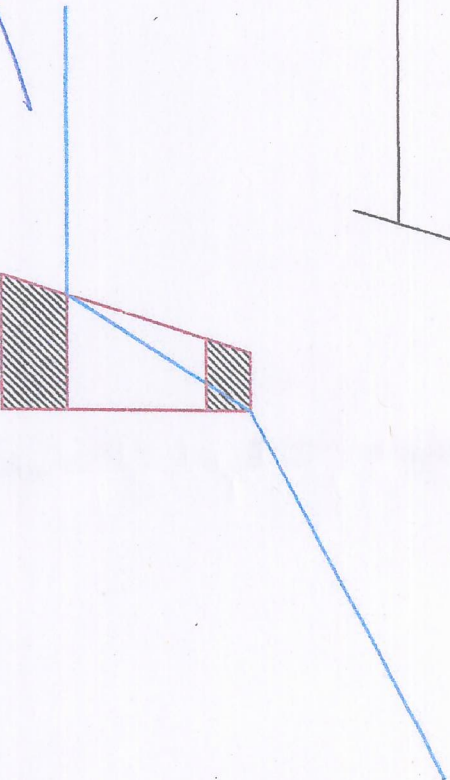

X-SECTION OF APPROACH WALL TO
CULVERT FOR PASSING WILD ANIMALS

[Signature]
Executive Engineer
PCCSY Division
Marwah

**PLAN SHOWING THE DRAWINGS OF APPROACH PATH WALLING AND 3MTR SPAN RCC CULVERT FOR
SAFE PASSAGE OF WILD ANIMALS IN FOREST LAND ON IKHALA BLOCK BOUNDARY KISHTWAR TO
LOPARA ROAD PART-II**

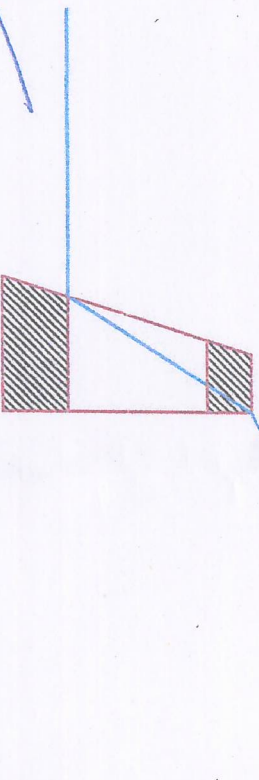
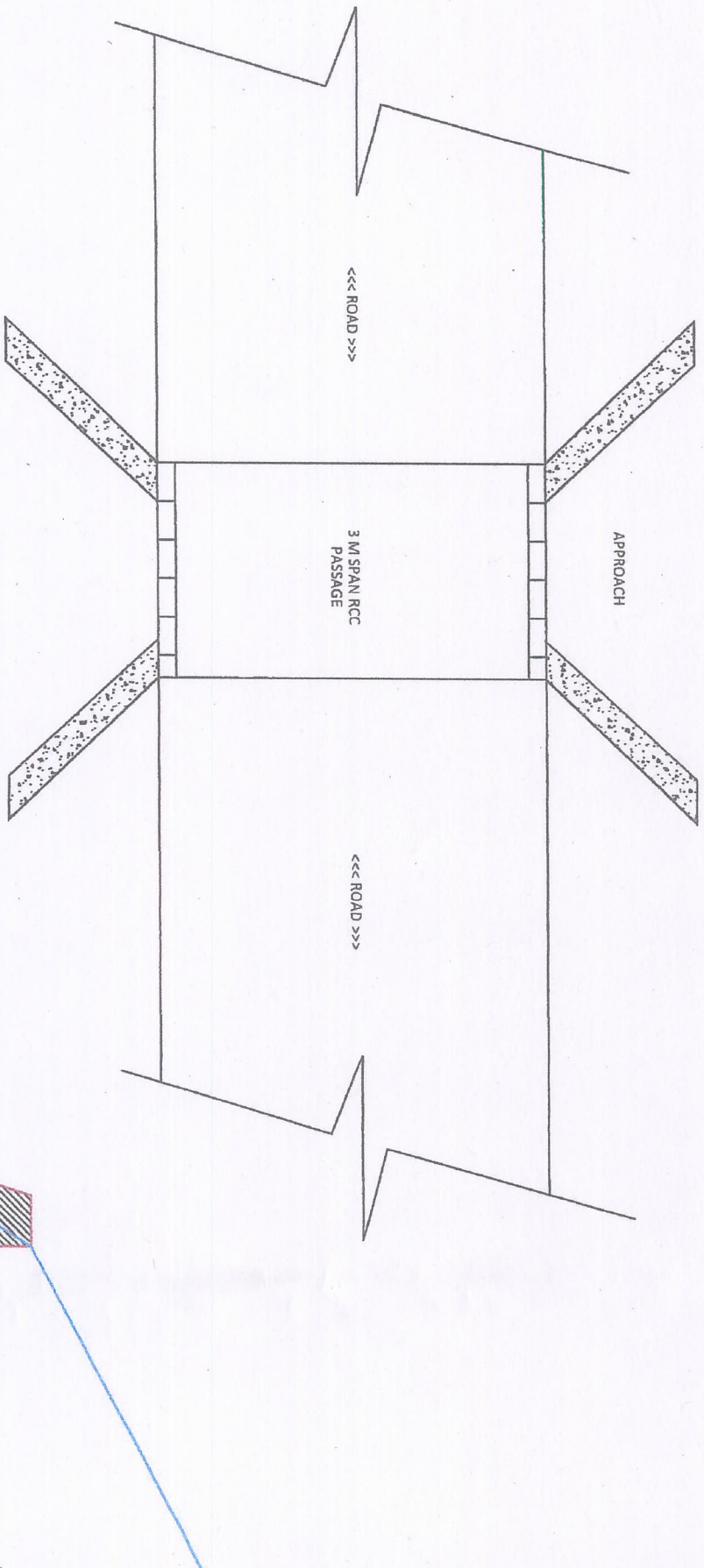

[Signature]
Wildlife Warden
Chenab Division
Kishtwar

[Signature]
Additional Forest Officer
Marwah Forest Division
H. O. Kishtwar

[Signature]
Executive Engineer
PMGSY Division
Marwah