

C-Bhupathipur

o/c

**Government of Telangana
Roads & Buildings Department**

From:
Sri. N.Venkatesh, M. Tech.,
District (R&B) Officer,
(Executive Engineer)
JS-Bhupalapally, Mulugu.

To:
The District Forest Officer ,
Mahabubabad

Lr.No Forest land/EE R&B BHPL MLG /2022-23 Dt: 13 .04.2023

Sir,

Sub: District (R&B) Officer, JS Bhupalapally, Mulugu – TSFD- F (C) Act, 1980 –
Diversion of 1.866 Ha Forest land for Construction of BT road from Chityal
to Bhupathipuram from Km 0/0 to 5/0 in Chityal, R/f in WLM Etunagaram
Forest Division in Mulugu District in favour of District (R&B) Officer, Mulugu
– Additional information sought for by IRO, Hyd- Reg.

Ref: 1)The Prl. Chief Conservator of Forests (HoFF) , TS, Hyderabad Rc No
FC2/FC09/28/2022 (18040/2019/FCA-2) Dt:11.10.2022
2)AIGF (C), GoI MoEF & CC IRO, Hyd F.No.4-TSB268/2022-HYD/732
Dt:29.09.2022

OoOoOo

Adverting to the subject cited above, the Prl. Chief Conservator of Forests (HoFF) ,
TS, Hyderabad vide reference 1st cited has issued instructions to the District Forest
Officer, Mahabubabad to submit information / details on

Point No.6 i.e., As per topo map, identified Non-Forest area for CA is overlapping
with Jally III RF . State Government may re-verify and inform the whether the NFL
identified ia a non-forest land or it has some overlapping with the RF area and mutation
certificate in respect of NFL shall be furnished.

Point no.7 i.e., DFL map duly signed by the DFO along with Kml file in soft copy be
submitted

Point no.8 i.e., Some of the components like vehicle procurement and engagement
of computer operator have been proposed in the CA Scheme which is not consonance with
the provisions of CAF Act Rules.

Hence, it is requested the District Forest Officer, Mahabubabad to submit the
information as mentioned above to the Prl. Chief Conservator of Forests (HoFF) , TS,
Hyderabad along with a copy to this office.

Encl: references cited

Yours faithfully,

Kind file to change

13/4/23
District R&B Officer
(Executive Engineer)
JS Bhupalapally, Mulugu

Cross Section

13/4/23

21/4/23

GOVERNMENT OF TELANGANA
ROADS AND BUILDINGS DEPARTMENT

From,
Sri N.Venkatesh, M.Tech
District (R&B) Officer,
(Executive Engineer)
JS Bhupalapally, Mulugu

To
The District Forest Officer
Mulugu District

Letter No. DB/ATO/EE/R&B/Mlg /P-A road/ 2022-23/

Dated:10-01-2023

Sir,

Sub:-Dist. R&B Office Mulugu- Diversion of 1.866 Ha of Forest land of Mulugu district for construction of B.T. road from Chityala to Bhupathipuram from Km 0/0 to 5/0 in Chityala RF in VWLM Eturnagaram Division of Mulugu district in favour of District R&B Officer, Mulugu District – EDS raised by IRO- submission of replies-reg.

Ref : -1. PCCF, Telangana, Hyderabad, RC No. FC2/FC09/28/2022 (18040/2019/FCA-2), Dt 11-10-2022
2. Gol, MoEF&CC, IRO, Hyd., Lr.No. 4-TSB268/2022-CHN/789, dt:29-09-2022
3. DEE, R&B, Mulugu, Lr No. DEE/R&B/Mlg/Chityal/Frst/2021, Dt. 10.01.2023

* * *

With reference to the subject cited it is to inform that vide ref. 1st cited the PCCF, Telangana has communicated the ref. 2nd cited in which EDS raised by the IRO Hyderabad. Accordingly I submit herewith the replies point-wise as under.

1. Design / Cross-Section of the road is herewith furnished
2. To be attended by the District Forest Officer, Mulugu
3. To be attended by the District Forest Officer after approval of the NBWL.
4. DGPS map and complete .KML file uploaded in Parivesh portal
5. Existing road is a old cart track. The legal status of the road to be clarified by the District Forest Officer, Mulugu
6. CA land identified in Mahabubabad District. Hence the point is to be clarified by the District Forest Officer, Mahabubabad.
7. To be clarified by the District Forest Officer, Mahabubabad.
8. To be clarified by the District Forest Officer, Mahabubabad.
9. To be attended by the District Forest Officer, Mulugu
10. To be attended by the District Forest Officer, Mulugu

Therefore I request the District Forest Officer, Mulugu to submit the compliance as called by the PCCF Telangana vide ref. 1st cited at the earliest for further process of the above diversion proposal.

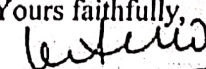
Yours faithfully,

District R&B Officer,
(Executive Engineer)
JS Bhupalapally, Mulugu

1. Copy to District Forest Officer, Mahabubabad and requested to submit the compliance as called by the PCCF Telangana vide ref. 1st cited for the points concerned to your selves.

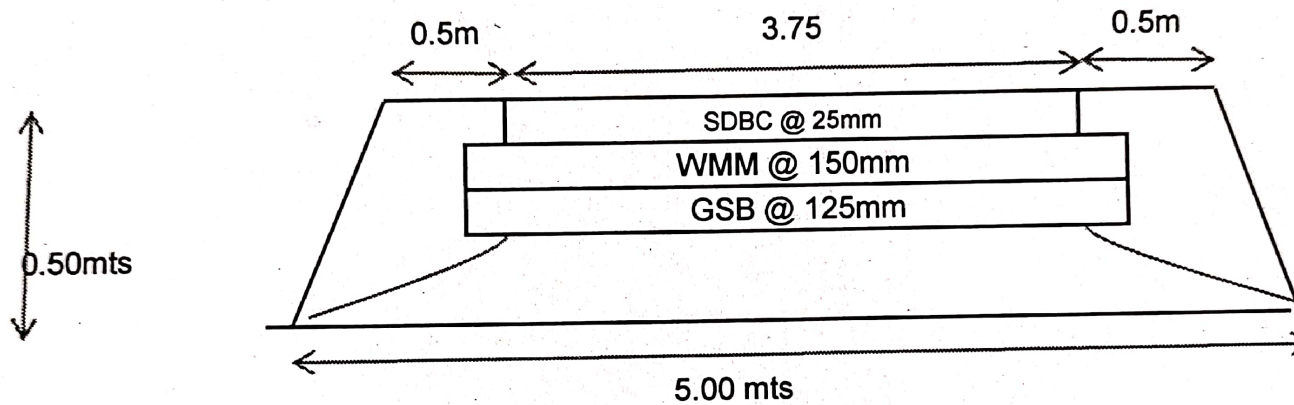
Name of Work: **Construction of BT Road from Chityal to Bhupatipur from Km 0/0 to 5/0 in Mulugu District**



Berz
Dy. Executive Engineer
R&B Sub-Division: Mulugu.

Map showing CA land to be taken over in Sy No 1 of Rangapuram (V), Allapalli (M)
of Kinnerasani Division in lieu of forest lands proposed for diversion for various Road Projects in Kothagudem Division



Fairly dense mixed jungle

389

MARKODE RF

MAR 8

MAR 31

MAR 29

KINNERASANI

Rangapuram

MAR 30

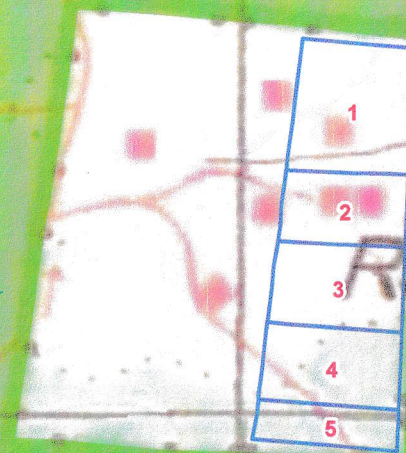

Sno	District	Name of the Road Proposal	Apportionment Area_Ha
1	Mulugu	Edhira to Kothapally	3.1430
2	Mulugu	Chityal to Bhupatipuram	1.8660
3	Mulugu	Cherukuru to Peruru	2.2880
4	Mulugu	Patha Alubaka to Seetharampuram	2.2293
5		Balance	1.1964
Total			10.7227

Prof. Bhadrachari Kothagudem.

MAR 28

376

Legend

Area Proposed for CA Land

Geographic Coordinate System - WGS84 Datum (UTM 44N)

Tagged to nearest SOI GCP

0 200 400 800 Meters

Map showing CA land to be taken over in Sy No 1 of Rangapuram (V), Allapalli (M)
of Kinnerasani Division in lieu of forest lands proposed for diversion for various Road Projects in Kothagudem Division

Total Area in Ha - 10.7249 Ha

Name	Easting	Northing	Longitude	Latitude
PP02	460525.987	1981435.071	80.62728908	17.92055024
R012	460369.917	1981548.652	80.62581335	17.92157401
R013	460365.988	1981518.674	80.62577683	17.92130299
R014	460362.393	1981488.929	80.62574345	17.92103407
R015	460358.541	1981458.913	80.62570764	17.92076271
R016	460354.882	1981429.447	80.62567366	17.92049631
R017	460350.800	1981399.631	80.62563568	17.92022674
R018	460346.878	1981370.219	80.62559921	17.91996083
R019	460343.309	1981340.166	80.62556608	17.91968913
R020	460338.051	1981310.567	80.62551700	17.91942150
R021	460336.953	1981280.110	80.62550721	17.91914620
R022	460332.468	1981250.474	80.62546543	17.91887824
R023	460327.272	1981221.935	80.62541691	17.91862020
R024	460324.578	1981191.442	80.62539206	17.91834455
R025	460320.797	1981162.139	80.62535691	17.91807961
R026	460316.460	1981131.382	80.62531655	17.91780154
R027	460313.622	1981101.540	80.62529032	17.91753176
R028	460310.501	1981072.908	80.62526139	17.91727291
R029	460305.172	1981042.491	80.62521166	17.91699789
R030	460303.692	1981011.256	80.62519828	17.91671555
R031	460295.404	1980974.010	80.62512073	17.91637875
RP02	460420.371	1981544.325	80.62628981	17.92153583
RP03	460470.201	1981540.011	80.62676038	17.92149773
RP04	460530.174	1981534.968	80.62732673	17.92145324
RP05	460528.209	1981485.049	80.62730912	17.92100201
RP07	460523.950	1981385.073	80.62727080	17.92009830
RP08	460521.882	1981335.140	80.62725222	17.91964694
RP09	460519.886	1981285.139	80.62723431	17.91919497
RP10	460517.798	1981235.254	80.62721554	17.91874404
RP11	460515.597	1981185.226	80.62719571	17.91829183
RP12	460513.466	1981135.482	80.62717653	17.91784217
RP13	460511.426	1981085.549	80.62715821	17.91739082
RP14	460509.439	1981035.464	80.62714040	17.91693808
RP15	460507.153	1980985.430	80.62711976	17.91648581
RP16	460506.080	1980956.021	80.62711019	17.91621997
RP17	460456.258	1980960.531	80.62663970	17.91625984
RP18	460406.352	1980964.906	80.62616843	17.91629847
RP19	460350.699	1980969.908	80.62564288	17.91634268

KINNERASANI

Rangapuram

FOREST RANGE OFFICER
W.L.M. REGALLA

Forest Divisional Officer
Wildlife Management Division, Kinnerasani

Dy. Executive Engineer (R&B)
Sub-Division-YELLANDU (R&B) Spl. Division, KOTHAGUDEM

EXECUTIVE ENGINEER
Spl. Division, KOTHAGUDEM

Legend
 * DGPS Surveyed Points
 Area Proposed for CA Land

Geographic Coordinate System - WGS84 Datum (UTM 44N)

Not tagged to SOI GCP

80°37'0"E

80°38'0"E

0 200 400 800 Meters

525-

17°55'0"N

17°55'0"N

80°38'0"E

80°37'0"E

3



MAR

MAR 31

MAR 29

MAR 8

MAR 30

MAR 28



[Signature]

[Signature]

351

GOVERNMENT OF TELANGANA
REVENUE DEPARTMENT.

OFFICE OF THE TAHSILDAR: ALLAPALLI.

Rc.No.B/191/2020.

Dt.23.12.2020.

CERTIFICATION OF MUTATION

1. This is certified that an extent of Ac.283.82 gts in Sy.No.28 situated at Rangapuram, Ulvachelka and Busurai enclosures in Markode Reserve forest of Ulvachelka Revenue Village of Allapally Mandal is Government land and free from all encumbrances and encroachments has been transferred and mutated in favour of the Telangana Forest Department represented by the Forest Range Officer, Regalla for Compensatory afforestation in lieu of Reserve Forest land proposed for diversion under Forest (Conservation) Act, 1980 to improve the road connectivity of the following roads proposed by the R & B Department, i.e, (1) Road from Veerapuram to Gundala (38.55 Ha), (2) Gundala to Parsa (Up to Dubbathanda - 9.02 Ha.), (3) Mamakannu to Battupally (39.153 Ha), (4) Tekulapally to Gundala (24.74 Ha) and (5) Peddamidisileru to Bhatinapally (16.56 Ha).



Tahsildar, Allapally,
Bhadrachalam District,
BHADRACHALAM DISTRICT, TELANGANA

353

GOVERNMENT OF TELANGANA
REVENUE DEPARTMENT,

OFFICE OF THE TAHSILDAR: ALLAPALLI.

Rc.No.B/191/2020

Dt.23.12.2020.

CERTIFICATION OF NON-ENCUMBRANCE

1. This is certified that an extent of Ac.283.82 gts in Sy.No.28 situated at Rangapuram, Ulvachelka and Busurai enclosures in Markode Reserve forest of Ulvachelka Revenue Village of Allapally Mandal is Government land and free from all encumbrances and encroachments proposed for transfer to the Forest Department for Compensatory afforestation in lieu of Reserve Forest land proposed for diversion under Forest (Conservation) Act, 1980 to improve the road connectivity of the following roads proposed by the R & B Department, i.e, (1) Road from Veerapuram to Gundala (38.55 Ha), (2) Gundala to Parsa (up to Dubbathanda - 9.02 Ha.), (3) Mamakannu to Battupally (39.153 Ha), (4) Tekulapally to Gundala (24.74 Ha) and (5) Peddamidisileru to Bhatinapally (16.56 Ha).
2. This area has not been proposed for any other assignment/ pattas or alternate use by the Government.
3. Certified that the above Government land has not been proposed earlier to the Forest Department for afforestation.



Tahsildar, Allapally,
ALLAPALLY MANDAL
Bhadrachalam District,
BHADRACHALAM DIST.

HANDING OVER OF GOVERNMENT NON-FOREST LAND TO THE FOREST DEPARTMENT FOR COMPENSATORY AFFORESTATION FOR THE FOREST DEPARTMENT

The Government Non-forest land measuring Ac.283.82 gts. as detailed here under situated in Ulvachelka Revenue Village of Allapally Mandal has been inspected jointly with the Forest Range Officer, Regalla.

Sl.No.	Mandal	Revenue Village	Sy.No.	Extent	Remarks
				Ac.gts. or Ha.	
1.	Allapally	Ulvachelka	28	283.82	Ulvachelka, Busurai and Part of Rangapuram enclosure

There are no encroachments or any obstructions are appeared. The boundaries have been fixed and peg marked. This possession of the above land has been handed over to Forest Range Officer, Regalla, Kinnerasani WLM Division, Palvanha on 23.12.2020 towards Compensatory Afforestation in lieu of Reserve Forest land proposed for diversion under Forest (Conservation) Act, 1980 to improve the road connectivity of the following roads proposed by the R & B Department, i.e, (1) Road from Veerapuram to Gundala (38.55 Ha), (2) Gundala to Parsa (Up to Dubbathanda - 9.02 Ha.), (3) Mamakannu to Battupally (39.153 Ha), (4) Tekulapally to Gundala (24.74 Ha) and (5) Peddamidisileru to Bhatinapally (16.56 Ha), total 128.023 Ha. as per the proceedings of the District Collector, Bhadradi Kothagudem, vide Rc.No. E1/3171/2020, Dt.19.09.2020.

Handed over by

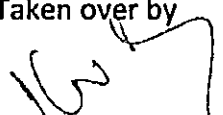
 Tahsildar, Allapally,
 Bhadradi Kothagudem District.

Taken over by

 Forest Range Officer, Regalla,
 Kinnerasani WLM Division,
 Palvanha.