

वन विभाग हरियाणा सरकार  
कार्यालय : वन मण्डल अधिकारी, रोहतक

पता : झंग कालोनी, नजदीक विजय पार्क, रोहतक, Phone No. 01262-256940, E-mail dforohtak2@yahoo.com

क्रमांक

942

दिनांक

17/9/21

सेवा में,

अतिरिक्त प्रधान मुख्य वन संरक्षक, (एफ0सी0ए0)  
हरियाणा, पंचकुला।

विषय:

**Diversion of 0.0918 Ha. of forest land for Const. of 132 KV S/C D/C  
Kalanaur to Manheru Line in under forest division and Distt. Rohtak.**

सन्दर्भ:

आपका पृ0 क्रमांक D-III-9925/2154-57 दिनांक 07.07.2021.

—0—

उपरोक्त विषय के सम्बन्ध में आपको अनुरोधपूर्वक अवगत करवाया जाता है कि सन्दर्भांकित पत्र में अंकित क्रं0स0 1 तथा 2 द्वारा मांगी गई सूचना तथा सी0ए0साईट का डी0जी0पी0एस0 मैप व के0एम0एल0 फाईल आर्न लाईन पार्ट-II में अपलोड दी गई है। रिपोर्ट आपकी सेवा में सूचनार्थ एवं आगामी आवश्यक कार्यवाही हेतु प्रेषित है।

संलग्न/उपरोक्त

पृ0 क्रमांक:

943

दिनांक:

17/9/21

उप वन संरक्षक, 01C  
रोहतक।

17/09/2021

प्रेषित है।

एक प्रति मुख्य वन संरक्षक, मध्य परिमण्डल रोहतक को सूचनार्थ एवं आगामी कार्यवाही हेतु

उप वन संरक्षक, 01C  
रोहतक।

17/9/2021

17/09/2021

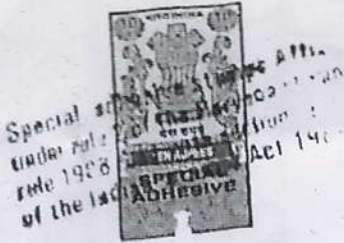

6190

18  
161712

Bijender kumar s/ satyvir  
Singh  
R/ Biji board  
Colloney (Bhiwari)

Title: DIVERSION OF 0.0918 Hac.FOREST LAND FOR Providing Construction of 132Kv  
S/C on D/C Tower Kalanaur- Manheru line. at village Rohtak Distt-Rohtak(HR)  
File No. :  
Date of Proposal :

### CHECK LIST SERIAL NUMBER -13

UNDERTAKING FOR PAYMENT OF COST OF NET PRESENT VALUE  
OF  
FOREST AREA

I/We Executive Engineer, T.S. Division, HVPNL, Bhiwani have applied for  
diversion of 0.0918 hac. of forest area for the Providing of construction of 132Kv  
S/C on D/C Tower Kalanaur- Manheru line. Crossing strips of Protected forest  
land, under Forest Division & Distt. Rohtak (HR)

I/we, hereby, undertaking to pay the additional amount of NPV, if so  
determined as per the decision of the Hon'ble Supreme Court.

Date.....

Place.....

CL

Signature of User Agency

Office Seal

S. D. O. Const. S/O Div.  
H.V.P.N.L. BHIWANI

Counter signed By:-

Divisional Forests Officer

.....Forest

Office

Division

Dy. Conservator of Forests  
ROHTAK

Seal \_\_\_\_\_

FP/HR/TRANS/118341/2021 132KV Line

# CA Site :- Meham Minor RD 52 to 68 R&L - Side



## Legend

- GPS Points
- CA Site

Dy. Conservator of Forests  
ROHTAK



28° 59' 25.973" N, 76° 20' 17.124" E 28° 59' 26.126" N, 76° 20' 17.315" E  
28° 59' 25.754" N, 76° 20' 16.851" E

28° 59' 6.673" N, 76° 20' 34.241" E 28° 59' 6.749" N, 76° 20' 34.485" E  
28° 59' 6.575" N, 76° 20' 33.888" E

28° 58' 23.014" N, 76° 20' 30.238" E 28° 58' 22.937" N, 76° 20' 30.481" E  
28° 58' 23.124" N, 76° 20' 29.890" E 28° 58' 23.091" N, 76° 20' 29.995" E

28° 58' 5.622" N, 76° 20' 19.742" E 28° 58' 5.464" N, 76° 20' 19.928" E  
28° 58' 5.855" N, 76° 20' 19.485" E 28° 58' 5.771" N, 76° 20' 19.546" E

28° 57' 45.551" N, 76° 18' 41.764" E 28° 57' 45.648" N, 76° 18' 41.751" E  
28° 57' 45.098" N, 76° 18' 41.824" E 28° 57' 45.325" N, 76° 18' 41.794" E

28° 57' 40.775" N, 76° 18' 31.068" E 28° 57' 40.367" N, 76° 18' 31.490" E  
28° 57' 40.703" N, 76° 18' 31.143" E 28° 57' 40.535" N, 76° 18' 31.316" E

28° 57' 39.207" N, 76° 19' 35.100" E  
28° 57' 39.417" N, 76° 19' 34.996" E

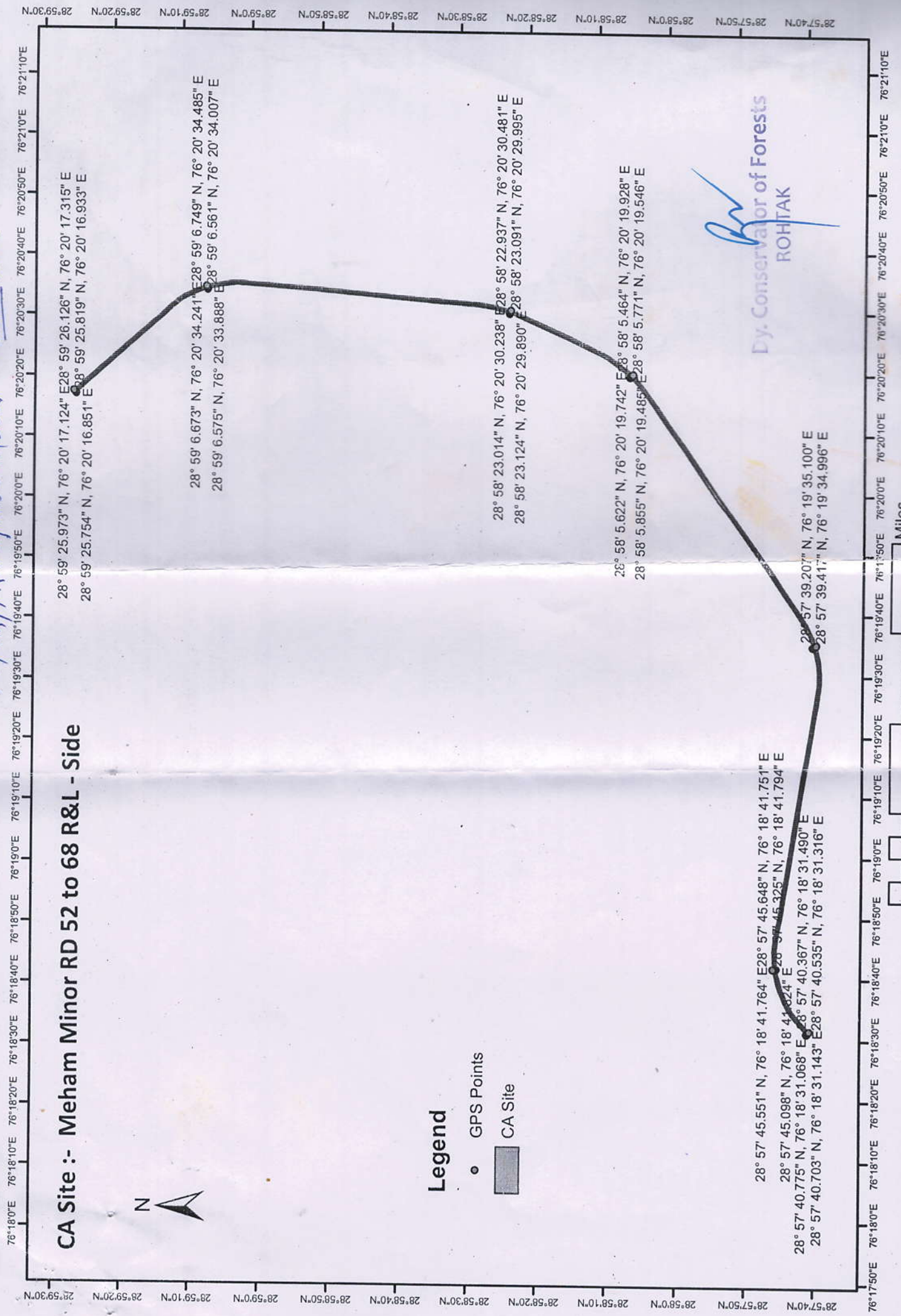
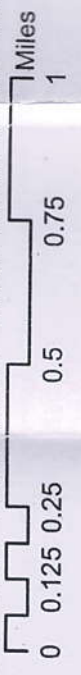

132KV S/C Line on D/C Towers में बाधक वृक्षों की मार्किंग सूची

No.	Name of Reach / Side	Species	V	IV	III	IIA	IIB	IA	IB	Total No.	Vol.	Natural Under Size	Plantation / Plants
1	Kalanaur Jindran Road, Left Side, Katesra Beat, Kalanaur Block	Kiker	0	0	0	0	1	0	0	1	1.98	2	0
		Total	0	0	0	0	1	0	0	1	1.98		
2	Kalanaur Gudan Road, Left & Right Side, Katesra Beat, Kalanaur	Kiker	0	0	1	0	1	0	0	2	2.55	2	16
		Total	0	0	1	0	1	0	0	2	2.55		
3	Kalanaur Nigana Road, Left & Right Side, Katesra Beat, Kalanaur Block	Kiker	0	0	1	1	0	0	0	2	1.7	7	0
		Total	0	0	1	1	0	0	0	2	1.70		
4	Kalanaur Bypass, Left & Right, Katesra Beat Kalanaur Block	Euc	0	0	0	0	0	0	0	0	0	0	44
		Total	0	0	0	0	0	0	0	0	0.00		
5	Rohtak Bhiwani Road, Km 15 to 27 Left Side, Kalanaur Beat, Kalanaur Block	Misc.	0	0	1	0	0	0	0	1	0.57	1	28
		Total	0	0	1	0	0	0	0	1	0.57		
6	Kalanaur Bond Road, Left & Right Side, Kalanaur Beat, Kalanaur Block	Sisham	0	2	0	0	0	0	0	2	0.28	0	2
		Misc.	2	10	0	0	0	0	0	12	1.52		
		Total	2	12	0	0	0	0	0	14	1.80		
7	Gudan Minor, Right Side, Kalanaur Beat, Kalanaur Block	Kiker	0	0	0	1	0	0	0	1	1.13	0	24
		Total	0	0	0	1	0	0	0	1	1.13		
8	Kherari Gudan Approach Road, Right Side, Kalanaur Beat, Kalanaur Block	Kiker	1	0	0	0	0	0	0	1	0.06	0	0
		Total	1	0	0	0	0	0	0	1	0.06		
<b>G.Total</b>			<b>3</b>	<b>12</b>	<b>3</b>	<b>2</b>	<b>2</b>	<b>0</b>	<b>0</b>	<b>22</b>	<b>9.79</b>	<b>12</b>	<b>114</b>

*D. K. Singh*  
 Beat Incharge

*Sanjay Kumar*  
 Block Incharge

Checked by me 100% and found Correct

*C/S*

Checked by me 100% and found Correct

*Sanjay Kumar*  
 Block Incharge

*[Signature]*  
 Dy. Conservator of Forests  
 ROHTAK

*[Signature]*  
 Range Forest Officer  
 Meham