

PROPOSED SITE/LAYOUT PLAN FOR ACCESS TO PRIVATE PROPERTY OF SH. ATMA SINGH S/O SURTA RAM VILL. NABHA AT KM 2.005 (RHS) ON NH - 64 (NEW-07) ZIRAKPUR- PATIALA ROAD, DISTT. S.A.S NAGAR (MOHALI)

NOTES

- 1 ORAL MARKINGS SHALL BE DONE AS PER DIRECTIONS OF NH-64 (NEW-07) AUTHORITY AS PER IRC-67
- 2 ALL DIMENSIONS ARE IN MTR OTHER WISE MENTIONED.

CERTIFICATES / NOTES

- 1 STORM WATER OF OUR BUILDING WILL NOT DISTURB THE NH-64 (NEW-07).
- 2 1.0 M WIDE SLAB CULVERT WILL BE PROVIDED BY US.
- 3 LEVEL OF BUILDING WILL BE KEPT 250MM BELOW THE NH ROAD LEVEL.
- 4 WE SHALL NOT DEMAND ANY GAP IN CENTRAL VERGE IN FRONT OF BUILDING.
- 5 WE WILL NOT CONSTRUCT ANY PUCCA STRUCTURE WITH IN 10.0M ON OUR LAND.
- 6 THE MORTH INSTRUCTIONS SHALL NOT VIOLATED.
- 7 CERTIFIED THAT ALL MORTH CONDITIONS HAVE BEEN SPECIFIED.
- 8 CERTIFIED THAT WE WILL APPLY THE CASE FOR RENEWAL AFTER 5 YEARS FROM THE DATE OF ISSUE.
- 9 WE WILL PAY THE NECESSARY RENT FOR THE USE OF NH-64 (NEW-07) LAND WHENEVER ASKED BY AUTHORITIES.
- 10 ACCESS ROAD CONSTRUCTED BY THE OWNER AT HIS OWN COST.
- 11 CERTIFIED THAT THERE IS NO OTHER STRUCTURE WILL BE ERRECTED NOR ANY OTHER SERVICE RENDERED EXCEPT THAT CONNECTED WITH PROPOSED SITE WITHOUT THE PRIOR APPROVAL OF HIGHWAY ADMINISTRATOR.
- 12 CERTIFIED THAT ALL THE CONDITIONS LAID DOWN BY THE GOVT. OF INDIA LOCAL GOVT. OF PUNJAB AND IRC FROM TIME TO TIME WITH REGARD TO THE LOCATION OF ROAD SIDE PROPOSED SITE HAVE BEEN COMPLIED WITH.
- 13 ENTIRE COST OF CONSTRUCTION AS WELL AS SUBSEQUENT MAINTENANCE OF ACCESS ROAD IN RM 2.005 (RHS) AND OTHER RELATED ITEMS WILL BE BORNE BY US (SH.ATMA SINGH S/O SURTA RAM) UNDER THE SUPERVISION OF HIGHWAY ADMINISTRATOR.
- 14 MINIMUM PAVEMENT COMPOSITION OF ACCESS ROAD SHALL BE 150 MM GSB OVERLAD BY THREE LAYERS OF WATER BOUND MACADAM (WBM), EACH OF 75MM THICKNESS OVERLAD BY BITUMINOUS SURFACING OF MINIMUM 20MM (AS PER DETAIL SHOWING CROSS SECTION OF ENTRY & EXIT ROAD)
- 15 ALL PAVEMENT MARKING SHALL BE AS PER IRC 35-1987.
- 16 ALL TRAFFIC SIGN SHALL BE AS PER IRC 57-2001 & IRC SP-55-2001.
- 17 ALL DRAINAGE REQUIREMENTS WILL BE DONE AS PER IRC SP-13 AND IRC SP 50 AS PER APPENDIX - II OF MORTH CIRCULAR NO. RWHN-3302/19/99. DO-II DATED 24TH JULY, 2013/CORRIGENDUM DATED-25-8-2014

SITE / LAYOUT PLAN OF APPROACH ROAD ON NH-64 (NEW-07) ZIRAKPUR- PATIALA ROAD AT KM. STONE 2.005 (RHS) (N.T.S)

CONSULTANT

M/s R.K. ASSOCIATES
388/6, Bhural Nagar,
Near DMW, Patiala
E-mail: rkassos@gmail.com
Mob: 97790-6940/9955-08740

MORTH EMPANEL NO. :- 35

APPLICANT SIGNATURE:-
(Name & Address)

Atma Singh

Forest Area Details			
A	=	12M X 13 M	= 156 Sq. Mt.
B	=	12M X 13 M	= 156 Sq. Mt.
Total Area A+B		= 312 Sq. Mt.	
Or		= 0.0312 Hac.	

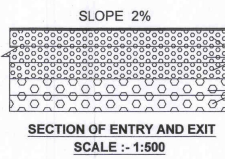
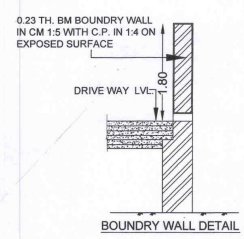

TYPICAL CROSS-SECTION (TYPE 3 A)
CONCENTRIC WIDENING IN URBAN/BUILT-UP AREAS WITH SERVICE ROAD

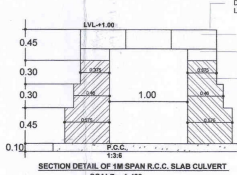

CARRIAGEWAY

PROPOSED SERVICE ROAD

CENTRAL VERGE

A SIDE ROAD SIGN

B FACILITY INFORMATION SIGN

C ONE WAY SIGN

D NO PARKING SIGN

E NO ENTRY SIGN

F NO RIGHT TURN SIGN

G GIVE WAY LINE

H NO LEFT TURN SIGN

I PARALLEL ACCELERATION LANE LINE

J TAPERED DECELERATION LANE LINE