

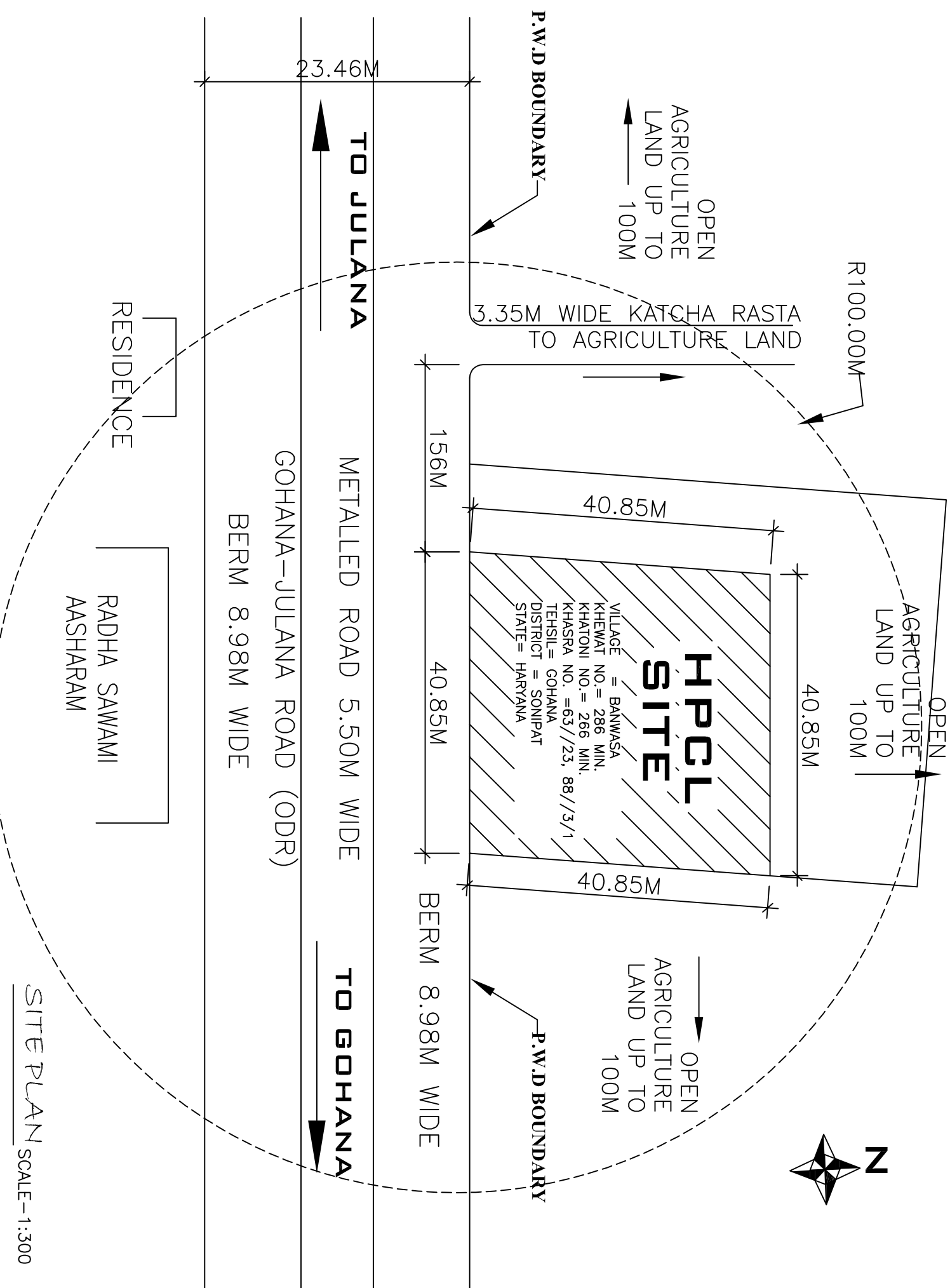

$$\begin{aligned} \text{AREA } A' - A' &= 6.0MX8.98M = 53.88X2 = 107.76 \text{ SQ.M.} \\ \text{AREA AT 'B' = AREA MARKED 'B' - AREA OF SEGMENT} \\ &2X[(1/2X5.0MX5.0M) - 2/3X7.07MX1.46M] \\ &= 2X[12.5 - 6.88] \text{ SQ.M.} \\ &= 2X5.62 \text{ SQ.M.} = 11.24 \text{ SQ.M.} \\ \text{TOTAL AREA} &= (A+B) \\ &= (107+11.24) \text{ SQ.M.} \\ &= 119.00 \text{ SQ.M.} \\ &= 0.0119 \text{ HECT.} \end{aligned}$$

AREA DETAIL	
TOTAL PLOT AREA	1664.00 SQ.M.
TOTAL BUILDING AREA	36.98 SQ.M.
TOTAL CANOPY AREA	150.00 SQ.M.

1. CERTIFIED THAT THERE IS NO OTHER STRUCTURE WILL BE ERRECTED NOR ANY OTHER SERVICE
2. APPROVAL OF PMD.
3. CERTIFIED THAT THERE IS NO ROAD CROSSING WITH IN 100M BETWEEN THE TANGENT POINT OF
4. THE CURVE OF SIDE ROAD AND THAT OF THE FUEL FILLING CUM SERVICE STATION.
5. PUMP HEAD PROPOSED WILL NOT AFFECT THE FUTURE IMPROVEMENT OF THE ROAD
6. ON EITHER SIDE OF THE PILOT.
7. PUMP HEAD PROPOSED WILL NOT AFFECT THE FUTURE IMPROVEMENT OF THE ROAD
8. ON EITHER SIDE OF THE PILOT.
9. CERTIFIED THAT THE BERM PORTION IS NOT INCLUDED IN THE AREA OF LAND TO BE LEASED FROM
10. P.W.D FOR APPROACH ROAD BUT IS TO BE METALLED BY THE CORPORATION.
11. CERTIFIED THAT ALL THE CONDITIONS Laid DOWN BY THE GOVT. OF INDIA AND IRC FROM TIME TO
12. TIME WITH THE LOCATION OF ROAD SIDE FUEL FILLING STATIONS HAVE BEEN COMPLIED WITH
13. NO DRAIN/SEWER OR STRUCTURE WITHIN 1.5M FROM U/G TANKS.
14. SLECTION PIPE UNDER THE BROWWAY HOUSED IN PIPES SIZES.
15. ELECTION FITTINGS CONFORM TO ISS CODE NO 2148 FOR DISPENSING PUMP ONLY
16. D.P.S BOARD 1.5M HIGH FROM FLOOR LEVEL AND WILL NOT BE KEPT UNDER LOCK AND KEY.
17. 40MM DIA. VENT PIPES 4.0M HIGH FROM G.L. AND 4M CLEAR AROUND. THE OPEN END OF VENT
18. PIPES COVERED WITH TWO LEAF OF NON CORRODIBLE METAL WIRE GAOOT OF 1/16TH PER CM.
19. THERE SHOULD BE SUFFICIENT STANDING SPACE IN SIDE THE STATION FOR VEHICLES
20. TO WAIT FOR THEIR TURN. 15. IN LIT UP AND SIGNS ARE PUT UP TO GUIDE VEHICLES
21. DURING THE DAY AND ARE PROPERLY LIT UP TO GUIDE THEM AT NIGHT.
22. NO SMOKING SIGN/FIRE EXTINGUISHER AND FIRE BROTHERS PROVIDED AT SITE.
23. CERTIFIED THAT BUFFER SHOULD NOT HAVE ANY INSTALLATION. UNDER GROUND TANKS ETC.
24. CERTIFIED THAT THE KERING STONE ALONG BORDER IS TO BE MADE BY CORP
25. CERTIFIED THAT THE METALLING OF THE BERM PORTION IS TO BE COMPLY TO BE
26. IMPROVED WITHIN 12 MONTHS FROM THE DATE OF THE ORDER.
27. CERTIFIED THAT THE SURPLUS WATER WILL NOT BE DISPOSED OFF IN PMD LAND.
28. CERTIFIED THAT ALL CLEARANCES/APPROVAL FROM MOP/IRC & OTHER RELEVANT GOVT.
29. DEPTS. HAVE ALREADY BEEN OBTAINED.
30. CERTIFIED THAT THERE IS NO COURT CASE PENDING IN ANY COURT OF INDIA AGAINST THIS PREMISES.
31. CERTIFIED THAT THIS IS NOT A RESIDENT CASE.
32. HIS LETTER NO. -P-6 (3) 60 OF DATED 6-10-2005
33. 16/224K STEEL TANK HAS BEEN FABRICATED AS PER DRG. APPROVED BY CCDO MAGPURA VIDE
34. CERTIFIED THAT THE CANNOPY MEASURING 12.00X17.00M CONFORM TO SOUND ENGINEERING SPECIFICATION

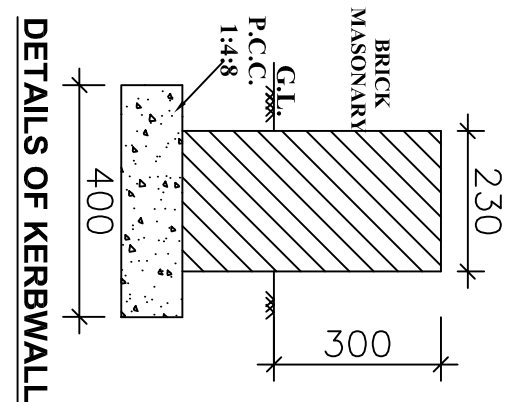
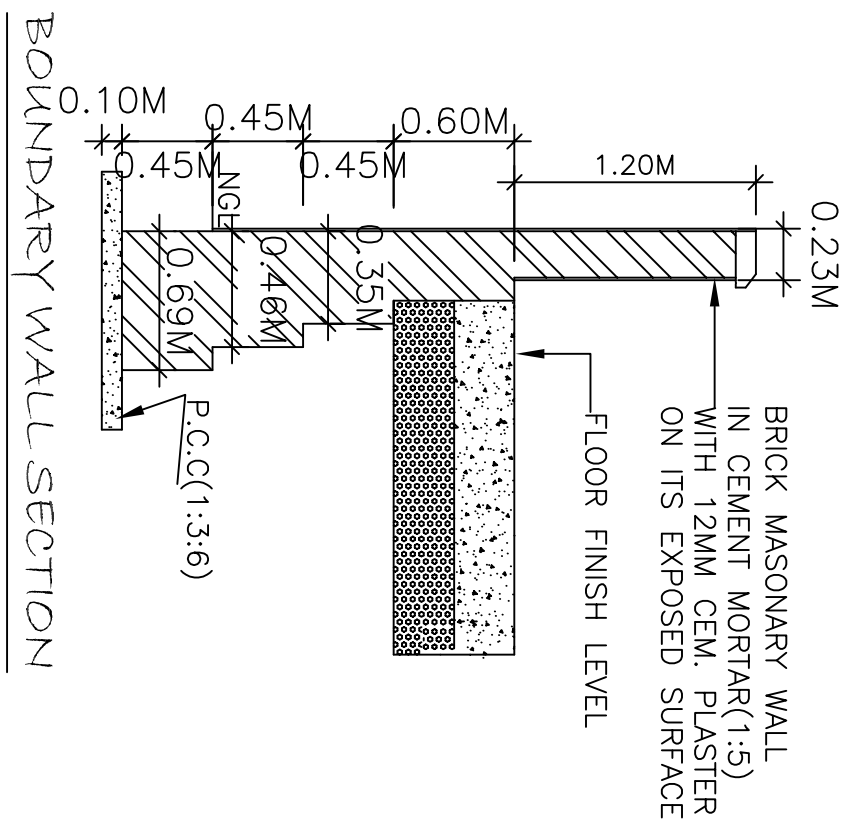
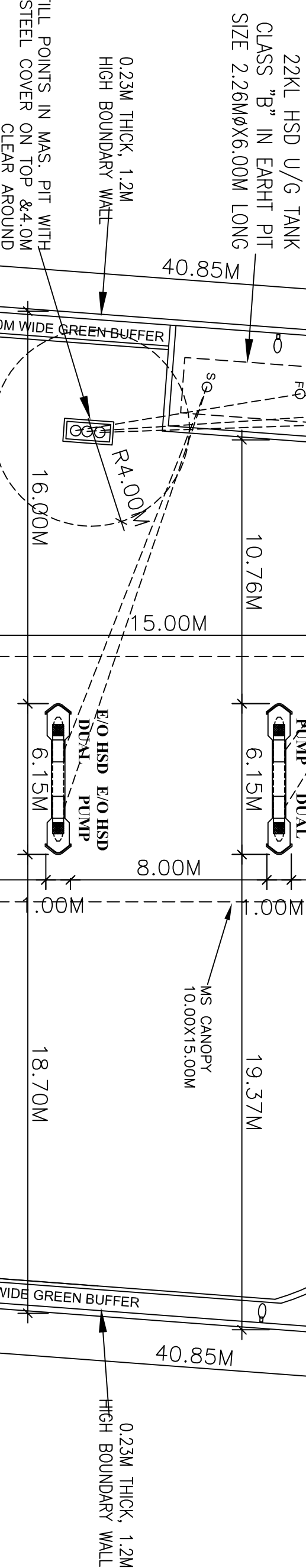

PROPOSED SITE & LAYOUT PLAN OF
RETAIL OUTLET ON GOHANA- JULANA
(ODR) ROAD BETWEEN KM STONE=12-13
AT VILLAGE BANWASA,
TEHSIL GOHANA, DISTT. SONIPAT
(HARYANA)

VILLAGE = BANWASA KHEMAT NO. = 286 MIN. KHATONI NO. = 266 MIN. KHASRA NO. = 63 / 23, 88 / 3 / 1 NEAREST POLICE STATION = BARODA NEAREST RAILWAY STATION = GOHANA		PROPOSED SITE & LAYOUT PLAN OF RETAIL OUTLET ON GOHANA- JULANA (ODR) ROAD BETWEEN KM STONE=12-13 AT VILLAGE BANWASA, TEHSIL GOHANA, DISTT. SONIPAT (HARYANA)	
TEHSIL = GOHANA DISTRICT = SONIPAT STATE = HARYANA		LIC. NO. = NEW PROPOSAL DRAWING NO. S-101	
 DRAWN BY: DEEP DESIGN DEVELOPMENT		C-5/114, (2ND FLOOR), SECTOR-6, ROHINI, DELHI-110085 Ph. NO. 98103-75830, 98992-03410	

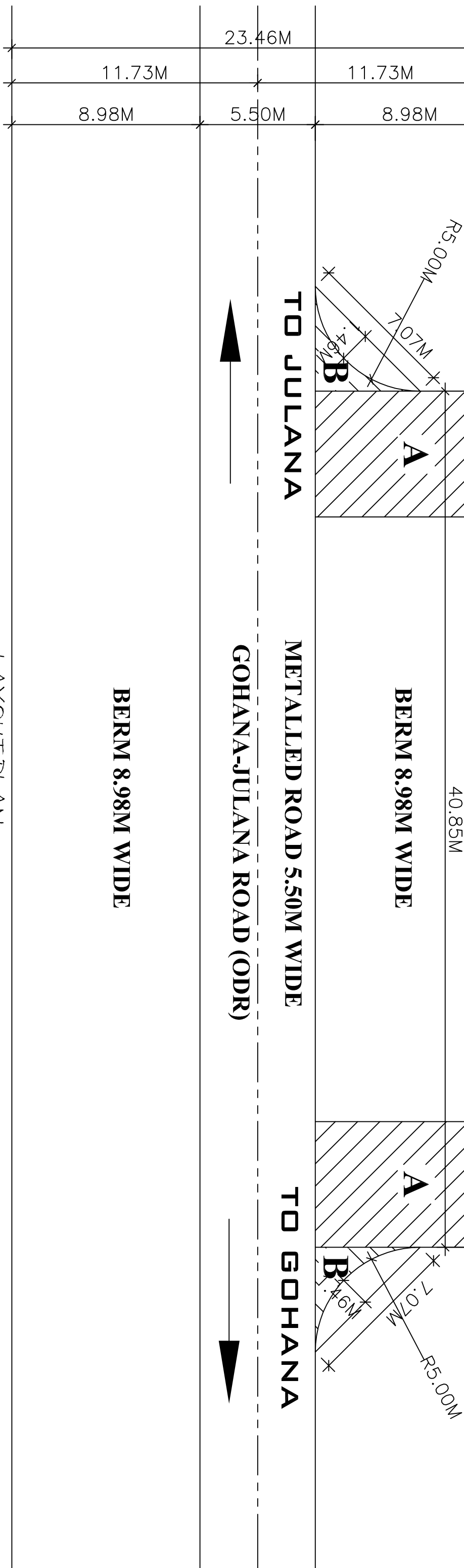

LAYOUT PLAN
SCALE=1:200