

17

**Annexure-19**

**Compensatory Afforestation Scheme for double degraded area**

Diversion of **0.315** ha. Reserved Forest Land to be diverted Proposal for Electrification of New 11 KV Overhead Electric Line Passing through Kalimbhada Village Taluka-Maliya District-Junagadh

Detailed scheme of Compensatory Afforestation for degraded area **1 ha.** to be carried out in lieu of **0.315 ha.** of Reserved forest land to be diverted in Junagadh district.

**1. Details of degraded land.**

Village	Khageshri
Taluka	Kutiyana
Range	Kutiyana Range
District	Porbandar
Division	Junagadh
Block/ Patal, Compartment No.	589
Areato be afforested	1 Ha.
Working circle	Inland Plantation

**2. Description of Area.**

Soil type	Black
Topography	Plain/Hilly
Slope	Gentle
Whether the area is bearing any root stock of Vegetation	Vegetation Mainly Prosopis

**3. Name of Plantation Programme:-**

Compensatory Afforestation Scheme for Degraded Forest Area.

**4. Schedule of Plantation Programme:-**

- |      |  |
|------|--|
| (i)  | The Compensatory Afforestation on degraded area would be started by Deputy Conservator of Forest Junagadh Forest Division as early as possible after the proposal is formally approved.  |
| (ii) | Compensatory Afforestation will be done in <b>1 ha.</b> area. The total afforestation cost will be about <b>Rs.5,28,112/-</b> Deputy Engineer, P.G.V.C.L. Maliya S.D. has given an undertaking to pay the cost of Compensatory Afforestation as per the prevailing wages (including the price escalation and supervision charges). |

  
**Deputy Conservator of Forests**  
**Junagadh Division, Junagadh**

9/9/20

# Technical Details:-

Technical details of Compensatory Afforestation are as Follows:

Sr. No.	Details	Specifications																														
a	General Details	The C.A. will be taken under Compensatory Afforestation for double land on degraded Forest Areas. The prevailing wage rate is 324.50 per day.																														
b	Spacement	3 X 3 mtr., 1111 plants per ha.																														
c	Species to be planted (No. of plants per ha.)	<table> <tr> <td>Garmalo</td><td>150</td><td>65cm</td></tr> <tr> <td>Khijado</td><td>100</td><td>65cm</td></tr> <tr> <td>Desi Bavai</td><td>150</td><td>65cm</td></tr> <tr> <td>Bordi</td><td>150</td><td>65cm</td></tr> <tr> <td>Harmo</td><td>100</td><td>65cm</td></tr> <tr> <td>Gundi</td><td>150</td><td>65cm</td></tr> <tr> <td>Charal</td><td>100</td><td>65cm</td></tr> <tr> <td>Arduso</td><td>100</td><td>90cm</td></tr> <tr> <td>Gorad</td><td>111</td><td>50cm</td></tr> <tr> <td><b>Total</b></td><td><b>1111</b></td><td></td></tr> </table>	Garmalo	150	65cm	Khijado	100	65cm	Desi Bavai	150	65cm	Bordi	150	65cm	Harmo	100	65cm	Gundi	150	65cm	Charal	100	65cm	Arduso	100	90cm	Gorad	111	50cm	<b>Total</b>	<b>1111</b>	
Garmalo	150	65cm																														
Khijado	100	65cm																														
Desi Bavai	150	65cm																														
Bordi	150	65cm																														
Harmo	100	65cm																														
Gundi	150	65cm																														
Charal	100	65cm																														
Arduso	100	90cm																														
Gorad	111	50cm																														
<b>Total</b>	<b>1111</b>																															
d	Nursery Technique	Nine months old polypot raised plants will be planted at the onset of monsoon.																														
e	Site Preparation	The malformed rootstock present in the area will be cutback & the site will be cleaned in the month of Nov-Dec. Alignment & pit digging 45 x 45 x 45 cms. will be carried out in the month of Dec-Jan.																														
f	Plantation Method	Polypot raised plants will be planted during monsoon.																														
g	Soil & Moisture Conservation Works	(i) Pucca structure like Check dam, check wall, retaining wall (ii) Contour trenches 2.00 x 0.45 x 0.30, 300 Nos/ha. will be dug along the contour line. the dug out soil will be heaped on the down ward side. Gully plugging & Nala Banding using The loose stone available in the area will be carried out as per requirement. Seeds of Jatropha, Agave plants ...etc. will be planted during monsoon in the upper side of nala as per suitability.																														
h	Protection Trench	Barbed wire fencing, Seed sowing and planting of cuttings of Ipomea/Glarcidia along the fence																														
i	Silvicultural Operations	1 <sup>st</sup> year three weeding soil working, Support watering will be provided if needed. 2 <sup>nd</sup> year two weeding soil working. 3 <sup>rd</sup> year one weeding soil working.																														
j	Maintenance	It is proposed to maintain the Plantation up to ten years.																														
k	Subsequent	Cleaning, cutbacks, thinning etc. (as per species specific requirement)																														

	silvicultural Operation	will be carried out at the age as per prescribed in the working plan.
1	Proposed monitoring mechanism	<p>(i) A plantation register is to be maintained.</p> <p>(ii) Monitoring is to be done as per the following norms.</p> <p>Forester – 100%</p> <p>RFO – 100%</p> <p>ACF – 20%</p> <p>DCF – 10%</p> <p>(iii) The results of survival etc. are maintained in the plantation register on a periodical basis, which is updated at the end of September and March each year.</p> <p>(iv) The collar girth is also to be reordered at the end of each year.</p> <p>(v) At the end of maintenance period, the area is aimed at full stocking and pole crop girth for all the species, except bamboo.</p> <p>(vi) Bamboo would be of the harvestable size by the end of 4<sup>th</sup> year.</p> <p>(vii) Third party monitoring mechanism is also in the State and if the plantation is in the sample selected, it will also be monitored by the third party selected for this purpose.</p>
m	Regeneration cleaning	Promotion of root suckers.
n	Silviculture & other activities	Only afforestation aimed plantation will be taken up, as the area falls under degraded forest land.

The Compensatory Afforestation scheme at the cost of Rs.5,28,112/- is technically and administrative approved by the undersigned.

Deputy Conservator of Forest  
Junagadh Division, Junagadh

9/9/20

Details of year wise Break-up of requirement of fund Is as under :- rate 324.50

year	ha.	rate / ha. at the daily wage per ha.	Total Amount
0 Year	1	188620	188620
1st Year	1	80292	80292
2nd Year	1	55831	55831
3rd Year	1	43701	43701
4th Year	1	15191	15191
5th Year	1	8139	8139
6th Year	1	8647	8647
7th Year	1	9156	9156
8th Year	1	9663	9663
9th Year	1	10172	10172
10th Year	1	10681	10681
<b>Total</b>		440093	440093
20% Supervision charge		88019	88019
<b>Total</b>		528112	528112

The User Agency has given an undertaking to pay the cost of Compensatory Afforestation as per the Prevailing wages (including the price escalation and supervision charge)

Place :Junagadh  
Date : 9/09/2020

  
Dy. Conservator of Forests  
Junagadh Forest Division Junagadh



**Checklist No. 19-B**

Rate structure of forestland of village : Khageshri ta. Kutliana District : Porbandar  
1.00 ha. Afforestation as per Add.prl.C.C.F. land, Gujarat State, Gandhinagar's letter no.  
Campa/31/B/4769-4838/Dt. 27/11/2019.

Year	Rate / ha. at the daily wage Rs.310.40	Admissible Rate / ha current daily Wage rate 324.50	Admissible total amount as per daily Wages rate Rs. 324.50
70% Adv.Works	82527	132034	132034
30% Adv.Works	35368	56586	56586
0 Year	117895	188620	188620
1st Year	76803	80292	80292
2nd Year	53405	55831	55831
3rd Year	41802	43701	43701
4th Year	14530	15191	15191
5th Year	7785	8139	8139
6th Year	8271	8647	8647
7th Year	8758	9156	9156
8th Year	9243	9663	9663
9th Year	9730	10172	10172
10th Year	10217	10681	10681
<b>Total</b>	358439	440093	440093
20% Supervision charge	71688	88019	88019
<b>Total</b>	430127	528112	528112

The User Agency has given an undertaking to pay the cost of Compensatory Afforestation as per the Prevailing wages ( including the price escalation and supervision charge )

Place : Junagadh

Date : 9/09/2020

  
Dy. Conservator of Forests  
Junagadh Forest Division Junagadh

Technically Sanctioned for Rs. 5,28,112/- in words Rs. Five Lakh Twenty Eight Thousand One hundred Twelve rupees only.

  
Dy. Conservator of Forests  
Junagadh Forest Division Junagadh

LOCATION OF DEGRADED FOREST IDENTIFIED LAND FOR COMPENSATORY AFFORESTATION AGAINST THE PROPOSAL FOR DIVERSION OF 1.00 HA. OF FOREST LAND FOR NEW 11 KV OVER HEAD ELECTRICLINE PASSING THORUGH KALIMBHADA VILLAGE UNDER MALIYA VILLAGE-KHAGESHRI SURVEY NO. 589PT. TALUKA-KUTIYANA DIST-PORBANDAR, DIVISION-JUNAGADH RANGE-KUTIYANA

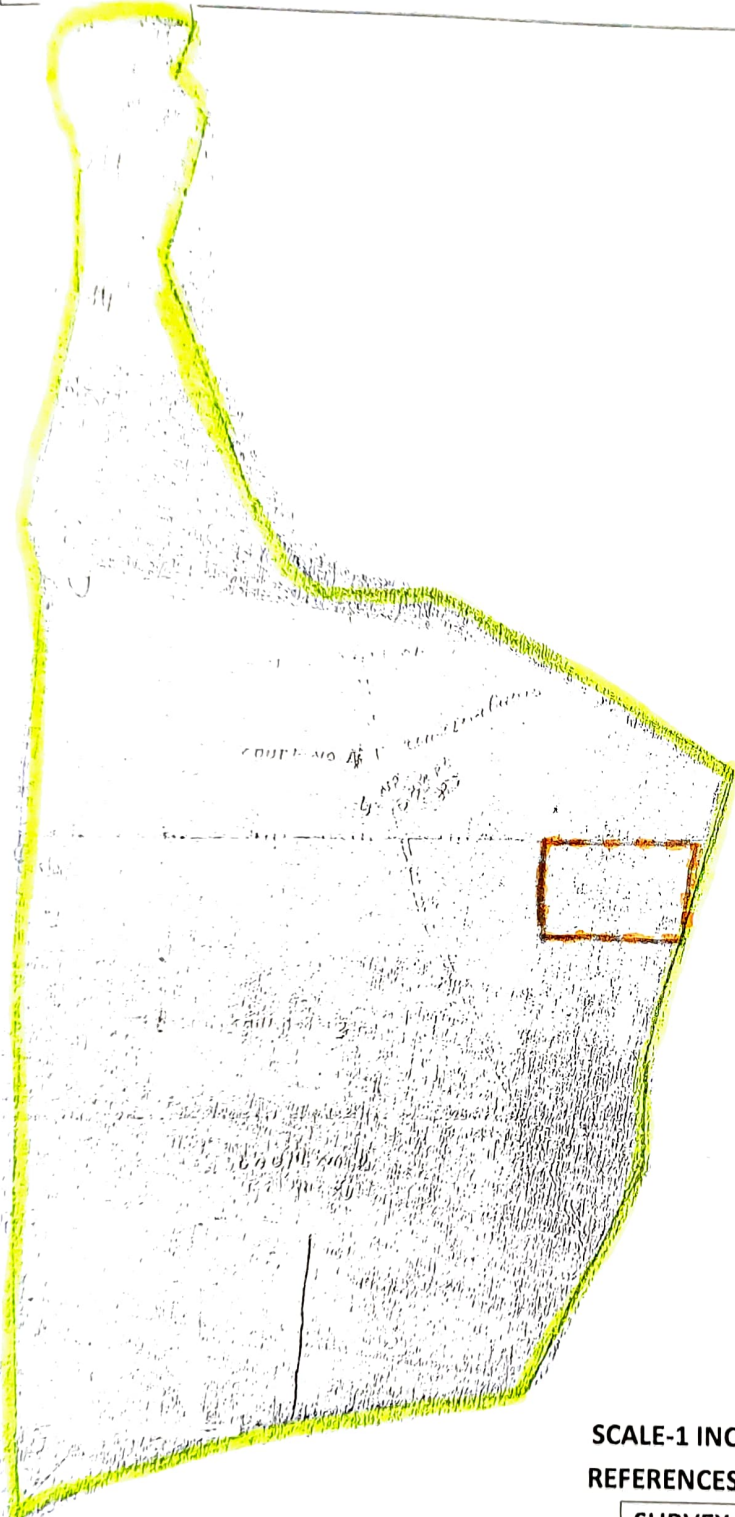

SCALE-1 INCH=660 FT

REFERENCES

SURVEY NO.	AREA HA.	FOREST
589PT	160	

AREA TO BE TAKEN FOR COMPASATORY AFFORESTATION AREA -1.00 HA.

Dy. Conservator of Forest  
Junagadh Division, Junagadh

2/2/20

**Compensatory Afforestation Scheme for double degraded area under FCA proposal  
Diversion of 0.315 ha. RF land for Electrification of New 11 KV Overhead Electric Line Passing  
through Kalimbhada Village Taluka-Maliya District-Junagadh Of Gujarat State.**

**Daily wages Rs.324.50**

Spacemnts = 3 m x 3 m

1111 seedling / Ha

1st year replacement 10 % = 111 seedling /ha

2nd year replacement 20 % = 111+111 seedling /ha

3rd year replacement 10 % = 111 seedling /ha

Total Seedlings = 1333 seedling /ha

Polypot size : 15 cm x 25 cm x 200

Item of work	Qty.	Labour	Material	Total
1	2	3	4	5
<b>0 year</b>				
<b>Nursery</b>				
(a) Cost of soil, ,manure, seeds, water, fertilizer, insecticides, implements, rent of lands. Shade, etc. (including 10 % for casualty replacement)	1222	0	1913	1913
(b) labour : Preparation of beds, filling and arranging of bags,showing of seeds, watering shifting, weeding etc.	1222	4681	243	4924
(c ) Seedling cost for casualty replacement in one year old (20%)	222	1479	441	1920
(d) Seedling cost for casualty replacement in two year old (10%)	111	741	221	962
<b>Total</b>		<b>6901</b>	<b>2818</b>	<b>9719</b>
<b>2. Area Development ( Land Preparation )</b>				
(a) Survey, cutback and promotion of root suckers		3517	0	3517
(b) Aligment and digging of pits 0.45 X 0.45 X 0.45	1111@ 6.00	10156	0	10156
<b>Total</b>		<b>13673</b>	<b>0</b>	<b>13673</b>
(a) Natural fertilizer (Neem cake/ Castor cake)	1111 @ 5.00	0	10360	10360
<b>Total</b>		<b>0</b>	<b>10360</b>	<b>10360</b>
<b>3. SMC Works</b>				
(a) Check wall/ retaining wall /checkdem (all pucca only)	L.S.	12495	24804	37299
(b) Contour trench 2 M x 45 Cm x 30 Cm as per Rs.17.00/rmt (300 trench)	600 rmt.	9510	0	9510
<b>Total</b>		<b>22005</b>	<b>24804</b>	<b>46809</b>
<b>4. Protection</b>				



a) Barbed wire fencing	400 RMT.	9682	96718	106400
(b) Seed sowing and planting of cuttings of Ipomea/ Gliricidia along the fence		1160	499	1659
<b>Total</b>		<b>10842</b>	<b>97217</b>	<b>108059</b>
<b>Sub Total of 0 year</b>		<b>53421</b>	<b>135199</b>	<b>188620</b>
<b>1st Year</b>				
(a) Maintenance of nursery (April to June)	1222	3591	359	3950
(b) Transport of seedling for plantation	1111	1970	407	2377
(c) Planting with khamna of Min 1 m dia	1111	6054	0	6054
(d) Transport of seedling for casualty replacement	111	210	46	256
(e) 3 weeding cum soil working	1111	23600	0	23600
(f) Support watering 5 times @ 3.25		15085	21647	36732
(g) Protection / tending operation		4883	0	4883
(h) Tending to natural vegetation		1220	0	1220
(i) Contingency		0	1220	1220
<b>Total for 1st year</b>		<b>56613</b>	<b>23679</b>	<b>80292</b>
<b>2nd Year</b>				
(a) 2 weeding & soil working		13107	0	13107
(b) 20 % Casually replcement, transport and planting	111+111	221	1097	1318
(c) Natural fertilizer (neem cake / caster cake ) etc.	Rs.5/ plant	0	12243	12243
(d ) Support watering 3 times @ 3.25		9803	14070	23873
(e) Protection / tending operation		5290	0	5290
<b>Total for 2nd year</b>		<b>28421</b>	<b>27410</b>	<b>55831</b>
<b>3rd Year</b>				
(a) 2 weeding & soil working		14115	0	14115
(b) 10 % Casually replcement, transport and planting	111	118	592	710
(c) Natural fertilizer, neem cake etc.	Rs.5/ plant	0	13186	13186
(d ) Support watering 1 times @ 3.25		3520	5050	8570
(e) Protection & maintenance of fencing / tending operation	L.S.	7120	0	7120
<b>Total for 3rd year</b>		<b>24873</b>	<b>18828</b>	<b>43701</b>
<b>4thYear</b>				
(a) 1 weeding & soil working		7561	0	7561
(b) Protection & Maintenance of fencing/ Tending operation	L.S.	7630	0	7630
<b>Total for 4th year</b>		<b>15191</b>	<b>0</b>	<b>15191</b>
<b>5thYear</b>				



Protection & maintenance of fencing/ tending operation	L.S.	8139	0	8139
<b>Total for 5th year</b>		<b>8139</b>	<b>0</b>	<b>8139</b>
<b>6thYear</b>				
Protection & maintenance of fencing/ tending operation	L.S.	8647	0	8647
<b>Total for 6th year</b>		<b>8647</b>	<b>0</b>	<b>8647</b>
<b>7thYear</b>				
Protection & maintenance of fencing/ tending operation	L.S.	9156	0	9156
<b>Total for 7th year</b>		<b>9156</b>	<b>0</b>	<b>9156</b>
<b>8thYear</b>				
Protection & maintenance of fencing/ tending operation	L.S.	9663	0	9663
<b>Total for 8th year</b>		<b>9663</b>	<b>0</b>	<b>9663</b>
<b>9thYear</b>				
Protection & maintenance of fencing/ tending operation	L.S.	10172	0	10172
<b>Total for 9th year</b>		<b>10172</b>	<b>0</b>	<b>10172</b>
<b>10thYear</b>				
Protection & maintenance of fencing/ tending operation	L.S.	10681	0	10681
<b>Total for 10th year</b>		<b>10681</b>	<b>0</b>	<b>10681</b>
<b>SUB TOTAL :</b>		<b>234977</b>	<b>205116</b>	<b>440093</b>
The Cost of Supervision/subsequential silvicultureal Operations	20%	46995	41023	88019
		<b>281972</b>	<b>246139</b>	<b>528112</b>

**Note :-**

- (1) Seed sowing along fencing towards the inner side, and also in the plot.
- (2) Planting of cutting of ipomea//Glaricidia along the fencing towards outer side.

Compensatory afforestation will be done in 1.00 ha. Area.

**Total Cost Rs. :5,28,112/-**

  
Deputy Conservator of Forest  
Junagadh Division, Junagadh

9/9/20