

AREA FOR DIVERSION OF FOREST LAND FOR PURPOSE OF INGRESS & EGRESS

AREA OF INGRESS = A+B+C+D

A = $1/2 \times 5.5 \times 22.64\text{M} = 62.26 \text{ SQ.M.}$

B = $36.02 \times 5.50\text{M} = 198.11 \text{ SQ.M.}$

C = $1/2 \times (5.5 + 7.38) \times 9.14\text{M} = 58.86 \text{ SQ.M.}$

D = $1/2 \times (7.38 + 12.26) \times 6.56\text{M} = 64.41 \text{ SQ.M.}$

E = $1/2 \times 12.26 \times 12.00 = 73.56 \text{ SQ.M.}$

TOTAL AREA AT INGRESS = (A+B+C+D+E) = $(62.26 + 198.11 + 58.86 + 64.41 + 73.56) \text{ SQ.M.} = 457.20 \text{ SQ.M.}$

= 0.0457 HECT.

AREA OF EGRESS = (E+F+G+H)

F = $1/2 \times 12.00 \times 12.58 = 75.48 \text{ SQ.M.}$

G = $1/2 \times (7.80 + 12.58) \times 5.89\text{M} = 60.01 \text{ SQ.M.}$

H = $1/2 \times (5.50 + 7.80) \times 9.55\text{M} = 63.50 \text{ SQ.M.}$

I = $57.61 \times 5.5\text{M} = 316.85 \text{ SQ.M.}$

J = $1/2 \times 5.5 \times 30.50\text{M} = 83.87 \text{ SQ.M.}$

TOTAL AREA AT INGRESS = (F+G+H+I+J) = $(75.48 + 60.01 + 63.50 + 316.85 + 83.87) \text{ SQ.M.} = 599.71 \text{ SQ.M.}$

= 0.0599 HECT.

TOTAL INGRESS & EGRESS AREA $(457.20 + 599.71) = 1056.91 \text{ SQ.M.}$

= 0.105 HECT.

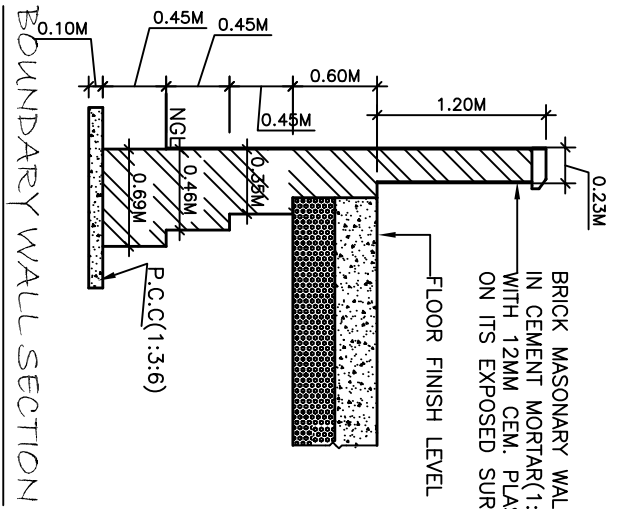
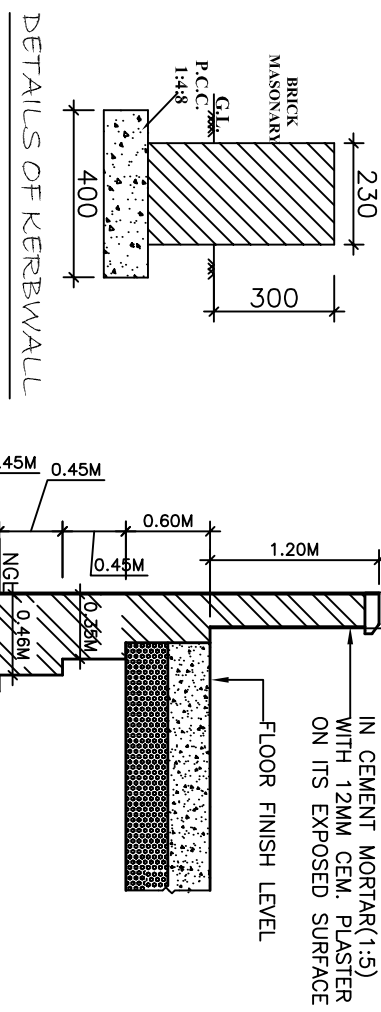
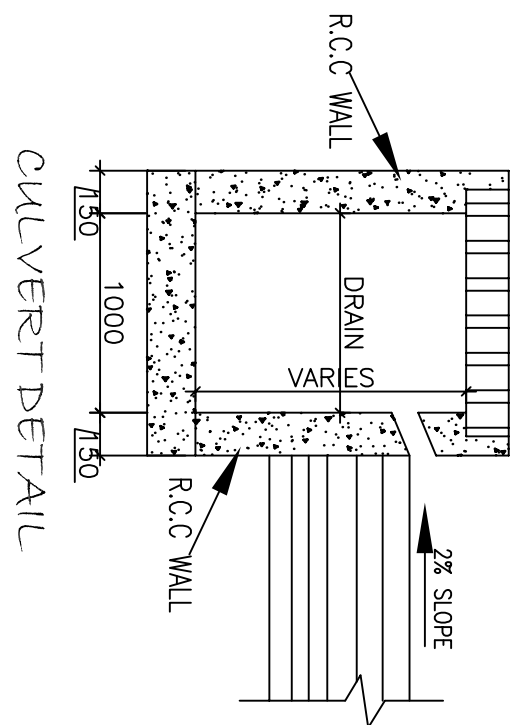
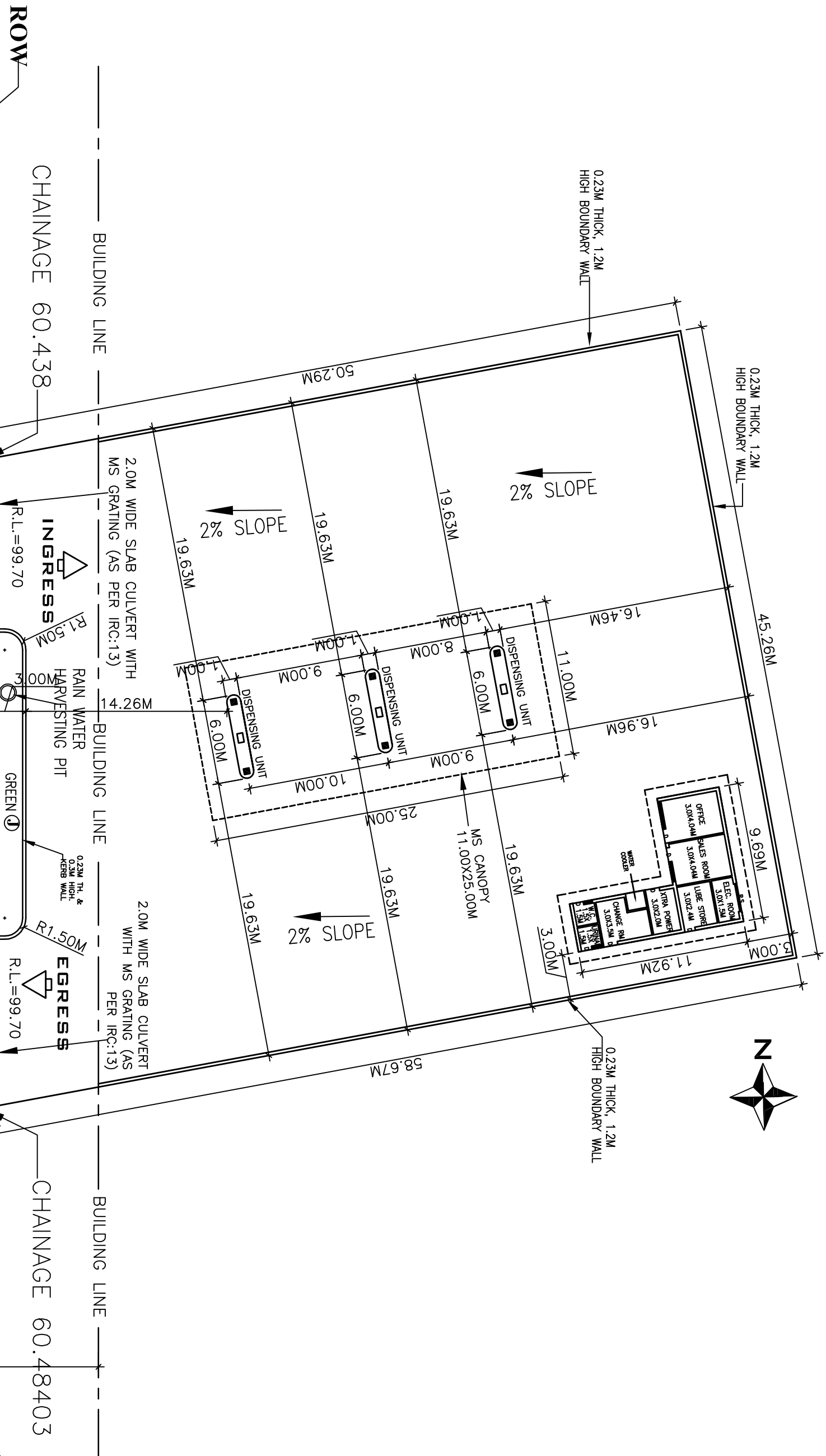

AREA DETAIL	
TOTAL FLOT AREA	24676 SQ.M.
TOTAL BUILDING AREA	6040 SQ.M.
TOTAL CANOPY AREA	2756 SQ.M.

Indian Oil Corporation Limited Marketing Division Gurgaon Divisional Office	
PROPOSED LAYOUT PLAN SECTION ELEVATION PROPOSED LAYOUT PLAN SECTION ELEVATION (NH-248A) CHAINAGE 60.438 TO 60.484 MADHIL, TEHSIL-FIROZPUR ZIRKHA, DISTT. MEWAT (HARYANA)	
KHEMW/HRMA NO-64/80, MUSTIL NO-05, KILA NO-18	DRAWN BY: DEEP DESIGN DEVELOPMENT
DATE:30.07.2015 DRG. NO--000/MADHIL	C-5/114, (2ND/3RD FLOOR), SECTOR-6, PHASE-1, GATE NO-1, MEWAT, HARYANA-131005
SCALE 1:200	Project No: DD-2015-014/10 deepdesigndevelopment@indiaoil.com

ROW

LAYOUT PLAN

ROW