

**DELHI DEVELOPMENT AUTHORITY
INSTITUTIONAL LAND BRANCH
A-216, Vikas Sadan INA, New Delhi-110023**

No. F. 32(05)21/IL/1867

Dated: 22/06/2021

To

**1. Additional Director General
Project Region Delhi
Central Public Works Department
Nirman Bhawan
New Delhi -110049**

**2. Chief Engineer / Constr. /Central
Northern Railway
Kashmere Gate
New Delhi**

**3. Chief Engineer /General
National Capital Region Transport Corporation (NCRTC)
7/6, Siri Fort Institutional Area, August Kranti Marg
New Delhi -110049**

References: 1. CPWD Letter No. D.O. No. 54(1)/ADG/PRND/CCS/2021/52 dated 04.06.2021 and letter 54(1)/CCS/CE/CVZ/CPWD/2021-22/86 dated 07.06.2021 for allocation of land admeasuring 8.11 Ha for Compensatory Afforestation (CA) under FCA, 1980 in lieu of deemed forest land being utilised for works related to Central Vista Project to CPWD.

2. Northern Railways Letter No. 133-W/325/C/CSB/Line 3rd -4th dated 23.03.2021 for allocation of land admeasuring 2.396 Ha for Compensatory Afforestation (CA) under FCA, 1980 in lieu of Railway Work between Anand Vihar & Tilak Bridge.

3. NCRTC Letter No. NCRTC/CE-SY/111/16/02 dated 11.03.2021 for allocation of land admeasuring 15 Ha for Compensatory Afforestation (CA) under FCA, 1980 in lieu of construction of alignment for implementation of Delhi-Ghaziabad-Meerut RRTS Corridor by NCRTC.

Sub: Allocation of land admeasuring 25.506 Ha for Compensatory Afforestation (CA) under FCA, 1980 at Master Plan Green, Sector -29, Dwarka to CPWD, NCRTC and Northern Railways .

Sir,

This is in reference to the aforementioned letters from CPWD , Northern Railways and NCRTC regarding request for allocation of land for compensatory afforestation under FCA, 1980.

In this regard, I am directed to inform that Competent Authority has been pleased to approve the allocation of land measuring **25.506 hac at Master Plan Green, Sector – 29, Dwarka** for compensatory afforestation under FCA 1980 as follows:

- i. 15 Ha to NCRTC;

- ii. 8.11 Ha to CPWD and
- iii. 2.396 HA to Northern Railways

The allocation is proposed subject to the following conditions :

1. Ownership & Management of land shall remain with DDA.
2. The area under reference is bound to be developed as per the guidelines of the Hon'ble NGT and the plantation shall be done in accordance with the recommendation of Hon'ble NGT.
3. The user agency shall contact Forest Department for the amount to be deposited on account of compensatory plantation which will be calculated by Department of Forest & Wild Life, GNCTD and the calculated amount shall be paid by the user agency to the Forest Deptt.

Encl: Site plan of area under reference.



(Sada Shiv)
Dy. Director (IL)

Copy To :

1. Addl. Commr. (LS), DDA- *For record that this land will continue to remain forest land as per the order dated 26.09.2018 of Hon'ble Supreme Court.*

Copy for kind information to: -

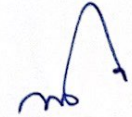
1. The Registrar, National Green Tribunal, New Delhi.
2. Dy. Conservator of Forest, Deptt. of Forest and Wildlife, GNCTD
3. The Chief Engineer, Central Vista Zone, Central Public Works department, Room no. 7B, E-Wing, Nirman Bhawan, New Delhi-110011
4. The Chief Engineer, (Dwarka) DDA
5. Director (Hort.) North West, DDA
6. Director (LM) -II, DDA, Vikas Sadan, New Delhi-110023
7. Dy. Director (S)LD, DDA, Vikas Sadan, New Delhi-110023
8. PS to PC (Hort., LS) DDA for kind information of later

Dy. Director (IL)

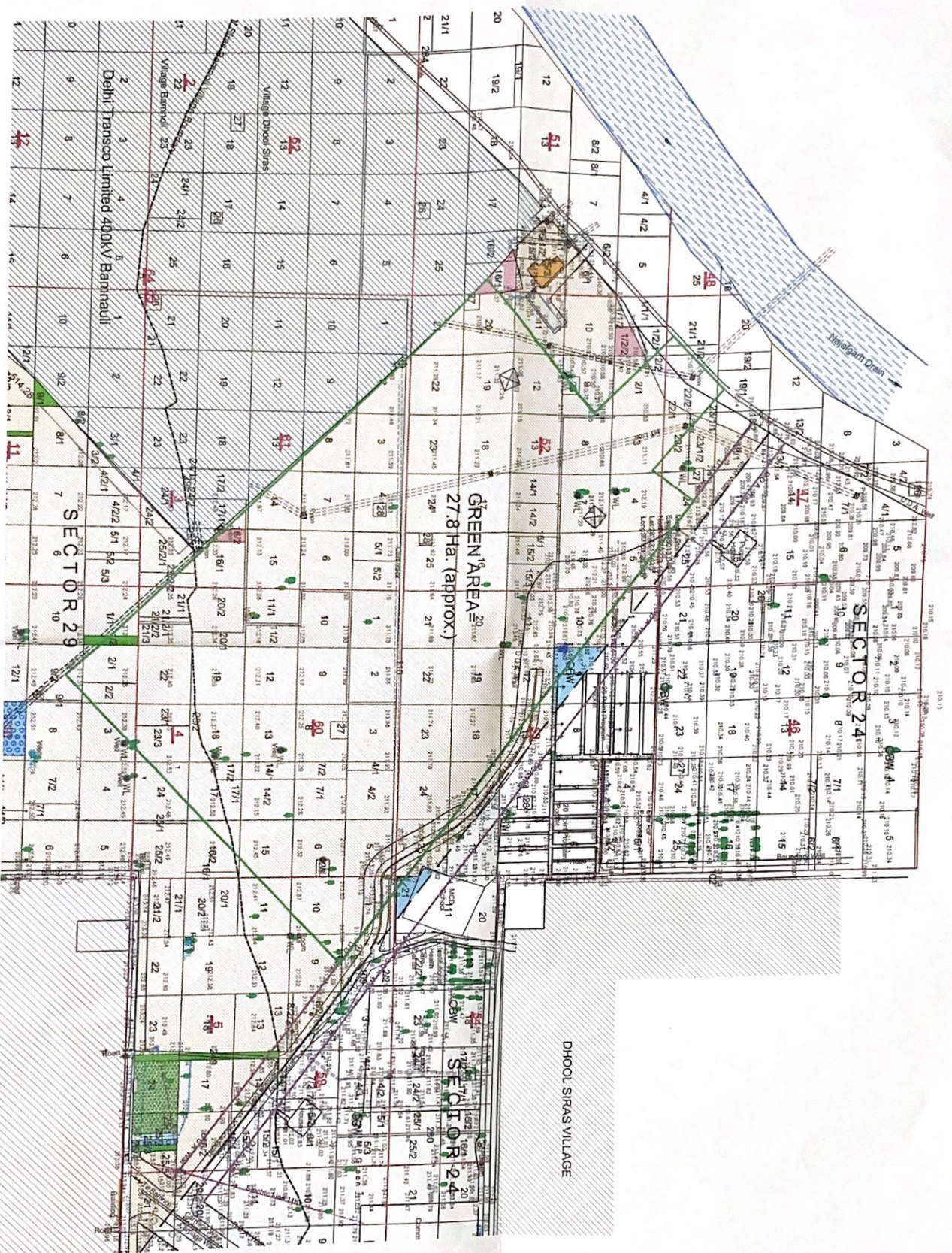

Delhi.
construction of 2 la
composite girder
Height Subw-
station at Km. 79/-
Diwana re. T
com.

**DELHI DEVELOPMENT AUTHORITY
INSTITUTIONAL LAND BRANCH
A-216, Vikas Sadan INA, New Delhi-110023**

No. F. 32(05)21/IL/2072

Dated: 03/08/2021

To

1. Additional Director General
Project Region Delhi
Central Public Works Department
Nirman Bhawan
New Delhi -110049

3. Chief Engineer /General
National Capital Region Transport Corporation
(NCRTC)
7/6, Siri Fort Institutional Area, August Kranti Marg
New Delhi -110049

2. Chief Engineer / Constn. /Central
Northern Railway
Kashmiri Gate
New Delhi

Sub: Allocation of land admeasuring 25.506 Ha for Compensatory Afforestation (CA) under FCA,1980 at Master Plan Green, Sector -29, Dwarka to CPWD, NCRTC and Northern Railways for CCS 1, 2 and 3 under Central Vista Project.

Ref: 1. Northern Railways Letter no.133-W/325/C/CSB/Line3rd- 4th dated 02.07.2021
2. DDA Letter F. 32(05)21/IL/1937 dated 07.07.2021

Sir,

This is in continuation to letter no. F. 32(05)21/IL/1937 dated 07.07.2021 on the subject cited above. The revised site plan of area under reference along with GPS co-ordinates regarding the allocation of 2.396 Ha to Northern Railways is enclosed herewith.

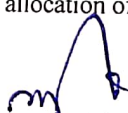
(Sada Shiv)
Dy. Director (IL)

Encl: As Above

Copy To :

1. Addl. Commr. (LS), DDA

Copy for kind information to: -

1. The Registrar, National Green Tribunal, New Delhi.
2. Dy. Conservator of Forest, Deptt. of Forest and Wildlife, GNCTD
3. The Chief Engineer, Central Vista Zone, Central Public Works department, Room no. 7B, E-Wing, Nirman Bhawan, New Delhi-110011
4. The Chief Engineer, (Dwarka) DDA
5. Director (Hort.) North West, DDA
6. Director (LM) -II, DDA, Vikas Sadan, New Delhi-110023
7. Dy. Director (S)LD, DDA, Vikas Sadan, New Delhi-110023
8. PS to PC (Hort., LS) DDA for kind information of later

Dy. Director (IL)

Coordinates for railway compensatory plantation for Yamuna guide bund in c/w 3rd & 4th line between TKI-ANVR

Sr. no.	Location	Latitude	Longitude
1	B7	28°23'55.96" N	77°1' 25.04"E
2	B18	28°33'6.93"N	77°1' 33.04"E
3	B19	28°32'57.31"N	77°1'23.7"E
4	B8	28°33'5.46"N	77°1' 34.79"E
	Total Area	(390.50+394.50)X0.5X61.05	
			23.962 SQM
		Say	2.396 Hact

31/8/2021
DD/L

सुप निदेशक
संस्थापक भूमि
बिल्डी विभाग न. नि.क.स.प.
विकास सदन, नई दिल्ली-110023

31/8/21

28/11/11

29/11/11

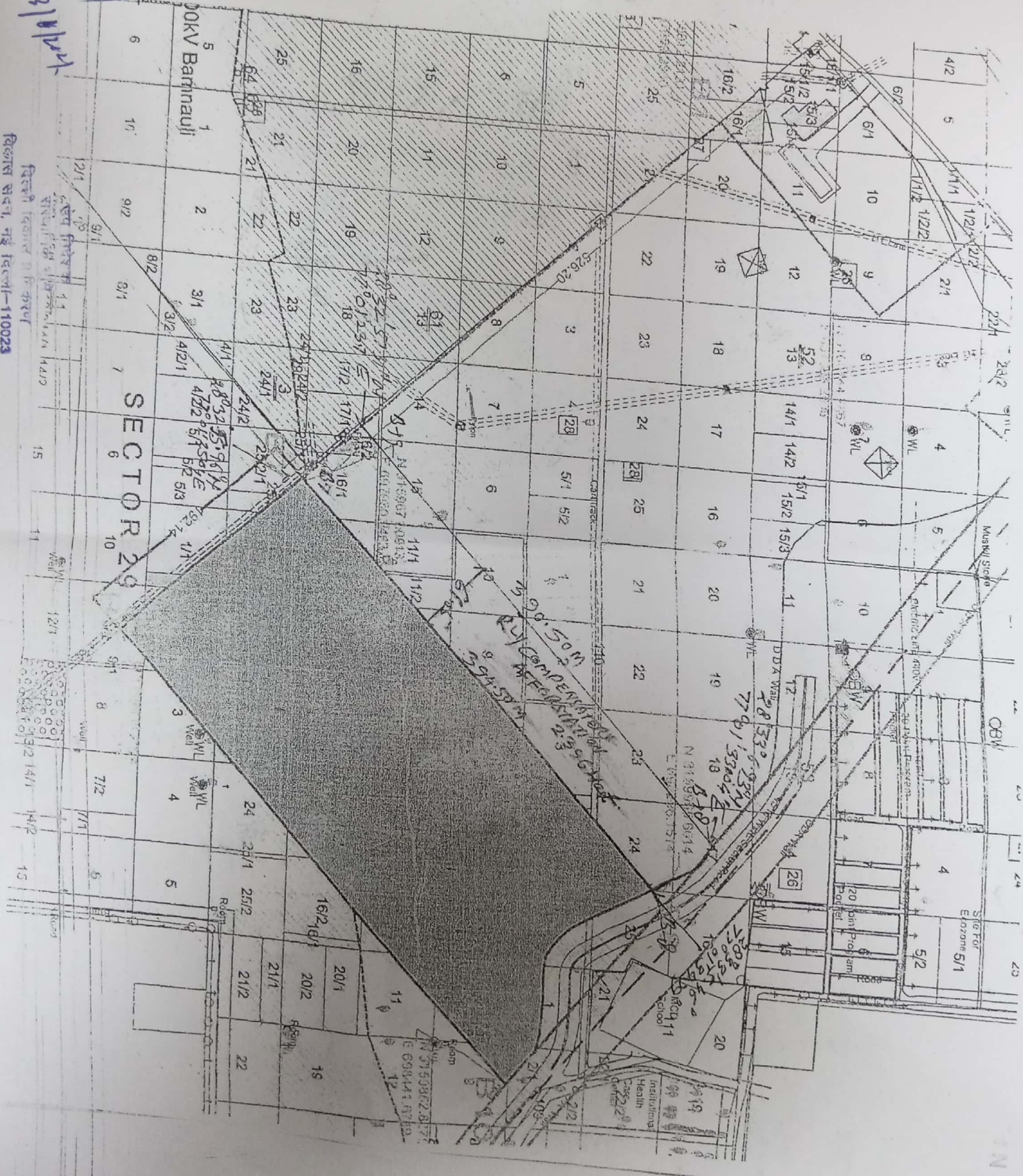

विशेष सदन, नई दिल्ली-110023

विशेष सदन, नई दिल्ली-110023