



# Sri Ramakrishna Sharada Ashrama (R.)

Swami Vivekananda Marg, Village & Post Yerlapady, Bailur,  
Karkala Taluk, Udupi Dist., Karnataka. Pin : 574102, India.

Ph : +91- 9880705858 (Sumatha Nayak)  
+91- 9945152755 / 8277654495 (Office)

email : bailurashram1@gmail.com  
website: www.rkashrambailurmath.org

**Ref:** SRSA/2018-19/041

॥ श्री रामकृष्णः शरणं मम ॥

**Date:** 21-08-2018  
**Place:** Bailur Math

To,  
Respected PCCF,  
Aranya Bhavan, Bangalore - 18.

Respected Sir,

**Sub:** For our application FP/KA/Others/33888/2018, Clarifications regarding a portion of area applied by us is Svy No. 659 and modification done.

**Ref:** Letter from your office having No. A5(2).GFL.CR-4/2018-19, dated 28/06/2018.

Namaste. Please accept our humble regards. Sir, for our proposal no. FP/KA/Others/33888/2018, vide the letter from your office having no.A5(2).GFL.CR-4/2018-19, dated 28/06/2018 there is a query that area applied by us comes in Svy No.659 of Kukkundoor Village and it's not in Svy No.283 of Kukkundoor Village. We are clarifying these queries in this letter (Refer 1).

Sir, we have checked the Akarband (Refer 2) and based on the Akarband we have also checked the Survey Sketch of Svy No.659 of Kukkundoor Village (Refer 3). A portion of our applied area was coming in the Survey No.659 and we have modified our applied area in Svy. No.283 of Kukkundoor Village has been modified accordingly to stop at Svy No.659 (Refer 4).

- 1) Village Map of Kukkundoor Village showing Svy No.659.
- 2) Akarband Copy of Svy No.659 of Kukkundoor Village.
- 3) Survey Sketch of Svy No.659 of Kukkundoor Village.
- 4) Geo Referenced Map of altered applied area in Svy. No.283 of Kukkundoor village modified so as to stop at Svy No.283 and not in Svy. No.659 of Kukkundoor Village.

Thanking you,

With Regards,  
Evers yours in the service of the Lord,

(Smt. Sumatha R Nayak)  
President & Managing Trustee  
Sri Ramakrishna Sharada Ashrama (R)

1

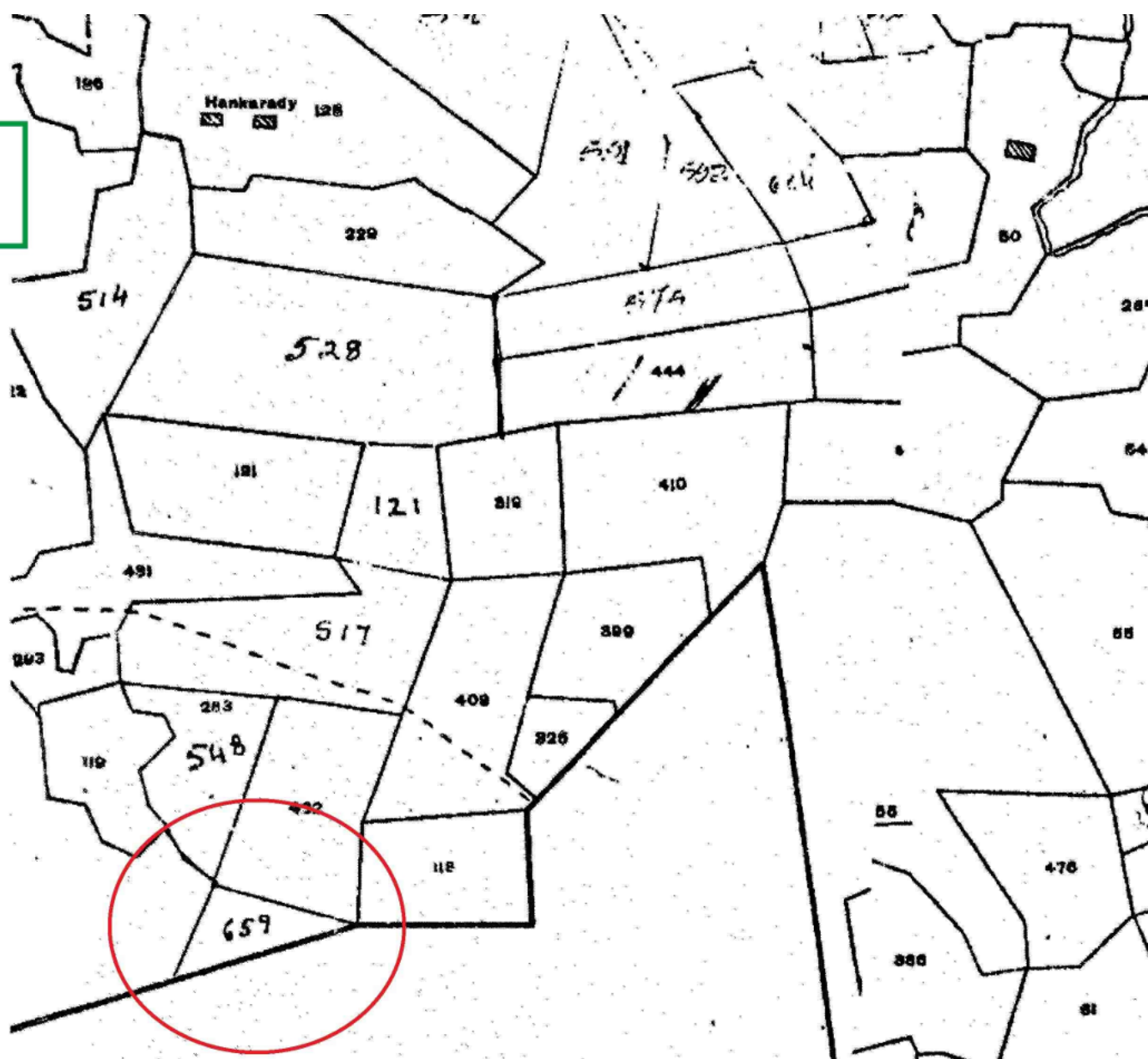

**The Village map of Kukkundoor shows Svy No.659 comes in the area we have applied.**

No. 38  
NITTE

For Sri Ramakrishna Sharada Ashrama (R.)

  
President / Secretary



ಕರ್ನಾಟಕ ಸರ್ಕಾರ  
ಕರ್ನಾಟಕ ರಿವಿಜನ್ ಸೆಟಲ್‌ಮೆಂಟ್ ಆಕಾರ್‌ಬಂದ್ (ಉತ್ತರ)

2

౧ హెక్టేర్ = ౧ ఎకరే ౧౯ గుంట  
 ౧ హెక్టేర్ = ౧౦౦ ఎర్స్  
 ౧ ఎకరే = ౪౦ గుంట = ౧౦౦ సెంటర్

ಪ್ರವಾಣ ಭೂತ ದರಗಳು

ಮಿ.ಸಿ.	1-20
ತರ	1-20
ಬಾಗಾಯ್ತು	1-20
ಬ್ಯಾಂಟಿಂಗ್	1-20
ಸಿಟ್ಟು ಮಂಡಿ ಚಾರಂಗಿ ಬಂದಿ ವರ್ತ	1-20

ಕಾ.ಸೂ. 61.ಸ.ಪ.ಮ.ಮು.ವ್ಯ. 20,000.ಪ್ರತಿಗಳು.ನವೆಂಬರ್.10

ಉಳಿದ ಸಾಗು ಜಮೀನು ಬಗ್ಗೆ ತಪ್ಪೀಲ್

[illegible]

For Sri Ramakrishna Sharada Ashraima (R.)

President / Secretary

ತಾಲ್ಲೂಕು :- ಕಾರ್ನಾಟ

ಗಣನೆ:- ಕುಕ್ಕುಂಡಾಳ

Ques. 23

ര.നം:- 659/12

3

1411/16-28

144/10-02

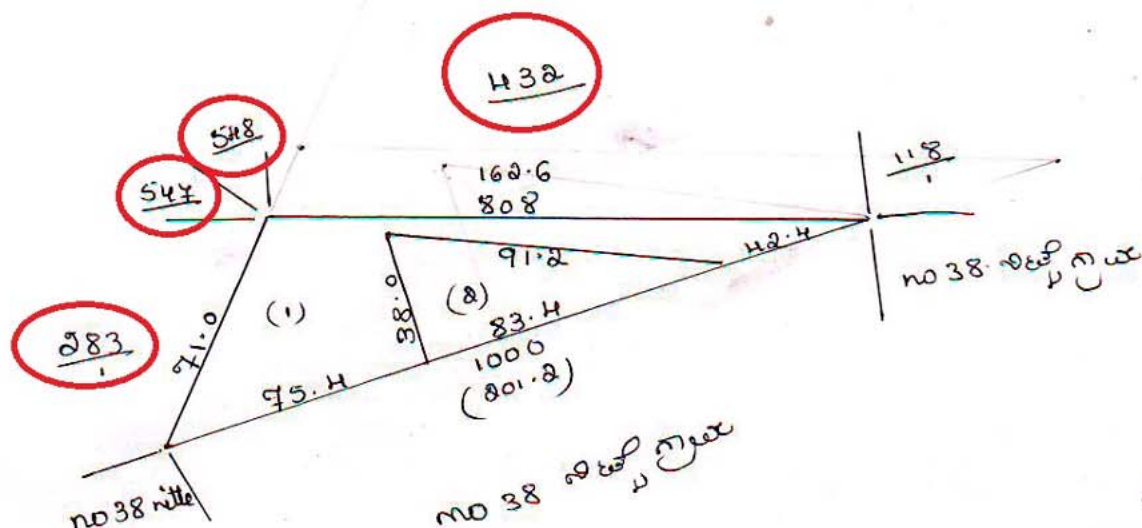

Survey Sketch of Svy No.659 showing Svy No.283 as boundary in the portion of area we have applied; and also shows Svy. No's 432, 548, 547 as the boundary.

മുഖ്യമന്ത്രി

Scale 1" = 0.1 m = 10 cm

**For Sri Ramakrishna Sharada Ashrama (R.)**

President / Secretary

2618 LR





Google Earth  
Image © 2018 DigitalGlobe

Geo Referenced Map of our FCA Applied area in  
circled portion showing modified applied area to  
stop in Svy No.283 itself and not in Svy no. 659

For Sri Ramakrishna Sharada Ashrama (R.)

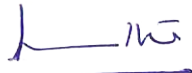
  
President / Secretary