

U.T.M.-REFERENCED MAP OF CA LAND AT VILL. DOLRI TEH PARASWADA, BALAGHAT

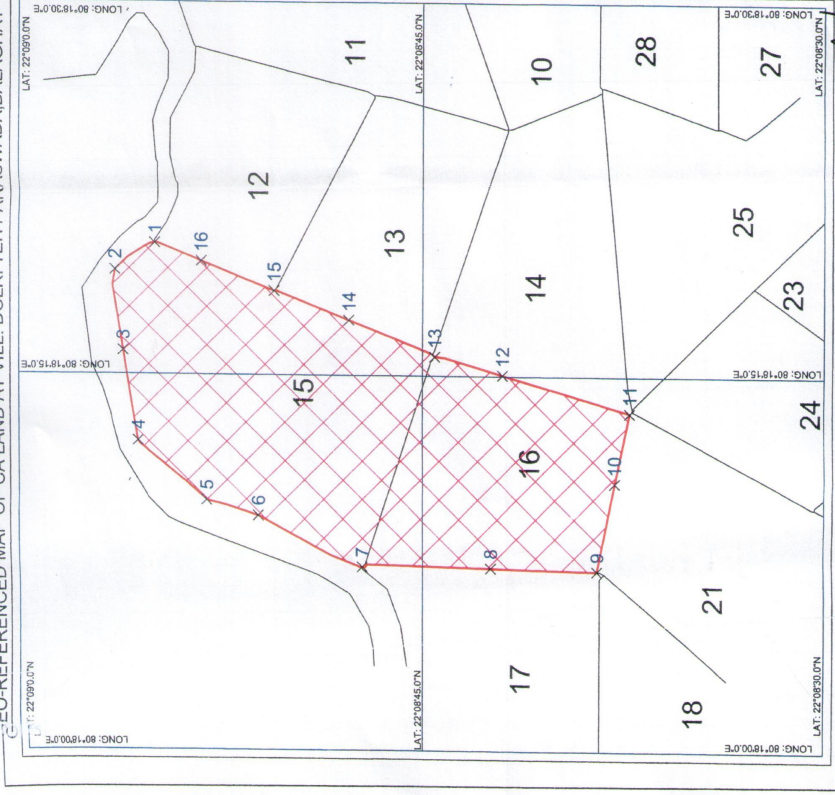

- LEGEND
- KHASRA LINE WITH KHASRA NO.
 - APPLIED FOR CA LAND
 - GRID LINE
 - X 31 PILLAR NO.

For *[Signature]*
The D.M.C. Co Ltd.

CO-ORDINATE LIST OF KHASRA NO 15, 16

PT.ID	UTM-44N		LATITUDE		LONGITUDE			
	NORTHING	EASTING	D	M	D	M		
1	2449413.886	429222.674	22	8	54.132	80	18	21.057
2	2449409.371	429339.812	22	8	55.653	80	18	19.973
3	2449405.856	429456.950	22	8	57.174	80	18	18.889
4	2449402.341	429574.088	22	8	58.695	80	18	17.805
5	2449398.826	429691.226	22	8	60.216	80	18	16.721
6	2449395.311	429808.364	22	8	61.737	80	18	15.637
7	2449391.796	429925.502	22	8	63.258	80	18	14.553
8	2449388.281	430042.640	22	8	64.779	80	18	13.469
9	2449384.766	430159.778	22	8	66.300	80	18	12.385
10	2449381.251	430276.916	22	8	67.821	80	18	11.301
11	2449377.736	430394.054	22	8	69.342	80	18	10.217
12	2449374.221	430511.192	22	8	70.863	80	18	9.133
13	2449370.706	430628.330	22	8	72.384	80	18	8.049
14	2449367.191	430745.468	22	8	73.905	80	18	6.965
15	2449363.676	430862.606	22	8	75.426	80	18	5.881
16	2449360.161	430979.744	22	8	76.947	80	18	4.797

VILLAGE - DORLI	
TEHSIL - PARASWARA , DIST - BALAGHAT	
PRAPOSED LAND	
LESSEE	D.M.C.C. Ltd MUMBAI (M/H)
AREA	BOXITE MINE PHADKI MOHGAON
13.33 Ha.	(32.939 Acre)

1:3960

Divisional Forest Officer
North Balaghat, B.S. Balaghat

Range officer
North Laxmi (1)

[Signature]
Range Officer
North Laxmi (1)