

LAYOUT PLAN OF SEWER LINE (EXTERNAL) FOR SECTOR-6, 7, 8 & 9, JIND

Along Sector - $6,7,8,9 = 255.00 + 892.00 + 1037.00 + 1191.50 = 2665.50 \times 1.185 = \frac{3158.62}{10000} = 0.316 \text{ Hac (HSVP Land)}$

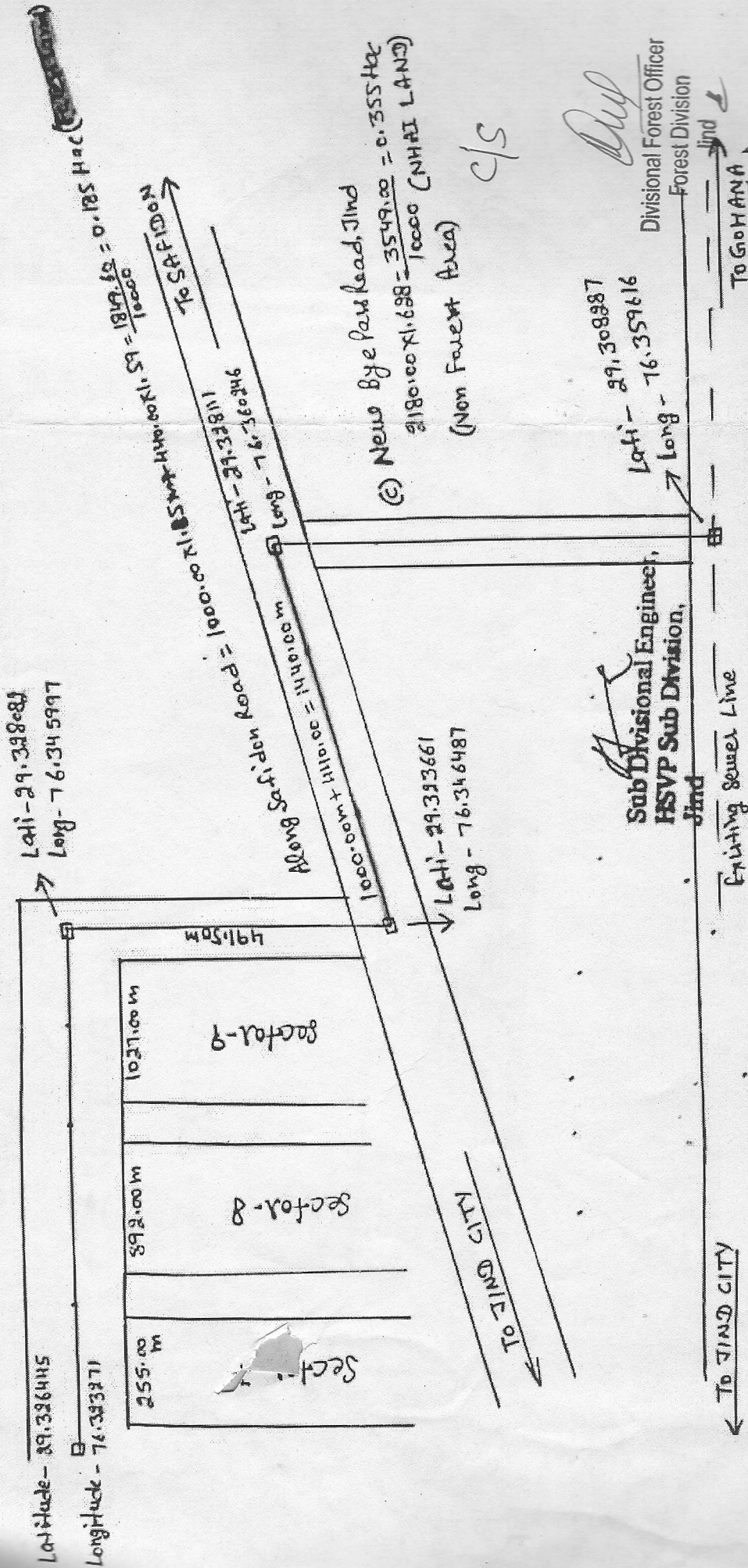

(c) New Bye Pass Road, Jind
 $2180.00 \times 1.688 = 3549.00 = 0.355 \text{ Hac}$
 (Non Forest Area)

C/S

Dip
 Divisional Forest Officer
 Forest Division

Sub Divisional Engineer,
 HSVP Sub Division,
 Jind

Executive Engineer,
 H.U.D.A. Division No. 1
 H I S A R.

Area Detail:- Jind-Saffidon Road = $1440 \text{ m} \times 1.55 = \frac{1849.60 \text{ m}}{10000} = 0.185 \text{ Hac}$
 Non Forest Area = $B + C = 0.316 + 0.355 = 0.671 \text{ Hac}$