

वन विभाग हरियाणा सरकार

कार्यालय :- वन मण्डल अधिकारी, मोरनी पिंजौर वन मण्डल, पिंजौर
वन परिसर पिंजौर, दूरभाष / फ़ैक्स नं० 01733-230537

e-mail-dfomorni@gmail.com

क्रमांक:- 946
सेवा में:-

दिनांक:- 05/8/22

मुख्य वन संरक्षक, उत्तरी परिमण्डल,
कम्पनी बाग, अम्बाला, हरियाणा।

विषय:- **Diversion of 0.98 ha. of Forest land for Construction of Link Road from Thapli-Barisher Road to Village -Koti in Tehsil-Morni, Distt. - Panchkula (HR). (FP/HR/ROAD/156170/2022)**

उपरोक्त विषय पर Executive Engineer, Provincial division, Hr.PWD B&R Br. Panchkula द्वारा सरकारी वन भूमि में 0.98 है० को डाईवर्ट करने हेतु भारतीय वन संरक्षण अधिनियम 1980 के तहत प्रस्ताव किया गया है। इस प्रस्ताव में चैक लिस्ट 18 के अनुसार

क्र० सं०	विवरण	राशि (Rs.)
1	Compensatory Afforestation Charges	2206568
2	Additional Compensatory Afforestation	27019
3	Supervisory/ Over head/ Miscellaneous Charges (10%)	220657
4	Catchment Area Treatment	728167
5	Tree Felling Charges	6840
6	Net present Value of Forest land	1204018
	Total	4393269

उक्त राशि सैधान्तिक स्वीकृति के उपरान्त एजेंसी से जमा करवाई जाएगी। प्रस्ताव को वन राजिक अधिकारी, मोरनी की रिपोर्ट के आधार पर तथा मौके के मुआयने अनुसार ही तैयार किया गया है। प्रस्ताव के दस्तावेजों की चैक लिस्ट अनुसार संकलित करके नम्बरवार लगाया गया है तथा नवीनतम मजदूरी की दरों के अनुसार पौधारोपण योजना केन्द्र व राज्य सरकार के गजट नोटिफिकेशन व हिदायतों अनुसार तैयार की गई है।

प्रस्ताव का फाईल नं० **FP/HR/RAOD/156170/2022** है। प्रस्ताव को वैबसाईट पर हस्ताक्षर उपरान्त फीड किया गया है। इस बारे आपको यह भी अवगत करवाया जाता है कि प्रोजेक्ट में 0.98 है का प्रस्ताव डाला गया है। वन राजिक अधिकारी, मोरनी तथा अधीनस्थ अमले की रिपोर्ट के अनुसार उचित पाया गया है। वन राजिक अधिकारी, मोरनी की रिपोर्ट के अनुसार प्रस्ताव पर कार्य करने पर 20 पेड़ 12 पौधे नष्ट होंगे। जिसका केस इस कार्यालय द्वारा आपको मुख्य वन संरक्षक, एफ०सी०ए०, हरियाणा, पंचकूला के पत्र क्र० **FCA Guideline/D-X-66-Vol-XIV-7413 dated 10-09-2020** की हिदायतों के अनुसार ऑनलाईन पोर्टल के माध्यम से भेजा जाता है।

वन मण्डल अधिकारी,
मोरनी-पिंजौर वन मण्डल,
पिंजौर।

पृ०क्र०: 947

दिनांक: 05/8/22

एक प्रति Executive Engineer, Provl. Division PWD B&R Br. Panchkula को सूचनार्थ एवं आगामी आवश्यक कार्यवाही हेतु प्रेषित है।

वन मण्डल अधिकारी,
मोरनी-पिंजौर वन मण्डल,
पिंजौर।

Makhlund
08/8/22

08/08/2022
24/8

Full title of the project: - Diversion of 0.98 ha. of Forest land for Construction of Link Road from Thapli-Barisher Road to Village -Koti in Tehsil-Morni, Distt. – Panchkula (HR).

File No. FP/HR/ROAD/156170/2022

Date of Proposal _____

**CHECK LIST SERIAL NUMBER 08
STATEMENT SHOWING DETAILS OF NON-FOREST AREA
INVOLVED IN THE PROPOSAL**

S#.	District	Division	Range/ Tehsil village	Khasra/ Survey or Compartment Number or Km. Stone	Non-Forest area involved in the proposal (Ha)	Present land use	Remarks
1	2	3	4	5	6	7	8
—Nil—							

Sub Divisional Engineer
Prov. Sub Divn.I.
Hr. PWD B&R Br., Panchkula
Signature of User agency

Forwarded by :

Place :

Dated :

Divisional Forest Officer
Morni - District Forest Division
Forest Division
Office seal Punore [Panchkula]

Full title of the project: - Diversion of 0.98 ha. of Forest land for Construction of Link Road from Thapli-Barisher Road to Village -Koti in Tehsil-Morni, Distt. – Panchkula (HR).

File No. EP/HR/ROAD/156170/2022

Date of Proposal _____

CHECK LIST SERIAL NUMBER: - 10
JUSTIFICATION FOR LOCATING THE PROJECT

Construction of Link Road from Thapli-Barisher Road to Village -Koti in Tehsil-Morni, Distt. – Panchkula (HR) has to be located in Forest Land; therefore, there is no other alternate but to use the forest land for Construction of link Road.

So, forest land is required for Construction of Link Road from Thapli - Barisher Road to Village -Koti in Tehsil-Morni, Distt. – Panchkula (HR).

Place: -

Date: -



Sub Divisional Engineer
Provl. Sub Divn.I.
Hr. PWD B&R Br., Panchkula

Signature of User Agency
Office Seal

Countersigned by :-

Divisional Forest Officer
Morni - Panchkula
.....Forest Division
Officer Seal



Divisional Forest Officer
Morni - Panchkula
Forest Division
Panchkula

Full title of the project: - Diversion of 0.98 ha. of Forest land for Construction of Link Road from Thapli-Barisher Road to Village -Koti in Tehsil-Morni, Distt. – Panchkula (HR).

File No. FP/HR/ROAD/156170/2022

Date of Proposal _____

CHECK LIST SERIAL NUMBER: - 11

CERTIFICATE FOR MINIMUM USE OF FOREST LAND

This is to certify that the forest area involved in the proposal is unavoidable and barest minimum forest area i.e., **0.98Ha.** which is proposed for diversion for Construction of Link Road from Thapli-Barisher Road to Village -Koti in Tehsil-Morni, Distt. – Panchkula (HR).

Place: -.....

Date: -

Sub Divisional Engineer
Prov. Sub Divn.I.
Hr. PWD B&R Br., Panchkula

Signature of User Agency

Office Seal

Countersigned by :-

Divisional Forest Officer

Morni - Panchkula Forest Division
Panchkula

Officer Seal

Full title of the project: - Diversion of 0.98 ha. of Forest land for Construction of Link Road from Thapli-Barisher Road to Village -Koti in Tehsil-Morni, Distt. – Panchkula (HR).

File No. _____

Date of Proposal _____

FP/HR/ROAD/156170/2022

CHECK LIST SERIAL NUMBER: - 12

**UNDER TAKING FOR PAYMENT OF COST OF
COMPENSATORY AFFORESTATION**

I, **Mr. Anil Kamboj, Sub Divisional Engineer, Provincial Sub Division No. 1, Hr. PWD B&R Br., Panchkula** hereby undertake to pay the entire amount for compensatory in lieu of the forest area diverted for Construction of Link Road from Thapli-Barisher Road to Village -Koti in Tehsil-Morni, Distt. – Panchkula (HR).

as per prevailing wage rates at the time of undertaking the plantation activities.

Place: -

Date: -

Sub Divisional Engineer
Provl. Sub Divn.I.
Hr. PWD B&R Br., Panchkula

Signature of User Agency
Office Seal

Countersigned by :-

Divisional Forest Officer
Divisional Forest Officer
.....Forest Division (Panchkula)
Officer Seal

Full title of the project: - Diversion of 0.98 ha. of Forest land for Construction of Link Road from Thapli-Barisher Road to Village -Koti in Tehsil-Morni, Distt. – Panchkula (HR).

File No. EP/HR/ROAD/156170/2022

Date of Proposal _____

CHECK LIST SERIAL NUMBER: - 12 A

**UNDER TAKING FOR PAYMENT OF COST OF
ADDITIONAL COMPENSATORY AFFORESTATION**

I, **Mr. Anil Kamboj, Sub Divisional Engineer, Provincial Sub Division No. 1, Hr. PWD B&R Br., Panchkula** hereby undertake to pay the entire amount for additional compensatory in lieu of the forest area diverted for Construction of Link Road from Thapli-Barisher Road to Village -Koti in Tehsil-Morni, Distt. – Panchkula (HR).

as per prevailing wage rates at the time of undertaking the plantation activities.

Place: -

Date: -

Sub Divisional Engineer
Provl. Sub Divn.I.
Hr. PWD B&R Br., Panchkula

Signature of User Agency
Office Seal

Countersigned by :-

Divisional Forest Officer
.....Forest Division
Morni - Pinjore Forest Division
Officer SealPinjore Panchkula



Full title of the project: - Diversion of 0.98 ha. of Forest land for Construction of Link Road from Thapli-Barisher Road to Village -Koti in Tehsil-Morni, Distt. – Panchkula (HR).
File No. FP/HR/ROAD/156170/2022
Date of Proposal _____

CHECK LIST SERIAL NUMBER: - 13

**UNDERTAKING FOR THE PAYMENT OF NET PRESENT VALUE OF
FOREST AREA**

It is to certify that I, **Mr. Anil Kamboj, Sub Divisional Engineer, Provincial Sub Division No. 1, Hr. PWD B&R Br., Panchkula** has applied for diversion of 0.98 ha. of Forest land for Construction of Link Road from Thapli-Barisher Road to Village -Koti in Tehsil-Morni, Distt. – Panchkula (HR).

I/We, hereby, undertake to pay the net present value (NPV) of the above forest land.

Place: -

Date: -



Sub Divisional Engineer
Provl. Sub Divn.I.
Hr. PWD B&R Br., Panchkula

Signature of User Agency

Office Seal

Countersigned by :-

Divisional Forest Officer

.....Forest Division

Officer Seal

Divisional Forest Officer
Morni - Pinjore Forest Division
Pinjore Panchkula



Full title of the project: - Diversion of 0.98 ha. of Forest land for Construction of Link Road from Thapli-Barisher Road to Village -Koti in Tehsil-Morni, Distt. – Panchkula (HR).

File No. FP/HR/ROAD/156170/2022

Date of Proposal _____

CHECK LIST SERIAL NUMBER: - 13-A

**UNDERTAKING FOR PAYMENT OF ADDITIONAL
NET PRESENT VALUE OF FOREST AREA**

It is certifying that I, **Mr. Anil Kamboj, Sub Divisional Engineer, Provincial Sub Division No. 1, Hr. PWD B&R Br., Panchkula** have applied for diversion of 0.98 ha. of Forest land for Construction of Link Road from Thapli-Barisher Road to Village -Koti in Tehsil-Morni, Distt. – Panchkula (HR).

I/we hereby undertake that our selected candidate will pay the additional NPV, if so determined, as per final decision of the Hon'ble Supreme Court of India.



Sub Divisional Engineer
Prov. Sub Divn.I.
Hr. PWD B&R Br., Panchkula

Sign. of User agency



Divisional Forest Officer
Morni - Pinjore Forest Division
Pinjore (Panchkula)

File No. EP/HR/ROAD/156170/2022
Date of Proposal _____

Sub Divisional Engineer
Prov. Sub Divn.I.
Hr. PWD B&R Br., Panchkula
Sign. of User agency

Divisional Forest Officer
Morni - Pinjore Forest Division
Pinjore [Panchkula]

Full title of the project: - Diversion of 0.98 ha. of Forest land for Construction of Link Road from Thapli-Barisher Road to Village -Koti in Tehsil-Morni, Distt. – Panchkula (HR).

File No. FP/HR/ROAD/156170/2022
Date of Proposal _____

CHECK LIST SERIAL NUMBER 04

DETAIL NOTE ON THE PROJECT FOR WHICH DIVERSION PROPOSED

IT MUST BE INCLUDED THE INFORMATION REGARDING NO. OF VILLAGERS AND NO. OF PERSONA TO BE BENEFITED FROM THE PROJECT INCLUDING EMPLOYMENT GENERATION.

It is certified that **Mr. Anil Kamboj, Sub Divisional Engineer, Provincial Sub Division No. 1, Hr. PWD B&R Br., Panchkula** have applied for the diversion of 0.98 ha. of Forest land for Construction of Link Road from Thapli-Barisher Road to Village -Koti in Tehsil-Morni, Distt. – Panchkula (HR).

It is benefited the population of nearby villages and also create Employment around areas.



Sub Divisional Engineer
Prov. Sub Divn.I.
Hr. PWD B&R Br., Panchkula

Signature of User Agency
Office Seal

Place:
Date:

Countersigned by :-

Divisional Forest Officer
.....
Officer Seal
Pinjore [Panchkula]

77°53'0"E

77°54'0"E

77°55'0"E

77°56'0"E

DGPS Map for Construction of Link Road from Thapli-Barisher Road to Village -Koti In Tehsil-Morni, Distt. – Panchkula (HR).

30° 43' 40.043" N, 77° 5' 46.544" E 30° 43' 40.195" N, 77° 5' 46.664" E

30° 43' 38.539" N, 77° 5' 47.984" E 30° 43' 38.620" N, 77° 5' 48.170" E

30° 43' 35.060" N, 77° 5' 46.420" E 30° 43' 34.997" N, 77° 5' 46.226" E

30° 43' 33.753" N, 77° 5' 49.650" E 30° 43' 33.897" N, 77° 5' 49.758" E

30° 43' 32.808" N, 77° 5' 54.390" E 30° 43' 32.832" N, 77° 5' 54.480" E

30° 43' 30.773" N, 77° 5' 54.705" E 30° 43' 30.696" N, 77° 5' 54.519" E

30° 43' 28.830" N, 77° 5' 57.307" E 30° 43' 28.877" N, 77° 5' 57.514" E

30° 43' 27.906" N, 77° 5' 56.799" E 30° 43' 27.965" N, 77° 5' 57.016" E

30° 43' 26.644" N, 77° 5' 56.050" E 30° 43' 27.085" N, 77° 5' 56.858" E

30° 43' 26.158" N, 77° 5' 56.758" E 30° 43' 26.282" N, 77° 5' 56.791" E

30° 43' 26.017" N, 77° 5' 33.844" E 30° 43' 25.805" N, 77° 5' 33.838" E

30° 43' 25.006" N, 77° 5' 38.890" E 30° 43' 25.222" N, 77° 5' 38.885" E

30° 43' 24.453" N, 77° 5' 41.361" E 30° 43' 24.669" N, 77° 5' 41.368" E

30° 43' 23.994" N, 77° 5' 51.386" E 30° 43' 23.968" N, 77° 5' 51.603" E

30° 43' 23.235" N, 77° 5' 51.733" E 30° 43' 23.188" N, 77° 5' 51.975" E

30° 43' 21.189" N, 77° 5' 46.970" E 30° 43' 20.982" N, 77° 5' 46.949" E

30° 43' 20.361" N, 77° 5' 50.323" E 30° 43' 20.346" N, 77° 5' 50.341" E

30° 43' 20.371" N, 77° 5' 50.097" E 30° 43' 20.369" N, 77° 5' 50.117" E

30° 43' 19.923" N, 77° 5' 49.576" E 30° 43' 19.705" N, 77° 5' 49.546" E

Legend

• GPS_Points

Forest Land for Diversion

0 0.0475 0.095

Miles

77°53'0"E

77°54'0"E

77°55'0"E

77°56'0"E



Sub Divisional Engineer
Prov. Sub Dym.I.

Ht. PWD BAR Br., Panchk

Construction of Link Road from Thapli-Barisher Road to Village -Koti in Tehsil-Morni, Distt. – Panchkula (HR).

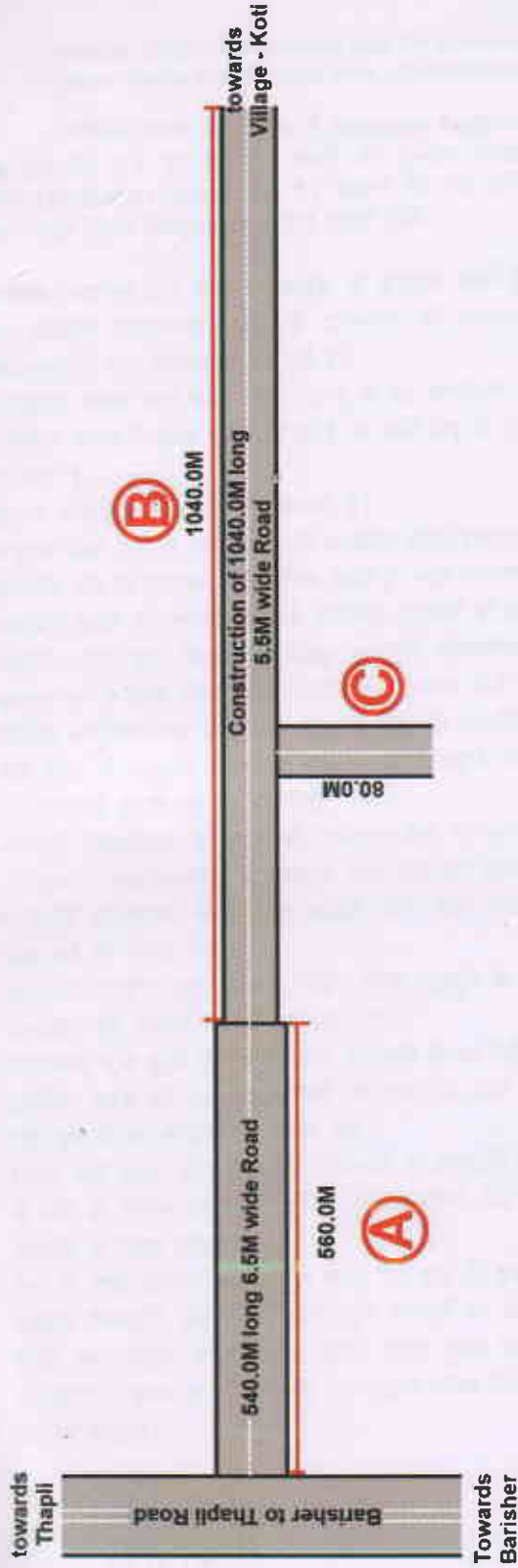

DRAWING NAME:	SCALE: -	DATE: -	NOTES: -	User Agency: -
SITE PLAN	NTS	02/06/2022	<ul style="list-style-type: none"> DRAWING AND DIMENSIONS ARE ONLY TO BE READ AND NOT SCALED. UNLESS OTHERWISE MENTIONED, ALL DIMENSIONS ARE GIVEN IN METERS THIS DRAWING SHALL BE READ IN CONJUNCTION WITH RELEVANT ARCHITECTURAL, STRUCTURAL AND SERVICES DRAWINGS. ALL LEVELS GIVEN IN DRAWING ARE WITH REFERENCE TO THE ROAD LEVEL AS BENCHMARK AT SITE ANY DISCREPANCY BETWEEN THE ARCHITECTURAL/ STRUCTURAL OR SERVICES DRAWINGS MUST BE BROUGHT TO THE ATTENTION OF THE ARCHITECT BY THE CONTRACTOR OR PROJECT MANAGER BEFORE EXECUTION OF THE SAME ARCHITECT & CAN NOT BE REPRODUCED IN ANY FORMAT WITHOUT WRITTEN CONSENT FROM THE ARCHITECT. 	<p>Sub Divisional Engineer Provl. Sub. Divn. I Hr. PWD B&R Br., Panchkula</p> <p>Mr. Anil Kamboj Sub Divisional Engineer, Provincial Sub Division No. 1, Hr. PWD B&R Br., Panchkula</p>
PROJECT NAME: - Site Plan for Construction of Link Road from Thapli-Barisher Road to Village -Koti in Tehsil-Morni, Distt. – Panchkula (HR).	Forest Area used A = 560.00M X 6.50M = 3640 SQMT B = 1040.00M X 5.50M = 5720 SQMT C = 80 X 5.50M = 440 SQMT A+B+C = 3640+5720+440 = 0.98 HECTARE = 0.98 HECTARE	<p>PRINCIPAL ARCHITECT:- Ar. NISHANT SINGH ARCHITECTS & INTERIOR DESIGNERS</p>		

Divisional Forest Officer
Morni - Pinjore Forest Division
Pinjore (Panchkula)

Full Title of the Project: Diversion of 0.98 ha. of Forest land for Construction of Link Road from Thapli-Barisher Road to Village -Koti in Tehsil-Morni, Distt. – Panchkula (HR).

File No.	(FP/HR/ROAD/156170/2022)	
Date of Proposal:		
PART-II		
(To be filled by the Deputy Conservator of Forests)		
State Serial No. of Proposal :		
a)	Location of the project/Scheme	Diversion of 0.98 ha. of Forest land for Construction of Link Road from Thapli-Barisher Road to Village -Koti in Tehsil-Morni, Distt. – Panchkula (HR)
(I)	State/Union Territory	Haryana
(ii)	District	Panchkula
(iii)	Forest Division	D.F.O (T), Morni, Pinjore
(iv)	Area of Forestland proposed for diversion (in Ha)	0.98 Ha
(v)	Legal status of forest.	P.F
(vi)	Density of vegetation.	0.50
(vii)	Species-wise (scientific names) and diameter class-wise enumeration of trees.	Attached
(viii)	Brief note on vulnerability of the forest area to erosion.	No.
(ix)	Approximate distance of proposed site for diversion from boundary of forest.	Site proposed site for diversion within Forest
(x)	Whether forms part of National, wildlife sanctuary, Biosdphere reserve, Tiger reserve, Elephant corridor, etc. (if so, the detail of the area and comments of the Chief Wildlife warden to be annexed).	No
(xi)	Whether any rare / endangered / unique species of Flora and Fauna found in area if so details thereof.	Not found at present
(xii)	Whether any protected archaeological / heritage site / defence establishment or any other important monument is located in the area. If so the details thereof with NOC from competent authority, if required.	No
8	Whether the requirement of forestland as proposed by user agency in col 2 of part 1 is un avoidable and barest minimum for the project. If NO, recommendation item wise with details alternatives examined.	Yes.
9	Whether any work violating the act has been carried out (Yes/No). If yes details of the same including period of work done, action taken in violation is still in progress.	No

10	Details of compensatory afforestation Scheme :	Attached
I)	Details of Non forest area/ degrade forest area identifies for compensatory afforestation, its distance from adjoining forest, number of plants, size of each path.	Attached
ii)	Map showing non-forest area indentified for compensatory afforestation and adjoining forest boundaries.	Attached
iii)	Detailed compensator afforestation scheme including species to be planted, implementing agency, time schedule, costructure etc.,	Attached
iv)	Total financial outlay for compensatory afforestation scheme.	Attached
v)	Certificates from competent authority regarding suitability of area identified for compensatory afforestation from management point of view. (To be signed by the concerned Deputy Conservator of forests)	Suitability certificate attached.
11	Site inspection report of the DCF (to be enclosed) especially highlighting facts asked in col-7 (xi, xii) 8 and 9 above.	Attached
12	Division/District profile :	
I)	Geographical area of district.	81615 Ha.
ii)	Forest area of District	38214.54 Ha.
iii)	Total forest area diverted since 1980 with number of cases. Upto 31-03-2017	Privious from 01-04-1980 Diverted area (Ha) = 544.9244. This proposal forest area = 0.98 Ha. Total forest area Diverted in Ha. = 549.2744
iv)	Total compensatory afforestation stipulated in the district/vision since 1980 on 31-03-2017	
a)	Forestland including penal compensatory afforestation.	298.6744 Ha.
b)	Non-Forestland	Nil
v)	Progress of compensatory afforestation as on (date 25-10-1980 on 31-03-2017	
a)	Forest Land	101.317 Ha.
b)	Non-Forestland	50 Ha.
13	Specific recommendations of the DCF for acceptance or otherwise of the proposal reasons.	Proposal may be accepted for public utility.

Place: Pinjore

Date

Divisional Forest Officer(T)
Morni Forest Division,
Pinjore

Full Title of the Project: Diversion of 0.98 ha. of Forest land for Construction of Link Road from Thapli-Barisher Road to Village -Koti in Tehsil-Morni, Distt. – Panchkula (HR)

File No. : FCA- (FP/HR/ROAD/156170/2022)

Date of Proposal:

CHECK LIST SERIAL NUMBER-07

STATEMENT SHOWING DETAILS OF FOREST AREA PROPOSED FOR DIVERSION

Sr. No.	District	Division	Range/ Tehsil Village	Khasara/ Survey or Compartment Number of KM Stone	Forest proposed for Diversion (Ha)	Legal Status of Forest Area	Remarks
1	2	3	4	5	6	7	8
1	Panchkula	Morni-Pinjore Territorial	Morni	Diversion of 0.98 ha. of Forest land for Construction of Link Road from Thapli-Barisher Road to Village -Koti in Tehsil-Morni, Distt. – Panchkula (HR)	0.98 Ha	PF	-

Place. Pinjore

Dated.....

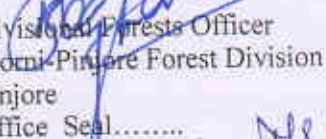
Divisional Forest Officer
Morni-Pinjore Forest Division
Pinjore
Office Seal..... 

Full Title of the Project: Diversion of 0.98 ha. of Forest land for Construction of Link Road from Thapli-Barisher Road to Village -Koti in Tehsil-Morni, Distt. – Panchkula (HR)

File No. : FCA- (FP/HR/ROAD/156170/2022)

Date of Proposal:

CHECK LIST SERIAL NUMBER: 16
SITE INSPECTION REPORT NOT BELOW THE RANK OF DCF
(For the Forest land to be diverted under FCA)

A proposal has been received by this office from **Executive Engineer, Provincial Division, Hr. PWD B&R Br., Panchkula** for diversion (under FCA1980) 0.98 ha. of Forest land for Construction of Link Road from Thapli-Barisher Road to Village -Koti in Tehsil-Morni, panchkula District The site inspection of the land involved in the proposal has been done by me on dated.....02/08/2022.....

On inspection of the site, it is found that the land required by the user agency is a forest measuring 0.98 ha.

The requirement of forest land as proposed by the user agency in Col. 2 of part-I is unavoidable and is barest minimum required for the project.

Whether any rare/ endangered/ unique species of flora and fauna found in the area. If so, the details thereof.

Whether any protected archaeological/ heritage site/ defense establishment or any other important monument is located in the area. If so, the details thereof with NOC from competent authority, if required.

(a) The user agency has not violated the provisions of Forest (Conservation) Act, 1980 and no work has been started without proper sanction.

(b) It has been found that the user agency has violated the Forest (Conservation) Act, 1980 provisions. A detailed report as per para 1.9 of Chapter 1, Part C of Hand book of Forest (Conservation) Act, 1980 is attached).

(Note: Whichever of the above is applicable should be shown in bold letters)

Specific recommendation for acceptance or otherwise of the proposal.

Place : Pinjore

Dated

Divisional Forests Officer
Morni- Pinjore Forest Division.
Pinjore
Office Seal

Full Title of the Project: Diversion of 0.98 ha. of Forest land for Construction of Link Road from Thapli-Barisher Road to Village -Koti in Tehsil-Morni, Distt. – Panchkula (HR)

File No. : FCA- (FP/HR/ROAD/156170/2022)

Date of Proposal:

CHECK LIST SERIAL NUMBER: 17

LOCATION MAP

Location Map of Non Forest/Degraded Forest Area identified for Compensatory Afforestation in lieu of proposal for diversion of 0.98 ha. of Forest land for Construction of Link Road from Thapli-Barisher Road to Village -Koti in Tehsil-Morni, Panchkula District by **Executive Engineer, Provincial Division, Hr. PWD B&R Br., Panchkula.**

Plantation Site

Tehsil:- Morni

Forest Division :- Territorial Division, Morni-Pinjore

District- Panchkula

Forest Range:- ~~Barwa~~ **Morni**

Block No: C-203 of Koti Beat, Barwa Block, Morni range

Place :Pinjore

Dated

Divisional Forests Officer
Morni-Pinjore Forest Division.
Office Seal

[Signature]
[Signature]

Full Title of the Project: Diversion of 0.98 ha. of Forest land for Construction of Link Road from Thapli-Barisher Road to Village -Koti in Tehsil-Morni, Distt. – Panchkula (HR).

File No.	(FP/HR/ROAD/156170/2022).			
Date of Proposal				
CHECK LIST SERIAL NUMBER:- 18				
Name of the Forest/Reach to be diverted	Diversion of 0.98 ha. of Forest land for Construction of Link Road from Thapli-Barisher Road to Village - Koti in Tehsil-Morni, Distt. – Panchkula (HR).			Panchkula Distt.
Forest Area (in Ha)	0.98 Ha			
Details of de-graded forest land/non forest land where CA is to be carried out :	Morni-Pinjore		C-203 of Koti Beat, Barwa Block, Morni range	Village. C-203 of Koti Beat, Barwa Block, Morni range
GPS Reading of proposed CA site	C-203 of Koti Beat, Barwa Block, Morni range			
Description of Area :				
2	Whether the site selected for Compensatory Afforestation is a land bank or not			
i	If the C.A site is other than the land bank, reasons be given N.A			
ii	In case of non-forest area identified for CA, then what is the distance of CA site from adjoining forest boundary Within Forest			
iii	Soil Type Arid brown soil with texture varies from sandy loam to clay.			
iv	Topography :		a. Hilly/Undulating/Plain.	Undulating
v			b. Slope:-	Gentle
Whether the area is bearing any root stock of vegetation				No
vi				
Plantation of Model:-				
3	Copy of the approved Compensatory Afforestation Scheme/Model showing component wise physical and financial break up is as under :-			
Detail of year wise breakup of requirement of funds is as under :-				
4				

The plantation cost is calculated for Small plants norms at 4mtr x 4 mtr spacing and it is approved by the PCCF, Haryana's vide letter no. CAMPA/ 683-85 dated 14-09-2021 at the wage rate of Rs.363.77/- per day as under :--

per day as under :-					
	Year		Cost norm per plants		
Sr.No.	1st Year Cost of Afforestation		163.40		
i	2nd Year Maintenance		51.60		
ii	3rd Year Maintenance		37.30		
iii	4th Year Maintenance		10.50		
iv	5th Year Maintenance		10.50		
v	6th Year Maintenance		10.50		
vi	7th Year Maintenance		10.50		
vii	8th Year Maintenance		10.50		
viii	9th Year Maintenance		10.50		
IX	10th Year Maintenance		10.50		
	Total		325.80		
Area to be Diverted					0.98 Ha
Area to be planted		(Two times the diverted area)			1.96 Ha
Nos of trees to be felled					20 No.
Nos of Plants to be planted @ 1000/- plants per Ha					1960
Nos of Plants to be damaged				12	
Two times of Plant to be damaged				24	
Schedule of Plantation Programme :-					
5	Detail of year wise break-up of requirements of funds is as under :-				
Sr. No.	Description		Rate		Amount
A	Compensatory Afforestation Charges		Nos of Plants	Rate Per plant	
i	1st Year Cost of Afforestation		1960	163.40	320264
ii	2nd Year Maintenance		1960	51.60	101136
iii	3rd Year Maintenance		1960	37.30	73108
iv	4th Year Maintenance		1960	10.50	20580
v	5th Year Maintenance		1960	10.50	20580
vi	6th Year Maintenance		1960	10.50	20580
vii	7th Year Maintenance		1960	10.50	20580
viii	8th Year Maintenance		1960	10.50	20580
ix	9th Year Maintenance		1960	10.50	20580
x	10th Year Maintenance		1960	10.50	20580
xi	Barbed wire fencing charge (RKM)		7.84	Rs.200000/- per RKM.	1568000
				Total Charges	2206568
Supervisory / Over Head / Miscellaneous Charges			10% of CA		220657
ToTal (A)		CA Charges			2427225

B	Addl Compensatory Afforestation Charges		Nos of Plants	Rate Per plant	
i	1st Year Cost of Afforestation		24	163.40	3921.6
ii	2nd Year Maintenance		24	51.60	1238.4
iii	3rd Year Maintenance		24	37.30	895.2
iv	4th Year Maintenance		24	10.50	252
v	5th Year Maintenance		24	10.50	252
vi	6th Year Maintenance		24	10.50	252
vii	7th Year Maintenance		24	10.50	252
viii	8th Year Maintenance		24	10.50	252
ix	9th Year Maintenance		24	10.50	252
x	10th Year Maintenance		24	10.50	252
xi	Barbed wire fencing charge (RKM)		0.10	Rs.200000/- per KM.	19200
	ToTal (B) Addl. C.A.Charges				27019.2
C	Penal C.A.				0
D	Catchment Area Treatment/Soil and Moisture Conservation Charges			30% of the total CA	728167
E	Safety Zone	if required			0
F	Add.charges	if required			0
G			0	0	0
H	Felling Charges	20 trees	5.7	Rs.1200/-per CUM	6840
	Grand Total				3189251
Or Say Technical Details :-					
6	Technical Details of Compensatory Afforestation Scheme are as follows :-				
	General Details			Plantation will be done with 3 standard barbed wire in RF/PF.	
a	Spacement.			4 x 4 mtr.	
b	Species.			Native species	
c	Plantation			Small Plantation	
d	Soil and Moisture Conservation Works.			As per requirement of CA site.	
e	Protection (Fencing, watchman, Peoples Participation etc).			Fencing	
f	Proposed Monitoring Mechanisim.			M&E	
g	Any Other Information			No any.	

 Divisional Forest Officer(T),
 Morni Forest Division,
 Pinjore

Full Title of the Project: Diversion of 0.98 ha. of Forest land for Construction of Link Road from Thapli-Barisher Road to Village -Koti in Tehsil-Morni, Distt. – Panchkula (HR).

File No.

FP/HR/ROAD/156170/2022

Date of Proposal

CHECK LIST SERIAL NUMBER:-

Net Present Value of forest land to be diverted	Density of vegetation	Eco-class	No. of trees	Area to be diverted (in Ha.)	NPV Rates (in Rs.)	Total Amount of NPV (Rs.)
	0.5	III	20 trees and 12 u/s plants	0.98	1228590	1204018

Divisional Forest Officer
Morni - Pinjore Forest Division
Pinjore [Panchkula]

Full Title of the Project: Diversion of 0.98 ha. of Forest land for Construction of Link Road from Thapli-Barisher Road to Village -Koti in Tehsil-Morni, Distt. – Panchkula (HR)

File No. : FCA- (FP/HR/ROAD/156170/2022)

Date of Proposal:

CHECK LIST NO. 19

“LAND SUITABILITY CERTIFICATE BY DFO (T)”

This is to certify that C-203 of Koti Beat, Barwa Block, Morni range is selected for Compensatory Afforestation is compact block and contiguous to forest area or in close proximity of forest area and suitable for plantation from management and Protection point of view.

Place: Pinjore

Dated

Divisional Forests Officer
Morni-Pinjore Forest
Division.
Office Seal. 

Full Title of the Project: Diversion of 0.98 ha. of Forest land for
Construction of Link Road from Thapli-Barisher Road to Village -Koti
in Tehsil-Morni, Distt. – Panchkula (HR)

File No. : FCA- (FP/HR/ROAD/156170/2022)

Date of Proposal:

CHECK LIST NO. 20

“LAND SUITABILITY CERTIFICATE BY DFO (T)”

This is to certify that **1.984 Ha** of **C-203** of **Koti Beat, Barwa Block, Morni range** will be planted. The said area is Protected Forest. The land identified for Compensatory Afforestation is suitable for plantation from management point of view and is free and all sorts of encumbrances and encroachments.

Place: Pinjore

Dated

Divisional Forests Officer
Morni-Pinjore Forest Division.
Office Seal.

CA Site - C-203, Koti Beat Barwa Block for Proposal No. - FP/HR/ROAD/156170/2022

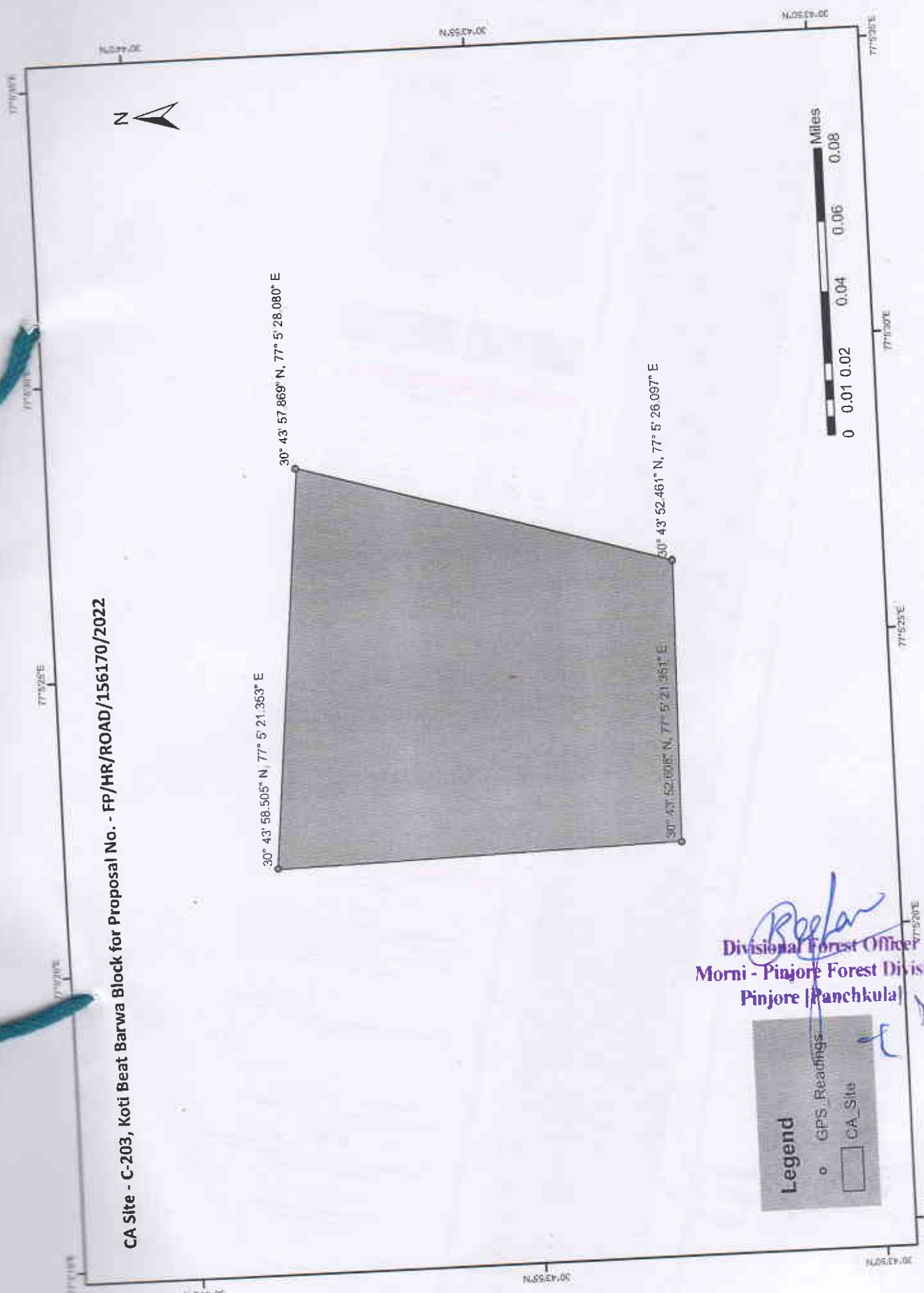

Reelax
Divisional Forest Officer
Morni - Pinjore Forest Division
Pinjore (Panchkula)



(2/3)
 o/c building
 block

Sandupfermarkt.
 1c Kati Bhanda Bent.

 वन प्राधिकार अधिकारी
 कोशी

No. H43L2

 Scale 1:50,000

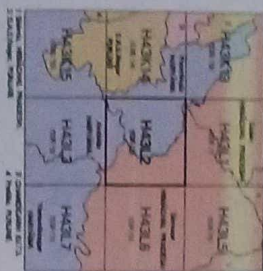

Survey of India

 New Delhi

CONVENTIONAL SYMBOLS

Capital City	District Boundary	National Highway	Railway Station
State Capital	District Capital	State Highway	Railway Junction
Town	Village	Road	Canal
Fort	Temple	Bridge	Waterfall
Hill	Mountain	Glacier	Lake
River	Stream	Embankment	Barrage
Dam	Well	Windmill	Lighthouse
Fortification	Prison	Hospital	School
Post Office	Railway Signal	Railway Bridge	Railway Tunnel
Airfield	Airport	Cableway	Pipeline
Pipeline	Pipeline	Pipeline	Pipeline

CONVENTIONAL INDEX

 Capital City

 District Capital

 Town

 Village

 Fort

 Temple

 Hill

 Mountain

 River

 Stream

 Road

 Canal

 Embankment

 Barrage

 Dam

 Well

 Windmill

 Lighthouse

 Fortification

 Prison

 Hospital

 School

 Post Office

 Railway Signal

 Railway Bridge

 Railway Tunnel

 Airfield

 Airport

 Cableway

 Pipeline



Divisional Forest Officer

 Morli - Pargore Forest Division

 Pargore (Parghul)