



एक कदम स्वच्छता की ओर



सीसीएल

एक मिनीरल कम्पनी

सेन्ट्रल कोलफील्ड्स लिमिटेड

(भारत सरकार का एक उपक्रम)

दरभंगा हाउस, कुचहरी रोड, राँची 834 029, झारखण्ड

CENTRAL COALFIELDS LIMITED

(Govt. of India Undertaking)

Darbhanga House, Kutcheri Road, Ranchi 834 029, Jharkhand

कॉर्पोरेट आइडेंटिटी नं./ : U10200JH1956GOI000581

फोन/Phone : (0651) 2301606, 2360123, 2316707 (DID)

फैक्स/Fax : (0651) 2360003

ई-मेल/e-mail : cml@cdl.gov.in, वेबसाइट/Website : http://www.cdl.gov.in

Ref. No. PO(KBP)/2022/61

Dated: 18-08-2022

To,
The Divisional Forest Officer
Ramgarh, Jharkhand

Sub: Compliance to the query raised in respect to the proposal for diversion of forest land of 633.19 Ha falls in Ramgarh District of Kotre Basantpur Pachmo OCP, dated 07/07/2022.

Ref: - पत्रांक- 1356, dated 07/07/22.

Dear Sir,

The online application for diversion of forest land (633.19 Ha) for Kotre Basantpur Pachmo OCP in Ramgarh District was submitted online vide FP/JH/MIN/38247/2019 in Form A. The compliance of queries raised against this proposal on 07/07/2022 are as mentioned below.

Point wise compliance against query raised are as follows:

Si. No.	Observation of MOEF&CC	Compliance
i.	Proposal has been submitted into two parts for two separate districts, while as per guidelines given under the chapter 7 of the Handbook proposal for a mining lease should be submitted in its entirety. Rationale for submitting isolated proposals for a single project needs to be informed by the State	<p>Total Forest Land required for Kotre Basantpur Pachmo OCP is 1,006.17 Ha</p> <ul style="list-style-type: none">- Notified Forest: 714.22 Ha- GMJJ: 291.95 Ha <p>The district-wise breakup is as below:</p> <ul style="list-style-type: none">- Ramgarh: 633.19 Ha<ul style="list-style-type: none">o Notified Forest: 497.86 Hao GMJJ: 135.33 Ha- Bokaro: 372.98 Ha<ul style="list-style-type: none">o Notified Forest: 216.36 Hao GMJJ: 156.62 Ha <p>Separate applications have been made for the two districts because, as per the Mining Plan, the Mining Operations would commence from the Ramgarh district and continue till 10 years Therefore, the application was first made for Ramgarh district on 22.01.2019.</p> <p>Subsequently, the application for Bokaro district was made on 18.03.2019, since some infrastructure which is allied to Mining Operations such as Workshop, magazine, etc. and the approach road was planned to be constructed in initial period of Mining Operation in Bokaro district.</p>

राजीब हुई / RAJIB HUI
परियोजना पदाधिकारी / PROJECT OFFICER
कोतरे बसंतपुर पचमो कोल परियोजना
Kotre Basantpur Pachmo Coal Mining
Ranchi

		However, we request the Ministry to merge both proposals and make a single proposal encompassing area of 1,006.17 Ha.
ii (d).	<p>Ministry vide its letter dated 17.10.2019 has conveyed its 'in-principle approval' accept the mined out and reclaimed non-forest lands available with the CIL subsidiaries. The Ministry of Coal vide their letter dated 20.01.2022 informed the availability of 300.75 ha of non-forest land, biologically reclaimed, available with the M/s CCL.</p> <p>The State Government may therefore assess the suitability of such non-forest land to include the same in the CA proposal.</p>	<p>The 300.75 ha of biologically reclaimed land available with the M/s CCL has been proposed to be transferred to forest department details of which are as below</p> <p>33 ha has been proposed for transfer to Bokaro Forest Division in respect of compliance of Stage II Forestry Clearance of Amlo OCP (copy as enclosed Annexure IA); and</p> <p>267.75 ha has been proposed for transfer to Bokaro Forest Division in respect of compliance of Stage II Forestry Clearance of Konar OCP, as evident from the compliance of Stage II vide 8-55/2009-FC in respect of Konar OCP at point no 13 (copy enclosed as Annexure IB).</p>
iii	<p>Details of degraded forest identified in lieu of 1.5 times the area of safety zone of the mining leases for raising afforestation has not been submitted along with the proposal. Same needs to be submitted along with complete details of supporting attributes such as afforestation scheme, suitability certificate, KML files etc.</p>	<p>As the 10.58 Ha of Safety Zone has been ear-marked within the 1006.17 Ha of forest land proposed for diversion, CA Land of 2012.34 Ha i.e 2 times to the land being diverted, has been proposed which covers CA Land 2 times to the safety zone area of 10.58 Ha. The details of total CA Land proposed is shown in Annexure IC.</p> <p>However, an additional degraded forest area 1.5 times to the area of the safety zone of 10.58 ha i.e. 15.87 ha area has been identified in Ramgarh Forest division. The cadastral plan and KML file of the proposed area is enclosed herewith as Annexure ID & IE. It is requested to provide the suitability certificate and afforestation scheme of the same.</p>

Q.

राजीब हुई / RAJIB HUI
परियोजना पदाधिकारी / PROJECT OFFICER
कोतरे बसंतपुर पंचमो कोल परियोजना
Kotre Basantpur Pachmo Coal Mine
सी.सी.एल., राँची / C.C.L., Ranchi

iv.	As the area has schedule-I and schedule-II species comments of PPCCF (Wildlife) and CWLW Jharkhand on the likely impact of the project on the movement of wildlife in general and elephant in particular need to be furnished by the State.	<p>The observation of PCCF (Wild Life) has been received on the likely impact of project on the movement of wildlife in general. Copy of the observation of PCCF (Wild life) on 16.03.2022 enclosed as Annexure-A.</p> <p>The Wild life management plan is under preparation. In case of delay in finalization of Wild Life Management Plan, the project proponent undertakes to submit lumpsum amount @ 2% of the total Project Cost towards cost of implementation of Wildlife Management Plan in CAMPA account along with Stage I compliance, as per the MOEF & CC directive FC-11/43/2021-FC dated 07/06/2022.</p>
v.	For the purpose wise breakup of forest land	
a.	An area of 26.96 ha of forest land, comprising of 14.95 ha in Ramgarh Forest Division and 12.01 ha in Bokaro Forest Division, has been proposed for infrastructure while only 0.88 ha only has been proposed in non-forest land. The State Government may therefore assess the legitimacy of site-specificity of various infrastructural components and possibility to shift non-site-specific components to the non-forest land.	<p>The Total Project Area of the Kotre Basantpur Pachmo Opencast Project is 1,162.87 ha, out of which 1,006.17 ha is Forest Land and the remaining 156.70 Ha is non-forest land.</p> <p>The non-forest land is scattered throughout the Project Area. To ensure the safety and ease of operations, the essential infrastructures such as Belt Conveyor, Coal Handling Plant, Sub-Station, etc. are proposed on the leasehold area, adjoining to the area proposed to be used for coal mining purpose.</p> <p>North side of the Project Area is Forest Land. The area towards East & West is coal bearing areas associated with upcoming Basantpur OCP in the West and Lalgah OCP in the East. In the South side Kedla washery and Dania to Kedla railway line are proposed.</p> <p>This has forced to accommodate infrastructure within the leasehold area. Some of the infrastructures are temporary in nature and may need to be shifted during Mining operations.</p> <p>Further, cluster of non-forest land having adequate space to accommodate the infrastructure outside the active mining area is not available. Hence, in order to execute mining operation, safely as well as efficiently, allied infrastructure such as workshops, office buildings, etc. have been proposed in the adjoining mining area.</p> <p>Copy of Plan is enclosed as Annexure II.</p>
b.	A total forest land of 134.47 ha of forest land, comprising of 68.86 ha in Ramgarh Forest Division and 65.61 ha in Bokaro Forest Division, has been proposed for Green belt which is in addition to 10.58 ha of forest land earmarked for safety zone. Rationalise	A Safety Zone of 7.5 m all around the leasehold area of the mine is proposed to be maintained as per the MOEF&CC guideline dated 04.07.2014. In addition, Green Belt is proposed to be developed adjoining Safety Zone within the leasehold area of the project as an additional measure to contain air pollution and to maintain ecological health of buffer zone. Further ear-marking of green belt area has been necessitated by standard Terms of Reference 1(A) – 8, issued

 राजीव हुई / RAJIB HUI
 परियोजना पदाधिकारी / PROJECT OFFICER
 कोतरे बसंतपुर पंचमो कोल परियोजना
 Kotre Basantpur Pachmo Coal Mine
 सी०सी०एल०, राँची / C.C.L., Ranchi

	for including green belt area in the project which could otherwise be excluded from the project and be managed by the Forest Department. Considered view of the State Government in this regard needs to be furnished.	by the MOEF. The map showing the safety zone and green belt of the project area is shown in the Annexure II-A1 . The area proposed for green belt is required for movement of Mining machinery during quarry operations and the felling of trees is required to facilitate the movement of equipment. Afforestation will be carried out in a phased manner in green belt area after completion of mining operations adjacent to these areas. Hence diversion of this forest land is also essential.
c.	No area has been earmarked for the storage of top soil.	It has been estimated that around 2.90 Mm ³ topsoil will be generated throughout the life of mine. It has been proposed to store the topsoil in a designated site away from mining operations within the land proposed for diversion and use it for bio reclamation of degraded mine area. The same has been shown on the map enclosed. (Annexure-II A-2) Top Soil Management Plan is enclosed as Annexure III .
vi.	Separate cost benefit ratio has been estimated for 633.19 ha and 372.98 ha of forest land indicating the cost benefit ratio of 19.31 and 1:26.73, respectively for a single project. Consolidated CB ratio for the entire forest land of 1006.17 involved in the project needs to be submitted by the State.	Cost benefit ratio for the entire Project including 1,006.17 ha of forest land and enclosed as Annexure- IV .
vii.	Nearest Railway Station Dania has been reported to be located at a distance of 4 km from the proposed area for diversion. Details of evacuation Plan from the mine head to nearest railway sidings may be informed by the State.	The Coal extracted from the instant Project will be crushed (within the Project Area) and transported to nearby existing Kedla Washery and proposed Tapin Wastery by Belt Conveyor. The Washed Coal will be loaded into the railway wagons via Rapid Loading System and will be transported by Railways Line under construction from Dania Station to Kedla Washery, and the same have been shown in the Surface Plan. The relevant surface plan is attached as Annexure-V .
viii.	Diversion of nalla has been proposed in the proposal. However, proposed course for diversion, conspicuously depicted on a map (KML file) has not been submitted, the same needs to be submitted.	The proposed course of diversion plan as well as KML file of seasonal stream is enclosed as Annexure VI . We would like to further mention that NOC for the proposed nala diversions has been obtained from Damodar Valley

राजीव हुई / RAJIB HUI
 परियोजना पदाधिकारी / PROJECT OFFICER
 कोतरे बसंतपुर पंचमो कोल परियोजना
 Kotre Basantpur Pachmo Coal Mine
 सी.सी.एल., राँची / C.C.L., Ranchi

	Further, comments of the Department of Water Resources on the efficacy of proposed diversion of nallah by the user agency needs to be informed by the State.	<p>Corporation (DVC) (Annexure-VI-A) as the project falls under the Command area of DVC.</p> <p>A detailed project report for the proposed nalla diversions is being prepared by IIT Roorkee. Once the DPR has been prepared the same will be submitted to State Water Resource Department for its approval. The efficacy of the proposed Nala diversion will be incorporated in the DPR. The copy of work-order awarded to IIT Roorkee is enclosed as Annexure VIB</p>
ix.	Forest area has been identified for OB. Non-forest area can also be used for OB. In this context, justification may be given for particularly including 44 ha (as ascertained from KML file) of very dense forest as forest site-specific requirement for dumping OB.	<p>The gradient of the seams proposed to be extracted varies from 18 to 25 degrees. The Block is having difficult geological conditions associated with 15 numbers of fault (copy of geological plan enclosed as Annexure VII A1 and section is enclosed as Annexure VII-A2).</p> <p>In order to ensure safety of mining operations, certain quantity of OB during initial life of the mine is proposed to be dumped externally which will be flushed with internal OB dump later on.</p> <p>There is no tenancy/non-forest land available adjacent to the project in any direction. There is Basantpur project on the west side, Lalgah coal block on the east side, complete forest land on north side and washery & railway line on south side. Thus the proposed 313.50 Ha of forest land for external dumping has become mandatory. The dense forest of 44 Ha is in isolated patches and could not be avoided due to the above reasons.</p>

This is for your Kind perusal and necessary action please.

Yours faithfully,



Rajib Hui

Project Officer

Kotre Basantpur Pachmo OCP, CCL

राजीब हुई / RAJIB HUI
परियोजना पदाधिकारी / PROJECT OFFICER
कोतरे बसंतपुर पंचमो कोल परियोजना
Kotre Basantpur Pachmo Coal Mine
सी०सी०एल०, रांची / C.C.L., Ranchi

कार्यालय, प्रधान मुख्य वन संरक्षक-सह-कार्यकारी निदेशक,
बंजर भूमि विकास बोर्ड, झारखण्ड, राँची।

वन भवन, झोरखंड, राँची, झारखंड, पिन-834002, Email-pecf-ednodal@gov.in

पत्रांक :-

राँची, दिनांक :-

सेवा में,

अपर मुख्य सचिव,
वन, पर्यावरण एवं जलवायु परिवर्तन विभाग,
झारखण्ड सरकार, राँची।

विषय :- सी0सी0एल0 के अमलो खुली खदान परियोजना हेतु 39.663 हे0 वनभूमि
अपयोजन का प्रस्ताव के संबंध में।

प्रसंग :-

1. भारत सरकार, पर्यावरण, वन एवं जलवायु परिवर्तन मंत्रालय, एकीकृत कार्यालय, राँची का पत्रांक FP/JH/MIN/25031/2017/4572 दिनांक 05.03.2021
2. भारत सरकार, पर्यावरण, वन एवं जलवायु परिवर्तन मंत्रालय, एकीकृत कार्यालय, राँची का पत्रांक FP/JH/MIN/25031/2017/4875 दिनांक 03.09.2021
3. क्षेत्रीय मुख्य वन संरक्षक, बोकारो का पत्रांक 1409 दिनांक 06.10.2021

महाशय,

उपर्युक्त विषयक भारत सरकार (एकीकृत क्षेत्रीय कार्यालय, राँची) के प्रासंगिक पत्र-2 द्वारा विषयगत वनभूमि अपयोजन प्रस्ताव में स्टेज- II की शर्त सं0 10 के संदर्भ में की गई पृच्छा का निराकरण क्षेत्रीय मुख्य वन संरक्षक, बोकारो के पत्रांक 1409 दिनांक 06.10.2021 (छायाप्रति संलग्न) द्वारा प्राप्त हुआ है।

पूर्व में इस कार्यालय के पत्रांक 674 दिनांक 10.06.2021 द्वारा स्टेज-II की शर्त सं0-10 के अनुपालन में प्रयोक्ता अभिकरण द्वारा बचनबद्धता के साथ सूचित किया गया था कि अपयोजित 222.324 हे0 में से Reclaimed 33.00 हे0 वनभूमि झारखण्ड सरकार को वापस नहीं किया जा सकता है, क्योंकि प्रस्तावित 33.00 हे0 Reclaimed वनभूमि का उपयोग AAD-Open Cast Mine में किया जाना प्रस्तावित है, जिसका कुल रकबा 364.32 हे0 होगा। इसके लिए अलग से प्रस्ताव समर्पित किया जायेगा।

झारखण्ड सरकार, वन, पर्यावरण एवं जलवायु परिवर्तन विभाग के पत्रांक 1962 दिनांक 19.07.2021 द्वारा विषयक परियोजना प्रस्ताव में स्टेज- II की स्वीकृति के शर्त सं0- 10 का अनुपालन नहीं करने का केन्द्र सरकार द्वारा प्रदत्त अन्तिम स्वीकृति पर क्या असर पड़ेगा, के संबंध में मंतव्य मांगी गई थी। इस संदर्भ में प्रयोक्ता अभिकरण द्वारा अनुपालन-सह-वचनबद्धता इस कार्यालय के पत्रांक 964 दिनांक 05.08.2021 द्वारा निम्नवत् समर्पित की गई थी :-

1. At the time of committing surrender of 33 ha land to forest department there was no proposal under consideration for expansion of AMLO Project.
2. Now expansion Plan of Amlo Project from 3.0 MTY to 5.0 MTY has come up whereby

राजीब हुई / RAJIB HUI
परियोजना पदाधिकारी / PROJECT OFFICER
कोतरे बसंतपुर पंचमो कोल परियोजना
Kotre Basantpur Pachmo Coal Mine
सी0सी0एल0, राँची / C.C.L., Ranchi

produce additional 150 L.Te coking coal from the project. For which following activities has been proposed this needs that the said land is required for mining purpose.

- i. Installation of belt conveyor for transporting of coal in environment friendly manner to reduce pollution by 90% and to comply the conditions laid down by MOC, Government of India.
 - ii. Joria Nallah diversion
 - iii. Phusro – Dumri Road diversion
 - iv. Dhori Railway siding shifting
3. It is submitted that this 33 ha land is already broken in the past and by using the same for above purpose will minimize pollution and no further virgin forest land for this purpose will be required.
 4. However user agency is committed to surrender 33.0 ha reclaimed land to state forest department, we only request reclaimed land to state forest department, we only request to allow us to defer the surrender of reclaimed and ecologically rehabilitated land.

This is to undertake that we will surrender reclaimed and ecologically rehabilitated land as per approved reclamation plan

By the end of 2024 – 12 ha

By the end of 2025 – 13 ha

By the end of 2026 – 8 ha

Total :- 33 ha

to comply the condition no. 10 of stage-II clearance.

भारत सरकार, पर्यावरण, वन एवं जलवायु परिवर्तन मंत्रालय, एकीकृत कार्यालय, राँची के पत्रांक FP/JH/MIN/25031/2017/4875 दिनांक 03.09.2021 द्वारा विषयगत अपयोजन प्रस्ताव के स्टेज-II की स्वीकृति की शर्त सं०-10 के संशोधन हेतु 06 बिन्दुओं पर पृच्छा की गई है।

भारत सरकार के उक्त पृच्छा के अनुपालन में क्षेत्रीय मुख्य वन संरक्षक, बोकारो के पत्रांक 1409 दिनांक 06.10.2021 द्वारा प्रतिवेदित किया गया है कि स्टेज-II की शर्त सं०-10 के संबंध में पूर्व में अपयोजित 222.324 हे० में से मौजा-ढोरी में अवस्थित कुल 33.00 हे० वनभूमि प्रयोक्ता अभिकरण द्वारा वन विभाग को हस्तान्तरण करते हुए DGPS Map, KML File समर्पित किया गया है। स्टेज-II की शर्त सं०-10 संशोधित अनुपालन निम्नवत् प्रतिवेदित है :-

Sl No.	Condition	Revised Compliance
1	2	3
1	शर्त संख्या-10 : As submitted by the User Agency, 33.00 ha. forest land (out of earlier diverted 222.324 ha. diverted forest land) which has been reclaimed, ecologically rehabilitated and no more required for mining, should be handed over to the State Forest Department and a report in this regard may be submitted in this office.	33.00 ha. Forest land has been reclaimed ecologically rehabilitated, outer periphery of which has been surveyed and demarcated on the ground by the pillars and has been handed over to Bokaro Forest Division. Details are given below :- Notified Forest : 15.40 Ha GMJ : 17.60 Ha Total : 33.00 Ha

परियोजना प्रबंधिका/PROJECT OFFICER
कोतरे बसंतपुर पचमो कोल परियोजना
Kotre Basantpur Pachmo Coal Mine
सी०सी०एल०, राँची/C.C.L., Ranchi

प्रयोक्ता अभिकरण ने उल्लेख किया है कि वर्तमान परिस्थितियों में अमलो विस्तारण परियोजना के क्रियान्वयन में विलम्ब है। साथ ही खदान परिचालन के लिए परियोजना के पास भूमि की कमी है, जिसके कारण अमलो परियोजना से कोयला उत्पादन बाधित हो जाने की सम्भावना है। फलस्वरूप प्रयोक्ता अभिकरण के प्रबंधक द्वारा शर्त सं०-10 का अनुपालन में पूर्व में अपयोजित 222.324 हे० में से मौजा-ढोरी में अवस्थित कुल 33 हे० reclaimed भूमि वन विभाग को हस्तान्तरण की गयी है।

अतः क्षेत्रीय मुख्य वन संरक्षक, बोकारो से प्राप्त अनुपालन प्रतिवेदन की तीन प्रतियाँ इस पत्र के साथ संलग्न करते हुए अनुरोध है कि विषयगत प्रस्ताव में वनभूमि विमुक्ति हेतु अग्रतर कार्रवाई करने की कृपा की जाय।

प्रस्ताव पर प्रधान मुख्य वन संरक्षक (HoFF), झारखण्ड, राँची का अनुमोदन प्राप्त है।

अनु०-यथोक्त।

विश्वासभाजन,

ह०/-

प्रधान मुख्य वन संरक्षक-सह-कार्यकारी निदेशक,
बंजर भूमि विकास बोर्ड, झारखण्ड, राँची।

ज्ञापांक- 1336

दिनांक- 28/10/2024

प्रतिलिपि :- वन संरक्षक, प्रादेशिक अंचल, बोकारो/वन प्रमण्डल पदाधिकारी, बोकारो वन प्रमण्डल, बोकारो/मुख्य महाप्रबंधक (पर्यावरण एवं वन), सी०सी०एल०, दरभंगा हाउस, राँची को सूचनार्थ एवं आवश्यक कार्रवाई हेतु प्रेषित।

प्रधान मुख्य वन संरक्षक-सह-कार्यकारी निदेशक,
बंजर भूमि विकास बोर्ड, झारखण्ड, राँची।

28-10

राजीब हुई / RAJIB HUI
परियोजना पदाधिकारी / PROJECT OFFICER
कोतरे बसंतपुर पंचमो कोल परियोजना
Kotre Basantpur Pachmo Coal Mine
सी०सी०एल०, राँची / C.C.L., Ranchi

कार्यालय :- वन प्रमण्डल पदाधिकारी, बोकारो वन प्रमण्डल, बोकारो।

BLOCK-A, VAN BHAWAN, PURULIA ROAD, CHAS, BOKARO-827013

E-mail : dfo-bokaro@gov.in & bokaro.dfo@gmail.com

Phone/Fax No : 91-91-67125143

सहायक वन संचालक
बोकारो वन प्रमण्डल, बोकारो।

वन प्रमण्डल पदाधिकारी,
बोकारो वन प्रमण्डल, बोकारो।

विषय :- मेसर्स सी०सी०एल०, चार्ली रोड सी०सी०एल० 33.63 हे० वनभूमि सम्पोजन के अंतिम स्वीकृति के शर्त स०-10 के अनुपालन के संबंध में।

प्राप्त :- माध्यम पत्रांक-2737 दिनांक-27.09.2021 एवं भारत सरकार, पर्यावरण एवं वन विभाग, पर्यावरण संरक्षण का क्षेत्रीय कार्यालय (पूर्व भवन क्षेत्र) का पत्रांक-NO.FP/JH/MIN/25031/2017/3473 दिनांक-24.09.2019

उपरोक्त प्रस्तावधीन विषय के आलेख में सूचित करना है कि विषयगत परियोजना के अंतर्गत चार्ली रोड सी०सी०एल० के आलेख में उपयोगिता 222324 हे० में से भूभाग-100 हे० वनभूमि का अधिभूत वन क्षेत्र वन प्रमण्डल एवं वन संचालक के अधिकार क्षेत्र में है।

क्र.सं.	भूभाग/आकार	प्लॉट नं०	क्षेत्र (है०)	भूमि का प्रकार
1	चरनी-68	3020	12.80	अधिभूत वन भूमि
		3021	2.59	
		कुल-	15.40	
2	चरनी-68	3020	12.337	गैर गन्तव्य क्षेत्र जंगल भूमि
		3021	5.263	
		कुल-	17.60	

सारांश

अधिभूत वनभूमि- 15.40 हे०

गैर गन्तव्य क्षेत्र जंगल भूमि- 17.60 हे०

कुल- 33.00 हे०

पत्रांक में सम्मिलित पदाधिकारियों का हस्ताक्षर-

परियोजना पदाधिकारी	परिचालक	परिचालक	परिचालक

राजीब हुई / RAJIB HUI
परियोजना पदाधिकारी / PROJECT OFFICER
कोतरे बसंतपुर पंचमो कोल परियोजना
Kotre Basantpur Pachmo Coal Mine
सी०सी०एल०, राँची / C.C.L., Ranchi



सेन्ट्रल कोलफील्ड्स लिमिटेड
विस्तारित कोनार खुली परियोजना
(अमलगमेटेड घासमहुल एवं कोनार खुली परियोजना)
बोकारो एवं करगली क्षेत्र

कुरपनिया, संडे बाजार, बोकारो - 829127

Ref. No.: FO/ARK OCP/FC 288.26/2022/914



Dated: 24.05.2022

To
The Divisional Forest Officer
Bokaro Forest Division
Chas, Bokaro, Jharkhand

Sub: Annual Compliance Report of Stage II Forest Clearance for the diversion
of 288.26 Ha forest land for Konar OCP, CCL

Dear Sir

Enclosed, please find herewith point wise Annual Compliance Report of Stage II Forest Clearance granted by Ministry of Environment, Forest & Climate Change (MoEFCC) vide F No. 8-55/2009-FC dated 23.10.2012 for the diversion of 288.26 Ha forest land for Konar OCP, B&K Area, Central Coalfields Limited.

This is for your kind information and needful, please,

R-h
24/05/2022
Project Officer
Konar Expansion OCP
B&K Area, CCL
Project Officer
Konar Expansion
(B&K)

Enclosures:

1. Eight Copies of Annual Compliance with annexures (15 pages each)



Copy to

1. The HOD (E&F), CCL HQ, Ranchi - for kind information
2. The Staff Officer (Project & Planning), B&K Area, CCL
3. Office Copy

R
राजीब हुई / RAJIB HUI
परियोजना पदाधिकारी / PROJECT OFFICER
कोतरे बसंतपुर पंचमो कोल परियोजना
Kotre Basantpur Pachmo Coal Mine
सी०सी०एल०, राँची / C.C.L., Ranchi

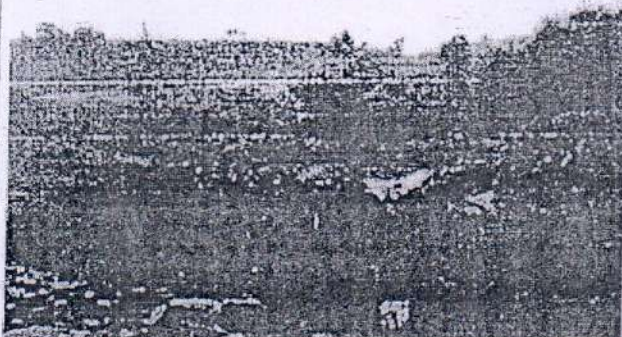
**POINT WISE COMPLIANCE OF STAGE-II CONDITION GRANTED BY
MOEF VIDE NO- 8-55/2009-FC DATED 23/10/2012 OF KONAR OCP FOR
DIVERSION OF 288.26 Ha FOREST LAND**

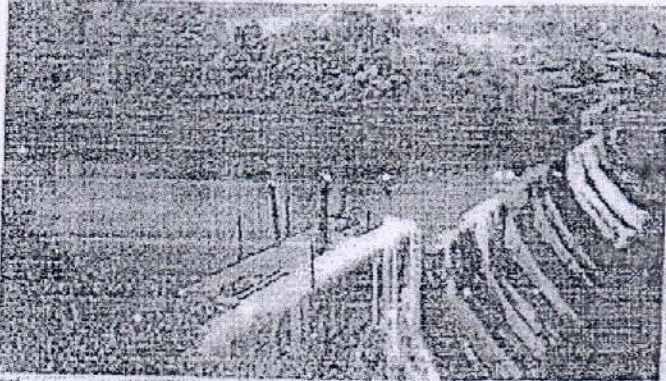
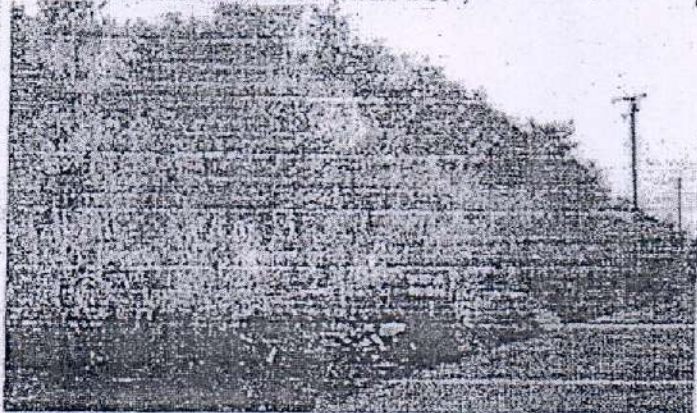
Sl. No	Conditions given by MoEF	Point wise compliance status / ATR																												
1	Legal status of the diverted forest land shall remain unchanged	It is noted that legal status of Forest land will remain unchanged. It is acquired under S.O. No 3154 dt.10.08.1976																												
2	The Compensatory afforestation over double degraded forest land shall be raised and maintained by the State forest department at the project cost.	A total payment of Rs. 26,62,93,877.00 has already been deposited to DFO Bokaro vide letter no 1175 dated 08/06/2010 and Draft no 361150 dated 31/05/2010 in which Compensatory afforestation amount Rs 3,30,64,985.00 is included. Additional CA amount Rs 2,54,70,19.500 by RTGS UTRno-SBINH13183369050 dt-02/07/2013Annexure -A																												
3	The following activities shall be undertaken by the user agency under the supervision of the State forest Department at the project cost.	Activities Followed as below--																												
	(i) Proper mitigative measures to minimise soil erosion and choking the stream shall be prepared and implemented.	<p>Sedimentation pond and check dam constructed and Toe wall erected. (Cost incurred =Rs 2.64+4.50+2.19 lakhs)</p>  <p>Fig. 1: Sedimentation pond at KONAR EXPANSION OCP</p>																												
	(ii) Planting of adequate draught hardy plant species and sowing of seeds to arrest soil erosion.	<p>Planting of draught hardy plant species and sowing of seeds have been done to arrest soil erosion.</p> <table border="1"> <thead> <tr> <th>Year</th><th>Plantation area (in ha)</th><th>Location covered</th><th>Planation (mode)</th></tr> </thead> <tbody> <tr> <td>2017</td><td>3.25 ha</td><td>Road Side, Mobile Crusher etc.</td><td>Through Hazaribag East Forest Division</td></tr> <tr> <td>2109</td><td>4.85 ha</td><td>3 tier plantation at top soil preservation site, surface and OB dump slope of about 4.85 ha</td><td>Department</td></tr> <tr> <td>2109</td><td>0.15 ha</td><td>view point</td><td>Department</td></tr> <tr> <td>2019</td><td>0.36 ha</td><td>Near Project Office</td><td>Department</td></tr> <tr> <td>2020</td><td>2.5 Ha</td><td>OBD (Seed Ball)</td><td>Outsourced</td></tr> <tr> <td>2021</td><td>17.0 Ha</td><td>42800 plants</td><td>Through Hazaribag East Forest Division</td></tr> </tbody> </table> <p>i. 1300 gabion plantation have been done during 2017 monsoon covering an expenditure of Rs 2.48 lakhs</p>	Year	Plantation area (in ha)	Location covered	Planation (mode)	2017	3.25 ha	Road Side, Mobile Crusher etc.	Through Hazaribag East Forest Division	2109	4.85 ha	3 tier plantation at top soil preservation site, surface and OB dump slope of about 4.85 ha	Department	2109	0.15 ha	view point	Department	2019	0.36 ha	Near Project Office	Department	2020	2.5 Ha	OBD (Seed Ball)	Outsourced	2021	17.0 Ha	42800 plants	Through Hazaribag East Forest Division
Year	Plantation area (in ha)	Location covered	Planation (mode)																											
2017	3.25 ha	Road Side, Mobile Crusher etc.	Through Hazaribag East Forest Division																											
2109	4.85 ha	3 tier plantation at top soil preservation site, surface and OB dump slope of about 4.85 ha	Department																											
2109	0.15 ha	view point	Department																											
2019	0.36 ha	Near Project Office	Department																											
2020	2.5 Ha	OBD (Seed Ball)	Outsourced																											
2021	17.0 Ha	42800 plants	Through Hazaribag East Forest Division																											

	ii.	Plantation (42800 plants) has been done in 17.12 Ha of land in monsoon 2021 through Forest department only.
(iii)	Construction of check dam, retention Toe walls to arrest sliding down of the excavated material along the contour.	<p>Check dam and Retention wall, toe wall constructed.</p>  <p>Fig.2 : Check dam constructed near Kharsinhal Rest House by KONAR EXPANSION OCP (AKK OCP)</p>  <p>Figure 3a : Toe Wall / Retaining wall constructed to arrest soil erosion / rolling of over burden material</p>  <p>Figure 3b: Close view of Toe Wall / Retaining wall constructed to arrest soil erosion / rolling of over burden material</p>
(iv)	The area shall be reclaimed keeping in view the international practice of stabilizing the dumps by grading, benching so that angle of repose normally less than 28 at any given place) are maintained.	Dump slope stability has been carried out. The OB dump is being benched so as to maintain overall slope angle at angle of repose or 28 degree, whichever is lesser.
(v)	The top soil management plan should be strictly adhered to.	The top soil is being preserved at a demarcated site,

Project Officer
Konar Expansion OCP
(B&K) Area, CCL

राजीव हुई / RAJIB HUI
परियोजना पदाधिकारी / PROJECT OFFICER
कोतरे-बसंतपुर पंचमो कोल परियोजना
Kotre Basantpur Pachmo Coal Mine
सी०सी०एल०, राँची / C.C.L., Ranchi

Whereas possible and technical feasible, the user agency shall under take afforestation measures in the blanks within the lease area diverted under this approval, in consultation with the State Forest Department at the project cost.

Wherever possible and technically feasible, afforestation is being done. Details of afforestation done in recent years are described in point 3(ii)

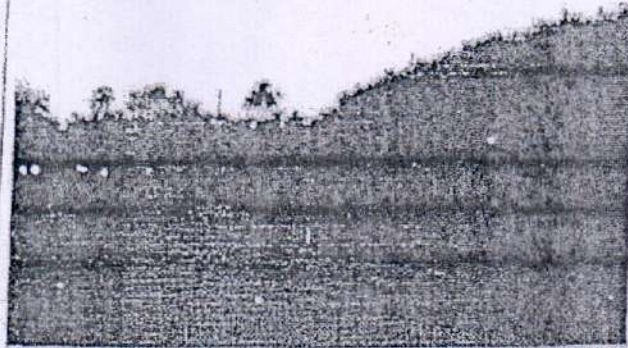

Figure 4: Plantation done in monsoon 2017 in 3.25 ha along 01 Km road side and around mobile crusher.

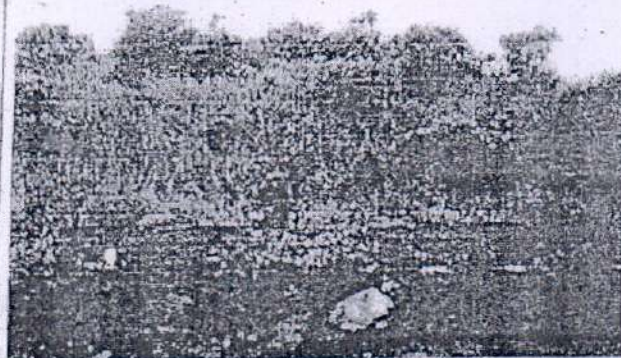

Figure 5 : A 3-tier plantation at top soil preservation site, surface and OB dump slope of about 4.85 ha has been done

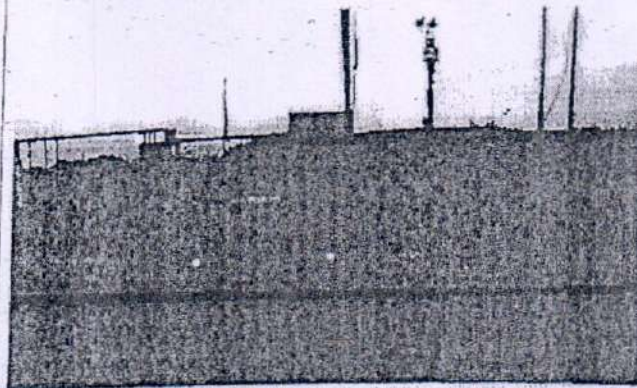

Figure 6 : Plantation near view point done in 0.015 ha area

[Signature]
Project Officer
Kotre Basantpur Pachmo Coal Mine
(B.M.C.) Ranchi, Jharkhand

[Signature]
राजीव हुई / RAJIB HUI
परियोजना पदाधिकारी / PROJECT OFFICER
कोतरे बसंतपुर पंचमो कोल परियोजना
Kotre Basantpur Pachmo Coal Mine
सी०सी०एल०, राँची / C.C.L., Ranchi

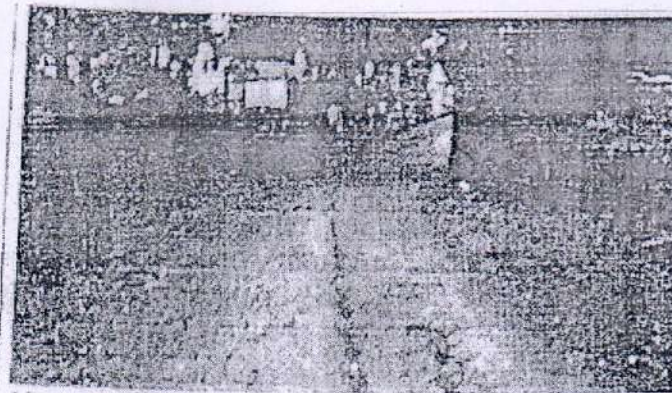

Figure 7: Plantation in about 0.036 Ha is also done recently around PO office to increase greenery in this monsoon 2019.

Plantation (42800 plants) has been done in 17.12 Ha of land in monsoon 2021 through Forest department only.

5	The period of diversion of under this approval shall be of 20 years subject to possession of valid lead by user agency under the MMDR Act 1957	Noted and Agreed, however the land has been acquired under CBA (AD) Act 1957 in which mining lease under the MMDR Act 1957 is not required. In this regard, a letter dated 24/08/2006 from ministry of Mines and Geology, Govt. Of Jharkhand to the Ministry of forest & Environment Govt. of Jharkhand is enclosed for ready reference.	
6	The user agency shall pay the additional NPV, if so determined, as per the final decision of the honourable Supreme Court of India	NPV paid (Rs)	23,14,72,780.00
		DD no	361150 dt 31.05.2010
		CCL will pay the additional NPV, if so determined, as per the final decision of the honourable Supreme Court of India.	
7	The forest land should not be used for any purpose other than that specified in the proposal.	CCL undertakes that the forest land will not be used for any purpose other than that specified in the proposal.	
8	Any tree felling shall be done only when it is unavoidable under strict supervision of the State Forest Department.	CCL undertakes that any tree felling will be done only when it is unavoidable under supervision of the Forest Department.	
9	No damage to the flora and fauna of the area shall be caused.	CCL undertakes that no damage to the flora and fauna of the area other than the diverted area shall be caused.	
10	No labour camp shall be set up inside the forest area.	CCL undertakes that no labour camp will be set up inside that subject forest area.	
11	The user agency will make arrangement for free supply of coal to labourers and staff working on the project site, so as to avoid any pressure on the adjacent forest area.	CCL provides free LPG instead of coal to the labours and staff working on the project site so as to avoid any pressure on the adjacent forest area.	
12	The user agency will implement the R&R Plan as per the R&R Policy of the state Govt., which should be consonant with the National R&R after obtaining approval from the Ministry of Tribal affairs.	R&R policy of Coal India Ltd. Based on R&R policy of Ministry of Rural Development, Govt. Of India already approved by Ministry of Coal, Govt. of India is already in practice.	
13	The user agency will surrender equal extent of area duly reclaimed and afforested from the already diverted area.	Out of 288.26 ha land, it is in process to surrender 267.75 ha to DFO, Bokaro. DGPS/KML files have been submitted to DFO, Bokaro vide Letter no. PO/AKKOCP/2021/5857 dt 22/03/2021. The land details are as follows:	
		Location	Area in Ha

Project Officer
Korba Expansion GCP
(B&K) Area, CCL

राजीव हुई / RAJIB HUI
परियोजना पदाधिकारी / PROJECT OFFICER
कोठरे बसंतपुर पंचमो कोल परियोजना
Kotre Basantpur Pachmo Coal Mine
सी०सी०एल०, राँची / C.C.L., Ranchi

		Scheduled Project New Scheduled District (N.S.D.) Kono Project Koppa Project K. I. I. C. P. K. I. I. C. P. Total	10.00 ha 47.11 ha 1.00 ha 1.11 ha 10.00 ha 79.22 ha
14	Any other condition that Addl. Principal Chief Conservator of Forest (Central) Regional office, Bhubaneswar, may impose from time to time in the interest of conservation, Protection and improvement and Development of the Forest	C.C.L. undertakes to follow any other condition that Addl. Principal Chief Conservator of Forest (central) Regional office, Bhubaneswar, may impose from time to time in the interest of conservation, Protection and improvement and Development of the Forest.	
15	The user agency shall submit the annual compliance to the State Govt. And to the Regional office Bhubaneswar regularly.	Annual compliance submitted last time vide PD/AR/KCOT/2021/8074 dt. 23.01.2021	

24/01/2022
 Project Officer -
 Kono Expansion OCP
 Project Officer
 Kono Expansion OCP
 (B&K) Area, CCI

राजीब हुई / RAJIB HUI
 परियोजना पदाधिकारी / PROJECT OFFICER
 कोतरे बसंतपुर पंचमो कोल परियोजना
 Kotre Basantpur Pachmo Coal Mine
 सी०सी०एल०, राँची / C.C.L., Ranchi

ANNEXURE - IC

LAND SUITABILITY CERTIFICATE BY DFO GIRIDIH EAST FOREST DIVISION

This to certify that 2019 ha. Forest Land of Giridih East Forest Division identified for Compensatory Afforestation in lieu of proposed diversion of forest land measuring area of 633.19 ha. in Ramgarh Forest Division & 372.98 ha. Forest Land of Bokaro Forest Division for C.C.L. Kotre Basantpur, Pachmo Open Cast Project is found suitable for Compensatory Afforestation from management point of view. The details of forest land identified for Compensatory Afforestation is as below:-

Sl. No.	Site Name	Thana & Thana No.	Plot No.	Area in Ha.
1	2	3	4	5
1	NONIATARI	DEORI-55	78, 110	22.00
2	SUJA	GAWAN-315	2, 8, 10, 11, 12	50.00
3	BENDRO	GAWAN-230	2, 263, 337	56.79
4	KANIKEND	GAWAN-183	4, 7, 19, 12	20.00
5	MACHANIYA	GAWAN-169	1, 6, 18, 20, 21, 23	52.58
6	SONRE	DEORI-53	1, 310, 356, 363	47.32
7	GUMGI	TISRI-166	655, 656, 567, 658, 659, 660, 671, 672, 673, 676, 678, 679, 680, 681, 674, 682, 684, 685, 686, 689, 923, 924, 925, 926, 927, 928	181.49
8	RANGAMATI	GAWAN-212	333, 349, 362, 363, 366	48.00
9	GARHATANAR	GAWAN-14	2, 3, 4, 12, 17, 18, 19, 20, 24, 25, 138, 139, 154	140.63
10	BARAPAHRI	PIRTAND-40	1, 26, 106, 162, 352, 503, 611, 624	71.75
11	PATHRIJOR	PIRTAND-31	1, 3, 188, 391, 204, 208	29.11
12	RAJUDIH	PIRTAND-53	517, 614, 615, 617, 626	35.00
13	DUMARIAKHALAR	PIRTAND-30	1, 31, 39, 41, 44, 50, 181, 182, 295	40.30
14	BARAI	BIRNI-146	300, 511, 597, 598	29.36
15	GORCHANCHO	PIRTAND-25	1, 214, 215, 293	39.55
16	KUMAHARLAO	PIRTAND-21	30, 40, 50, 108, 118	50.00
17	BARDHI	PIRTAND-56	1, 14, 15, 27, 130, 132, 457, 642, 643	120.07
18	PIPRADIH	BIRNI-114	2, 4, 64, 363, 504, 514, 518, 530	80.00
19	MAJHALDIH	BIRNI-106	636, 720, 739, 779, 786	35.83
20	MANDANUTAND	BENGABAD-127	7, 29, 33	23.93
21	BADIABAD	BENGABAD-04	743, 744, 745	38.00
22	CHINARES	BENGABAD-117	22, 698, 816, 820	16.00
23	KARGALO	BENGABAD-13G	20	23.15
24	QJHADIH	BENGABAD-11G	6, 40, 62, 65, 93, 339, 382, 384, 391, 994, 1014, 1020, 1091, 873, 1042	206.33
25	MOHANIAPAHARI	BENGABAD-123	6, 164, 169, 175, 178, 179, 181, 184, 192	184.21
26	DONGO	BENGABAD-42	34, 343, 344	44.85
27	BAJNATHPUR	BENGABAD-337	2, 5	24.44

राजीव हुई
परियोजना पदाधिका
कोतरे बसंतपुर पंच
Kotre Basantpur Pachmo Coal Mine
सी.सी.एल., राँची/C.C.L., Ranchi

B HUI
ECT OFFICER
परियोजना



Sl. No.	Site Name	Thana & Thana No.	Plot No.	Area in Ha.
1	2	3	4	5
28	MOHANPUR	GANDEY-440	116, 178, 213, 138, 219	15.64
29	SHAHARPURA	BENGABAD-5G	1, 2, 3, 4, 386	37.00
30	TINPATLI	GANDEY-485	2, 16, 104, 111, 144, 146, 233, 235, 252	30.58
31	TILABONA	GANDEY-551	1, 11, 15, 161, 162, 163, 168, 232	57.30
32	AHLEYADUR	GANDEY-548	3086, 3849, 3003, 3835, 3806, 3813, 3019, 3079, 3897, 3847, 2889	60.00
33	JABARDAHA	GANDEY-566	351, 570, 371, 378, 498	18.52
34	KHUDDISAR	DUMRI-12	181, 2, 3, 4, 5, 6, 7	33.75
35	GULIDARI	DUMRI-13	162	55.52
TOTAL:-				2019.00



[Signature] 29/3/21
 Divisional Forest Officer,
 Giridih East Forest Division.

[Signature] 29/3/21

[Signature]

जीब हुर्र / RAJIB HUI
 परियोजना अधिकारी / PROJECT OFFICER
 कोतरे बसंतपुर पश्चिमी कोल परियोजना
 Kotre Basantpur Pachmo Coal Mine
 सी०सी०एल०, राँची / C.C.L., Ranchi

Scale:- 16"=1Mile or 1:3960

Painki

मशहूर नाम पैकी चादरनाम्बर १९
थाना नम्बर १४८
थाना मान्डू
परगना जगोसर
जिला हज़ारिवाड़ा
पैमाना बहिमाब की मोक ५९ ईन्च
सन १८७५-७६ ईस्वी

नाम	नाम ज्ञ म ज्ञ ह
२६	} संत व्यापाराला
२२२	

200 copies
1417199

चापरा

Made and Published Under The Authority of Government.

Scale 10 inches = 1 mile

रखता

रुता

Painki

मशहूर नाम पैकी चादर नामवर
थाना नम्बर १४ ई
थाना मान्डू
परगनः जगोसर
जिला हजारीबाग
पैमात्रावहिसाब की मीन १९ ई
सन १८०६-१० ईस्वी

Scale 16" = 1 mile or 1:3960

Made and Published Under The Authority of Government.









Seed 16 July 1972.

कैथा
थानारामगढ़
परगनःचैनगड़ा

GEO CO-ORDINATES OF FOREST PATCH

CORNER POINT	LATITUDE	LONGITUDE	FOREST PATCH
1	23° 39' 53.46" N	85° 32' 22.07" E	PATCH-A
2	23° 39' 52.63" N	85° 32' 26.73" E	PATCH-A
3	23° 39' 49.55" N	85° 32' 28.89" E	PATCH-A
4	23° 39' 44.42" N	85° 32' 30.41" E	PATCH-A
5	23° 39' 42.00" N	85° 32' 32.69" E	PATCH-A
6	23° 39' 40.64" N	85° 32' 37.55" E	PATCH-A
7	23° 39' 38.09" N	85° 32' 37.44" E	PATCH-A
8	23° 39' 36.54" N	85° 32' 41.89" E	PATCH-A
9	23° 39' 32.41" N	85° 32' 41.21" E	PATCH-A
10	23° 39' 31.74" N	85° 32' 40.75" E	PATCH-A
11	23° 39' 35.08" N	85° 32' 35.52" E	PATCH-A
12	23° 39' 39.85" N	85° 32' 29.23" E	PATCH-A
13	23° 39' 44.45" N	85° 32' 28.99" E	PATCH-A
14	23° 39' 47.12" N	85° 32' 28.96" E	PATCH-A
15	23° 39' 48.63" N	85° 32' 27.85" E	PATCH-A
16	23° 39' 49.55" N	85° 32' 23.06" E	PATCH-A
17	23° 39' 50.53" N	85° 32' 19.51" E	PATCH-A
18	23° 39' 36.90" N	85° 32' 29.83" E	PATCH-B
19	23° 39' 33.53" N	85° 32' 34.23" E	PATCH-B
20	23° 39' 30.93" N	85° 32' 38.20" E	PATCH-B
21	23° 39' 30.08" N	85° 32' 39.66" E	PATCH-B
22	23° 39' 29.54" N	85° 32' 39.27" E	PATCH-B
23	23° 39' 27.16" N	85° 32' 39.07" E	PATCH-B
24	23° 39' 26.62" N	85° 32' 36.81" E	PATCH-B
25	23° 39' 23.73" N	85° 32' 37.91" E	PATCH-B
26	23° 39' 23.67" N	85° 32' 40.86" E	PATCH-B
27	23° 39' 20.48" N	85° 32' 40.32" E	PATCH-B
28	23° 39' 20.38" N	85° 32' 39.29" E	PATCH-B
29	23° 39' 21.66" N	85° 32' 38.51" E	PATCH-B
30	23° 39' 21.18" N	85° 32' 34.06" E	PATCH-B
31	23° 39' 22.76" N	85° 32' 34.35" E	PATCH-B
32	23° 39' 25.28" N	85° 32' 32.83" E	PATCH-B
33	23° 39' 26.70" N	85° 32' 31.87" E	PATCH-B
34	23° 39' 28.11" N	85° 32' 30.88" E	PATCH-B
35	23° 39' 29.90" N	85° 32' 30.74" E	PATCH-B
36	23° 39' 32.07" N	85° 32' 30.12" E	PATCH-B
37	23° 39' 35.45" N	85° 32' 29.81" E	PATCH-B

LEGEND

NET AREA BOUNDARY	
GROSS AREA BOUNDARY	
CORNER POINTS	
C.A. PATCH	
FOREST TRENCH	
NATIONAL HIGHWAY	
VILLAGE ROAD	
NH LAND BOUNDARY 100'	

Customer		KBP MINING PRIVATE LIMITED				
Project		Preparation of DGPS Survey Map Superimposed on Village Sheet of Proposed CA Land (16.0 Ha) in Village - Painki				
Subject	DIVISION - RAMGARH RANGE - KUUJU VILLAGE - PAINKI THANA NO - 149	Activity	Name	Designation	Signature	Date
	NET AREA - 16.00 HA, SAFETY ZONE- 10.58 HA.	Surveyed By	Nursanj Kumar	Surveyor		
		Checked By	Srihar Dev Singh	Sr. Surveyor KBP		
		Approved By	Y. R. Reddy	G.M Mining KBP		
M/S NAMAN ENTERPRISES ASHOK NAGAR, RANCHI		Scale - 1 : 14000				
		Drawing No. - PAN/30/22/1-1				

राजीव हुई / RAJIB HUI
प्रोजेक्ट पदाधिकारी, PROJECT OFFICER
गोरे बरसतपुर पवन कोयल परियोजना
Gore Barasatpur Pawan Coal Mine
रांची, जमशेदपुर, झारखण्ड, India, Ranchi

TOPO LOCATION MAP SHOWING PLANTATION (CA LAND) PROPOSED FOR
SAFETY ZONE OF KOTRE BASANTHPUR PACHMO O.C. PROJECT

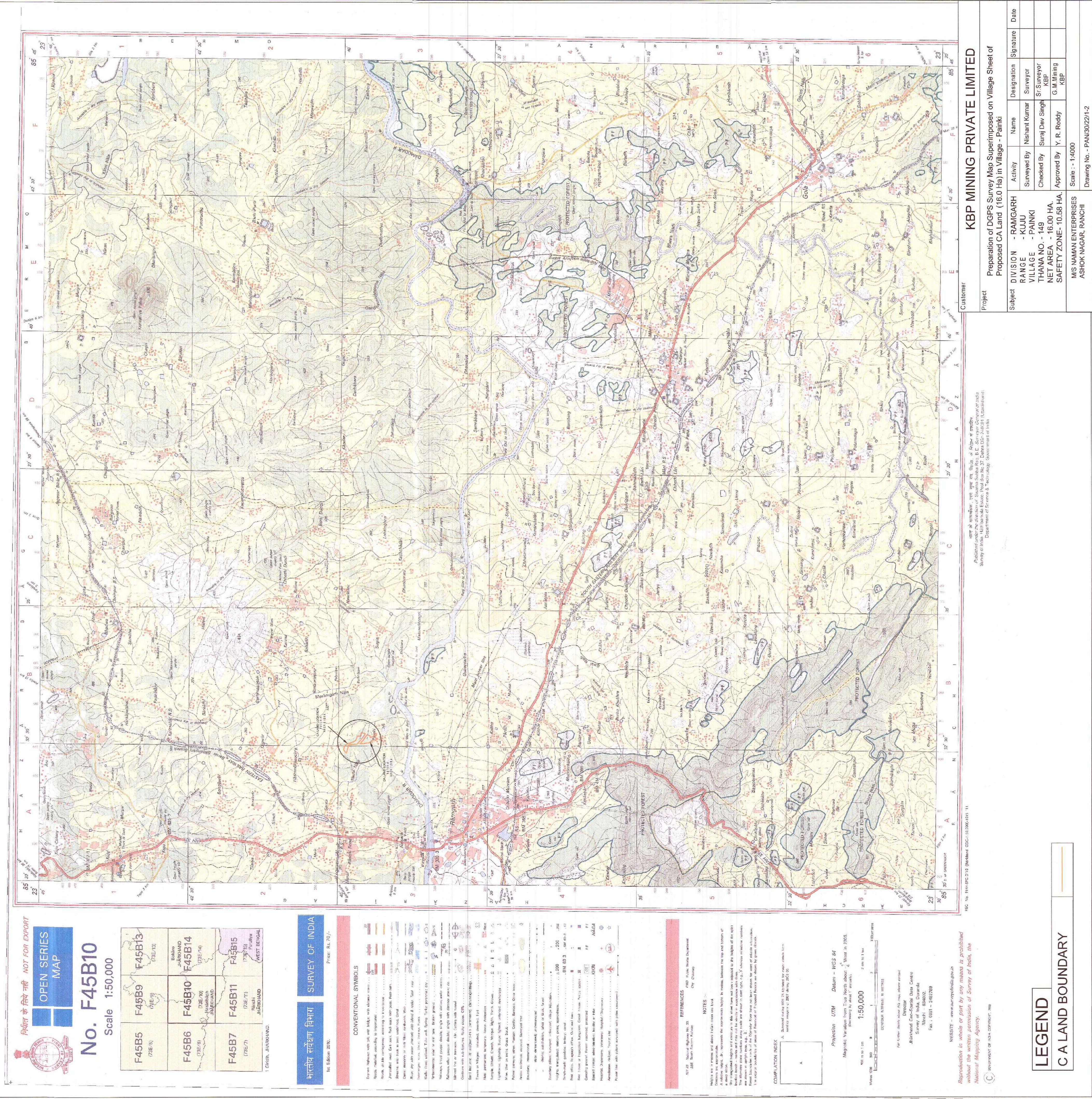

कार्यालय प्रधान मुख्य वन संरक्षक वन्यप्राणी
एवं मुख्य वन्यप्राणी प्रतिपालक झारखण्ड
वन भवन झोरण्डा राँची



पत्रांक : 391

रांची दिनांक: 16/3/22

प्रधान मुख्य वन संरक्षक-सह-कार्यकारी निदेशक,
बंजर भूमि विकास बोर्ड,
झारखण्ड, राँची।

विषय:-

1. मेसर्स सी0सी0एल0 की कोतरे बसन्तपुर पचमो कोल माइन्स परियोजना हेतु रामगढ़ वन प्रमण्डल अंतर्गत 633.19 हे0 वनभूमि अपयोजन प्रस्ताव के संबंध में।
2. मेसर्स सी0सी0एल0 की कोतरे बसन्तपुर पचमो कोल माइन्स परियोजना हेतु बोकारो वन प्रमण्डल अंतर्गत 372.98 हे0 वनभूमि अपयोजन प्रस्ताव के संबंध में।

प्रसंग:- आपका ज्ञापक 231 दिनांक 09.03.2022 एवं ज्ञापक 232 दिनांक 09.03.2022।

महाशय,

उपर्युक्त प्रासंगिक विषयक पत्रों के संदर्भ में वन्यप्राणी संरक्षण के दृष्टिकोण से अधोहस्ताक्षरी का मंतव्य निम्नवत है:-

- 1) The above refereed subject matter Kotre, Basantpur and Pachmo coal mining project proposals of M/s Central Coal Field (CCL) limited contains proposals for Forest land diversions in a linked extended forest areas of Kotre, Basantpur, Pachanda, Hurdag, Rahwan, Baghraiya, Purnapani, and Pachmo forests that includes of 633.19 Hectare in Ramgarh Forest Division and of 372.98 Hectare in Bokaro Forest Division and therefore from the wildlife conservation point of view an integrated Site Specific Wildlife Conservation Plan on a landscape level containing the area as a whole unit is recommended with a view expressed in the following paragraphs:-
- 2) The likelihood impact of the mining on ecology, and the flora & fauna within and adjoining areas of the mining projects in question are expected to be assessed through subject matter expert/s by the user agency. This may be done through collection of data on flora and fauna in the landscape areas; taking the context of the list of threatened plant species endemic to region of Jharkhand by Botanical Survey of India; and of the list of faunal endangered species of Jharkhand by Zoological Survey of India (ZSI)- (RAJYA SABHA question no 1662 of Shri Parimal Nathwani answered on 09.05.2016 by Shri Prakash Javadekar MoS, MoEF&CC, Gol); in order that scientific data are verified for monitoring and taking appropriate decision for prevention and mitigation measures for ecology in and around the proposed mining area.
- 3) The forest areas of Kotre, Basantpur, Pachanda, Hurdag, Rahwan, Baghraiya, Purnapani, and Pachmo and nearby forests have intensive coal mines areas spread from South-west to the South-East e.g. the CCL coal mines of Tapin mines, Parej mines, Tata's west Bokaro mines Ghatotand, Kedla OCP, Jharkhand OCP etc. In view of this scenario of elephant movement

राजीब हुई / RAJIB HUI

परियोजना पदाधिकारी / PROJECT OFFICER

कोतरे बसन्तपुर पचमो कोल परियोजना

Kotre Basantpur Pachmo Coal Mine

सी0सी0एल0, राँची / C.C.L., Ranchi

P.T.O.

243

zones have already got restricted due to severe fragmentation of the wildlife habitats around the project area. And elephant population spreading into new areas in Jharkhand –now found in atleast 29 forest divisions of Jharkhand including that of Ramgarh & Bokaro, and thereby expansion of the conflict zones of Human- Elephant conflict incidences in Jharkhand (Ref: Strategic Action Plan for East-Central Indian Region for Conservation of Elephant with special emphasis on Human-Elephant conflict, MoEF&CC Govt Project Elephant Division F.No. 7-5/2000-PE (Pt.) dated 6th May 2019).

- 4) Hence special emphasis from user agency will also be needed to restrict the conflict zone. This may be done by dedicated support from user agency by supporting and promoting Human-Elephant Co-existence Zone for taking welfare of elephants as well as human in the vicinities of the project areas through wildlife mitigation measures like promoting community crop guarding supported by watchtowers (Assam) & "Gajabandhu" of Odisha, providing safe bins or community pucca godowns for storing food grains (Odisha Practice Khani-dhaan), establishing pre-alert system in the area sharing the location of elephant herds and lone bulls, street lights in the villages, suitable over/underpasses on elephant path obstructions to be identified as project builds up, or keeping secure free habitat for elephant movement with bamboos and other preferred plants by elephants, with sufficient water provision.
- 5) In view of above, and the refereed subject matters being related to Open Cast Coal Mining, the user agency should get prepared, with the help of subject matter specialists, within and in 10 km circumference of the Project proposal area; an "Integrated Site Specific Wildlife Conservation, Management and Mitigation Plan"; keeping exclusive strategic action plan chapter for managing elephants, and Human-Elephant Co-existence Zone; and a chapter on the plan area data collection on threatened plant species endemic to region of Jharkhand & faunal endangered species, and the prevention and mitigation measures for ecology within and adjoining areas of the proposed mining project areas, at the Project Cost; and in close consultations with and the directions of the Divisional forest officers of Ramgarh Forest Division, Bokaro Forest Division, and Conservator of Forests Bokaro. A time bound implementation of the prepared wildlife conservation plan shall be done.
- 6) The user agency shall take will adequate measures to ensure that the prospecting activities do not harm the wildlife in the area.

सूचनार्थ एवं आवश्यक कारवाई हेतु प्रेषित ।

विश्वसभाजन

प्रधान मुख्य वन संरक्षक, वन्यप्राणी
एवं मुख्य वन्यप्राणी प्रतिपालक, झारखण्ड

राजीव हुई / RAJIB HUI
परियोजना पदाधिकारी / PROJECT OFFICER
कोलारे बसंतपुर पंचमो कोल परियोजना
Kolar Basantpur Pachmo Coal Mine
कोलारे, राँची / C.C.L., Ranchi

mark

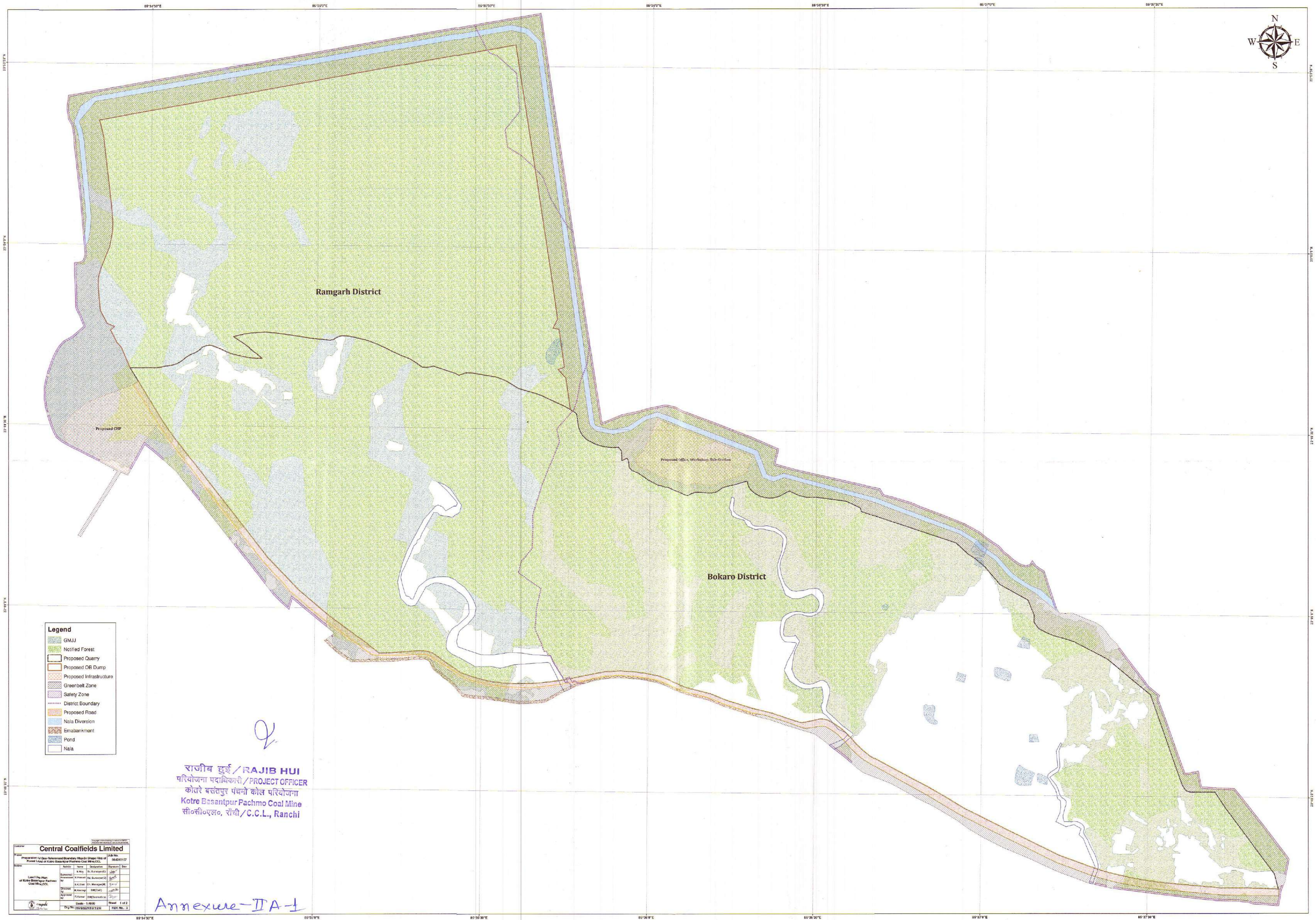

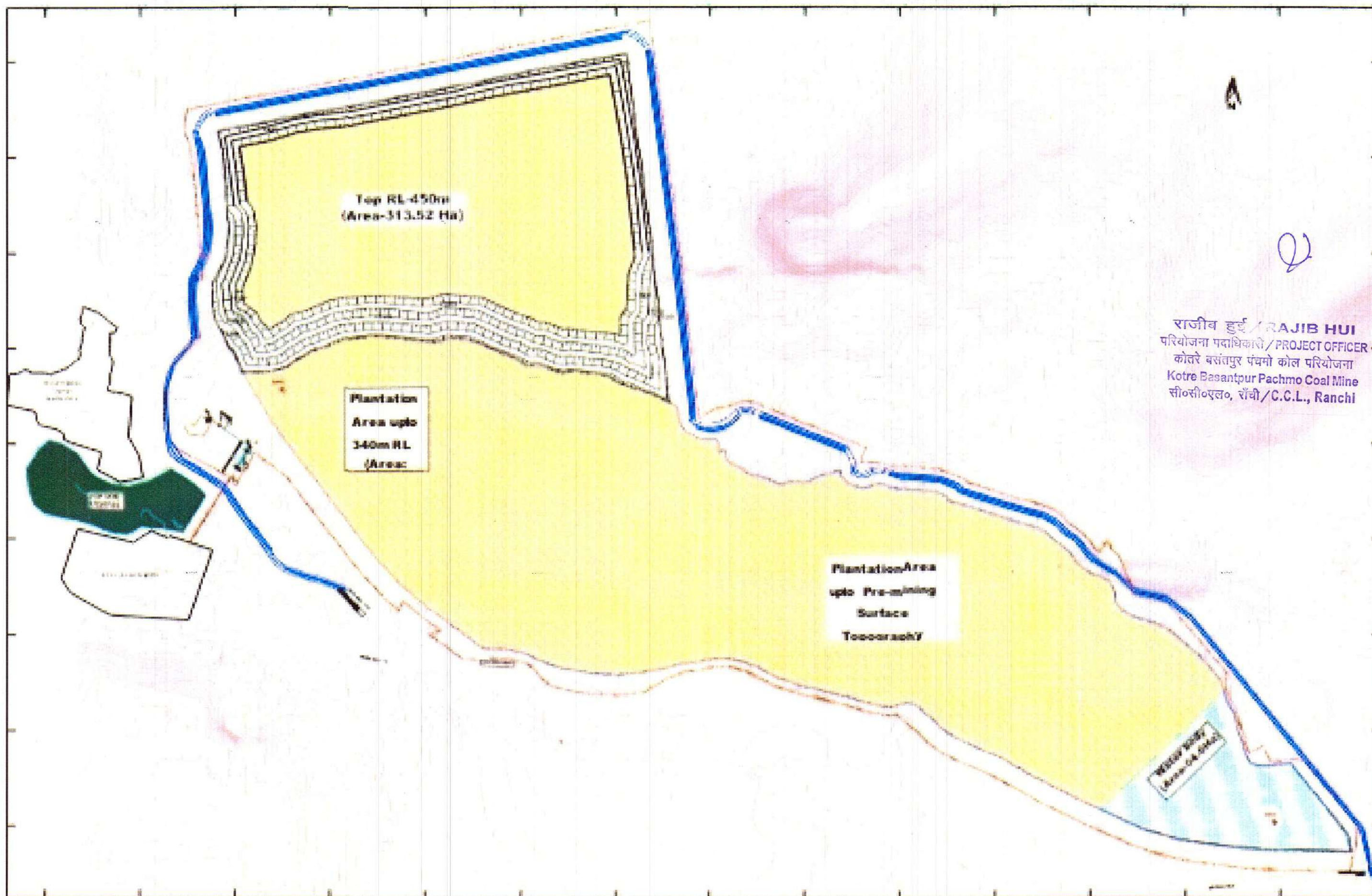

Surface Plan of Kotre-Basantpur-Pachmo Opencast Coal Project

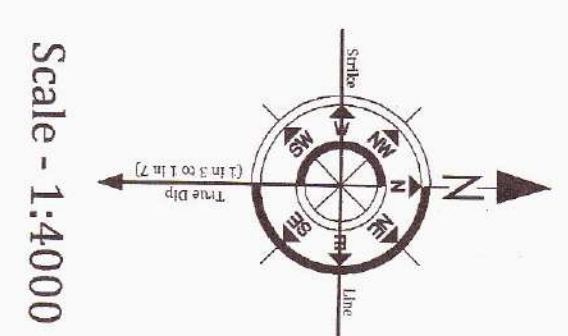

Scale - 1:4000

BOKARO
DISTRICT

Location Map of Kotre-Basantpur-Pachmo Opencast Coal project

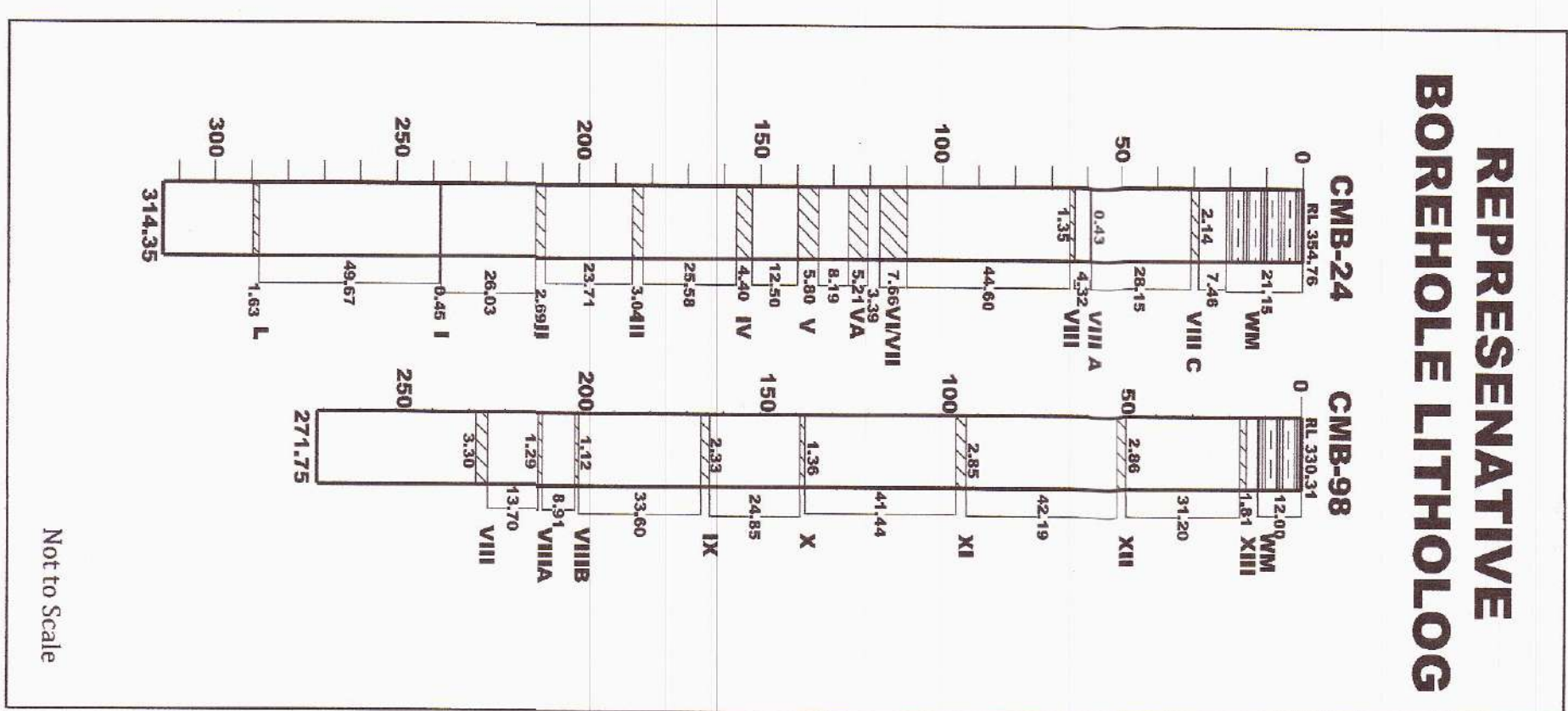
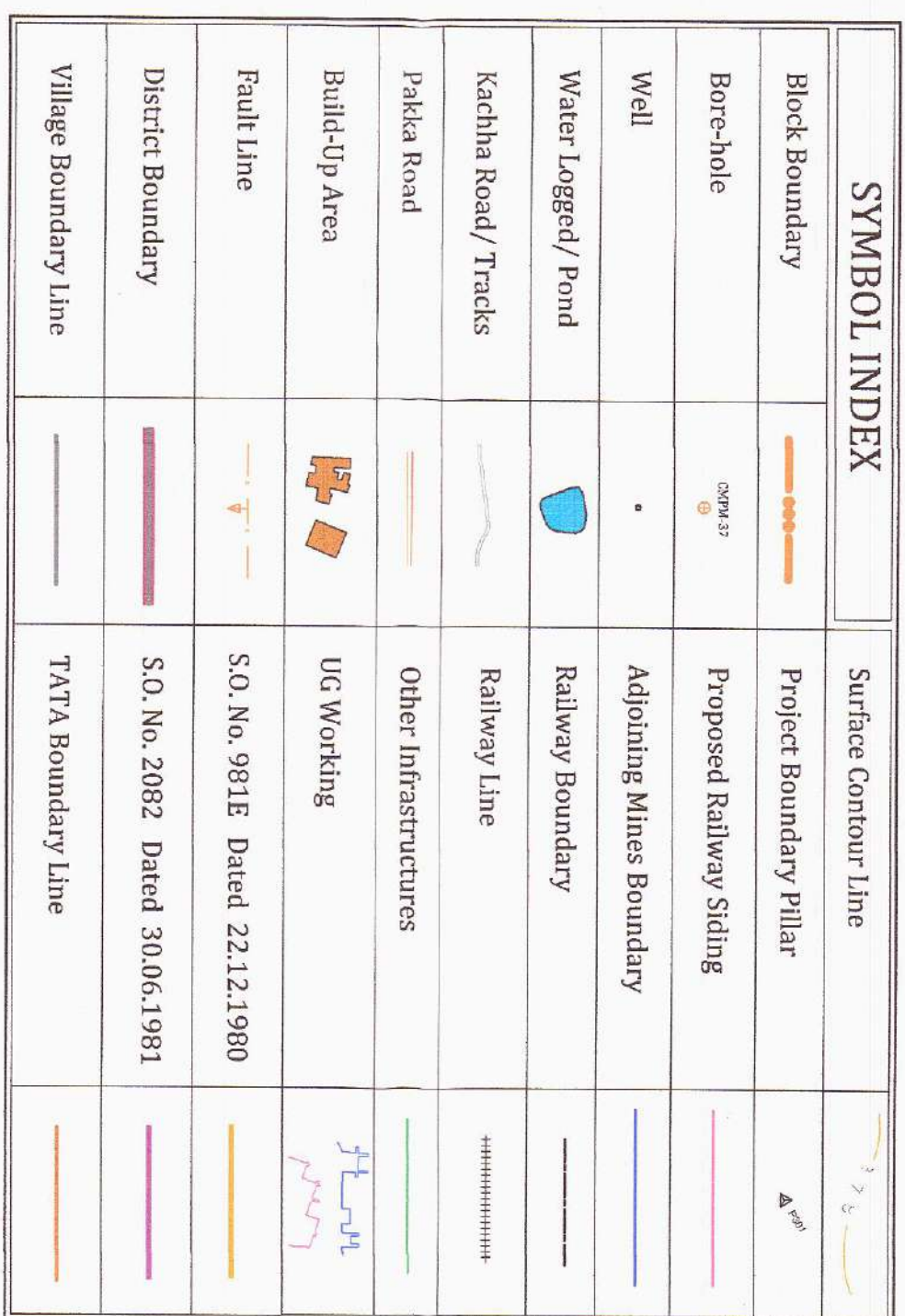
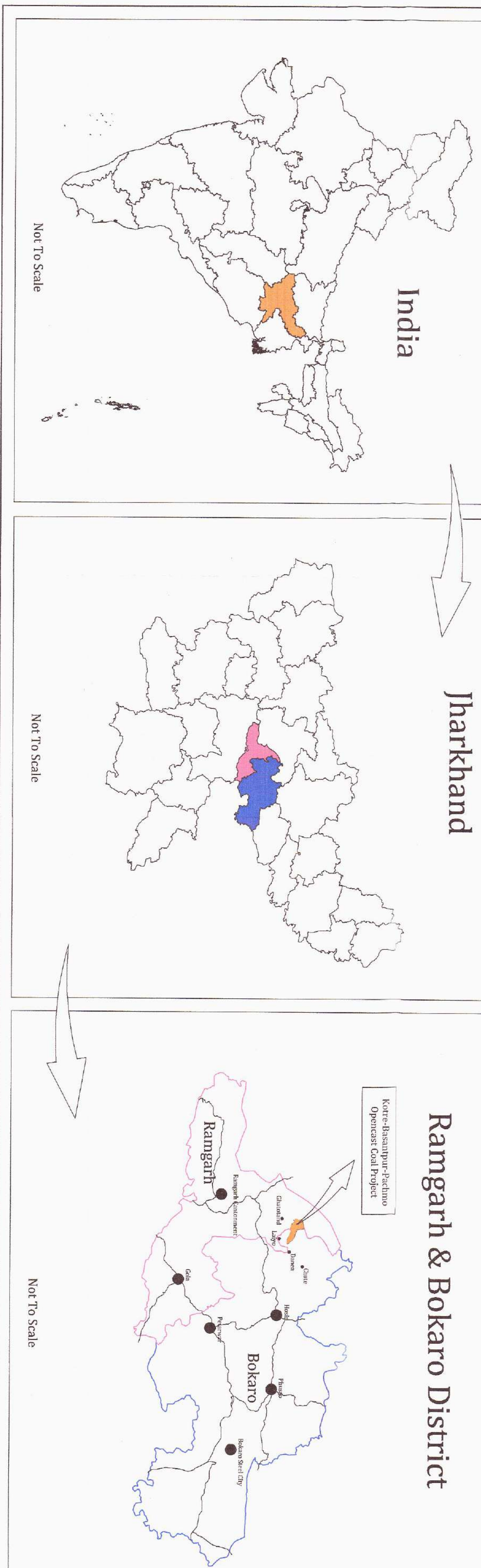

Owner	CENTRAL COALFIELDS LIMITED	
Project	Korle-Basranpur-Pachmo Opencast Coal Project (Capacity: SMT / annum)	
	Date & Signature of Manager (Korle-Basranpur-Pachmo OCP)	Date & Signature of Manager (Contributor/Ministry)

राजीव इन्ड / RAJIB INDI
राजीव इन्डिया प्राइवेट लि. / RAJIB INDIA
प्राइवेट लि. / PRAIVAT
लि. / LI.
राजीव इन्डिया प्राइवेट लि. / RAJIB INDIA
प्राइवेट लि. / PRAIVAT
लि. / LI.
राजीव इन्डिया प्राइवेट लि. / RAJIB INDIA
प्राइवेट लि. / PRAIVAT
लि. / LI.

Annexure- I Top Soil Management Plan

Topsoil is that uppermost layer of soil capable of growing and supporting vegetation. Topsoil contains the essential micro-organisms, nutrients, organic matter, and physical characteristics necessary to grow and sustain permanent vegetation.

The salvaging, stockpiling and re-application of topsoil to be used as growth medium in the reclamation of dumps within the mining area is a major environment protection programme. Soil management in opencast mine is necessary to re-establish the stability & productivity of lands disturbed due to mining activity.

The total Top soil removal has been estimated as 2.91 Mm³ throughout the life of mine. The quantity of top soil removal stage wise and its use in the reclamation has been detailed in the table given below.

Year/Stage (Life of the mine plus post closure period)	Top Soil Removal Plan	Top Soil Used (in M.Cum)					
		Spreading Over Embankment	Spreading over Backfill area	Spreading over External OB Dump area	Used in Green Belt area	Used in land Dismantled	Total Utilised
End of Construction period	0.08	0.00	0.00	0.00	0.00	0.00	0.00
Y-1	0.16	0.01	0.00	0.00	0.23	0.00	0.24
Y-5	0.98	0.01	0.00	0.00	0.35	0.00	0.36
Y-15	2.06	0.01	0.00	0.00	0.63	0.00	0.64
Y-25	2.59	0.01	0.00	0.00	0.63	0.00	0.64
Y-33	2.91	0.01	0.00	0.00	0.63	0.00	0.64
Post Closure							
Y-38	2.91	0.01	1.25	0.94	0.63	0.08	2.91

It has been proposed to preserve the top soil on the land earmarked for top soil stockpiling. The measures to be taken for handling, preserving and spreading of top soil

राजीव हुई / RAJIB HUI
परियोजना पदाधिकारी / PROJECT OFFICER
कोतरे बसंतपुर पंचमो कोल परियोजना
Kotre Besantpur Panchmo Coal Mine
सी.सी.एल.एल. रॉडी / C.C.L.L. Road

1. The top layer i.e., 0-30 cm of soil shall be treated as top soil.
2. Top soil removal shall be done separately using suitable HEMM/machines and not mixed with Overburden removal.
3. The max. height of Top soil dump shall not be maintained beyond 10 ft. from the ground R.L. proper terracing of dump shall be done.
4. Provision of jute mesh for facilitating grass or vegetative growth on slopes. Slope shall be vegetated using species like Khus (Vetiveria Zizanioides), lemon grass (cymbopogon), Shishu (Delbargia Shishu), Khair (Casia Katachu) etc. Gully plugs along the slopes, Garland drain and Toe wall all along the dump shall be provided for prevention of soil erosion.
5. The recommendation of institute of forest products (IFP) study on top soil conservation shall be implemented in Kotre Basantpur Pachmo OCP also.

राजीब हुई / RAJIB HUI
परियोजना पदाधिकारी / PROJECT OFFICER
कोतरे बसंतपुर पंचमो कोल परियोजना
Kotre Basantpur Pachmo Coal Mine
सी०सी०एल०, राँची / C.C.L., Ranchi

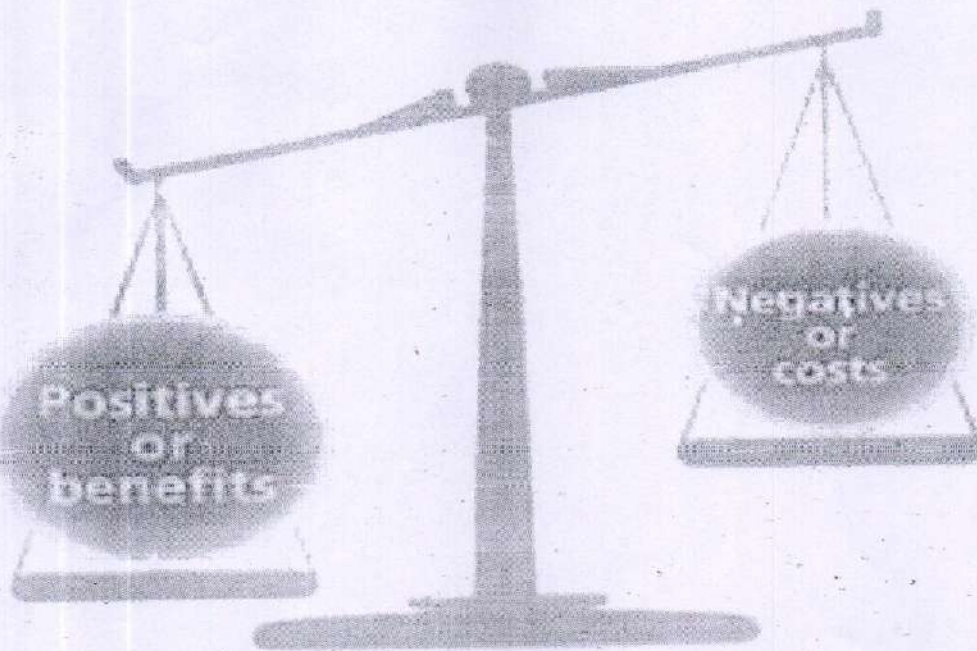

COST BENEFIT ANALYSIS REPORT

[as per MoEFCC Guideline 7-69/2011-FC(Pt.) dtd. 01 August, 2017]



Central Coalfields Limited
(A Miniratna Company)

Kotre Basantpur Pachmo OCP (1006.17 Ha)

राजीव हुई / RAJIB HUI
परियोजना पदाधिकारी / PROJECT OFFICER
कोतरे बसंतपुर पंचमो कोल परियोजना
Kotre Basantpur Pachmo Coal Mine
सी०सी०एल०, राँची / C.C.L., Ranchi

Introduction:

Kotre Basantpur Pachmo OCP is a green field project located in the west Bokaro coalfields, in Ramgarh and Bokaro districts of Jharkhand. Kotre-Basantpur and Pachmo coal mine has been allotted to Central Coalfields Limited (CCL) on 19th April 2018 by the office of the Nominated Authority, Ministry of Coal vide order no F.No. NA-103/1/2017-NA. The project report of Kotre Basantpur Pachmo OCP was prepared for a rated capacity of 5.00 MTPA. The PR has obtained in-principal approval by CIL Board in 399th Board of directors meeting held on 25.02.2020 and final approval of PR was accorded by CIL board in 408th Board meeting held on 04.08.2020.

Communication:

Name of Project Officer	:	Rajib Hui
Address	:	Office of Project officer, KBP OCP, Kedla
Mobile no.	:	6200292870
Email Address	:	Pokbp2018@yahoo.com

Purpose for Cost benefit analysis :

Cost benefit report is required for making on line application. The report has been prepared on the basis of MoEFCC circular no. 7-69/2011-FC(Pt.) dtd. 01 August, 2017. (copy Attached as Annexure A).

Table 1 : Break up of land

Notified forest land (Ha)	GM JJ land (Ha)	Non Forest land (Ha)	Total land (Ha)
714.22	291.95	156.70	1162.87

The nature of forest-land for which application for diversion of forest land for Kotre Basantpur Pachmo OCP (1006.17 Ha) falls in Class III MDF forest. As such Rate of NPV comes out as Rs 12,28,590/ha for 1006.17 Ha of the proposed forest land for diversion.

Table 2: Calculation rate for NPV NPV rates published vide File No.5-3/2011-FC(Vol-I) Dt. 06.01.2022		
Description	Amount in Rs.	Amount in Rs. Lakhs
Total NPV @Rs.1228590/Ha for 1006.17 Ha of the forest land proposed for diversion	1228590*1006.17= 1236170400	12361.704
10% NPV Value	123617040	1236.17
30% NPV Value	370851000	3708.51
50% NPV Value	618085000	6180.85

राजीब हुई / RAJIB HUI
परियोजना पदाधिकारी / PROJECT OFFICER
कोतरे बसंतपुर पंचमो कोल परियोजना
Kotre Basantpur Pachmo Coal Mine
सी.सी.एल., राँची / C.C.L., Ranchi

Table 2 (b): Economic value of carbon storage					
Class	Forest type group/ value of carbon Storage (Rs/ Ha)	VDF	MDF	OF	LTF
III	Tropical dry deciduous forest	300064	270040	95721	95721

Source: Revision of rates of NPV applicable for different class/category of forests published by centre for ecological services management (CESM), Indian Institute of Forest Management (IUFM), Bhopal in collaboration with Forest Survey of India (FSI), Dehradun, Nov. 2014

Table 3:
Rate of land as per circle rate

Name of Village	Circle rate per decimal(in Rs)	Forest Land (in Ha)	Circle rate per Hectare (in Rs)	Circle Rate of the villages (Rs in Lakh)
Kotre	8415	378.34	2079346.5	7865.68
Basantpur	10000	155.22	2471000	3835.48
Pachanda	9075	99.63	2242432.5	2234.13
Pachmo	14520	109.98	3587964.6	3946.04
Purnapani	14520	20.43	3587964.6	733.02
Rahawan	14520	1.01	3587964.6	36.23
Baghraiya	14520	71.13	3587964.6	2552.12
Hurdag	14520	170.43	3587964.6	6114.96
Total				27317.66

Total circle rate of 1006.17 Ha = Rs. 27317.66 Lakhs

Other conversion factor

100 decimal = 1 acre

1 Ha = 2.471 Acre = 247.1 Decimal

CALCULATION AS PER MOEFCC CIRCULAR NO. 7-69/2011-FC(PT.)
Ddt. 01 AUGUST, 2017.

I. Estimation of cost of forest diversion

1. Ecosystem services losses due to proposed forest diversion

Economic value of loss of ecosystem services due to diversion of forest = Net present value (NPV) of the forest land being diverted as per prescribed by the Central Government (MoEF&CC).

As the Forest land proposed does not fall in National park & Wild life sanctuary

Ecosystem services losses due to proposed forest diversion for 1006.17 Ha = Rs.
1228590 * 1006.17 = 12,361,704 Lakhs (Ref Table 2)

2. Loss of animal husbandry productivity, including loss of fodder

No. of PAFs = 1000

राजीब हुई / RAJIB HUI
परियोजना पदाधिकारी / PROJECT OFFICER
कोतरे बसंतपुर पंचायत कोल परियोजना
Kotre Basantpur Pachmo Coal Mine
सी.सी.एल.एल. रौंदी / C

Cost Benefit Analysis of Kotre Basantpur Pachmo OCP (1006.17 Ha)

Assuming no. Of animal husbandry as 4

Factor = 60

Loss of Loss of animal husbandry productivity, including loss of fodder =
 $1000 \times 4 \times 365 \times 60 = \text{Rs. } 876.0 \text{ Lakhs}$

10% of NPV = Rs. 1236.17 lakhs (ref Table 2)

Since 10% of NPV is more

Thus, as per guideline

Loss of animal husbandry productivity, including loss of fodder = Rs 1236.17 lakhs

3. Cost of human resettlement as per R&R Plan = Rs $5 \times (138.1 \times 2.471) = 1706.47 \text{ Lakhs}$

4. Loss of public facilities and administrative infrastructure (Roads, buildings, schools, dispensaries, electric line, railways, etc.) in forest land, which would require forest land, if these facilities were diverted due to the project = Rs. 0.00

5. Possession value of forest land diverted

Amount as per circle rate of adjoining area = 27317.66 lakhs (As per table 3)

30% of NPV = 3708.51 Lakhs

6. Cost of suffering of oustees

No. Of Outsees = No. Of PAFs = 1000

No. of days worked = 300 (Assumed)

Minimum wages of Unskilled labour = Rs. 604.33

Thus, cost of suffering of Ousteers = $1.5 \times (\text{daily wages} \times \text{No. of days} \times 2 \text{ years}) \times \text{No. of Ousteers}$

= $1.5 \times (604.33 \times 300 \times 2) \times 1000 \times 4 = 21755.88 \text{ Lakhs}$

7. Habitat Fragmentation cost

Cost due to fragmentation has been pegged at 50% of NPV applicable as a thumb rule (Ref Circular MoEF)

50 % of NPV = Rs. 6180.85 Lakhs (Ref table 2)

8. Compensatory afforestation and soil & moisture conservation cost

Cost of Compensatory Afforestation = Rs. 4448.09 Lakhs (As per 10year plantation scheme issued by DFO Giridih for 2012.34 Ha CA land)

II. Estimating benefits of forest – diversion in CBA

1. Increase in productively attribute to the specific project

Productively attribute = Profit per tonne x mineable reserve X 10

= $804.43 \times 149.65 \times 10 = \text{Rs. } 1203829.49 \text{ Lakh}$

2. Benefits to economy due to specific project

CSR = 2% of the profit

Profit = profit per tonne x Mineable reserve = Rs $804.43 \times 149.65 \times 10 = \text{Rs. } 1203829.49$

Lakh

राजीब हुई / RAJIB HUI

Cost Benefit Analysis of Kotre Basantpur Pachmo OCP (1006.17 Ha)

परियोजना अधिकारी / PROJECT OFFICER

कोट्रे बसंतपुर पंचमो को 4 परियोजना

Kotre Basantpur Pachmo Coal Mine

राजकीय खनो, राँची / C.O. Ranchi

A. CSR cost = 2 % of Profit = 24076.59 Lakh

B. Royalty to the exchequer = sale price x 149.65 MT x 14 % = Rs. 2524.25 x 149.65 x 0.14 x 10 = Rs. 528855.61 Lakh

C. District Mining Fund (DMF) = 30 % of Royalty = Rs 528855.61 x 0.3 = Rs. 158656.68 Lakhs

D. National Mineral fund = 2 % of Royalty = Rs 528855.61 x 0.02 = Rs. 10577.1 Lakh

E. Coal cess = 400 x 149.65 x 10 = Rs. 598600 Lakh

Total Benefit = A+B+C+D+E = 24076.59 + 528855.61 + 158656.68 + 10577.1 + 598600 = Rs 1320765.98 Lakh

3. No. of population benefitted due to specific project

Direct employment = 170

Indirect Employment = 850

Considering avg. family size 5, then no. of Population benefitted = 5100

4. Economic benefits due to direct and indirect employment due to project

A. For indirect employment generated for = 850 people

Avg. days of Working (as in Jharkhand) = 230 days

Rate of unskilled manpower = Rs. 985/- day (As per HPC wages circular vide 267 dated 06.05.2022)

Life of mine = 35 years

Economic benefits due to indirect employment = Rs. (850*230*985*35) Lakhs = 67398.62 lakhs

B. For direct employment for = 170

Minimum Wage for Skilled labour = Rs 1060/day (As per HPC wages circular vide 267 dated 06.05.2022)

Assumed working Days = 230

Life of mine = 35 years

Economic benefits due to direct employment = Rs. 14506.10 Lakhs

Economic benefits due to of direct and indirect employment due to project

= A+B = Rs. 81904.72 lakhs

5. Economic benefits due to compensatory afforestation

CA Land = 1006.17 x 2 = 2012.34 Ha

Class of degraded forest land supposed to change from LDF to MDF

A. Thus, change in benefits (as per NPV) [@ Rs (12.286 – 9.57) lakhs/ha

= 2.716* 2012.34 = Rs. 5465.51 Lakhs

B. Economic value of carbon storage

Change in economic value @ Rs (270040 – 95721) = Rs. 174319 = Rs. 1.74319 Lakhs for 60yrs.

Cost Benefit Analysis of Kotre Basantpur Pachmo OCP (1006.17 Ha)

राजीब हुई / RAJIB HUI

प्रोजेक्ट पदाधिकारी / PROJECT OFFICER

कोतरे बसंतपुर पचमो कोल परियोजना

Kotre Basantpur Pachmo Coal Mine

मोएला, राँची, Jharkhand, Ranchi

Thus, economic value for 50 yrs = Rs. 2917.5 lakhs

Total Economic benefits due to compensatory afforestation = (A+B) = Rs 8383.4 Lakhs

Table: Estimation of cost of forest diversion (as per table B of guidelines)		
Sl No	Parameter	Result(in Lakhs)
1	Ecosystem services losses due to proposed forest diversion	12361.70
2	Loss of animal husbandry productivity, including loss of fodder	1236.17
3	Cost of human resettlement	1706.47
4	Loss of public facilities and administrative infrastructure (Roads, buildings, schools, dispensaries, electric line, railways, etc.) On forest land, which would require forest land if these facilities were diverted due to the project	0.00
5	Possession value of forest land diverted	27317.66
6	Cost of suffering of oustees	21755.88
7	Habitat Fragmentation cost	6180.85
8	Compensatory afforestation and soil & moisture conservation cost	4448.09
	Total loss in lakhs	75006.82

Table: Existing guidelines for estimating benefits of forest – diversion in CBA (As per Table C of Guidelines)		
Sl No	Parameters	Result(in Lakhs)
1	Increase in productively attribute to the specific project	1203829.49
2	Benefits to economy due to specific project	1320765.98
3	No of population benefitted due to specific project	5100
4	Economic benefits due to of direct and indirect employment due to project	81904.72
5	Economic benefits due to compensatory afforestation	8383.4
	Total	2619983.6

$$\text{Cost to benefit ratio} = 75006.82/2619983.6 = 1: 34.92$$

राजीव हुई / RAJIB HUI
 परियोजना पदाधिकारी / PROJECT OFFICER
 कोतरे बसंतपुर पंचमो कोल परियोजना
 Kotre Basantpur Pachmo Coal Mine
 सी०सी०एल०, राँची / C.C.L., Ranchi

No. 7-69/2011-FC(Pt.)
Government of India
Ministry of Environment, Forest & Climate Change
(Forest Conservation Division)

Indira Paryavaran Bhawan,
Jorbagh Road, Aliganj,
New Delhi-110003.
Dated: 01st August, 2017.

To

The Principal Secretary (Forests)
All States / Union Territories Governments.

Sub: **Guidelines for conducting Cost Benefit Analysis for projects involving diversion of forest land under the provisions of the Forest (Conservation) Act, 1980.**

Sir,

I am directed to inform that in supersession of all earlier orders / guidelines including that referred to at 2.6 of the Handbook of Forest (Conservation) Act, 1980 for conducting Cost Benefit Analysis of projects involving forest diversion, a revised set of guidelines has been prepared by the Ministry and shall be applicable for all projects involving diversion of forest land under the provisions of the Forest (Conservation) Act, 1980, which are required to be undertaken as per Table A of the new guidelines, from the date of issue of this letter. These guidelines will be applicable for all such projects which are yet to be recommended by the State Government on the date of issue of this guideline.

The guidelines for conducting Cost Benefit Analysis for projects involving forest diversion areas is enclosed herewith for further action.

This issues with the approval of competent authority.

Yours faithfully,

Encl: As above.

(Nisheet Saxena)

Sr. Assistant Inspector General of Forests

Copy to:-

1. Prime Minister's Office (PMO)
2. Secretary, Ministry of Mines, Government of India
3. Secretary, Ministry of Coal, Government of India.
4. Secretary, Ministry of Steel, Government of India
5. Principal Chief Conservator of Forests, all States/UTs.

राजीव हुई / RAJIB HUI
परियोजना पदाधिकारी / PROJECT OFFICER
कोतरे बसंतपुर पंचगो कोल परियोजना
Kotre Basantpur Pachmo Coal Mine
सी०सी०एल०, राँची / C.C.L., Ranchi

7. All Regional Offices, Ministry of Environment, Forest and Climate Change (MoEF&C)
8. Joint Secretary, In-charge, Impact Assessment Division, MoEF&CC.
9. PS to the Hon'ble Minister of State (Independent Charge) for Environment, Forest and Climate Change.
10. Chairman, State Environment Impact Assessment Authority, all States/UTs.
11. Member-Secretary, State Environment Impact Assessment Authority, all States/UTs.
12. All Directors/Assistant Inspector General of Forests in Forest Conservation Division, MoEF&CC.
13. All Advisors/Directors/Dy. Directors in the Impact Assessment Division, MoEF&CC.
14. Director, Regional Office (Headquarters), MoEF&CC.
15. Sr. Director (Technical), NIC, MoEF&CC with a request to place a copy of this letter on website of this Ministry.
16. Sr. PPS to the Secretary, Ministry of Environment, Forest and Climate Change.
17. Sr. PPS to Director General of Forests and Special Secretary, Ministry of Environment, Forest and Climate Change.
18. Sr. PPS to Addl. Director General of Forests (Forest Conservation), Ministry of Environment, Forest and Climate Change.
19. PPS to IGF(FC), MoEF&CC.
20. Guard File.



(Nisheeth Saxena)

Sr. Assistant Inspector General of Forests



राजीब हुई / RAJIB HUI

परियोजना पदाधिकारी / PROJECT OFFICER

कोतरे बसंतपुर पंचमो कोल परियोजना

Kotre Basantpur Pachmo Coal Mine

सी०सी०एल०, राँची / C.C.L., Ranchi

Guidelines for conducting cost-benefit analysis for projects involving forest diversion

- (i) While considering proposal for diversion of forest land for non-forestry use, it is essential that ecological and environmental losses and eco-economic distress caused to the people who are displaced are weighted against economic and social gains.
- (ii) Whenever the forest land is involved in the development projects, the cost of ecosystem services and fragmentation of habitat of wildlife and economic distress caused to people dependent on forests and the cost of settlement of people dependent on forest should also be added as the cost of forest diversion in addition to the standard project cost which would have been incurred by the user agencies without involvement of forest land while conducting the cost benefit analysis of the project. Similarly the benefits from the project accruing due to diversion of forest land and used in the project should also be accounted for in the benefits component in addition to the standard benefits of the project which would have been accrued without involvement of forest land while conducting the cost benefit analysis and determining the benefit and cost ratio (BC ratio).
- (iii) The cost of compensatory afforestation and its maintenance in future and soil & moisture conservation at present discounted value and future benefits from such compensatory forestation accruing over next 50 years monetised and discounted to the present value should be included as cost and benefits respectively of compensatory afforestation while conducting the cost benefit analysis and determining the benefit and cost ratio (BC ratio).
- (iv) Table-A lists the details the types of projects involving forest land for which cost-benefit analysis will be required. Table-B lists the parameters according to which the cost aspect of forest land diverted for the development projects will be determined, while Table-C lists the parameters for assessing the benefits accruing to the project using of forest land.
- (v) A cost-benefit analysis as above should accompany the proposals sent to the Central Government for forest clearance under the Forest Conservation Act.

राजीब हुई / RAJIB HUI
परियोजना पदाधिकारी / PROJECT OFFICER
कोठरे बसंतपुर पंचमो कोल परियोजना
Kothre Basantpur Pachmo Coal Mine
सी०सी०एल०, राँची / C.C.L., Ranchi
Page 1 of 4

Cost Benefit Analysis Guidelines for forest land diversion -2017

Table-A : Cases under which a cost-benefit analysis for forest diversion are required

No	Nature of proposal	Applicable/ not applicable	Remarks
1	All categories of proposals involving forest land upto 20 hectares in plains and upto 5 hectare in hills	Not applicable	These proposals may be considered on a case to case basis and value judgement
2	Proposal for defence installation purposes and oil prospecting (prospecting only)	Not applicable	In view of national Priority accorded to these sectors, the proposals would be critically assessed to help ascertain that the utmost minimum forest land is diverted for non-forest use
3	Habitation, establishment of industrial units, tourist lodges complex and other building construction.	Not applicable	These activities being detrimental to protection and conservation of forest, as a matter of policy, such proposals would be rarely entertained.
4	All other proposals involving forestland more than 20 hectares in plains and more than 5 hectares in hills including roads, transmission lines, minor, medium and major irrigation projects, hydro projects, mining activity, railway lines, location specific installations like micro-wave stations, auto repeater centres, TV towers etc.	Applicable	These are cases where a cost-benefit analysis is necessary to determine when diverting the forest land to non-forest use in the overall public interest.

Table-B: Estimation of cost of forest diversion

SN	Parameters	Remarks
1	Ecosystem services losses due to proposed forest diversion	Economic value of loss of eco-system services due to diversion of forests shall be the net present value (NPV) of the forest land being diverted as prescribed by the Central Government (MoEF& CC). <i>Note: In case of National Parks the NPV shall be ten (10) times the normal NPV and in case of Wildlife Sanctuary the NPV shall be five (5) times the normal NPV or otherwise prescribed by the ministry or any other competent authority</i>
2	Loss of animal husbandry productivity, including loss of fodder	To be quantified and expressed in monetary terms or 10% of NPV applicable whichever is maximum
3	Cost of human resettlement	To be quantified and expressed in monetary terms as per approved R&R plan
4	Loss of public facilities and administrative infrastructure (Roads, building, schools, dispensaries, electric lines, railways, etc.) on forest land, which would require forest land if these facilities were diverted due to the project	To be quantified and expressed in monetary terms on actual cost basis at the time of diversion

राजीव हुई / RAJIB HUI
 परियोजना पदाधिकारी / PROJECT OFFICER
 कोतरे बसंतपुर खेडो कोल परियोजना
 Kotra Basantpur Khedo Coal Mine
 सीएसओएल, राँची C.O.L., Ranchi

Cost Benefit Analysis Guidelines for forest land diversion -2017

5	possession value of forest land diverted	30% of environmental costs (NPV) due to loss of forests or circle rate of adjoining area in the district should be added as a cost component as possession value of forestland whichever is maximum
6	Cost of suffering to oustees	The social cost of rehabilitation of oustees (in addition to the cost likely to be incurred in providing residence, occupation and social services as per R&R plan) be worked out as 1.5 times of what oustees should have earned in two years had he not been shifted.
8	Habitat Fragmentation Cost	While the relationship between fragmentation and forest goods and services is complex, for the sake of simplicity the cost due to fragmentation has been pegged at 50% of NPV applicable as a thumb rule.
	Compensatory afforestation and soil & moisture conservation cost	The actual cost of compensatory afforestation and soil & moisture conservation and its maintenance in future at present discounted value.

Table-C - Existing guidelines for estimating benefits of forest-diversion in CBA

Sr. No.	Parameters	Remarks
1	Increase in productivity attribute to the specific project	To be quantified & expressed in monetary terms avoiding double counting
2	Benefits to economy due to the specific project	The incremental economic benefit in monetary terms due to the activities attributed to the specific project
3	No. of population benefited due to specific project	As per the Detailed project report
4	Economic benefits due to of direct and indirect employment due to the project	As per the Detailed project report.
5	Economic benefits due to Compensatory afforestation	Benefits from such compensatory forestation accruing over next 50 years monetised and discounted to the present value should be included as benefits of compensatory afforestation. *For benefits of CA the guideline of the Ministry for NPV estimation may be consulted.

Note-1: Net Present value (NPV) of environment and ecosystem services loss:

The concept of Net Present value of the forest land diverted is a scientific method of calculating the environmental cost and other losses caused due to diversion of forest land for non-forestry purposes. The NPV represents the net value of various ecosystem services and other environmental services in monetary terms which the forest would have provided if the forest would not have been diverted.

राजीव हुई / RAJIB HUI
 परियोजना पदाधिकारी / PROJECT OFFICER
 कोतरे बसंतपुर पंचायत कोल परियोजना
 Kotra Basantpur Pa Coal Mine
 राँची, ज. राँची / Jharkhand

Note-2: Possession value of forest land diverted:

The forest land diverted for the project such as irrigation, hydropower, railways, roads, wind, and transmission lines and mining etc are unlikely to be returned and remains in possession of the user agencies. Therefore 30% of the net present value (NPV) of forest land diverted or market rate of adjoining area in the district should be added as a cost component as "possession value of forest land" in addition to the environmental costs due to loss of forests.



राजीव हुई / RAJIB HUI
परियोजना पदाधिकारी / PROJECT OFFICER
कोतरे बसंतपुर पंचमो कोल परियोजना
Kotre Basantpur Pachmo Coal Mine
सी०सी०एल०, राँची / C.C.L., Ranchi



2
राजीव हुई / RAJIB HUI
परियोजना पदाधिकारी / PROJECT OFFICER
कोलरे बसंतपुर पंचमो कोल परियोजना
Kotre Basantpur Pachmo Coal Mine
सी०सी०एल०, राँची / C.C.L., Ranchi

Annexure-VI A

File-F-17



दामोदर घाटी निगम
DAMODAR VALLEY CORPORATION
डीवीसी टावर्स: वीआईपी रोड
DVC TOWERS: VIP ROAD
कोलकाता/KOLKATA - 700 054



No. AS/PS/Misc./F-17/1111

Date: 18.09.2021

To
The Project Officer
Kotre Basantpur Pachmo Coal Mine
M/s Central Coalfields Limited,
Darbhanga House, Kutchery Road,
Ranchi-834029

Sub : NOC for diversion of 4 (four) small nallas Kotre, Jhumra, Pachmo and Bagharia flowing through Kotre Basantpur Pachmo OCP belonging to CCL into the Chutua nala falling within Damodar Valley (DV) area.

Ref : Your letter no : GM (KBP)/New Projects/2021/676, dated 03rd April, 2021 of the Project Officer, Kotre Basantpur Pachmo Coal mine, CCL, Ranchi, Jharkhand.

Dear Sir,

With reference to above letter, NOC is hereby issued to M/s CCL for diversion of 4 (four) small nallas Kotre, Jhumra, Pachmo and Bagharia flowing through Kotre Basantpur Pachmo OCP belonging to CCL into the Chutua nala falling within Damodar Valley (DV) area in the state of Jharkhand subject to following conditions:

1. The responsibility of design, construction, commissioning and operation of scheme including temporary antecedental structures such as diversion, cofferdams, cause ways etc. solely rests with the authorities of CCL and DVC will not be responsible in any way for structural sustainability and inconvenience, if any, caused to the public in case of failure.
2. The temporary structure required in connection with the diversion work shall have to be approved by CCL in order to ensure uninterrupted flow of water and traffic. In case of crossing of water courses either with moderate flow rate or of torrential nature with marked and unpredictable flooding, adequate survey shall have to be carried out before starting the work with the object of determining what precautions are necessary and the most favourable period for executing the work.
3. CCL shall arrange to back fill the excavation where ever required as per the technical specification to prevent soil and bank erosion to the satisfaction of authorities having Jurisdictions thereon.
4. CCL will have to arrange necessary NOCs from State Highways Authorities, National Highways Authorities, District Board Authorities, Public Works Department authorities, Irrigation Department authority & Forest Department authorities, Pollution Control Authority etc. for such diversion of Nalas into Chutua Nala in the DV area falling under their domain.

राजीव हुई / RAJIB HUI
परियोजना पदाधिकारी / PROJECT OFFICER
कोतरे बसंतपुर पैचमो कोल परियोजना
Kotre Basantpur Pachmo Coal Mine
सी.सी.एल., रांची / C.C.L., Ranchi

Scanned with CamScanner

5. All safety protocols/ measures are required to be taken up by CCL mandatorily during diversion work of these Nalas.
6. CCL will take all steps for protection of environment and ensure maintenance of ecosystem and will also take steps to control pollutant from mines in to the river through these Nalas.
7. Temporary interventions wherever required for construction of roads, bridges, cause ways etc. which are required to be created in connection with diverting Nalas, it will be planned and constructed in such a fashion that the structures thus created will not obstruct the cross flow of water within the rivers, Nalas drains & rivulets i.e. sufficient water ways will have to be ensured to pass maximum probable flood with a provision to ensure upstream and downstream flow at the locations where these are warranted as per site conditions.
8. The dimensions of Nalas at the outmost boundary of the coal mine area should be proper & constructed in such a manner that it should receive all the rainfall along with other percolating water without overflowing.
9. If there be any future proposal for development in DV area of Jharkhand by DVC for construction of any structure within the area through which Nalas pass, the alignment of Nalas in the reaches, will have to be shifted suitably by CCL at their risk and cost.
10. Before discharging water accumulated in mines area into the Chutua Nala, CCL should construct a sump of adequate capacity to store such leaking water to settle the impurities present & also ensure its quality.
11. CCL will have to submit the final lay out plan of such diversion relating to the above proposal after completion of the project indicating methodologies at all the location.
12. Entire cost shall be borne by M/s CCL for the above scheme of diversion.
13. Non-compliance of any one of the recommendations enumerated above, NOC stands automatically withdrawn.

Yours faithfully,

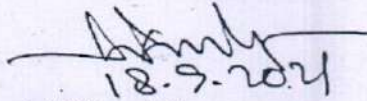
18.9.2024
Additional Secretary,
DVC Towers, Kolkata

राजीव हुई / RAJIB HUI
परियोजना पदाधिकारी / PROJECT OFFICER
कोलरे बसंतपुर पंचमो कोल परियोजना
Kotre Basantpur Pachmo Coal Mine
सी.सी.एल., राँची / C.C.L., Ranchi

WORK ORDER

Details of Service Provider	Details of Billing Address	Work Order No : 6000030826
Name : INDIAN INSTITUTE OF TECHNOLOGY ROORKEE	Name : KBP Mining Private Limited	Date : 30.07.2022
Address : SRI C. O. Main Building, IIT Roorkee Haridwar	Address : Gandhi Building, Bijulia, Ramy Ranchi - 834 029	Amendment : 0
Vendor code : 209594	State : JHARKHAND	Site : :KBP Mining Private Limited (5895)
PAN No : AAALI0033R	State Code : 20	Quotation Ref : :
State : Uttara khand	GSTIN/Unique ID : 20AA1CK6677J1Z8	Quotation Date : :
State Code : 05		PR Ref : :
GSTIN/Unique ID : 05AAALI0033R1Z5		Delivery Address
		Site Name : KBP Mining Private Limited
		Address : Gandhi Building, Bijulia, Ramy , Ranchi 834029

Preparation of Detailed Project Report of Proposed Nala diversions in Kotre Baisanthpur Pachmo project

S.No	HSN Cod./SAC	Desp. of Goods/Services	Total Taxable Value	CGST Rate	CGST Amt	SGST/UTGST Rate	SGST/UTGST Amt	IGST Rate	IGST Amt	Amount(INR)
1	998519	Study Report		0.00		0.00		18 %		
		Total		0.00		0.00				
		Basic Price + Tax								
		Total								

Total Value in Words :

WO Period From DT: 30.07.2022
WO Period To DT: 31.12.2022

राजीव हुई / RAJIB HUI
परियोजना प्रदाधिकारी / PROJECT OFFICER
कोतरे बसंतपुर पंचमो कोल परियोजना
Kotre Baisanthpur Pachmo Colliery

Vall
Prepared By
PROJECT DIRECTOR
VP SCT CIVIL
HODS/CACTS
CTCO-1
PRESIDENT BD & OP
CMD OFFICE

S.No	Material/Work IDescription	Quantity	UOM	Price Details Unit Price	Amount
10	Study Report	1.000	AU		
Payment Breakup					
Payment against monthly RA bills will be released as per the breakup furnished as under.					
1	DPR of proposed Nala Diversion	1.000	Lumpsum		
	Scope of the work 1. To conduct reconnaissance survey of the mining area for examination of site in the respect of existing drainage system, land use land cover, type of soil, morphology of the river, hydraulic structures, etc. and also for discussion with the authorities. 2. Study of the present topography of the mining area and existing drainage system. 3. Preparation of maximum intensity-duration-frequency curve of the study area using hourly rainfall data, if the same is not available. Otherwise isopleth maps available in the CWC report and/or PMP Atlas for Ganga River Basin including Yamuna of CWC shall also be used. 4. Development of digital elevation model and drainage map of the mining areas using the developed topographical map of the area through land survey. 5. Delineation of the catchment area of the different nalas/streams inside and outside of the mining area. Development of digital elevation model and drainage				

राजीव हुई / RAJIB HUI
 परियोजना प्रबन्धिकासी / PROJECT OFFICER
 कोलरे बरसतपुर पंचमो कोल परियोजना
Kotla Barampur Pachmo Coal Mine
 सी०सी०एल०, राँची / C.C.L., Ranchi

S.No	Material/Work Description	Quantity	UOM	Price Details Unit Price	Amount
	<p>map of the areas outside of the mining area using satellite images (SRTM/Cartosat/Google engine).</p> <p>6. Development of the land use and land cover map of the catchment areas of nalas inside and outside of the mining areas.</p> <p>7. Study of soil map of the catchment areas of nalas inside and outside of the mining areas.</p> <p>8. Estimation of peak discharge/flood hydrograph for different return periods like 25,50 and 100 years in the Kotre, Jhumra, Pachmo, Bhagriya and Chutua, nalas on the basis of hydrological analysis of the catchment area, land use pattern, topography of the area and meteorological data etc. Estimation of peak discharge/hydrograph shall be carried out invoking empirical equations, rational method and unit hydrograph theory.</p> <p>9. Fixing the alignment of the diversion channel on the basis of the contour map and utility plan of the mining area. Fixing the shape and size including bed slope of the channel on the basis of the peak discharge, L-section of the ground along the channel, etc.</p> <p>10. Designing the lining of the diversion channel, if necessary. Design of structure/bund/embankment across the nalas to divert the flow in the diversion channel.</p> <p>11. Design of suitable measures at the</p>			<p>राजीव हुई / RAJIB HUI परियोजना प्रशासक / PROJECT OFFICER कोलरे बसंतपुर पंचमो कोल परियोजना Kotre Basantpur Pachmo Coal Mine सी.सी.एल., रांची / C.C.L., Ranchi</p>	

S.No	Material/Work Description	Quantity	UOM	Price Details Unit Price	Amount
	<p>end of the diversion channel to avoid any degradation/aggradation in the existing naals, if necessary.</p> <p>12. Development of one-dimensional HEC-RAS model for the Chutua River from 2.5km upstream to 2.0km downstream of the mining area under the virgin condition and with diversion channel. The diversion channel shall also be modelled.</p> <p>13. Running the model for the pre and post diversion scenarios with estimated peak discharge for return periods of 25, 50 and 100 years for to obtain hydraulic parameters like water surface profile, velocity, bed shear stress, aggradation/degradation etc.</p> <p>14. Discussion on the hydraulic parameters and morphology of the Chutua naals to examine the pre and post diversion scenarios- impact of the diversion of the naals on the Chutua naals.</p> <p>15. To study the impact of the diversion of the naals on the existing structures/protection works on the Chutua river due to diversion of the naals.</p> <p>16. Examination of water surface profile vis-à-vis bank levels of the Chutua naals to identify the stretches that require raising of the bank and their design.</p> <p>17. Preparation of the detailed project report and relevant drawings and their submission.</p> <p>18. Presentation of the report to the</p>				

Q2

राजीव हुई / RAJIB HUI
परियोजना प्रदायिकासी / PROJECT OFFICER
कोलरे बसंतपुर पंचमी कोल परियोजना
Kotire Basantpur Pachmo Coal Mine
सी.सी.एल., राँची / C.C.L., Ranchi

S.No	Material/Work Description	Quantity	UOM	Price Details Unit Price	Amount
	Authority/ies, if required and discussion with the project authorities for finalization of the DIPR.				

राजीव हुई / RAJIB HUI
परियोजना प्रशासिका / PROJECT OFFICER
कोठरे बसन्तपुर पंचमी कोल परियोजना
Kotire Basantpur Pachmo Coal Mine
सी०सी०एल०, रैची / C.C.L., Ranchi

Preparation of Detailed Project Report of Proposed Nala diversions in "Kotre - Basantpur" Coal Mine, Hazaribag District, Jharkhand.

Scope of the work

1. To conduct reconnaissance survey of the mining area for examination of site in the respect of existing drainage system, land use land cover, type of soil, morphology of the river, hydraulic structures, etc. and also for discussion with the authorities.
2. Study of the present topography of the mining area and existing drainage system.
3. Preparation of maximum intensity-duration -frequency curve of the study area using hourly rainfall data, if the same is not available. Otherwise isopleth maps available in the CWC report and/or PMP Atlas for Ganga River Basin including Yamuna of CWC shall also be used.
4. Development of digital elevation model and drainage map of the mining areas using the developed topographical map of the area through land survey.
5. Delineation of the catchment area of the different nalas/rivers inside and outside of the mining area. Development of digital elevation model and drainage map of the areas outside of the mining area using satellite images (SRTM/Cartosat/Google engine).
6. Development of the land use and land cover map of the catchment areas of nalas inside and outside of the mining areas.
7. Study of soil map of the catchment areas of nalas inside and outside of the mining areas.
8. Estimation of peak discharge/flood hydrograph for different return periods like 25,50 and 100 years in the Kotre, Jhumra, Pachmo, Bhagriya and Chutua, nalas on the basis of hydrological analysis of the catchment area, land use pattern, topography of the area and meteorological data etc.
9. Estimation of peak discharge/hydrograph shall be carried out invoking empirical equations, rational method and unit hydrograph theory.
9. Fixing the alignment of the diversion channel on the basis of the contour map and utility plan of the mining area. Fixing the shape and size including bed slope of the channel on the basis of the peak discharge, L-section of the ground along the channel, etc.
10. Designing the lining of the diversion channel, if necessary. Design of structure/bund/embankment across the nalas to divert the flow in the diversion channel.
11. Design of suitable measures at the end of the diversion channel to avoid any degradation/aggradation in the existing nalas, if necessary.
12. Development of one-dimensional HEC-RAS model for the Chutua River from 2.5km upstream to 2.0km downstream of the mining area under the virgin condition and with diversion channel. The diversion channel shall also be modelled.
13. Running the model for the pre and post diversion scenarios with estimated peak discharge for return periods of 25,50 and 100 years for to obtain hydraulic parameters like water surface profile, velocity, bed shear stress, aggradation/degradation etc.
14. Discussion on the hydraulic parameters and morphology of the Chutua nalas to examine the pre and post diversion scenarios- impact of the diversion of the nalas on the Chutua nalas.
15. To study the impact of the diversion of the nalas on the existing structures/protection works on the Chutua river due to diversion of the nalas.
16. Examination of water surface profile vis-à-vis bank levels of the Chutua nalas to identify the stretches that require raising of the bank and their design.
17. Preparation of the detailed project report and relevant drawings and their submission.
18. Presentation of the report to the Authority/ies, if required and discussion with the project authorities for finalization of the DPR.

It is to be noted that obtaining approval of the DPR by the Engineer in Chief, Water Resource Department Ranchi, Jharkhand state shall not be a

राजीव हुई / RAJIB HUI

परियोजना प्रदाधिकारी / PROJECT OFFICER

कोलरे बसंतपुर पंचमो कोल परियोजना

Kotre Basantpur Pachmo Coal Mine

सी.सी.एल.एल., राँची / C.C.L., Ranchi

part of our scope of the work, however, we will provide all technical supports for getting approval from WRD, Ranchi.

2. Data requirements (KBP SCOPE)

- 1) Topographical map of the mining area marked with the salient features including land use along with existing nallas in the mining area.
- 2) L-section and cross-section of the existing nallas i.e., Kotre, Jhumra, Pachmo, Bhagriya and Chutua.
- 3) Details of the hydraulic structures constructed across the nallas.
- 4) Daily/hourly rainfall data, if available.
- 5) Observed maximum discharge and highest flood level in these nallas, if available.
- 6) Particle size gradation and C and ϕ of the soil.
- 7) L-section and cross-section of the ground along the alignment of the proposed diversion channel.

3. TERMS OF PAYMENT

Our consultancy charges would be plus 18% GST. This include two additional visits to the site for inspection of the topography and planning of the diversion of the nallas. Local hospitality at Ramgarh shall be provided by KBP. One staff may be deputed at Ramgarh for some period as per the requirement.

1. 50% of the amount as an advance along with the Purchase order,
2. 25% after submission of draft DPR
3. And remaining 25% after submission of the final DPR incorporating suggestions/ comments of the WRD.
4. All payment through bank draft in favor of IIT Roorkee payable at Roorkee.
5. It can also be transferred through RTGS as per attached bank details
6. TDS will be deducted from your running bills as per norms.
7. No idle payment will be made under any circumstances.

4. COMPLETION PERIOD

We will take three months for this assignment after receipt of the consultancy charges and requisite data.

Other terms and conditions:
The project work will be taken up as per IIT Roorkee Consultancy Rules and Guidelines

To the satisfaction of KBP and is unresponsive to instructions, communications, notices from site in charge or Head office KBP.

राजीव हुई / RAJIB HUI
परियोजना प्रशासिका / PROJECT OFFICER
कोतरे बसंतपुर पंचमो कोल परियोजना
Kotre Basantpur Pachmo Coal Mine
सी०सी०एल०, राँची / C.C.L., Ranchi

ACCEPTANCE/ACKNOWLEDGEMENT

We acknowledge with thanks the receipt of Sub-contract Work Order no 6000030826 from KBP MINING PVT LTD, DT: 30.07.2022..

Preparation of Detailed Project Report of Proposed Nala diversions in Kotre Basantpur Pachmo project

We hereby communicate our acceptance to all KBP MINING PVT LTD terms and conditions.

We confirm that as agreed by us we will mobilize the site and start the work immediately as advised by KBP MINING PVT LTD/site in-charge at site.

We undertake to abide by all terms and conditions enforced in this work order.

We agree that KBP MINING PVT LTD has the sole right to terminate this work order at any instant of time if any delinquency in the performance from our side is evident during the life of work order.

We also confirm that all required inputs as acceptable to KBP MINING PVT LTD will be arranged for testing as and when required during the course of work.

For and on behalf of,
INDIAN INSTITUTE OF TECHNOLOGY ROOR.

Authorized Signatory & Seal

Dr. Z. Ahmad

Professor
Dept. of Civil Engineering
Indian Institute of Technology Roorkee
ROORKEE-247 667, (U.K.), INDIA

Place: Roorkee
Date: 8/8/2022

Encl:
1. Copy of Work Order duly signed.
2. Others (If any)

राजीव हुई / RAJIB HUI
परियोजना प्रबंधिका / PROJECT OFFICER
कोतरे बसंतपुर पचमो कोल परियोजना
Kotre Basantpur Pachmo Coal Mine
सी.सी.एल., रांची / C.C.L., Ranchi

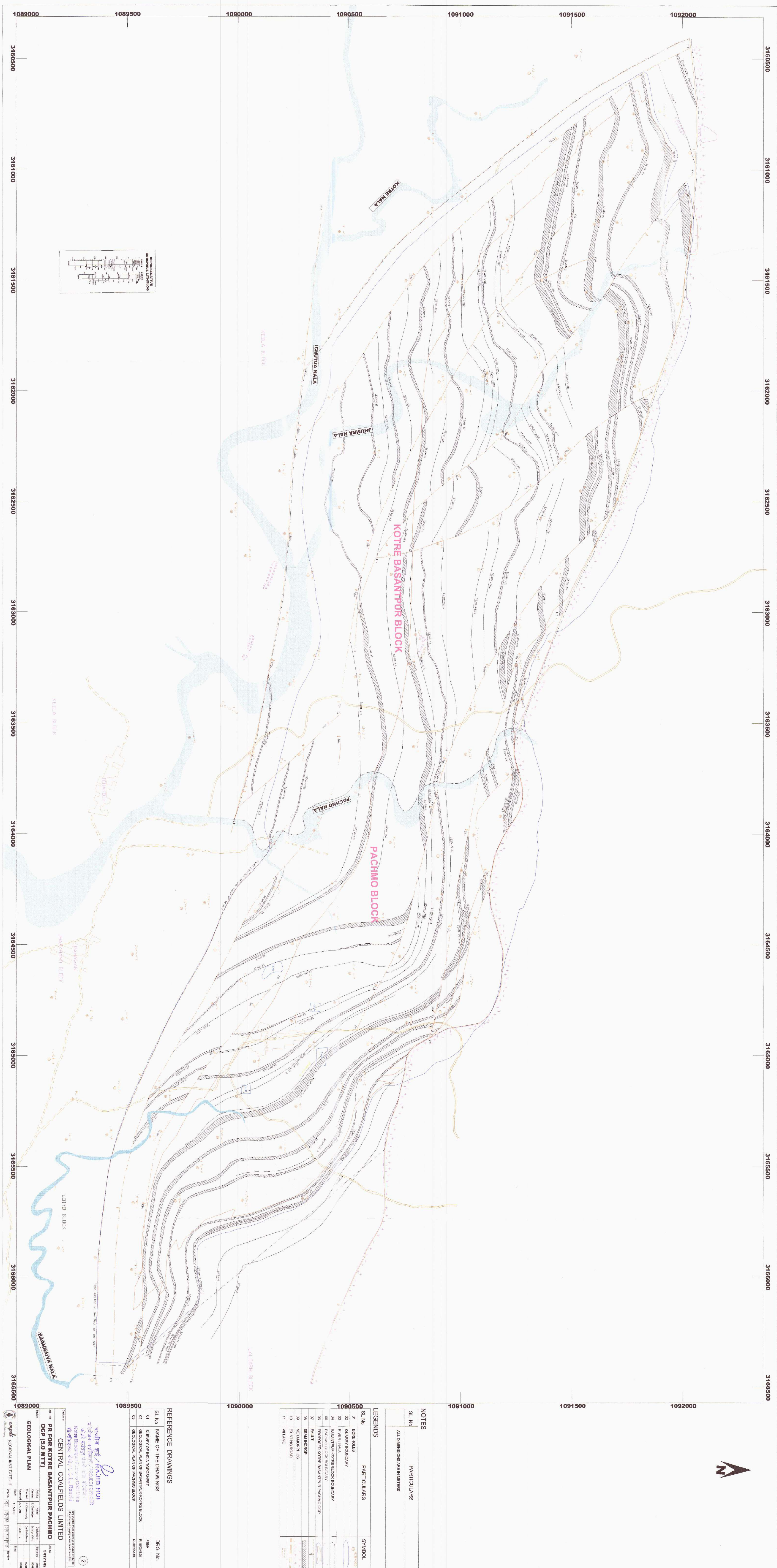

Annexure-VIII A1

Affine - $\sqrt[n]{A}$

