

परियोजना का नाम- भारतीय स्टेट बैंक के प्रशासनिक कार्यालय हेतु भवन निर्माण।

परियोजना का ले-आउट प्लान/मदवार विवरण।

S.no.	Component	Area(Sqm.)	Area(Hc.)
1	Building area	1044.99	0.1045
2	Open landscaped green area	1040.00	0.1040
3	Internal road	655.01	0.0655
4	Open ground for parking and other activities	1280.00	0.1280
	Total Area	4020.00	0.4020

● भारतीय स्टेट बैंक

उप-महाप्रबन्धक (बि०परि०)
प्रशासनिक कार्यालय, हल्द्वानी

THIS DRAWING IS AN INSTRUMENT OF PROFESSIONAL SERVICE AND SHALL REMAIN THE PROPERTY OF THE ARCHITECT. IT IS TO BE USED FOR THE PROJECT FOR WHICH IT IS PREPARED AND FOR NO OTHER PURPOSES. ANY REUSE, REPRODUCTION, OR ALTERATION OF THIS DRAWING WITHOUT THE WRITTEN CONSENT OF THE ARCHITECT IS STRICTLY PROHIBITED. THIS DRAWING SHALL NOT BE REPRODUCED BY ANYONE ON OTHER PROJECTS. FOR ADDITIONS TO THIS PROJECT, OR FOR COMPLETION OF THIS PROJECT BY OTHERS WITHOUT WRITTEN CONSENT.

All Units in Imperial
Format (Feet and Inches)
unless mentioned
otherwise

Sheet Title:
SITE PLAN
Category- Plans

AO Haldwani
(OFFICE BUILDING)

Client Name :
DGM
SBI Haldwani

M/s APID
Architects Planners Interior Designers
Phone- 9454011356
Fax: 9873 644 009
URL: www.apid.in
E-mail: info@apid.in

Office:
Eco Town
Phase 1, Chan
Mill
Haldwani
Uttarakhand
261319, UK
22/ G-13,
Kampur
Garden
Bareilly,
Uttarakhand
245001 UP



Drafted By:
A. Pandey
Drawing No.
AR-349
Checked By:
S. Suman
Sheet No:
01
Plot Date:
18 April 2017

Component	Formula	Remarks	Area	Remarks
Total Plot Area	A	Property is situated on an approx 12 metre wide road	4020 Sq Mt	
Road Widening	B		NIL	
Net Plot Area	C = A - B		4020 Sq Mt	
Ground Coverage	D	40%	28%	COMPLIED
Front Set Back	E =	12 Run Mt	17.50 Run Mt	COMPLIED
Rear Set Back	F	6 Run Mt	48 Run Mt	COMPLIED
Side Set Back	G	6 Run Mt	6 Run Mt	COMPLIED
Floor Space Index (FSI)	H	2.20	0.80	COMPLIED
Floor Area Ratio (FAR)				
Building Plinth	I	0.45 Run Mt	0.90 Run Mt	COMPLIED
Building Height	J	12 Run Mt	8.20 Run Mt	COMPLIED
Floor to Floor Height	K	3 Run Mt	3.65 Run Mt	
Covered Area on Ground Floor (as part of FSI)			813 Sq Mt	Two Double Height Entrance Foyer of 21.84 Sq Mt (DGM Secretariat) and 43.50 Sq Mt (Region Block) have been deducted from Floor Area
Covered Area on Ground Floor (relaxed from FSI)	L		231.99 Sq Mt	
Covered Area on First Floor (as part of FSI)	M		878.34 Sq Mt	Two Double Height Entrance Foyer of 21.84 Sq Mt (DGM Secretariat) and 43.50 Sq Mt (Region Block) have been added to Floor Area
Covered Area on First Floor (relaxed from FSI)	N		149.92 Sq Mt	
Covered Area on Terrace Floor (as part of FSI)	O		NIL	
Covered Area on Terrace Floor (relaxed from FSI)	P		141.61 Sq Mt	
Net Covered Area (as part of FSI)	Q = K + M + O		1691.34 Sq Mt	
Net Covered Area (relaxed from FSI)	R = L + N + P		533.42 Sq Mt	
Total Covered Area	S = Q + R		2224.76 Sq Mt	Area Summation for Cost Calculation
Parking Required- ECS	T	43	55	Norms specify 2.5 ECS per 100 Sq Mt of Covered Area- which is part of FSI. The Design Proposal has an Open Parking Area of 1280 Sq Mt
Open Landscaped Green Area	U		1040 Sq Mt	Approx 25% of the Entire Site Area
Area designated as Proposed Internal Roads	V = A - (K+L+T+U)		655.01 Sq Mt	Approx 16% of Entire Site Area
Summarized COVERED AREA of the Project	W = (K+L)		1044.98 Sq Mt	Approx 26% of Total Site Area
Summarized OPEN AREA of the Project	X = (T+U+V)		2975.01 Sq Mt	Approx 74% of the Total Site Area

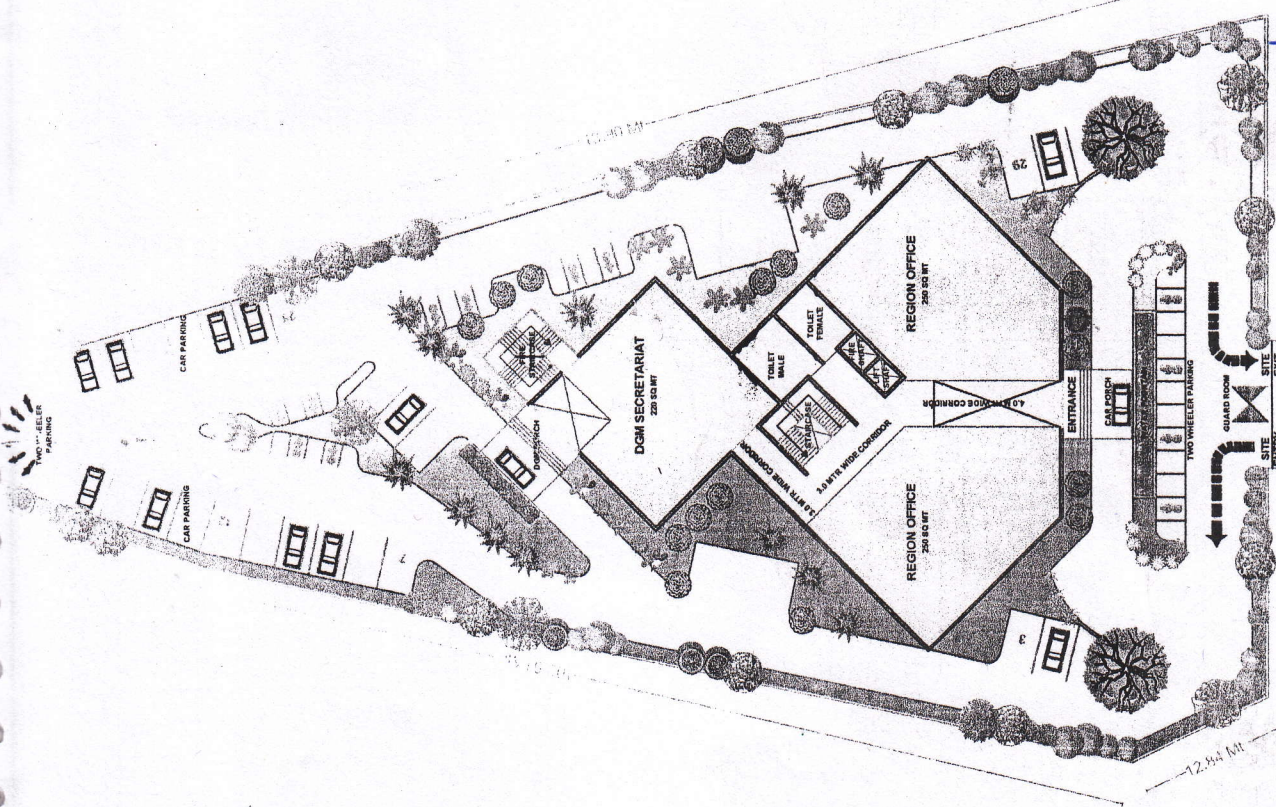

भारतीय स्टेट बैंक
उप-महाप्रबन्धक (बैंगरि)
प्रशासनिक कार्यालय, हल्द्वानी

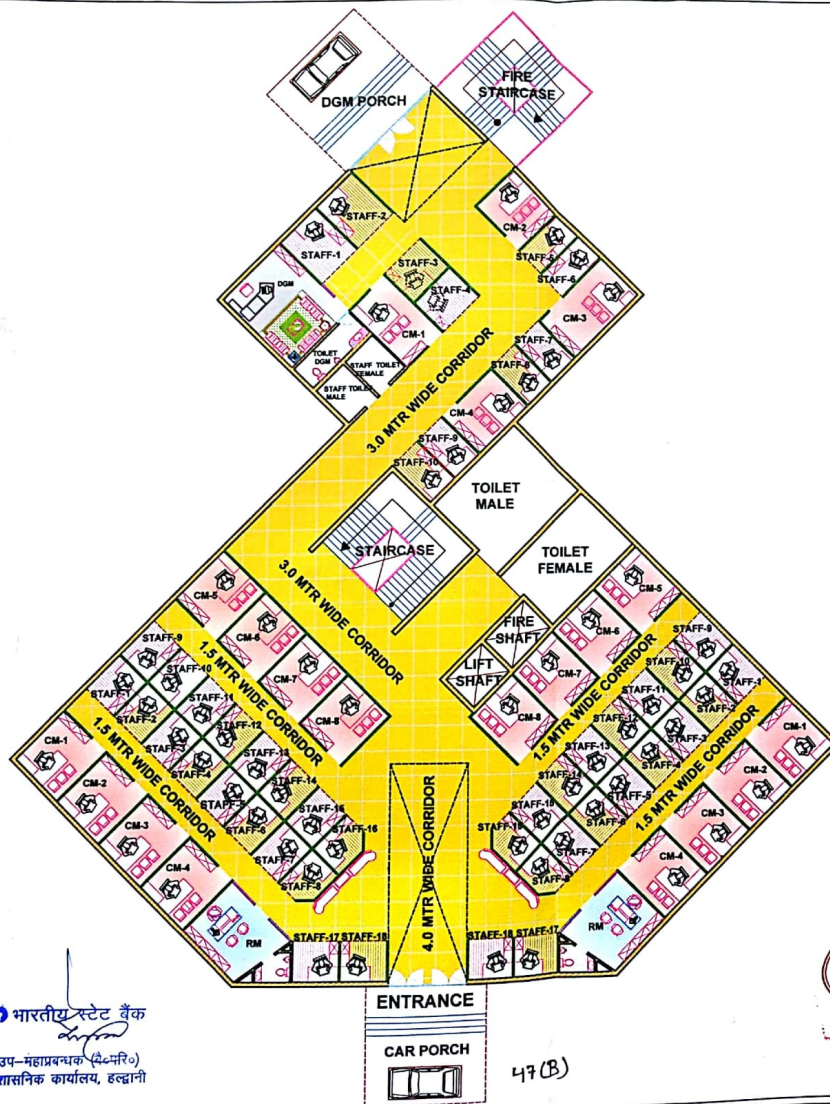

भारतीय स्टेट बैंक
उप-महाप्रबन्धक (ऑपरि०)
प्रशासनिक कार्यालय, हल्द्वानी



THIS DRAWING IS NOT
DRAWN TO SCALE
All rights reserved.

THIS DRAWING IS AN INSTRUMENT OF
PROFESSIONAL SERVICE AND SHALL
REMAIN THE PROPERTY OF THE
ARCHITECT. WHETHER THE PROJECT
FOR WHICH IT IS PREPARED IS
EXECUTED OR NOT, NO CHANGES,
ALTERATIONS, ADDITIONS, OR
DELETIONS MAY BE MADE EXCEPT BY
THE ARCHITECT. THIS DRAWING SHALL
NOT BE REPRODUCED BY ANYONE ON
OTHER PROJECTS, FOR ADDITIONS TO
THIS PROJECT, OR FOR COMPLETION
OF THIS PROJECT BY OTHERS WITHOUT
WRITTEN CONSENT.

All Units in Imperial
Format (Feet and Inches)
unless mentioned
otherwise

Sheet Title:
**Ground Floor
Plan**
Category: Plans

AO Haldwani
(OFFICE BUILDING)

Client Name :
**DGM
SBI Haldwani**

M/s APID
Architects Planners Interior Designers
Phone: 9454 011 354
Fax: 9873 444 009
URL: www.apid.in
E-mail: info@apid.in

• OFFICE:
Eco Town
Phase 1, Dham
Jail
Haldwani,
263129, UK
• 22/ G-13,
Rampur
Garden
Bareilly,
243001 UP



Drafted By:
A. Pandey
Drawing No.
AR-349

Checked By:
S. Suman
Sheet No:
02

Plot Date:
28 March 2017

भारतीय स्टेट बैंक
सुप-महामन्थक (वि.प.रि.)
प्रशासनिक कार्यालय, हल्द्वानी

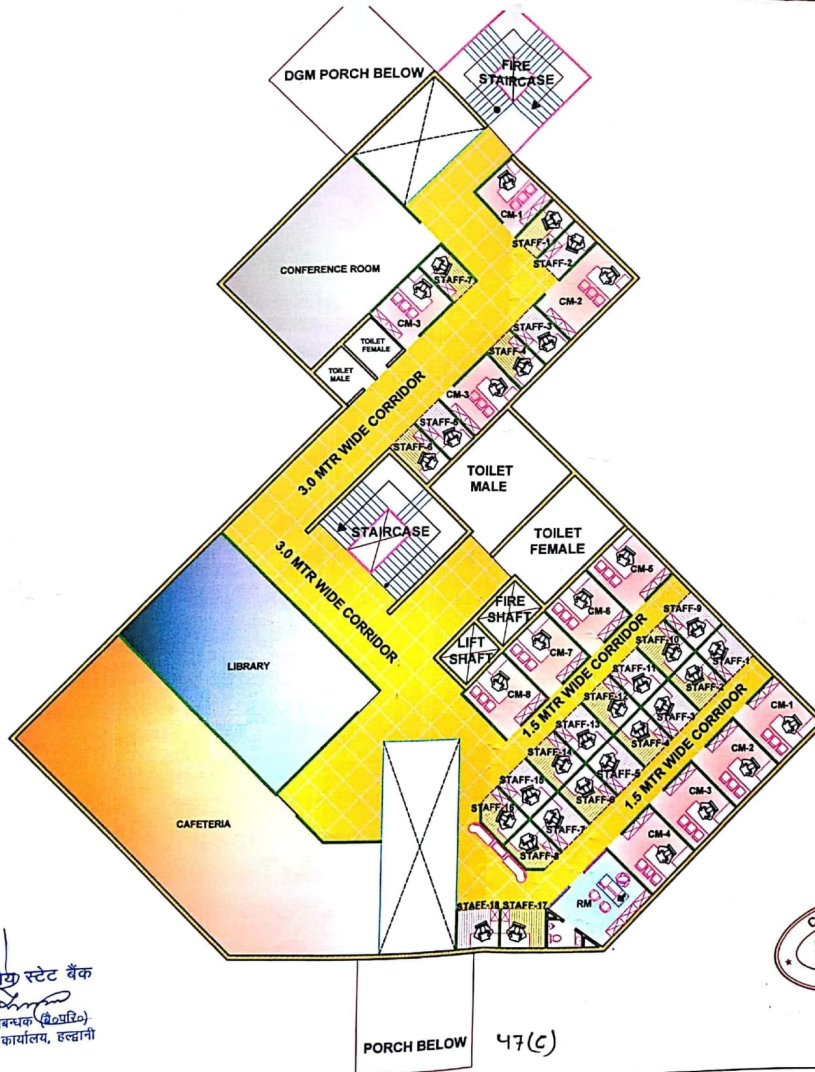

ALL RIGHTS RESERVED.
THIS DRAWING IS AN INSTRUMENT OF PROFESSIONAL SERVICE AND SHALL REMAIN THE PROPERTY OF THE ARCHITECT WHATEVER THE PROJECT FOR WHICH IT IS PREPARED IS EXECUTED OR NOT. NO CHANGES, ALTERATIONS, ADDITIONS, OR DELETIONS MAY BE MADE EXCEPT BY THE ARCHITECT. THIS DRAWING SHALL NOT BE REPRODUCED BY ANYONE ON OTHER PROJECTS, FOR ADDITIONS TO THIS PROJECT, OR FOR COMPLETION OF THIS PROJECT BY OTHERS WITHOUT WRITTEN CONSENT.

All Units in Imperial Format (Feet and Inches) unless mentioned otherwise

Sheet Title:
First Floor Plan
Category- Plans

AO Haldwani
(OFFICE BUILDING)

Client Name :
DGM
SBI Haldwani

M/s APID
Architects Planners Interior Designers
Phone - 9454 011 356
Fax 9873 644 009
URL: www.apid.in
E-mail: info@apid.in

CHARGE:-
Eco Town
Phase 1, Dham
NAB
Haldwani,
263139, UK
22/ G-13,
Rangpur
Garden
Bareilly,
243001 UP



Drafted By: A. Pandey	Checked By: S. Sumran
Drawing No. AR-349	Sheet No. 03
Plot Date: 28 March 2017	

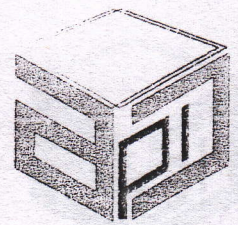

Executive Summary

State Bank of India, India's Largest Bank, also serves as the Backbone of India's growing and enterprising next generation economy.

Its Administrative Office at Haldwani monitors and services through 5 Subordinate Regions looking after 174 Branches spread across Eight Districts of Nainital, Udham Singh Nagar, Almora, Chamoli, Champawat, Pithoragarh and Bageshwar.

A Design Exercise for an upcoming New OFFICE BUILDING CAMPUS of the Administrative Office- Haldwani (AO- Haldwani) is currently at the Proposal Stage.

APID, an Architectural Practice, located at Haldwani is submitting a Design Proposal of Two Storey Building of Project Cost INR 350 Lakh for a 2100 Square Metre Floor Area comprising a DGM Secretariat + 3 Region Offices and a Conference Section having a Project Cost of **INR 609.31 Lakh or Rupees Six Crore Nine Lakh** approx including taxes.

Component	Alphabetic Formula	Amount (INR)
Building Construction Cost	A	55286277
Site Development Cost	B	1658588
Total Construction Cost	$C = A + B$	56944865
Labour Cess	D	569448.7
Service Tax	E	3416692
Total Cost of Project	$F = C + D + E$	60931006

For APID
Kamika
Proprietor 28/3/17

भारतीय स्टेट बैंक

उप-महाप्रबन्धक (बैंक)
प्रशासनिक कार्यालय, हल्द्वानी

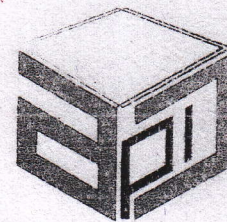

1. Project Primer

1.1 Project General Information

Field	Detail
Project Type	Office Building
Project Name	Administrative Office- Haldwani
Client	Deputy General Manager AO Haldwani- State Bank of India Kaladhungi Road, Kusumkheda Haldwani, Dist- Nainital (Uttarakhand)
Email	dgm.zohld@sbi.co.in
Phone	05946 260593
Fax	05946 260593
Location	Gaulapaar- Near CRPF Group Centre and Opposite Commercial Tax Building- Haldwani
Site Area	4020 Sq Mtr
Building Construction Technology	Earthquake Resistant, RCC Frame Building
Building Design Description	Principle of Green Building ¹ Design- Environment Friendly use of Building Materials and Energy Conservation
Building Height	Two Storey Building- Ground + First Floor with at Grade Parking as per Norms
Building Compliance	<ul style="list-style-type: none">Uttarakhand Building Bye Laws and Regulations 2011- Amendment 2016National Building Code 2005<ul style="list-style-type: none">CPWD - A Handbook of Planning of Office BuildingHandbook on Green Building Planning and Design- 2013- Indian Green Building Council (IGBC)

भारतीय स्टेट बैंक

उप-महाप्रबन्धक (ऑफिस)
प्रशासनिक कार्यालय, हल्द्वानी

¹ Consultants are Accredited Professional of Indian Green Building Congress

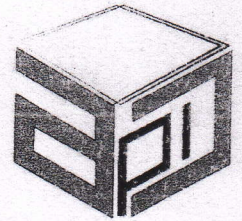

1.2 Project Design & Area Statement

as per "Uttarakhand Building Bye Laws and Regulations 2011- Amendment 2016"

Component	Alphabetic Formula	As per Rule	Actual	Remarks
Total Plot Area	A		4020 Sq Mt	
Road Widening	B		NIL	Property is situated on an approx 12 metre wide road
Net Plot Area	C= A		4020 Sq Mt	
Ground Coverage	D	40%	28%	COMPLIED
Front Set Back	E	12 Run Mt	17.50 Run Mt	COMPLIED
Rear Set Back	F	6 Run Mt	48 Run Mt	COMPLIED
Side Set Back	G	6 Run Mt	6 Run Mt	COMPLIED
Floor Space Index (FSI)/	H	2.20	0.80	COMPLIED
Floor Area Ratio (FAR)				
Building Plinth		0.45 Run Mt	0.90 Run Mt	COMPLIED
Building Height	I	12 Run Mt	8.20 Run Mt	COMPLIED
Floor to Floor Height	J	3 Run Mt	3.65 Run Mt	
Covered Area on Ground Floor (as part of FSI)	K		813 Sq Mt	Two Double Height Entrance Foyer of 21.84 Sq Mt (DGM Secretariat) and 43.50 Sq Mt (Region Block) have been deducted from Floor Area
Covered Area on Ground Floor (relaxed from FSI)	L		231.99 Sq Mt	
Covered Area on First Floor (as part of FSI)	M		878.34 Sq Mt	Two Double Height Entrance Foyer of 21.84 Sq Mt (DGM Secretariat) and 43.50 Sq Mt (Region Block) have been added to Floor Area
Covered Area on First Floor (relaxed from FSI)	N		159.82 Sq Mt	Comprising Building Staircase Mummy + Lift Room which are relaxed

(50)

भारतीय स्टेट बैंक

उप-महाप्रबन्धक (बैंकिंग)
प्रशासनिक कार्यालय, हल्द्वानी

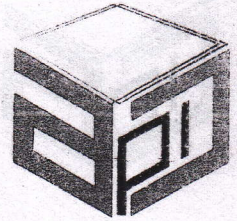

Component	Alphabetic Formula	As per Rule	Actual	Remarks
				from BOTH the Covered Area and Building Height
Covered Area on Terrace Floor (as part of FSI)	O		NIL	
Covered Area on Terrace Floor (relaxed from FSI)	P		141.61 Sq Mt	
Net Covered Area (as part of FSI)	$Q = K + M + O$		1691.34 Sq Mt	
Net Covered Area (relaxed from FSI)	$R = L + N + P$		533.42 Sq Mt	
Total Covered Area	$S = Q + R$		2224.76 Sq Mt	Area Summation for Cost Calculation
Parking Required-ECS	T	43	55	Norms specify 2.5 ECS per 100 Sq Mt of Covered Area- which is part of FSI The Deign Proposal has an Open Parking Area of 1280 Sq Mtr
Open Landscaped Green Area	U		1040 Sq Mt	Approx 25% of the Entire Site Area

1.3 Abstract of Costs

The Guideline Handbook "CPWD Plinth Area Rates 2012" has been referred to while deciding the Building Specifications. It is worth mentioning that the Plinth Area Rates 2012 generalise Construction Costs for a RCC Building upto 6 Storey High and therefore are at INR 23500 per Sq Mt.

Based on our rich experience of over 8 years, we analyse that the Actual Project Costs on Prepration of Detailed Estimate and after Technical Bidding for Selection of Turnkey Contractor would be far less that the Aforementioned Plinth Area Rates.

Cost Index for Haldwani has been added as 4.90% increasing the Basic Cost to INR 24651 per Sq Mt.

The Work Package can be divided into the following two major Classes

(51)

भारतीय स्टेट बैंक
उप-महाप्रबन्धक (बि०परि०)
प्रशासनिक कार्यालय, हल्द्वानी