

SECTION A-A
U/S RETURN WALL

SECTION B-B
U/S WING WALL

SECTION C-C
ABUTMENT

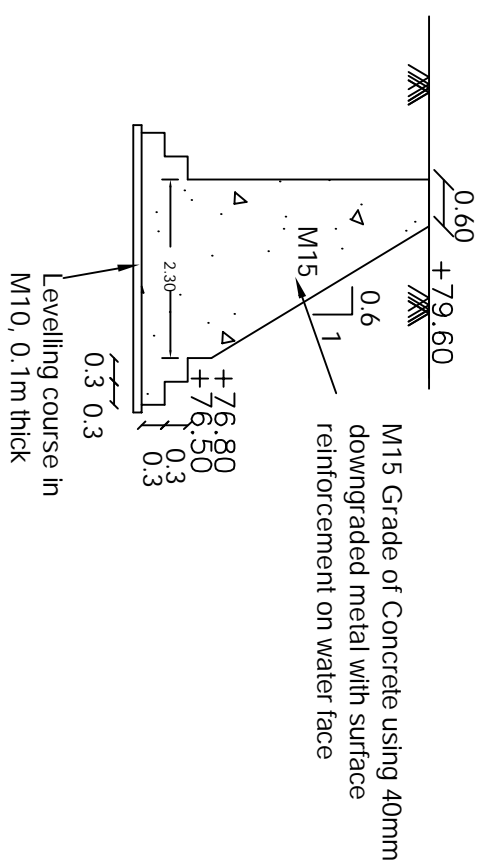
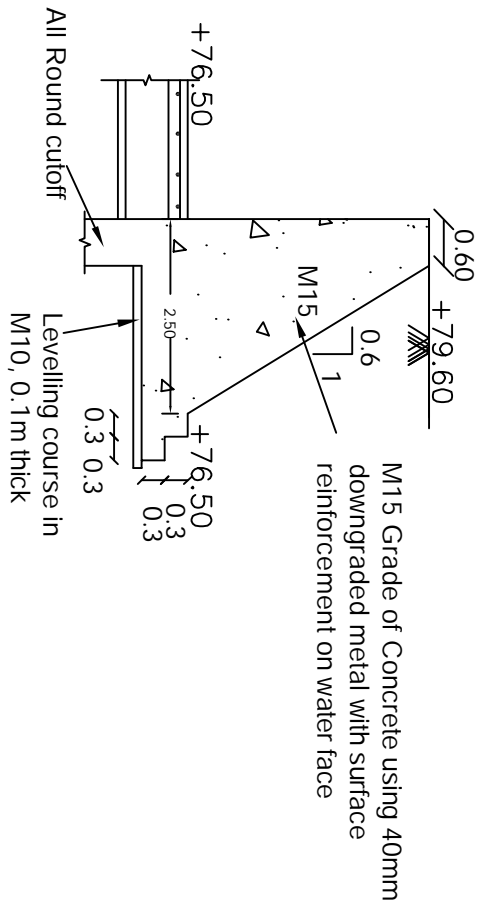

SECTION D-D
D/S WINGWALL

SECTION E-E
D/S RETURN WALL

- Note:
1. All dimensions are in metres unless specified.
 2. This drawing should be read along with drawings T.No /2020 and T.No. /2020

NOTES :-

1. This drawing is drawn based on the hydraulic particulars of Drop - 1 @ LS 6835m in Malattar Channel
2. This drawing shall be adopted for the Drop - II @ LS 8840 m in Malattar Channel with the relevant hydraulic particulars

NAME OF WORK:

Improvements to Malattar channel fro Tirukoilur Anicut offtake point OM to 24000M Tirukoilur & Ulundurpet Taluk of Villupura District - Reconstruction of 0.80M DROP @ 1 6835 M

Designed drawing of:

C/S of Abutment, Wing walls & Return Walls