

## Annexure-18

Details of non-forest land / degraded forest area identified for compensatory afforestation viz.. Survey No. / Compartment No. / Khasra No./ Khatoni No. Village, Tehsil, District etc. along with map in appropriate scale showing the boundaries of adjoining forest areas with their use in distinct colours and GPS readings.

Sr.No.	Details	Description
1	Village	Mahuda
2	Taluka	Danta
3	District	Banaskantha
4	Survey No/Compartment No./Khasra No.	57 pt.
5	Area To be Afforested	1.00 Ha.
6	Name of Range	Ambaji-south
7	Name of Division	Banaskantha
8	G.P.S. Location With Longitude & Latitude of Proposal	Attached herewith

Place : Palanpur

Date : 1 / 6 / 2019

(Dr. G. S. Singh, IFS)

Dy. Conservator of Forests,  
Banaskantha Palanpur

O/C  
atm



Village: Mahuda  
Taluka: Danta  
Dist.: Banaskantha  
Survey no.: 57/pt.  
Ha: 1.00  
Range: Ambaji-South

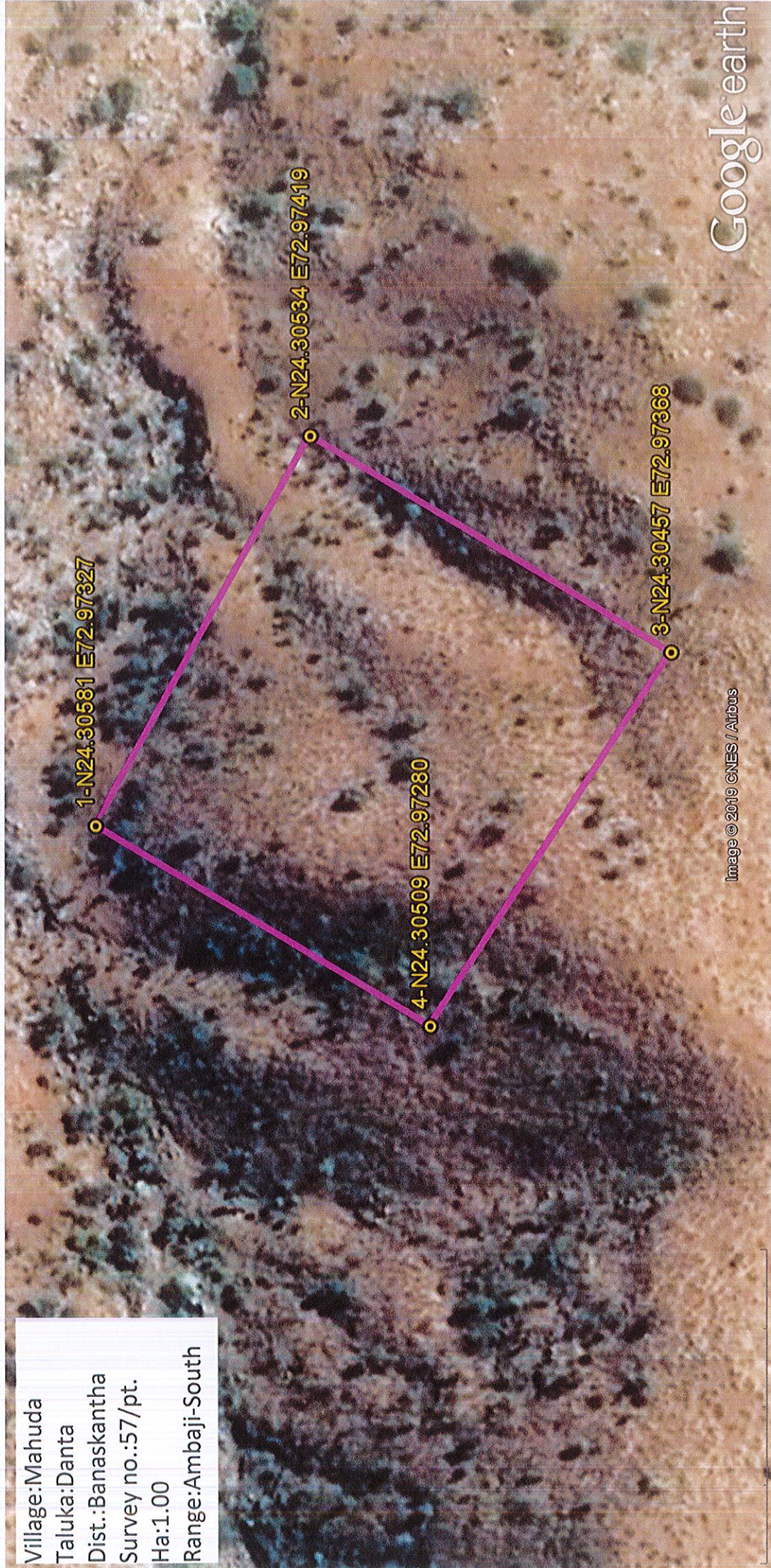

Google earth

Deputy Conservator of Forests  
Banaskantha, Palanpur.

2/1  
2/3



## Scheme of Compensatory Afforestation

Detailed of Degraded scheme Compensatory Afforestation to be carried out in lieu of 1.00 ha. of Forest land to Diversion of 0.250 ha. Proposal for grant of permission for laying Optical Fiber Cable along the routes mentioned here under (0.250 ha.) Ambaji to Aburoad of Forest Land for the purpose of Optical Fiber Cable.

(1) Details of Degraded forest land. :-  
 Village: Mahuda  
 District: Banaskantha. Taluka: Danta  
 Name of Forest Division: Banaskantha. Range: Ambaji-South  
 Block/Compartment./Survey No.: 57/pt  
 Area to be Afforested : 1.00 Ha

(2) Description of Area:  
 Soil type: Hard Murram  
 Topography: medium  
 Hilly/Plain/Slope-Steep/medium/gentle.

Whether the area is bearing any root stock or Vegetation : 10 % Root Stock

(3) Name of Plantation Programme: Model No.2 833+25=858 Pits/ha.

(4) Schedule of Plantation programme:

The Compensatory Afforestation on Degraded forest land would be started by Dy.Conservator of Forest Banaskantha Division Palanpur as early as possible after the proposal is formally approved.

Details of Yearwise break-up of requirement of fund is as under:

(Daily wage: Rs.304.20)

Year	Area	Rate per Ha.	Total Amount.
0 Year	1.0000	112444	112444
1 Year	1.0000	38908	38908
2nd Year	1.0000	25133	25133
3rd Year	1.0000	19099	19099
4th Year	1.0000	7533	7533
5th year	1.0000	4768	4768
6th year	1.0000	4768	4768
7th year	1.0000	4768	4768
8th year	1.0000	4768	4768
9th year	1.0000	4768	4768
10th year	1.0000	4768	4768
Total		231725	231725
Supervision Charge 20 %		46345	46345
Grand Total		278070	278070

The user agency has given undertaking to pay the cost of compensatory Afforestation as per the prevailing wages. (Including the price escalation and supervision charges)



## (5) Technical Details :

Technical Details of Compensatory Afforestation are as follows :

- |   |  |
|---|--|
| (a) General Details:                                | Size of Pit: 45x45x45 cmt (833+25 Pits/ha.) Protection wall & trench contour trench, Gully Plugging, Nala bunding etc SMC work.  |
| (b) Spacement                                       | 4 x 3 mt Alignment & Staking.  |
| (c) Species   | Small timber, Fuelwood & MFP Species such ad Ficus benghalensis, Ficus religiousa, Tamarindus indica, Ficus glomerata, Cordia dichotoma and Azadirachta indica etc.  |
| (d) Nursery Technique                               | 60 cms Tall Plants raised is poly pots of size 15 cm x 25 cm x 200 g. To be Planted in the 30 cms 3 pits on omet of the monsoon.   |
| (e) Site Prepartion.                                | Existing malformed tree growth and illcitey cut stools will be cut back in the month of February / March. Pits of 0.45 cms x 0.45 cms x 0.45 cms will be dug. As per the site gully plugging Nala Bunding contour trenches. Construction of Van talavadi. Small Check dams to be done for Soil Conservation and Water Harresting measures. |
| (f) Plantation Method (Size of Pit, Ploughing etc.) | BHC 50% Powder of Aldrin 30 EC is into be used for antiermite treatment and NPK fertilized @ 10 gram pits is applied as abase before planting. 9 months old seedings raised in 15 cm x 25 cm x 200 g. of polypot will be Planted with on set of rains.   |
| (g) SMC Work  | Gully plugging- Nala bunding (20-30 cmt) vantalavadi, Check Dams-1 Contour trench -500 RMT Etc.  |
| i) Protection.                                      | Peripherel trench 120 cm x 60 cm top will be created around the plantation and three rows of prosopis and puwad seeds along with bulbbil. or jatropa or ipomea cuttings will be planted on the dug up soil for convenience of work. Pot size would be 25 ha or over  |
| (i) Silvicultural operations                        | Fence repair Cleaning pruning and unkeep of planted and naturally regenerated saplings will be done through castral naturally regenerated will be done through casual labour till the end of 4 th year   |
| (j) Maintenance                                     | Repair & Maintenance of fence & Protection   |

(k) Subsequent silvicultural  
Operations Proposed such as  
Cleaning, cutbacks, thinning  
etc

As per specific requirement

(l) Proposed, Monitoring,  
Mechanism

Monitoring done by Block wise Area.

Note: This project has been prepared keeping the current daily wage rate into consideration. The maintenance of plantation upto 10th year is subject to budget provision as per prevailing wage rate from time to time

  
(Dr. G. S. Singh, IFS)  
Dy. Conservator of Forests  
Banaskantha-Palanpur

O/C  



# Model No - 2

## Annexure-3 (1)

### Compensatory Afforestation Scheme for double degradation areas & NPV Palntations

Daily wages Rs.304.20

213

Spacements = 4 m x 3 m				
833+25=858 seedling / Ha				
1st year replacement 10 % = 86 seedling /ha				
2nd year replacement 20 % = 86+86 seedling /ha				
3rd year replacement 10 % = 86 seedling /ha				
Total Seedlings = 1202 seedling /ha				
Polypot size : 20 cm x 30 cm x 250 g for 25 Deshi Mango seedlings and for other seedlings 15 cm X 25 cm X 200				
Item of work	Qty.	Labour	Material	Total
1	2	3	4	5
<b>0 year</b>				
Nursery				
(a) Cost of soil, ,manure, seeds, water, fertilizer, insecticides, implements, rent of lands. Shade, etc. (including 10 % for casualty replacement)	944	0	1260	1260
(b) labour : Preparation of beds, filling and arranging of bags,showing of seeds, watering shifting, weeding etc.	944	3083	177	3260
(c ) Seedling cost for casualty replacement in one year old (20%)	172	977	291	1268
(d) Seedling cost for casualty replacement in two year old (10%)	86	490	145	635
<b>Total</b>		<b>4550</b>	<b>1873</b>	<b>6423</b>
<b>2. Area Development ( Land Preparation )</b>				
(a) Survey, cutback and promotion of root suckers		2997	38	3035
(b) Aligment and digging of pits 0.45 X 0.45 X 0.45	833 @ 6.00	6489	0	6489
(c) Aligment and digging of pits 1 m X 1 m X 1 m	25 @ 63.00	2503	0	2503
<b>Total</b>		<b>11989</b>	<b>38</b>	<b>12027</b>
(a) Natural fertilizer (Neem cake/ Castor cake)	858 @ 5.00	0	5165	5165
<b>Total</b>		<b>0</b>	<b>5165</b>	<b>5165</b>
<b>3. SMC Works</b>				
(a) Check wall/ retaining wall /checkdem (all pucca only)	L.S.	12238	24317	36555
(b) Contour trench 2 M x 45 Cm x 30 Cm as per Rs.17.00/rmt (300 trench)	600 rmt.	16354	0	16354
<b>Total</b>		<b>28592</b>	<b>24317</b>	<b>52909</b>
<b>4. Protection</b>				
(a) Barbed wire fencing	L.S.	3179	31787	34966
(b) Seed sowing and planting of cuttings of Ipomea/ Glaricidia along the fence		636	318	954
<b>Total</b>		<b>3815</b>	<b>32105</b>	<b>35920</b>
<b>Sub Total of 0 year</b>		<b>48946</b>	<b>63498</b>	<b>112444</b>
<b>1st Year</b>				
(a) Maintenance of nursery (April to June)	715	1491	149	1640
(b) Transport of seedling for plantation	650	901	186	1087
(c) Planting with khamna of Min 1 m dia	650	2767	0	2767
(d)Transport of seediling for casualty replacement	65	96	21	117
(e) 3 weeding cum soil working	650	10786	0	10786
(f) Support watering 5 times @ 3.25		6402	10386	16788
(g) Protection / tending operation		3815	0	3815
(h) Tending to natural vegetation		954	0	954
(i) Contingency		0	954	954
<b>Total for 1st year</b>		<b>27212</b>	<b>11696</b>	<b>38908</b>



Item of work	Qty.	Labour	Material	Total
<b>2nd Year</b>				
(a) 2 weeding & soil working		5529	0	5529
(b) 20 % Casually replcement, transport and planting	65+65	95	458	553
(c) Natural fertilizer (neem cake / caster cake ) etc.	Rs.5/ plant	0	5165	5165
(d ) Support watering 3 times @ 3.25		4102	5970	10072
(e) Protection / tending operation		3815	0	3815
<b>Total for 2nd year</b>		<b>13541</b>	<b>11593</b>	<b>25134</b>
<b>3rd Year</b>				
(a) 2 weeding & soil working		5529	0	5529
(b) 10 % Casually replcement, transport and planting	65	48	229	277
(c) Natural fertilizer, neem cake etc.	Rs.5/ plant	0	5165	5165
(d ) Support watering 1 times @ 3.25		1380	1979	3359
(e) Protection & maintenance of fencing / tending operation	L.S.	4768	0	4768
<b>Total for 3rd year</b>		<b>11725</b>	<b>7373</b>	<b>19098</b>
<b>4thYear</b>				
(a) 1 weeding & soil working		2765	0	2765
(b) Protection & Maintenance of fencing/ Tending operation	L.S.	4768	0	4768
<b>Total for 4th year</b>		<b>7533</b>	<b>0</b>	<b>7533</b>
<b>5thYear</b>				
Protection & maintenance of fencing/ tending operation	L.S.	4768	0	4768
<b>Total for 5th year</b>		<b>4768</b>	<b>0</b>	<b>4768</b>
<b>6thYear</b>				
Protection & maintenance of fencing/ tending operation	L.S.	4768	0	4768
<b>Total for 6th year</b>		<b>4768</b>	<b>0</b>	<b>4768</b>
<b>7thYear</b>				
Protection & maintenance of fencing/ tending operation	L.S.	4768	0	4768
<b>Total for 7th year</b>		<b>4768</b>	<b>0</b>	<b>4768</b>
<b>8thYear</b>				
Protection & maintenance of fencing/ tending operation	L.S.	4768	0	4768
<b>Total for 8th year</b>		<b>4768</b>	<b>0</b>	<b>4768</b>
<b>9thYear</b>				
Protection & maintenance of fencing/ tending operation	L.S.	4768	0	4768
<b>Total for 9th year</b>		<b>4768</b>	<b>0</b>	<b>4768</b>
<b>10thYear</b>				
Protection & maintenance of fencing/ tending operation	L.S.	4768	0	4768
<b>Total for 10th year</b>		<b>4768</b>	<b>0</b>	<b>4768</b>
<b>G.Total</b>		<b>137565</b>	<b>94160</b>	<b>231725</b>

**Note :-**

- (1) Seed sowing along fencing towards the inner side, and also in the plot.
- (2) Planting of cutting of ipomea//Glarcidia along the fencing towards outer side.
- (3) Planting of 25 seedling of Deshi Mango in a pit size of 1 m x 1 m x 1 m along the boundary of the plot.

  
 (Dr. G. S. Singh, IFS)  
 Dy. Conservator of Forests  
 Banaskantha-Palanpur

  
 O/C  
 Don



## ***CERTIFICATE***

This is to certify that the compensatory afforestation scheme attached herewith for 1.00 ha in Mahuda Village, Ta. Danta, Survey No. 57pt. in lieu 0.250 ha. diversion of Forest land Proposal for grant of permission for laying Optical Fiber Cable along the routes mentioned here under (0.250 ha.) Ambaji to Aburoad with the guidelines issued vide additional Principal Chief Conservator of Forests, Land Gujarat State Gandhinagar Letter No. land/31/b/147-216/2016-17, Dated.06/04/2016 and same is here by approved technically.

Palanpur

Date: 1 / 6 / 2019

  
(Dr. G. S. Singh, IFS)  
Dy.Conservator of Forests,  
Banaskantha-Palanpur







**Annexure-20****CERTIFICATE**

This is to certify that I have visited 141.6408 ha. area of Mahuda Village of Ambaji-South Range degraded forest (for taking up 1.00 ha. of CA), Survey No.57pt. Mahuda Village, Ta. Danta, Dist. Banaskantha on dt.13/05/2019 (Date) which has been identified for compensatory Afforestation Scheme against the Diversion 0.250 ha. Proposal for grant of permission for laying Optical Fiber Cable along the routes mentioned here under (0.250 ha.) Ambaji to Aburoad of Forest land the side area is suitable for compensatory afforestation. It is also certified that the compensatory afforestation scheme suggested in the area is in consonance with the Site specific treatment Requirements.

Place : Palanpur  
Date: 1 / 6 / 2019

  
(Dr. G. S. Singh, IFS)  
Dy. Conservator of Forests,  
Banaskantha-Palanpur

o/c  



Detailed of Degraded scheme Compensatory Afforestation to be carried out in lieu of 1.00 ha. of Forest land to Diversion of 0.250 ha. Proposal for grant of permission for laying Optical Fiber Cable along the routes mentioned here under (0.250 ha.) Ambaji to Aburoad of Forest Land for the purpose of Optical Fiber Cable.

Sr.No.	Name of Village	Taluka	District	Survey No.	C.A. Area to be carried out for this proposal ha.
1	Mahuda	Danta	Banaskantha	57/pt	1.0000

  
 (Dr. G. S. Singh, IFS)  
 Dy. Conservator of Forests,  
 Banaskantha-Palanpur



Detailed of Degraded scheme Compensatory Afforestation to be carried out in lieu of 1.00 Ha. of Forest land to Reliance jio Infocomm Limited,Ahmedabad.Proposal For Diversion 0.250 Ha. Forest Land For The Purpose of Optical fiber cable.

Village:Mahuda  
Taluka:Danta  
Dist.:Banaskantha  
Survey no.:57/pt.  
Ha:1.00  
Range:Ambaji-South

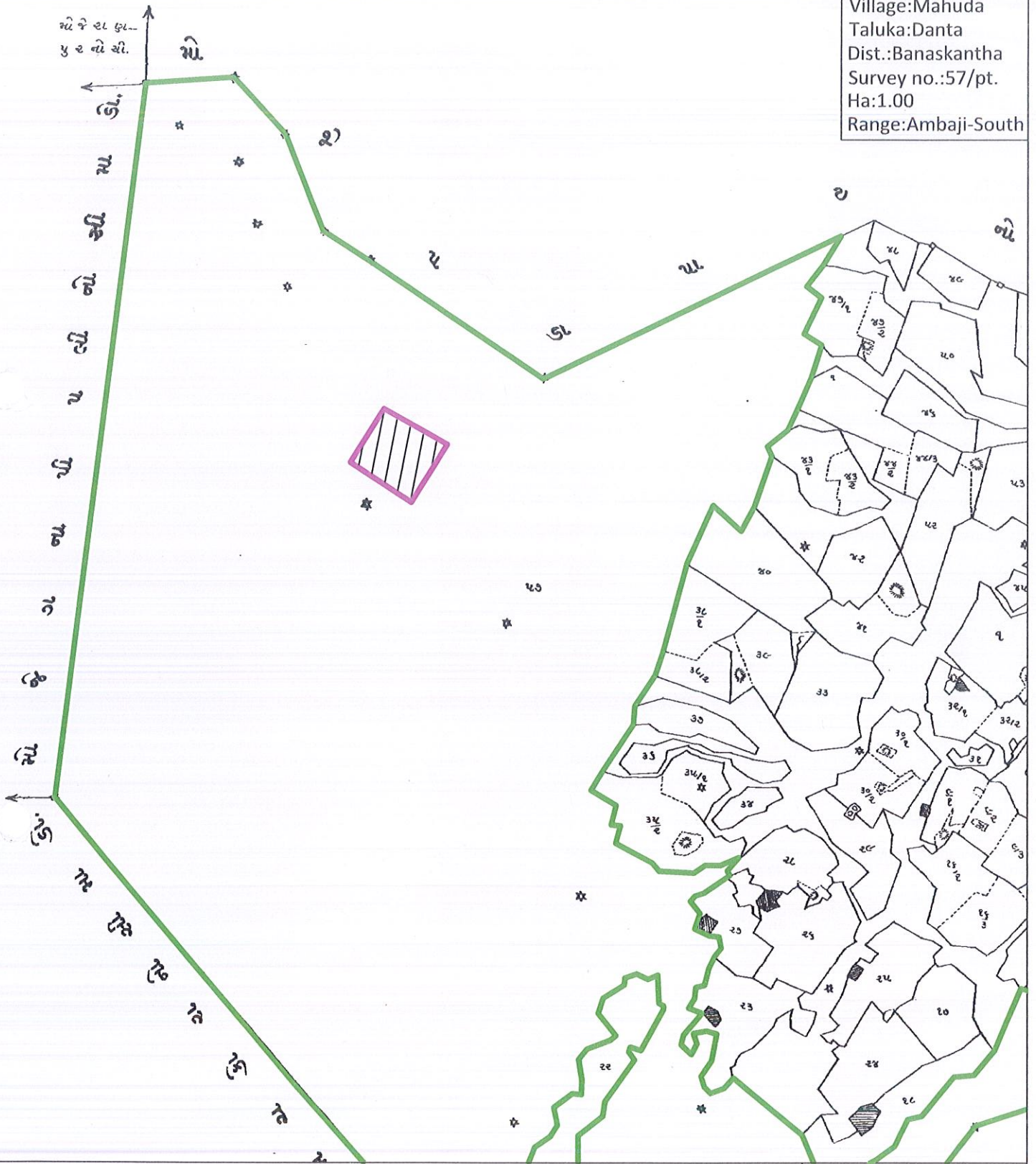

Forest Area



Area to be taken for Compensatory Afforestation 1.00 Ha.



SCALE:1 C.M = 79.20 M.T

O/c  
[Signature]

Deputy Conservator of Forests  
Banaskantha, Palanpur.



Detailed of Degraded scheme Compensatory Afforestation to be carried out in lieu of 1.00 Ha. of Forest land to Reliance jio Infocomm Limited,Ahmedabad.Proposal For Diversion 0.250 Ha. Forest Land For The Purpose of Optical fiber cable.

Topo Sheet No.G43S15  
Village:Mahuda  
Taluka:Danta  
Dist.:Banaskantha  
Survey no.:57/pt.  
Ha:1.00  
Range:Ambaji-South

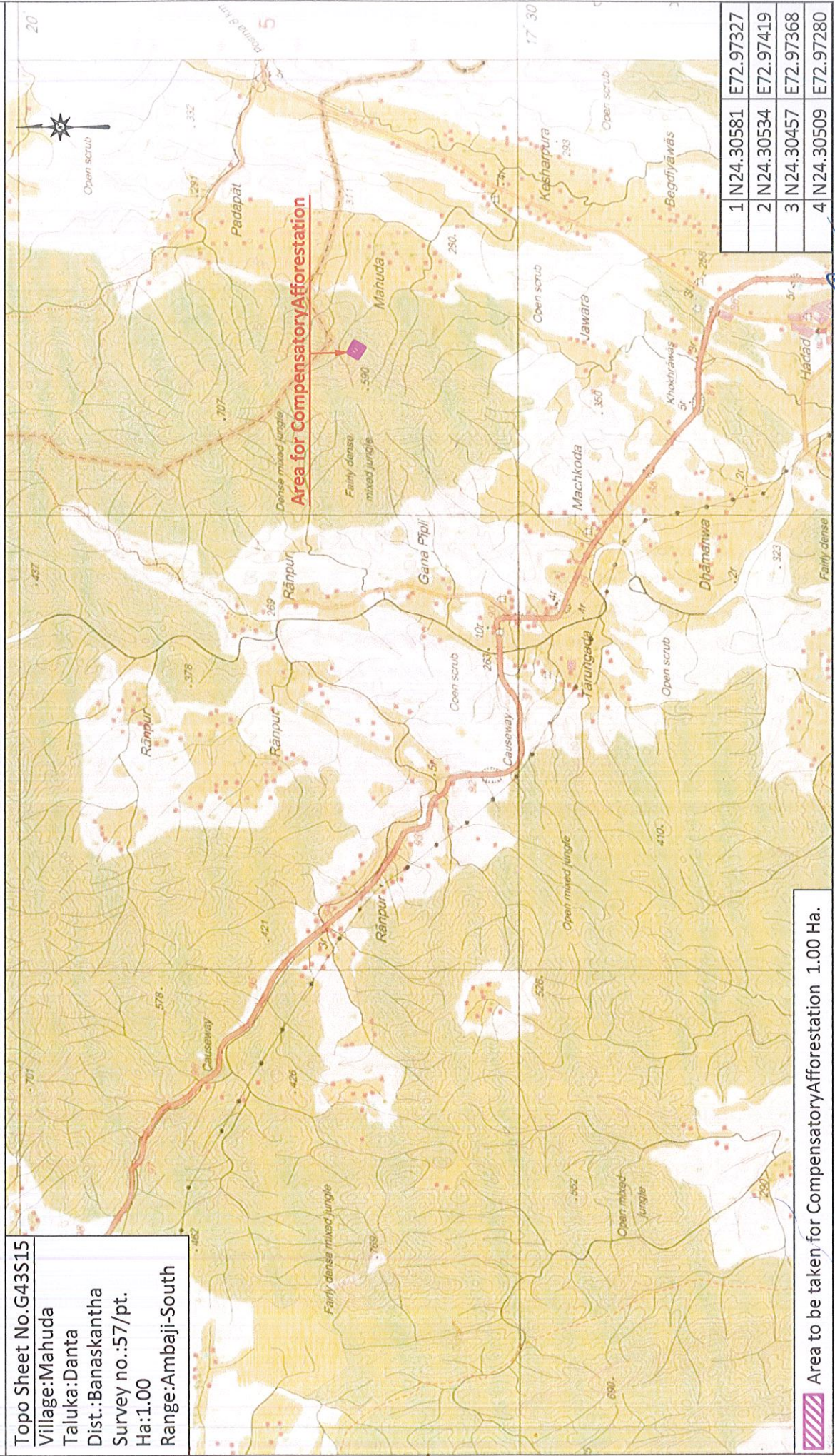

Area to be taken for Compensatory/Afforestation 1.00 Ha.

Deputy Conservator of Forests  
Banaskantha, Palanpur.

49



**Annexure-21****CERTIFICATE**

This is certified that 1.00 Ha. land of S.No. 57pt. of Village Mahuda, Ta. Danta, Dist. Banaskantha proposal for Compensatory Afforestation against the Diversion of 0.250 ha, Proposal for laying of under Proposal for grant of permission for laying Optical Fiber Cable along the routes mentioned here under (0.250 ha.) Ambaji to Aburoad in the state of Gujarat is identified and found suitable for afforestation.

Place : Palanpur  
Date: 1 / 6 / 2019

  
(Dr. G. S. Singh, IFS)  
Dy.Conservator of Forests,  
Banaskantha-Palanpur