

Korbandha

मशहूर नाम कोरबन्धा चादरनम्बर

थाना नम्बर ६२६

थाना गिरीडीह

परगन: खरगडोहा

जिला हजारीबाग

पंचायत समिति की माल १६ ईस्वी

सन १९१०-११ ईस्वी

पेहरवा

मिलानचादरनम्बर

केनारी

बदगुन्हा

PC No.	Ac.	To	Ac. Secd	Left	Right
447	1-62	1-20	1.80		
448	2-17	2.00			
449	2-32	2.00			
450	2-09				

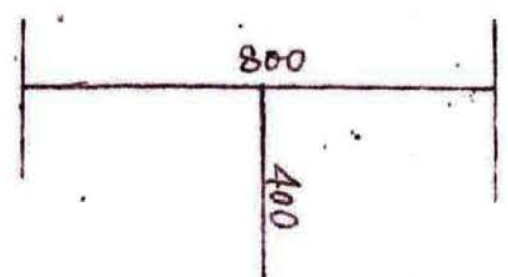

Printed and Published Under The Authority of Government.

- ४४१ मन्सिटी इटिनी
- ४१३ नवाकीरटोली

Scale 10 = 1 Mile

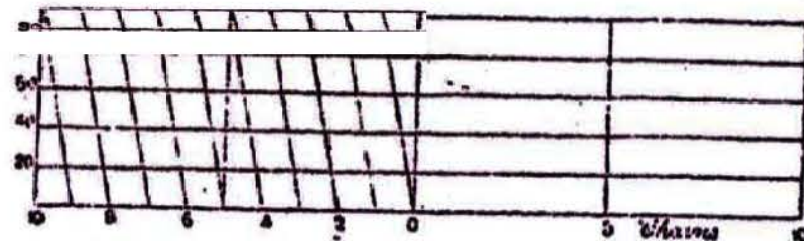

पुन्डलप्रादेश

Sl. No.	Latitude	Longitude	Code
1	24° 3' 13.916" N	86° 27' 5.177" E	A1
2	24° 3' 14.701" N	86° 27' 3.627" E	A2
3	24° 3' 15.469" N	86° 27' 2.067" E	A3
4	24° 3' 16.411" N	86° 27' 0.618" E	A4
5	24° 3' 15.793" N	86° 26' 59.838" E	A5
6	24° 3' 16.194" N	86° 26' 58.722" E	A6
7	24° 3' 17.491" N	86° 26' 59.789" E	A7
8	24° 3' 17.786" N	86° 27' 0.031" E	A8
9	24° 3' 17.620" N	86° 27' 0.505" E	A9
10	24° 3' 18.724" N	86° 27' 1.343" E	A10
11	24° 3' 18.835" N	86° 27' 1.118" E	A11
12	24° 3' 19.878" N	86° 27' 1.713" E	A12
13	24° 3' 19.717" N	86° 27' 2.328" E	A13
14	24° 3' 20.768" N	86° 27' 2.838" E	A14
15	24° 3' 20.051" N	86° 27' 4.427" E	A15
16	24° 3' 19.449" N	86° 27' 6.072" E	A16
17	24° 3' 18.855" N	86° 27' 7.826" E	A17
18	24° 3' 18.653" N	86° 27' 8.052" E	A18
19	24° 3' 17.382" N	86° 27' 7.293" E	A19
20	24° 3' 16.822" N	86° 27' 8.261" E	A20
21	24° 3' 15.321" N	86° 27' 7.580" E	A21
22	24° 3' 14.877" N	86° 27' 7.379" E	A22
23	24° 3' 15.239" N	86° 27' 5.907" E	A23

INDEX				
PURCHASE AREA -				
FOREST BOUNDARY -				
खण्ड	खण्ड नं०	खण्ड का क्षेत्रफल	कुल क्षेत्रफल	मेषी खण्ड का क्षेत्रफल
28	886	9.62	9.20	9.20
	887	2.96	2.00	2.00
	888	2.00	2.00	2.00
	889	2.00	2.00	2.00
			कुल	6.00

प्रमुख अधिकारी
गिरिडीह

PLATE: VA
MAP SHOWING PROPOSED COMPENSATORY AFFORESTATION LAND OVER AN AREA OF 7.00Ac/2.83 Ha. IN VILLAGE-KORBANDHA, THANA-GIRIDIH, DIST-GIRIDIH OF JHARKHAND STATE FOR ALOKE STEELS INDUSTRIES PRIVATE LIMITED FOR FOREST CLEARANCE UNDER FC ACT 1980.

Scale:- 1:3960