

**FORM 'A'**

For seeking prior approval under section 2 for the proposals by the State Government and other authorities.

**PART-I**

(TO BE FILLED UP BY USER AGENCY)

Sr. No.																			
1.		<b>Project details</b>																	
	(i)	Short narrative of the proposal and Project/Scheme for which the forest land is required.	The forest land is required for Diversion of <b>1.4489 Hect.</b> of forest Land for <b>C/O Proposed Link Road Patyar Ghatttru Via Sitri Jayan Berti Nallah (0/000 to 3/600 KM)</b> Detail attached page _____.																
	(ii)	Map showing the required forest land, boundary of adjoining forest on a 1:50,000 scale map	The contour map on 1:50000 scale showing the required forest area, boundary of adjoining forests is attached as page _____. The item wise break up of the required forest area for different purposes is as under: <table border="0"> <tr> <td><u>Purpose</u></td> <td><u>Forest land required.</u></td> </tr> <tr> <td>Road</td> <td>0.7987 Hect.</td> </tr> <tr> <td>Dumping</td> <td>0.6502 Hect.</td> </tr> <tr> <td>Total Forest Land</td> <td>1.4489 Hect.</td> </tr> <tr> <td><u>Purpose</u></td> <td><u>Non-Forest land required</u></td> </tr> <tr> <td>Road</td> <td>0.5838 Hect.</td> </tr> <tr> <td>Dumping</td> <td>0.0807 Hect.</td> </tr> <tr> <td>Total Non Forest Land</td> <td>0.6645 Hect.</td> </tr> </table>	<u>Purpose</u>	<u>Forest land required.</u>	Road	0.7987 Hect.	Dumping	0.6502 Hect.	Total Forest Land	1.4489 Hect.	<u>Purpose</u>	<u>Non-Forest land required</u>	Road	0.5838 Hect.	Dumping	0.0807 Hect.	Total Non Forest Land	0.6645 Hect.
<u>Purpose</u>	<u>Forest land required.</u>																		
Road	0.7987 Hect.																		
Dumping	0.6502 Hect.																		
Total Forest Land	1.4489 Hect.																		
<u>Purpose</u>	<u>Non-Forest land required</u>																		
Road	0.5838 Hect.																		
Dumping	0.0807 Hect.																		
Total Non Forest Land	0.6645 Hect.																		
	(iii)	Cost of Project.	Estimated cost for construction of this road will be approximately Rs 400.00 lacs																
	(iv)	Justification for locating the project in forest area.	Detail attached page _____.																
	(v)	Cost benefit analysis (to be enclosed)	Detail attached page _____.																
	(vi)	Employment likely to be generated.	About 39000 man days will be generated directly as a result of construction activity of the Road. Besides, due to increased economic activity in the area, many indirect opportunities of employment.																
2.		Purpose wise break up of total land required.	Total land required for the road is <b>1.4489 Hect.</b> of forest Land for <b>C/O Proposed Link Road Patyar Ghatttru Via Sitri Jayan Berti Nallah (0/000 to 3/600 KM)</b>																
3.		Details of displacement of people due to the project, if any	No displacement of people is involved.																
	(i)	Number of families,	Not applicable																
	(ii)	Number of scheduled castes/scheduled tribe families.	Not applicable																
	(iii)	Rehabilitation plan (to be enclosed)	Not applicable																
4.		Whether clearance under Environment (Protection) Act, 1986 required?	Not required.																
5.		Undertaking to bear the cost of raising and maintenance of compensatory afforestation/additional compensatory afforestation as well as cost of protection and regeneration of Safety Zone.	Undertaking attached.																

		etc. as per the scheme prepared by the State Government (undertaking to be enclosed)	
6.		Details of Certificates/documents enclosed as required under the instructions.	<ol style="list-style-type: none"> <li>1. Demand letter of the project authority.</li> <li>2. Detailed project note.</li> <li>3. Kh. No. wise detail of forest and non forest land.</li> <li>4. Index map.</li> <li>5. Alignment Plan.</li> <li>6. Revenue papers like Parcha-Tatima .</li> <li>7. Joint inspection report.</li> <li>8. Detail of non forest area involved in the proposal</li> <li>9. Justification for locating the project in forest area.</li> <li>10. Certificate regarding minimum use of forest land.</li> <li>11. Information regarding length and width of road in forest area.</li> <li>12. Undertaking regarding payment of cost of CA.</li> <li>13. Undertaking regarding payment of cost of NPV.</li> <li>14. Performa showing the detail of muck to be Generated and its disposal.</li> </ol>

Place :- Dhami

Date:- 29-07-2022

  
 Assistant Engineer  
 H.P.P.W.D. Sub Division  
 Udhampur

  
 Executive Engineer,  
 Shimla Rural Division,  
 HP.P.W.D. Dhami

**CHECK LIST SERIAL NUMBER:-04**

**DETAILED NOTE ON THE PROJECT**

The project for the **C/O Proposed Link Road Patyar Ghattru Via Sitri Jayan Berti Nallah (0/000 to 3/600 KM)**, connects village Patyar Ghattru Via Sitri Jayan Berti Nallah which is an area under Shimla Forest (R) Tehsil Sunni, Distt Shimla Himachal Pradesh. The road will be constructed By H.PPWD department. Diversion of forest land is 1.4489 Hect. Prior to the construction of the subject road the villagers had to take uphill journey to reach their villages. It was also very problematic for the villagers to transport essential commodities to the village in the absence of a link road especially in view of the rugged terrain and steep slopes. Now as per the policy of the government to connect all Panchayats, villages by road and transfer the land to HP.PWD Department For Construction, proper maintenance of road, the forest case has been prepared for the subject road to transfer the land to HP.PWD Department. The total length of this road is 3/600 KM out of which 1.4489 Hect. of forest land involved and 0.6645 Hect. non forest land (Pvt. Land) involved. The Pvt.Land has been donated by people and Local villagers agree for construction of road. The road gives boost to the local economy. The link road facilitates gives the transportation of agricultural and horticultural produce like Almonds, Potatoes, and other cereal crops to the markets. Besides this, the Link road is also helpful for the patients in case of medical emergencies. The project also generates indirect opportunities of employment as result of increased economic activity in the area. The location of target village is such that there is no alternate alignment possible except the proposed alignment which can avoid up to maximum extent. the use of forest land for the construction of the said road. Also during the construction of said road employment of about 39000 man days is likely to be generated. 869 persons will be benefited from the construction this road. The estimated cost of road will be approximately 400.00 lach. As such location of the road /project in the forest land is justified and proposed alignment of road is finalized. For the construction of this road 1.4489 Hect. of forest land is required to be diverted for road.

**Assistant Engineer**  
**H.P.P.W.D. Sub Division**  
**Dhami**

**Executive Engineer,**  
**Shimla Rural Division**  
**HP.PWD Dhami**

SPOSHEET:-

Proposed Link Road Patyar Ghatru Via Sitri Jayan Berti Nallah  
(0/000 to 3/600 KM)



**Index**

**Scale**

**1.50000**

**Proposed Site**



**Toposheet No :-**

**H43F3**

43

Divisional Engineer  
Shimla Division  
SHIMLA

Assistant Engineer  
H.P.P.W.D. Sub Division  
Dhamsi

Executive Engineer  
Shimla Division  
HPPWD, Dhamsi

# Digital Landuse Map for C/O Proposed Link Road Patyar Ghattu Via Sitri Jayan Berti Nallah (0/000 to 3/600 KM)

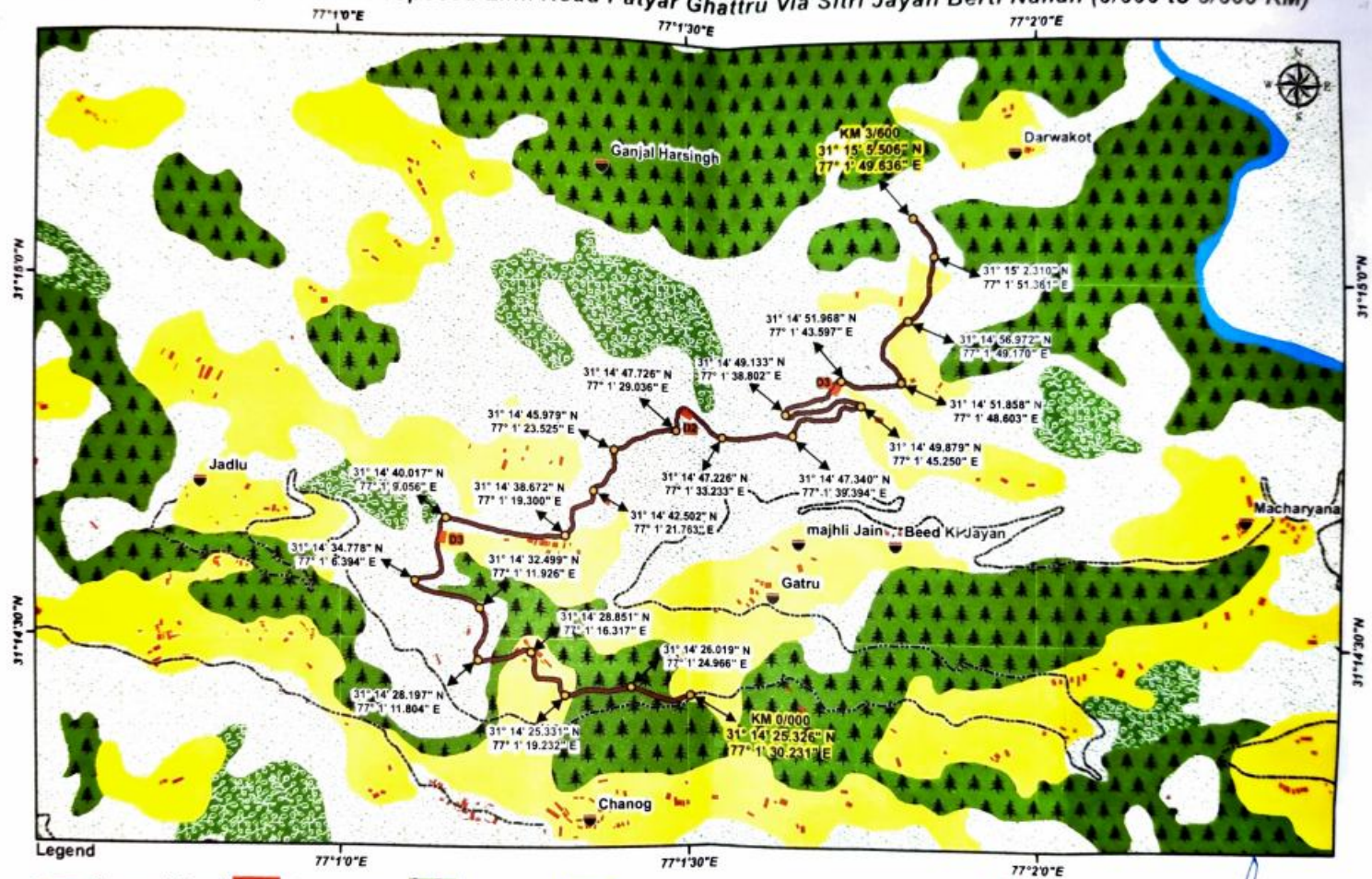

- Legend**
- Proposed Road
  - Existing Road
  - Dumping Site
  - Bulltup
  - Forest Area
  - Open Land
  - Private Land
  - Shrubs
  - Water Body

Divisional Forest Officer  
Shri - Forest Division  
SHIMLA

Assistant Engineer  
H.P.P.W.D. & S.D.M.  
SHIMLA

Executive Engineer,  
Shimla Rural Division,  
H.P.P.W.D., Dhamsi

# Layout Plan for the Construction of Link Road Patyoz Ghatou via Sitsi Jayem Besti Nallah KM 0/0 to 3/600

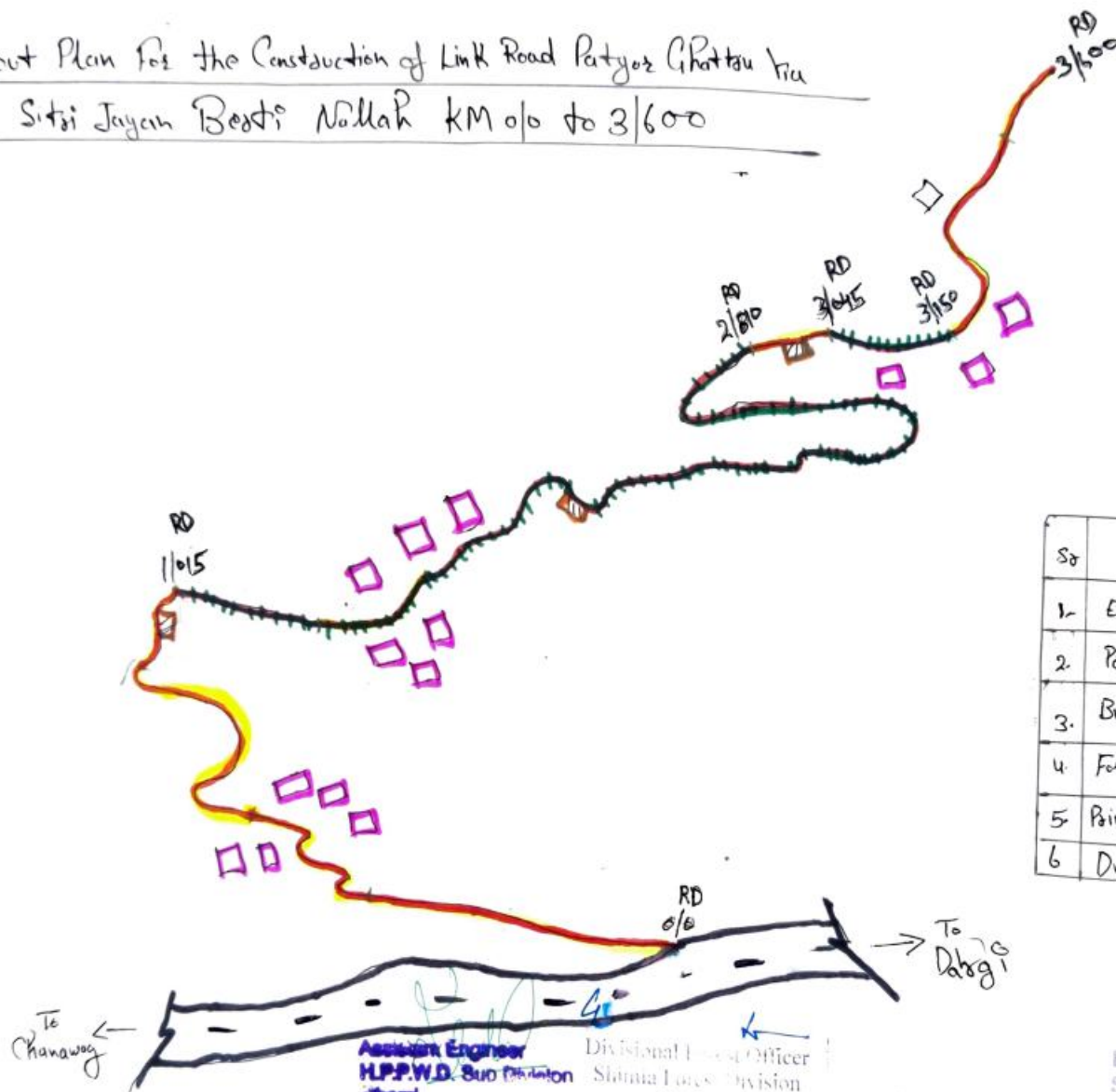

Sl	INDEX	Legend
1.	Existing Road	
2.	Proposed Land	
3.	Built up Area	
4.	Forest	
5.	Private	
6.	Dumping	

← To Chanaway

Assistant Engineer  
H.P.P.W.D. Sub Division  
Chand

Divisional Forest Officer  
Shimla Forest Division  
SHIMLA

→ To Dabgi

Executive Engineer,  
Shimla Forest Division  
H.P.P.W.D., Shimla

# Line Plan of Patyar Ghatu Dadwaket road 0/00 to 3/600

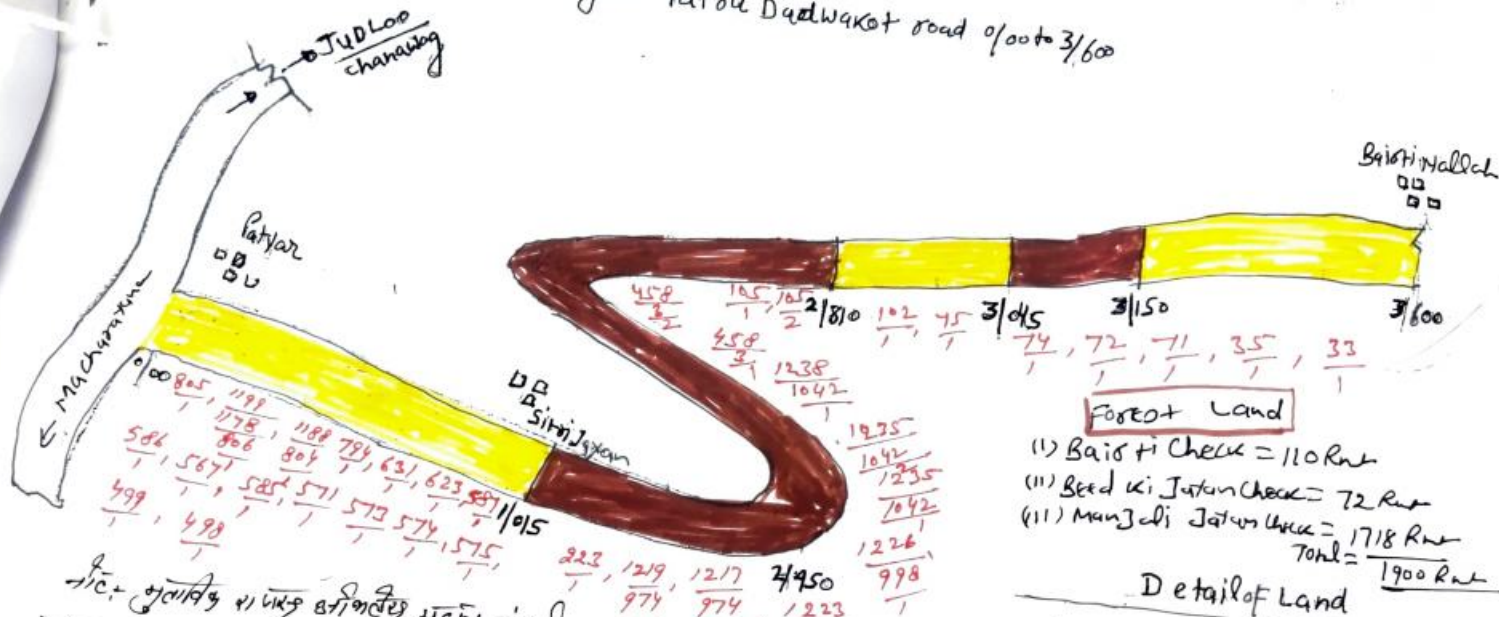

**Forest Land**

- (i) Baisthi Check = 110 Rm
- (ii) Beed ki Jatan Check = 72 Rm
- (iii) Manjoli Jatan Check = 1718 Rm
- Total = 1900 Rm**

## Detail of Land

0/00 to 1/015 = 1015.00 mtr Private Land  
 1/015 to 2/810 = 1795.00 mtr Forest Land  
 2/810 to 3/045 = 235.00 mtr Private Land  
 3/045 to 3/150 = 105.00 mtr Court Land  
 3/150 to 3/600 = 450.00 mtr Private Land  
**Total 3660 mtr**

Forest Land = 1900.00 mtr  
 Private Land = 1700.00 mtr

Private Land Shown Thus  
 Court Land  
 Forest Land Shown Thus

नोट: मुलाक़ात वी लान्ड बारीकदारि मेलु मंजोरी बागल के खतरा नउरु  
 नाला, खण्ड 805, 1223, 1235 किमि यो भिउं क खण्ड 499, भिउं भिउं  
 1226, 1235 किमि यो भिउं क खण्ड 498, 1215, 1217, 974, 974, 1223, 997  
 998, 1042 किमि यो भिउं क खण्ड 102, 75, 74, 72, 71, 35, 33 किमि यो भिउं क खण्ड  
 458, 458 किमि यो भिउं क खण्ड 102, 75, 74, 72, 71, 35, 33 किमि यो भिउं क खण्ड  
 यो भिउं क खण्ड 102, 75, 74, 72, 71, 35, 33 किमि यो भिउं क खण्ड

19/05/2023  
 Village Revenue Officer  
 Circle... Chanaug  
 Teshil... Chanaug  
 P. K. G. J. J. J.

## CHECK LIST SERIAL NUMBER -07.

STATEMENT SHOWING DETAILS OF FOREST AREA FOR DIVERSION OF FOREST LAND FOR THE CONSTRUCTION OF LINK ROAD FROM GHATTRU VIA SITRI JAYAN BERTI NALLA, TEHSIL AND DISTRICT SHIMLA HP.

S.No	District	Division	Range/Tehsil/ Village	Khasra/ Survey Compartment number of Stone.	or Km.	Forest Proposed Area for diversion (ha.).	Legal Status of Forest Area	Remarks
1	2	3	4	5		6	7	8
1	Shimla	Shimla	Bhajji/ Suni/Bairty	102/1		0.0800	U-577 Jaini Nali	
2	Shimla	Shimla	Bhajji/ Suni/Bairty	458/3/1		0.0220		
3	Shimla	Shimla	Bhajji/ Suni/Bairty	458/3/2		0.0300		
4	Shimla	Shimla	Bhajji/ Suni/Bairty	498/1		0.0320		
5	Shimla	Shimla	Bhajji/ Suni/Bairty	223/1		0.0135		
6	Shimla	Shimla	Bhajji/ Suni/Bairty	1219/974/1		0.0036		
7	Shimla	Shimla	Bhajji/ Suni/Bairty	1217/974/1		0.1820		
8	Shimla	Shimla	Bhajji/ Suni/Bairty	1217/974/2		0.6502		
9	Shimla	Shimla	Bhajji/ Suni/Bairty	1223/997/1		0.0790		
10	Shimla	Shimla	Bhajji/ Suni/Bairty	1226/998/1		0.0025		
11	Shimla	Shimla	Bhajji/ Suni/Bairty	1235/1042/1		0.2300		
12	Shimla	Shimla	Bhajji/ Suni/Bairty	1235/1042/2		0.0828		
13	Shimla	Shimla	Bhajji/ Suni/Bairty	1238/1042/1		0.0036		
14	Shimla	Shimla	Bhajji/ Suni/Bairty	805/1		0.0275		
15	Shimla	Shimla	Bhajji/ Suni/Bairty	499/1		0.0102		
				<b>Total</b>		<b>1.4489</b>		

Divisional Forest Officer,  
Shimla Forest Division,  
Shimla-2.

## DETAILS OF THE TOTAL NON-FOREST LAND REQUIRED FOR DIVERSION UNDER FOREST CONSERVATION ACT, 1980

Sl. No.	Ad Distance in Meter	Khasra No.	Kind of land as per Revenue Paper	Class of land as per Forest Record	Area in Hact.	No. of Trees.	Name of Component
1.	56	35/1	वांज नदी कि		00-02-75		दभाराम
2.	48	33/1	वासनी		00-02-40		- 00 -
3.	21	71/1	वासनी		00-00-95		कुन्दन लाल
4.	95	72/1	वांज नदी कि		00-04-60		- 00 -
5.	32	74/1	वासनी		00-01-45		पुष्प कुमार, महेन्द्र, विद्याचन्द्र
6.	147	75/1	वासनी		00-07-65		दीर्घा चन्द
7.	96	105/1	वासनी		00-04-45		महेन्द्र लाल
8.	96	105/2	वासनी		00-07-47		- 00 -
9.	22	525/1	वासनी		00-00-96		गोला राम
10.	53	526/1	वासनी		00-02-18		श्रीराम प्रकाश, हिरा लाल
11.	50	527/1	वासनी		00-02-76		दभाराम
12.	20	528/1	वासनी		00-00-95		कुम्भ चन्द
13.	5	576/1	वासनी		00-00-25		- 00 -
14.	6	575/1	वासनी		00-00-30		- 00 -
15.	6	574/1	वासनी		00-00-30		- 00 -
16.	2	573/1	गोमठवाला		00-00-16		- 00 -
17.	47	571/1	वांज नदी कि		00-02-58		श्रीमति प्रेमा देवी
18.	11	585/1	वासनी		00-00-60		कुम्भ चन्द
19.	99	567/1	वांज नदी कि		00-06-42		दभाराम
20.	66	586/1	वांज नदी कि		00-02-98		कुम्भ चन्द
21.	11	587/1	वांज नदी कि		00-00-66		- 00 -
22.	28	622/1	वासनी		00-02-43		श्रीमति सुदमा
23.	26	623/1	वासनी		00-01-30		दभाराम, वांज नदी
24.	15	632/1	वासनी		00-00-84		- 00 -
25.	58	794/1	वांज नदी कि		00-02-00		कुम्भ चन्द



No. SML-SR-57/2022- 1439  
Office of the Deputy Commissioner,  
Shimla, District Shimla, H.P.

Dated, Shimla-1 the

12 September, 2022.

**NON AVAILABILITY OF NON FOREST LAND CERTIFICATE**

Certified that no alternative suitable Non Forest land is available for construction of link road from Patyar Ghatru via Sitri Berti Nallah. The diversion of forest land area measuring **01-44-89 Hectares** situated in Mohal/Mauja Manjhali Jayan, Bairty and Beed ki Jayan, Sub-Tehsil Dhami, District Shimla, Himachal Pradesh is essential which cannot be avoided. The detail of forest land is as under:-

Sr. No.	Name of Tehsil/ Sub-Tehsil	Name of Mauja/ Up-Mohal	Khasra No.	Area in Hectares	Classification of Land
1	Dhami	Bairty	102/1	00-08-00	Charagah Billa Drakhtan
			<b>Kitta=01</b>	<b>00-08-00</b>	
		Beed Ki Jayan	458/3/1	00-02-20	Charagah Billa Drakhtan
			458/3/2	00-03-00	Charagah Billa Drakhtan
			<b>Kitta=02</b>	<b>00-05-20</b>	
		Manjhali Jayan	498/1	00-03-20	Charagah Drakhtan
			499/1	00-01-02	Gair Mumkin Nallah
			223/1	00-01-35	Charagah Billa Drakhtan
			1219/974/1	00-00-36	Charagah Drakhtan
			1217/974/1	00-18-20	Charagah Drakhtan
			1217/974/2	00-65-02	Charagah Drakhtan
			1223/997/1	00-07-90	Charagah Billa Drakhtan

		1226/998/1	00-00-25	Charagah Drakhtan
		1235/1042/2	00-23-00	Charagah Billa Drakhtan
		1235/1042/1	00-08-28	Charagah Billa Drakhtan
		1238/1042/1	00-00-36	Charagah Billa Drakhtan
		805/1	00-02-75	Charagah Billa Drakhtan
		<b>Kitta=12</b>	<b>01-31-69</b>	
		<b>Grand Total=</b>	<b>01-44-89</b>	

  
 Deputy Commissioner,  
 Shimla (H.P.)-171001  
 Shimla.

**CHECK LIST SERIAL NUMBER:- 10**

**JUSTIFICATION FOR LOCATING THE PROJECT IN FOREST AREA.**

**1.4489 Hect. of forest land is required for C/O Proposed Link Road Patyar Ghattru Via Sitri Jayan Berti Nallah (0/000 to 3/600 KM). For the construction of this road 1.4489 Hect. of forest land is required to be diverted.**

Two alternative alignment for the construction of road are examine but they are not feasible . All the beneficiary area are surrounded by proposed alignment and less trees are involved. The proposed road is necessarily pass through a forest land There is no non forest land is available. There is no natural water resource .Temple etc. Hence there is no escape from using the forest land.

Assistant Engineer  
H.P.W.D. Sub Division  
Jhansi

Executive Engineer,  
Shimla Rural Division;  
H.P.W.D. Dhami

Countersigned by -

Divisional Forest Officer,  
Forest Division, Khalim (R)  
Shimla  
Divisional Forest Officer,  
Shimla Forest Division  
Office Seal  
SHIMLA

**CHECK LIST SERIAL NUMBER:-11**

**CERTIFICATE FOR MINIMUM USE OF FOREST LAND.**

This is to certify that the forest area involved in the proposal for **C/O Proposed Link Road Patyar Ghattru Via Sitri Jayan Berti Nallah (0/000 to 3/600 KM)** is unavoidable and barest minimum forest area i.e. **1.4489 Hect.** area which is proposed for diversion

  
Assistant Engineer  
H.P.P.W.D. Sub Division  
Chandi

  
Executive Engineer,  
Shimla Rural Division,  
HP.P.W.D. Dhami  
Executive Engineer,  
Shimla Rural Division  
HP.P.W.D. Dhami

Countersigned by:-

  
Divisional Forest Officer,  
Forest Division, Khalini (R)  
Shimla-2.

Office Seal-----



**Alternative Toposheet:-**  
**Proposed Link Road Patyar Ghattru Via Sitri Jayan Berti Nallah**  
**(0/000 to 3/600 KM)**

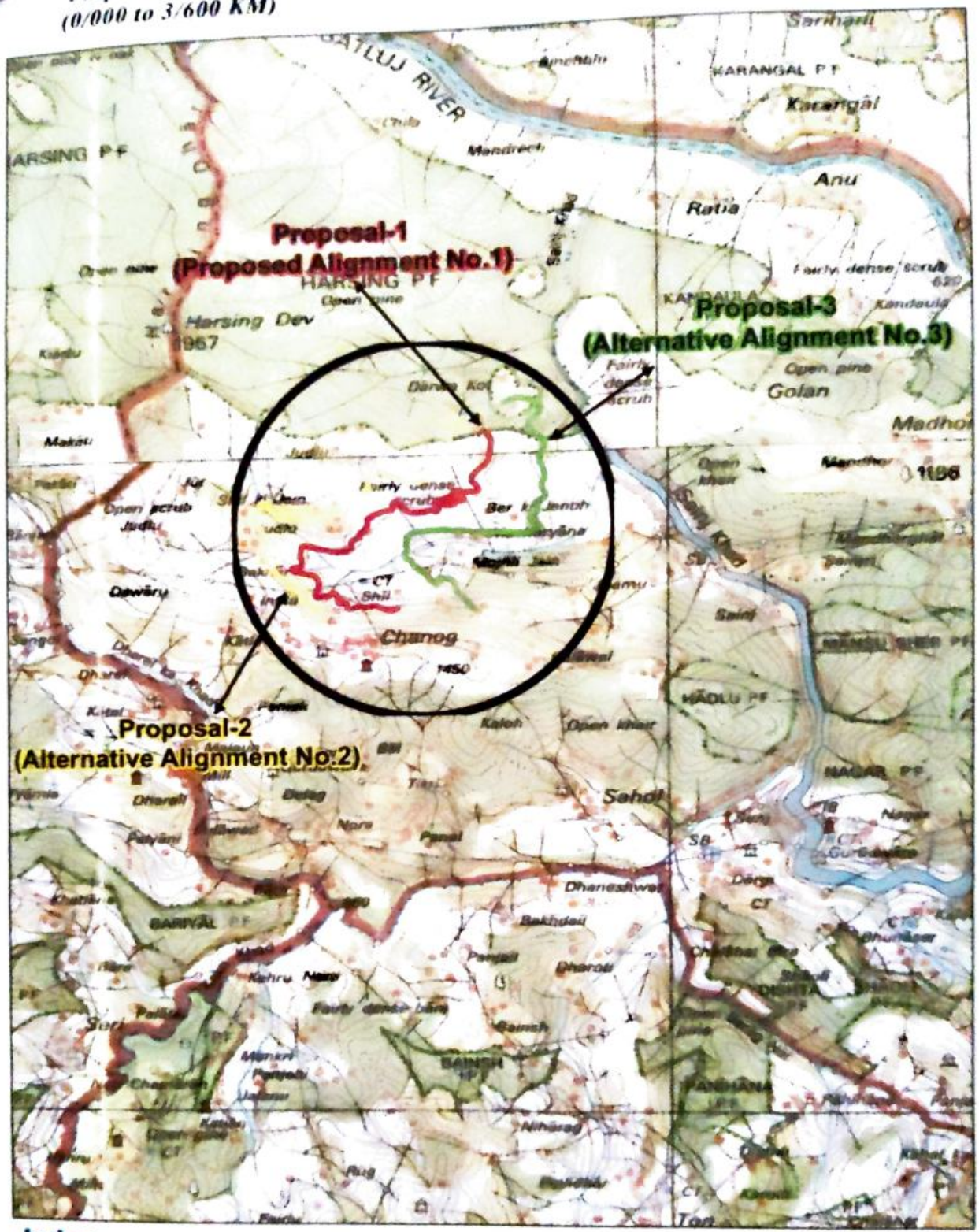

**Index**

**Scale: 1:50000**

**Toposheet NO: H43F 3&4**

**Proposal-2**  
**(Alternative Alignment No.2)**

**Proposal-1**  
**(Proposed Alignment No.1)**

**Proposal-3**  
**(Alternative Alignment No.3)**

65  
Divisional Officer  
Sitri Jayan Division  
Chamog

Assistant Engineer  
H.P.P.W.D. Sub Division  
Chamog

Executive Engineer  
Sitri Jayan Division  
H.P.P.W.D. Chamog

**CHECK LIST SERIAL NUMBER:-12**

**UNDERTAKING FOR PAYMENT OF COST OF COMPENSATORY  
AFFORESTATION.**

I/ Executive Engineer, Shimla Rural Division, HP.PWD  
Dhami, here by, undertake to pay the entire amount for compensatory afforestation in lieu of  
the forest area i.e. **1.4489 Hect.** of forest Land diverted for **C/O Proposed Link Road  
Patyar Ghattru Via Sitri Jayan Berti Nallah (0/000 to 3/600 KM)** as per prevailing wage  
rates at the time of plantation as and when demanded by forest department.

  
Assistant Engineer  
H.P.P.W.D. Sub Division  
Dhami

  
Executive Engineer,  
Shimla Rural Division,  
HP.PWD, Dhami  
Shimla Rural Division  
HP.PWD. Dhami

Countersigned by :-

  
Divisional Forest Officer,  
Forest Division, Khalini (R)  
Shimla District Office  
Shimla Rural Division  
Office Seal-----

**CHECK LIST SERIAL NUMBER:-13**

**UNDERTAKING FOR PAYMENT OF NET PRESENT VALUE OF  
FOREST AREA.**

I/ Executive Engineer, Shimla Rural Division, HP.PWD  
Dhami, have applied for diversion of **1.4489 Hect.** of forest area for the purpose of **C/O  
Proposed Link Road Patyar Ghattru Via Sitri Jayan Berti Nallah (0/000 to 3/600 KM)**  
I, here by, undertake to pay the net present value (NPV) of the above forest land as and when  
demanded by forest department.

  
Assistant Engineer  
H.P.P.W.D. Sub Division  
Dhami

  
Executive Engineer,  
Shimla Rural Division  
HP.PWD. Dhami

Countersigned by:-

  
Divisional Forest Officer,  
Forest Division, Khalini (R)  
Shimla-2.

Divisional Forest Officer  
Office Seal Shimla Forest Division  
Shimla-2

**CHECK LIST SERIAL NUMBER :-13-A**

**UNDERTAKING FOR PAYMENT OF ADDITIONAL NPV OF FOREST  
AREA**

I/ Executive Engineer, Shimla Rural Division, HP.PWD Dhami, here by undertake to pay Additional amount for NPV in lieu of the forest area diverted for C/O Proposed Link Road Patyar Ghattru Via Sitri Jayan Berti Nallah (0/000 to 3/600 KM)

  
Assistant Engineer  
H.P.P.W.D. Sub Division  
Uthman

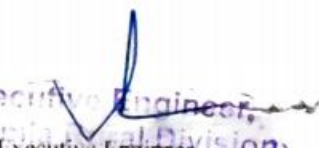
  
Executive Engineer,  
Shimla Rural Division,  
HP.PWD. Dhami

Countersigned by:-

  
Divisional Forest Officer,  
Forest Division, Khalini (R)  
Shimla Division  
Office Seal

## CHECK LIST NO. 28

Detail Reclamation Plan, whenever required. It should be realistic exhaustive and complete in all respects along with relevant maps in distinct colours. It should also include the details of back fillings, afforestation and execution of such works, whenever required.

Diversion of 1.4489 hectare of forest land has been proposed for the construction of motorable Link road from Patyar ghatru Via sitri jaya Berti Nallah Km. 0/0 to 3/600 in sub Tehsil Dhami, District Shimla. The construction of this road will generate muck to the extent of 54000 Cubic Metre. By taking a swell factor of 40% the total muck become 50400 cubic metre (Detail attached at Page\_\_\_) Out of this 30240.00 cubic metre of muck will be used locally in filling, construction of masonry walls in dumping place and in leveling of road. The remaining 20160.00 Cubic metre of muck will require safe disposal. The user agency has identified 3 No. dumping site for the disposal of this muck. The dumping site has been identified along the proposed site and the capacity of these dumping sites has been worked out to be 31500.00 cubic metre (Detail attached at Page\_\_\_) which is sufficient to hold the muck to be generated.

Thus all the muck generated will be dumped in the designated dumping sites. 3 number dumping site designated as DS-I & III had been identified for dumping of muck / debris to be produced during the construction phase of the project. It is proposed that the dumping sites are treated in such a manner that these do not pose any problem to the environmental management consideration arising out of the necessity to stabilize the dumping sites at the earliest. Therefore, this reclamation plan has been formulated with the following objectives:-

1. To arrest the dumped muck in-situ so that it does not find its way to the nearby drainage channels, thus altering the drainage pattern of the area.
2. To rehabilitate the dumped area over a period of time so that it merges with the Adjoining natural landscape and does not stand out as a sore point.
3. To improve the aesthetics of the dumping grounds/ dumping site by planting suitable Plants and trees species thereby increasing the forest cover in the area.
4. To stabilize the dumping site by vegetative and engineering structures.

### Implementation :

The proposal will be implemented by the user agency itself at its own cost as detailed in this plan. The implementation of the plan will be supervised by the forest department from time to time and the progress will be periodically monitored. In case of default the sanction of diverted land may be revoked with suitable penalty as decided by the Govt. of India.

### Strategy :

The pronged approach will be followed for reclamation of dumping sites. In the first instance crate wall will be erected around the dumping site so that required capacity for dumping of muck is created at the sites. The detailed drawings of the crate work to be undertaken are enclosed. The primary objective of the crate works will be to arrest the dumped muck at the dumping sites itself and not allow its spillage to adjoining areas and eventually to nearby drainage lines. The capacity of the dumping sites has been calculated as detailed in the table and will be enough to hold the muck required to be dumped in each of the sites.

In the second phase, once the dumping is complete it will be ensured that the dumping site is planted with grasses, bushes, shrubs and tree so that it gives an aesthetic look. This vegetal cover will also help in binding the soil and will prevent its erosion. For vegetating the dumping sites, suitable local species will be preferred. However, it may be noted that bulk of the muck to be dumped will be excavated material which will be lacking in essential nutrients and organic matter. Hence it will be desirable to increase the nutrient status of the top soil to make it conducive to tree/ vegetal growth. For this purpose maturing of top soil shall be done. If required, imported soil shall be brought to replenish the top soil. Instantly grasses and bushes will be planted in the area to improve the soil condition. Once these grasses and bushes take hold of the site, tree species will be planted in next phase. The tree species to be planted will be namely Robinia, Lucinea, albizia, Drek Amla Bamboo, Khair, Chail and Devdar.

Grasses like Steria and Napier will also be propagated. Trees will be Planted as the closer spacing so that canopy is closed at the earliest. Hence the spacing will be kept at 1.5 mtr. x 1.5 mtr. The total area involved in dumping is 7336 Square metre. Also due to inert nature of soil, plants will need extra care for their establishment. For this purpose, imported soil/ organic manure will be added in each pit for easy establishment of plants. Watering of the plant in dry season will be provided to prevent mortality. The plantation will be further maintained at project cost for next five year beating up of failure will be done.

**Post reclamation arrangement :**

Since the area in question is required by the user agency only for the temporary use of dumping, hence the area will be reverted back to forest department after implementing the reclamation plan, if so stipulated by Govt. of India. However if at the time of so reverting back the areas to forest department if any activities as per this reclamation plan is found wanting then the forest department may realize the cost that activity from the user agency at the prevailing wages rates applicable in forest department and may get the same done departmentally at the project cost.

Place : Dhami

Dated :-

  
Assistant Engineer  
H.P.P.W.D. Sub Division  
Dhami



Divisional Forest Officer  
Shimla Forest Division  
SHIMLA

  
Executive Engineer,  
Shimla Rural Division.  
HPPWD, Dhami

**Title -: C/O Proposed Link Road Patyar Ghattru Via Sitri Jayan Berti Nallah (0/000 to 3/600 KM).**

**Certificate of Muck Dumping**

Certified that the muck which generated during **C/O Proposed Link Road Patyar Ghattru Via Sitri Jayan Berti Nallah (0/000 to 3/600 KM)** will be used in Filling work of proposed road & filling behind the R/Wall & B/Wall. The Extra/ Remaining muck will be used for leveling of site, safely disposed in muck dumping site and private. Land is also taken for Dumping/Muck disposal .

  
Assistant Engineer  
H.P.P.W.D. Sub Division  
Chami

  
Executive Engineer,  
Shimla Canal Division,  
HPPWD Chami

# **MUCK MANAGEMENT PLAN**

1	Total Qty. of Muck being Produce	54000.00
2	Deduction for useful stone as required under the clause of agreement to be executed by the contractor and executive Engineer of Project	18000.00
3	Net Balance quantity of Debris/Muck(1-2) A	36000.00
4	Quantity available on site with swell factor 2 40% 1.40xA	50400.00
5	Material/Muck to be used in project:	
	1. Deduction for material/required for the construction of dumping place in dry masonry wall/ edge walls @ 5% of(B)	2520.00
	2. Less for material/muck required for the levelling of the proposed road for the construction @ 15% of (B)	7560.00
	3. Less for material/muckrequired for the Construction of the proposed road on the analogy of half cutting & half filling @ 40% of (B)	20160.00
	Total:- 5(1)+5(2)+5(3)	30240.00
6	Net material/muck to be dumping in dumping site (B-C)	20160.00
7	Proposed Dunping sites	
	Material/Muck left at site which required carriages for the proper dumping at the recognized site as per instruction of Forest and Environment Ministry reinforced by various judgment of the apex court Govt. of india.	
	Dumping Capacity Plan	
	Sr. No.	Dumpling site no.
	1	105/2
	2	585/1
	3	1217/974/2
	Total:-	00-73-36

Assistant Engineer  
H.P.P.W.D. Sub Division  
Dhami

Executive Engineer,  
Shimla Rural Division  
HPPWD, Dhami

Divisional Forest Officer  
Shimla Forest Division  
SHIMI

NAME OF WORK - MUCK DUMPING PLAN (SH- C/O Link road From  
Pat to ghata via Sitarai Jatan Badi Nalla km. 0/00 to 3/00  
(Kh. No 105/2, 58.5/11217/974/2)

RD

RD

GR

Divisional Forest Officer  
Shimla Forest Division  
SHIMLA

$L = 50m$   
 $W = 30m$   
 $H = 7m$   
No. of dump = 3  
Total =  $3 \times 10500 = 31500 \text{ Cum}$

Wire Mesh  
(10x10)  
cm

Executive Engineer  
HPPWD, Sub Division  
Dhami

Executive Engineer,  
Shimla Rural Division,  
HPPWD, Dhami

**Title of the project:- C/O Proposed Link Road Patyar Ghattru Via Sitri Jayan Berti  
Nallah (0/000 to 3/600 KM)**

**CHECK LIST SERIAL NUMBER:-31**

**CERTIFICATE**

Certified that the total length of the road is 3600.00 mtrs . out of which 2450.00 mtrs is Passing Though Forest Land in various reaches and rest 1150.00 mtrs is Passing Though Non- Forest Land in various reaches under forest Division Khalini Shimla District Shimla H.P. The width of road shall be 5 /7 mtrs.

  
Assistant Engineer  
H.P.P.W.D. Sub Division  
Shimla

  
Executive Engineer,  
Shimla Forest Division,  
H.P. Shimla

↙  
Divisional Forest Officer  
Shimla Forest Division  
SHIMLA

No. WLM-102/ 6261  
H.P. Forest Department,

Dated Shimla, the 10-1-2023

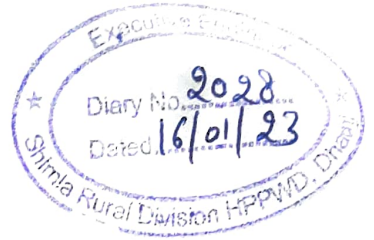

**From:**

**Dy. Conservator of Forests,  
Wildlife Division, Shimla.**

**To:**

**The Executive Engineer,  
Shimla Rural Division,  
H.P PWD, Dhami**

**Subject:**

Regarding Issuance of Aerial Distance Certificate (Eco Sensitive Zone) for C/o link road from Patyar Ghattu via Sitri Jayan berti Nallah Km. 0/0 to 3/600.

Sir,

Kindly refer to your office memo No. PW-SRDD- WA-D.O.F.L/ 2022-23/ 9213-14 dated 22-06-2022 on the subject cited above.

2. As per report sent by Range Forest Officer, Chandi, the aerial distance of the proposed above site is approx. **0.52 Km.** from Majathal Wildlife Sanctuary and **proposed site is fall in within ESZ of Majathal Wildlife Sanctuary.**

**Note:**

**This is only distance certificate and cannot be treated as NOC.**

  
**Dy. Conservator of Forests,  
Wildlife Division, Shimla.**

  
SE/WA  
SM  
16/01/2023

H P PWD

No. PW-SRDD-W/A-D.O.F.L/23-

Copy forwarded to the Assistant Engineer  
HPPWD Shimla Division - Suam, for taking further  
nll.

  
Executive Engineer,  
Shimla Rural Division  
HPPWD, Dhami.

## Certificate For Village Beneficiaries

This is certify that following villages shall be benefited

Sr.No	Village Name	Village Code	Village Population
1	हिरावा/बानावा	011501	371
2	पुडा	011601	44
3	बिसवा/बानावा	011701	51

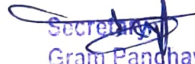
  
Secretary  
Gram Panchayat Chanawag  
Dev. Block Basantpur  
Distt. Shimla (H.P.)

## Certificate For Village Beneficiaries

This is certify that following villages shall be benefited

Sr.No	Village Name	Village Code	Village Population
1	श्री गुरुद्वारा		321
2	पूरुवा		44
3	वर्मा चौक		55

Secretary  
Gram Panchayat Chanawag  
Dev. Block Basantpur  
Distt. Shimla (H.P.)

## Certificate For Village Beneficiaries

This is certify that following villages shall be benefited

Sr.No	Village Name	Village Code	Village Population
1	भनसिंहवाली		371
2	गिरवा		44
3	बनसिंहवाली		51

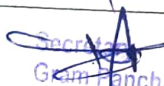
  
Secretary  
Gram Panchayat Chanawag  
Dev. Block Basantpur  
Distt. Shimla (H.P.)

**Line Plan of Patyar ghatru Dadwakot road km. 0/00 to 3/600.**

Sr.No.	RD.No.	Khasra No.	Status
1	0/00 to 1/015	805/1, 1199/1178/806, 1188/804/2, 794/1, 631/1, 623/1 ,587/1, 586/1, 567/1, 585/1, 571/1, 573/1, 574/1, 575/1, 499,1, 498/1.	Private land
2	1/015 to 2/450	223/1, 1219/974/1, 1217/974/1	Government land
3	2/450 to 2/810	1223/997/1, 1226/998/1, 1235/1042/1, 1235/1042/2, 1238/1042/1, 458/3/1, 458/3/2, 105/1, 105/2	Government land
4	2/810 to 3/045	102/1, 45/1	Private land
5	3/045 to 3/150	74/1, 72/1	Government land
6	3/150 to 3/600	71/1, 35/1, 33/1	Private land

Executive Engineer,  
Shimla Rural Division  
H.P.W.D., Dhamsi

Assistant Engineer  
H.P.W.D. Sub Division  
Dhamsi

वैरली

धामनी

शिमला

27 27

30 20 50 40  
5 22 5 26  
29 21  
5 47

00-02-45 देव (घासनी)

प्रस्तावित सडक

सडक

No Gift Deed

$\frac{30+40}{2} = \frac{5+5}{2} = 5$

$\frac{50+40}{2} = \frac{5+47}{2} = 49$

$49 \times 5 = 245$

बाकी रकम मांदा  
वदस्तूर रहा

00-23-33 दे०

घासनी

35 35

30 50 80 90  
5 54 5 56  
 $\frac{30+40}{2} = \frac{5+5}{2} = 5$

00-02-75 दे०

बांजर कडमि

प्रस्तावित सडक

$\frac{50+40}{2} = \frac{5+56}{2} = 55$

$55 \times 5 = 275$

बाकी रकम मांदा  
वदस्तूर रहा

00-19-22 दे०

बांजर कडमि

33 33

30 50 80 90  
5 48 5 48  
 $\frac{30+40}{2} = \frac{5+5}{2} = 5$

00-02-40 दे०

घासनी

प्रस्तावित सडक

$\frac{50+40}{2} = \frac{48+48}{2} = 48$

$48 \times 5 = 240$

बाकी रकम मांदा  
वदस्तूर रहा

00-28-72 दे०

घासनी

00-00-95 दे०

घासनी

प्रस्तावित सडक

71 71

30 50 80 90  
5 21 5 18

$$\frac{30+90}{2} = \frac{5+5}{2} = 5$$

$$\frac{50+40}{2} = \frac{2+18}{2} = 19$$

$$19 \times 5 = 95$$

बाकी रकमा मांदा  
वदस्तूर रहे।

००-१७-३९<sup>१९</sup> ६०  
वासनी

$$72 \quad \frac{72}{1}$$

$$\begin{array}{r} 30 \quad 50 \quad 40 \quad 50 \quad 00-04-60 \text{ हेमट } \\ 5 \quad 45 \quad 5 \quad 22 \quad \text{वासनी} \\ 30 \quad 24 \quad \text{प्रस्तावित सडक} \\ 14 \quad 44 \\ \hline 84 \quad 95 \end{array}$$

$$\frac{30+90}{2} = \frac{5+5}{2} = 5$$

$$\frac{50+40}{2} = \frac{89+95}{2} = 91$$

$$91 \times 5 = 460$$

बाकी रकमा मांदा ००-३५-६०<sup>१९</sup> ६०  
वदस्तूर रहे। वासनी

$$74 \quad \frac{74}{1}$$

$$30 \quad 50 \quad 40 \quad 50 \quad 00-01-45 \text{ हेमट}$$

$$5 \quad 32 \quad 5 \quad 26 \quad \text{वासनी}$$

$$\frac{30+90}{2} = \frac{5+5}{2} = 5$$

प्रस्तावित सडक

$$\frac{50+40}{2} = \frac{32+26}{2} = 29$$

$$29 \times 5 = 145$$

बाकी रकमा मांदा  
वदस्तूर रहे।

००-५५-०७<sup>१९</sup> ६०  
वासनी

$$75 \quad \frac{75}{1}$$

$$30 \quad 50 \quad 40 \quad 50 \quad 00-07-६५ \text{ हेमट}$$

$$12 \quad 5 \quad 53 \quad 5 \quad \text{वासनी}$$

$$16 \quad 40$$

$$16 \quad 12$$

$$13 \quad 42$$

$$17 \quad 147$$

$$26 \quad 158$$

$$48 \quad 158$$

प्रस्तावित सडक

222

मा. १५२

शमल

प्रश्न संख्या	प्रश्न	समाधान	निष्कर्ष
101	$\frac{30+90}{2} = \frac{158+147}{2}$ $= 153$ $\frac{50+90}{2} = \frac{5+5}{2} = 5$ $153 \times 5 = 765$	मोदी खरबों मांदा बड़सूख रहा	$100 - 44 - 19 = 37$ वासनी
102	$\frac{102}{1}$ $\frac{30+90}{2} = \frac{158+163}{2}$ $= 160$ $\frac{50+90}{2} = \frac{5+5}{2} = 5$ $160 \times 5 = 800$	$\frac{60}{45}$ $\frac{55}{48}$ $\frac{5}{60}$ $\frac{158}{163}$	$100 - 08 - 00 = 92$ पं० वि० ५० प्रस्तावित ५०
103	$\frac{102}{2}$ $\frac{60 \times 16}{2} = 480$ $66 \times \frac{(45+9)}{2} = 1782$ $\frac{100 \times 24}{2} = 1200$ $58 \times 15 = 435$ $34 \times 15 = 285$ $35 \times (4+2) = 105$ $18 \times 3 = 27$	$100 - 04 - 80 = 16$ पं० वि० ५०	$100 - 38 - 34 = 28$ पं० वि० ५०

$$\frac{102}{4}$$

वाकी रकवा मांदा 02-66-79<sup>४०</sup>  
बदस्तूर रहा च० वि० ५०

$$\frac{105}{1}$$

30 50 40 00-04-45 हेन  
31 5 28 5 वापस  
13 10 प्रस्तावित ५५५  
13 10  
11 8  
28 26  
96 82

$$\frac{30+50}{2} = \frac{96+82}{2}$$

$$= 89$$

$$\frac{50+40}{2} = \frac{5+5}{2} = 5$$

$$89 \times 5 = 445$$

$$\frac{105}{2}$$

$$40 \frac{(18+16)}{2} = 68 \text{ 00-07-47<sup>४०</sup> वापस}$$

$$24 \times 4 = 48 \text{ डंपिंग साइट}$$

$$\frac{14 \times 3}{2} = 19$$

$$\frac{105}{3}$$

वाकी रकवा मांदा 01-48-48<sup>४०</sup>  
बदस्तूर रहा चोसनी

पडताल शुद्ध

Bimpab  
Hypomnch

Village 17/6/11/21  
Chanawag

संख्या दोड़ की जमा

बोली

सिखा रिमला

$$\begin{array}{r} 458 \\ 3 \end{array}$$

$$\begin{array}{r} 458 \\ 3 \\ \hline 1 \end{array}$$

$$\begin{array}{r} 458 \\ 3 \end{array}$$

$$\begin{array}{r} 458 \\ 3 \\ \hline 2 \end{array}$$

$$\begin{array}{r} 458 \\ 3 \end{array}$$

$$\begin{array}{r} 458 \\ 3 \\ \hline 3 \end{array}$$

$$\begin{array}{r} 458 \\ 3 \end{array}$$

$$\begin{array}{r} 458 \\ 3 \\ \hline 4 \end{array}$$

$$\begin{array}{r} 458 \\ 3 \end{array}$$

$$\begin{array}{r} 458 \\ 3 \\ \hline 5 \end{array}$$

पञ्चाङ्ग

Bimhal

High Mandi

$$30 \times 90 = 2700$$

$$43 \times 5 = 215$$

$$\frac{30+90}{2} = \frac{45+43}{2}$$

$$44$$

$$\frac{50+90}{2} = \frac{5+5}{2} = 5$$

$$44 \times 5 = 220$$

$$50 \times 90 = 4500$$

$$58 \times 5 = 290$$

$$\frac{50 \times 90}{2} = \frac{58 \times 61}{2} = 60$$

$$\frac{50+90}{2} = \frac{5+5}{2} = 5$$

$$60 \times 5 = 300$$

$$43 \times 3 = 129$$

$$60 \left( \frac{5+22}{2} \right) = 810$$

$$\frac{43 \times 3}{2} = 64$$

$$30 \times 84 = 2520$$

$$40 \times 84 = 3360$$

10-02-20

10-03-20

10-08-10

10-00-64

10-03-84

10-08-10

10-00-64

10-03-84

10-08-10

10-00-64

10-03-84

10-08-10

10-00-64

10-03-84

10-08-10

10-00-64

10-03-84

10-08-10

10-00-64

10-03-84

10-08-10

10-00-64

10-03-84

10-08-10

10-00-64

10-03-84

10-08-10

10-00-64

10-03-84

10-08-10

10-00-64

10-03-84

16/11/21  
Chenay

सं. नोट की जायज

सं. धार

सं. रिमल

$$\begin{array}{r} 458 \\ 3 \\ \hline 1 \end{array}$$

$$\begin{array}{r} 458 \\ 3 \\ \hline 2 \end{array}$$

$$\begin{array}{r} 458 \\ 3 \\ \hline 3 \end{array}$$

$$\begin{array}{r} 458 \\ 3 \\ \hline 4 \end{array}$$

$$\begin{array}{r} 458 \\ 3 \\ \hline 5 \end{array}$$

पञ्चमं  
Bimhal  
Hig Mandhi

$$30 \times 2 = 60$$

$$43 \times 5 = 215$$

$$\frac{30+43}{2} = \frac{73}{2} = 36.5$$

$$\frac{50+90}{2} = \frac{140}{2} = 70$$

$$44 \times 5 = 220$$

$$50 \times 6 = 300$$

$$58 \times 5 = 290$$

$$\frac{50+90}{2} = \frac{140}{2} = 70$$

$$\frac{50+90}{2} = \frac{140}{2} = 70$$

$$60 \times 5 = 300$$

$$43 \times 3 = 129$$

$$60(5+22) = 810$$

$$\frac{43 \times 3}{2} = 64.5$$

$$30 \times 2 = 60$$

$$43 \times 5 = 215$$

००-०२-२० ई. २०  
-०० वि. २०  
प्र. ला. वि. २०

००-०३-०० ई. २०  
-०० वि. २०  
प्र. ला. वि. २०

००-०८-१० ई. २०  
-०० वि. २०

००-००-६५ ई. २०  
-०० वि. २०

००-०३-८५ ई. २०  
-०० वि. २०

16/11/21  
Chenay

महाराष्ट्र जल संयंत्र

उप जल नाली

दिनांक

479

$$\frac{495}{1}$$

उ. ज. सं. प.

0-01-02 ई०

17 17 17 5

जं. कु. नाला

$$\frac{17+17}{2} = 17$$

प्रस्तावित बांध

$$\frac{7+5}{2} = 6$$

$$17 \times 6 = 102$$

वाकि रचना

00-88-82 ई०

आन्दा वदस्तूर

जं. कु. नाला

498

$$\frac{498}{1}$$

$$\frac{64(575)}{2} = 320$$

0-03-20 ई०

रागा

प्रस्तावित बांध

वाकि रचना

खोलान

आन्दा वदस्तूर

00-83-32

परागा

खोलान

223

$$\frac{223}{1}$$

$$\frac{19(445)}{2} = 85$$

0-01-35

जं. कु. नाला

जो.

$$\frac{20 \times 5}{2} = \frac{50}{135}$$

प्रस्तावित बांध

वाकि रचना

00-00-79

आन्दा वदस्तूर

जं. कु. नाला

$$\frac{1219}{974}$$

$$\frac{1219}{974}$$

$$\frac{9(444)}{8} = 36$$

00-00-36

जं. कु. नाला

प्रस्तावित बांध

वाकि रचना

00-04-49

आन्दा वदस्तूर

जं. कु. नाला

पत्राव बुक

Bimhal  
F.K. Mandhi

1217  
974

1217  
974  
1

3.	पू.	द.	4.
21	5	80	5
15		116	
18		10	
37		10	
24		5	
11		10	
6		7	
9		11	
19		27	
10		35	
112		20	
77		13	
		25	
359		369	

0-18-20 <sup>49</sup> ~~है~~  
परागाह  
प्रमाण  
प्रस्तावित असक

$$\frac{359+369}{2} = 364$$

$$\frac{5+5}{2} = 5$$

$$364 \times 5 = 1820$$

1217  
974  
2

130(30+4) <sup>49</sup> ~~है~~  
28860 0-6502

$$\frac{115 \times 12}{2} = 690$$

$$\frac{108 \times 11}{2} = 594$$

$$\frac{96 \times 21}{2} = 1008$$

$$\frac{87 \times 20}{2} = 870$$

प्रमाणित  
प्रमाणित  
प्रमाणित

1217  
974  
3

प्राक् प्रमाणित 01-57-65 <sup>49</sup> ~~है~~  
आन्दा वदस्तूर परागाह  
प्रमाणित

1223  
997

1223  
997  
1

3.	पू.	द.	4.
6	49	5	5
71		31	
38		66	
158		50	
		158	

0-0190 <sup>49</sup> ~~है~~  
प्राक् प्रमाणित  
प्रमाणित

$$\frac{158+158}{2} = 158$$

$$\frac{6+5}{2} = 5$$

$$5 \times 158 = 790$$

प्राक् प्रमाणित आन्दा 00-92-68 <sup>49</sup> ~~है~~  
वदस्तूर परागाह  
प्रमाणित

ਸਰ ਸ਼ਹੀਦੀ ਜੋਸ਼ੀ

ਉਪਰਾਲਾ ਬੰਸੀ

ਗਿਮਲਾ

$$\begin{array}{r} 1226 \\ 998 \\ \hline \end{array}$$

$$\begin{array}{r} 1226 \\ 998 \\ \hline 1 \end{array}$$

$$\begin{array}{r} 10(372) \\ 225 \\ \hline \end{array}$$

00-00-25 ਏ.ਓ.  
-ਯੋ.ਸਿ.ਓ.  
ਪੁਸ਼ਤਾਕਿਤ ਪਾਸਕ

ਪਾਕਿ ਰਕਾਬਾ

00-32-35 ਏ.ਓ.

ਮਾਨਾ ਕਰਮਪੁਰ

-ਯੋ.ਸਿ.ਓ.

$$\begin{array}{r} 1235 \\ 1042 \\ \hline \end{array}$$

$$\begin{array}{r} 1235 \\ 1042 \\ \hline 1 \end{array}$$

ਭ.ਯੂ.ਦ.ਪੋ

0-23-00 ਏ.ਓ.

115 5 135 6

-ਯੋ.ਸਿ.ਓ.

195

193

ਪੁਸ਼ਤਾਕਿਤ ਪਾਸਕ

136

42

5

370

451

5+6=5

$$\begin{array}{r} 370+451 \\ 2 \\ \hline 2460 \end{array}$$

$$460 \times 5 = 2300$$

$$\begin{array}{r} 1235 \\ 1042 \\ \hline 2 \end{array}$$

$$\begin{array}{r} 129(574) \\ 2 \\ \hline \end{array}$$

0-08-28 ਏ.ਓ.  
-ਯੋ.ਸਿ.ਓ.

ਕ

$$\begin{array}{r} 23 \times 5 \\ 2 \\ \hline \end{array}$$

57

ਪੁਸ਼ਤਾਕਿਤ ਪਾਸਕ

ਕ

$$\begin{array}{r} 19 \times 4 \\ 2 \\ \hline \end{array}$$

38

ਕ

$$\begin{array}{r} 34(574) \\ 2 \\ \hline \end{array}$$

2153

838

ਪਤਾਲ ਭੁੱਖ

Bmkab  
Fkgd Mandhi

$$\begin{array}{r} 1238 \\ 1042 \\ \hline \end{array}$$

$$\begin{array}{r} 1238 \\ 1042 \\ \hline 1 \end{array}$$

$$\begin{array}{r} 18 \times 4 \\ 2 \\ \hline \end{array}$$

36

0-00-36 ਏ.ਓ.  
-ਯੋ.ਸਿ.ਓ.

ਪੁਸ਼ਤਾਕਿਤ ਪਾਸਕ

ਪਾਕਿ ਰਕਾਬਾ

00-38-59 ਏ.ਓ.

ਮਾਨਾ ਕਰਮਪੁਰ

-ਯੋ.ਸਿ.ਓ.

माइली जंक्शन

धामे

रामला

$$\begin{array}{r} 525 \\ 525 \\ \hline 1 \end{array}$$

30 20 70 70 00-00-96 हेक्टर  
7 5 5 6 धालनी  
 $\frac{7}{2} \quad \frac{5}{10}$  **प्रस्तावित**  
**सड़क**

$$\frac{30+50}{2} = \frac{22+10}{2}$$

$$= 16$$

$$\frac{20+70}{2} = \frac{5+6}{2}$$

$$16 \times 6 = 96$$

बाकी रकबा मांदा 00-28-98  
बदलू रहा धालनी

$$\begin{array}{r} 526 \\ 526 \\ \hline 1 \end{array}$$

30 20 70 70 00-03-18 हेक्टर  
6 53 6 53 धालनी  
 $\frac{6}{2} \quad \frac{53}{2}$  **प्रस्तावित**  
**सड़क**

$$\frac{30+70}{2} = \frac{6+53}{2} = 53$$

$$53 \times 6 = 318$$

बाकी रकबा मांदा 00-24-07  
बदलू रहा धालनी

$$\begin{array}{r} 527 \\ 527 \\ \hline 1 \end{array}$$

30 20 70 70 00-02-76 हेक्टर  
6 50 5 42 धालनी  
 $\frac{6}{2} \quad \frac{50}{2}$  **प्रस्तावित**  
**सड़क**

$$\frac{30+70}{2} = \frac{50+42}{2}$$

$$= 46$$

$$46 \times 6 = 276$$

बाकी रकबा मांदा 00-23-36 हेक्टर  
बदलू रहा धालनी

528 528  
1

30 20 70 70 100-100-95 है  
5 18 5 20 धासनी  
प्रस्तावित  
 $\frac{30+70}{2} = \frac{5+5}{2} = 5$  सड़क  
 $\frac{20+70}{2} = \frac{18+20}{2} = 19$   
 $19 \times 5 = 95$   
बाकी रखना मांदा 100-12-35 है  
बदल रहा धासनी

576 576  
1

30 20 40 70 100-100-25 है  
5 5 5 5 प्रस्तावित  
सड़क  
 $\frac{30+70}{2} = \frac{5+5}{2} = 5$   
 $\frac{20+70}{2} = \frac{5+5}{2} = 5$   
 $5 \times 5 = 25$   
बाकी रखना मांदा  
बदल रहा

575 575  
1

30 20 40 70 100-100-30 है  
5 6 5 5 धासनी  
प्रस्तावित  
सड़क  
 $\frac{30+70}{2} = \frac{5+5}{2} = 5$   
 $\frac{20+70}{2} = \frac{6+5}{2} = 6$   
 $6 \times 5 = 30$   
बाकी रखना मांदा 100-100-90  
बदल रहा धासनी

574 574  
1

30 20 40 70 100-100-30 है  
5 7 5 5 धासनी  
प्रस्तावित  
सड़क  
 $\frac{30+70}{2} = \frac{5+5}{2} = 5$   
 $\frac{20+70}{2} = \frac{7+5}{2} = 6$   
 $5 \times 6 = 30$

बाकी रखना मांदा बदल रहा 100-101-05  
धासनी

अंशाली जायग

पामी

रिमला

573

573

1

उठ दू फो पठ ००-००-१० हव

5 2 5 2

$$\frac{5+5}{2} = \frac{5+5}{2} = 5$$

$$\frac{2+2}{2} = \frac{2+2}{2} = 2$$

$$5 \times 2 = 10$$

वाकी रकवा मांदा ००-२-४२  
वयस्तूर रद गो मुंनलो

571

571

1

उठ दू फो पठ ००-०२-५४ हव

5 8 6 33

35

43

$$\frac{5+5}{2} = \frac{5+5}{2} = 5$$

$$\frac{43+43}{2} = \frac{43+43}{2} = 43$$

$$43 \times 6 = 258$$

वाकी रकवा मांदा ००-०१-६९

वयस्तूर रद गो मुंनलो

585

585

1

उठ दू फो पठ ००-००-६० हव

6 11 6 9

$$\frac{6+6}{2} = \frac{6+6}{2} = 6$$

$$\frac{11+9}{2} = \frac{11+9}{2} = 10$$

$$10 \times 6 = 60$$

वाकी रकवा मांदा ००-१७-६९ हव

वयस्तूर रद गो मुंनलो

567 567 30 50 40 90 00-06-42 हैक्टर

$$\begin{array}{r} 567 \\ 1 \end{array}$$

$$\begin{array}{r} 30 \quad 50 \quad 40 \quad 90 \\ 6 \quad 30 \quad 5 \quad 58 \\ 25 \quad 23 \\ 44 \quad 33 \\ 99 \quad 114 \end{array}$$

$$\frac{30+90}{2} = \frac{6+5}{2} = 6$$

$$\frac{50+40}{2} = \frac{99+114}{2} = 107$$

$$107 \times 6 = 642$$

वाकी रकबा मांदा 00-00-30  
वदस्तूर रह। वाकल  
30वल

586 586 30 50 40 90 00-03-96 हैक्टर

$$\begin{array}{r} 586 \\ 1 \end{array}$$

$$\begin{array}{r} 30 \quad 50 \quad 40 \quad 90 \\ 5 \quad 37 \quad 6 \quad 4 \\ 25 \quad 27 \\ 4 \quad 21 \\ 66 \quad 13 \\ 65 \end{array}$$

$$\frac{30+90}{2} = \frac{5+6}{2} = 6$$

$$\frac{50+40}{2} = \frac{66+65}{2} = 66$$

$$66 \times 6 = 396$$

वाकी रकबा मांदा 00-11-43  
वदस्तूर रह। वाकल  
30वल

587 587 30 50 40 90 00-00-66 हैक्टर

$$\begin{array}{r} 587 \\ 1 \end{array}$$

$$\begin{array}{r} 30 \quad 50 \quad 40 \quad 90 \\ 6 \quad 11 \quad 6 \quad 11 \\ 6 \quad 11 \end{array}$$

$$\frac{30+90}{2} = \frac{6+5}{2} = 6$$

$$\frac{50+40}{2} = \frac{11+11}{2} = 11$$

$$11 \times 6 = 66$$

वाकी रकबा मांदा 00-02-55  
वदस्तूर रह। वाकल  
30वल

मोहली जागण

मोही का मो

रामल

622 622  
1

उ० पू० क० प० ००-०२-५३ एकर  
12 20 5 27 घासनी  
6 प्रस्तावित  
33 सड़क

$$\frac{उ०+प०}{2} = \frac{12+5}{2} = 9$$

$$\frac{पू०+प०}{2} = \frac{20+33}{2} = 27$$

$$27 \times 9 = 243$$

० बिक्री का मोहला वस्तु ००-०१-१०  
रहा घासनी

623 623  
1

उ० पू० क० प० ००-०१-३० एकर  
15 5 10 5 बारवले  
11 16 अकर  
26 26 प्रस्तावित  
सड़क

$$\frac{उ०+प०}{2} = \frac{26+26}{2} = 26$$

$$\frac{पू०+प०}{2} = \frac{5+5}{2} = 5$$

$$26 \times 5 = 130$$

बाकी रखवा मोहला ००-००-६८  
वस्तु रहा बारवले  
अकर

632 632  
1

उ० पू० क० प० ००-००-८५ एकर  
14 6 15 5 घासनी  
प्रस्तावित  
सड़क

$$\frac{उ०+प०}{2} = \frac{14+15}{2} = 14$$

$$\frac{पू०+प०}{2} = \frac{6+5}{2} = 6$$

$$14 \times 6 = 84$$

बाकी रखवा मोहला ००-०६-५१  
वस्तु रहा घासनी

21/12/2021

enter

2125

$$\begin{array}{r} 794 \\ 794 \\ \hline 1 \end{array}$$

1

30	20	40	40
15	5	11	5
11		11	
13		10	
7		12	
<hr/> 46		9	
		<hr/> 4	
		57	

an-02-6

2. 2. 2. 2.

2100

4411

✓

$$\frac{30+50}{2} = \frac{46+57}{2} = 52$$
$$\frac{2+9}{2} = \frac{5+5}{2} = 5$$
$$52 \times 5 = 260$$

०१/०१/२०००-०१-३१

अक-कककक

১/৫৫৫

3100

$$\frac{1188}{804} \quad \frac{1188}{804}$$

804

804

1

30	20	40	50
41	5	52	-
14			
55			

00-03-24 ~~88~~ =

विष बारकल

415-5 काददा

१५॥

रासक

$$\frac{30+50}{2} = \frac{55+52}{2}$$
$$= 54$$
$$\frac{50+90}{2} = \frac{5+7}{2} = 6$$
$$54 \times 6 = 324$$

वाकी रक्का मांदा ००-१२-७९

२५२५२५

20 170 970

4/5 4/5

~~805 805~~

805 805

1

$$\begin{array}{r} 35 \quad 50 \quad 90 \quad 40 \\ 33 \quad 5 \quad 54 \quad 5 \\ 23 \\ \hline 56 \end{array}$$

20-02-75

मा विठ्ठल

21/11/21

कृत

$$\frac{30+50}{2} = \frac{56+54}{2} = 55$$
$$\frac{50+50}{2} = \frac{5+5}{2} = 5$$
$$55 \times 5 = 275$$

20-62-76

प्राविशना माया वेदमय य. वि. ७०

$$\begin{array}{r}
 1175 - 1175 \\
 300 - 300 \\
 \hline
 1 \\
 \end{array}
 \quad
 \begin{array}{r}
 30 \quad 50 \quad 50 \quad 50 \\
 26 \quad 5 \quad 25 \quad 5 \\
 30 + 50 = 26 + 25 \\
 \hline
 2 \quad 2 \\
 = 26
 \end{array}
 \quad
 \begin{array}{l}
 00-01-30 \text{ हस्त} \\
 \text{घोसनी} \\
 \text{पुस्तकित} \\
 \text{संज्ञक}
 \end{array}$$

$$\frac{50 + 50}{2} = \frac{5 + 5}{2} = 5$$

$$26 \times 5 = 130$$

वाणि रक्का मांदा 00-05-36  
 अक्षर रक्षा घोसनी

$$\begin{array}{r}
 1202 \\
 1179 \\
 \hline
 806
 \end{array}
 \quad
 \begin{array}{r}
 1202 \\
 1179 \\
 \hline
 806
 \end{array}
 \quad
 \begin{array}{r}
 30 \quad 50 \quad 50 \quad 50 \\
 27 \quad 5 \quad 26 \quad 5 \\
 30 + 50 = 27 + 26 \\
 \hline
 2 \quad 2 \\
 = 26
 \end{array}
 \quad
 \begin{array}{l}
 00-01-30 \text{ हस्त} \\
 \text{घोसनी} \\
 \text{पुस्तकित} \\
 \text{संज्ञक}
 \end{array}$$

$$\frac{50 + 50}{2} = \frac{5 + 5}{2} = 5$$

$$26 \times 5 = 130$$

वाणि रक्का मांदा 00-03-97  
 अक्षर रक्षा घोसनी

10/11/21  
 Village Head Officer  
 Circle.. Chanaway

NO gift deed

पञ्जाब अरु

Bmhal  
 Hg Mandhi

Handwritten notes on the right margin, possibly describing the survey area or data collection methods.

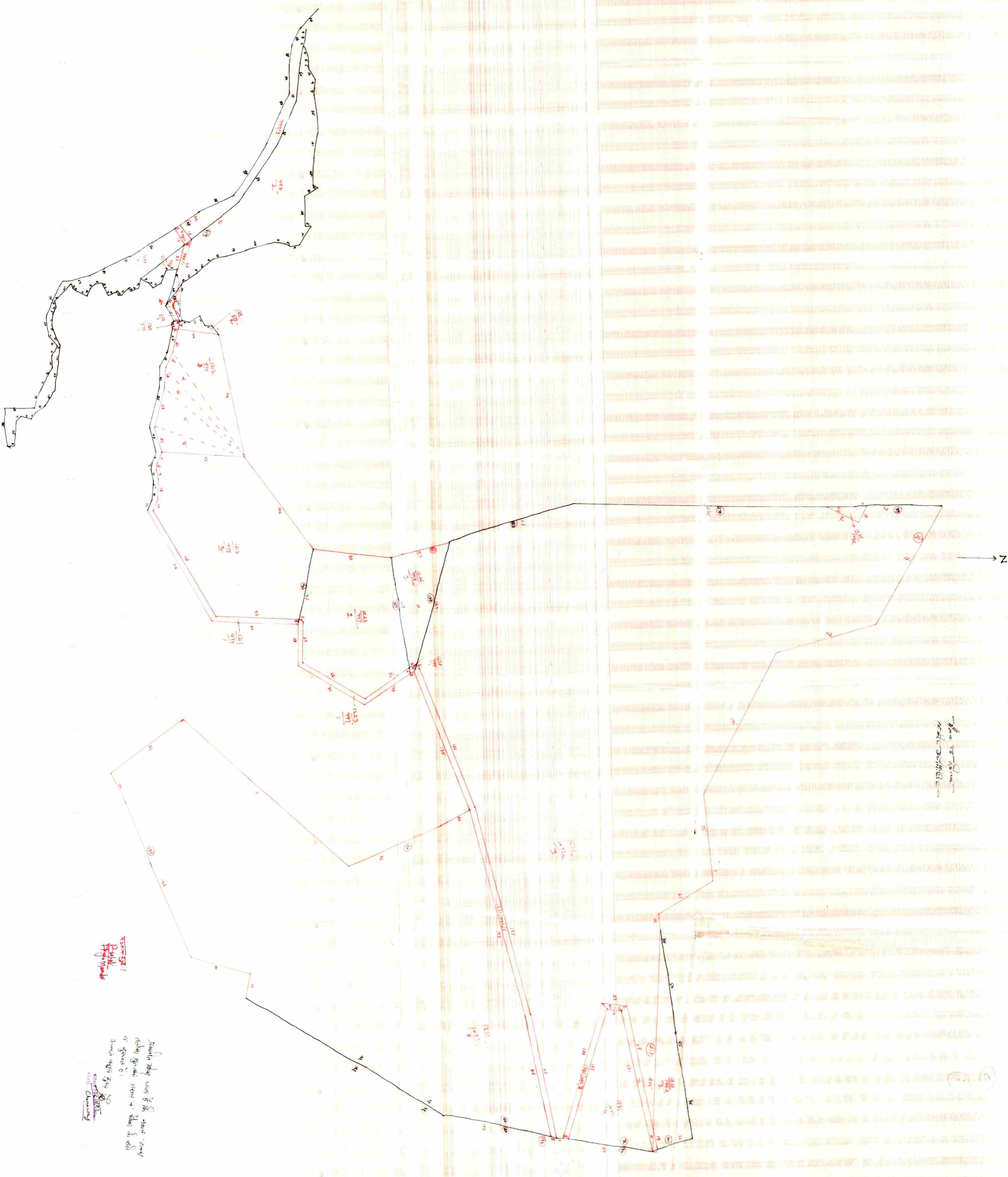

Handwritten notes in the lower left corner, possibly indicating the date or the name of the surveyor.

Handwritten notes in the bottom left corner, possibly providing additional details about the survey or the land.

नमोल अक्स (लढा) शजरा किवलपार बन्दीबस्त जदीद महाल वैरी- तहसील सुन्नी जिला बिलाल हि. प्र.

पैमाना बरिसाव 10 मीटर प्रति सेंटीमीटर

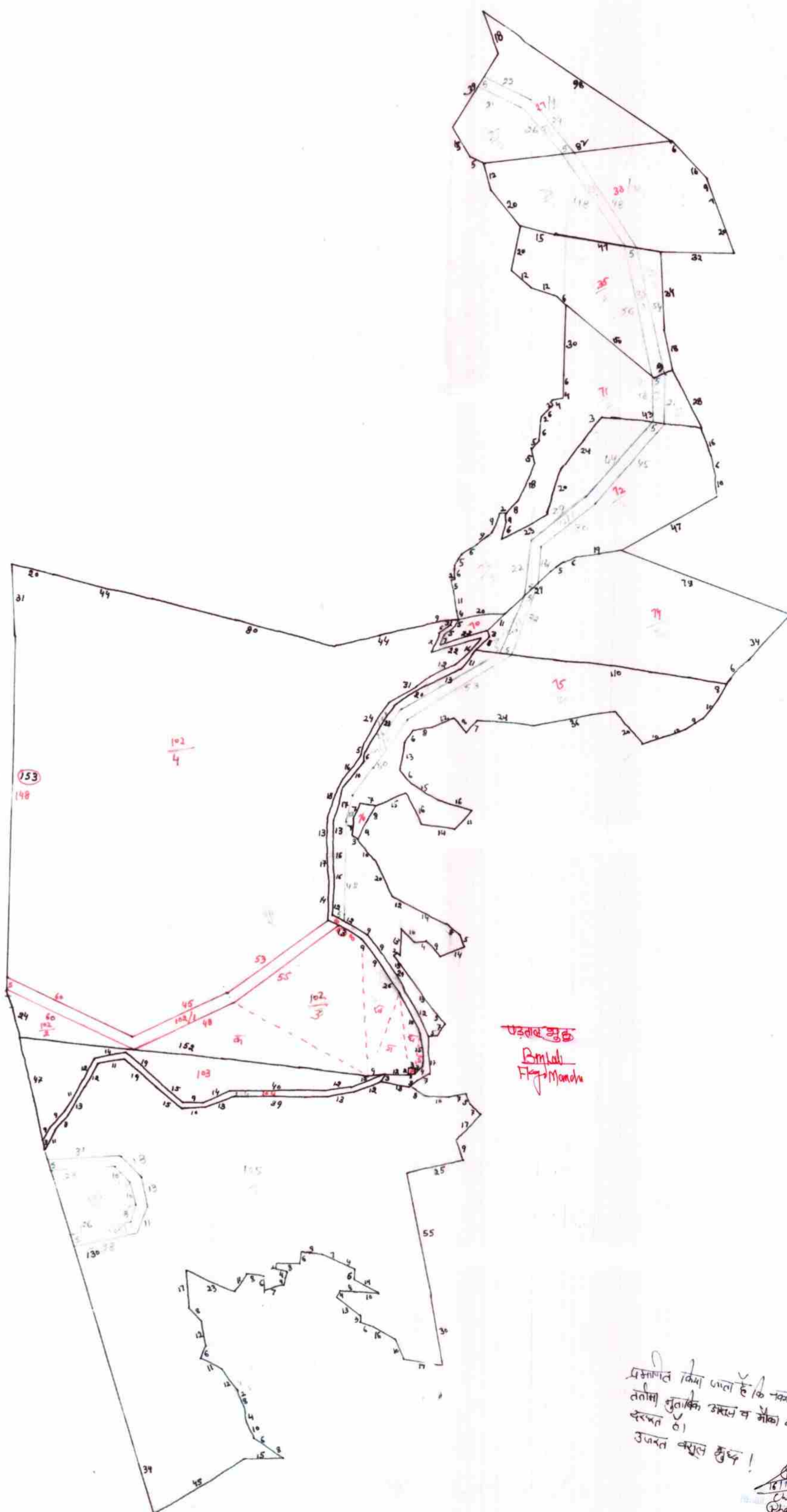

सिगला विभायल जेव्हा

विशाल १० मीटर लंबी गहिराई

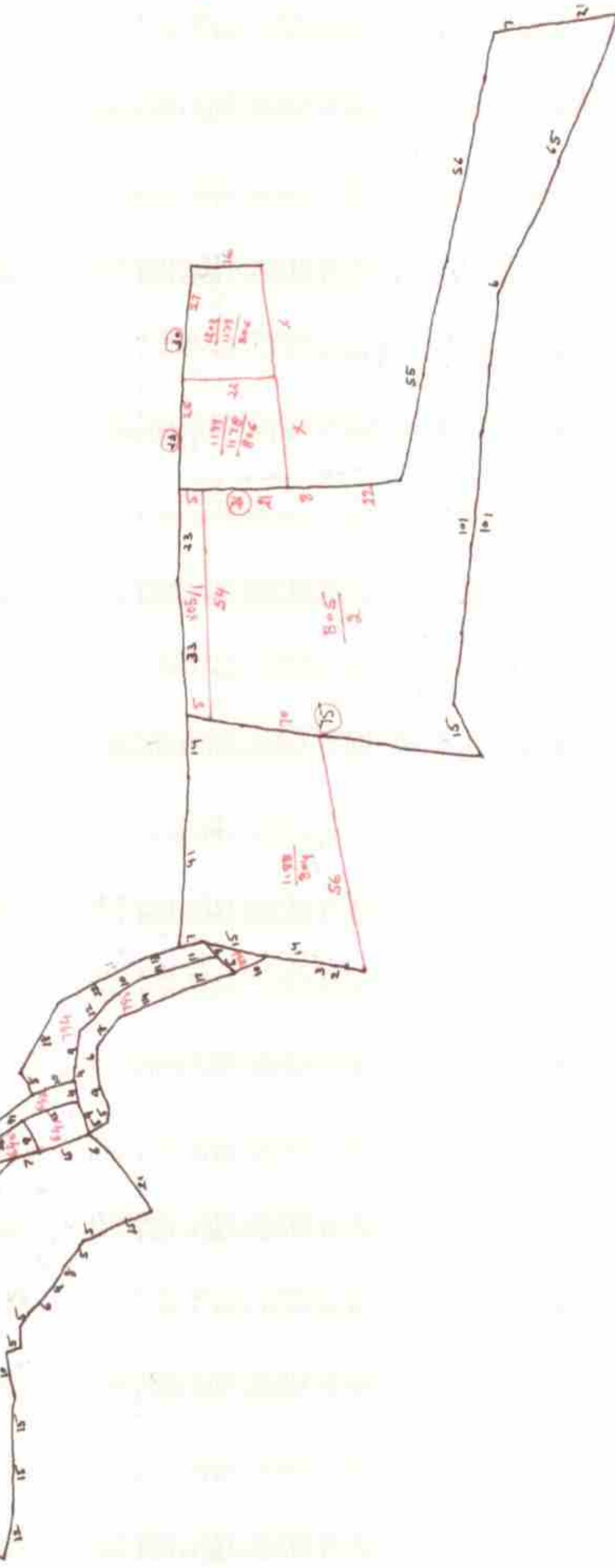
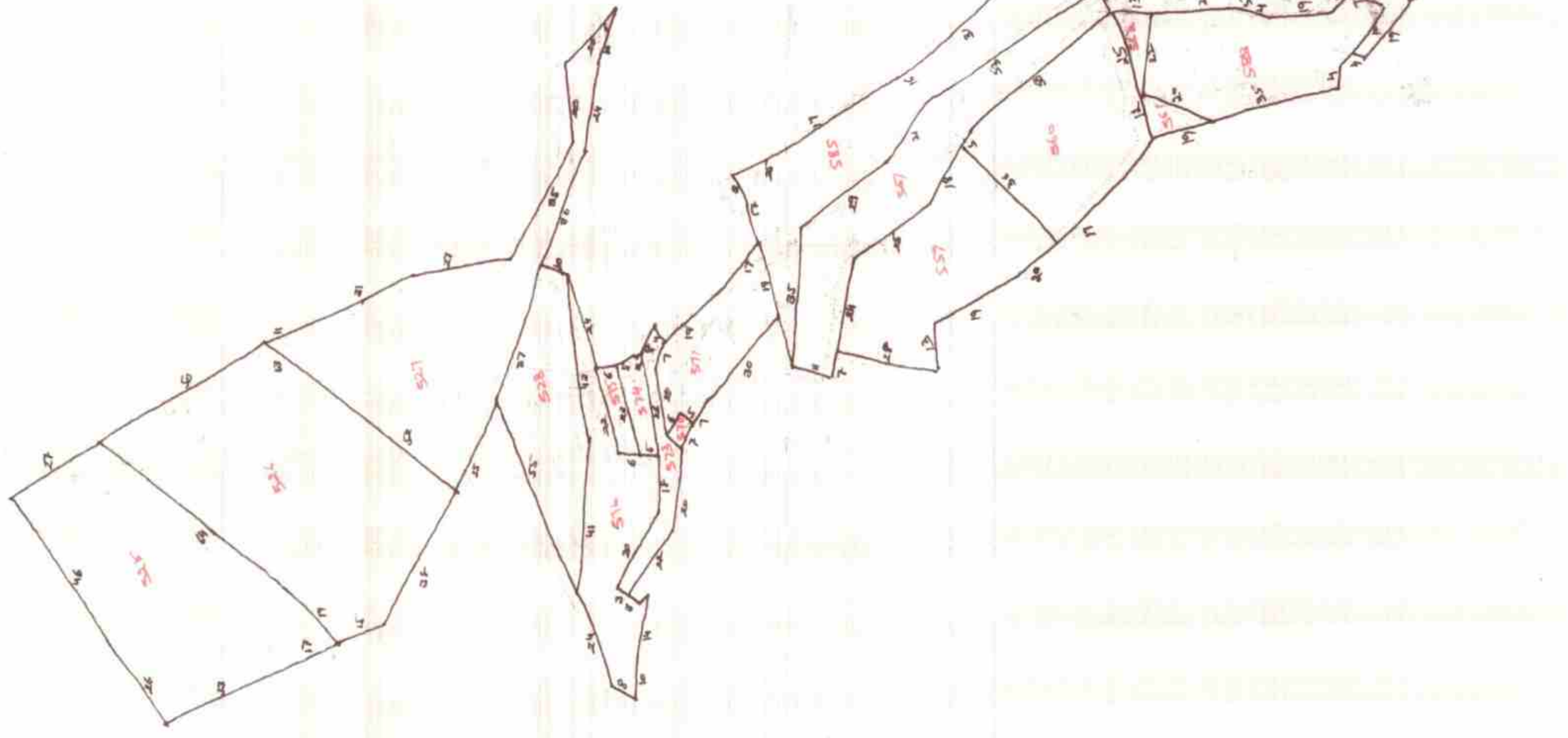

प्रमाणित किया जाता है कि नमाल अम्य  
तमिना मुलायिक कोरु के सहि व परत है एवर  
ममना सिमल ल्यात किया गया उगत वधल बाई

Handwritten text: पुस्तक / पुस्तक / पुस्तक

Village Revenue 6/11/21  
C.A.S. Channay

U (5)

1.  $182 \div 173 = 1$   
 2.  $182 - 173 = 9$   
 3.  $173 \div 9 = 19$   
 4.  $173 - 9 \times 19 = 173 - 171 = 2$   
 5.  $9 \div 2 = 4$   
 6.  $9 - 2 \times 4 = 9 - 8 = 1$   
 7.  $2 \div 1 = 2$   
 8.  $2 - 1 \times 2 = 0$   
 9.  $173 \div 9 = 19$   
 10.  $173 - 9 \times 19 = 2$   
 11.  $9 \div 2 = 4$   
 12.  $9 - 2 \times 4 = 1$   
 13.  $2 \div 1 = 2$   
 14.  $2 - 1 \times 2 = 0$   
 15.  $173 \div 9 = 19$   
 16.  $173 - 9 \times 19 = 2$   
 17.  $9 \div 2 = 4$   
 18.  $9 - 2 \times 4 = 1$   
 19.  $2 \div 1 = 2$   
 20.  $2 - 1 \times 2 = 0$   
 21.  $173 \div 9 = 19$   
 22.  $173 - 9 \times 19 = 2$   
 23.  $9 \div 2 = 4$   
 24.  $9 - 2 \times 4 = 1$   
 25.  $2 \div 1 = 2$   
 26.  $2 - 1 \times 2 = 0$   
 27.  $173 \div 9 = 19$   
 28.  $173 - 9 \times 19 = 2$   
 29.  $9 \div 2 = 4$   
 30.  $9 - 2 \times 4 = 1$   
 31.  $2 \div 1 = 2$   
 32.  $2 - 1 \times 2 = 0$   
 33.  $173 \div 9 = 19$   
 34.  $173 - 9 \times 19 = 2$   
 35.  $9 \div 2 = 4$   
 36.  $9 - 2 \times 4 = 1$   
 37.  $2 \div 1 = 2$   
 38.  $2 - 1 \times 2 = 0$   
 39.  $173 \div 9 = 19$   
 40.  $173 - 9 \times 19 = 2$   
 41.  $9 \div 2 = 4$   
 42.  $9 - 2 \times 4 = 1$   
 43.  $2 \div 1 = 2$   
 44.  $2 - 1 \times 2 = 0$   
 45.  $173 \div 9 = 19$   
 46.  $173 - 9 \times 19 = 2$   
 47.  $9 \div 2 = 4$   
 48.  $9 - 2 \times 4 = 1$   
 49.  $2 \div 1 = 2$   
 50.  $2 - 1 \times 2 = 0$   
 51.  $173 \div 9 = 19$   
 52.  $173 - 9 \times 19 = 2$   
 53.  $9 \div 2 = 4$   
 54.  $9 - 2 \times 4 = 1$   
 55.  $2 \div 1 = 2$   
 56.  $2 - 1 \times 2 = 0$   
 57.  $173 \div 9 = 19$   
 58.  $173 - 9 \times 19 = 2$   
 59.  $9 \div 2 = 4$   
 60.  $9 - 2 \times 4 = 1$   
 61.  $2 \div 1 = 2$   
 62.  $2 - 1 \times 2 = 0$   
 63.  $173 \div 9 = 19$   
 64.  $173 - 9 \times 19 = 2$   
 65.  $9 \div 2 = 4$   
 66.  $9 - 2 \times 4 = 1$   
 67.  $2 \div 1 = 2$   
 68.  $2 - 1 \times 2 = 0$   
 69.  $173 \div 9 = 19$   
 70.  $173 - 9 \times 19 = 2$   
 71.  $9 \div 2 = 4$   
 72.  $9 - 2 \times 4 = 1$   
 73.  $2 \div 1 = 2$   
 74.  $2 - 1 \times 2 = 0$   
 75.  $173 \div 9 = 19$   
 76.  $173 - 9 \times 19 = 2$   
 77.  $9 \div 2 = 4$   
 78.  $9 - 2 \times 4 = 1$   
 79.  $2 \div 1 = 2$   
 80.  $2 - 1 \times 2 = 0$   
 81.  $173 \div 9 = 19$   
 82.  $173 - 9 \times 19 = 2$   
 83.  $9 \div 2 = 4$   
 84.  $9 - 2 \times 4 = 1$   
 85.  $2 \div 1 = 2$   
 86.  $2 - 1 \times 2 = 0$   
 87.  $173 \div 9 = 19$   
 88.  $173 - 9 \times 19 = 2$   
 89.  $9 \div 2 = 4$   
 90.  $9 - 2 \times 4 = 1$   
 91.  $2 \div 1 = 2$   
 92.  $2 - 1 \times 2 = 0$   
 93.  $173 \div 9 = 19$   
 94.  $173 - 9 \times 19 = 2$   
 95.  $9 \div 2 = 4$   
 96.  $9 - 2 \times 4 = 1$   
 97.  $2 \div 1 = 2$   
 98.  $2 - 1 \times 2 = 0$   
 99.  $173 \div 9 = 19$   
 100.  $173 - 9 \times 19 = 2$   
 101.  $9 \div 2 = 4$   
 102.  $9 - 2 \times 4 = 1$   
 103.  $2 \div 1 = 2$   
 104.  $2 - 1 \times 2 = 0$   
 105.  $173 \div 9 = 19$   
 106.  $173 - 9 \times 19 = 2$   
 107.  $9 \div 2 = 4$   
 108.  $9 - 2 \times 4 = 1$   
 109.  $2 \div 1 = 2$   
 110.  $2 - 1 \times 2 = 0$   
 111.  $173 \div 9 = 19$   
 112.  $173 - 9 \times 19 = 2$   
 113.  $9 \div 2 = 4$   
 114.  $9 - 2 \times 4 = 1$   
 115.  $2 \div 1 = 2$   
 116.  $2 - 1 \times 2 = 0$   
 117.  $173 \div 9 = 19$   
 118.  $173 - 9 \times 19 = 2$   
 119.  $9 \div 2 = 4$   
 120.  $9 - 2 \times 4 = 1$   
 121.  $2 \div 1 = 2$   
 122.  $2 - 1 \times 2 = 0$   
 123.  $173 \div 9 = 19$   
 124.  $173 - 9 \times 19 = 2$   
 125.  $9 \div 2 = 4$   
 126.  $9 - 2 \times 4 = 1$   
 127.  $2 \div 1 = 2$   
 128.  $2 - 1 \times 2 = 0$   
 129.  $173 \div 9 = 19$   
 130.  $173 - 9 \times 19 = 2$   
 131.  $9 \div 2 = 4$   
 132.  $9 - 2 \times 4 = 1$   
 133.  $2 \div 1 = 2$   
 134.  $2 - 1 \times 2 = 0$   
 135.  $173 \div 9 = 19$   
 136.  $173 - 9 \times 19 = 2$   
 137.  $9 \div 2 = 4$   
 138.  $9 - 2 \times 4 = 1$   
 139.  $2 \div 1 = 2$   
 140.  $2 - 1 \times 2 = 0$   
 141.  $173 \div 9 = 19$   
 142.  $173 - 9 \times 19 = 2$   
 143.  $9 \div 2 = 4$   
 144.  $9 - 2 \times 4 = 1$   
 145.  $2 \div 1 = 2$   
 146.  $2 - 1 \times 2 = 0$   
 147.  $173 \div 9 = 19$   
 148.  $173 - 9 \times 19 = 2$   
 149.  $9 \div 2 = 4$   
 150.  $9 - 2 \times 4 = 1$   
 151.  $2 \div 1 = 2$   
 152.  $2 - 1 \times 2 = 0$   
 153.  $173 \div 9 = 19$   
 154.  $173 - 9 \times 19 = 2$   
 155.  $9 \div 2 = 4$   
 156.  $9 - 2 \times 4 = 1$   
 157.  $2 \div 1 = 2$   
 158.  $2 - 1 \times 2 = 0$   
 159.  $173 \div 9 = 19$   
 160.  $173 - 9 \times 19 = 2$   
 161.  $9 \div 2 = 4$   
 162.  $9 - 2 \times 4 = 1$   
 163.  $2 \div 1 = 2$   
 164.  $2 - 1 \times 2 = 0$

Bibi Mash

②  $\frac{101121}{101121}$