

PROPOSED LAYOUT PLAN FOR KUPVI TEHSIL BUILDING CHOPAL DISTT. SHIMLA (H.P.)

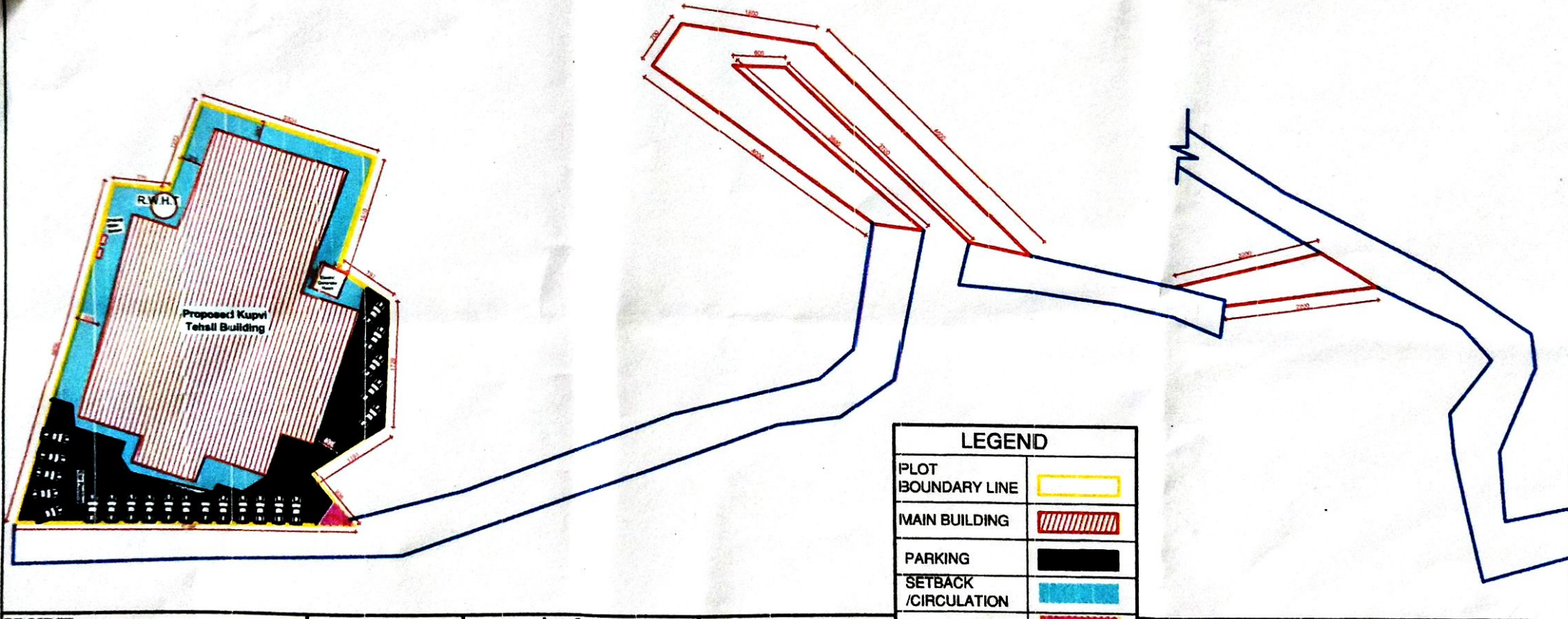

LEGEND	
PLOT BOUNDARY LINE	
MAIN BUILDING	
PARKING	
SETBACK /CIRCULATION	
MAIN ENTRY	
APPROACH ROAD (FOREST AREA)	

PROJECT :-
PROPOSED LAYOUT PLAN FOR
KUPVI TEHSIL BUILDING CHOPAL
DISTT. SHIMLA (H.P.)

NOTES
ALL DIMENSIONS ARE IN (CM.)
Scale - NTS
Dwg. no. - 01
CONCEPT OF DRAWING
SITE PLAN

Area Statement	
PROPOSED BUILDING AREA	= 1174.00 SQMT.
CAR PARKING AREA	= 428.00 SQMT.
ELECTRIC GENERATOR	= 115.00 SQMT.
R.W.H.T. AREA	= 131.00 SQMT.
DRINKING WATER AREA	= 3.00 SQMT.
CIRCULATION /SETBACK AREA	= 453.60 SQMT.
MAIN ENTRY AREA	= 8.40 SQMT.
TOTAL AREA	= 2147 SQMT.

Road Area Statement	
APPROACH ROAD (AREA)	658.00 SQMT.

VASTUKAR & ASSOCIATES
 ARCHITECTS ENGINEERS ESTIMATORS
 LANDSCAPERS INTERIOR DESIGNER
 CONTRACTOR & CONSULTANTS

Deputy Conservator of Forests
 Chopal Forest Division

Tehsildar
 Kupvi, Tehsil Kupvi
 Distt. Shimla H.P.