

Design Chainage			
S. N.	From	To	Length (km.)
1	33.200	33.300	0.100
2	35.100	35.600	0.500
3	36.100	36.250	0.150
4	37.400	37.600	0.200
5	38.000	38.500	0.500
6	38.750	39.200	0.450
Total Length (Km)			1.900

Note :- 1. The Shape & size of drain shall be as per drainage design.
2. All Dimension are in mm unless & Otherwise Specified.

Fig.-3
Concentric widening, Reconstruction & Raising to 2-Lane
with Paved shoulder
(Open Country Plain/ Rolling Terrain)

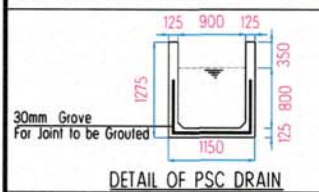
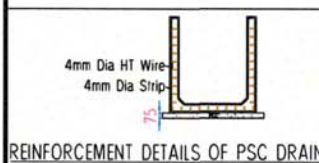
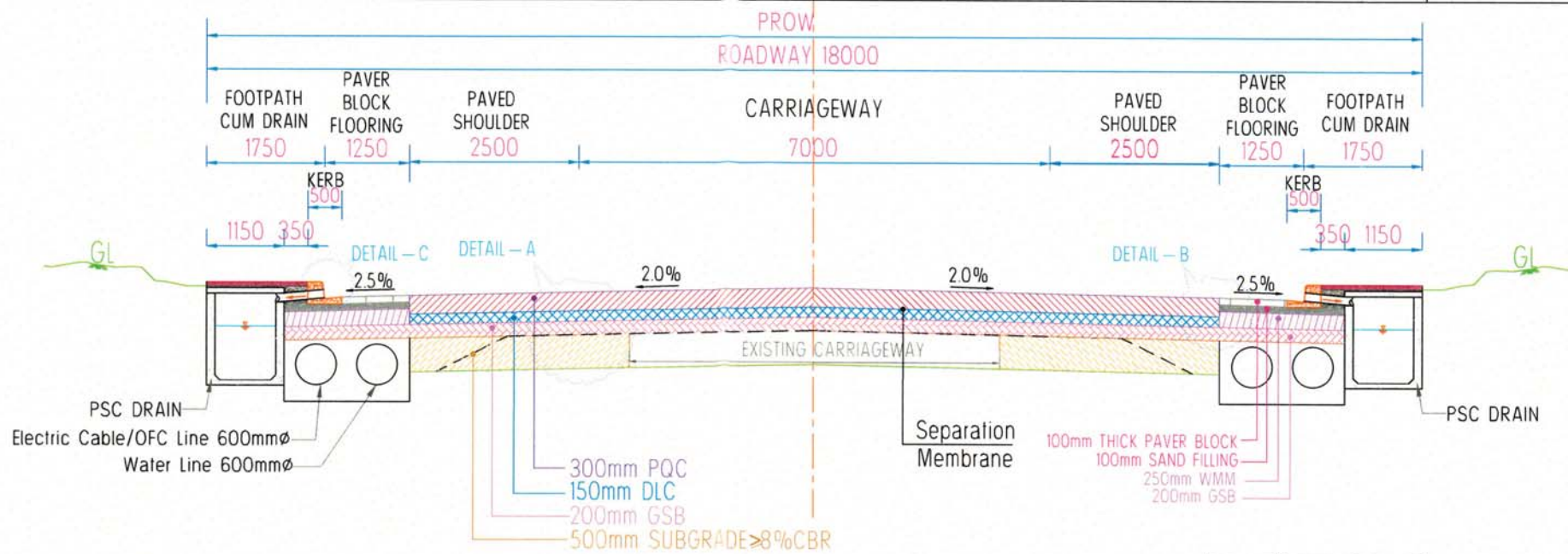
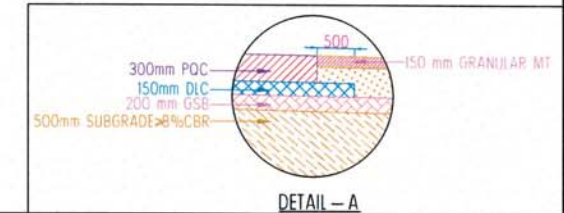

Design Chainage			
S. N.	From	To	Length (km.)
1	6.030	7.100	1.070
2	7.300	7.600	0.300
Total Length (Km)			1.370

Note :- 1. The Shape & size of drain shall be as per drainage design.
2. All Dimension are in mm unless & Otherwise Specified.
3. The Paver Block width may varies as per available ROW

Fig.-4
Concentric widening to 2-Lane
with Paved shoulder in Built-up section
(Built-up Section Plain/Rolling Terrain)

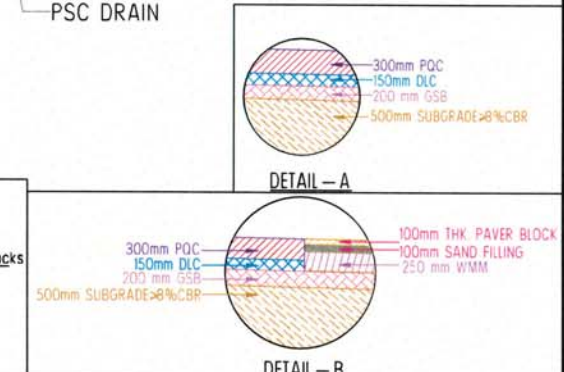
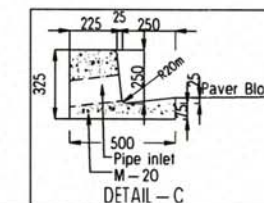

CLIENT -
MINISTRY OF ROAD TRANSPORT AND HIGHWAY
(N.H. DIVISION, PWD, MAHARASHTRA)

REV	DATE	DETAILS OF REVISION	DRAWN	CHECKED	APPROVED
RD	20-03-2017	FINAL FEASIBILITY REPORT	ADL	AM	SBM
RD	08-01-2017	DRAFT FEASIBILITY REPORT	ADL	AM	SBM

CONSULTANT -
K & J Projects Pvt. Ltd.
Shivam, 16 NIT Layout, Ravinagar,
Nagpur-440033 Maharashtra, India.
Ph : (0712)2556402, Fax : 2556403
Email : contact@knjprojects.com

NAME OF WORK:
Up-gradation of NH-3531 starting from Wadi connecting to Hingna T point Isasani-Mihan-Outer Ring Road-Gumgaon-Salaidhabha-Butibori MIDC-Takalghat-Khapri Moreshwar-Asola-Sindi Railway-Pavnar to Two Lane with Paved Shoulder configuration in section from Wadi Junction (Existing km. 9+200 (NH-53) to Asola Junction (Existing km. 39+400 (NH-361) [Design km.0.000 to km. 39.200] in the State of Maharashtra on EPC Mode

DRG. NO. 00392/KJ/FFR/WSP/PK-U/TYPCS-2
SCALE: NTS
TITLE: TYPICAL CROSS SECTION
Fig. No. 3 & 4

[Signature]
Executive Engineer
National Highway Division
Nagpur

Attachment-6 , Typical Cross section

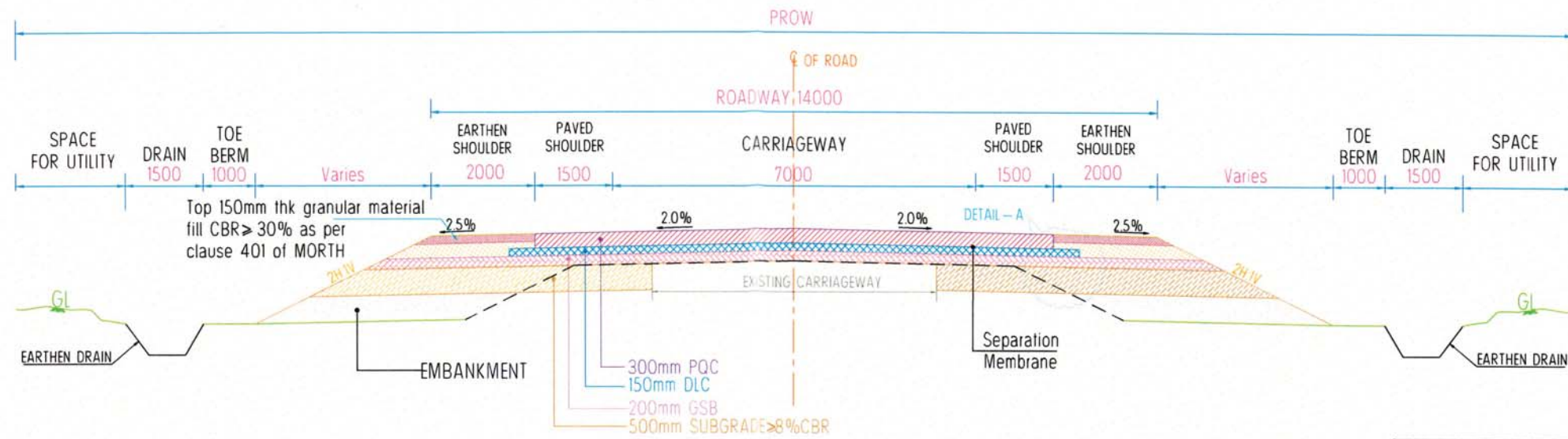

Design Chainage			
S. N.	From	To	Length (km.)
1	9.050	9.500	0.450
2	9.800	10.300	0.500
3	10.450	10.700	0.250
4	10.900	11.100	0.200
5	11.300	11.800	0.500
6	13.200	14.250	1.050
7	14.400	15.100	0.700
8	15.200	15.650	0.450
9	15.750	17.200	1.450
10	24.000	25.000	1.000
11	25.200	25.500	0.300
12	26.300	26.700	0.400
13	26.700	27.920	1.220
14	30.580	31.500	0.920
Total Length (Km)			9.390

Fig.-1
Concentric widening & Reconstruction from Sub base to 2-Lane with Paved shoulder
(Open Country Plain/ Rolling Terrain)

Note :-1. The Shape & size of drain shall be as per drainage design.
2. All Dimension are in mm unless & Otherwise Specified.

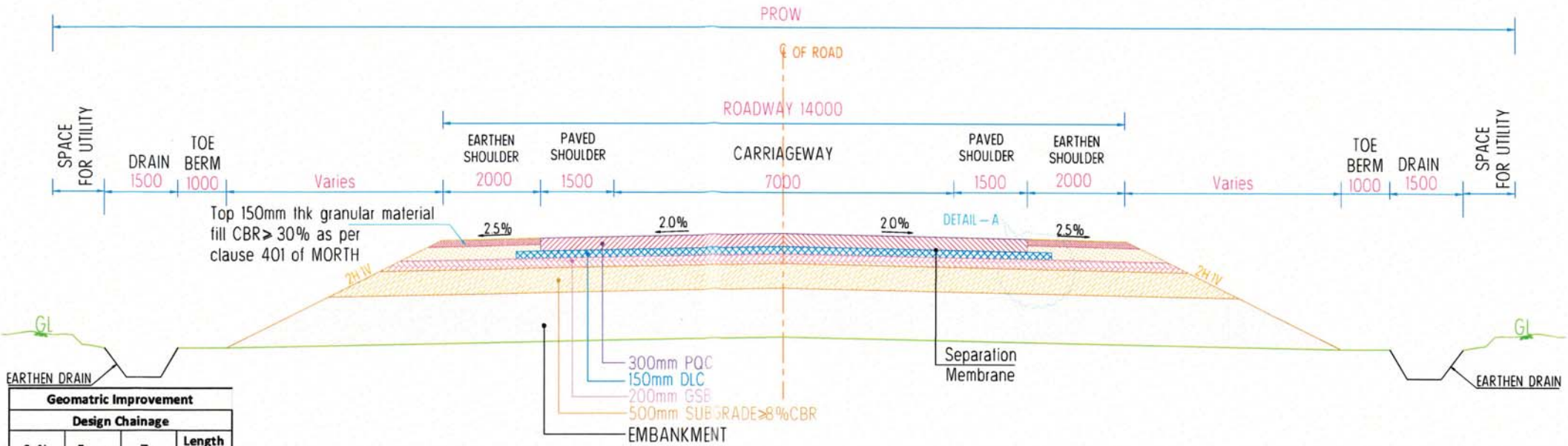
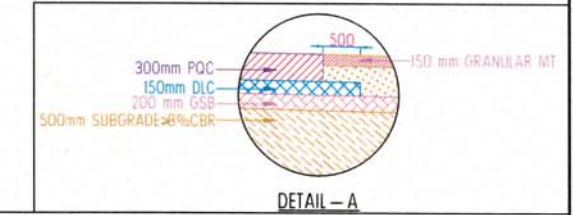

Realignment Design Chainage			
S. N.	From	To	Length (km.)
1	7.600	8.460	0.860
2	8.460	8.800	0.340
3	8.800	9.050	0.250
4	9.500	9.800	0.300
5	12.300	13.200	0.900
6	25.500	26.300	0.800
7	31.500	31.800	0.300
8	32.500	33.200	0.700
9	33.300	35.100	1.800
10	35.600	36.100	0.500
11	36.250	36.900	0.650
12	37.100	37.400	0.300
13	37.600	38.000	0.400
14	38.500	38.750	0.250
Total Length (Km)			8.350

Geometric Improvement Design Chainage			
S. N.	From	To	Length (km.)
1	10.300	10.450	0.150
2	10.700	10.900	0.200
3	11.100	11.300	0.200
4	14.250	14.400	0.150
5	15.100	15.200	0.100
6	15.650	15.750	0.100
7	25.000	25.200	0.200
8	36.900	37.100	0.200
Total Length (Km)			1.300

Fig.-2
Realignment/ Geometric Improvement to 2-Lane with Paved shoulder
(Open Country Plain/ Rolling Terrain)

Note :-1. The Shape & size of drain shall be as per drainage design.
2. All Dimension are in mm unless & Otherwise Specified.

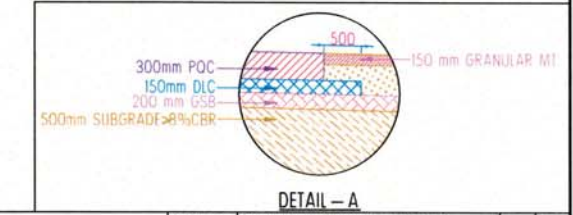

CLIENT - MINISTRY OF ROAD TRANSPORT AND HIGHWAY (N.H. DIVISION, PWD, MAHARASHTRA)	CONSULTANT - K & J Projects Pvt. Ltd. Shivam, 16 NIT Layout, Ravinagar, Nagpur-440033 Maharashtra, India. Ph : (0712)2556402, Fax : 2556403 Email : contact@knjprojects.com	NAME OF WORK: Up-gradation of NH-3531 starting from Wadi connecting to Hingna T point Isasani-Mihan-Outer Ring Road-Gumgaon-Salaiddhabha-Butibori MIDC-Takalghat-Khapri Moreshwar-Asola-Sindi Railway-Pavnar to Two Lane with Paved Shoulder configuration in section from Wadi Junction (Existing km. 9+200 (NH-53) to Asola Junction (Existing km. 39+400 (NH-361) [Design km.0.000 to km. 39.200] in the State of Maharashtra on EPC Mode	DRG. NO. 00392/KJ/FFR/WSP/PK-U/TYPCS-1 SCALE NTS TITLE: TYPICAL CROSS SECTION Fig. No. 1 & 2
---	--	---	---

[Signature]
Executive Engineer
National Highway Division
Nagpur

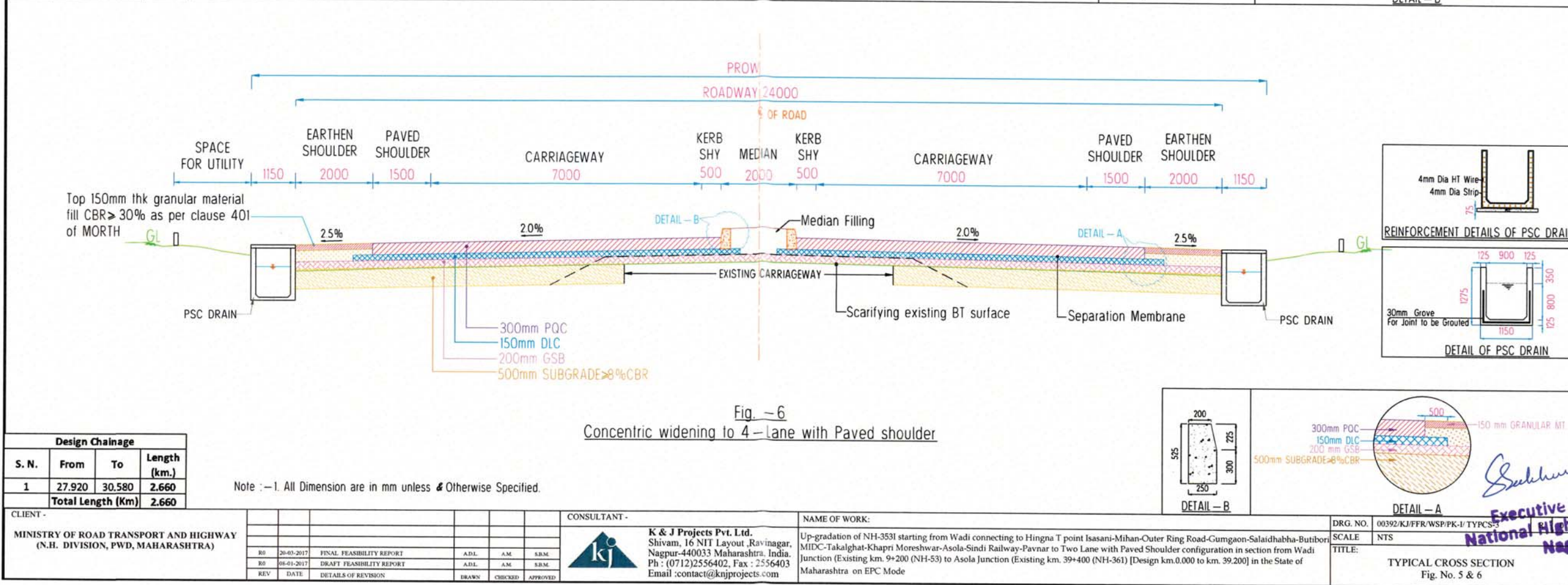
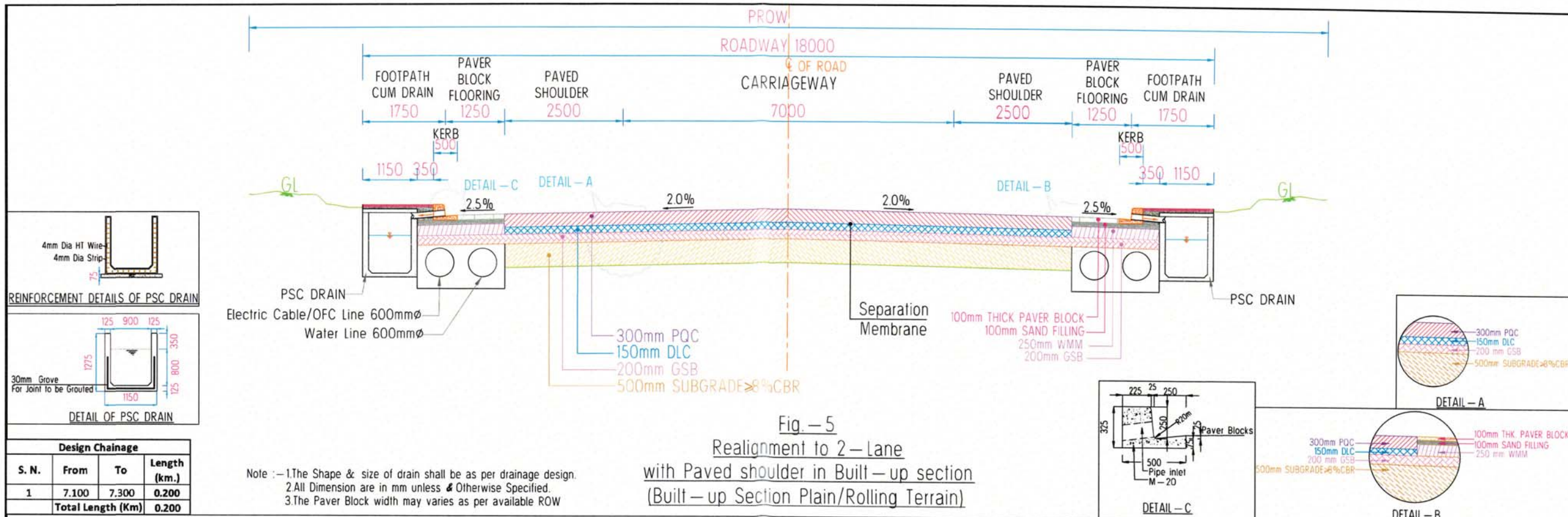

Design Chainage

S. N.	From	To	Length (km.)
1	7.100	7.300	0.200
Total Length (Km)			0.200

Design Chainage

S. N.	From	To	Length (km.)
1	27.920	30.580	2.660
Total Length (Km)			2.660

CLIENT - MINISTRY OF ROAD TRANSPORT AND HIGHWAY (N.H. DIVISION, PWD, MAHARASHTRA)	CONSULTANT - K & J Projects Pvt. Ltd. Shivam, 16 NIT Layout, Ravinagar, Nagpur-440033 Maharashtra, India. Ph : (0712)2556402, Fax : 2556403 Email : contact@knjprojects.com	NAME OF WORK: Up-gradation of NH-3531 starting from Wadi connecting to Hingna T point Isasani-Mihan-Outer Ring Road-Gumgaon-Salaidhaba-Butibori MIDC-Takalghat-Khapri Moreshwar-Asola-Sindi Railway-Pavnar to Two Lane with Paved Shoulder configuration in section from Wadi Junction (Existing km. 9+200 (NH-53) to Asola Junction (Existing km. 39+400 (NH-361) [Design km.0.000 to km. 39.200] in the State of Maharashtra on EPC Mode	DRG. NO. 00392/KJ/FFR/WSP/PK-I/TYPCS-3 SCALE NTS TITLE: TYPICAL CROSS SECTION Fig. No. 5 & 6
REV. DATE. DETAILS OF REVISION	DRAWN CHECKED APPROVED		

Sushil
Executive Engineer
National Highway Div
Nagpur

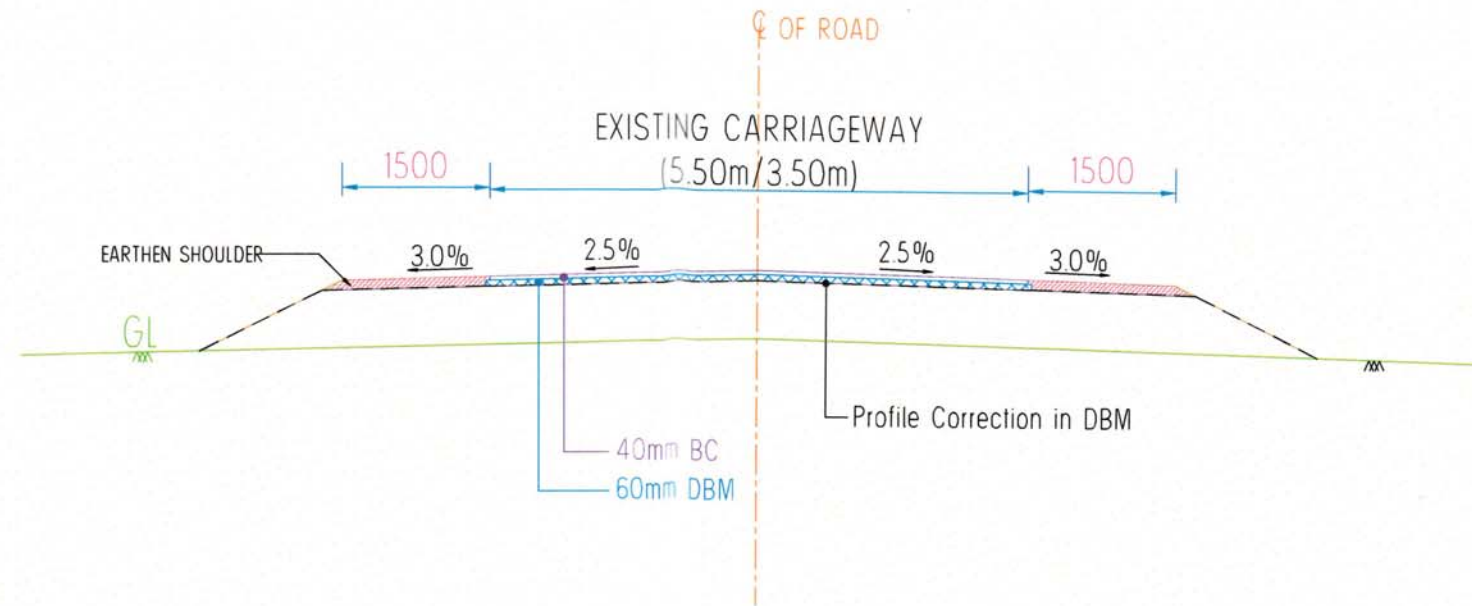

Fig. - 09
Strengthening to Existing Road with Earthen Shoulder

Design Chainage			
S. N.	From	To	Length (km.)
1	17.200	24.000	6.800
Total Length (Km)			6.800

Sahdev
Executive Engineer
National Highway Division
Nagpur

CLIENT -		CONSULTANT -		NAME OF WORK:		DRG. NO.	00392/KJ/FFR/WSP/PK-I/TYPCS-5	R	0
MINISTRY OF ROAD TRANSPORT AND HIGHWAY (N.H. DIVISION, PWD, MAHARASHTRA)		K & J Projects Pvt. Ltd. Shivam, 16 NIT Layout, Ravinagar, Nagpur-440033 Maharashtra, India. Ph : (0712)2556402, Fax : 2556403 Email : contact@knjprojects.com		Up-gradation of NH-3531 starting from Wadi connecting to Hingna T point Isasani-Mihan-Outer Ring Road-Gumgaon-Salaidhabha-Butibori MIDC-Takalghat-Khapri Moreshwar-Asola-Sindi Railway-Pavnar to Two Lane with Paved Shoulder configuration in section from Wadi Junction (Existing km. 9+200 (NH-53) to Asola Junction (Existing km. 39+400 (NH-361) [Design km.0.000 to km. 39.200] in the State of Maharashtra on EPC Mode		SCALE	NTS		
REV	DATE	DETAILS OF REVISION	DRAWN	CHECKED	APPROVED	TITLE: TYPICAL CROSS SECTION Fig. No. 9			