

AREA DETAIL

PLOT AREA	= 1602.78 sq. mt.
TOTAL BUILDING AREA	= 2750.00 sq. mt.
TOTAL CANOPY AREA	= 2750.00 sq. mt.

ITEM DATA SHEET

Product	Quantity	No. of Tank	L	D	PL	PL2
WT	16.0	1	5.000	2.000	500	500
PHO	22.0	2	6.000	2.500	500	500

NON FOREST AREA: 1602.78 SQ. MT. or 0.1603 Hectare

APPROACH ROAD AREA

1. AREA = A+A' = 2(11.50 X 15.27) = 351.21 sq.mt
 2. AREA = B+B' = 2(1/2 X 5.0X5.0 - 2/3 X 7.0 X 1.46) = 11.24 sq.mt.
 TOTAL AREA = 2(12.50 - 6.88) = 362.45 SQ.MT.
 TOTAL AREA = 351.21 + 11.24 = 0.0362 hectare

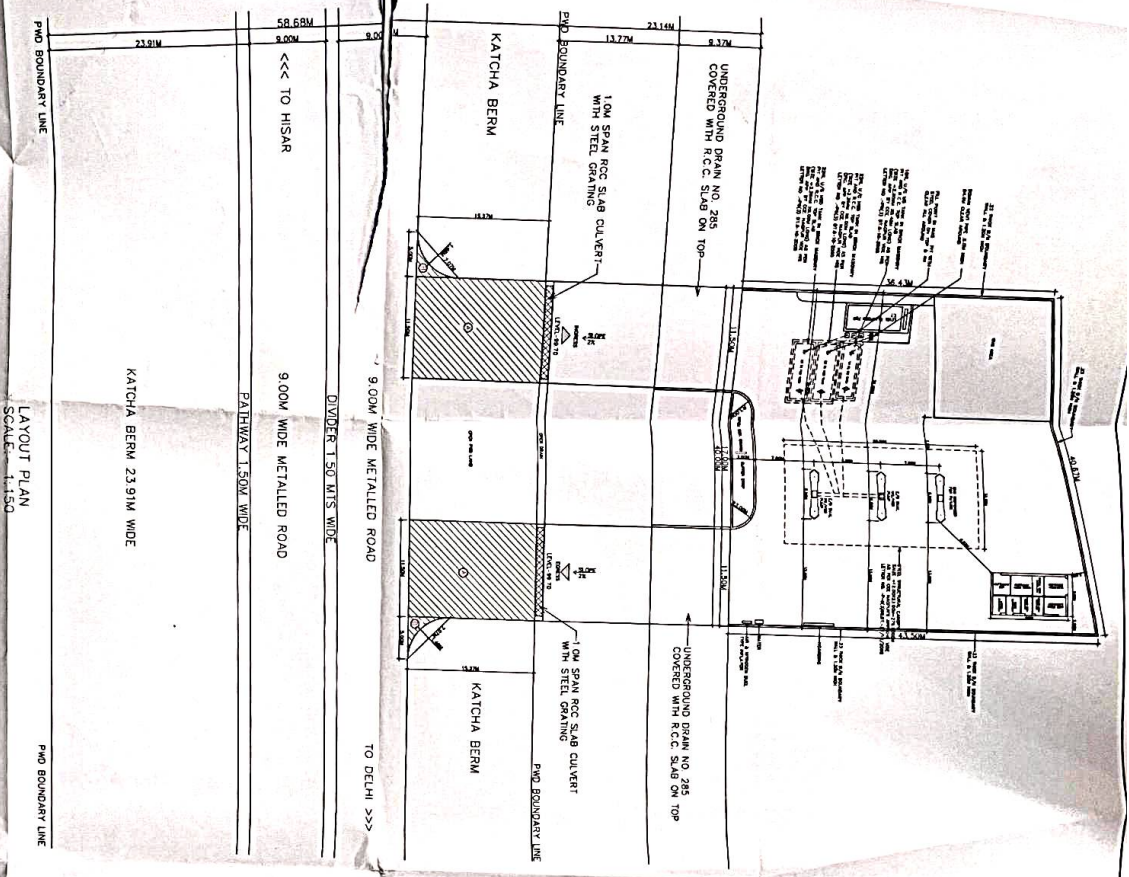

LAYOUT PLAN
SCALE: 1:150

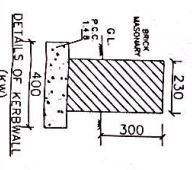
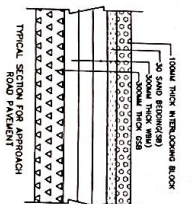
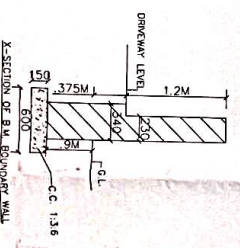
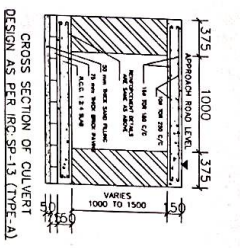

NOTES & CERTIFICATES

- CERTIFIED THAT THERE NO OTHER STRUCTURE WILL BE ERRECTED AND ANY OTHER SERVICE RENDERED EXCEPT THAT CONNECTED WITH THE ROAD FROM PUMP WITHOUT THE PRIOR APPROVAL OF PWD.
- CERTIFIED THAT THERE NO ROAD CROSSING WITH IN ROW BETWEEN THE TANGENT POINT OF THE CURVE OF ROAD AND THAT OF THE R.C.C. RAILING CUM STAKE STATION.
- CERTIFIED THAT THERE NO OBSTACLE FROM ROAD POINT OF VIEW FOR THE INSTALLATION OF THIS PUMP. THE PROPOSAL WILL NOT EFFECT THE FUTURE IMPROVEMENT OF THE ROAD.
- CERTIFIED THAT NO OTHER PETROL PUMP EXISTS WITHIN THE DISTANCE OF 300M ON EITHER SIDE OF THE PLOT APPROACH ROAD BUT IS TO BE METALLED BY THE CORPORATION.
- CERTIFIED THAT ALL THE CONDITIONS Laid Down BY THE GOVT. OF INDIA AND THE ROAD THAT TO THE WITH THE LOCATION OF ROAD SIDE FILLING STATION HAVE BEEN COMPLETED WITH EXISTING CONSTRUCTION WILL BE ON CORPORATION LAND.
- NO DIMENSION STRUCTURE WITHIN 1.5M FROM U/S TAKE.
- SECTION UNDER THE BRIMNEY HOODS SHALL BE PROVIDED FOR SEPARATION PUMPS ONLY.
- ELECTRICAL AND PUMP SHALL BE PROVIDED FOR THE PUMP AND SHALL BE KEPT UNDER LOCK AND KEY.
- NO. OF BRIMNEY HOOD SHALL BE 100M LEVEL AND WILL NOT BE KEPT UNDER LOCK AND KEY.
- NO. OF TANKS TO BE TANK LOBBY.
- NO. OF DAY NEW PIPE SHALL BE HIGH FROM G.L. AND 4M CLEAR AROUND THE OPEN END OF.
- VENT PIPE CONNECTED WITH TWO LINES OF NON-CORRODIBLE METAL WIRE GAUGE OF MESH PER LAYER CM.
- NO. OF HOLES AND PLANTS MORE THAN 600MM SHOULD BE GROWN AROUND THE BUFFER STRIP.
- THERE SHOULD BE SUFFICIENT STANDING SPACE IN SIDE THE STATION FOR VEHICLES TO WAIT FOR THEIR TURN IN AND OUTSIDE ARE PUT UP TO GUIDE VEHICLES DURING THE DAY AND ARE PROPERLY LIT UP UP TO GUIDE THEM AT NIGHT.
- NO. OF SMOKE SMOKE EXHAUSTERS AND FIRE BUCKETS PROVIDED AT SITE.
- CERTIFIED THAT BUFFER SHOULD NOT HAVE ANY INSTALLATION UNDER GROUND TANK ETC.
- CERTIFIED THAT THE KERBING STONE ALONG BUFFER IS TO BE LAID BY CORP.
- CERTIFIED THAT THE METALING OF THE BERM PORTION AT THE CORP. OF COMPANY TO BE PROVIDED.
- CERTIFIED THAT THERE WILL NOT BE ANY HANDRACES FROM OVER HEAD LINES AND POLES.
- CERTIFIED THAT THE SURPLUS WATER WILL NOT BE DISPOSED OUT IN ROAD LAND.
- CERTIFIED THAT THE DESIGN APPROVAL W/O P.W.D. & OTHER HELD W/OUT COST.
- CERTIFIED THAT THERE IS NO COURT CASE PENDING IN ANY COURT OF INDIA AGAINST THIS PREPARED 16/2004 STEEL TANK HAS BEEN FABRICATED AS PER SPEC. APPROVED BY C.E. MADRAS W/O HIS LETTER NO. P-4 (2) 60 OF DATED 6.10.05.

HINDUSTAN PETROLEUM CORPORATION LIMITED
(PANIPAT REGIONAL OFFICE)
(A GOVERNMENT OF INDIA ENTERPRISE)

LINEAR ALIGNMENT PLAN FOR NEW PETROL OUTLET

PROJECT NO. 238
 DRAWING NO. 16/2004
 LOCATION: KHAS (HISAR) (M.M.), TENSIL, DIST. HISAR, STATE HARYANA

APPROVED BY: [Signature]

CHECKED BY: [Signature]