

MPSEZ UTILITIES PVT. LTD.

PROPOSAL FOR UNDER FCA-1980 DIVERSION OF 0.4 HA FOREST LAND DEMAND FOR INSTALLATION 66 KV OVERHEAD TRANSMISSION LINE BY DISCOM IN THEIR LICENCE AREA IN SEZ MUNDRA MANGROVE FOREST LAND
Map Showing Area Demanded Under FCA 1980 in DGPS Map at Un Surveyed Mundra Mangrove Land District: Kachchh 0.40 Ha.(222.64 MTR. x 18 MTR. = 4007.52)

APPROVEDD LAND
UNDER FCA 1980
PART OF 1840

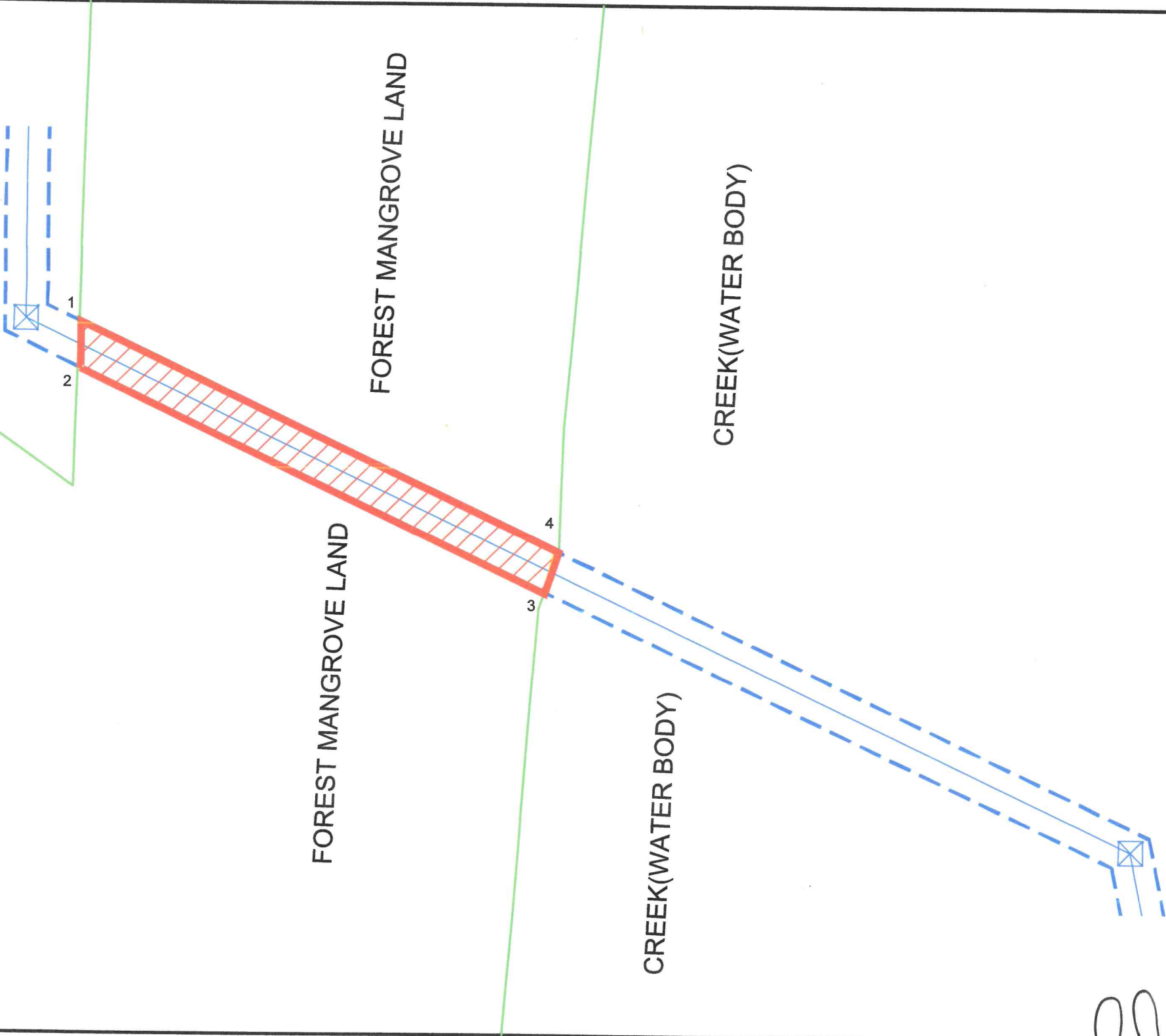

MUNDRA MANGROVE FOREST

1	22°46'21.95"N 69°39'43.77"E
2	22°46'21.30"N 69°39'43.77"E
3	22°46'18.21"N 69°39'50.73"E
4	22°46'18.78"N 69°39'50.89"E

USER AGENCY :::

LEGENDS :::

- AREA DEMANDED UNDER FCA 1980
- AREA HA. 0.40 OF UNSURVEYED MANGROVE SWAMP
- FOREST BOUNDARY OF MANGROVE FOREST MUNDRA

Niranjan Shah
MPSEZ UTILITIES PRIVATE LTD. ★ MPSEZ

