

To

No. S.D.M/Balh/S.D.K-12023/94/- Dated: 13th June 2023

The Divisional Forest Officer,
Forest Division Mandi.

Subject:- Diversion of 23.97 ha of forest land for setting up of National Disaster Response Force (NDRF) Battalion in favour of Sub-Divisional Officer (Civil) at Balh, Tehsil Balh, Distt. Mandi, Himachal Pradesh, within the jurisdiction of Mandi Forest Division, Distt. Mandi, Himachal Pradesh.

सन्दर्भ:- Online Proposal No. FP/HP/Others/122895/2021 received on 20.03.2023.

Sir ,

This is with reference to the IRO EDS letter no. FC/HPC/09/53/2022 Dated:-06.04.2023 on the subject cited above. In this context the EDS raised by your good office has been attended as below:-

Sr.No.	Observation	Replay	Remarks
1.	The legal status of the Diversion Area is mentioned as “Charagah vila Darakhtan & Roota Sarkaar” . Therefore, the Land Revenue Records of the proposed Diversion Area verifying the same may be provided	The Land Revenue Records verifying the legal status of the proposed Diversion Area has been attached and uploaded on the portal	Attached as Annexure-I
2.	Regarding reply to EDS at point no. 3, it has been submitted that revised KML file has been uploaded at Para-C on online Part-I, However, the Patch-I of the KML file is still not downloadable. Needful in this regard may be done.	Revised KML file has been uploaded on the Portal	
3.	As per FC Guidelines clarification by the MoEF&CC dated 24.01.2022 it has been clearly mentioned that “In exceptional circumstances, residential projects up to one ha. can be considered for approval under FCA, 1980 by MoEF&CC, subject to appropriate justification and recommendation by the concerned State Government and the Regional Officer of the IRO of MoEF&CC” . Careful examination of the component of the proposal reveals that the residential components (Quarters/Guest House/Hostel etc.) are exceeding one (01) ha	The total area of the project has been revised and the area for residential components has been reduced to 1.00 ha. Also, the residential component is an essential part of the project as per norms of NDRF.	Undertaking Attached as Annexure-II

	area. Therefore, the proposal needs to be reviewed and revised accordingly for the aforesaid components along with proper justification for the requirement of residential components (Quarters/Guest House/Hostel etc.) .		
4.	i) As per the Norms of Infrastructure of NDRF Battalion, the area required is 15.6291 ha (156291.28 square meter) only that covers all the major components. However, the proposed Diversion Area of the extant proposal is 27.5709 ha which is more than the area mentioned in the Norms. Therefore, the proposal needs to be reviewed and revised accordingly.	i) As per norms of NDRF the minimum area requirement for establishment of NDRF Battalion in Hilly/Mountainous Area is 70 Acres (i.e. 28.328 Ha.) and the proposed area is 23.97 Ha. which is as per Norms and copy of office memorandum has been attached and uploaded on the portal for clarification.	Clarification attached as Annexure-III
	ii) Further a more legible document of Norms of Infrastructure of NDRF Battalion may be provided.	ii) Legible copy of Norms and office memorandum has been attached and uploaded on the portal.	
5.	Layout Plan of both patches has been provided. However, the Layout maps are not legible. Therefore, legible Layout Plan showing both patches with all components of the proposed project may be provided.	Revised Layout Plan has been attached and uploaded on the portal	Attached as Annexure-IV
6.	Large number of Trees (1100) of different species including ecological important Quercus spp. are being affected in the proposal. However, the proposed Line Plan shows that large number of trees are standing in the periphery/boundary line of the proposed diversion area as well as in open area of the proposal can be saved. Therefore, State Govt. shall review and revise the proposal thoroughly exploring the possibility to minimize the number of trees to be felled and accordingly list of trees to be felled and trees not to be felled/retained may be submitted	The total tree coming in the alignment of the project will not be felled, only 450 to 550 trees will be felled for built up structure and roads. The trees coming in boundary of the proposed site will not be felled and will be retained for view cutter facility from the civil area.	Undertaking Attached as Annexure-V
7.	Regarding reply to EDS at point no. 4, proper clarification has not been provided. Therefore, State Govt. may clarify the legal status of the proposed CA land whether it is notified forest land under IFA 1927 or	Pertains to DFO Office	

	wasteland declared as Protected Forest as per 152 Notification of the Himachal Pradesh Government and is under the possession of State Forest Department or not. Land Revenue Record supporting the same may be provided.		
8.	Regarding reply to EDS at point no. 17, it has been submitted by the User Agency the EC is under process and will be submitted when received. Therefore, necessary correction in Part-I Para-H is required to be done in this regard.	Necessary correction has been done in online Part-I, Para-H.	
9.	Regarding reply to EDS at point no. 18, it has been submitted by the user agency that "During any major disaster extra troops of NDRF is required to be deputed for rescue work, for which temporary campus have to be accommodated. This setback and open area is required for the same purpose". However, in the norms of Infrastructure of NDRF Battalion no such component like setback and open area has been mentioned. Also, since the diversion of forest land for non-forestry purpose is permitted for barest minimum requirement, therefore large areas under setback & open area and land vegetation components cannot be considered. Therefore, the proposal needs to be reviewed and revised accordingly.	The total area of proposed project has been reduced to 23.97 Ha. Accordingly the area for setback & open area has also been reduced to minimize the use of forest land.	Justification Attached as Annexure-VI
10.	In component wise breakup many components have been mentioned which are not identical with the components mentioned in the Norms of NDRFB. Therefore, the same may be reviewed and accordingly all the components may be revised, and should be identical as per Norms of NDRFB.	Revised component detail has been attached and uploaded on the portal	Attached as Annexure-VII
11.	In component wise breakup a component "Land for Vegetative (1.4418 Ha)" has been included. The State Govt. may properly clarify and justify the use of these proposed components. If required, the component may be removed from component wise breakup and accordingly Diversion Area may be revised.	Revised component detail has been uploaded and the component "Land for Vegetative (1.4418 Ha)" has been removed from online Part-I	

 Sub Divisional Officer (Civil)
 Bathi, District Mandi (H.P.)

नं. खेवट. या जमाबन्दी	भूखर खतौनी	नाम पति या तरफ मय नाम नम्बरदार व तादाद मुआमला	नाम मालिक व ऐहवाल	नाम कारतकार व ऐहवाल	नाम बाए व दीगर वसायल आवपाशी	नम्बर हाथ खारा	रकबा हर खेत व मिजान खाता मय किरम अराजी	लगाव जो मुजारा अदा करता है व तफरील शरह व तादाद	हिसरा या पैमाना हकीयत व तरीका बाछ	मुतालबा व शरह मुआमला व हदूब	कैफियत
1	2	3	4	5	6	7	8	9	10	11	12
मिन	457 मिन	-	सरकार डिग्रायल ५६३	मकबूला मइकभा अंगालात हाबे इकुके बलेन दारान् मुताबिक जेमशा बलेन	-	1179 318	150-04-19 सरटा सरकार	-	-	-	
	458 मिन			मकबूला मइकभा हाबे इकुके बलेन बलेन दारान् मुताबिक जेमशा बलेन	-	479	08-09-18 परभाट मिला इकुके	-	-	-	
	469 मिन			मकबूला मइकभा अंगालात मारफत मुताबिक मइकभा दारान् मुताबिक जेमशा बलेन	-	1292 478	158-08-03 इकुके सरकार	-	-	-	
						किता-3	317-03-00				

नोट: ख.न. 479 ख.
8-9-18 बिदा कुल, ई.
मुत्र शम्भु समभावा
बास मटाई के इकुके
है।

मौजान जी,
मुआमला फिका जाला है कि नकल
मुताबिक अइल के सही व इकुके
है मिला इकुके वकार सरकार लैकर
की गई।

25/05/2023
परभाट
मिला इकुके

ग्रीड बुक मुहाला खैना/210 तहसील बल्लह जिला मण्डी (हिमाचल)

नं. वर खसरा	इस्तखराज	रकवा मय किल्य	विवरण
1179 318 <u>4</u>	$\frac{214(94+88)}{2} = 19474$	143-00-08	
(क)	$\frac{32 \times 12}{2} = 192$	रुय सरकार बै प्रस्तावित रकवा NDRF.	
(ख)	$\frac{70 \times 28}{2} = 980$		
(ग)	$\frac{64 \times 31}{2} = 992$		
(घ)	$\frac{32 \times 19}{2} = 304$		
(ङ.)	$\frac{18 \times 6}{2} = 54$		
(च)	$\frac{60 \times 17}{2} = 510$		
(छ)	$\frac{80 \times 23}{2} = 920$		
(ज)	$\frac{92(9+11)}{2} = 920$		
(झ)	$\frac{99(14+29)}{2} = 2129$		
(ञ)	$\frac{102 \times 11}{2} = 561$		
(ट)	$\frac{146 \times 65}{2} = 4745$		
(ठ)	$\frac{98 \times 23}{2} = 1127$		
(ड.)	$\frac{149 \times 12}{2} = 894$		
(ढ)	$\frac{120 \times 16}{2} = 960$		

25/05/2023
प्रमाणित
परमाणु पुत मंडपाल
म. ब. म. जिला मण्डी हिमाचल

नम्बर खसरा	इस्तखरा (क)	रकवा मय फैलम	विवरण
(ज)	$\frac{95 \times 5}{2} = 238$		
(त)	$\frac{128 \times 19}{2} = 1216$		
(थ)	$\frac{124(6+8)}{2} = 868$		
(द)	$\frac{150(23+50)}{2} = 5475$		
(ध)	$\frac{36 \times 6}{2} = 108$		
(न)	$\frac{26 \times 2}{2} = 26$		
(म)	$\frac{138 \times 15}{2} = 1035$		
(म)	$\frac{145(39+56)}{2} = 6453$		
(ब)	$\frac{124(42+18)}{2} = 3720$		
(भ)	$\frac{68 \times 3}{2} = 102$		
(म)	$\frac{66 \times 33}{2} = 1089$		
(य)	$\frac{72(23+14)}{2} = 1332$		
(र)	$\frac{56 \times 28}{2} = 784$		
वकी माफा खसरा 1179/38/2 रकम 7-4-11 कस 21 सरकार		57208	

प्रमाणित किया जाता है कि फाईलबुक
तरीका जो का डेबोबक असल के साथ
है।

25/05/2023
पटवार बुले मंडा
नं 38 मिला मजदू 1179/38/2

अन्तर्गत तालिका में नक्शा नुसार कुल क्षेत्र 1210 तहसील बल्लू जिला (हि. प्र.)

उत्तर

पैमाना 1 इंच = 40 फीट (40) चालीस फीट प्रति इंच

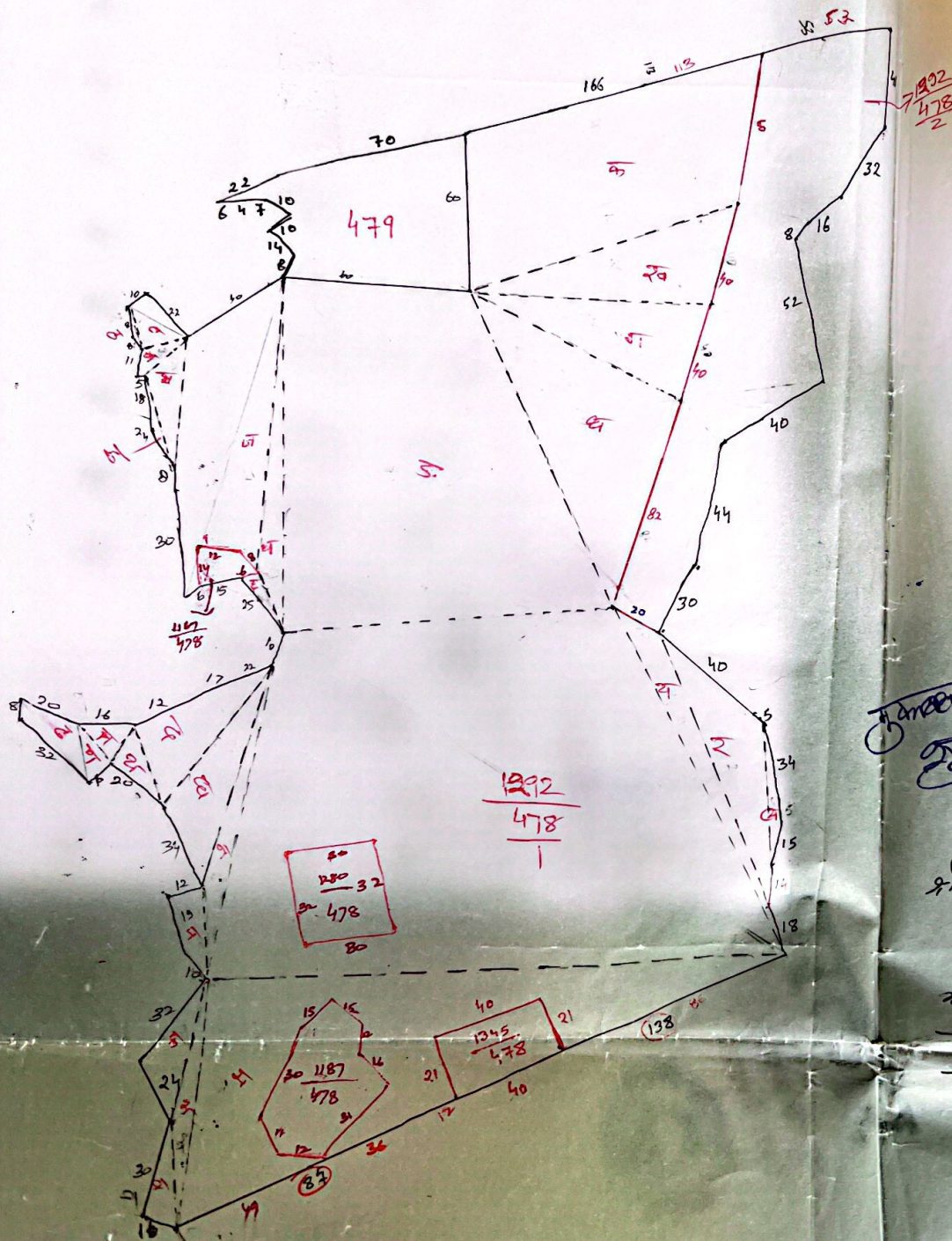

महेश्वर
25/5/23
जिला

उपरोक्त विषय जागहें कि नक्शा
नक्शा तालिका में नक्शा नुसार तहसील व
जिला के तहसील उक्त नक्शा नुसार
नक्शा नुसार नक्शा

25/5/23
पटवारी
जिला नक्शा तहसील

बुक मंथल - बैदना/२१०, तह. बल्ल, जिला मन्डा (दि. ५.) ①

नम्बर खसरा	इसखसरा	रकबा मय कि. म.
$\begin{array}{r} 1292 \\ 478 \\ 1 \end{array}$	$\begin{array}{r} 210(114+72) \\ 19530 \\ - 960 \\ \hline 18570 \end{array}$ <p>बाद मिन हाई २ खसरा न. १२८०/५७८ रकबा - २-८-० मिया</p>	<p>१५५-१३-१२ विधा सटा सरकार से प्रस्तावित रकबा NDRF</p>
क)	$\frac{140(37+46)}{2} = 5810$	
ख)	$\frac{104 \times 32}{2} = 1664$	
ग)	$\frac{86 \times 36}{2} = 1548$	
घ)	$\frac{127 \times 54}{2} = 3429$	
ङ.)	$\frac{166(90+46)}{2} = 11,288$	
च)	$\frac{130 \times 9}{2} = 585$	
छ)	$\frac{25 \times 5}{2} = 62$	
ज)	$\begin{array}{r} 124(26+21) \\ 2914 \\ - 164 \\ \hline 2750 \end{array}$ <p>बाद मिन हाई २ खसरा न. ११६७/७७८ रकबा - ०-८-५ विधा</p>	<p>१२</p>
झ)	$\frac{50 \times 14}{2} = 350$	
ञ)	$\frac{24(2+6)}{2} = 96$	

१२

२३/०५/२०२३
१० वन विभाग मन्डा (१२०८२)

संख्या क्रमांक

इतिहास

संख्या मय क्रमांक २

१)

$$\frac{24(12+8)}{2} = 240$$

२)

$$\frac{17 \times 2}{2} = 17$$

३)

$$\frac{34 \times 4}{2} = 68$$

४)

$$\frac{38(5+9)}{2} = 266$$

५)

$$\frac{20 \times 9}{2} = 90$$

६)

$$\frac{16 \times 14}{2} = 112$$

७)

$$\frac{31 \times 12}{2} = 186$$

८)

$$\frac{62 \times 25}{2} = 775$$

९)

$$\frac{82 \times 22}{2} = 902$$

१०)

$$\frac{122 \times 6}{2} = 366$$

११)

$$\frac{30(3+11)}{2} = 210$$

१२)

$$\frac{48 \times 15}{2} = 360$$

१३)

$$\frac{33 \times 10}{2} = 165$$

१४)

$$\frac{80 \times 7}{2} = 280$$

१५)

$$\frac{225 \times 72}{2} = 8100$$

बाद निज १३
संख्या नं- 1345/478, 1187/478
5504

पटवार वृत्त मंडियाल
७० बल्ब, जिला मण्डी (हिमाचल)
23/05/2023

संख्या 20/सरा

इस्तखाराग

शकबा मय किस्त

(3)

शकबा क्रमशः = 2-2-0 विद्या व
04-07-16 विद्या

य)

$$\frac{138 \times 10}{2} = 690$$

2)

$$\frac{124 \times 22}{2} = 1364$$

ल)

$$\frac{50 \times 5}{2} = 125$$

$$57872$$

2.

1992/478/2

बोकि मान्श शकबा बरखुल

13-14-11 विद्या ✓

शकबा सरकार

प्रमाणित किया जाता है कि फील्ड बुक लीखा गया है व
मालिक असल के सही है।

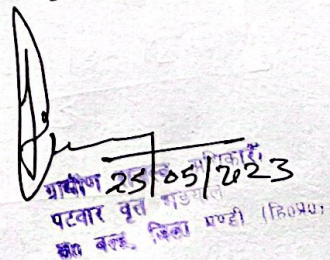

प्रमाणित 23/05/2023
पटवार वृत्त गडगा
क्षेत्र बरख, जिला पण्डी (हिमाचल)

Undertaking Against Point No.-3

This is submitted that the total area of the project has been revised from 27.57 Ha. to 23.97 Ha. and the area for residential components has been reduced to 1.00 ha. Also, the residential component is an essential part of the project as per norms of NDRF.



Sub Divisional Officer (Civil)
Bath, District Mandi (H.P.)

Annexure-III

Clarification Against point No.-4

i) As per norms of NDRF the minimum area requirement for establishment of NDRF Battalion in Hilly/Mountainous Area is 70 Acres (i.e. 28.328 Ha.) and the proposed area is 23.97 Ha. which is as per Norms and copy of office memorandum has been attached and uploaded on the portal for clarification.

ii) Legible copy of Norms and office memorandum has been attached and uploaded on the portal.



Sub Divisional Officer (Civil)
Bath, District Mandi (H.P.)

No. 31-33/2008-NDM-110001
 Government of India, Bharat Sanchar Nigam Ltd.
 Ministry of Home Affairs / Grah Mantralaya
 Disaster Management Division
NDRF Section

Lok Nayak Bhawan, New Delhi
 Dated the 10-08-2011

To

- (i) Secretary (NDMA)
 NDMA Bhawan, A-1 Safdurjung Enclave,
 New Delhi.
- (ii) Director General,
 NDRF, East Block-VII,
 Level-7, R.K. Puram,
 New Delhi.

Subject: Proposal for approval of NDRF Battalion infrastructure by MHA.

Sir,

I am directed to refer to your letter No. NDMA/NDRF/Infrastructure/381/2010 dated 18-2-2011 on the above mentioned subject and to state that the competent authority has approved the norms and scales of infrastructure relating to office accommodation, residential accommodation, outdoor training block, kennel for dogs, hospital, prop area, fitness centre ware house, library, miscellaneous works etc. for NDRF Battalion as per the details given in the enclosed **Annexure**.

2. The approval is subject to the condition that the kennel infrastructure for dogs may be restricted to 36 dogs for each of the new battalions at Guntur and Patna and for 12 dogs in each of the other 08 NDRF Bns.

3. This issue with the concurrence of IFD, vide its diary No.84046/Fin-IV/2011 dated 21-7-2011.

Encl: As above (Total 5 pages)

Yours faithfully,

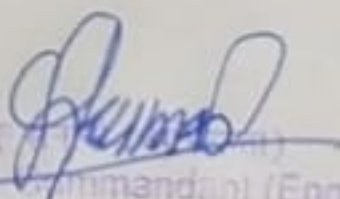
 Asst. Commandant (Engr.)
 14th Bn, NDRF

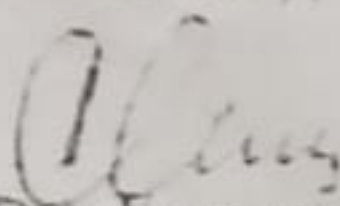
 (Dev Kumar)
 Director (DM-I)
 Tel: 24642853

Copy to: Integrated Finance Division, (FIN-IV), MHA, North Block, New Delhi.

Subject: 12. Delhi
 (Encl)

1258
21/11/15

11-27012/20/CF-3087210/2006-PF.I
Government of India/Bharat Sarkar
Ministry of Home Affairs/Grh Mantralaya
Police-II Division

1263
31/7/15

North Block, New Delhi,
Dated the 30th July, 2015

Office Memorandum

Sub: Revision of authorization of lands norms in respect of CAPFs -reg.

In continuation to this Ministry's O.M of even number dated 29.08.2014 on the subject cited above, the undersigned has been directed to convey the revised norms for authorization of land for various establishment of CAPFs as under :

Establishment	Existing land norms vide O.M dated 29.08.2014	Revised land norms for CAPFs
Battalions HQrs	(i) 17.48 acres for urban/semi urban areas (ii) 40.00 acres for rural area (30.00 acres in case of WB & Bihar)	(i) 20.00 acres in areas within the limit of Municipal Corporations/Municipalities. (ii) The land norms for areas not covered by Municipal Corporation/Municipalities will be 70 acres. In case of hilly/mountainous areas, the upper ceiling will be 100 acres, instead of 70 acres.
BOPs (both company & platoon level)	(i) 1.00 acres for platoon level BOP. (ii) 2.00 acres for coy level BOP.	4.00 acres (both company & platoon level). In case of Helipad is required to be established, additional land required for that purpose will be considered on case to case basis.
Kendriya Vidyalaya Sangathan (KVS) in Battalions	3 acres vide MHA letter No.27012/06/2013/PF.V dated 18.02.2014	7.5 acres for areas not covered by Municipal Corporation/Municipalities. For areas within the limit of Municipal Corporations/Municipalities the norms of 03 acres will continue.

The other existing terms and conditions will remain same as per Ministry's O.M of even number dated 29.08.2014. For leasing land to KVS, the other terms and conditions of MHA letter No.27012/06/2013-PF.V dated 18.02.2014 will also continue.

3. This issues with the concurrence of IFD vide their Diary No.CF.3087210/Fin-III dated 30.07.2015.

Gracy James
30/7/15
(Gracy James)

Under Secretary to the Govt. of India

CG: BSF/CISF/CRPF/TBP/SSB/NSG/AR (through LCAR).

Copy to:

- PPS to Home Secretary
- PPS to SS(IS)
- PPS to AS&FA(Home)
- PS to JS(P-II)
- PS to Director (Fin/Home)
- AFS (Fin. VII/III/IV/V)
- PF. I/III/IV/V/VI
- Guard file

Commandant

14th बहिनी, रा०आ०मो० बल
14th Bn NDRF

Kuldeep Kumar
30/7/15
(Kuldeep Kumar)

सहायक मंत्री (अभियन्ता)
असिस्टेंट मंत्री (Engr.)
14th बहिनी, रा०आ०मो० बल
14th Bn, NDRF

HORIZONTALIZATION OF SCALE/NORMS OF INFRASTRUCTURE FOR NDRF BATTALION

496
Annexure

S.No.	Details of facilities.	Area authorized. (in Sq.mtr)
1	2	3
1	OUTDOOR TRAINING BLOCK	1
	1. Drill sheds (692.38 sq.mtr)	692.38
	2. P.T Ground	
	3. Parade ground	46700
	4. Obstacles course	
	5. Play Grounds	(Athletics of 400 mtr. Track, play ground like hockey ground, football ground, volleyball court, basketball, boxing ring and swimming pool, etc.)
2	KENNEL INFRASTRUCTURE FOR DOGS TRAINING	1880
	Kennel (with requisite facilities) for 36 dogs for each of the battalion at Patna & Guntur. For the other 8 battalions to be restricted to 12 dogs.	
	Cook house for dogs food.	
	A veterinary Hospital with the following facilities i.e. vet. Officer room, M.I room, Minor operation room, Injection room, Quarantine bloc, Store	
	Training area of appropriate size and facilities	
	Dog handler staff room.	
3	COMMUNICATION BLOCK	255
	Office Room for Asstt. Commandant (Comm)-1	
	Signal Centre	
	Radio Grid supervisor office	
	Telephone exchange-1	
	Internet/Room-1	
	Instruments repair room-1	
	Store room for Communication equipments-1	
	Battery Charging cum generator room-1	
4	QUARTER MASTER STORES	696
	store room for CSSR equipment	
	store rooms for MFR equipment	
	Store room for Flood rescue equipment (excluding boats)	
	store rooms for NBC equipment	
	Store rooms for clothing and personal protective equipments	
	store room for tent	
	store room for	
	sheds for Boats	
	for ready to ship containers	

Commandant
14th Bn NDRF

Asstt. Commandant (Engr)
14th Bn NDRF



	store rooms for condemned stores awaiting disposal	
	Office room for QM stores staff	
	MT BLOCK	
5	Office room for Asstt. Comdt. (MTO)-1	4130
	MT Office	-
	Sheds for all MT Vehicle (as per sanctioned fleet strength)	-
	Heavy Vehicle X 21	-
	Medium Vehicle X 18	-
	Light Vehicle X 38	-
	MT Workshop with work pit	-
	Engine shop	-
	Lathe Machine	-
	Body Fitter room	-
	Painting room	-
	Welder room	-
	Washing Ramp	-
	Store for spare parts, tyres / tubes and batteries	-
	MT General store	-
	Tyre store	-
	Spare part store	-
	Storage for POL	-
	Battery Charging Room	-
	Room for MT staff / Drivers duty room	-
6	ADM BLOCK	2100
	Office room for Commandant-1	-
	Steno to the Comdt-1	-
	Second-in-Command-1	-
	Deputy Commandant (Adm)-1	-
	Deputy Commandant(QM)-1	-
	Asstt. Commandant(JSO)-1	-
	Asstt. Commandant Pioneer platoon	-
	Office accommodation for staff of Adm. and pioneer platoons	-
	Office accommodation for Establishment <i>सहायक (संयोजक)</i>	-
	Office accommodation for Account Branch <i>सहायक (अनुमान)</i>	-
	Office accommodation for QM Branch <i>सहायक (गुणवत्ता)</i>	-
	Office accommodation for Training Branch	-
	Cashier Room	-
	Record room	-
	Conference room	-
7	Control room	6000
	COMPANY & TEAM OFFICE BLOCK	
	Office Chamber for coy Commander(DC/AC)-1	-
	Office accommodation for other company staff (Insp/ SI/HCs/PCs)	-
	QM Stores-1	-
8	D.M. Stores	15452
	MESSES / GUEST HOUSE / BARRACKS	
	A fully-furnished rest house for VIP personages and	-

CTC
[Signature]
 सहायक (संयोजक)
 सहायक (अनुमान)
 सहायक (गुणवत्ता)
 Asstt. Commandant (Engr.)
 14th Bn, NDRF

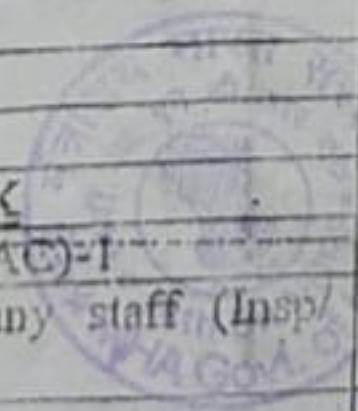

1998

	outstation guest faculty-1(with 4 suits and 12 rooms fully furnished) with Messing etc facilities.	
	A Hostel for trainee officer from State Government and Community volunteer 30 double bedded rooms (Fully furnished)	
	Subordinate officers Mess (fully furnished) with 30 double bedded rooms, besides a common room, dining hall, kitchen, store room etc.	
	Barracks(fully furnished) for other ranks of a capacity to accommodate 180 personnel each)-3	
	A fully furnished Barracks (to accommodate 180 persons) for trainee from outside .	
9	RESIDENTIAL ACCOMMODATION	
	100 % family accommodation for commandant and other Gazetted Officer, as per the types of entitlement. 01	270.40
	Family accommodation for subordinate officer to the extent of 75% of sanctioned strength. 10	1992
	Type-II & III qtrs for Constable, Head constable and other staff (as per the entitled type of accommodation) to the extent of 75% of sanctioned strength.	1257.10
	Type-III (128 Nos) 81	4653.45
	Type-II (716 Nos) 340	16722
Note: As per Kamal Kumar Committee report 100 % family accommodation for officers and 75 % authorization for upto the rank of Inspectors.		
10	20 BEDED HOSPITAL	1250
11	OTHER FACILITIES	
	i)Generator Room	100
	ii)Cooperative stores and canteen	660
	iii)Recreation Centre	650
	iv) Family welfare centre	500 ✓
	v) Bank, Post office/cyber café and shopping complex	500 ✓
	vi) In PAR estimate the area of Children park has not been considered but now the area.	2500
12	Development work (75 Acres)	-
13	Sub station equipments electrical	-
14	Over head tank (8.00 lac lit capacity)	-
15	Bore well (150 mtr. Deep) 02 Nos.	-
16	Allied PIPE works.	-
17	Peripheral boundary wall (300 7 mtr	100
✓ 18	Quarter Guard	1943.16
19	TRAINING BLOCK	
	Class Room (of seating capacity of 40 each) with 4 break away syndicate rooms of a capacity of 10 each	
	Class Room (of seating capacity of 60)-1	
	Table top exercise Hall (with seating capacity of 100)-1	
	Earthquake Simulator Room	
	Computer Room-1	
	Store Room for training equipment-1	

[Signature]
Commandant

[Signature]
Asstt. Commandant (Engr.)
14th Bn. NDRF



Prop area

Rubble filed with collapsed single & Multi stored structures

Decontamination trg area

Artificial wall cum slithering tower-1

Swift water training facility

Area for dead body management

Responders fitness room cum Gymnasium

Indoor auditorium (with a seating capacity for 300 persons)

Swimming Pool with deep diving facility-1 and one deep end

Open air Auditorium with a seating capacity of 1500 Personnel.

21 **ADDITIONAL REQUIREMENT OF NBC BATTALION**

Radiological training laboratory with instruments Calibration room

Mask Testing Room

Head stroke relied room

Shower area

change Room

Monitoring Room

Debriefing Room

Decontamination Room

Biological Model Room

Chemical Model Room

Hazardous Material stores

Non hazardous material stores

Underground Nuclear shelter for learning and practice by troops

Personal protective equipment (PPE) stores

22 **WAREHOUSING OF NATIONAL DISASTER MITIGATION RESERVE STORES**

1. Pre- Fabricated steel structure godown with poly coated sheet in roofing and sidewall cladding of the size 126 X21.80 mtr

2. Approach road 50X6 mtr

3. Tube well.

23 **LIBRARY**

Library -Cum-Reading Room-1

24 Office space for Library Staff-1

OTHER FACILITIES

i) Helipad cum Heli dropping area

25 ii) Central school

Miscellaneous works

i) Incident

ii) Rain

iii) Auditorium

digital central unit

Commandant

14th Bn NDRF unit enclosures unit, Multi

सहयक (आगमना)
Asstt. Commandant (Engr)
14th Bn, NDRF



(799)

point HD video conference system, video conference mixer, tele conferencing mixer, VGA switch gear, composite switch gear, digital steer able audio solution, teleprompter, interpreter solutions, plasma display, 3 chip high luminous DLP projector, Video scalar, control system with fixed & WI-FI touch panel. cable & connectors)

iv) SITC of stage lighting system with compact controller.

TOTAL AREA

156291.23

(R.C.S. + 11000 - 11000)

(24,894,95 + 131396)

Salazar

सेनानी

Commandant

14वीं वाहिनी, रा०आ०मो० बल
14th Bn NDRF

CRC

Salazar

सहायक (अभियन्ता)
Asstt. Commandant (Engr.)
14वीं वाहिनी, रा०आ०मो० बल
14th Bn, NDRF



Undertaking Against point No.-6

This is submitted that the total tree coming in the alignment of the project will not be felled, only 450 to 550 trees will be felled for built up structure and roads. The trees coming in boundary of the proposed site will not be felled and will be retained for view cutter facility from the civil area.



Sub Divisional Officer (Civil)
Bath. District Mandi (H.P.)

Annexure-VI

Undertaking Against point No.-9

This is submitted that the total area of proposed project has been reduced to 23.97 Ha. Accordingly the area for setback & open area has also been reduced to minimize the use of forest land.



Sub Divisional Officer (Civil)
Bath, District Mandi (H.P.)

AREA STATEMENT OF PATCH-I			
Sr. No.	Component	Area in sqm.	Area in Ha.
1	Outdoor Training Block D		
	B	2800	0.28
	D	25620	2.562
	E	2720	0.272
	TOTAL	31140	3.114
2	Kennel Infrastructure for Dogs Training	1880	0.188
4	Quarter Master Stores	696	0.0696
8	Messes	3750	0.375
9	20 Bed Hospital	1250	0.125
10	Generator Room	100	0.01
11	Cooperative Stores and Canteen	660	0.066
12	Recreation Centre	650	0.065
13	Family Welfare Centre	500	0.05
14	Bank, Post Office, Cyber Cafe and Shopping Complex	500	0.05
15	In par estimate the area children park	2500	0.25
16	Quarter Guard	100	0.01
18	Area for dead body management	100	0.01
19	Responders fitness room cum Gymnasium	1250	0.125
20	Indoor auditorium	400	0.04
21	Open Air Auditorium	100	0.01
24	LIBRARY	150	0.015
25	Other facilities	1500	0.15
27	Road & Path	18500	1.85
28	Set Back & Open area	12000	1.2
	Boundary set back area	13000	1.3
29	Sewerage & irrigation system, Electrical Sub Station and other public utilities	1650	0.165
30	Green Cover Area Retained	22397	2.2397
31	Residential Area	9192	0.9192
	TOATAL AREA	123965	12.3965

 Sub Divisional Officer (Civil)
 Balh, District Mandi (H.P.)

AREA STATEMENT OF PATCH-II			
Sr. No.	Component	AREA in (SQM)	Area in Ha.
1	Outdoor Training Block		
	A	692.38	0.069238
	C	5260	0.526
	E	10300	1.03
	TOTAL	16252.38	1.625238
3	Communication Block	255	0.0255
5	MT Block	4130	0.413
6	ADM Block	2100	0.21
7	Company 8iTeam office Block	6000	0.6
8	Messes	11702	1.1702
17	Training Block	1943	0.1943
22	Radiological Training Laboratory	1366	0.1366
23	Warehousing of NDMRS	4000	0.4
26	Helipad Cum Heli Dropping area	1500	0.15
27	Road & Path	18000	1.8
28	Set Back & Open area	20000	2
	Boundary set back area	10000	1
29	Sewerage & Irrigation system, Electric System	5465	0.5465
30	Green Cover Area Retained	13041.62	1.304162
	Total	115755	11.5755

Total Area of the Project = 12.3965 + 11.5755 = 23.97 Ha.

Samir
 Sub Divisional Officer (Civil)
 Balh, District Mandi (H.P.)