

Full Title of the Project:- Construction of link road Gai Dessa to Bhatta via Magal Thatha and Dewal Kund.

File No.:- FP/JK/ROAD/45770/2020.

Date of Proposal:- 22-06-2020.

Name of the Forest Division:- Doda Forest Division.

Forest area to be diverted:- 2.557Ha

Detail of land where Compensatory Afforestation to be carried out:

Degraded Forest land: Yes	Area: 5.2 Ha
Non-Forest land: No	Forest Division: Doda Forest Division
Range: Siraj	District: Doda
Tehsil: Bhagwah	Compartment No. 44/Sj
C.A Site: Mangalthata Village	C.A Area: 5.2 Ha.

C.A Site Geo-Coordinates:

Starting point: Latitude: 33°17.850' N **Longitude:** 75°29.430' E

Ending point: Latitude: 33°17.876' N **Longitude:** 75°29.505' E

I. Description of C.A Site:

- a. **Soil type:** Sandy Loom with boulders
- b. **Topography:** Hilly
- c. **Slope:** Steep.
- d. **In case of degraded forest land-description of forest land and crown density:** Deodar
Kail Conversion working circle with crown density is 20-30%.

Plantation Model: Compensatory Afforestation over an area of 5.2 Hac. of degraded forest land is proposed to be raised. The area selected for this purpose is in village Mangalthata, which is degraded forest. Presently the area supports scattered trees. Whole of the plantation of 5.2 Hac. will be raised in a single compact block inside the degraded forest for such purpose. The area identified for plantation has also been shown on the attached map. Plants @ 1000 plants per hectare will be planted. The species to be planted will be mainly conifer and other misc. species of broad leaved plants. The plantation will be raised in the following year after the approval of FCA proposal and further maintenance and beating up of failures will be done for the subsequent ten years. The scheme will be implemented by Forest Department through DFO, Doda. Total financial Outlay for compensatory plantation scheme is 1029576/- Site is suitable for Compensatory Afforestation. The monitoring will be done as per existing monitoring mechanism in the forest department at present.



Forest Range Officer
Siraj Range
Hq Doda

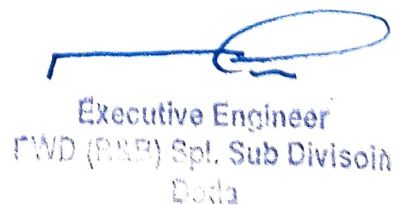

Executive Engineer
FWD (P&R) Spl. Sub Division
Doda

Naresh
Divisional Forest Officer
Doda Forest Division Doda

Compensatory Afforestation for degraded forest area

S.No.	Description			Rate (in ₹)	Total amount (in ₹)
		Unit	No.		
A	1st year cost of Afforestation			40.03	208156
1	2nd year maintenance			40.03	52039
2	3rd year maintenance			40.03	20815.6
3	4th year maintenance			40.03	10407.8
4	5th year maintenance			40.03	10407.8
5	6th year maintenance			40.03	10407.8
6	7th year maintenance			40.03	10407.8
7	8th year maintenance			40.03	10407.8
8	9th year maintenance			40.03	10407.8
9	10th year maintenance			40.03	10407.8
	Total				353865.2

B Other Afforestation Interventions (As per the requirement of the site condition)

1	Patch Sowing	No. of patches	1560	6.99	10904.4
2	Planting of grass slips	No. of slips	1560	6.35	9906
	Total				20810.4
C.	Fencing:				
1	Square PCC Post Fencing (4 Strand)	Rft	3120	72.78	227073.6
2	Wooden fencing				
3	Chain link fencing				
4	Fencing repair		3120	16.74	52228.8
	Total				279302.4
D	Site Preparation: (Cutting, Grubbing and removal of lantana)	Ha	1.56	22904	35730.24
E	Pruning and Training of existing root stocks:	No.	1560	6.35	9906
	Total C.A Charges				699614.24
F	Soil and water conservation and protection measures like constructon of fire lines and inspection path.				260000
	Total (A+B+C+D+E+F)				959614.24
G	Supervisory/Watch and ward/Overhead/Miscellaneous charges: (10% of the C.A Charges)				69961.424
	Grand Total: (A+B+C+D+E+F+G)				1029575.664

III Technical Details: Technical detail of compensatory afforestation scheme are as follow:

i General detail

ii Plantation method: Poly bags

iii Spacing: 2 x 2 m

iv Species proposed to be planted: Deodar and Kail

v Silviculture Operations: Nil

vi Soil and Moisture Conservation Works:

vii Protection: (Fencing, Watch and Ward, People's Participation etc): Yes

viii Proposed monitoring Mechanisim: Regular patrolling of concerned beat guard

ix Any other information: No

Naveet
Divisional Forest Officer
Doda Forest Division Doda

[Signature]
Forest Range Officer
Siraj Range
Hq Doda

[Signature]
Executive Engineer
(PWD (R&B) Spl. Sub Division
Doda

Altitude: 33°17'41"
Longitude: 75°29'21"
Elevation: 2108.14 m
Accuracy: 2.5 m
STime: 04-24-2021 14:56:39
File: co_44_block_dessa_mnglthata_pul_wpl

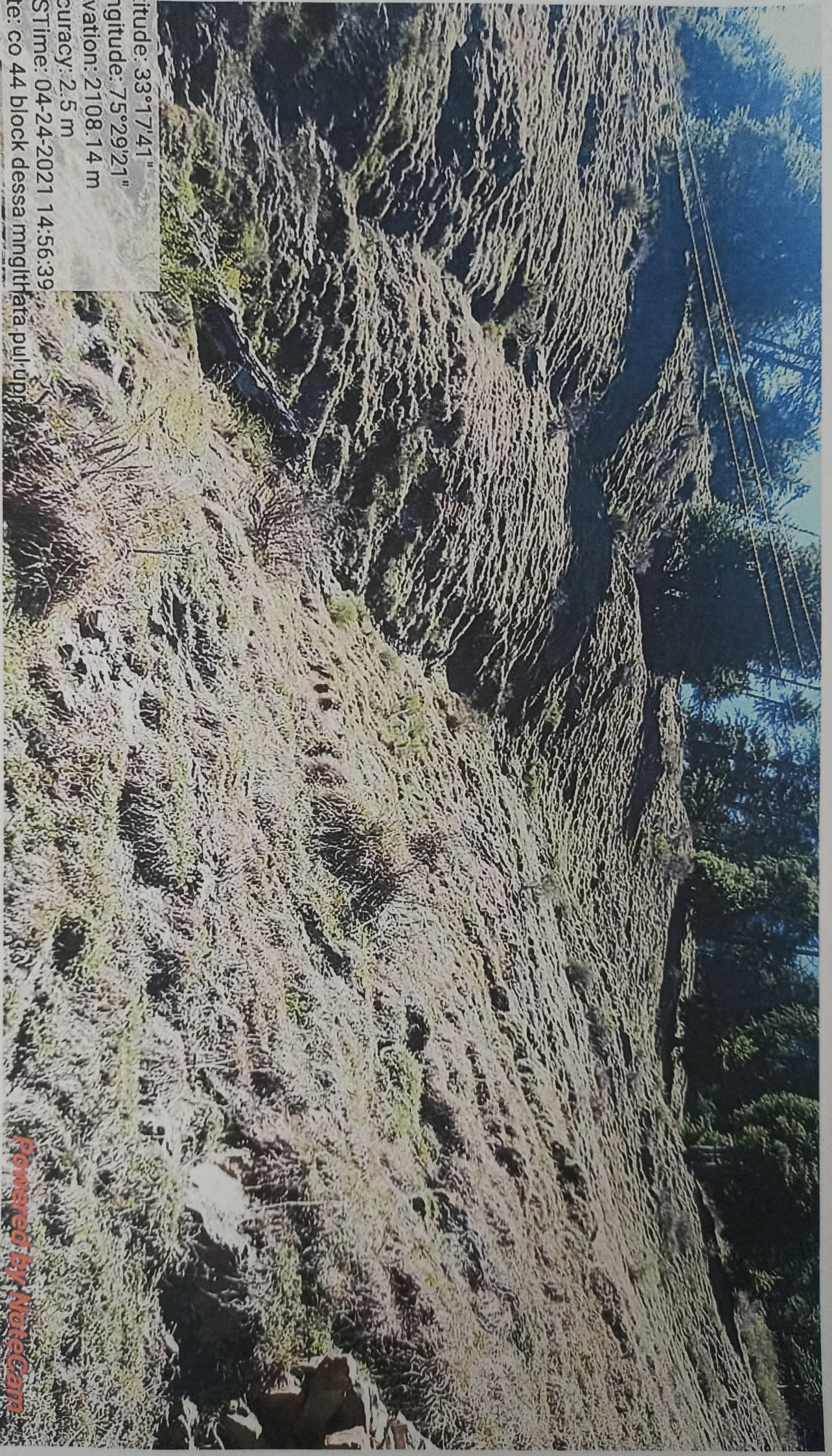

Powered by NoreCam

Latitude: 33°17'39"

Longitude: 75°29'18"

Elevation: 2111.23 m

Accuracy: 5.5 m

GPSTime: 04-24-2021 14:59:20

Note: co 44 block dessa mnglthata pul upi