

THE PLAN OF FOREST LAND FOR APPROACH ACCESS ROAD TO R. K. RESORT (MARRIAGE PALACE) BELONGING TO SH. RAMANDEEP CHAUDHARY S/O SH. RAJ KUMAR @ SH. RAJMAL SITUATED AT VILLAGE : KHICHIAN ON MUKERIAN TO GURDASPUR ROAD, L.H.S, TEHSIL : MUKERIAN, DISTT. HOSHIARPUR

H.B.NO. = 261 KHEWET NO. = ^{229 230}/_{204 204} KHANTANI NO. = 286,287
KHASRA NO. = 23//3,23//4/1/2,23//8

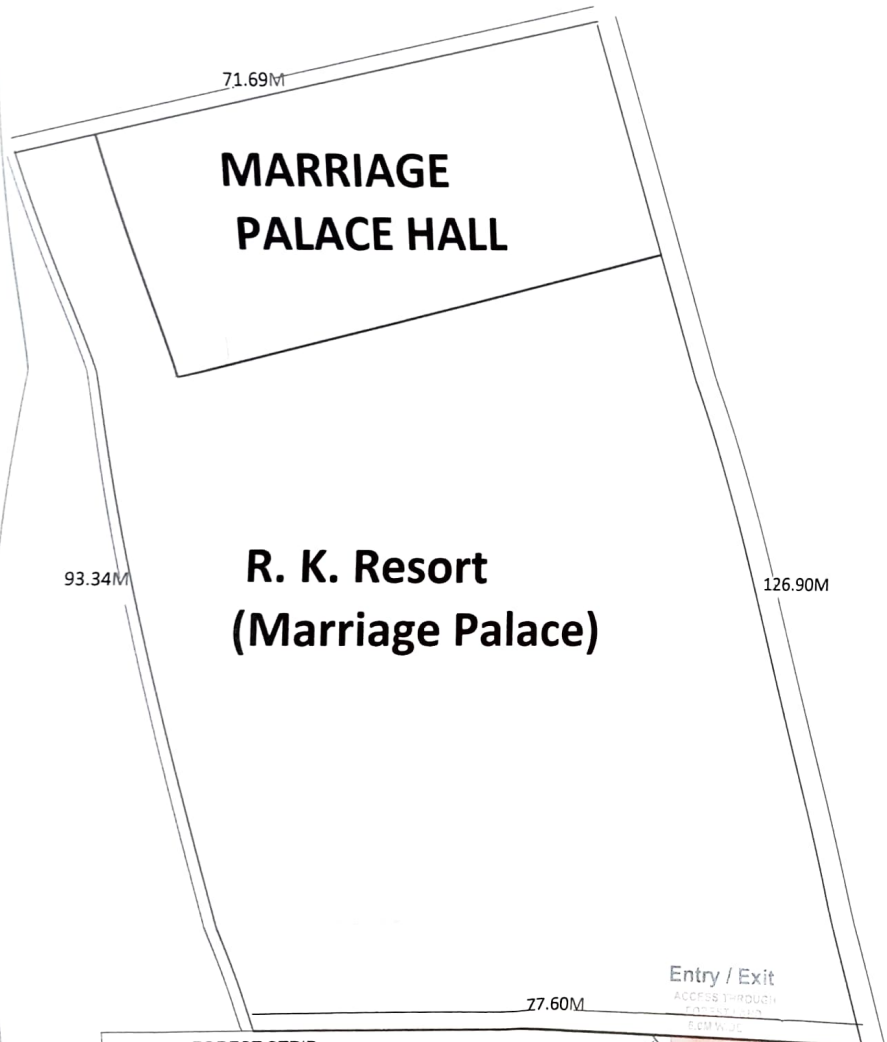

TOTAL AREA OF NON FOREST LAND & MARRIAGE PALACE
LAND=7735.31SQ.MT
=0.77 HA.



AREA OF 2A
=2[$\frac{1}{2}$ X 2.0MX2.0M- $\frac{2}{3}$ X 2.82MX0.11M]
=2[2.0 SQ.MT-0.20 SQ.MT]
=2[1.80 SQ.MT]
=3.60 SQ.MT

AREA OF B
=6.0MX3.38M
=31.38 SQ.MT

TOTAL PROTECTED AREA
AREA OF 2A = 3.60 SQ.MT
AREA OF B = 20.28 SQ.MT
TOTAL AREA = 23.88 SQ.MT
SAY= 24 SQ.MT.

=0.0024 HECT.

Sub Division Engineer
Provl. Sub Div. No. 1
PWD B&R Br. Hoshiarpur

SIGNATURE OF APPLICANT

[Signature]
R. K. RESORT
Gurdaspur Road, MUKERIAN
Distt. Hoshiarpur (Pb.)

DRAWN BY-

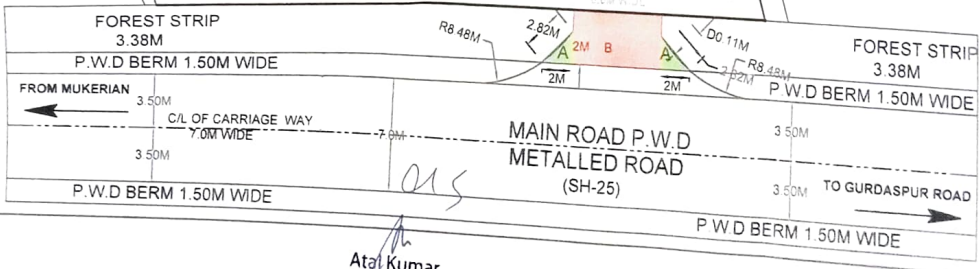

Atal Kumar
Divisional Forest Officer
Dasuya Forest Division