

## **AREA CALCULATION SHEET AS PER APPROVED LAYOUT PLAN**

**PROPOSED PROTECTED FOREST LAND TO BE DIVERTED FOR ENTRY/EXIT APPROACH TO HINDUSTAN PETROLEUM CORPORATION LIMITED RETAIL OUTLET ON LUCKNOW-GORAKHPUR ROAD NH-27 (OLD NH-28) IN KM NO. 152 (CH. NO. 151.564, LHS) AT KHASRA NO. – 1159, VILLAGE:- SHANKARPUR, TEHSIL:- HARRAIYA, DISTRICT:- BASTI (U.P.)**

### **Entry Area approach to Retail Outlet**

$$\begin{aligned} &= AA1A2 + A1A2A3 + A2A3A4 + BB1A4A3 \\ &= \{1/2 \times (57.0m \times 5.5m)\} + \{1/2 \times (13.0m \times 5.5m)\} + \{1/2 \times (13.7967m \times 9.6m)\} + (11.61m \times 3.0m) \\ &= 156.75 \text{ SqM} + 35.75 \text{ SqM} + 66.224 \text{ SqM} + 34.83 \text{ SqM} \\ &= 293.554 \text{ SqM} \end{aligned}$$

### **Area of Earthen Shoulder along Entry approach to Retail Outlet**

$$\begin{aligned} &= AA2G1G + G1A2A4 \\ &= (57.0m \times 2.25m) + \{1/2 \times (17.44712m \times 2.25m)\} \\ &= 128.25 \text{ SqM} + 19.628 \text{ SqM} \\ &= 147.878 \text{ SqM} \end{aligned}$$

### **Area in Between Entry & Exit (Separator)**

$$\begin{aligned} &= CC1C2B3 \\ &= [1/2 \times (54.34m + 58.38m) \times 2.25m] \\ &= 126.814 \text{ SqM} \end{aligned}$$

### **Area of Exit approach from Retail Outlet**

$$\begin{aligned} &= DD1D2 + D1D2C2C3 \\ &= \{1/2 \times (30.0m \times 5.5m)\} + [1/2 \times (8.8m + 5.5m) \times 58.2742m] \\ &= 82.5 \text{ SqM} + 416.66 \text{ SqM} \\ &= 499.16 \text{ SqM} \end{aligned}$$

### **Area of Earthen Shoulder along Exit approach from Retail Outlet**

$$\begin{aligned} &= HH1D2D + H1H2C2D2 \\ &= (30.0m \times 2.25m) + (59.216m \times 2.25m) \\ &= 67.5 \text{ SqM} + 133.236 \text{ SqM} \\ &= 200.736 \text{ SqM} \end{aligned}$$

### **Area of Proposed Service Road along Entry/Exit approach to Retail Outlet**

$$\begin{aligned} &= BB1B2B3 + C2C3B2B3 \\ &= (121.3798m \times 9.5m) + [1/2 \times (9.5m + 8.8m) \times 54.59126m] \\ &= 1153.108 \text{ SqM} + 499.51 \text{ SqM} \\ &= 1652.618 \text{ SqM} \end{aligned}$$

17/5/22  
*Ashish Kumar Sharma*  
Ashish Kumar Sharma  
Duly Consulted Attorney  
Hindustan Petroleum Corporation Limited

**Total Protected Forest Area Proposed to be Diverted**

= 293.554 (Entry Area) SqM + 147.878 (Entry Earthen shoulder) SqM + 126.814 (Separator) SqM +  
 499.16 (Exit Area) SqM + 200.736 (Exit Earthen shoulder) SqM + 1652.618 (Service Road) SqM  
 = 2920.76 SqM  
 = **0.292076 Ha.**

**Total Area of Non-Forest Land as per Layout Plan**

Private land area calculation =

= area of rectangle shape plot = PQRS = {length(m) x width(m)}  
 = (42.0 x 48.0m) = 2016.0 SqM

Non Forest Land area calculation =

= SS1S2 + ST1S3S2 + T1U1Q3S3 + UU1Q3Q2 + QQ1Q2  
 = [(4.6m x 7.14m) - {3.14 x (4.6m x 7.14m)/4}] +  
 (11.50m x 7.14m) + (12.0m x 7.14m) + (11.50m x 7.14m) +  
 [(4.6m x 7.14m) - {3.14 x (4.6m x 7.14m)/4}]  
 = (7.06 + 82.11 + 85.68 + 82.11 + 7.06) SqM  
 = 264.02 SqM

So, total non-forest land is = (2016.0 + 264.02) SqM  
 = 2280.02 SqM

≈ **0.228 Ha.**

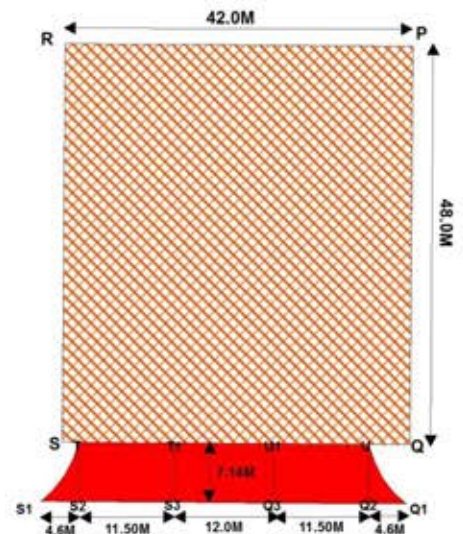

**(Authorized Signatory)**

**Hindustan Petroleum Corporation Ltd.  
 Gorakhpur Retail Regional Office**

17/5/22  
*Ashish Kumar Sharma*  
 Ashish Kumar Sharma  
 Duty Consulted Attorney  
 Hindustan Petroleum Corporation Limited

**PROPOSED PROTECTED FOREST LAND TO BE DIVERTED FOR ENTRY/EXIT APPROACH TO HINDUSTAN PETROLEUM CORPORATION LIMITED  
RETAIL OUTLET ON LUCKNOW-GORAKHPUR ROAD NH-27 (OLDNH-28) IN KM NO. 152 (CH. NO. 151.564, LHS) AT KHASRA NO. – 1159,  
VILLAGE:- SHANKARPUR, TEHSIL:- HARRAIYA, DISTRICT:- BASTI (U.P.)**



**Hindustan Petroleum Corporation Ltd.**  
**Gorakhpur Retail Regional Office**