

TOTAL SITE AREA	0.1225 HECTARES
VILLAGE	NOGAON
TEHSIL	MATANHAIL
DISTRICT	JHAJJAR
STATE	HARYANA

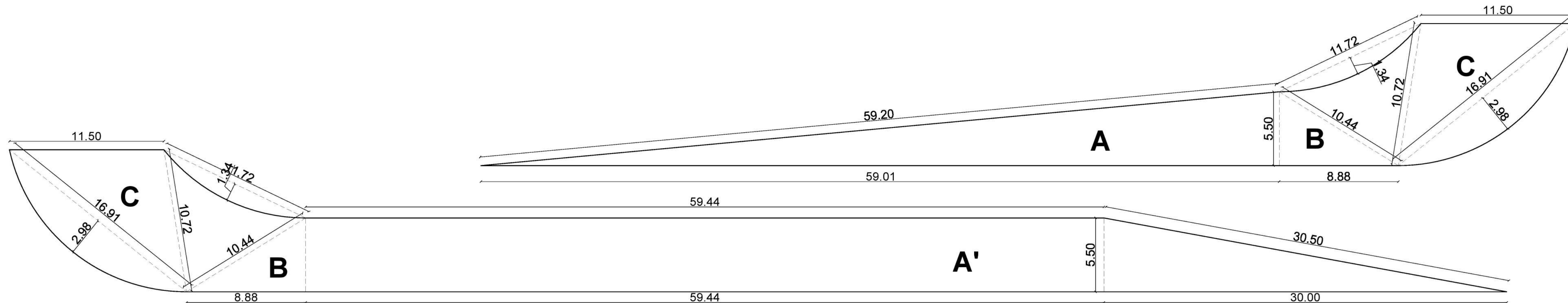
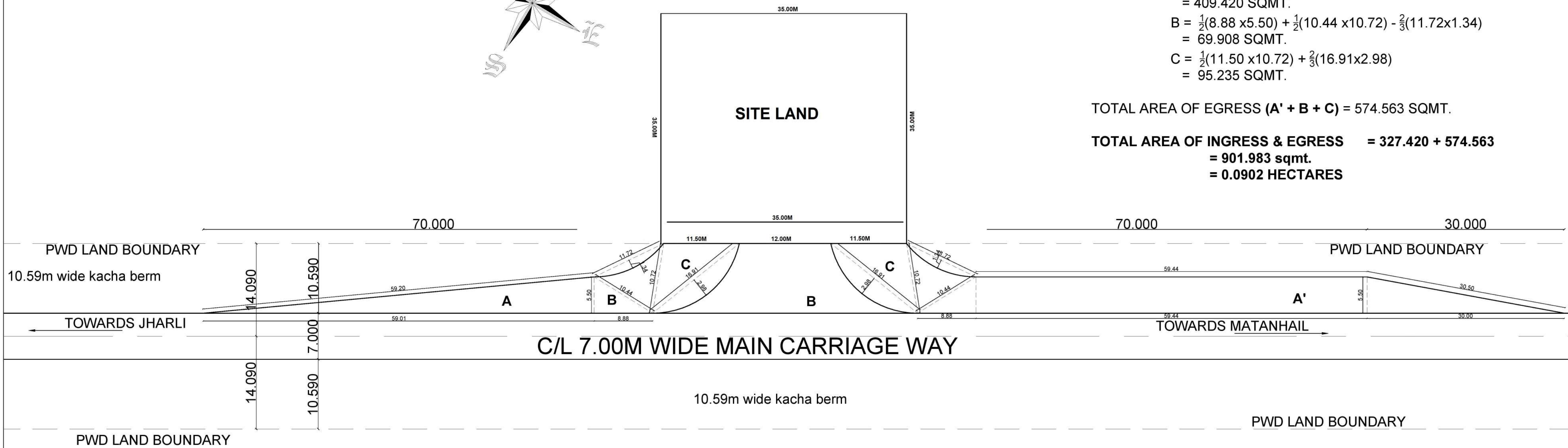
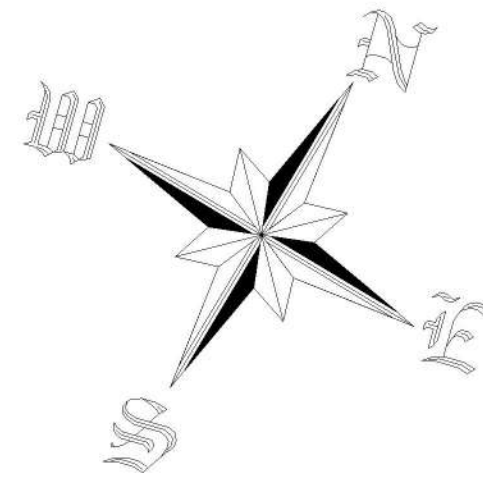

APPROACH ROAD AREA

AREA OF INGRESS = A + B + C

$$A = \frac{1}{2}(59.01 \times 5.50)$$
$$= 162.278 \text{ SQMT.}$$

$$B = \frac{1}{2}(8.88 \times 5.50) + \frac{1}{2}(10.44 \times 10.72) - \frac{2}{3}(11.72 \times 1.34) = 69.908 \text{ SQMT.}$$

$$C = \frac{1}{2}(11.50 \times 10.72) + \frac{2}{3}(16.91 \times 2.98)$$
$$= 95.234 \text{ SQMT.}$$

TOTAL AREA OF INGRESS (A + B + C) = 327.420 SQMT.

$$\text{AREA OF EGRESS} = A' + B + C$$

$$A' = (59.44 \times 5.50) + \frac{1}{2}(30.00 \times 5.50)$$

$$= 409.420 \text{ SQMT.}$$

$$B = \frac{1}{2}(8.88 \times 5.50) + \frac{1}{2}(10.44 \times 10.72) - \frac{2}{3}(11.72 \times 1.34) = 69.908 \text{ SQMT.}$$

$$C = \frac{1}{2}(11.50 \times 10.72) + \frac{2}{3}(16.91 \times 2.98) = 95.235 \text{ SQMT.}$$

TOTAL AREA OF EGRESS (A' + B + C) = 574.563 SQMT.

TOTAL AREA OF INGRESS & EGRESS = 327.420 + 574.563
= 901.983 sqmt.
= 0.0902 HECTARES

NOTES:-

1.DRAWING AND DIMENSIONS ARE ONLY TO BE READ AND NOT SCALED.

2.UNLESS OTHERWISE MENTIONED,
ALL DIMENSIONS ARE GIVEN IN FEET -
INCHES.

3. THIS DRAWING SHALL BE READ IN CONJUNCTION WITH RELEVANT ARCHITECTURAL, STRUCTURAL AND SERVICE DRAWINGS.

4.ALL LEVELS GIVEN IN DRAWING ARE
WITH REFERENCE TO THE ROAD
LEVEL AS BENCHMARKED AT SITE.

5. ANY DISCREPANCY BETWEEN THE ARCHITECTURAL / STRUCTURAL OR SERVICES DRAWINGS MUST BE BROUGHT TO THE ATTENTION OF THE ARCHITECT BY THE CONTRACTOR OR PROJECT MANAGER BEFORE EXECUTION OF THE SAME.

6. THIS DRAWING & DESIGN IS THE
COPYRIGHT OF THE ARCHITECT & CAN
NOT BE REPRODUCED IN ANY FORM
WITHOUT WRITTEN CONSENT FROM
THE ARCHITECT

USER AGENCY:

अश्विन यादव / Ashwin Yadav
सहायक प्रबन्धक (रि.से.), रेवारी-1, रि.से.ए.
Asstt. Manager (RS), Rewari-1, RSA
इंडियनॉइल कार्पोरेशन लिमिटेड
INDIANOIL CORPORATION LIMITED
गुर्गाँव मण्डल कार्यालय / Gurgaon Divisional Office

ASHWIN YADAV
ASST. MANAGER (RS))
REWARI -I, RSA
INDIAN OIL CORPORATION LIMITED
GURGAON DIVISIONAL OFFICE

ARCHITECT:

DRAWING NAME:

SITE PLAN

SCALE : NTS

PLOT SIZE: 0.1225 HACTARES

PROJECT NAME:
SITE PLAN OF PROPOSED STE FOR RETAIL
OUTLET (MS/HSD) OF IOCL SITUATED AT
VILLAGE - NOGAON ON MATANHAIL - JHARLI
ROAD OF BLOCK- MATANHAIL, DISTT. - JHAJJAR
(HARYANA)

DATE:	
-------	--

11/04/2021

ORG. NO.:

01



DRAWN BY:

PRINCIPAL ARCHITECT:

Ar. NISHANT SINGLA

ARCHITECTS & INTERIOR DESIGNERS
EMAIL :- nishantsingla8@gmail.com