

Muck Management Plan

Proposal Name:- C/O Road from Bijmal to halau via Shallan GP Halau Km 0/0 to 7/0.

Sr.	Description	Quantity	
1	Total Quantity of Muck being produced	122091.07	
	Deduction for useful stone as required under the clause of agreement to be executed by the Contractor and Executive Engineer of Project. @ 5%	6104.55	
2	Net Balance Quantity of Debris/Muck (1-2)	115986.52	Cum (A)
3	Quantity available on site with swell factor @ 25% of (A)	28996.63	Cum (B)
	Total Muck with Swell factor	144983.15	Cum (C)
	Material /Muck to be used in Project:-		
(i)	Deduction of material required for the construction of dry masonry wall/Edge wall @ 10% of (C)	14498.31	
(ii)	Less for material/Muck required for leveling of the proposed road @15% of (C)	21747.47	
(iii)	Less for material/Muck used in filling behind R/Wall, B/Wall @ 15% (C)	21747.47	
	Total :- (i)+(ii)+(iii)	57993.26	Cum (D)
	Net material/Muck to dumped in dumping site (C-D) in Cum	86989.89	Cum (D)
	Total Muck to be Dumped in project site	86989.89	Cum

 Engineer
 B & B Division
 HPPWD Chopala

Dumping Capacity Plan				
Sr. No.	Dumping Site	R.D.	Design Annexed	Capacity (in Cum)
1	Bjmal	1/545 to 1/645	D1	24782
2	Aar	1/800 to 1/915	D2	7964.9
3	Aar	4/060 to 4/120	D3	9631.2
4	Shalan	4/710 to 4/810	D4	31466
5	DPF Sawara	5/287 to 5/339	D5	7375.16
6	Shalan	7/400 to 7/450	D6	7672.5
			Total	88891.76



 Executive Engineer
 Chopal Division
 HPPWD, Chopal

Detail of Measurement						
Sr. No.	Description of Item	No.	L	B	H	Qty.
1	Earth Work in excavation for structure as per drawing and technical specification clauses 305.1 including setting out, construction of shoring and bracing removal of stumps and other deleterious material in ordinary rock using manual means					
	D1, D4	2	100	1.25	0.25	62.50
	D2	1	115	1.25	0.25	35.94
	D3	1	60	1.25	0.25	18.75
	D5	1	52	1.25	0.25	16.25
	D6	1	50	1.25	0.25	15.63
	Total					149.06
2	Providing and laying of bolder apron laid in wire crate with 4mm Dia conforming to IS 280 and 48.26 mesh design including joints laid in bolder weighing not less than 25 Kg each as per drawing and technical specification clause 1301					
	D1, D4	2	100	1.25	1.25	312.50
	D2	1	115	1.25	1.25	179.69
	D3	1	60	1.25	1.25	93.75
	D5	1	52	1.25	1.25	81.25
	D6	1	50	1.25	1.25	78.13
	Total					745.31

ABSTRACT OF COST**Name of Work:- C/O Bijmal to Halau via Shalan GP Halau Km 0/0 to 7/0 (SH:- F/C Between Km 0/0 to 7/0)**

Sr. No.	Description of Item	Qty.	Rate	Unit	Amount
	Earth Work in excavation for structure as per drawing and technical specification clauses 305.1 including setting out, construction of shoring and bracing removal of stumps and other deleterious material in ordinary rock using manual means	149.06	128.5	Per Cubic Meter	19154.53125
	Providing and laying of bolder apron laid in wire crate with 4mm Dia conforming to IS 280 and 48.26 mesh design including joints laid in bolder weighing not less than 25 Kg each as per drawing and technical specification clause 1301	745.31	1458.4	Per Cubic Meter	1086963.75
				Total	1106118.281

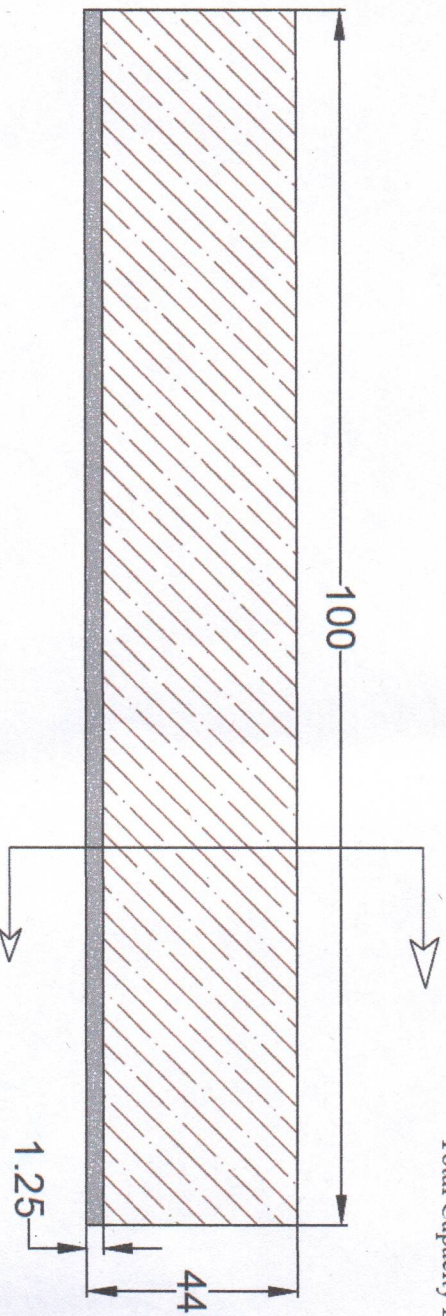
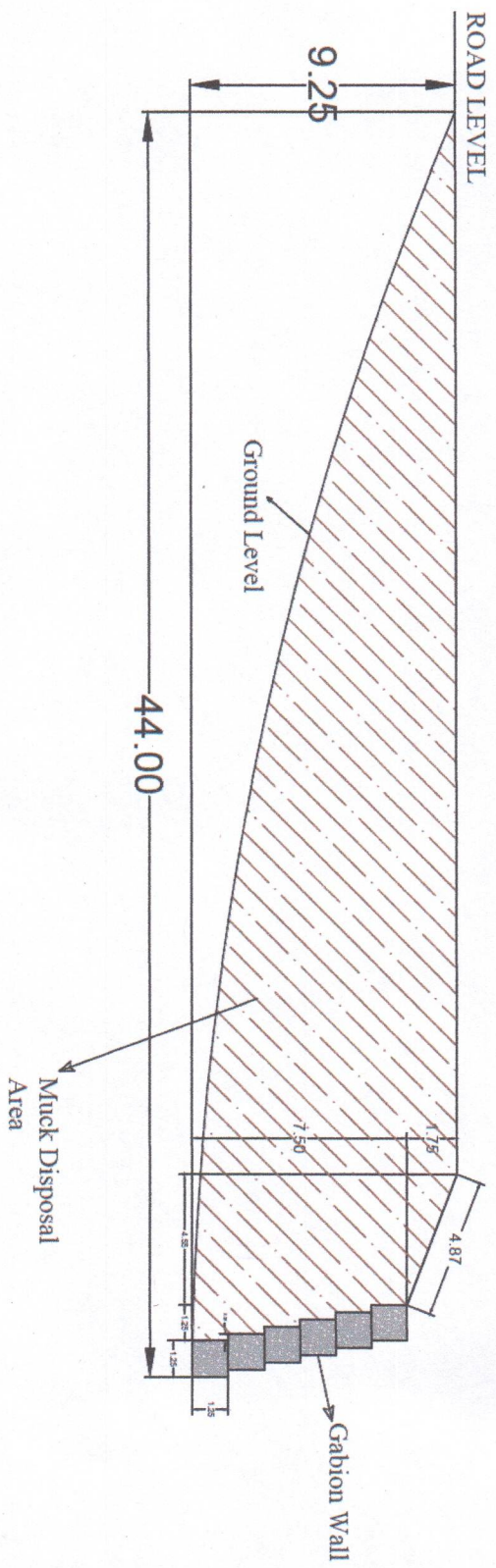
Cross-section Plan & X-Section of Dumping site at RD 1/545 to 1/645



Muck Disposal Area - 247.82 SqM
 Total Capacity Dumping Area - 24782 Cum

Engineer
 B&R Division
 HPPWD Chopal

Cross-section Plan & X-Section of Dumping site at RD 4/060 to 4/120

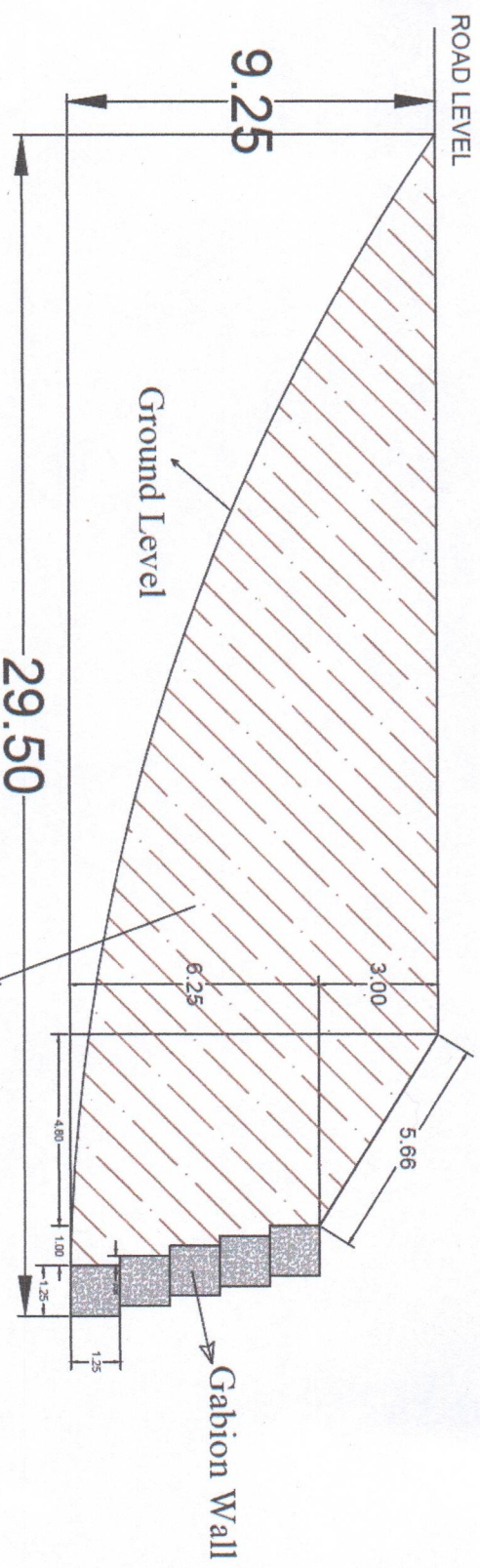

Muck Disposal Area - 160.52 SqM
 Total Capacity Dumping Area - 9631.2 Cum

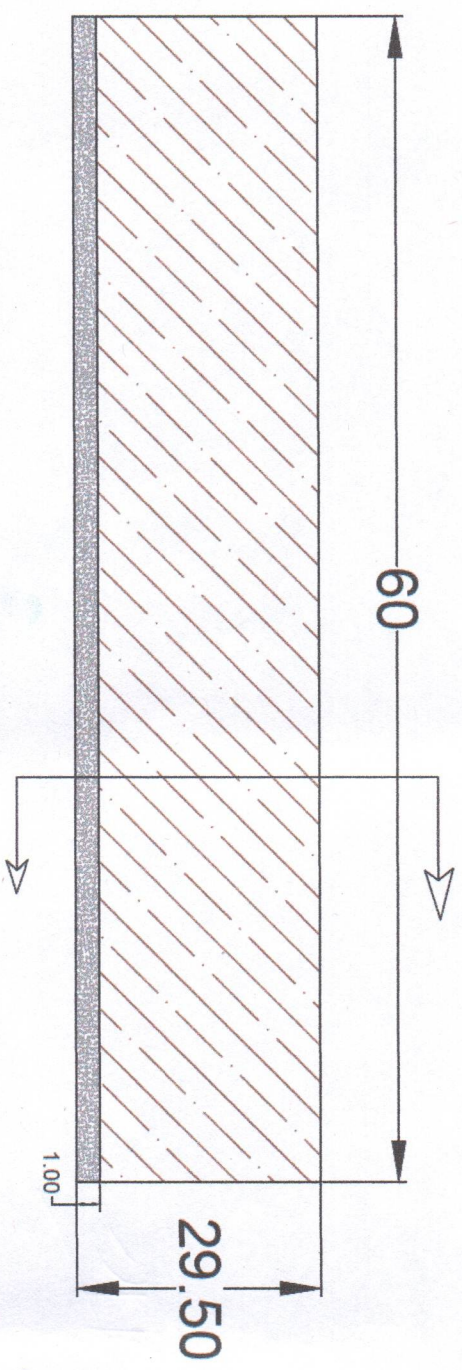

Signature
 Executive Engineer
 B&R Division
 HPPWD Chopal

Cross-section Plan & X-Section of Dumping site at RD 4/710 to 4/810

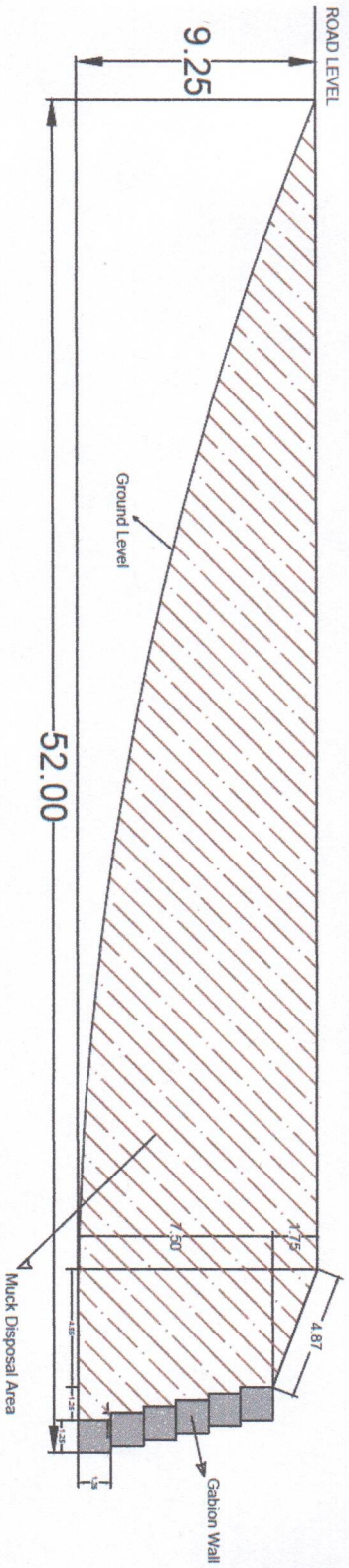

Muck Disposal Area - 314.66 SqM
 Total Capacity Dumping Area - 31466 Cum

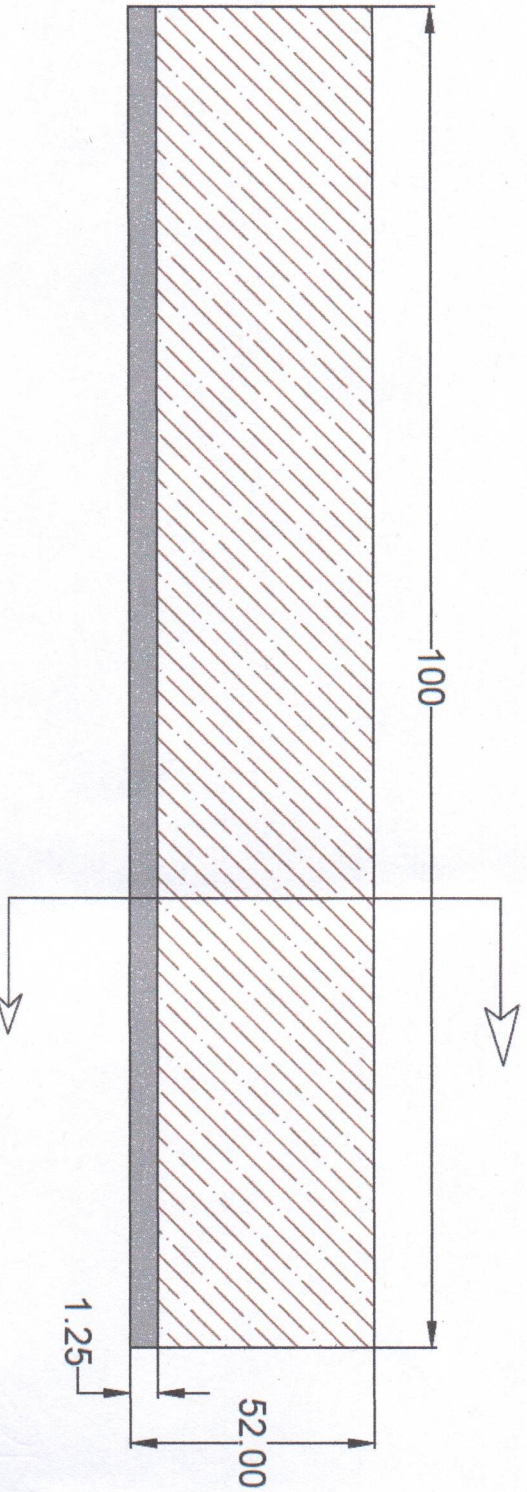

Senior Engineer
 B&K Division
 HPPWD Chopala

Cross-section Plan & X-Section of Dumping site at RD 7/400 to 7/450

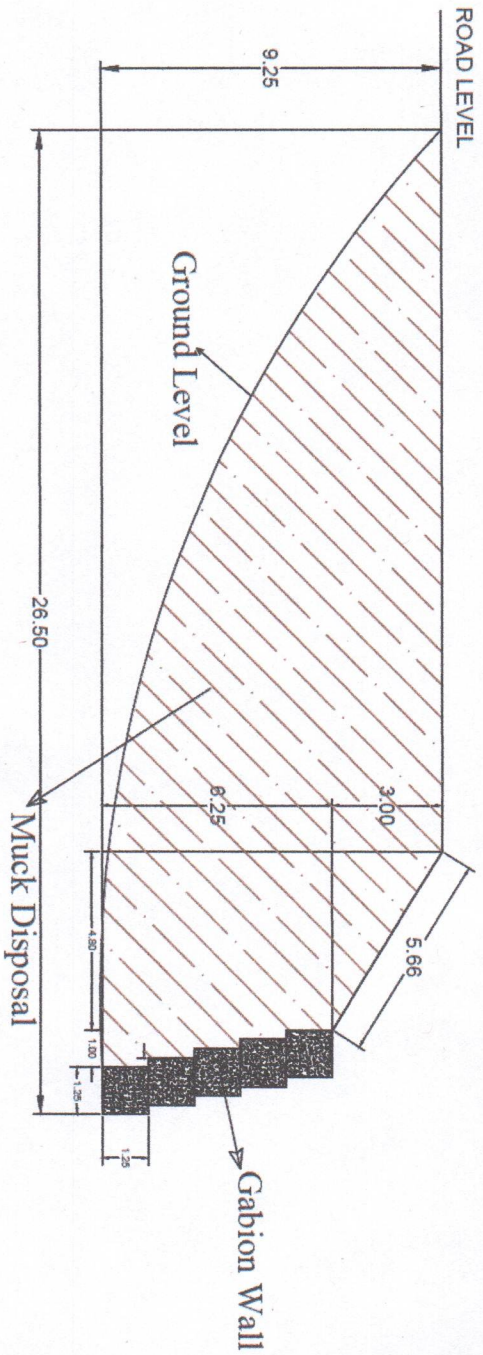

Muck Disposal Area - 153.45 SqM
 Total Capacity Dumping Area - 7672.50 Cum

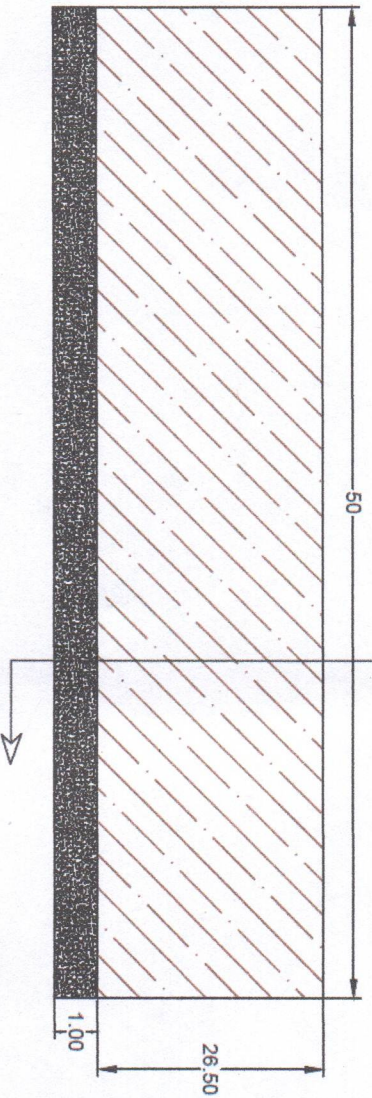

Executive Engineer
 B&R Division
 HPPWD Chopal

Cross-section Plan & X-Section of Dumping site at RD 5/287 to 5/339

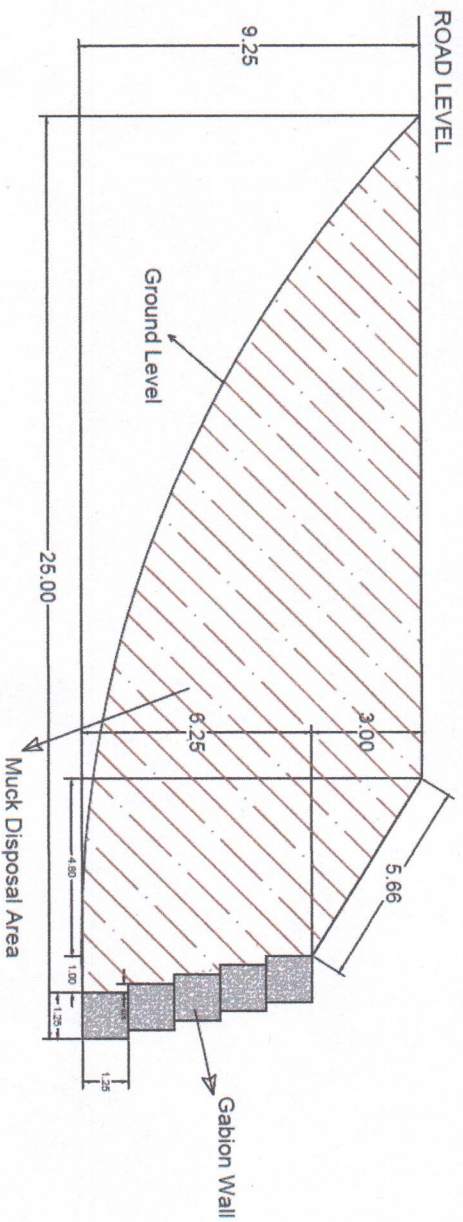

Muck Disposal Area - 141.83 SqM
 Total Capacity Dumping Area - 7375.16 Cum

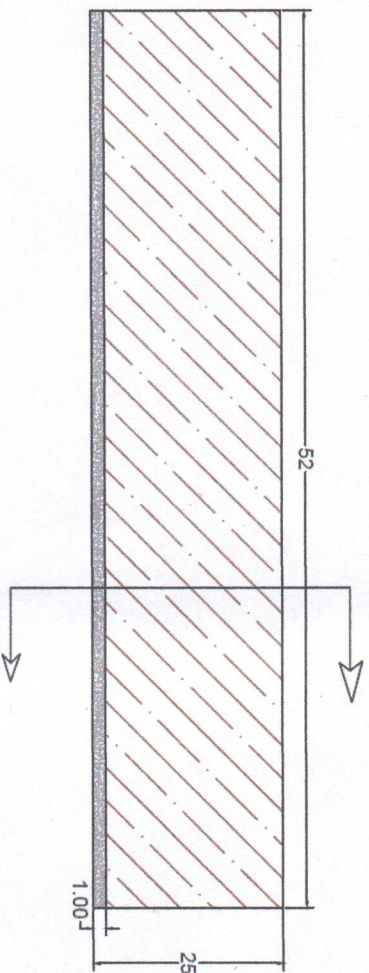

Executive Engineer
 B&N Division
 HPPWD Chopal