

SITE/LAYOUT PLAN FOR CONSTRUCTION OF GOVT. POLYTECHNIC COLLEGE DALASH, DISTRICT KULLU (H.P.)

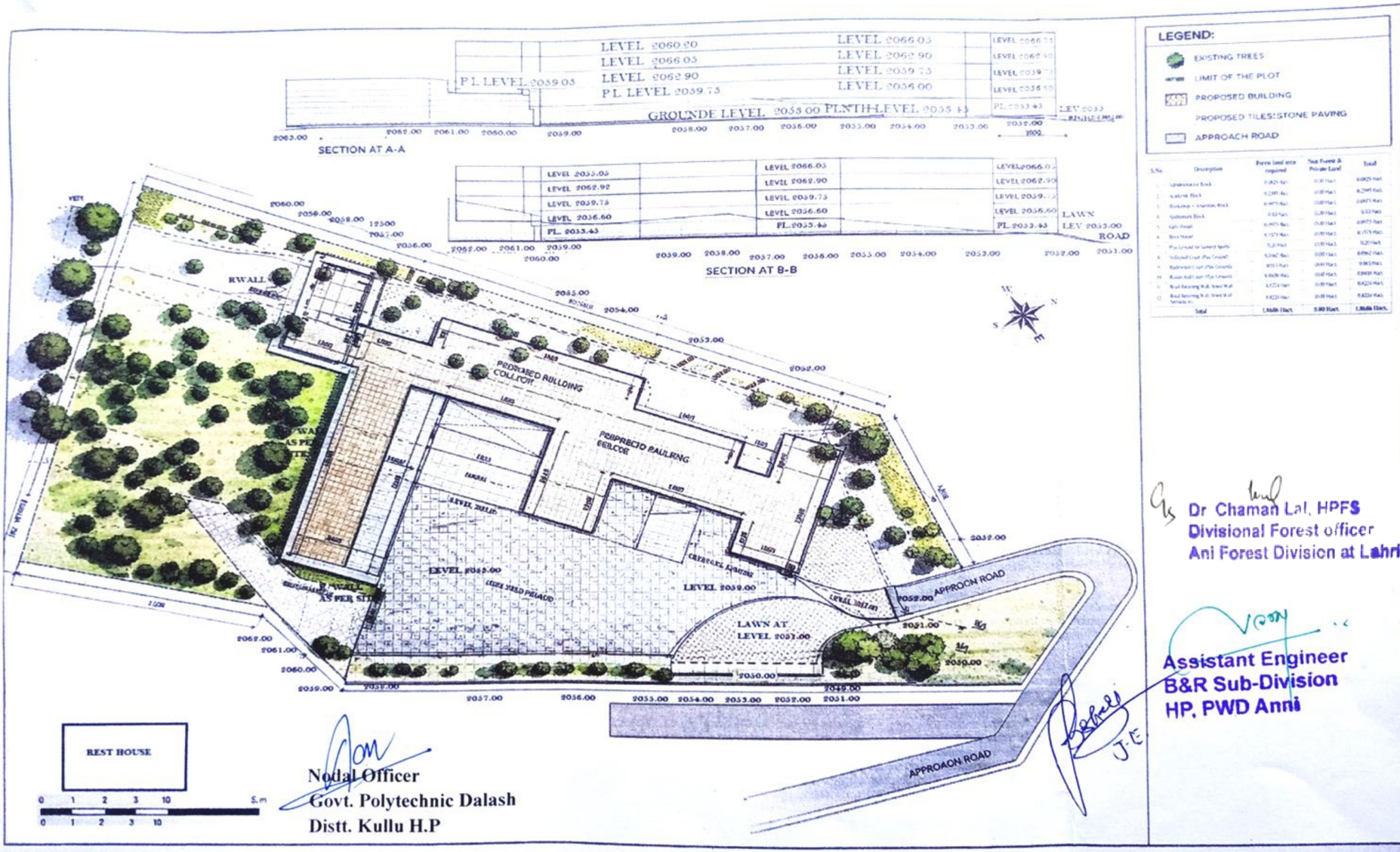

SITE/LAYOUT PLAN FOR CONSTRUCTION OF GOVT. POLYTECHNIC COLLEGE DALASH, DISTRICT KULLU (H.P.)

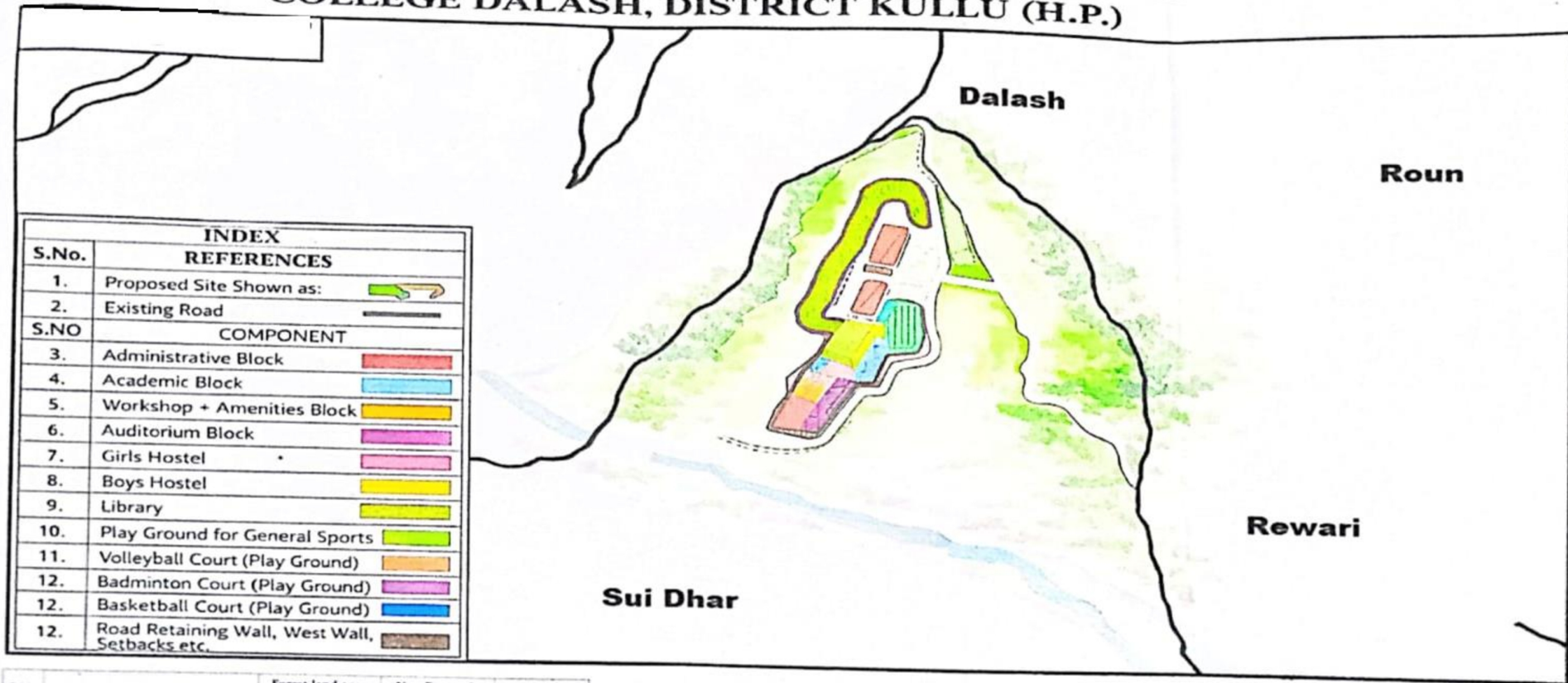

INDEX	
S.No.	REFERENCES
1.	Proposed Site Shown as:
2.	Existing Road
S.NO	COMPONENT
3.	Administrative Block
4.	Academic Block
5.	Workshop + Amenities Block
6.	Auditorium Block
7.	Girls Hostel
8.	Boys Hostel
9.	Library
10.	Play Ground for General Sports
11.	Volleyball Court (Play Ground)
12.	Badminton Court (Play Ground)
12.	Basketball Court (Play Ground)
12.	Road Retaining Wall, West Wall, Setbacks etc.

S.No.	Description	Forest land area required	Non Forest & Private Land	Total
1.	Administrative Block	0.0825 Hact.	0.00 Hact.	0.0825 Hact.
2.	Academic Block	0.2595 Hact.	0.00 Hact.	0.2595 Hact.
3.	Workshop + Amenities Block	0.0975 Hact.	0.00 Hact.	0.0975 Hact.
4.	Auditorium Block	0.03 Hact.	0.00 Hact.	0.03 Hact.
5.	Girls Hostel	0.0975 Hact.	0.00 Hact.	0.0975 Hact.
6.	Boys Hostel	0.1575 Hact.	0.00 Hact.	0.1575 Hact.
7.	Play Ground for General Sports	0.20 Hact.	0.00 Hact.	0.20 Hact.
8.	Volleyball Court (Play Ground)	0.0162 Hact.	0.00 Hact.	0.0162 Hact.
9.	Badminton Court (Play Ground)	0.015 Hact.	0.00 Hact.	0.015 Hact.
10.	Basket Ball Court (Play Ground)	0.0435 Hact.	0.00 Hact.	0.0435 Hact.
11.	Road Retaining Wall, West Wall	0.8224 Hact.	0.00 Hact.	0.8224 Hact.
12.	Road Retaining Wall, West Wall Setbacks etc.	0.8224 Hact.	0.00 Hact.	0.8224 Hact.
Total		1.8686 Hact.	0.00 Hact.	1.8686 Hact.

Dr Chaman Lal, HPFS
Divisional Forest officer
Ani Forest Division at Lahri

Nodal Officer
Govt. Polytechnic Dalash
Distt. Kullu H.P.

Assistant Engineer
B&R Sub-Division
HP, PWD Anni

Line Plan of Proposed Road from PWD Rest House Dalash to Proposed Govt. Polytechnic College (Deokufar) Km 0/00 to 0/400

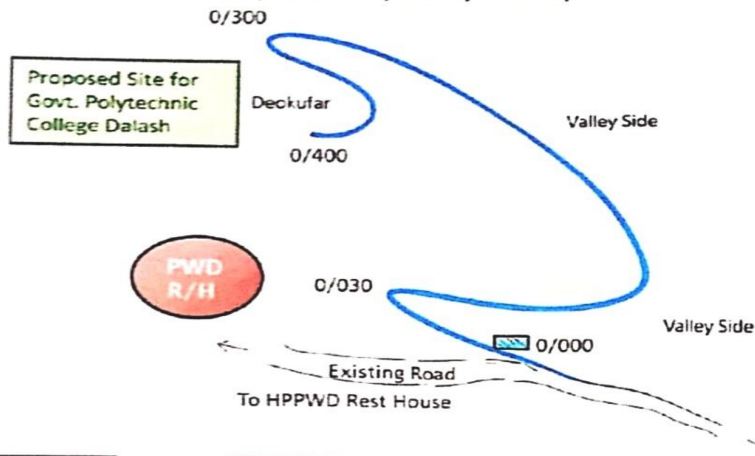

LEGEND	
DESCRIPTION	SYMBOL
Proposed College Site	
Proposed Road	
PWD R/H	
Dumping Site	

GRADIENT	
RD	GRADE
0/000	1:14 Rise
0/090	1:15 Rise
0/300	1:16 Rise

To Dalash		
DETAIL OF LAND		
RD	TO	PVT.
0/400	0/400	-
	400m	-
Total	400m	-

Nodal Officer
 Govt. Polytechnic Dalash
 Distt. Kullu H.P

Assistant Engineer
 B&R Sub-Division
 HP. PWD Anni

Dr. Chaman Lal, HPFS
 Divisional Forest officer
 Ani Forest Division at Lahri

Layout Plan For Govt. Polytechnic College at Dalash

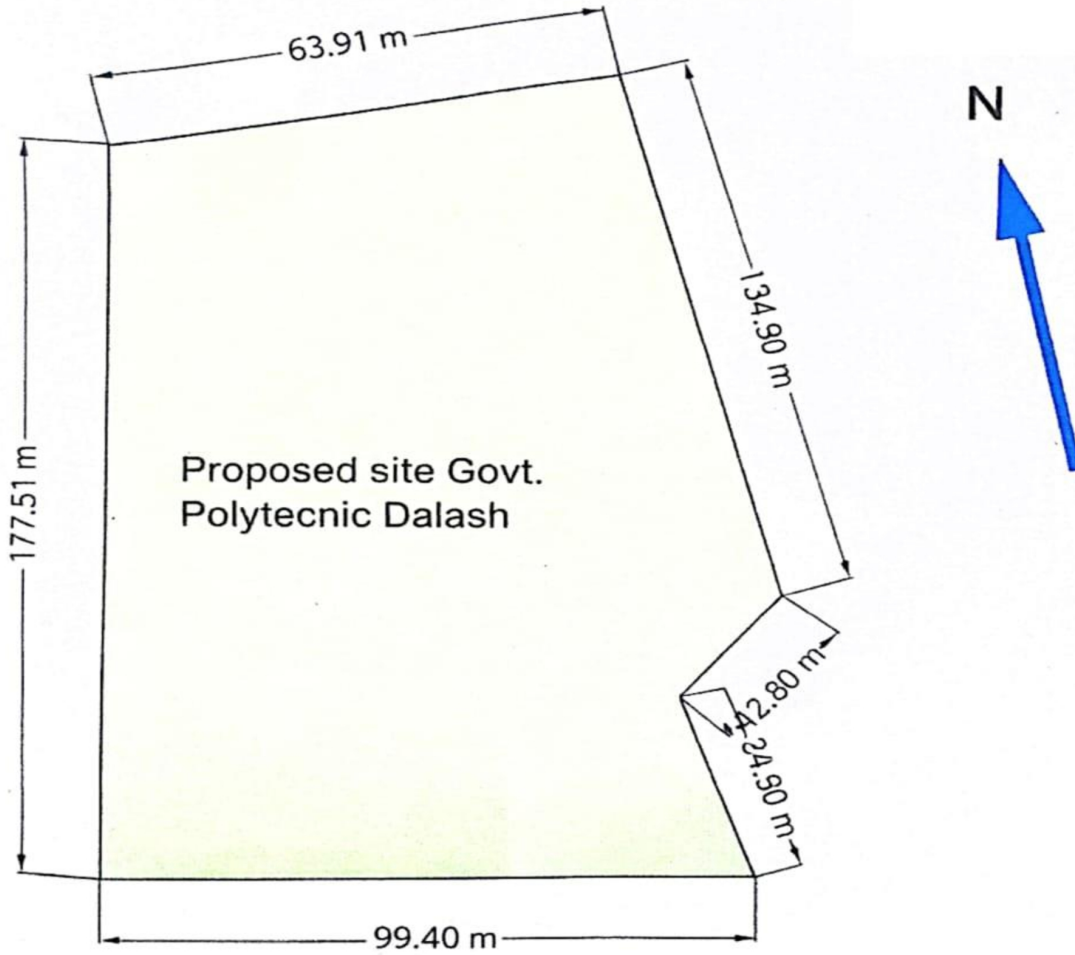

Nodal Officer
Govt. Polytechnic Dalash
Dist. Kullu H.P

Assistant Engineer
B&R Sub-Division
HP. PWD Anni

Dr Chaman Lal, HPFS
Divisional Forest officer
Ani Forest Division at Lahri