

AREA OF APPROACHES

AREA AT 'A' = $6.0MX3.36M = 20.16X2 = 40.32$ SQ.M.

AREA AT 'B' = AREA MARKED 'B' - AREA OF SEGMENT
 $2X[(1/2X5.0MX3.36M) - 2/3X6.02MX1.01M]$
 $= 2X[8.40 - 4.05]$ SQ.M.

$= 2X4.35$ SQ.M. = 8.70 SQ.M.

TOTAL AREA = $(A+B)$
 $= 40.32 + 8.70$ SQ.M.

$= 49.02$ SQ.M.

$= 0.0049$ HECT.

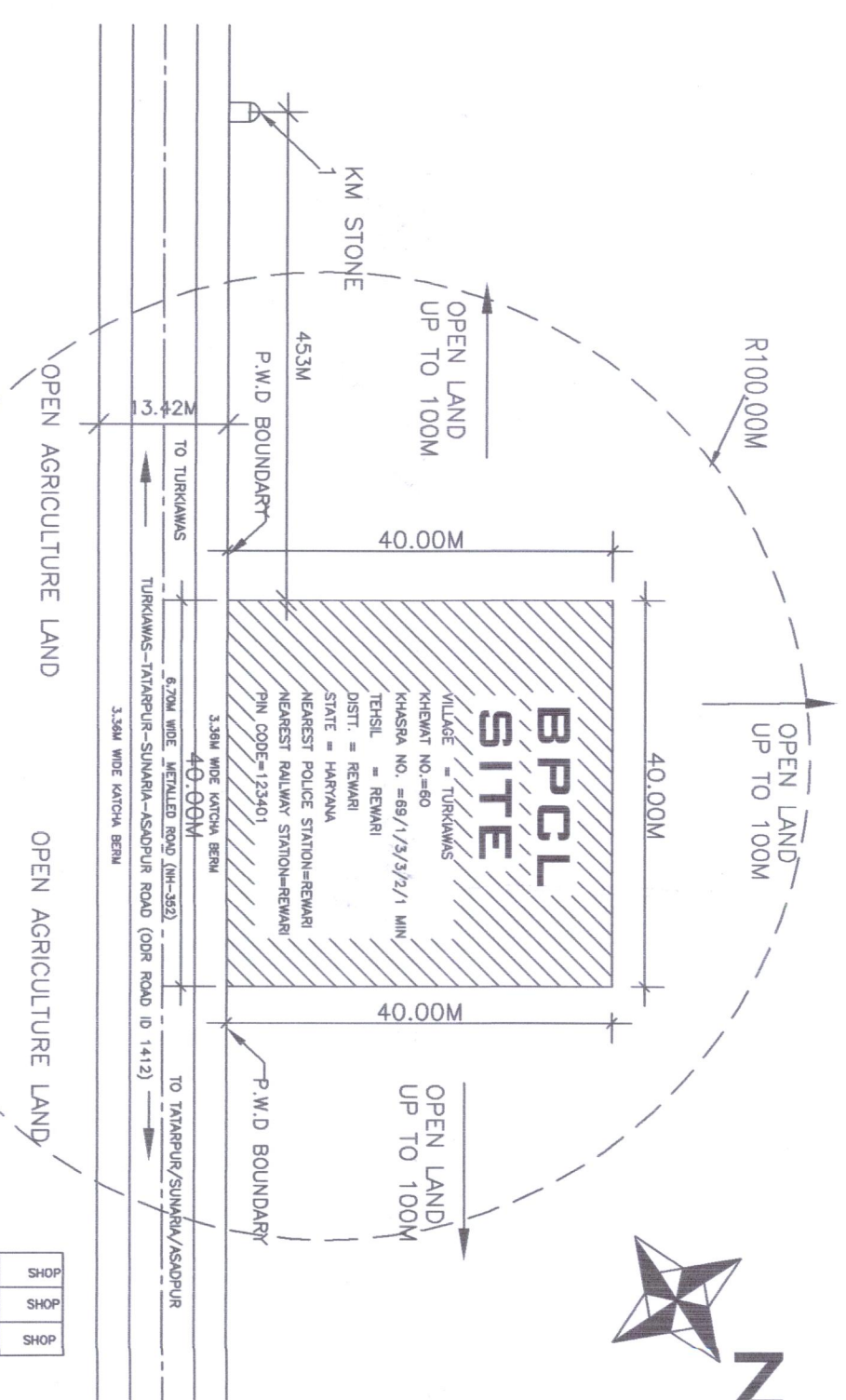
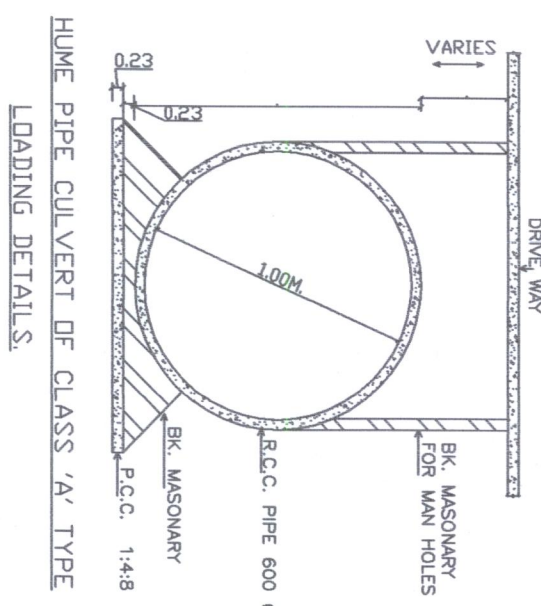
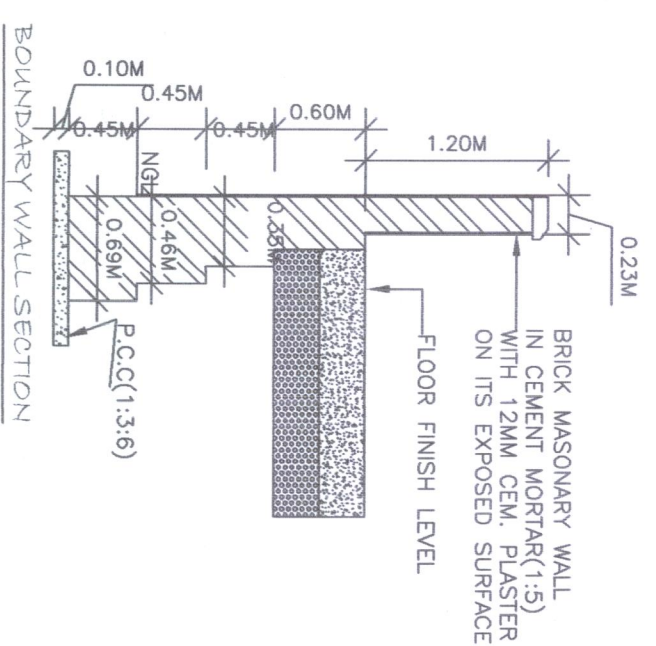
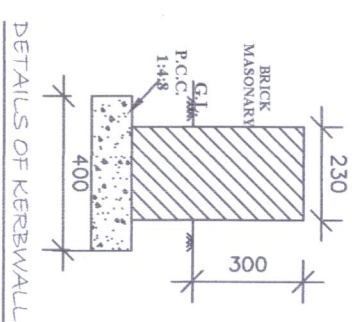
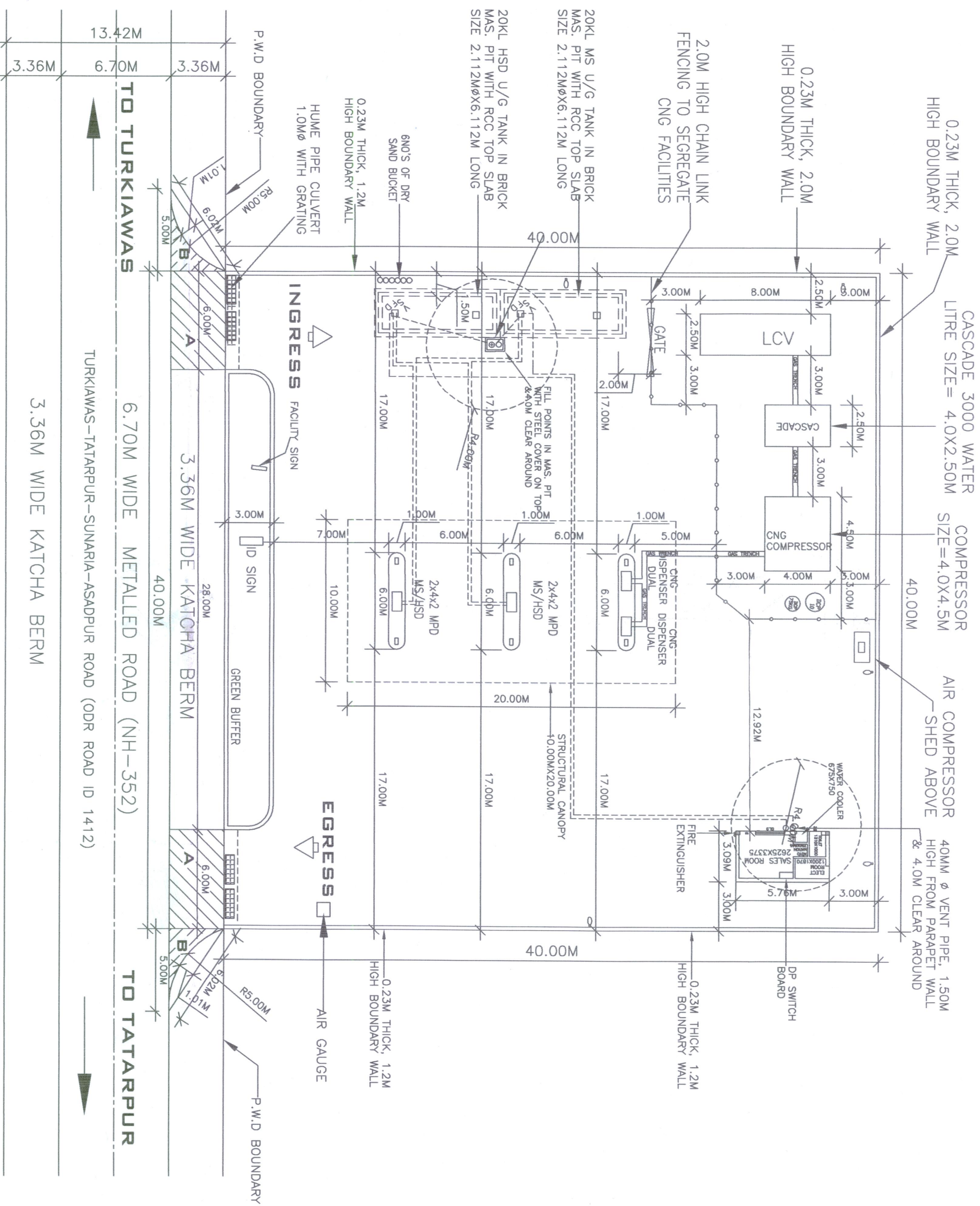

AREA DETAIL	
TOTAL PLOT AREA	1600.00 SQM.
TOTAL BUILDING AREA	17.79 SQM.
TOTAL CANOPY AREA	200.00 SQM.

NOTES & CERTIFICATES

1. CERTIFIED THAT THERE IS NO OTHER STRUCTURE WILL BE ERECTED FOR ANY OTHER SERVICE RENDERED EXCEPT THAT CONNECTED WITH THE PETROL PUMP WITHOUT THE PRIOR APPROVAL OF P.W.O.
 2. CERTIFIED THAT THERE IS NO ROAD CROSSING WITH IN 100M BETWEEN THE TANGENT POINT OF THE CURVE OF SIDE ROAD AND THAT OF THE R.F.L. FILLING CLAM SERVICE STATION.
 3. CERTIFIED THAT THERE IS NO OBSTACLE FROM THE R.F.L. POINT OF VIEW FOR THE INSTALLATION OF THIS PUMP AND PROPOSED ROAD.
 4. CERTIFIED THAT NO OTHER PETROL PUMP EXISTS WITHIN THE DISTANCE OF 300M ON EITHER SIDE OF THE PLOT.
 5. CERTIFIED THAT THE BERM PORTION IS NOT INCLUDED IN THE AREA OF LAND TO BE LEASED FROM THE GOVT. FOR APPROACH ROAD BUT IS TO BE METALLED IN THE CORPORATION.
 6. CERTIFIED THAT THE APPROACH ROAD SHALL BE 12' WIDE, 10' R.C. FLOW TIME TO TIME WITH THE LOCATION OF ROAD SIDE FUEL FILLING STATIONS HAVE BEEN COMPLIED WITH THE ENTIRE CONSTRUCTION WILL BE ON CORPORATION LAND.
 7. CERTIFIED THAT THE APPROACH ROAD SHALL BE 12' WIDE, 10' R.C. FLOW TIME TO TIME WITH THE LOCATION OF ROAD SIDE FUEL FILLING STATIONS HAVE BEEN COMPLIED WITH THE ENTIRE CONSTRUCTION WILL BE ON CORPORATION LAND.
 8. ELECTRIC PIPE UNDER OR STRUCTURE WITHIN 1.5M FROM U/G TANKS.
 9. ELECTRIC FITTINGS CONFORM TO IS CODE NO 214 FOR DISPENSING PUMP ONLY.
 10. TANKS SHALL BE CONFORM TO FLOOR LEVEL AND WILL NOT BE KEPT UNDER LOCK AND KEY.
 11. TANKS FED BY TANK Lorry.
 12. 40MM DIA. VENT PIPES 4.0M HIGH FROM SL. AND 4M CLEAR AROUND. THE OPEN END OF VENT PIPES COVERED WITH TWO LEAK OF NON CORRODIBLE METAL WIRE GAUGE OF 1/16TH PER CM.
 13. NO HEDGES AND PLANTS MORE THAN 60M HIGH SHOULD BE GROWN AROUND THE BUFFER
 14. THERE SHOULD BE SUFFICIENT STANDING SPACE IN SIDE THE STATION FOR VEHICLES
 15. THERE SHOULD BE SUFFICIENT STANDING SPACE IN SIDE THE STATION FOR VEHICLES
 16. NO SMOKING, SINGULAR EXTINGUISHER AND FIRE BUCKETS PROVIDED AT SITE.
 17. CERTIFIED THAT THE KERMING STONE NOT HAVE ANY INSTALLATION, UNDER GROUND TANKS ETC.
 18. CERTIFIED THAT THE BUILDING OF THE BERM PORTION IS TO BE MADE BY CORP.
 19. CERTIFIED THAT THE BUILDING OF THE BERM PORTION IS TO BE MADE BY CORP.
 20. CERTIFIED THAT THE SURPLUS WATER WILL NOT BE DISPOSED OFF IN PWD LAND
 21. CERTIFIED THAT THE SURPLUS WATER WILL NOT BE DISPOSED OFF IN PWD LAND
 22. CERTIFIED THAT ALL CLEARANCES APPROVAL FROM MOP&P & OTHER RELEVANT GOVT. DEPTS. HAVE ALREADY BEEN OBTAINED.
 23. CERTIFIED THAT THERE IS NO COURT CASE PENDING IN ANY COURT OF INDIA AGAINST THIS PREMISES.
 24. CERTIFIED THAT THIS IS NOT A RESUME CASE.
 25. CERTIFIED THAT STEEL TANK HAS BEEN FABRICATED AS PER DRG. APPROVED BY COE
 26. CERTIFIED THAT THE CANOPY MEASURING 10.00X20.00M CONFORM TO SOUND ENGINEERING SPECIFICATION
- SPECIFICATIONS FOR TANKS:—**
1. COE, NAGPUR APPROVED IN PRINCIPLE THE ARRANGEMENT FOR AUTOMATION SYSTEM FOR R/O. VIDE THEIR LETTER NO. (P-63)/58/1 DATED 08.04.13
 2. ALL TANKS ARE FITTED WITH 0.75W.P.S.T.P. (SUBMERGIBLE TENSILE PUMP) WITH P.F.M.FE
 3. PROOF ELECTRICAL CONNECTION WITH GATE VOLTAGE AS PER CODE APPROVAL R.1(1) 136/DO/PWD/384/1 DT. 17.11.2004

**BHARAT PETROLEUM
CORPORATION LIMITED**

VILLAGE = TURKIAWAS	PROPOSED SITE & LAYOUT PLAN OF
KHASRA NO.-60	RETAIL OUTLET ON
KHASA NO. = 69 1/3/3/2/1 MIN	TURKIAWAS-TATARPUR-SUNARIA-
TEHSIL = REWARI	ASADPUR ROAD (ODR ROAD ID 1412)
DISTT. = REWARI	NEAR KM. STONE 1(LHS)
STATE = HARYANA	AT VILLAGE TURKIAWAS
NEAREST POLICE STATION=REWARI	TEHSIL REWARI
NEAREST RAILWAY STATION=REWARI	DISTT. REWARI (HARYANA)
DRN CODE = 134471	

 DRAWN BY: DEEP DESIGN DEVELOPMENT	L.C. NO. = NEW PROPOSAL DRC. NO. = G/BBCL/10 DATED: 23.03.2019
--	--

विक्रम ठाकुर
प्रारंभिक प्रश्नक - रिटेल
भारत पेट्रोलियम कॉर्पोरेशन लिमिटेड
ग्राम-कननाबाग, रेवाड़ी (हरियाणा)
Vikram S Thakur
Territory Manager (Retail)
Bharat Petroleum Corp. Ltd.
Vill. Kamawas Rewari (H.R.)