

Name of Project: Diversion of 0.32 Ha. of Forest Land for 'Construction of RCC drain at ward 38 (Loni Lal Bag sabji Mandi) along road side district Ghaziabad of Uttar Pradesh State'.

ANNEXURE-I [Forest Area Calculation sheet]

Name of work - Construction Of R.C.C. Drain at Lal Bagh in Tahseel Loni, Ghaziabad.

Average Section (1.50 x 1.00)

Length of Drain = 1270 mtrs.

width of Drain with working Space = 2.50 mtr

Area of Drain = $1270 \times 2.50 = 3175 \text{ m}^2 \approx 0.32 \text{ Hactare.}$

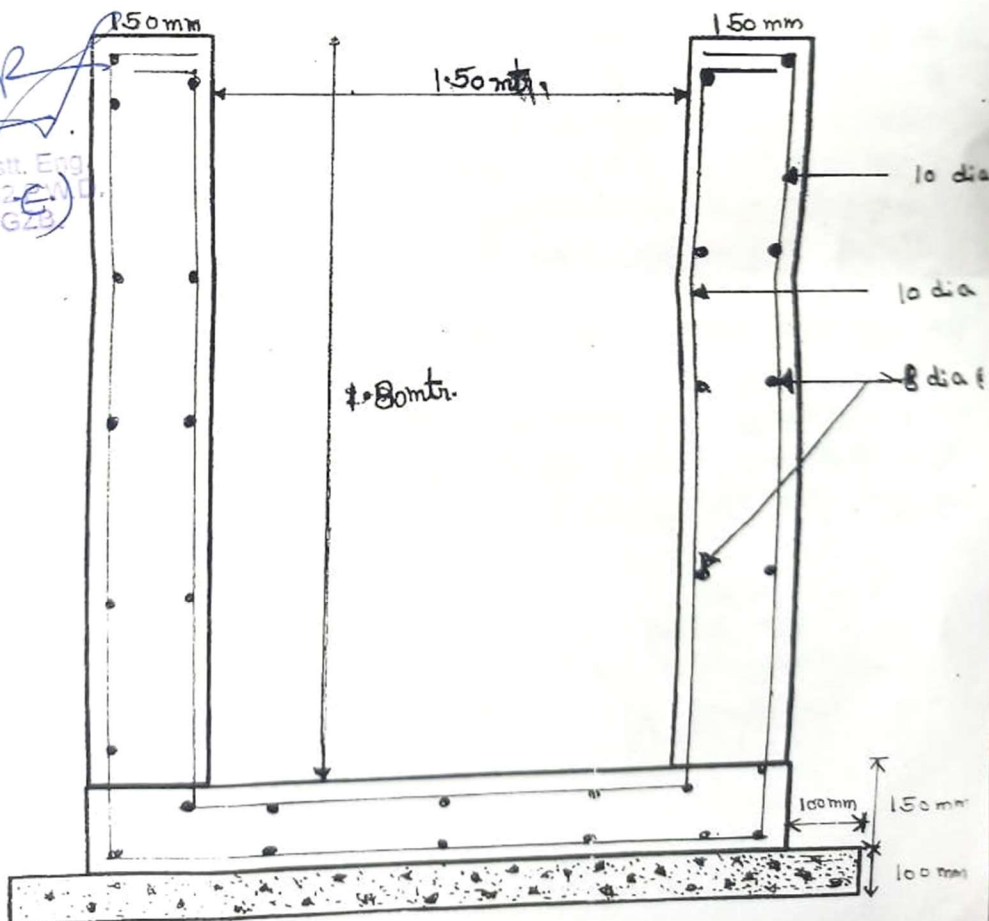

Assistant Engineer-VI
Construction Division-2 P.W.D
Ghaziabad