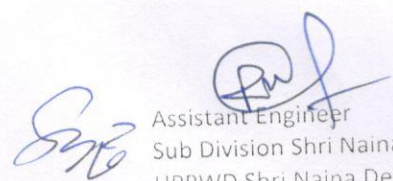
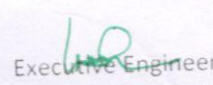

MUCK MANAGEMENT PLAN

FULL Title of the Project: - C/O Link Road from Bassi -Ghwandal KM O/000-6/00
(SH: - Formation cutting and removal of formation deficiency)

	Total Qty of Muck being produced	5424.24 m ³
1	Deduction for useful stone as required under the clause of agreement.	542.42 m ³
2	Balance quantity of muck = 5424.24 -542.42	4881.82 m ³
3	Add Qty. available on site (With Swell factor @ 40% on 2)	1952.73 m ³
	Total Loose qty at site = 2+3 (A)	6834.55 m ³
	Muck to be used	
4	Muck required for construction of proposed road on the analogy of half cutting and half filling @ 25 % of (A)	1708.63 m ³
5	Muck required for the leveling of proposed road @ 15 % (A)	1025.18 m ³
6(i)	Muck used for Kharanja Soling and binding material (GSB)	449.87 m ³
(ii)	Muck used for Back filling in R/Wall	263.08 m ³
(iii)	Muck used for berm filling	263.08 m ³
(iv)	Muck used for culvert filling	175.38 m ³
	Total of sub 6 i.e. (i+ii+iii+iv)	1151.41 m ³
	Loose qty of Sub head 6= 1151.41 x 40%	460.96 m ³
	Total loose quantity	1611.97 m ³
	Total muck to be used = 4+5+6	4345.78 m ³
	Muck / Debris left at site which required carriage to the proper dumping site duly recognized as per the instruction of Forest and Environment Ministry reinforced by various judgment of the Apex Court Govt. of India (A-B)	2488.77 m ³
	Say	2489.00 m ³

 Assistant Engineer
 Sub Division Shri Naina Devi Ji
 HPPWD Shri Naina Devi Ji

 Executive Engineer
 Bilaspur Division No-2
 HPPWD Bilaspur

99

PROFORMA NO-XV

STATEMENT SHOWING THE DUMPING PLACE AND QUANTITY OF MUCK/DEBRIS TO BE DUMPED WITH OTHER DETAIL CONSTRUCTION OF LINK ROAD from BASSI TO GHWANDAL KM 0/000-6/000 IN DISTT. BILASPUR (H.P.) Under NABARD PROPOSAL NO.FP/HP/ROAD/39140/2020

Sr No.	Name of the component from where muck/debris be produced	Total muck to be produced in m3	Qty. of muck/debris to be utilized locally m3	Qty. of muck/debris to be dumped on contract basis	Factor of increase in volume for dumping	Qty. of muck/debris to be dumped on basis of increase	Name of dumping place	Locating dumping place village	Distance of dumping place from near by river	*Area of dumping place with length and breadth in Meters	Area of forest land out of land in Co. 4	Height of muck/debris is dumped expected meter	Height of expected made up soil	Remarks /capacity of dumping sites
1	CONSTRUCTION OF LINK ROAD from BASSI TO GHWANDAL KM 0/000-6/000 IN DISTT. BILASPUR (H.P.) (SH:- Formation cutting and removal of formation deficiency) Under NABARD)	6834.55 M3 Including swell factor 40%	4345.78 m3	2489.0 m3	As per muck management plan attached	As per muck management plan attached @ 2489.0 M3	Ajnol	KH No 229/227	7.00 KM	0.015 Hect	12	13 0.00+5.00 2	14 0.00+5.00 2	15 Detail attached 2490.59 cum Page-
							Ajnol	KH No 229/227	6.00 KM	0.025 Hect		0.00+5.00 2	0.00+5.00 2	
							Ajnol	KH No 229/227	4.50 KM	0.015 Hect		0.00+5.00 2	0.00+5.00 2	
							Ajnol	KH No 229/227	2.5 KM	0.015 Hect		0.00+4.00 2	0.00+4.00 2	

Assistant Engineer
Sub Division Shri Naina Devi Ji
HPPWD Shri Naina Devi Ji

Executive Engineer
Bilaspur Division No-2
HPPWD Bilaspur

[Handwritten Signature]

200

PROPOSED DUMPING SITES

FULL Title of the Project: - C/O Link Road from BASSI TO GHWANDAL KM 0/000-6/000 (SH: - Formation cutting and removal of formation deficiency. (UNDER NABARD)

Muck / Debris left at site which required carriage to the proper dumping site duly recognized as per the instruction of Forest and Environment Ministry reinforced by various judgment of the Apex Court Govt. of India

Sr. No	Dumping Site No	RD No/ KH NO	Design Annexéd YES/NO	Capacity	Remarks
1	1	Ajnol 229/227	Yes	566.25 m3	
2	2	Ajnol 229/227	Yes	971.75 m3	
3	3	Ajnol 229/227	Yes	525.00 m3	
4	4	Ajnol 229/227	Yes	427.50 m3	
		TOTAL:-		2490.50 m3	

 Assistant Engineer
 Sub Division Shri Naina Devi Ji
 HPPWD Shri Naina Devi Ji

 Executive Engineer
 Bilaspur Division No-2
 HPPWD Bilaspur

6

101

DUMPING SITE DETAILS

NAME OF WORK:- Diversion of 3.6045 ha of forest land in favour of HPPWD for the construction of link road for the construction of link road from Bassi to Ghwandal km 0/000-6/000 within the jurisdiction of Bilaspur forest Division.

DUMPING SITE NO:- I

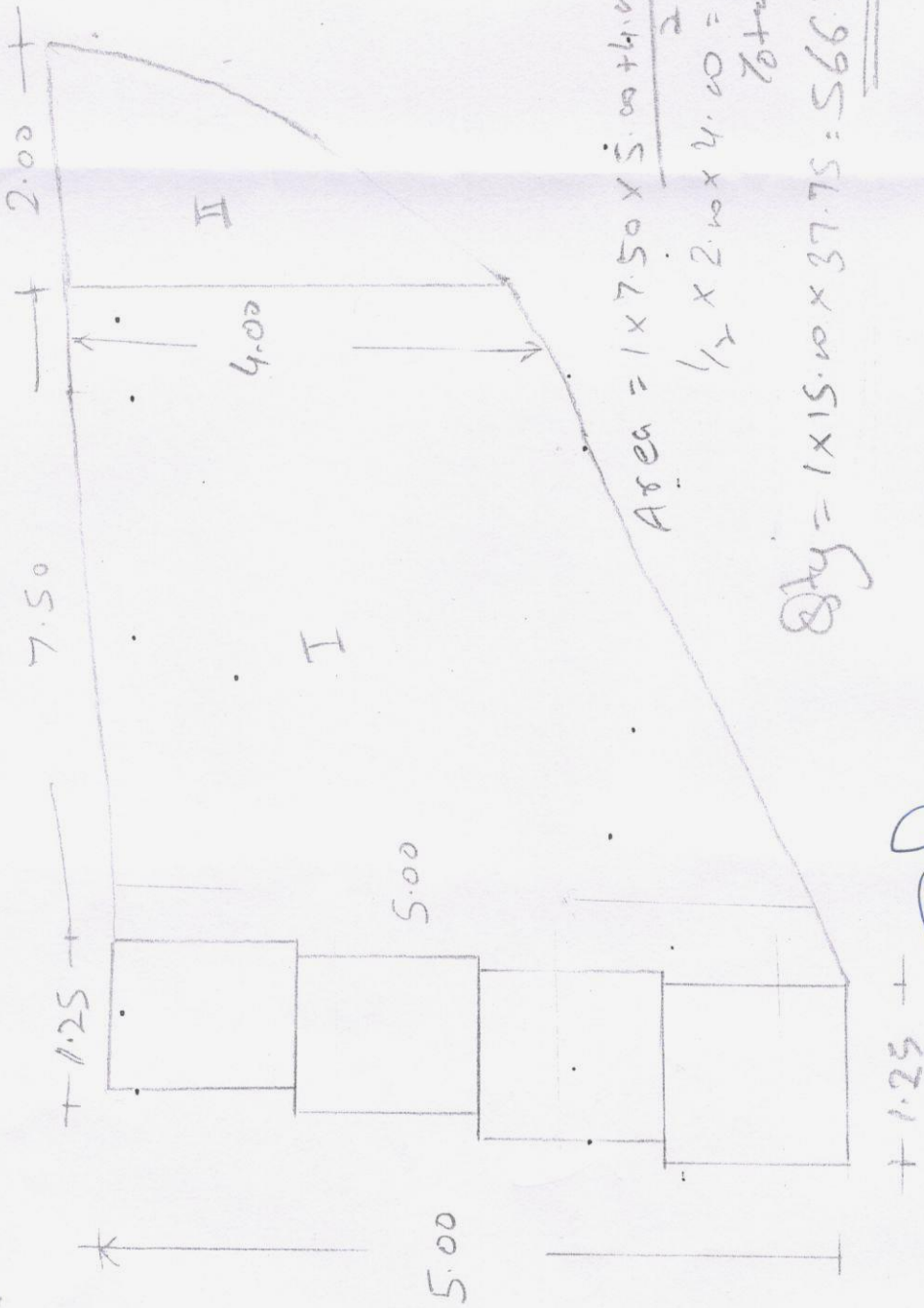

 ASSISTANT ENGINEER
 Shri Naina Devi Ji Sub-Division
 HP-PWD- Shri Naina Devi Ji

SDS

6

102

DUMPING SITE DETAILS

NAME OF WORK:- Diversion of 3.6045 ha of forest land in favour of HPPWD for the construction of link road for the construction of link road from Bassi to Ghwandal km 0/000-6/000 within the jurisdiction of Bilaspur forest Division.

DUMPING SITE NO:- 2

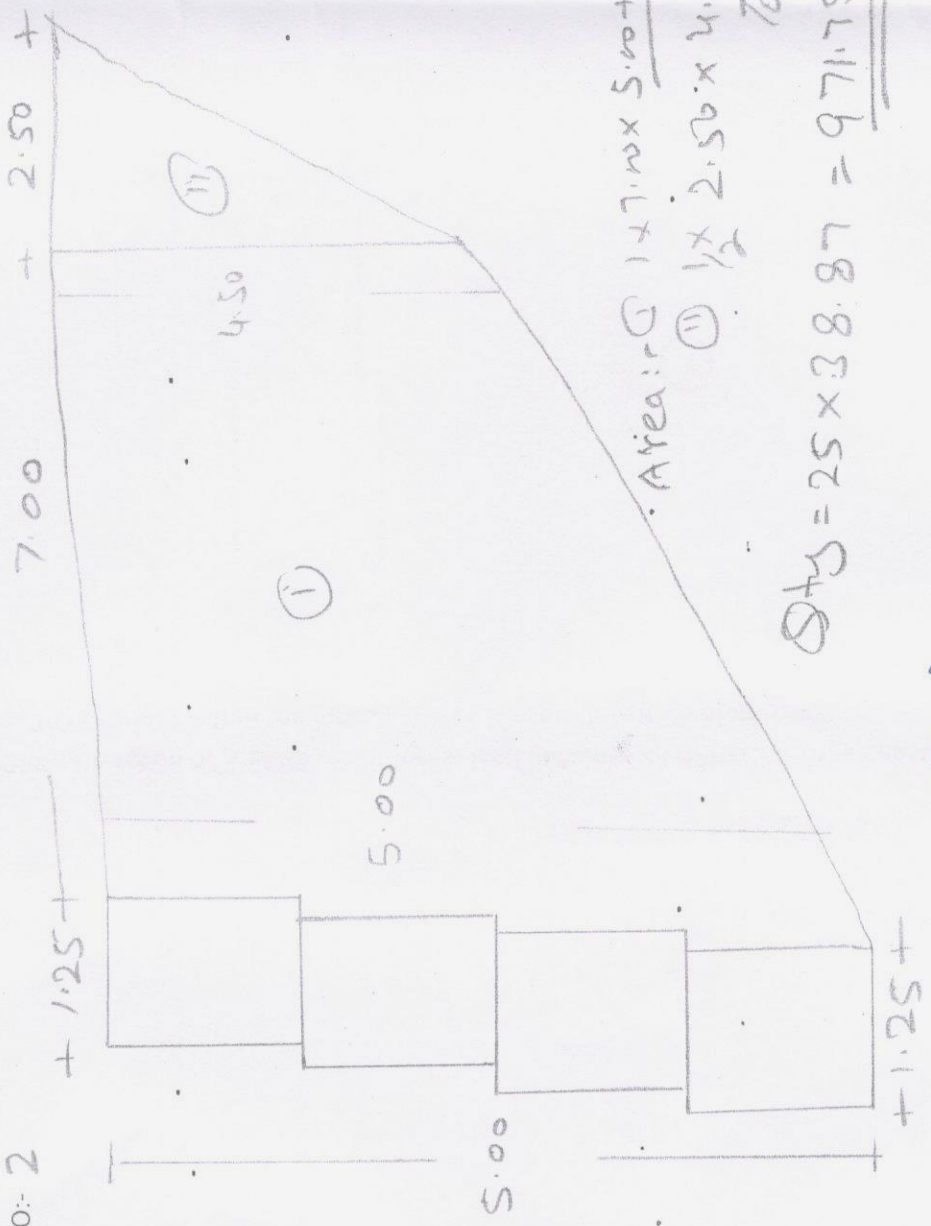

Area: I $\frac{1}{2} \times 7.00 \times 5.00 + 4.50 = 33.25 \text{ m}^2$
 II $\frac{1}{2} \times 2.50 \times 4.50 = 5.62 \text{ m}^2$
 Total = 38.87 m²

$38.87 \times 25 = 971.75 \text{ m}^3$

(Signature)
 ASSISTANT ENGINEER
 Shri Naina Devi Ji Sub-Division
 HP-PWD- Shri Naina Devi Ji

(Signature)

6

103

DUMPING SITE DETAILS

NAME OF WORK:- Diversion of 3.6045 ha of forest land in favour of HPPWD for the construction of link road for the construction of link road from Bassi to Ghwandal km 0/000-6/000 within the jurisdiction of Bilaspur forest Division.

DUMPING SITE NO:- 3

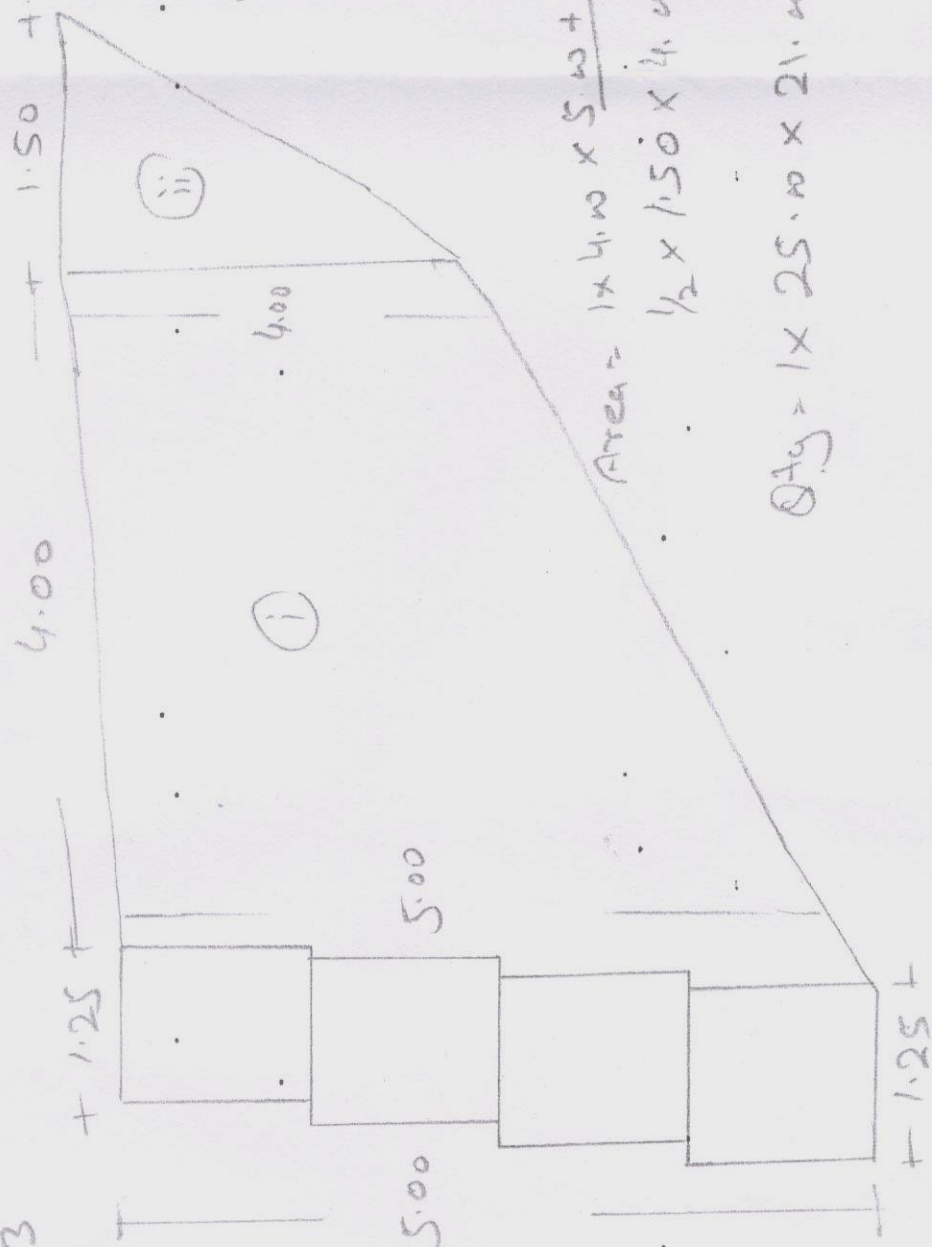

$$\text{Area} = 1 \times 4.00 \times 5.00 + \frac{4.00 \times 1.50 \times 4.00}{2} = 18.00 \text{ m}^2$$

$$\frac{1}{2} \times 1.50 \times 4.00 = 3.00 \text{ m}^2$$

$$\text{Total} = \frac{18.00 \text{ m}^2 + 3.00 \text{ m}^2}{2} = 21.00 \text{ m}^2$$

$$\text{Qty} = 1 \times 25.00 \times 21.00 = 525.00 \text{ m}^3$$

(Signature)
 Assistant Engineer

Shri Naina Devi Ji Sub-Division
 HP-PWD- Sani Maina Devi Ji

(Signature)

104

DUMPING SITE DETAILS

NAME OF WORK:- Diversion of 3.6645 ha of forest land in favour of HPPWD for the construction of link road for the construction of link road from Bassi to Ghwandal km 0/000-6/000 within the jurisdiction of Bilaspur forest Division.

DUMPING SITE NO:- 4

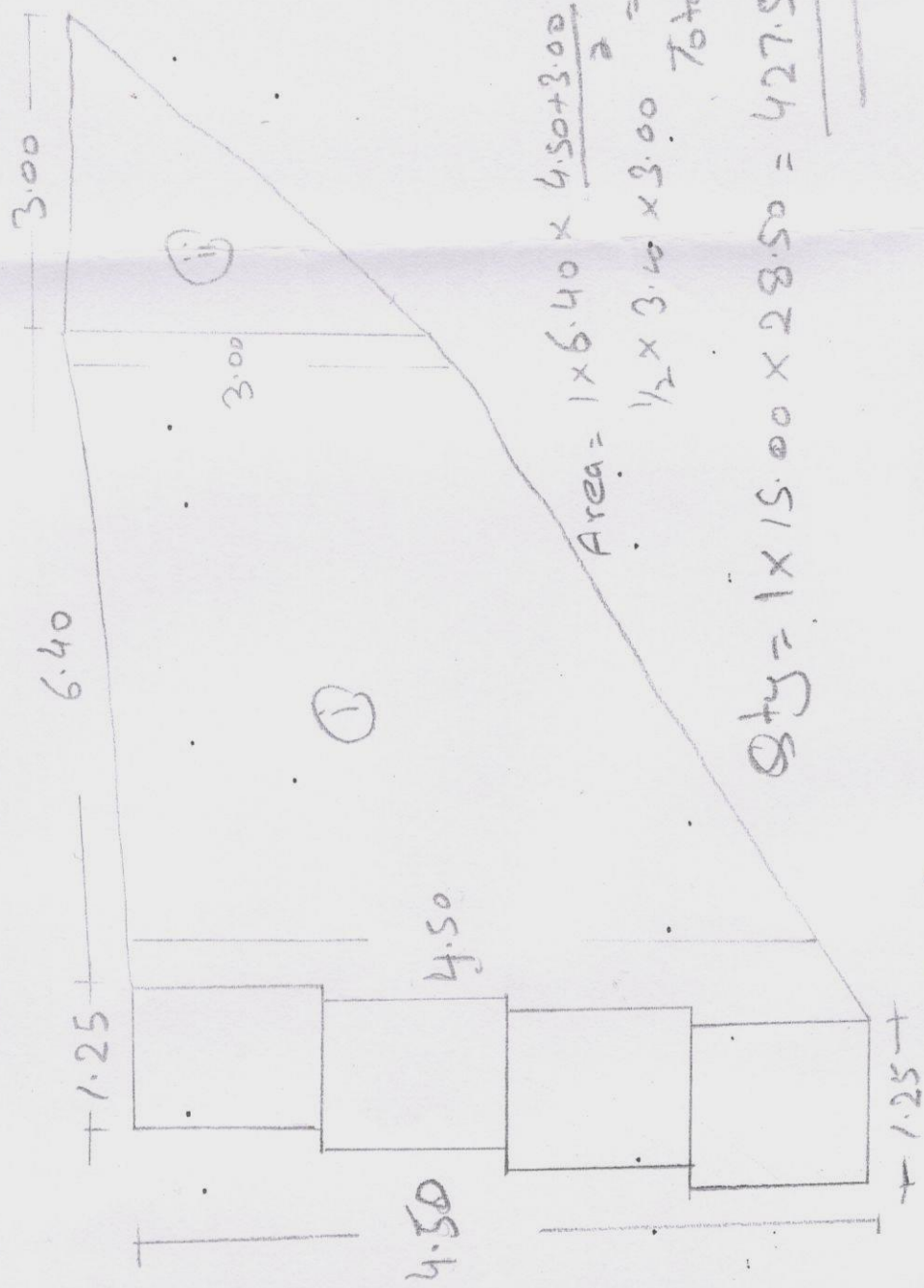

$$\text{Area} = 1 \times 6.40 \times \frac{4.50 + 3.00}{2} = 24.00 \text{ m}^2$$

$$\frac{1}{2} \times 3.40 \times 3.00 = 5.10$$

$$\text{Total} = \frac{24.00 + 5.10}{2} = 14.55 \text{ m}^2$$

$$\text{Qty} = 1 \times 15.00 \times 28.50 = 427.50 \text{ m}^3$$

RWJ
 ASSISTANT ENGINEER

Shri Naina Devi Ji Sub-Division
 H.P. PWD - Shri Naina Devi Ji

SDE

6