

To

The Divisional Forest Officer  
Forest Division Dehra, Kangra

**Sub:-** Diversion of 0.9918 Ha. of forest land in favour of Director of Technical Education, Vocational & Industrial Training H.P. Sundernagar, Distt. Mandi, HP for the construction of Govt. Polytechnic Jandour in Tehsil Jaswan Distt. Kangra, within the jurisdiction of Dehra Forest Division Kangra H.P. (Online No. FP/HP/Others/114095/2020).

Sir,

This with reference to the Nodal Office letter No. Ft. 48-5212/2020 (FCA) Dated 25<sup>th</sup> Aug. 2022 on the subject cited above. In this context this is to inform you that the EDS raised by your department has been attended as below:

| Sr. No. | Observations   | Reply   |
|---------|--|---|
| 1.      | The KML file of the proposed project has not been found uploaded against the column C(ii) (a) of online Part-I.  | Revised KML has been uploaded on the portal                     |
| 2.      | No component has been shown in the layout plan as placed at page no. 44. Dimension wise detail of component should be shown in the layout plan.  | Revised Layout Plan has been attached with the proposal folders |
| 3.      | The legal status of forest land is mentioned as 'Jungle Mehfuja gair Mehduda' in Part-II of the hard copy whereas UPF has been mentioned in online Part-II, necessary correction may be made in this regard.   | Pertains to DFO Office  |
| 4.      | Against column No. 1 (viii) the area is stated slightly vulnerable to the land slide, whereas, in online Part-II area is not vulnerable to land slide has been mentioned. Necessary correction may be made. In case the protection measures for protection of soil erosion be given. | Pertains to DFO Office  |
| 5.      | The classification of the trees is not matching with the detail as mentioned in online Part-II. Necessary correction in this regard may be made. Further, the calculation sheet of the cost of trees has not been found placed in the  | Pertains to DFO Office  |



|     |  |   |
|-----|--|---|
|     | proposal folders. The list of trees to be felled and not to be felled is required to be submitted separately.  |   |
| 6.  | The approximate distance of proposed site from the boundary of forests has been mentioned 500 mtrs. in Part-II of the hard copy whereas, 100 mtrs. has been mentioned in Part-II of online portal.   | Pertains to DFO Office  |
| 7.  | The detail of the CA area as mentioned in the Land Suitability Certificate as well as Checklist 17 is not matching with the detail mentioned in CA scheme, necessary correction may be made in this regard.  | Pertains to DFO Office  |
| 8.  | Part-IV and V are signed by user agency which is not required to be signed. Further, title on Part-IV & V is required to be mentioned at header.   | Revised Part-IV & V has been attached with the proposal folders       |
| 9.  | The muck management plan has not been found placed in the proposal folders. In case muck to be generated will be used in the construction area then the detail of muck to be generated and to be used is required to be given along with the undertaking regarding use of such muck is required to be given. | The muck management plan has been attached and uploaded on the portal |
| 10. | All uploaded and related documents in original/authenticated copies are required to be uploaded in one PDF file against additional information detail of Online Part-I.  | Combined PDF has been uploaded on the portal                          |



Principal

Govt. Model ITI Sansarpur terrace  
Distt. Kangra (H.P.)



# Muck Management Plan

| S<br>r. | Description  | Quantity     |                    |
|---------|--|--------------|--------------------|
|         |  |              | Cum<br>(A)         |
| 1       | Total Quantity of Muck being produced  | 42.00        |                    |
|         | Deduction for useful stone as required under the clause of agreement to be executed by the Contractor and Executive Engineer of Project. @ 30% | 12.60        |                    |
| 2       | Net Balance Quantity of Debris/Muck (1-2)  | 29.40        |                    |
| 3       | Quantity available on site with swell factor @ 40% of (A)  | 16.80        | Cum<br>(B)         |
|         | <b>Total Muck with Swell factor</b>  | <b>46.20</b> | <b>Cum<br/>(C)</b> |
|         | <b>Material /Muck to be used in Project:-</b>  |              |                    |
| (i)     | Deduction of material required for the construction of dry masonry wall/Edge wall @ 25% of (B)   | 11.55        |                    |
| (ii)    | Less for material/Muck required for construction of the proposed site for the construction of R /wall B/wall in filling work etc. @25% of (B)  | 11.55        |                    |
| (iii)   | iii) Less for material/muck required for the filling work on the analogy of half cutting half filling @ 50% (B)                                | 23.10        |                    |
|         | <b>Total :- (i)+(ii)+(iii)</b>   | <b>46.20</b> | <b>Cum<br/>(D)</b> |
|         | <b>Net material/Muck to dumped in dumping site (C-D) in Cum</b>  | <b>0.00</b>  |                    |
|         |  |              |                    |
|         |  |              |                    |

*Atul*  
Principal 6/11/2022

Govt. Model ITI Sansarpur Terrace  
Distt. Kangra (H.P.)



# Layout Plan of Govt. Polytechnic Jandaur in Jaswan Distt. Kangra H.P.

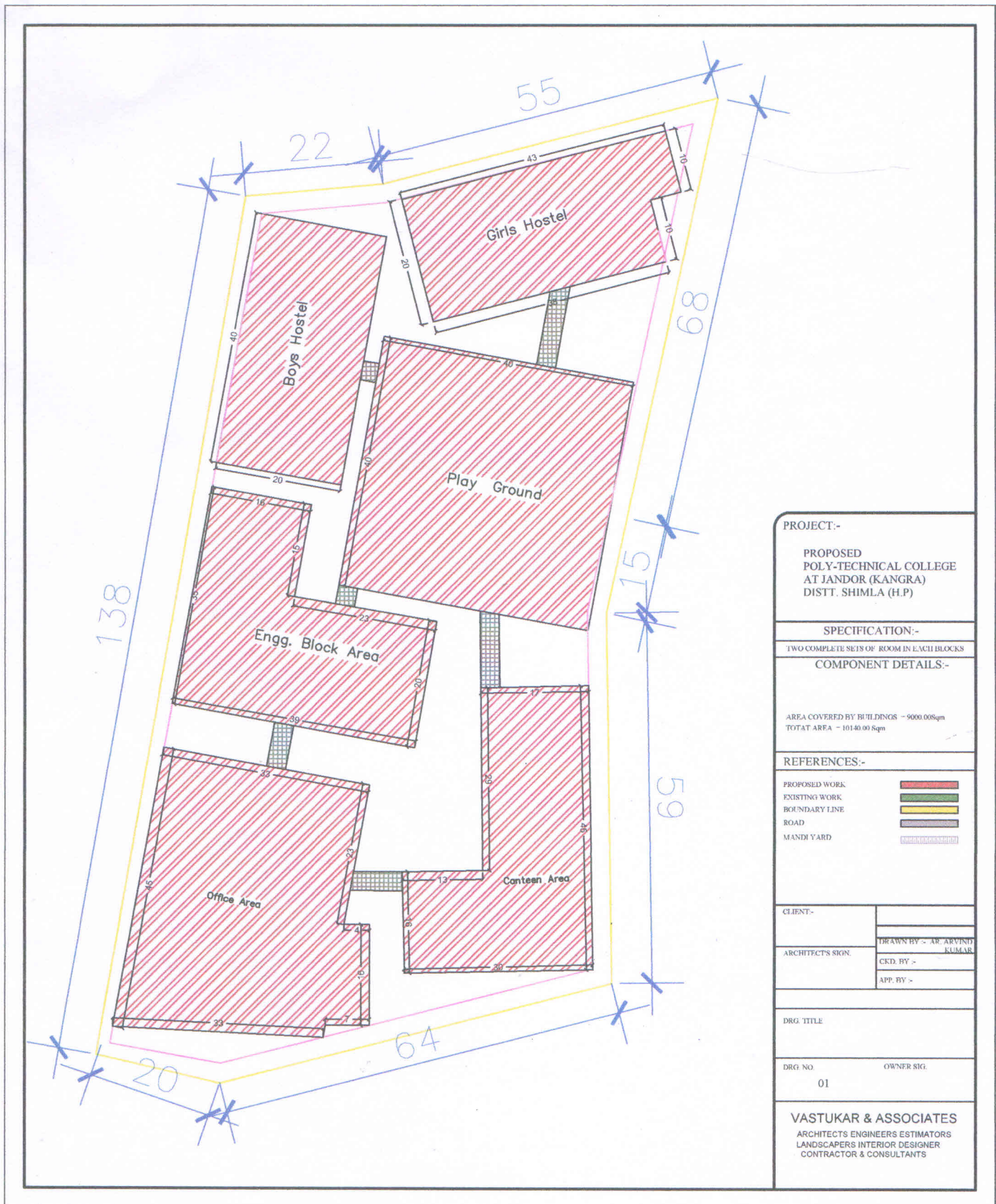

*Principal*  
Govt. Model ITI Sansarpur Terrace  
Distt. Kangra (Himachal Pradesh)