

कार्यालय अधिशासी अभियन्ता,
निर्माण खण्ड, लोक निर्माण विभाग, रानीखेत

दूरभाष :- 05966-220035 फ़ैक्स :- 05966-220035 ई-मेल cdpwdrkt@gmail.com
पत्रांक 712 /18सी. दिनांक, रानीखेत, 26-3-2018

सेवा में,

प्रभागीय वनाधिकारी, अल्मोड़ा
वन प्रभाग, अल्मोड़ा।

विषय :- पनघट-गुलोली से अम्याड़ी की ओर मोटर मार्ग के वन भूमि हस्तान्तरण के सम्बन्ध में। (प्रस्ताव सं. 15358/2016)

संदर्भ :- आपका पत्रांक मैमों/12-1(2) दिनांक 04.01.2018।

उपरोक्त विषयक संदर्भित पत्र के क्रम में आपको अवगत कराना है कि आप द्वारा उपरोक्त मोटर मार्ग के वन भूमि हस्तान्तरण प्रस्ताव में आन लाईन द्वारा आपत्तियों में लौटाया गया था। जिसकी आख्या विन्दुवार निम्नवत है:-

1	Short Narrative of the project does not provide adequate information about project in A-1(iii) Part-I.	The short narrative of the project is attached in online para A-1
2	The State Govt. may uploaded revised geo-referenced digital map of area proposed for diversion showing coordinate on 200-300m and of every turn of the proposed road authenticated by DFO at para C (iv) online Part-I.	Revised geo reference digital map is attached in online para I
3	The employment generation detail at para E (ii) appears to be incorrect. The State Govt. may review the same and provide correct details in online portal.	The correct employment detail is submitted in online part I para E II
4	The State Govt. may review the information provided in Para 5 of online Part II because no reserve forest is affected in the proposal as per the information is provided in online PartII and do necessary correction if required.	
5	The plantatio scheme of 300 plants may be uploaded at para 13 (ii) online Part II.	
6	The following documents in hard Copy are need to be uploaded in this s office: a. Geo- referenced digital map of area proposed for division dully authenticated by DFO as per the point-2 above. b. The original /attested copy of SIR carried out by DFO. c. Original/attested copy of Part I, II, III, IV and V. d. Original/attested copy of NPV calculation uploaded as an additional document in online Part II. e. Original/ attested copy of plantation scheme of 300 trees.	The hard copy of proposal containing original document already submitted to nodal office Deheradun. vide this office letter no.1751/18 C dated 17-08-2017.(Letter Atteched)

अधिशासी अभियन्ता,
निर्माण खण्ड, लोक निर्माण विभाग,
रानीखेत
26/3/18

योजना का नाम:-राजीव गांधी मोटर मार्ग से पनघट से गुजाली होते हुए अम्बाला की ओर लिंक मोटर मार्ग का नव निर्माण

नियोजित क्षेत्र का नक्शा

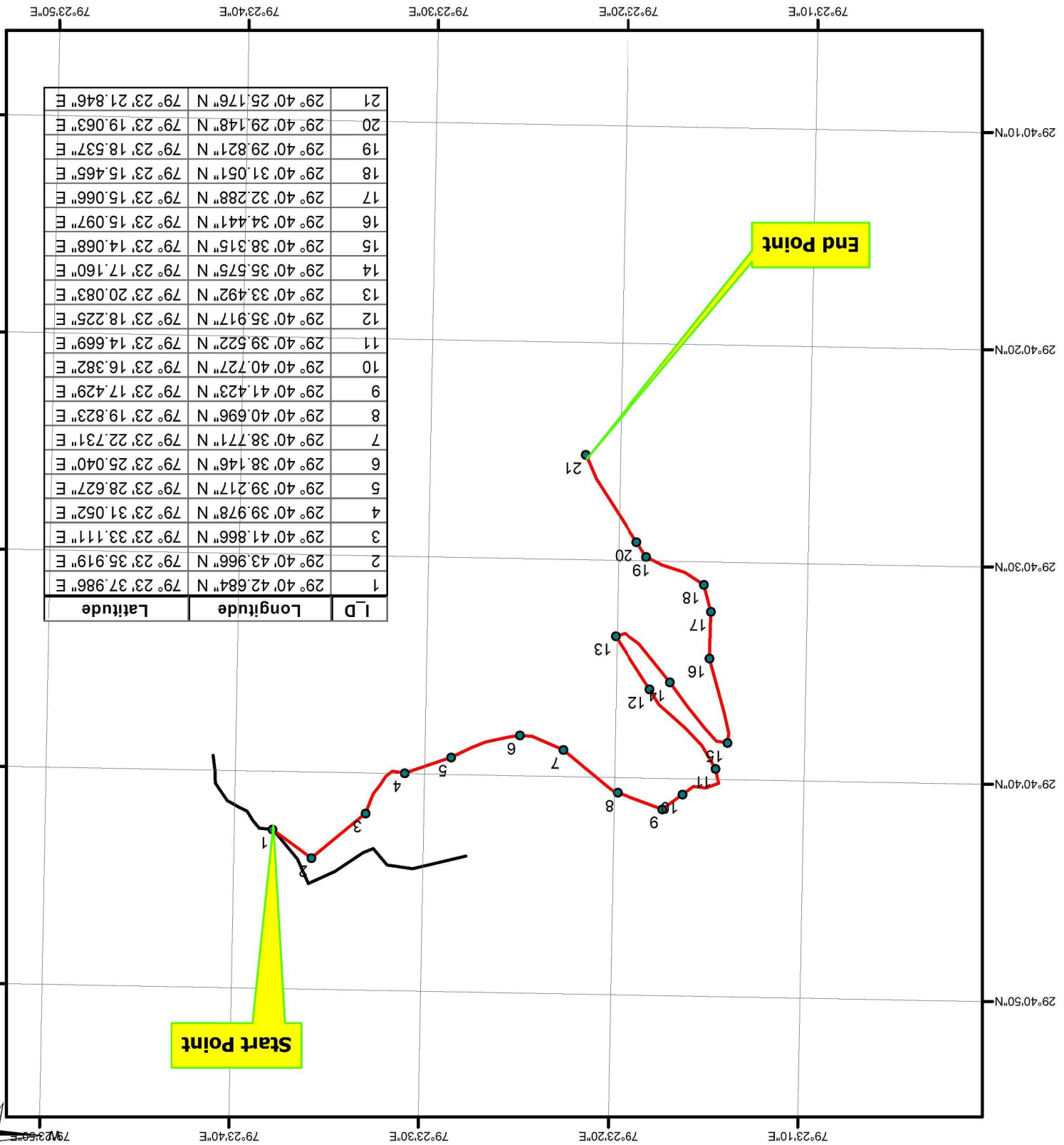
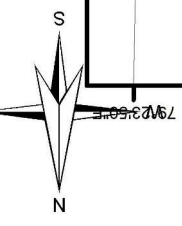

0.04 0.09 0.19 0.285 Kilometers

●

GPS

—

Main Alignment

—

Existing Motor Road

ID	Longitude	Latitude
1	79° 23' 42.684" N	79° 23' 37.986" E
2	79° 23' 43.966" N	79° 23' 35.919" E
3	79° 23' 41.866" N	79° 23' 33.111" E
4	79° 40' 39.978" N	79° 23' 31.052" E
5	79° 40' 39.217" N	79° 23' 28.627" E
6	79° 40' 38.146" N	79° 23' 25.040" E
7	79° 40' 38.771" N	79° 23' 22.731" E
8	79° 40' 40.696" N	79° 23' 19.823" E
9	79° 40' 41.423" N	79° 23' 17.429" E
10	79° 40' 40.727" N	79° 23' 16.382" E
11	79° 40' 39.522" N	79° 23' 14.669" E
12	79° 40' 35.917" N	79° 23' 18.225" E
13	79° 40' 33.492" N	79° 23' 20.083" E
14	79° 40' 35.575" N	79° 23' 17.160" E
15	79° 40' 38.315" N	79° 23' 14.068" E
16	79° 40' 34.441" N	79° 23' 15.097" E
17	79° 40' 32.288" N	79° 23' 15.066" E
18	79° 40' 31.051" N	79° 23' 15.465" E
19	79° 40' 29.821" N	79° 23' 18.537" E
20	79° 40' 29.148" N	79° 23' 19.063" E
21	79° 40' 25.176" N	79° 23' 21.846" E

राजीव गांधी मोटर मार्ग
पनघट से गुजाली होते हुए अम्बाला की ओर लिंक मोटर मार्ग का नव निर्माण