

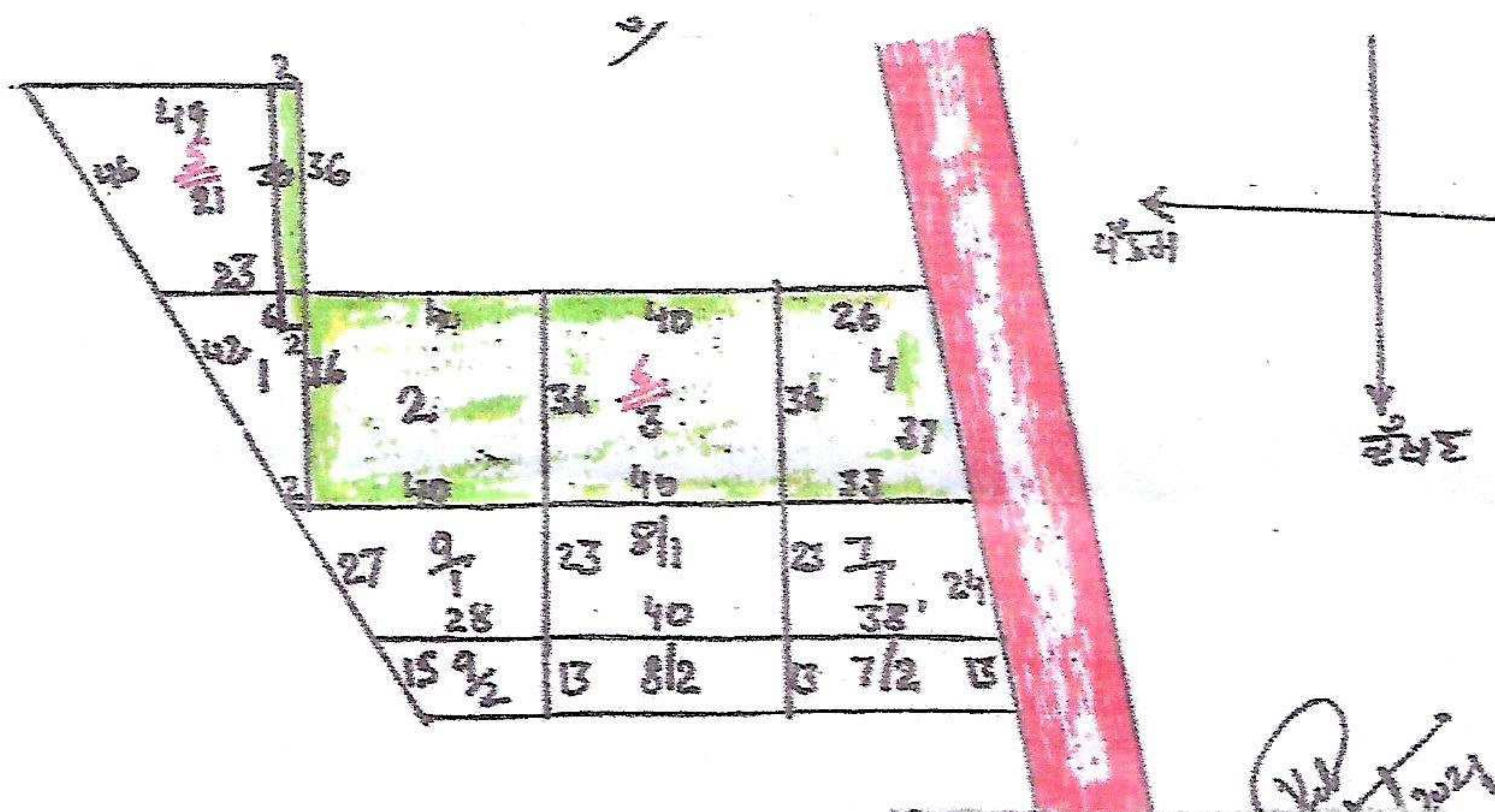

Sir,

It is requested that according your order the possession of the applicant is inspected at the spot. The applicant is in possession of the coloured in the site plan. It is situated on Sunam-Chhajli Road. The applicant Firm M/s J.RG Laminates Pvt. Ltd. owner in possession at the spot in Khasra Nos. 5//21min(0-8) & Khasra Nos. 6//3(8-0) & Khasra Nos. 6//1/1(1-10) 6//2(8-0) 6//4(5-18) 6//7/1(4-15) 6//9/1(3-13) Total 23 Kanal 16 Marla to the extent of 279-1/3/476 share i.e. 13 Kanal 19-1/3 Marla Total 22 Kanal 7-1/3 Marla situated in are Village Chhajli B. The applicant is owner and in possession as co-sharer in the total Khata. But the applicant is in possession in the Khasra Nos. shown in the site plan in green color.

Khasra Nos. 6//2(8-0) 3(8-0) 4(5-18) 21min(0-8) & 1min(0-1-1/3)



Sd/- & Date

9-9-2021

Sd/- & Stamp

For JRG Laminates Pvt.Ltd.

Director

Sd/- & Stamp

Tehsildar

Sunam Udham Singh Wala

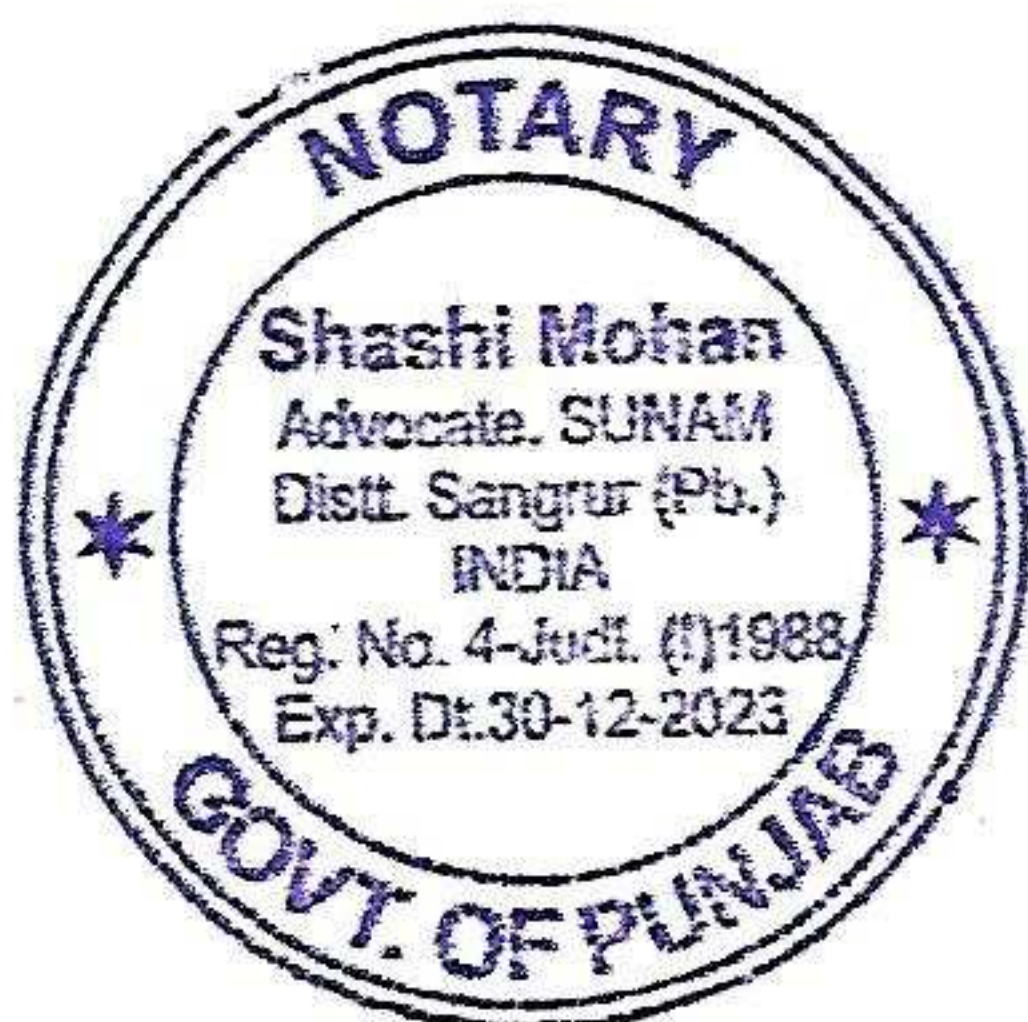

For JRG Laminates Pvt. Ltd.

Mohish
Director

True Translation from *Punjabi*

Into *English* language is attested

Shashi Mohan