

GEOREFERENCED MAP OF PROPOSED EQUIVALANT PRIVATE LAND FOR COMPENSATORY AFFORESTATION (CA) PLANTATION AT VILLAGE:- BHANGHAKALA, IN DISTRICT:- BALRAMPUR, AGAINST PROPOSED RESERVED FOREST LAND TO BE DIVERTED FOR CONSTRUCTION OF RAPTI MAIN CANAL IN FOREST LAND BETWEEN KM. 71.4900 TO 72.300 KM, IN TEHSIL:- TULSI PUR, DISTRICT:- BALRAMPUR (UTTAR PRADESH)

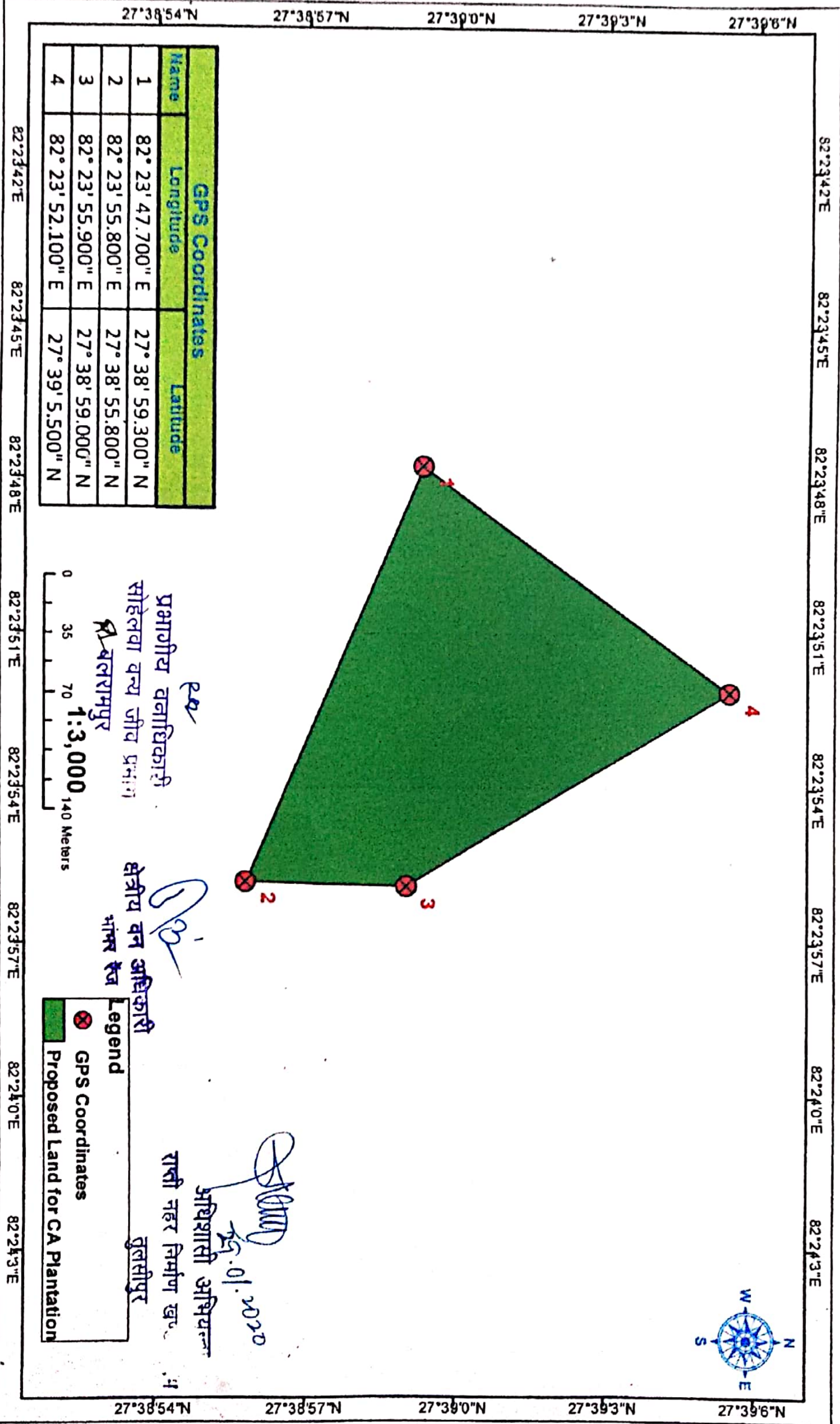

GPS Coordinates		
Name	Longitude	Latitude
1	82° 23' 47.700" E	27° 38' 59.300" N
2	82° 23' 55.800" E	27° 38' 55.800" N
3	82° 23' 55.900" E	27° 38' 59.000" N
4	82° 23' 52.100" E	27° 39' 5.500" N

प्रभागीय वनाधिकारी
 सोहेलवा वन्य जीव प्रभाग
 बलरामपुर

क्षेत्रीय वन अधिकारी
 भांवर ख
 राप्ती नहर निर्माण खा.
 तुलसीपुर

25.01.2020

Legend	
	GPS Coordinates
	Proposed Land for CA Plantation

27°38'54"N 27°38'57"N 27°39'0"N 27°39'3"N 27°39'6"N
 82°23'42"E 82°23'45"E 82°23'48"E 82°23'51"E 82°23'54"E 82°23'57"E 82°24'0"E 82°24'3"E
 0 35 70 140 Meters
 1:3,000
 W N
 S E