



CCL

(A Miniratna Category-I Company)



CENTRAL COALFIELDS LIMITED

(A Subsidiary of Coal India Limited)

(A Miniratna Category-I Company)

**OFFICE OF THE PROJECT OFFICER
MAGADH OCP, MAGADH-SANGHMITRA
AREA, AVANTIKA, VILL-KUNDI, PO-
SARADHU, DIST:- CHATRA**

E-mail ID: pomagadhms@gmail.com

Ref No: PO(Magadh OCP)/MRS/2023-24/ 3871

Date:- 12.03.2024

To
The Divisional Forest Officer
Latehar Forest Division
Latehar

The Divisional Forest Officer
Chatra South Forest Division
Chatra

Sub: -Request for Processing of Forest Diversion application of Magadh Railway Siding (121.29 Ha) in Parivesh 1.0 Portal while considering degraded forest land as compensatory afforestation (CA) land.

Ref No: -File No: - FP/JH/Rail/47332 /2020

Respected Sir,

This is with reference to the Forest Diversion proposal, proposal no FP/JH/Rail/47332 /2020. We hereby submit the following details regarding the subject matter.

Magadh OCP which is a pioneer project of Central Coalfields Limited (CCL), is presently operating at the project capacity of 20MT per annum. Coal India Board has already approved the capacity expansion of Magadh OCP to the tune of 51MY per annum to meet the increasing demand of coal in the Nation. However, capacity cannot be expanded without the construction of modern evacuation systems like Railway Siding, CHP, and Rapid Loading Systems.

It is submitted that the subject proposal for diversion of forest land is meant to construct environmental compliments evacuation infrastructure i.e. Railway Siding with a rapid loading system. This plan is the part of ambitious First Mile Connectivity (FMC) policy of the Ministry of Coal, which is regularly monitored by the PMO office also to develop environmentally friendly practices. The construction of Railway Siding with silo has a projected capital investment of Rs. 402.10 Crore for the environment-compliant activity.

It may be brought to your kind knowledge that we have submitted our FDP(Form-A) proposal on 21st July 2020, it was accepted by PCCF nodal on 31st August 2020 and forwarded to Divisional Forest Office on 05th November 2020. Further, our proposal was further accepted by DFO, Latehar and Subsequently, the EDS raised by DFO Latehar Office on 25th January 2020 which is before enactment of Forest (Conservation) Rules 2022.

12.03.24
SADALA SATYANARAYAN
PROJECT OFFICER
MAGADH OCP

All the EDS compliances have already been completed & complied and now the proposal is ready for onward submission for further processing by processing authority.

As per the compliance of EDS, the finalization and certification of degraded forest land of 121.29 Ha has been completed which is twice in the extent of forest land proposed for diversion of 242.58 Ha (Notified Forest Land 242.58 Ha).

As per the new provisions & guidelines on Compensatory Afforestation, user agency is required to provide land which is neither notified as forest under Forest Act 1927 or any other law nor managed as forest by the forest department which shall also bear the cost of raising Compensatory Afforestation over such land.

In this regard, it is humbly submitted that considering our FC Stage-I proposal is at very advance stage of processing by the processing authority, may be considered for further processing, examining and recommendation for onward submission with presently identified and certified degraded forest land earmarked for Compensatory Afforestation. Further, we shall provide matching non forest land for Compensatory Afforestation and comply to the conditions of Compensatory Afforestation as per the provisions if the grant is not accorded.

In addition to above, action and process for identification of compensatory afforestation land (non-forest land) in parallel to processing of our proposal for further processing & examining would save time as the requirement and shall be complied before commissioning of work. As, we are already in delay in obtaining the FC Stage-I considering our proposal acceptance at PCCF Nodal on **31st August 2020** & EDS received from DFO, Latehar on **25th January 2020**.

In view of above subject proposals criticality, for faster development & operation of Magadh OCP we earnestly request your good office for kind consideration of our proposal for onward submission for further processing, examining and recommendation with presently identified and certified degraded forest land earmarked for Compensatory Afforestation.

Further, project proponent undertakes to comply & abide by conditions of Forest (Conservation) Rules 2022 including the provisions of guideline issued on Aug 2023 regarding Compensatory Afforestation for providing matching Non-Forest for Compensatory Afforestation, if required before commissioning of work, undertaking regarding this is also attached herewith online and hardcopy of proposal.

It is requested for kind consideration for onward submission for further processing, examining and recommendation of our proposal please.

Yours Faithfully

Project officer
Magadh OCP
SADALA SATYANARAYAN
PROJECT OFFICER
MAGADH OCP.



CENTRAL COALFIELDS LIMITED
(A Subsidiary of Coal India Limited)
(A Miniratna Category- I Company)
OFFICE OF THE PROJECT OFFICER
MAGADH OCP, MAGADH-SANGHMITRA
AREA, AVANTIKA, VILL-KUNDI, PO-
SARADHU, DIST:- CHATRA
E-mail ID: pomagadhms@gmail.com

Undertaking For Compensatory Afforestation (CA) **Land**

Magadh OCP, Magadh-Sanghmitra Area CCL undertake that if and when required, equivalent area of non- forest land shall be provided as CA Land instead of double degraded forest land for Compensatory Afforestation before start of any work at Magadh Railway Siding.

28.02.24
Project Officer
Magadh OCP
SADALA SATYANARAYAN
PROJECT OFFICER
MAGADH OCP

खण्ड क्रमांक नाम और नम्बर
कलेक्टरेट रजिस्ट्रार नम्बर ४९

Bailu

पाना जालुगाथ नम्बर १०५

पत्तानः देह्री

मशहूर नाम बालू

जिला पलामू

मिलान चादर नम्बर ६

पैमाना: तहसिल की मीन ११ इंच
मस २८१२ - २५ बरस

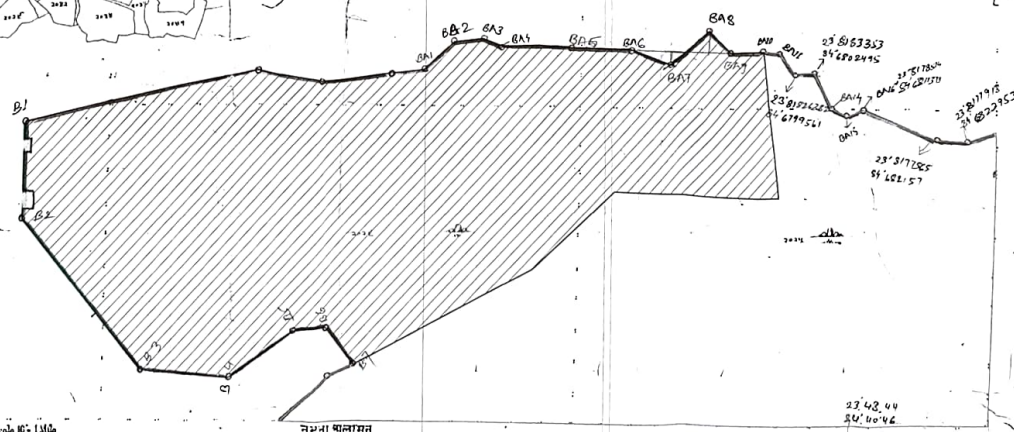
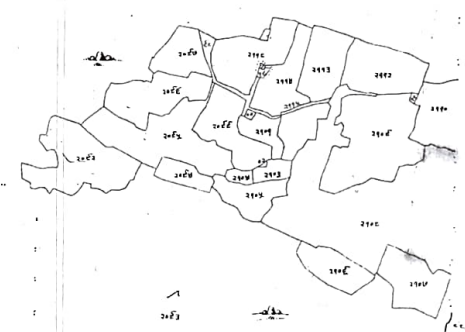
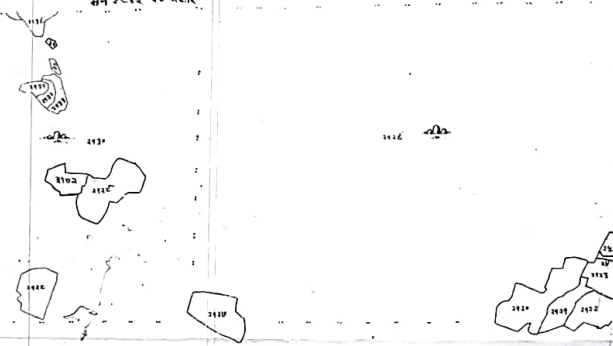
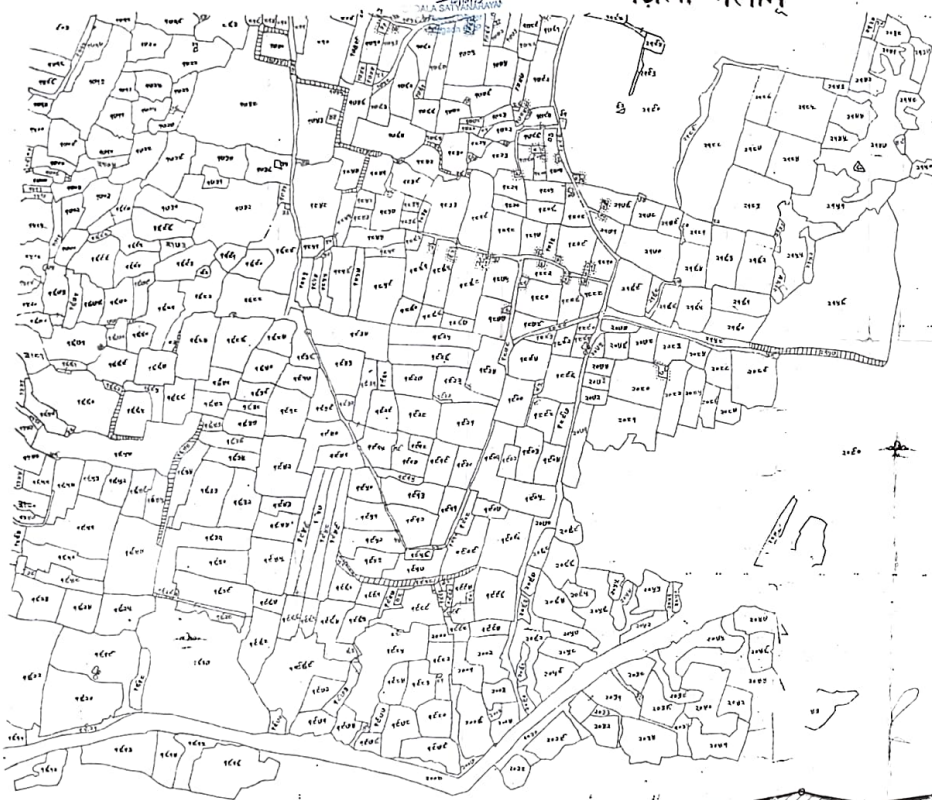

मिलान चादर नम्बर ५

मिलान चादर नम्बर ४

कराया
नला

नाट
बाद हाथ कायदा प्रमाण चादर नम्बर ५

Scale 1:1000

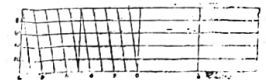

१	पहिले नाम के जिनका जमीन मालिकाना
२	मय नाम के जिनका जमीन मालिकाना
३	मय नाम के जिनका जमीन मालिकाना
४	मय नाम के जिनका जमीन मालिकाना

मिलान चादर

मिलान चादर नम्बर १०

Printed and Published at

Printed and Published at

Printed and Published at

खेती जमीन का नाम
कानूनी रजिस्ट्रार नम्बर
मशहूर नाम बालू चार नम्बर ६

बालू चार नम्बर ६
तमाम १००
समान: दोही
सप्या
जिना पलामू

मैसानी बालू चार नम्बर ६
सन् १८२३-२४ ईस्वी

SADALA SATYANARAYAN
Project Officer
Magadh CDP

मैसानी बालू चार नम्बर ६

मैसानी बालू चार नम्बर ६

Net Area- 21.43 Ha.
2376-37-00
2375-37-60
2374-34-80
2373-70-00
2353-71-00
2352-03-00
2378-05-00
2322-00-75
411-13

Total no. of documents
145
Total area 4 Ha.
411-13

Scale 10" = 1 Mile
666.6

मैसानी बालू चार नम्बर ६
Superintendent of Survey



मैसानी बालू चार नम्बर ६
मैसानी बालू चार नम्बर ६

मैसानी बालू चार नम्बर ६
मैसानी बालू चार नम्बर ६

1	2	3	4	5	6	7	8	9	10	11	12	13	14	15	16	17	18	19	20	21	22	23	24	25	26	27	28	29	30	31	32	33	34	35	36	37	38	39	40	41	42	43	44	45	46	47	48	49	50	51	52	53	54	55	56	57	58	59	60	61	62	63	64	65	66	67	68	69	70	71	72	73	74	75	76	77	78	79	80	81	82	83	84	85	86	87	88	89	90	91	92	93	94	95	96	97	98	99	100
---	---	---	---	---	---	---	---	---	----	----	----	----	----	----	----	----	----	----	----	----	----	----	----	----	----	----	----	----	----	----	----	----	----	----	----	----	----	----	----	----	----	----	----	----	----	----	----	----	----	----	----	----	----	----	----	----	----	----	----	----	----	----	----	----	----	----	----	----	----	----	----	----	----	----	----	----	----	----	----	----	----	----	----	----	----	----	----	----	----	----	----	----	----	----	----	----	----	----	-----

मैसानी बालू चार नम्बर ६

286
2581

Largari

रेवेन्यू सर्वे नाम और नम्बर

कालेक्टरी रजिस्ट्रार नम्बर ४२६

मशहूर नाम लगार्डी

चादर नम्बर २

थाना बालुसाथ

नम्बर १३६

परगना: टेड़ा

तप्पा

ज़िला पलामू

पैमाना बलिसाव फी मील २६ इंच

सन १८९२-१४ ईस्वी

SADALA SATYANARAYAN
Project Officer
Magadh OCP

मुकरो

५४
३४
३००
६९८

समुदाय आलायत

१	यह निशान फी लेखारिज संयोजन	अंग
२	सकान में महल	अंग
३	पक्का कुवा	अंग
४	कच्चा कुवा	अंग

चोदान

लोहसीनी उर्फ तुलबुल

Plot in Demarcated area

378-7.18
378-6.64
388-18.34
389-16.50
397-3.04
430-17.62
435-23.28
92.56

Total no of boundary pillars-27
Total area of the forest-92.56 aers.

Copy of the map showing the boundary of the forests notified as "Protected Forests" in village Largari
Balmuth No. 136 vide
Government Notification No. 666-R
dated 21.2.56

Divisional Forest Officer, Forest Survey Office
Forest Division, Forest Survey Office

Superintendent of Survey

Copied by
Amir

मतनाग

Scale 18" = 1 Mile

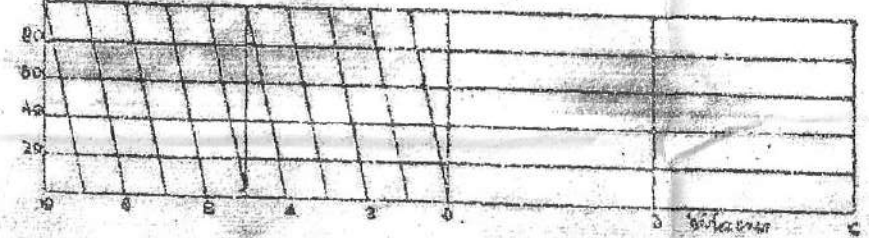

बिचलोदाग
थाना लातेहार
परगना: पलामू

Index to Sheet A

मुकरी

Largari

रेखनु नाम और नम्बर

कॉन्ट्रोल रजिस्ट्र नम्बर ४२६

मशहूर नाम लाराडी चादर नम्बर १

थाना लातेहार

नम्बर १३६

परगना: देडी

तप्पा

ज़िला पलामू

पैमाना बहिष्कार की मील १६ इंच

सन १९१३-१४ ईस्वी

SADALA SATYANARAYAN
Project Officer
Magadh OCP

नम्बर
४६
४८

नाम श्री मशहूर
सांहर देवस्थान
आ बादी खास

Made and Published Under The Authority of Government.

नमूना आलासत

१	यह निशान के लैन खासिजनमभाजायगा	२०१
२	मवान मे सहन	२०२
३	पक्का कुवा	२०३
४	रुक्का कुवा	२०४

Plot No.	Demarcated Area
1	25.8.6
11	17.8.7
14	12.5.0
15	12.6.6
17	10.8.6
26	9.5.0
263	4.8.6
264	14.3.4
278	7.8.1
279	19.0.0
280	11.5.0
282	8.3.8

154.04 ac.

Total no of boundary pillars
Total area of the forest 154.04 ac.

Certified that the green line shows
the boundary of the forests notified as
"Protected Forests" in village Largari
Baramahal Taluka No. 126...
Government notification No. 666...
dated ... 21.2.56

Divisional Forest Officer, Forest Settlement Officer
Baramahal Taluka

Corrected by
[Signature]

Scale 16" = 1 Mile

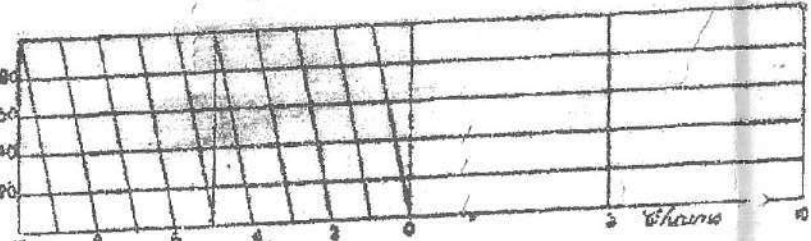

मतनारा

T. M. Bridge
Superintendent of Survey

Index to Sheet A

Made and Published Under The Authority of Government.

विचुलीदाग
याना नातेहार
पगान: पलामू

Sukri

खण्ड सन्त नाम और नम्बर
कलेकरी रजिस्ट्रार नम्बर
मशहूर नाम सुकरी चादर नम्बर १
याना बालुमाछ नम्बर १३५
पगान: टोड़ी
तप्पा
ज़िला पलामू
पैमाना बहिस्ताव फी मील १९ इंच
सन १९१३-१४ ईस्वी

SADALA SATYANARAYAN
Project Officer
Magadh OCP.

नम्बर १० नाम से मशहूर
और सुकरी टोली

सोतम

नमूना यानामात

१	गर्भानाचक	लिखित और नमूना यानामा	२-१
२	मकान नमूना		२-२
३	पठन कुवा		२-३
४	कछा कुवा		२-४

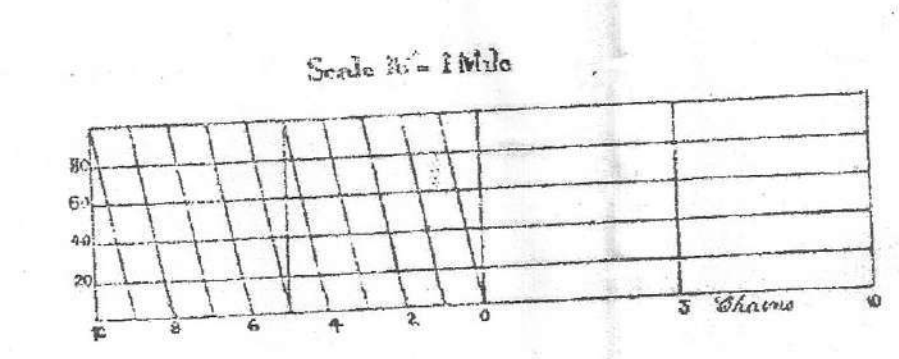

Plat no. dimaced area
1-35-66
2-5-36
13-5-50
44-0-75
04-12-30
05-17-25
06-25-38
07-5-00
132-00 Acres
Total no. of Bendaori Villages 48
Total Area of this forest 132-00 Acres
Balumath Forest No. 135 vide
21-2-58

Net Area- 26.09 Ha.

Net Area- 12.91 Ha.

Net Area- 14.17 Ha.

नागड़ी

Superintendent of Survey.

Prising (B)
R. L. Singhania

सिलान चादर नम्बर २

सिलान चादर नम्बर २



नमूना बालमाथ

१	यह निवाज ५ लेन खासिजसमभ्यजायमा	०-१
२	मनाज नैसहन	०-२
३	पका कुवा	०
४	कछा कुवा	०

Sukri

खैनु सवै नाम और नम्वर
कलेकरी रेजिस्ट्र नम्वर

मशहर नाम मुकरी बाहर नम्वर २

धाना बालमाथ नम्वर १३५

परान: टोडा

तप्पा

ज़िला पलामू

पैमाना बलिसाव फी मील १६ ईंच

सन १९१२-१४ ईस्वी

नाम श्री मशहर
टोला बाधा पथल टोली
टोला भंवर लया टोली
ब्यवादी खास

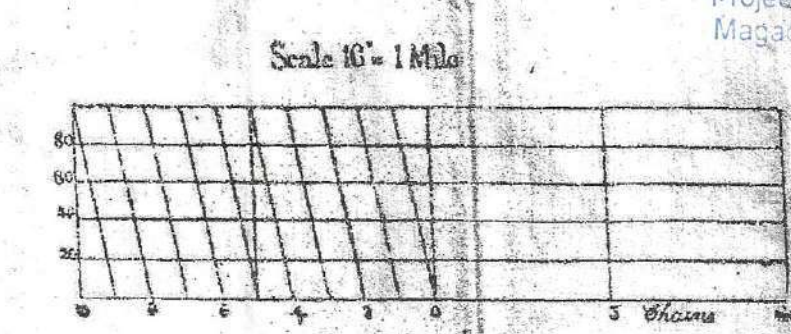

Made and Published Under The Authority of Government.

Plat no. ~~damaged~~ Area

232	8-00
233	6-00
235	15-30
236	20-00
237	22-50
238	15-00 15-00
239	12-70 2-70
240	13-00 13-00
243	1-43
244	17-00
245	0-42
<hr/>	
134.05 Acres	

Total no of Boudari Pillars 43
Total Area of the forest 134.05 Acres

It is noted that the green line shows the boundary of the forests notified as "Protected Forests" in village Sukri. Subordinate Thana No. 135 vide Government notification No. 666 dated 21.2.56

Divisional Forest Officer, Forest Settlement Officer
Sub-forest Division, Palamou | Latehas
R. L. Singh
Mishra

T. W. Bridge
Superintendent of Survey

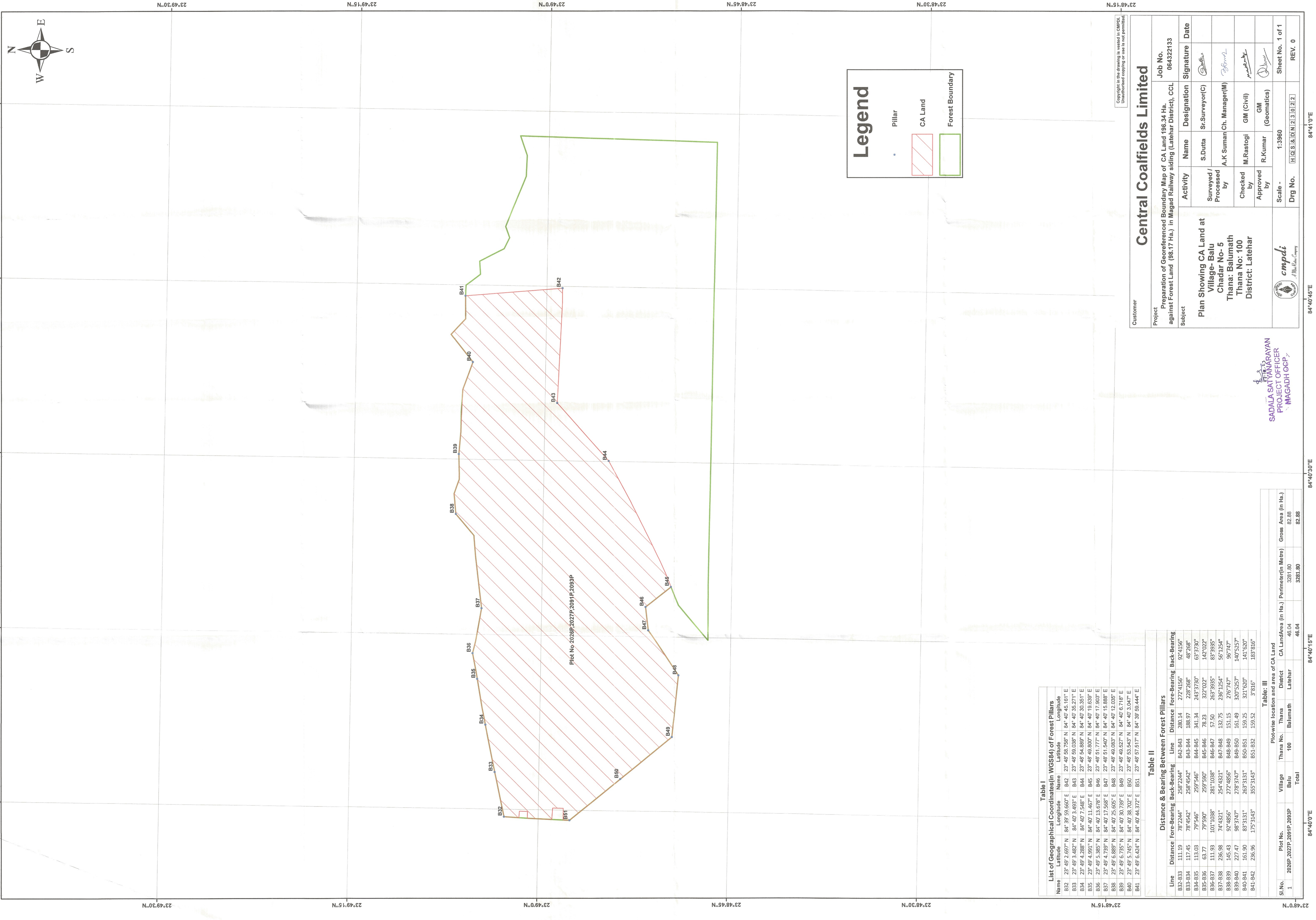

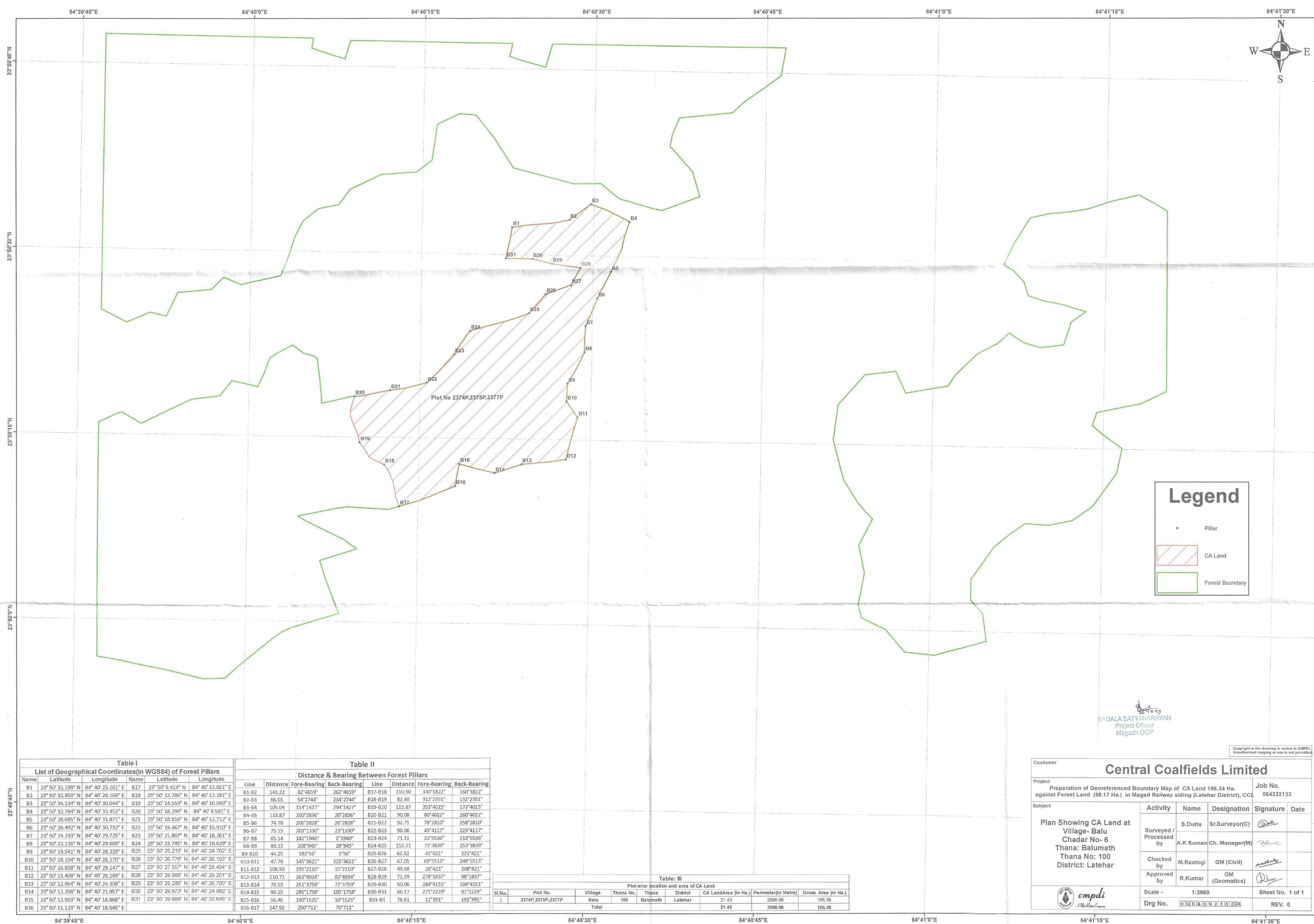

SADALA SATYANARAYAN
Project Officer
Magadh OCP

Copyright in the drawing is vested in CIMPDI.
Unauthorized copying or use is not permitted.

Customer					
Central Coalfields Limited					
Project Preparation of Georeferenced Boundary Map of CA Land 196.34 Ha. against Forest Land (98.17 Ha.) in Magad Railway siding (Latehar District), CCL					Job No. 064322133
Subject					
Plan Showing CA Land at Village- Balu Chadar No- 6 Thana: Balumath Thana No: 100 District: Latehar	Activity	Name	Designation	Signature	Date
	Surveyed / Processed by	S.Dutta	Sr.Surveyor(C)	<i>S.Dutta</i>	
	Checked by	A.K Suman	Ch. Manager(M)	<i>A.K Suman</i>	
	Approved by	M.Rastogi	GM (Civil)	<i>M.Rastogi</i>	
		R.Kumar	GM (Geomatics)	<i>R.Kumar</i>	
Scale -		1:3960		Sheet No. 1 of 1	
Drg No.		H Q S & Q N 2 3 Q 22A		REV. 0	



84°27'30"E

84°27'45"E

84°28'0"E

Table: III								
Plot-wise location and area of CA Land								
Sl.No.	Plot No.	Village	Thana No.	Thana	District	CA Land Area (in Ha.)	Perimeter (in Metre)	Gross Area (in Ha.)
1	397P,338P	Largari	139	Balumath	Latehar	4.54	848.80	37.46
Total						4.54	848.80	37.46



Table I

**List of Geographical Coordinates
(in WGS84) of Forest Pillars**

Name	Latitude	Longitude
L60	23° 48' 18.477" N	84° 27' 20.227" E
L61	23° 48' 21.343" N	84° 27' 24.146" E
L62	23° 48' 23.620" N	84° 27' 27.055" E
L63	23° 48' 20.965" N	84° 27' 29.985" E
L64	23° 48' 18.669" N	84° 27' 28.937" E
L65	23° 48' 16.059" N	84° 27' 27.952" E
L66	23° 48' 15.010" N	84° 27' 25.462" E
L67	23° 48' 15.393" N	84° 27' 20.265" E

Legend

• Pillar

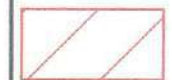

CA Land



Forest Boundary

SADALA SATYANARAYAN
Project Officer
Magadh OCP

Copyright in the drawing is vested in CMPDI.
Unauthorized copying or use is not permitted.

Table II

Distance & Bearing Between Forest Pillars

Line	Distance	Fore-Bearing	Back-Bearing
L60-L61	141.77	52°3226"	232°3226"
L61-L62	108.14	50°3842"	230°3842"
L62-L63	116.44	135°351"	315°351"
L63-L64	76.65	203°4827"	23°4827"
L64-L65	85.03	200°1025"	20°1025"
L65-L66	77.55	246°252"	66°252"
L66-L67	147.64	275°3617"	95°3617"
L67-L60	94.93	0°2250"	180°2250"

Customer

Central Coalfields Limited

Project

Preparation of Georeferenced Boundary Map of CA Land 196.34 Ha.
against Forest Land (98.17 Ha.) in Magadh Railway siding (Latehar District), CCL

Job No.

064322133

Subject

Plan Showing CA Land at
Village- Largari
Chadar No- 2
Thana: Balumath
Thana No: 139
District: Latehar

Activity	Name	Designation	Signature	Date
Surveyed / Processed by	S.Dutta	Sr.Surveyor(C)		
	A.K Suman	Ch. Manager(M)		
Checked by	M.Rastogi	GM (Civil)		
Approved by	R.Kumar	GM (Geomatics)		



Scale - 1:3960

Sheet No. 1 of 1

Drg No. HQS&DN23022C

REV. 0

84°27'30"E

84°27'45"E

23°48'15"N

23°48'0"N

23°47'45"N

23°48'15"N

23°48'0"N

23°47'45"N

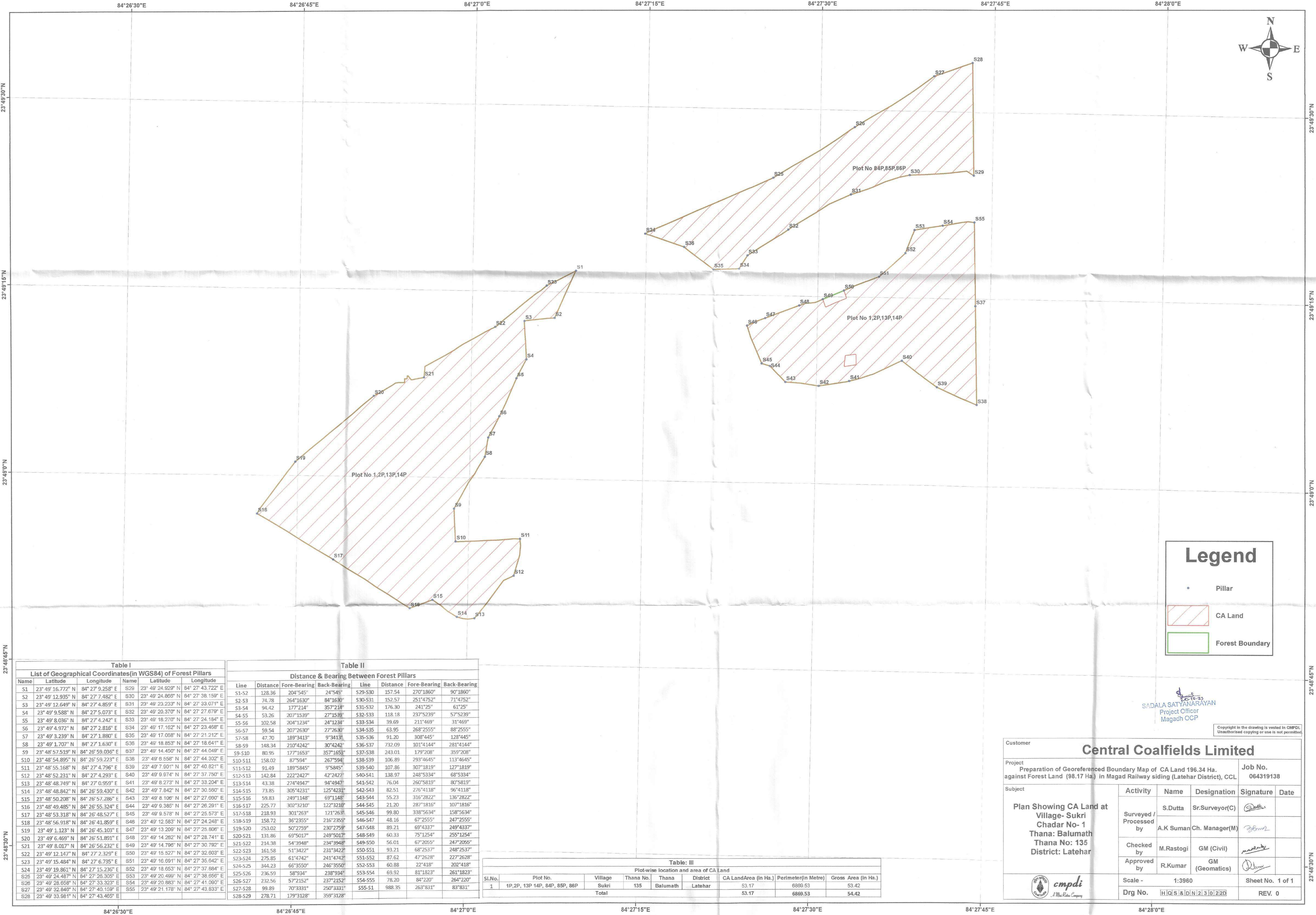

Table I					
List of Geographical Coordinates(in WGS84) of Forest Pillars					
Name	Latitude	Longitude	Name	Latitude	Longitude
S1	23° 49' 16.772" N	84° 27' 9.258" E	S29	23° 49' 24.929" N	84° 27' 43.722" E
S2	23° 49' 12.935" N	84° 27' 7.482" E	S30	23° 49' 24.868" N	84° 27' 38.159" E
S3	23° 49' 12.649" N	84° 27' 4.859" E	S31	23° 49' 23.233" N	84° 27' 33.071" E
S4	23° 49' 9.588" N	84° 27' 5.073" E	S32	23° 49' 20.370" N	84° 27' 27.679" E
S5	23° 49' 8.036" N	84° 27' 4.242" E	S33	23° 49' 18.270" N	84° 27' 24.184" E
S6	23° 49' 4.972" N	84° 27' 2.816" E	S34	23° 49' 17.162" N	84° 27' 23.468" E
S7	23° 49' 3.239" N	84° 27' 1.880" E	S35	23° 49' 17.068" N	84° 27' 21.212" E
S8	23° 49' 1.707" N	84° 27' 1.630" E	S36	23° 49' 18.853" N	84° 27' 18.641" E
S9	23° 48' 57.519" N	84° 26' 59.036" E	S37	23° 49' 14.450" N	84° 27' 44.049" E
S10	23° 48' 54.895" N	84° 26' 59.223" E	S38	23° 49' 6.558" N	84° 27' 44.302" E
S11	23° 48' 55.168" N	84° 27' 4.796" E	S39	23° 49' 7.901" N	84° 27' 40.821" E
S12	23° 48' 52.231" N	84° 27' 4.293" E	S40	23° 49' 9.974" N	84° 27' 37.750" E
S13	23° 48' 48.749" N	84° 27' 0.959" E	S41	23° 49' 8.273" N	84° 27' 33.204" E
S14	23° 48' 48.842" N	84° 26' 59.430" E	S42	23° 49' 7.842" N	84° 27' 30.590" E
S15	23° 48' 50.208" N	84° 26' 57.286" E	S43	23° 49' 8.106" N	84° 27' 27.690" E
S16	23° 48' 49.485" N	84° 26' 55.324" E	S44	23° 49' 9.385" N	84° 27' 26.291" E
S17	23° 48' 53.318" N	84° 26' 48.527" E	S45	23° 49' 9.578" N	84° 27' 25.573" E
S18	23° 48' 56.918" N	84° 26' 41.859" E	S46	23° 49' 12.563" N	84° 27' 24.248" E
S19	23° 49' 1.123" N	84° 26' 45.103" E	S47	23° 49' 13.209" N	84° 27' 25.806" E
S20	23° 49' 6.469" N	84° 26' 51.891" E	S48	23° 49' 14.262" N	84° 27' 28.741" E
S21	23° 49' 8.017" N	84° 26' 56.232" E	S49	23° 49' 14.795" N	84° 27' 30.792" E
S22	23° 49' 12.147" N	84° 27' 2.329" E	S50	23° 49' 15.527" N	84° 27' 32.603" E
S23	23° 49' 15.484" N	84° 27' 6.735" E	S51	23° 49' 16.691" N	84° 27' 36.642" E
S24	23° 49' 19.861" N	84° 27' 15.236" E	S52	23° 49' 18.653" N	84° 27' 37.884" E
S25	23° 49' 24.487" N	84° 27' 26.305" E	S53	23° 49' 20.499" N	84° 27' 38.656" E
S26	23° 49' 28.658" N	84° 27' 33.323" E	S54	23° 49' 20.883" N	84° 27' 41.090" E
S27	23° 49' 32.849" N	84° 27' 40.159" E	S55	23° 49' 21.178" N	84° 27' 43.833" E
S28	23° 49' 33.981" N	84° 27' 43.465" E			

Table II							
Distance & Bearing Between Forest Pillars							
Line	Distance	Fore-Bearing	Back-Bearing	Line	Distance	Fore-Bearing	Back-Bearing
S1-S2	128.36	204°545'	24°545'	S29-S30	157.54	270°1860"	90°1860"
S2-S3	74.78	264°1630'	84°1630'	S30-S31	152.57	251°4752"	71°4752"
S3-S4	94.42	177°214"	357°214"	S31-S32	176.30	241°25"	61°25"
S4-S5	53.26	207°1539"	27°1539"	S32-S33	118.18	237°5239"	57°5239"
S5-S6	102.58	204°1234"	24°1234"	S33-S34	39.69	211°469"	31°469"
S6-S7	59.54	207°2630"	27°2630"	S34-S35	63.95	268°2555"	88°2555"
S7-S8	47.70	189°3413"	9°3413"	S35-S36	91.20	308°445"	128°445"
S8-S9	148.34	210°4242"	30°4242"	S36-S37	732.09	101°4144"	281°4144"
S9-S10	80.95	177°1653"	357°1653"	S37-S38	243.01	179°208"	359°208"
S10-S11	158.02	87°594"	267°594"	S38-S39	106.89	293°4645"	113°4645"
S11-S12	91.49	189°5845"	9°5845"	S39-S40	107.86	307°1819"	127°1819"
S12-S13	142.84	222°2427"	42°2427"	S40-S41	138.97	248°5334"	68°5334"
S13-S14	43.38	274°4947"	94°4947"	S41-S42	76.04	260°5819"	80°5819"
S14-S15	73.85	305°4231"	125°4231"	S42-S43	82.51	276°4118"	96°4118"
S15-S16	59.83	249°1148"	69°1148"	S43-S44	55.23	316°2822"	136°2822"
S16-S17	225.77	302°3210"	122°3210"	S44-S45	21.20	287°1816"	107°1816"
S17-S18	218.93	301°263"	121°263"	S45-S46	99.80	338°5634"	158°5634"
S18-S19	158.72	36°2355"	216°2355"	S46-S47	48.16	67°2555"	247°2555"
S19-S20	253.02	50°2759"	230°2759"	S47-S48	89.21	69°4337"	249°4337"
S20-S21	131.86	69°5017"	249°5017"	S48-S49	60.33	75°1254"	255°1254"
S21-S22	214.38	54°3948"	234°3948"	S49-S50	56.01	67°2055"	247°2055"
S22-S23	161.58	51°3427"	231°3427"	S50-S51	93.21	68°2537"	248°2537"
S23-S24	275.85	61°4742"	241°4742"	S51-S52	87.62	47°2628"	227°2628"
S24-S25	344.23	66°3550"	246°3550"	S52-S53	60.88	22°418"	202°418"
S25-S26	736.59	58°934"	238°934"	S53-S54	69.92	81°1823"	261°1823"
S26-S27	232.56	57°2152"	237°2152"	S54-S55	78.20	84°220"	264°220"
S27-S28	99.99	70°3331"	250°3331"	S55-S1	988.35	263°831"	83°831"
S28-S29	278.71	179°3128"	359°3128"				

Table: III							
Plot-wise location and area of CA Land							
Sl.No.	Plot No.	Village	Thana No.	Thana	District	CA Land Area (in Ha.)	Gross Area (in Ha.)
1	1P,2P, 13P 14P, 84P, 85P, 86P	Sukri	135	Balumath	Latehar	53.17	6869.53
Total						53.17	6869.53

Customer

Central Coalfields Limited

Project

Preparation of Georeferenced Boundary Map of CA Land 196.34 Ha. against Forest Land (98.17 Ha.) in Magad Railway siding (Latehar District), CCL

Job No.
064319138

Subject

Plan Showing CA Land at Village- Sukri Chadar No- 1 Thana: Balumath Thana No: 135 District: Latehar

Activity	Name	Designation	Signature	Date
Surveyed / Processed by	S.Dutta	Sr.Surveyor(C)		
Checked by	A.K Suman	Ch. Manager(M)		
Approved by	M.Rastogi	GM (Civil)		
	R.Kumar	GM (Geomatics)		
Scale -	1:3960		Sheet No. 1 of 1	
Drp No.	HQS&DN230220		REV. 0	

cmpdi
A Maa Raha Company

SADALA SATYANARAYAN
Project Officer
Magadh OCP

Copyright in the drawing is vested in CMPDI. Unauthorised copying or use is not permitted.

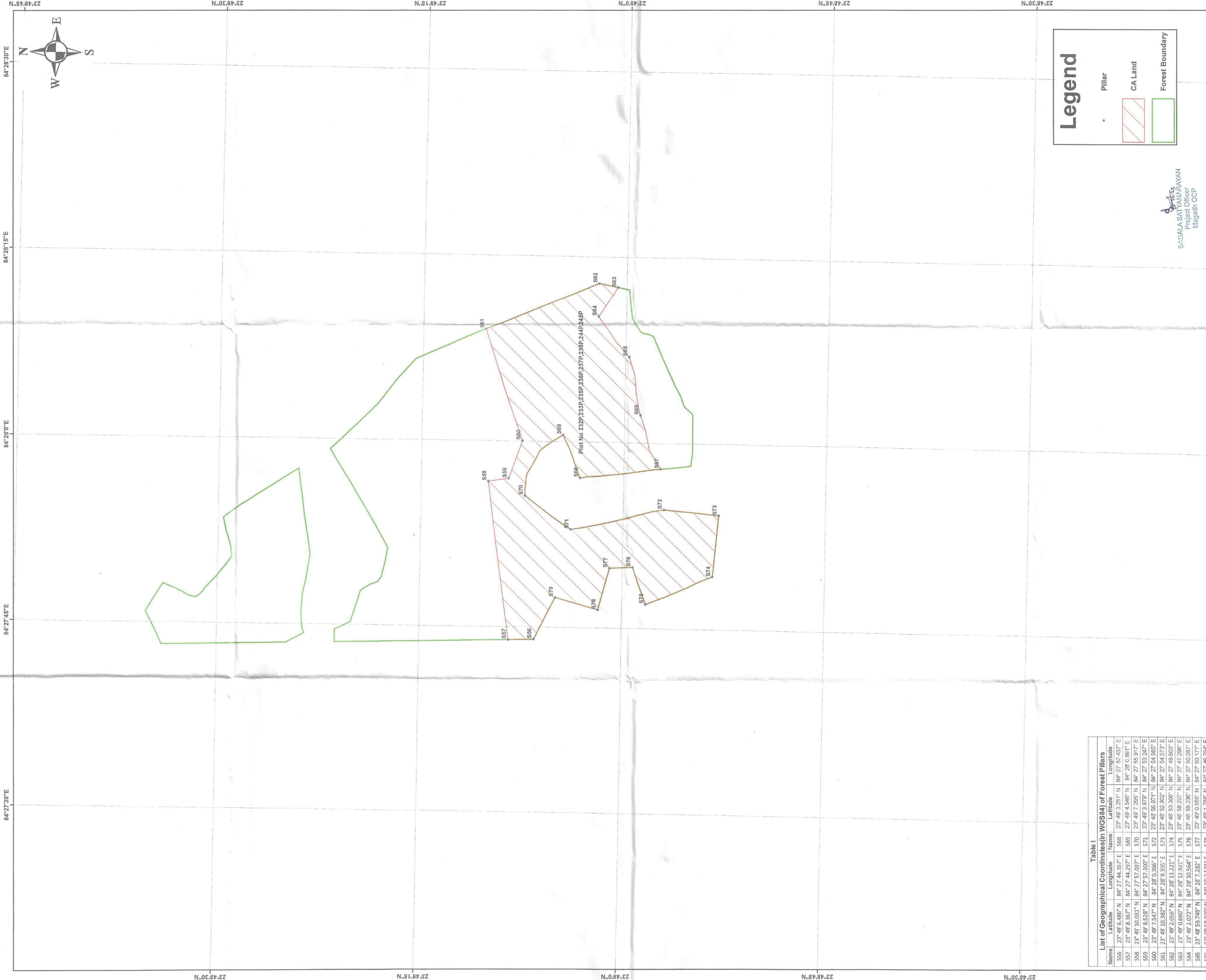

SADALA SATYANARAYAN
Project Officer
Magadh OCP

Copyright in the drawing is vested in CMPDI.
Unauthorized copying or use is not permitted.

Customer		Central Coalfields Limited			
Project	Preparation of Georeferenced Boundary Map of CA Land 196.34 Ha. against Forest Land (98.17 Ha.) in Magad Railway siding (Latehar District), CCL			Job No. 064322133	
	Subject	Plan Showing CA Land at Village- Sukri Chadar No- 2 Thana: Balmath District: Latehar			
		Activity	Name	Designation	Signature
	Surveyed / Processed by	S. Dutta	Sr. Surveyor (C)	<i>S. Dutta</i>	
		A. K. Suman	Ch. Manager (M)	<i>A. K. Suman</i>	
	Checked by	M. Rastogi	GM (Civil)	<i>M. Rastogi</i>	
		R. Kumar	GM (Geomatics)	<i>R. Kumar</i>	
	Approved by				
		Scale -	1:4000	Sheet No. 1 of 1	
	Drg No.	H. Q. S. S. D. N. 23.10.22E		REV. 0	
					

Table I List of Geographical Coordinates (in WGS84) of Forest Pillars					
Name	Latitude	Longitude	Latitude	Longitude	
S55	23° 48' 6.486" N	84° 27' 44.357" E	S58	23° 48' 2.251" N	84° 27' 57.437" E
S57	23° 48' 8.387" N	84° 27' 44.297" E	S69	23° 48' 4.548" N	84° 28' 0.881" E
S58	23° 48' 10.031" N	84° 27' 57.037" E	S70	23° 48' 7.295" N	84° 27' 55.917" E
S59	23° 48' 8.528" N	84° 27' 57.300" E	S71	23° 48' 3.878" N	84° 27' 53.247" E
S60	23° 48' 7.547" N	84° 28' 0.366" E	S72	23° 48' 56.971" N	84° 27' 54.985" E
S61	23° 48' 10.382" N	84° 28' 0.365" E	S73	23° 48' 52.802" N	84° 27' 54.573" E
S62	23° 48' 7.056" N	84° 28' 13.221" E	S74	23° 48' 53.305" N	84° 27' 48.603" E
S63	23° 48' 0.660" N	84° 28' 13.931" E	S75	23° 48' 58.238" N	84° 27' 47.286" E
S64	23° 48' 2.072" N	84° 28' 10.564" E	S76	23° 48' 59.286" N	84° 27' 50.287" E
S65	23° 48' 53.749" N	84° 28' 7.282" E	S77	23° 48' 0.655" N	84° 27' 50.177" E
S66	23° 48' 58.829" N	84° 28' 2.581" E	S78	23° 48' 1.788" N	84° 27' 46.194" E
S67	23° 48' 57.274" N	84° 27' 58.272" E	S79	23° 48' 4.940" N	84° 27' 47.724" E

Table II Distance & Bearing Between Forest Pillars			
Line	Distance	Fore-Bearing	Back-Bearing
S56-S57	57.92	359°208"	179°208"
S57-S58	364.37	82°568"	262°568"
S58-S59	46.84	171°521"	351°521"
S59-S60	91.91	110°1231"	290°1231"
S60-S61	269.05	72°66"	252°66"
S61-S62	278.66	157°5310"	337°5310"
S62-S63	43.80	192°1328"	12°1328"
S63-S64	79.63	304°65"	124°65"
S64-S65	136.10	295°116"	233°2655"
S65-S66	131.07	249°3650"	69°3650"
S66-S67	385.47	353°405"	173°405"

Table III Plotwise location and area of CA Land			
S.No.	Plot No.	Village	Thana
1.	232P-233P-238P-237P-238P-244P-249P	Sukri	135
Total		Balmath	135
		Perimeter (in Meters)	Gross Area (in Ha.)
		21.04	54.25
		3316.08	54.25



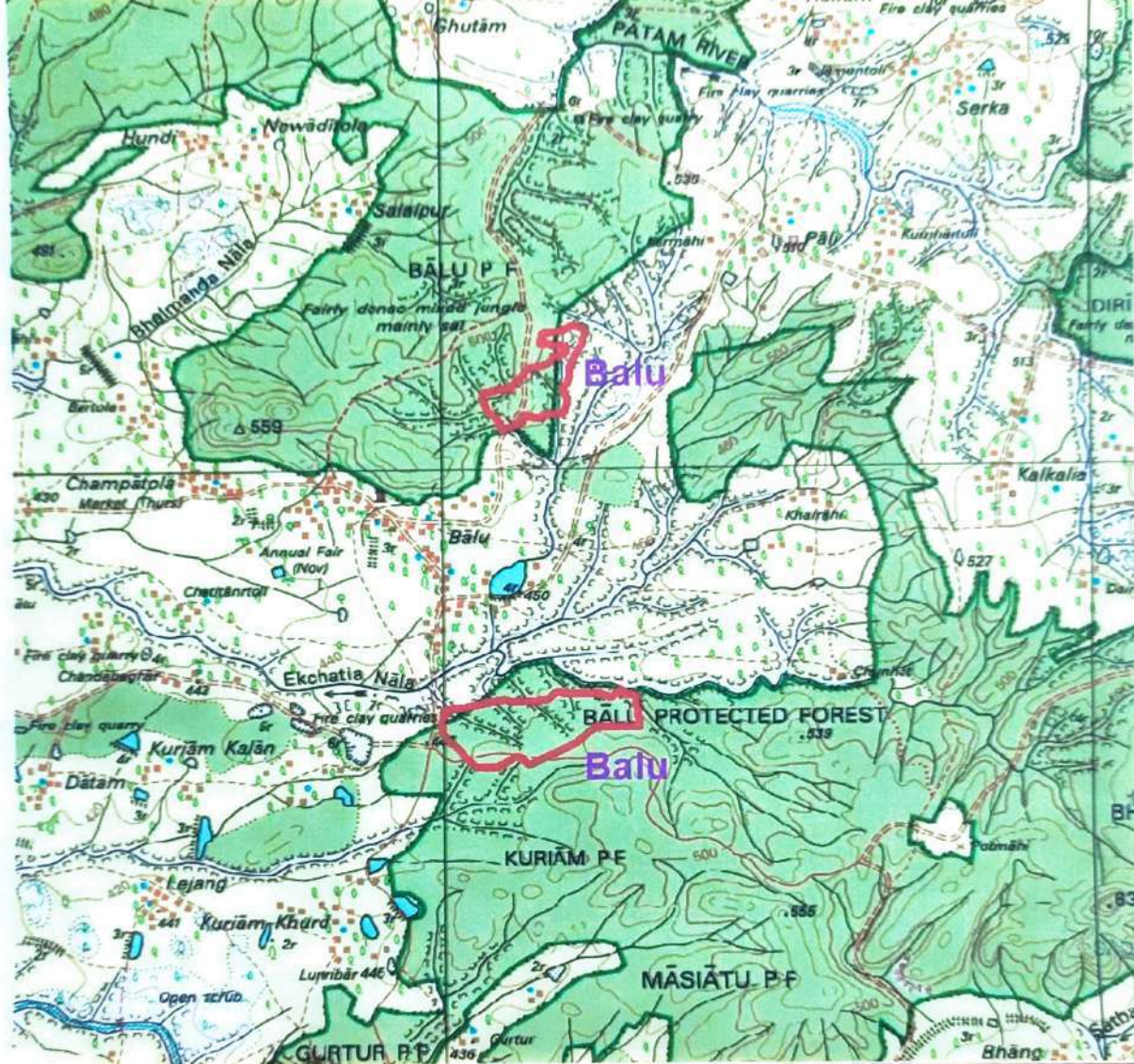

OPEN SERIES
MAP

No. F45A9

Scale 1:50,000

G45S8 Palamu JHARKHAND	G45S12	G45S16 Chatra JHARKHAND
F45A5	F45A9 Latehar JHARKHAND	F45A13
F45A6	F45A10 Lohardaga JHARKHAND	F45A14

1 Gumia, JHARKHAND. 2 Ranchi, JHARKHAND.

भारतीय सर्वेक्षण विभाग

SURVEY OF INDIA

1st Edition 2009.

Price : Rs. 50 /-

CONVENTIONAL SYMBOLS

Express Highway with toll; with bridge; with distance stone	
Roads, metalled; according to importance	
Roads, double cartage-way; according to importance	
Unmetalled road, Cart-track, Path-track with pass, Foot-path	
Streams: with track in bed; undefined; Canal	
Dams: masonry or rock-filled; earthwork; Weir	
River: dry with water channel; with island & rocks; Tidal river	
Submerged rocks; Shoal; Swamp; Reeds	
Well: fixed; unlined; Tube-well; Spring; Tank; Permanent; dry	
Embankments: road or railway; Bank; Broken ground	
Railways: broad gauge; double; single with station; under construction	
Railways: other gauges; double; single with distance stone; do	
Mineral line or tramway; Kin. Cutting with tunnel	
Contours with sub-features. Rocky slopes, Gullies	
Sand features: (fixed) dunes (permanent), (dunes) shifting	
Towns or Villages: inhabited; deserted; Fort	
Huts: permanent; temporary; Tower; Antiquities	
Temple, Chhatra, Church, Mosque, Idgah, Tomb, Graves	
Lighthouse, Lightship, Buoy: lighted; unlighted; Anchorage	
Mine: Vine on trellis; Grass, Scrub	
Palms: palm-tree; other; Plantain, Canebrake, Bamboo; Other trees	
Areas: cultivated; wooded; Surveyed tree	
Boundary: international	
Boundary: district; subdivision; tahsil or taluk; forest	
Boundary pillars: surveyed; uncoloured; village trijunction	
Height: triangulation station; point; approximate	
Barometrical: geodetic; tertiary; canal	
Post office; Telegraph office; Overhead tank	
Rest house or Hospital bungalow; Civil house; Police station	
Camping ground; Forest: reserved; protected	
Spaced names: administrative; locality or tribal	
Hospital, Dispensary, Veterinary hospital	
Aerodrome, Helipad, Tourist site	
Power line: with pylons surveyed; with poles unsurveyed	

NOTES :-

Heights are in metres and above Indian mean sea level.
Contours are appropriate.
Tanks shown dry, in this area, usually contain water from July to January.
A relative height, 8, represents the approximate height, in metres, between the top and bottom of a steep slope.
The information regarding the forests in this sheet is not complete.
Wells are numerous in southern half of the sheet, only the important ones have been shown.
The kilometre scale numbers along roads, are shown in black type, e.g. 5, whereas kilometre numbers are shown in red type, e.g. 5.
Cultivation is periodic and dependent on rainfall.

COMPILATION INDEX

A. Surveyed during 1978-79. Updated for major details during 1982-83 and 2004-06.

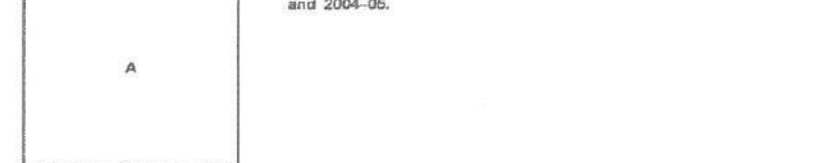

Projection - UTM Datum - WGS 84

Magnetic Variation from True North about 1/4° West in 2005.
(Decreasing by about 1° annually).

1:50,000

500 m to 1 cm 2 cm to 1 km
Kilometres
CONTOUR INTERVAL 20 METRES

For further details about this map, please contact

Director

Jharkhand Geo-Spatial Data Centre

Survey of India, Ranchi

Ranchi-834002

Fax : 0661 - 2482789



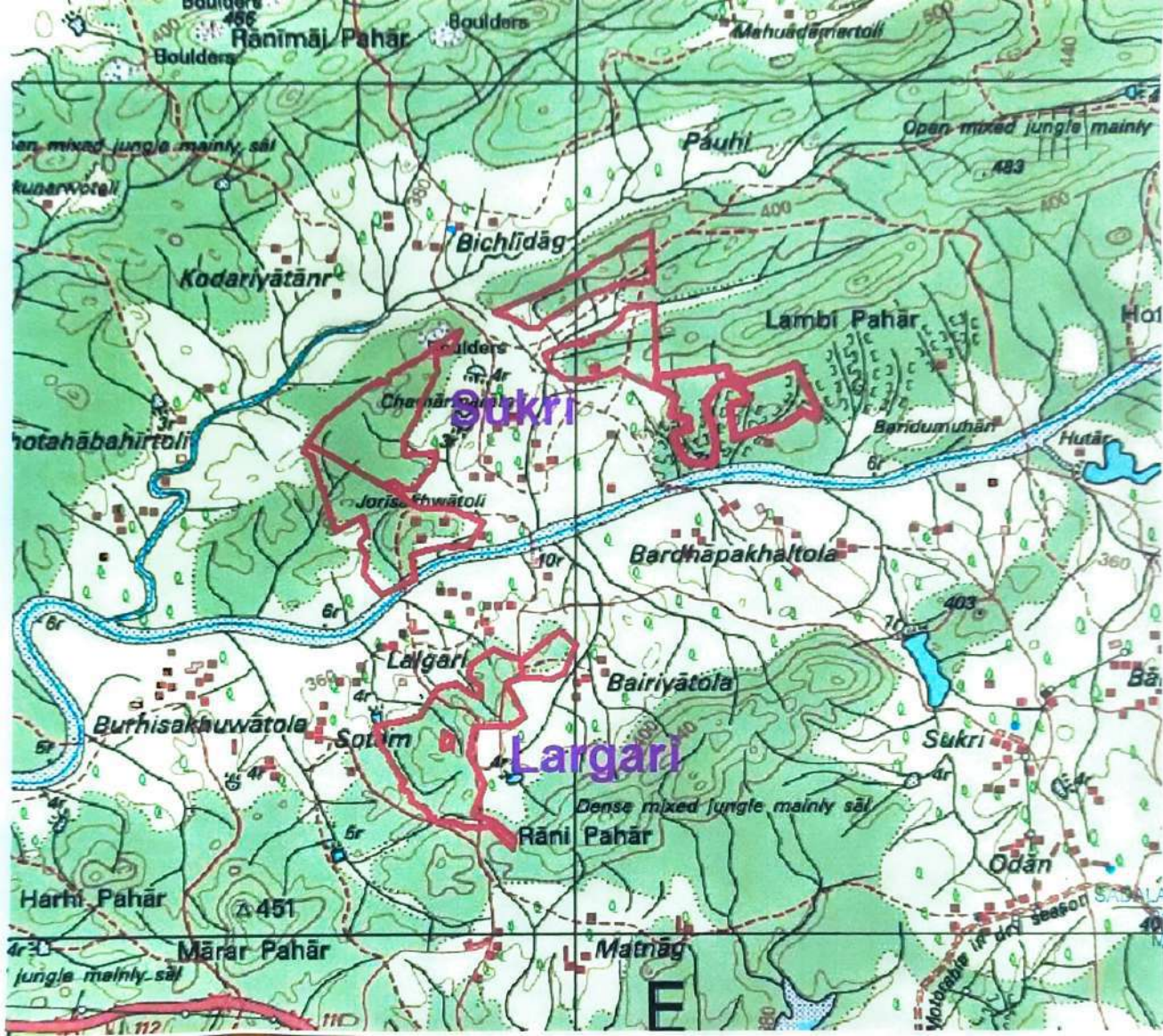

S. 10.23
SADALA SATYANARAYAN
Project Officer
Magadh CCP



नियत क लिय नहीं NOT FOR EXPORT

OPEN SERIES
MAP

No.F45A5

Scale 1:50,000

G45S4	G45S8	G45S12
Chitra	Palamu	Jharkhand
F45A1	F45A5	F45A9
Lohardaga	Jharkhand	
F45A2	F45A6	F45A10
Surgha, CHHATTISGARH.	Garhwa, JHARKHAND.	

भारतीय सर्वेक्षण विभाग

SURVEY OF INDIA

1st Edition 2009.

Price : Rs. 50 /-

CONVENTIONAL SYMBOLS

Express highway: with toll; with bridge; with distance stone	20
Roads, metalled: according to importance	
Roads, double cartage-way: according to importance	
Unmetalled road: Cart-track: Path-track with pass: Foot-path	
Grass: with track in bed; unmetalled: Canal	
Dam: masonry or rock-filled; earthenwork: Weir	
River: dry with water channel; with island & rocks: Tidal river	
Submerged rocks: Shoal: Scarp: Reefs	
Wells: lined; unlined: Tube-well: Spring: Tank: perennial; dry	
Embankments: road or rail: tank: Broken ground	
Railways, broad gauge: double single with station; under constr.	
Railways, other gauges: double single with distance stone: do	
Mineral line or tramway: Kite: Cutting with tunnel	
Contours with sub-features: Rocky slopes: Cliffs	
Sand features: (Mud) (Zand)-hill (permanent): (Dunes) (shifting)	
Towns or Villages: inhabited: deserted: Fort	
Huts: permanent; temporary: Tower: Antiquities	
Temple: Chatri: Church: Mosque: Light: Tomb: Doves	
Lighthouse: Lightship: Buoys: lighted: unlighted: Anchorage	
Mine: Vine on trellis: Grass: Scrub	
Palms: palms: other: Plantain: Coffee: Bamboo: Other trees	
Areas: cultivated: wooded: Surveyed tree	
Boundary: International	
state: demarcated: undemarcated	
district: subdivision: taluk or taluk: forest	
Boundary pillars: surveyed: unlocated: village: junction	
Height: triangulation: station: pole: approximate	
Barometrical: geodetic: surveying: aneroid	
Post office: Telegraph office: Overhead tank	
Rest house or inspection bungalow: Circuit house: Police station	
Camping ground: Forest: reserved: protected	
Speed names: administrative: locality or tribal	
Hospital: Dispensary: Veterinary hospital	
Aerodrome: Heliport: Tourist site	
Power line: with pylons surveyed: with poles unsurveyed	

REFERENCES

800 Block Development Office. NH 75 National Highway No. 75.

NOTES

Heights are in metres and above Indian mean sea level.
Contours are approximate.
Tanks shown dry, in this area usually contain water from July to December.
A relative height, Δ , represents the approximate height, in metres, between the top and bottom of a steep slope.
The district boundary between Lohardaga and Palamu Districts has been surveyed as pointed out by the local officials on the ground, but has not been verified by the District authorities.
Forest boundaries have not been shown for want of reliable information.
The kilometre stone numbers along roads and the railway are shown in slant type, e. g., '5' whereas mile stone numbers are shown in upright type, e. g., '5'.

COMPILATION INDEX

A. Compiled from 1:25,000 Survey 1979-83. Updated for major details during 2004-05.

Projection - UTM Datum - WGS 84

Magnetic Variation from True North about $\frac{1}{4}^\circ$ West in 2005.
(Decreasing by about $1'$ annually).

1:50,000

500 m to 1 cm
2 cm to 1 km
Kilometres

CONTOUR INTERVAL 20 METRES

For further details about this map, please contact

Director

Jharkhand Geo-Spatial Data Centre

Survey of India, Dorenda

Ranchi-834002.

Fax : 0651 - 2482789

