

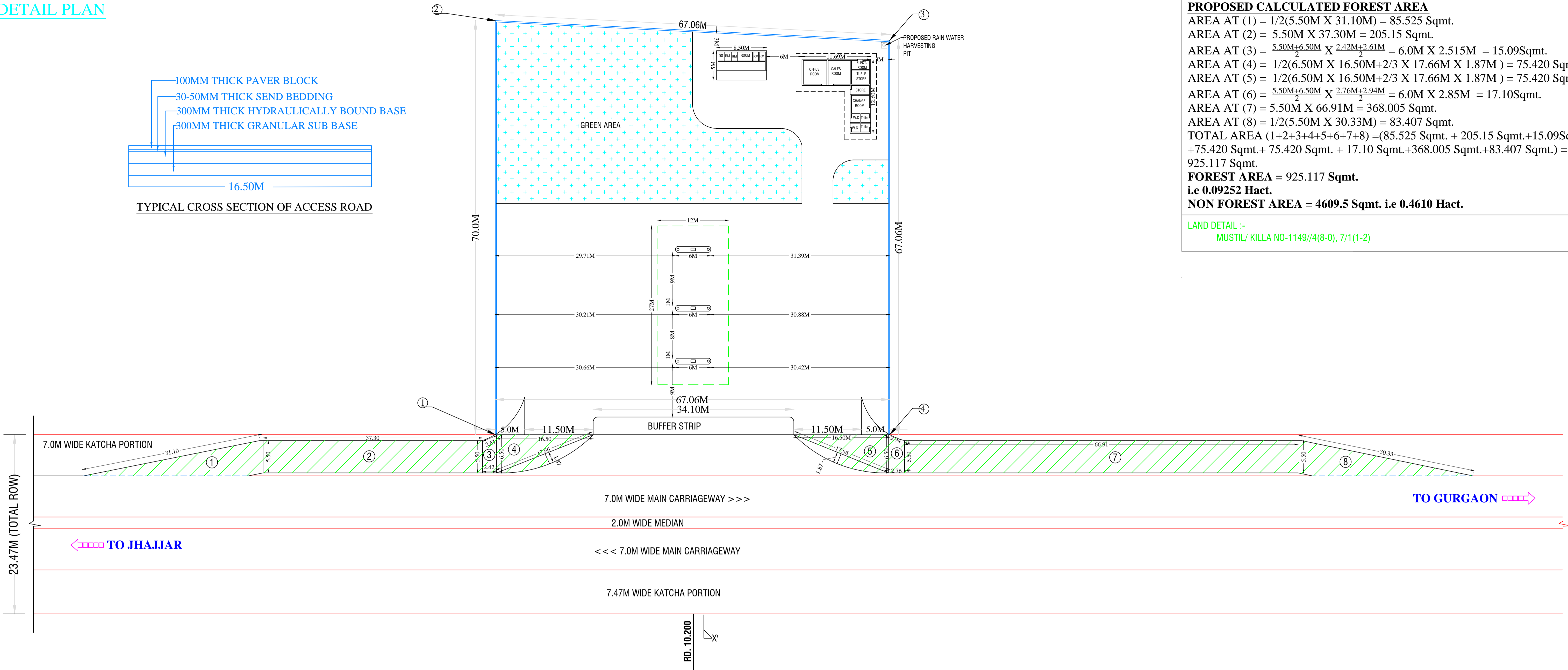

**DETAIL PLAN**

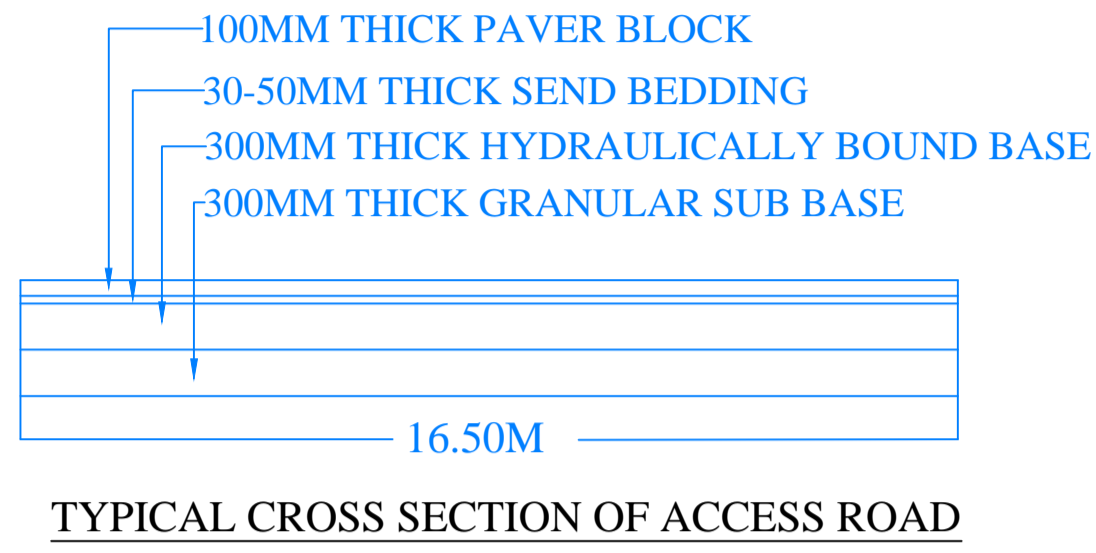

**PROPOSED CALCULATED FOREST AREA**  
 AREA AT (1) =  $1/2(5.50M \times 31.10M) = 85.525$  Sqmt.  
 AREA AT (2) =  $5.50M \times 37.30M = 205.15$  Sqmt.  
 AREA AT (3) =  $\frac{5.50M+6.50M}{2} \times \frac{2.42M+2.61M}{2} = 6.0M \times 2.515M = 15.09$  Sqmt.  
 AREA AT (4) =  $1/2(6.50M \times 16.50M + 2/3 \times 17.66M \times 1.87M) = 75.420$  Sqmt.  
 AREA AT (5) =  $1/2(6.50M \times 16.50M + 2/3 \times 17.66M \times 1.87M) = 75.420$  Sqmt.  
 AREA AT (6) =  $\frac{5.50M+6.50M}{2} \times \frac{2.76M+2.94M}{2} = 6.0M \times 2.85M = 17.10$  Sqmt.  
 AREA AT (7) =  $5.50M \times 66.91M = 368.005$  Sqmt.  
 AREA AT (8) =  $1/2(5.50M \times 30.33M) = 83.407$  Sqmt.  
**TOTAL AREA** (1+2+3+4+5+6+7+8) =  $(85.525$  Sqmt. +  $205.15$  Sqmt. +  $15.09$  Sqmt. +  $75.420$  Sqmt. +  $75.420$  Sqmt. +  $17.10$  Sqmt. +  $368.005$  Sqmt. +  $83.407$  Sqmt.) =  $925.117$  Sqmt.  
**FOREST AREA = 925.117 Sqmt.**  
**i.e 0.09252 Hact.**  
**NON FOREST AREA = 4609.5 Sqmt. i.e 0.4610 Hact.**

LAND DETAIL :-  
 MUSTIL/ KILLA NO-1149/4(8-0), 7/1(1-2)

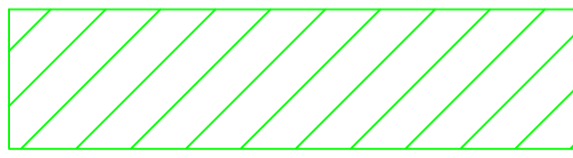
DIVERSION OF FOREST LAND (0.09252 HECTARE) FOR THE PROPOSED FUEL STATION OF M/s INDIAN OIL CORPORATION LIMITED ON SH 15A (GURGAON-JHAJJAR) AT KM.10.200 (RHS) IN VILLAGE- BUDHERA, TEHSIL-HARSARU, DISTRICT-GURGAON (HARYANA)

**DETAILS:-**  
 FOREST AREA SHOWN AS   
 ROAD SHOWN AS   
 PROPOSAL BOUNDARY SHOWN AS 

SR No.	Latitude	Longitude
1.	28° 28' 20.72"N	76° 55' 55.90"E
2.	28° 28' 22.95"N	76° 55' 55.93"E
3.	28° 28' 22.94"N	76° 55' 58.46"E
4.	28° 28' 20.79"N	76° 55' 58.36"E

Dr. No. - S1 of S1  
 SCALE - N.T.S  
 Dr. By - MAHESH 9992790142

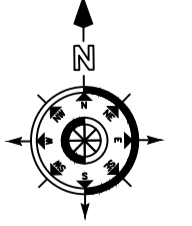

**INDIAN OIL CORPORATION LIMITED**



*Manoj Arora*  
 गौरव अरोरा (R.S.), गुग्गा-11, R.S.ए.  
 Manager (RS), Gurgaon-11, RSA  
 इंडियन ऑयल कॉर्पोरेशन लिमिटेड  
**INDIAN OIL CORPORATION LIMITED**  
 गुग्गा नगर अफिस / Gurgaon Divisional Office