

TOTAL SITE AREA 2598 sqmt.  
0.2598 HECTARES

VILLAGE SARAKPUR  
TEHSIL RAIPUR RANI  
DISTRICT PANCHKULA  
STATE HARYANA

APPROACH ROAD AREA

AREA A = 9.000 X 3.045  
= 27.405 SQMT.

AREA B+B' = 2(1/2X4.602X3.045 - 2/3X5.518X0.880)  
= 2(7.007 - 3.237)  
= 7.540 sqmt.

TOTAL AREA = 27.405 + 7.540  
= 34.945 sqmt.  
= 0.0035 HECTARES

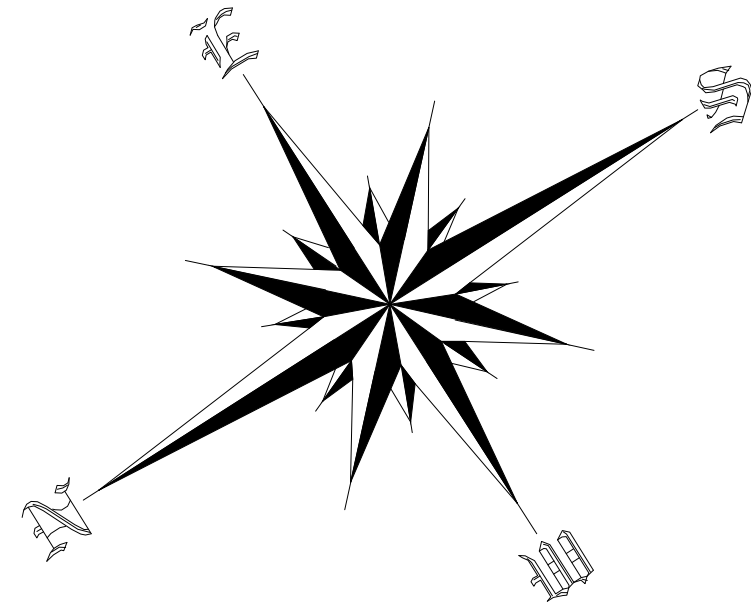
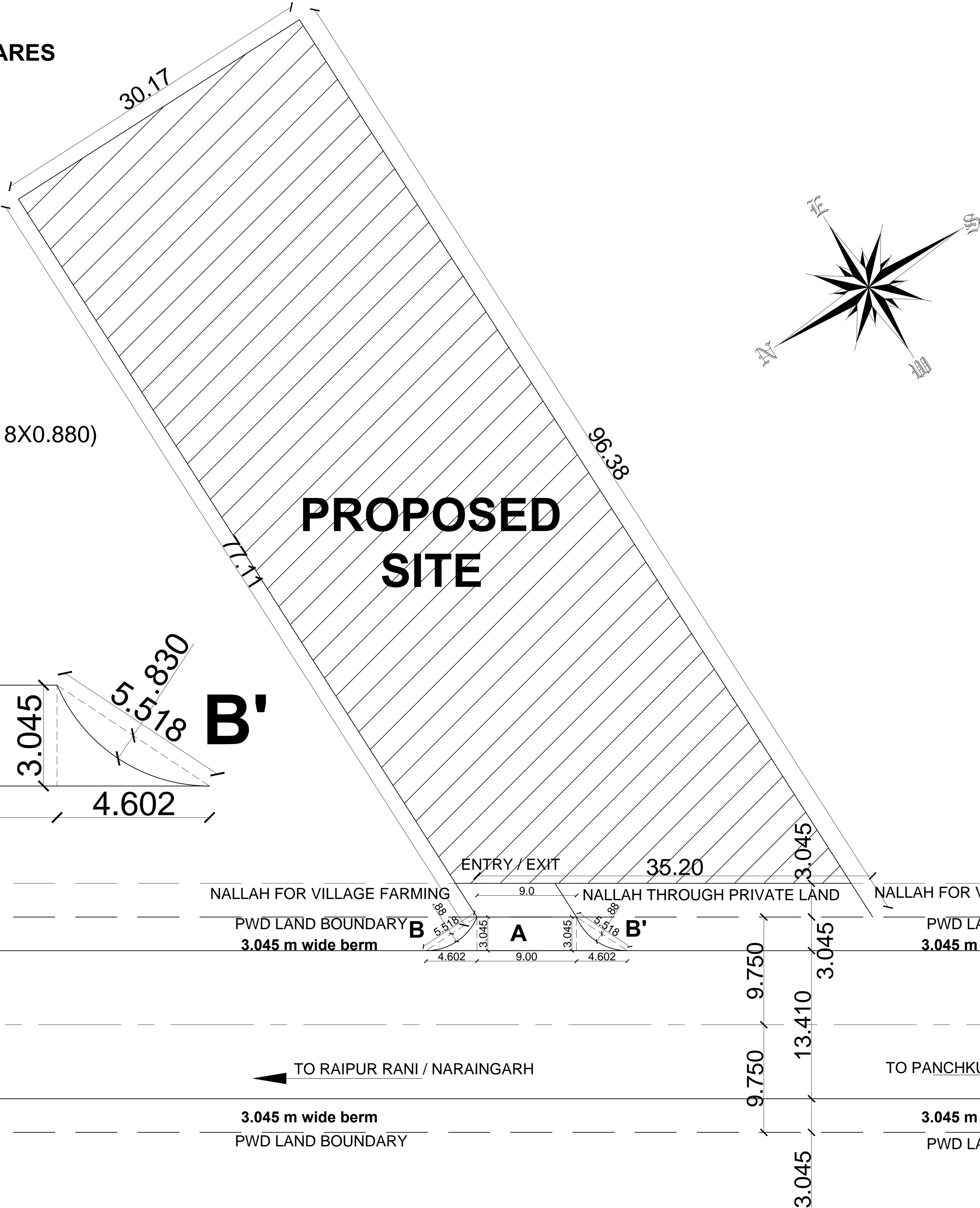
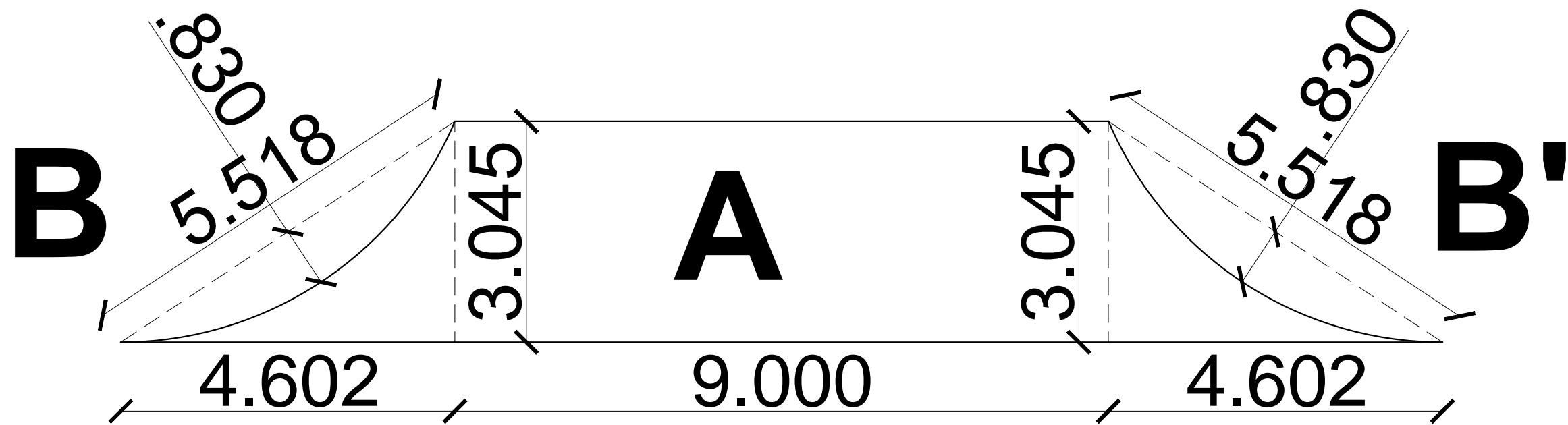

- NOTES:-
- 1.DRAWING AND DIMENSIONS ARE ONLY TO BE READ AND NOT SCALED.
  - 2.UNLESS OTHERWISE MENTIONED, ALL DIMENSIONS ARE GIVEN IN FEET INCHES.
  - 3.THIS DRAWING SHALL BE READ IN CONJUNCTION WITH RELEVANT ARCHITECTURAL, STRUCTURAL AND SERVICE DRAWINGS.
  - 4.ALL LEVELS GIVEN IN DRAWING ARE WITH REFERENCE TO THE ROAD LEVEL AS BENCHMARKED AT SITE.
  - 5.ANY DISCREPANCY BETWEEN THE ARCHITECTURAL / STRUCTURAL OR SERVICES DRAWINGS MUST BE BROUGHT TO THE ATTENTION OF THE ARCHITECT BY THE CONTRACTOR OR PROJECT MANAGER BEFORE EXECUTION OF THE SAME.
  6. THIS DRAWING & DESIGN IS THE COPYRIGHT OF THE ARCHITECT & CANNOT BE REPRODUCED IN ANY FORM WITHOUT WRITTEN CONSENT FROM THE ARCHITECT

USER AGENCY:

For Modern Steel Industry

Partner

ARCHITECT:

DRAWING NAME:

SITE PLAN

SCALE : NTS

PLOT SIZE: 0.2598 HACTARES

PROJECT NAME:

PROPOSED SITE PLAN FOR M/s MODERN STEELS INDUSTRY AT SADHOURA VILLAGE - SARAKPUR TEH. - RAIPUR RANI, DISTT. - PANCHKULA (HARYANA)

DATE: 30/12/2021

DRG. NO.: 01

DRAWN BY:

PRINCIPAL ARCHITECT:

Ar. NISHANT SINGLA

ARCHITECTS & INTERIOR DESIGNERS

EMAIL -> nishantsingla@gmail.com