

Map Showing DGPS Surveyed Co-ordinates and Boundary of Forest Area Proposed to be Divided for M/s Larsen & Toubro Ltd. for Bauxite over 2017.71 Acre or 816.56 Hectare in Village-Maipadara Sheet2, Tahasil-Kasipur, District-Rayagada, Forest Division-Rayagada, Odisha

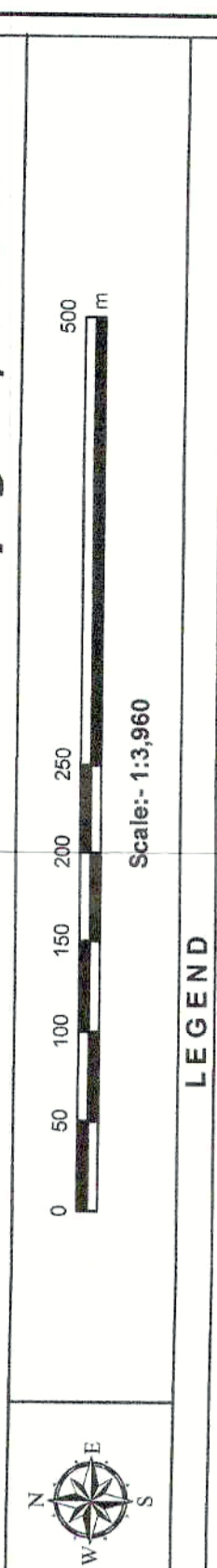

LEGEND
 Observation Point (Red circle with dot)
 Forest Pillar (Green circle)
 ML Boundary Pillar (Red square)
 Sijmali ML Boundary (Red line)
 Forest Plot(DLC) (Green area)
 Patch Boundary (Black line)
 Forest Plot (Green area)

DGPS CO-ORDINATES OF SCIP/DGPS OBSERVATION POINT

OBSERVATION ID	EASTING	NORTHING	LONGITUDE	LATITUDE
15	21755.000	2156366.188	83°51'55.000"	19°29'42.000"
16	21755.000	2156366.188	83°51'55.000"	19°29'42.000"
17	21755.000	2156366.188	83°51'55.000"	19°29'42.000"
18	21755.000	2156366.188	83°51'55.000"	19°29'42.000"
19	21755.000	2156366.188	83°51'55.000"	19°29'42.000"
20	21755.000	2156366.188	83°51'55.000"	19°29'42.000"
21	21755.000	2156366.188	83°51'55.000"	19°29'42.000"
22	21755.000	2156366.188	83°51'55.000"	19°29'42.000"
23	21755.000	2156366.188	83°51'55.000"	19°29'42.000"
24	21755.000	2156366.188	83°51'55.000"	19°29'42.000"
25	21755.000	2156366.188	83°51'55.000"	19°29'42.000"

UTM COORDINATES OF FOREST PILLAR

Forest Pillar Id	Easting	Northing	Longitude	Latitude
101	21755.000	2156366.188	83°51'55.000"	19°29'42.000"
102	21755.000	2156366.188	83°51'55.000"	19°29'42.000"
103	21755.000	2156366.188	83°51'55.000"	19°29'42.000"
104	21755.000	2156366.188	83°51'55.000"	19°29'42.000"
105	21755.000	2156366.188	83°51'55.000"	19°29'42.000"
106	21755.000	2156366.188	83°51'55.000"	19°29'42.000"
107	21755.000	2156366.188	83°51'55.000"	19°29'42.000"
108	21755.000	2156366.188	83°51'55.000"	19°29'42.000"
109	21755.000	2156366.188	83°51'55.000"	19°29'42.000"
110	21755.000	2156366.188	83°51'55.000"	19°29'42.000"

CO-ORDINATES OF FOREST PILLAR

Forest Pillar Id	Easting	Northing	Longitude	Latitude
101	21755.000	2156366.188	83°51'55.000"	19°29'42.000"
102	21755.000	2156366.188	83°51'55.000"	19°29'42.000"
103	21755.000	2156366.188	83°51'55.000"	19°29'42.000"
104	21755.000	2156366.188	83°51'55.000"	19°29'42.000"
105	21755.000	2156366.188	83°51'55.000"	19°29'42.000"
106	21755.000	2156366.188	83°51'55.000"	19°29'42.000"
107	21755.000	2156366.188	83°51'55.000"	19°29'42.000"
108	21755.000	2156366.188	83°51'55.000"	19°29'42.000"
109	21755.000	2156366.188	83°51'55.000"	19°29'42.000"
110	21755.000	2156366.188	83°51'55.000"	19°29'42.000"

Area Statement

Patch No	RoR Plot No	Tenant Name	Land Schedule Proposed		DGPS Surveyed		
			Area in Hectare	Area in Acre	Area in Hectare	Area in Acre	
Patch-7	135	Grianya Jungle Jogyo	4.400	1.781	4.392	1.777	
Patch-7	136	Patra Jungle	0.100	0.040	0.109	0.044	
Patch-7	140P	Patra Jungle	3.150	1.275	3.374	1.368	
Patch-7	141P	Patra Jungle	2.000	0.800	2.014	0.815	
Patch-7	142	Patra Jungle	11.250	4.553	10.703	4.331	
Patch-7	143	Patra chana(DLC)	6.500	2.631	6.866	2.831	
Patch-7	144	Grianya Jungle Jogyo	0.180	0.073	0.180	0.073	
Patch-7	146	Grianya Jungle Jogyo	3.900	1.578	3.776	1.528	
Patch-8	152	Grianya Jungle Jogyo	3.920	1.586	4.124	1.669	
Patch-8	153	Grianya Jungle Jogyo	0.240	0.097	0.245	0.098	
Patch-8	154	Grianya Jungle Jogyo	0.220	0.089	0.221	0.089	
Patch-8	155	Grianya Jungle Jogyo	2.600	1.052	2.481	1.008	
Patch-18	194	Pahara(DLC)	8.500	3.440	8.162	3.303	
			Total Area	46.960	19.004	47.148	19.081

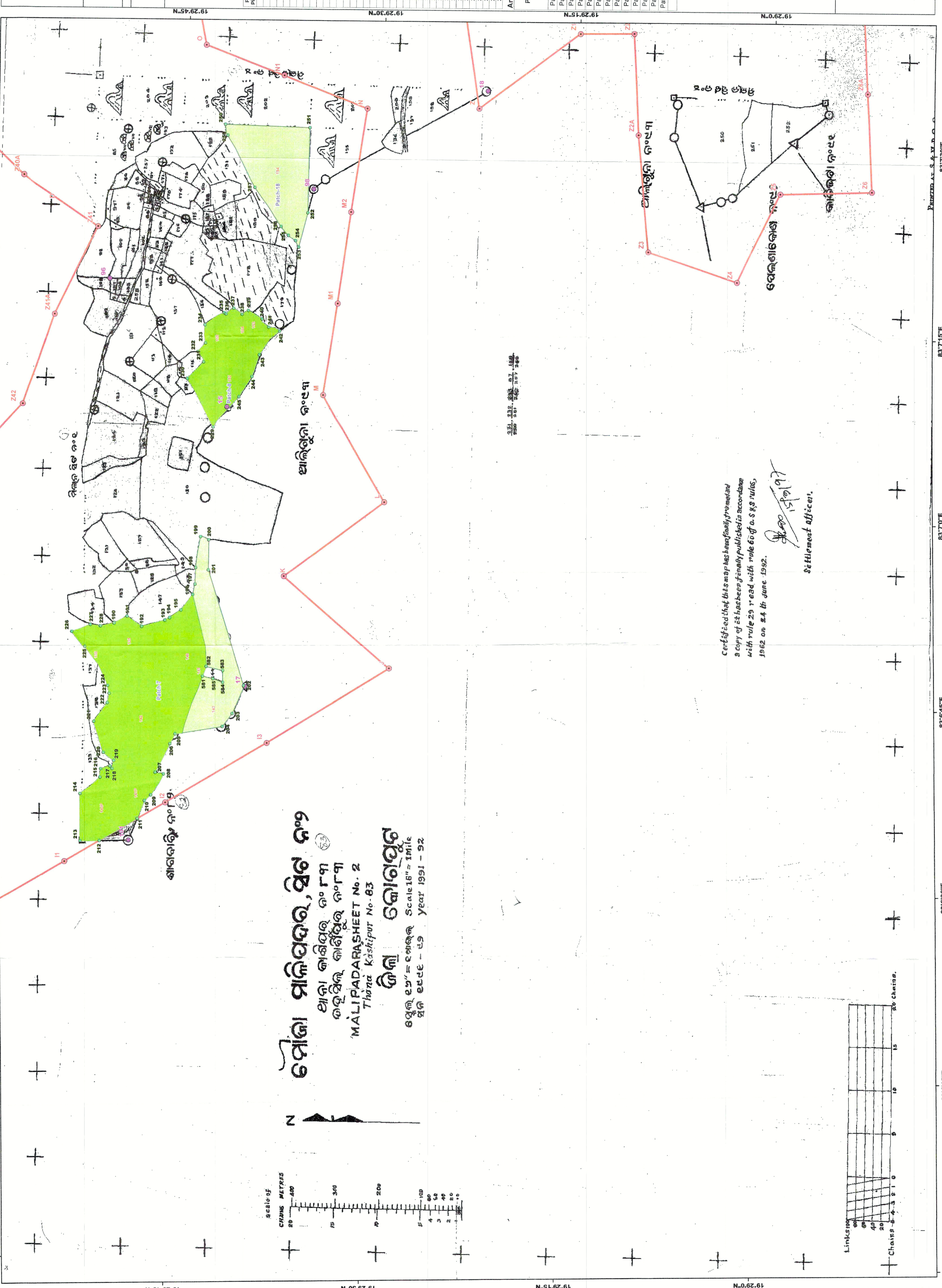

Certified that this map has been finally prepared and a copy of it has been finally published in accordance with rule 29 read with rule 60 of O.S.S. Rules, 1962 on 24th June 1992.

[Signature]
 Settlement Officer.



[Signature]
 District Surveyor, Rayagada.

DGPS Survey Conducted and Map Prepared by :-
 Spatial Planning and Analysis Research Centre Pvt. Ltd.,
 E/11, Indira City, Cuttack Central Estate,
 Bhubaneswar - 751024.

Map Showing DGPS Surveyed Co-ordinates and Boundary of Forest Area Proposed to be Diverted for M/s Larsen & Toubr Ltd. for Bauxite over 2017.71 Acre or 816.56 Hectare in Village-Malipadara Sheet3, Tahasil-Kasipur, District-Rayagada, Forest Division-Rayagada, Odisha

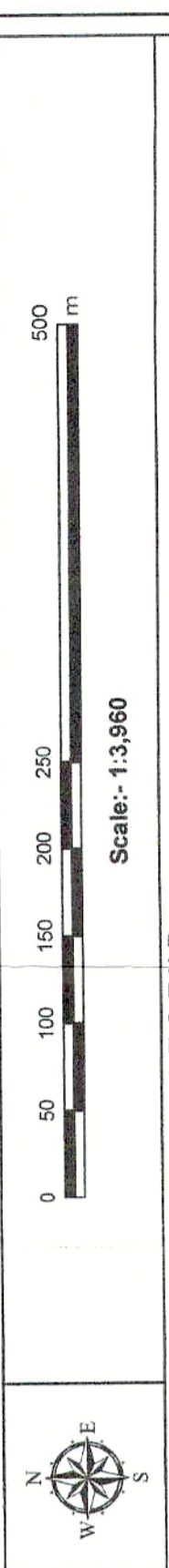

LEGEND

- Observation Point
- Forest Pillar
- ML Boundary Pillar
- Sijimal ML Boundary
- Patch Boundary
- Forest Plot(DLC)
- Forest Plot

CO-ORDINATES OF SCIP/DGPS OBSERVATION POINT

DGPS OBSERVATION ID	EASTING	NORTHING	LATITUDE	LONGITUDE	Elevation	Height
47	724716.948	2158465.579	N19°30'29.60538"	E83°08'28.66192"	1140.218	1075.48
11	724560.179	2158146.253	N19°30'19.28819"	E83°08'23.08179"	1175.39	1110.65
13	724806.709	2157808.952	N19°30'08.15712"	E83°08'31.38884"	1185.92	1121.182
39	724563.354	2158755.311	N19°30'39.08801"	E83°08'23.45118"	1141.252	1076.513
1	723260.053	2158203.386	N19°30'21.67176"	E83°07'36.53084"	1126.154	1061.402
93	723871.488	2158920.109	N19°30'44.72606"	E83°07'59.80022"	1116.947	1052.202

CO-ORDINATES OF FOREST PILLAR

Forest Pillar Id	UTM COORDINATES Easting	UTM COORDINATES Northing	UTM COORDINATES Longitude	UTM COORDINATES Latitude
988	723161.860	2157280.188	83°6'28.769817"	19°30'10.217851"
399	723162.237	2157983.733	83°6'28.180657"	19°30'12.562603"
400	723258.486	2158603.662	83°6'26.770218"	19°30'14.664672"
401	723357.637	2158632.780	83°6'23.310589"	19°30'21.267120"
402	723587.248	2158430.064	83°6'19.892226"	19°30'21.598832"
403	723665.326	2158430.064	83°6'18.405138"	19°30'24.648226"
404	723502.169	2158584.135	83°6'14.989730"	19°30'24.135688"
405	723585.858	2158662.729	83°6'16.546159"	19°30'33.554992"
406	723727.658	2158795.451	83°6'19.433632"	19°30'36.797778"
407	723872.362	2158920.384	83°6'20.362225"	19°30'44.733012"
408	723956.048	2158966.696	83°6'20.362225"	19°30'36.580387"
409	724102.944	2159032.622	83°6'20.726407"	19°30'36.89175"
410	724161.391	2159046.055	83°6'20.36111"	19°30'35.955007"
411	724278.253	2159006.516	83°6'20.26111"	19°30'35.461720"
412	724446.754	2158916.157	83°6'19.169354"	19°30'35.692776"
413	724560.177	2158940.731	83°6'18.367654"	19°30'34.804920"
414	724564.085	2158746.148	83°6'18.371068"	19°30'34.404380"
415	724603.099	2158607.518	83°6'18.750565"	19°30'34.266880"
416	724715.776	2158967.335	83°6'17.282322"	19°30'34.82687"
417	724800.736	2159244.960	83°6'17.213707"	19°30'33.548417"
418	724832.911	2159086.088	83°6'15.011613"	19°30'33.502376"
419	724894.611	2159019.689	83°6'15.054636"	19°30'31.207111"
420	724971.212	2159014.665	83°6'17.113784"	19°30'30.555832"
421	724973.250	2159004.497	83°6'18.629703"	19°30'29.13748"
422	724984.167	2159161.401	83°6'18.601796"	19°30'27.871719"
424	725225.063	2157310.330	83°6'20.819770"	19°30'26.982289"
425	723627.524	2157286.492	83°6'21.787654"	19°30'26.895033"
426	723773.367	2157427.079	83°6'22.817363"	19°30'26.516875"
427	723886.637	2157374.031	83°6'23.598480"	19°30'25.934454"
428	723967.454	2157284.616	83°6'23.294386"	19°30'25.95018"

Area Statement

Patch No	Ror Plot No	Tenant Name	Area in Acre	Area in Hectare	DGPS Surveyed Area in Acre	DGPS Surveyed Area in Hectare
Patch-19	205	Pahada(DLC)	30.000	12.141	30.134	12.195
Patch-19	206	Pahada(DLC)	40.000	16.188	40.764	16.497
Patch-19	207	Pahada(DLC)	40.000	16.188	39.971	16.176
Patch-19	208	Pahada(DLC)	35.750	14.873	36.708	14.866
Patch-19	209	Pahada(DLC)	37.000	14.164	34.634	14.016
Patch-19	210	Pahada(DLC)	40.000	16.188	40.274	16.269
Patch-19	211	Pahada(DLC)	30.000	12.141	29.921	12.109
Patch-19	212	Pahada(DLC)	40.000	16.188	41.221	16.682
Patch-19	213	Pahada(DLC)	40.000	16.188	41.221	16.682
Patch-19	214P	Pahada(DLC)	24.250	9.814	24.031	9.725
Patch-19	245	Pahada(DLC)	53.130	21.501	51.264	20.746
Patch-19	246	Pahada(DLC)	40.000	16.188	41.379	16.746
Patch-19	248	Pahada(DLC)	40.000	16.188	40.632	16.444
Patch-19	249	Pahada(DLC)	44.500	18.009	45.209	18.295
Total Area			530.630	214.743	533.460	215.888

REVENUE DEPARTMENT
RAJAGHATTA
RAJAGHATTA
RAJAGHATTA

APPLICATION CENTRE
 Map No. FDC. 217
 Date: 09/10/2017
 Auth. Signature: [Signature]

REVENUE DEPARTMENT
 Social Planning & Research Centre Pvt. Ltd.
 E-11, 1st Floor, Panchsagar, Bhubaneswar - 751024.

DGPS Survey Conducted and Map Prepared by :-
 Spatial Planning and Mapping Centre Pvt. Ltd.,
 E/11, Antrachy, Chudaka Industrial Estate,
 Bhubaneswar - 751024.

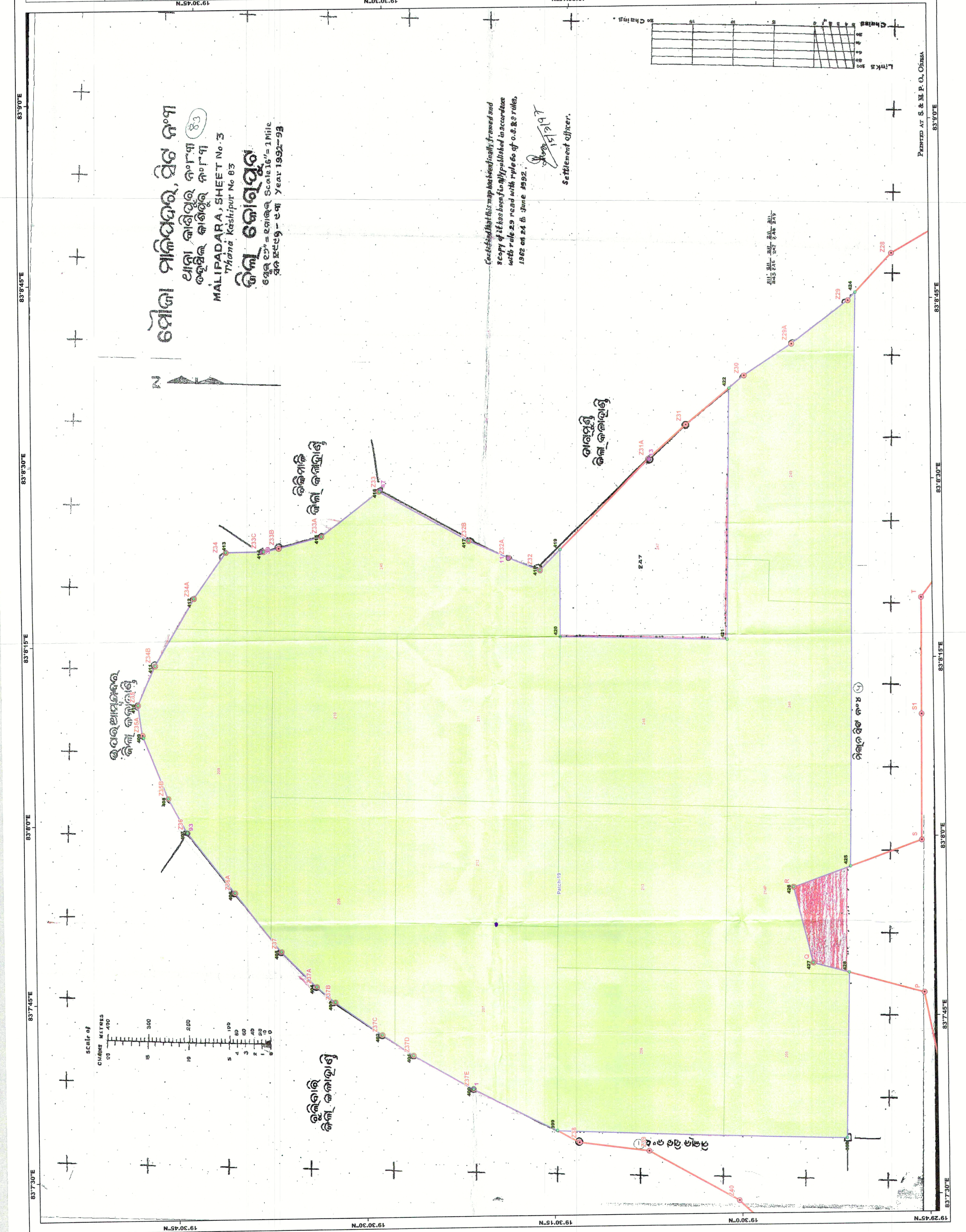

Map Showing DGPS Surveyed Co-ordinates and Boundary of Forest Area Proposed to be Diverted for M/s Larsen & Toubrol Ltd. for Bauxite over 2017.71 Acre or 816.56 Hectare in Village-Aliguna Sheet1, Tahasil-Kasipur, District-Rayagada, Forest Division-Rayagada, Odisha

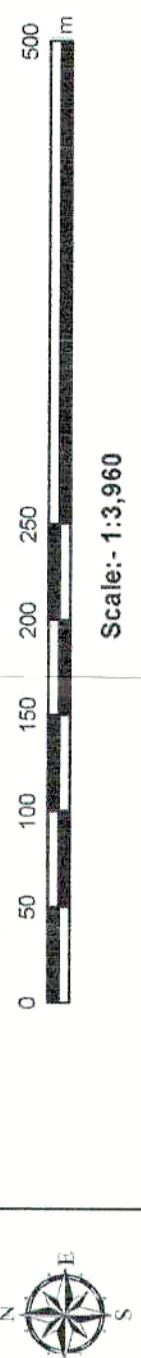

LEGEND

- Observation Point
- Forest Pillar
- ML Boundary Pillar
- Sijmail ML Boundary
- Patch Boundary
- Forest Plot(DLC)
- Forest Plot

CO-ORDINATES OF BCP/DGPS OBSERVATION POINT

OBSERVATION IN	UTM CO-ORDINATES EASTING	NORTHING	LONGITUDE	ELEVATION	HEIGHT
16	722028.486	2156979.483	N19°29'42.37566"	1014.884	950.12
18	722406.275	2156849.817	N19°29'41.25966"	1031.134	966.374
17	721755.906	2156888.188	N19°29'38.45168"	1023.216	958.45
22	722528.054	2156925.258	N19°29'11.15190"	911.571	846.812
20	721083.653	2156920.293	N19°29'11.58446"	1015.529	950.757

CO-ORDINATES OF FOREST PILLAR

Forest Pillar Id	UTM CO-ORDINATES Easting	Northing	Longitude	Latitude
475	722104.699	2156981.042	83°6'58.40688"	19°29'42.39573"
476	722027.933	2156960.358	83°6'55.76938"	19°29'42.40433"
477	721757.891	2156889.354	83°6'45.47328"	19°29'39.55513"
478	721739.662	2156853.525	83°6'45.74942"	19°29'31.89383"
479	721755.838	2156928.318	83°6'46.29277"	19°29'31.67924"
480	721874.919	2156928.940	83°6'50.37537"	19°29'31.40469"
481	722018.411	2156901.736	83°6'55.36700"	19°29'36.60080"
483	722197.543	2156959.561	83°7'1.41076"	19°29'28.98136"
484	722441.952	2156724.355	83°7'6.84190"	19°29'33.91534"
485	722529.359	2156713.380	83°7'12.84720"	19°29'33.52329"
486	722478.114	2156884.139	83°7'11.16930"	19°29'36.87953"
487	722430.073	2156822.735	83°7'9.53201"	19°29'39.42068"
488	722376.027	2156871.061	83°7'7.69697"	19°29'41.96247"
490	722306.721	2157005.952	83°7'5.33833"	19°29'43.12464"
491	722254.359	2156823.596	83°7'5.50832"	19°29'40.46813"
492	722211.148	2156804.130	83°7'1.97639"	19°29'36.60144"
493	722095.240	2156832.588	83°6'58.14688"	19°29'37.57345"
494	722095.240	2156817.496	83°6'58.50578"	19°29'40.33361"

Area Statement:-

Patch No	Ror Plot No	Tenant Name	Land Schedule Proposed		DGPS Surveyed	
			Area in Hectare	Area in Acre	Area in Hectare	Area in Acre
Patch-21	1P	Palnada(DLC)	17.750	7.183	17.442	7.059
	7P	Palnada(DLC)	18.000	7.285	17.627	7.134
	8P	Palnada(DLC)	11.500	4.654	11.338	4.588
	10P	Palnada(DLC)	0.550	0.223	1.006	0.407
Total Area			47.800	19.344	47.413	19.188



REVENUE SUPERVISOR

REVENUE SUPERVISOR ADYAKANTI

REVENUE SUPERVISOR ADYAKANTI

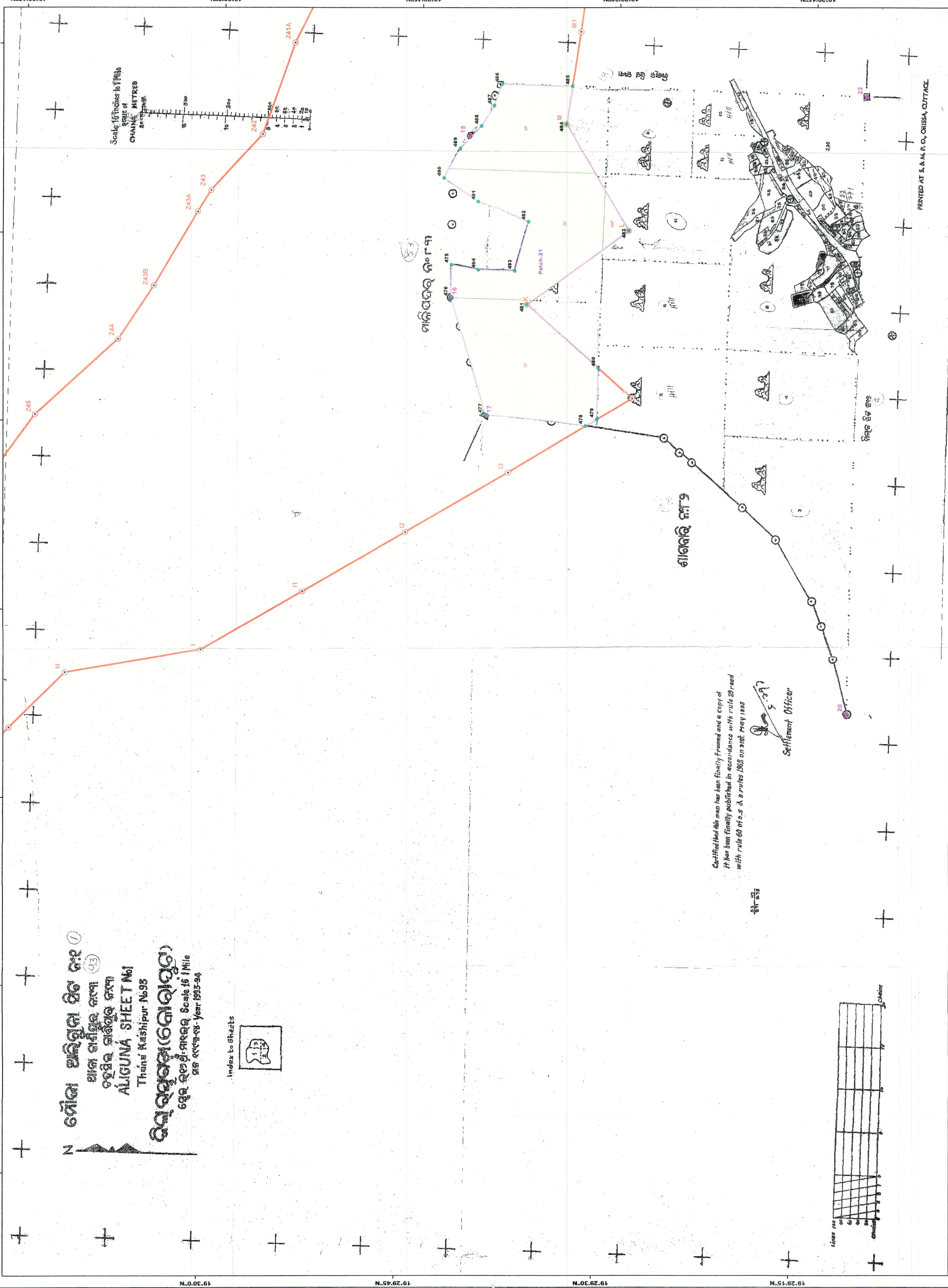

ମୌଜା ଅଭିଭୂତା ଶିଳ ନଂ ୧୧
ଅଥବା ନାମାସ୍ତ୍ରର ନମ୍ବର ୧୩
ଠହୁଣ୍ଡିର ଅଭିଭୂତ ନମ୍ବର
ALIGUNA SHEET No1
Thana Kasipur No.93
ବିଲ୍ଡିଂ ପ୍ଲାନ(ନୋରାୟର)
ଶିଳ ନଂ ୧୧-୧୧-୧୧-୧୧-୧୧-୧୧-୧୧
ସକାଳ ୧୯୯୩-୯୮-୧୧-୧୧-୧୧-୧୧-୧୧

Certified this map has been finally framed and a copy of it has been finally published in accordance with rule 291 read with rule 60 of O.S.A. & S. Rules 1963 on 28th May 1988

Settlement Officer

Index to Sheets

Sheet No	Scale	Year
1	1:50,000	1988
2	1:50,000	1988
3	1:50,000	1988
4	1:50,000	1988
5	1:50,000	1988

PRINTED AT S.A.M.P.O. CHISSA, CUTTACK.

DGPS Survey Conducted and Map Prepared by :-
Spatial Planning And Analysis Research Centre Pvt. Ltd.,
F/11, Infocity, Chandaka Industrial Estate,
Bhubaneswar - 751024.

Map Showing DGPS Surveyed Co-ordinates and Boundary of Forest Area Proposed to be Diverted for M/s Larsen & Toubro Ltd. for Bauxite over 2017.71 Acre or 816.56 Hectare in Village-Aliguna Sheet3, Tahasil-Kasipur, District-Rayagada, Forest Division-Rayagada, Odisha

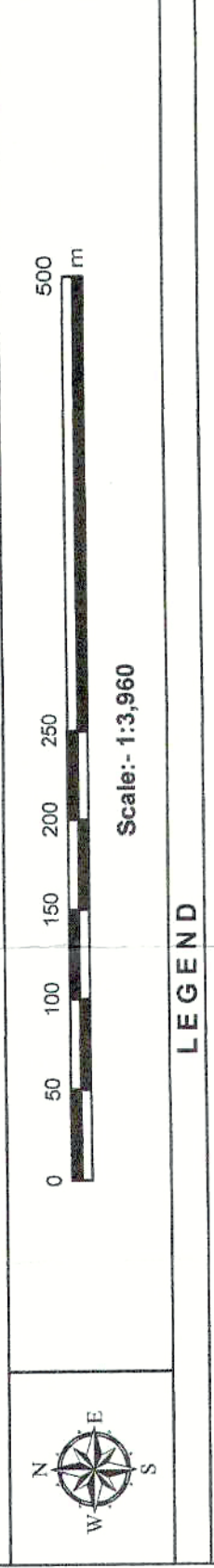

LEGEND
 Observation Point
 Forest Pillar
 ML Boundary Pillar
 Sijimal ML Boundary
 Forest Plot(DLC)
 Patch Boundary
 Forest Plot

CO-ORDINATES OF SPIDGPS OBSERVATION POINT

DGPS OBSERVATION ID	EASTING	NORTHING	LATITUDE	LONGITUDE	Elevation	Height
19	723307.068	2156289.884	N19°29'18.79172"	E83°07'39.32062"	1065.455	1004.704
88	723320.305	2156165.016	N19°29'35.04490"	E83°07'28.27186"	1034.742	969.987
18	723164.648	2156385.788	N19°29'21.96705"	E83°07'34.47908"	1039.684	974.912
21	723283.522	2156037.466	N19°29'11.24497"	E83°07'36.41485"	1052.793	986.041
22	722528.064	2156225.258	N19°29'11.15190"	E83°07'12.51142"	911.571	846.812

CO-ORDINATES OF FOREST PILLAR

Forest Pillar Id	UTM COORDINATES Easting	UTM COORDINATES Northing	UTM COORDINATES Longitude	UTM COORDINATES Latitude
486	723181.274	2156343.719	83°7'35.39463"	19°29'21.225312"
486	723156.171	2156342.705	83°7'34.178696"	19°29'21.220023"
487	723307.173	2156153.314	83°7'39.274862"	19°29'15.18107"
488	723308.137	2156108.784	83°7'39.323291"	19°29'13.553300"
500	723306.389	2156268.443	83°7'39.296877"	19°29'18.745141"
501	723194.648	2156330.592	83°7'35.492601"	19°29'20.810700"

Area Statement:-

Patch No	RoR Plot No	Tenant Name	Land Schedule Proposed		DGPS Surveyed	
			Area in Acre	Area in Hectare	Area in Acre	Area in Hectare
Patch-22	254P	Parade(DLC)	3.000	1.214	2.891	1.210
Total Area			3.000	1.214	2.891	1.210



REVENUE DIRECTOR
RAYAGADA

REVENUE DIRECTOR
RAYAGADA

Tahasil Kasipur
District Rayagada

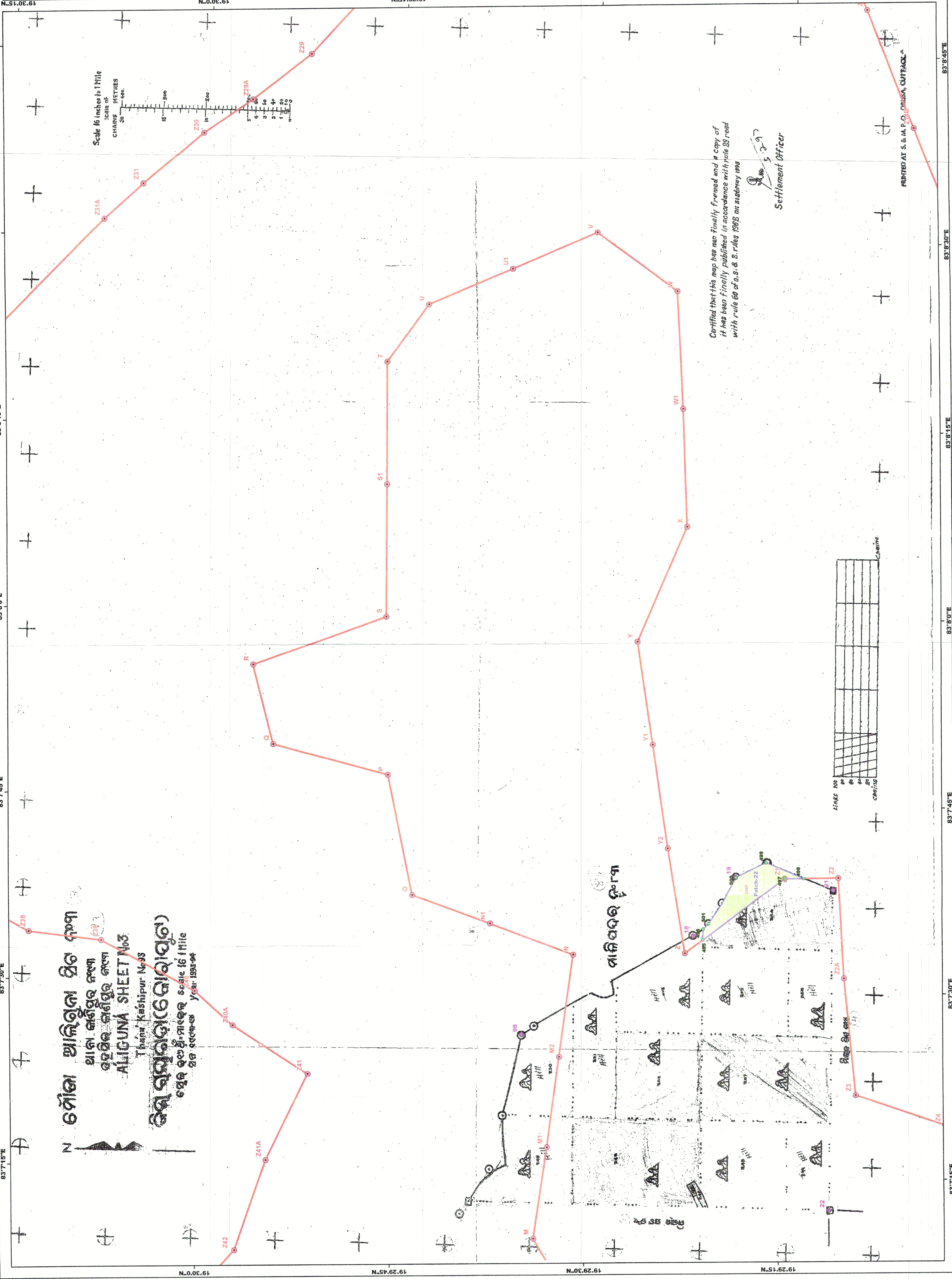

Certified that this map has been finally framed and a copy of it has been finally published in accordance with rule 83 read with rule 60 of a.s. & S. rules 1963 on 25/07/2018
 Settlement Officer

CHAINS

CHAINS	METRES
0	0
1	20
2	40
3	60
4	80
5	100
6	120
7	140
8	160
9	180
10	200

PRINTED AT S. & M. P. O. Bhubaneswar

DGPS Survey Conducted and Map Prepared by :-
 Spatial Planning And Analysis Research Centre Pvt. Ltd.,
 E/11, Indira Nagar, Bhubaneswar - 751024.

Map Showing DGPS Surveyed Co-ordinates and Boundary of Forest Area Proposed to be Diverted for M/s Larsen & Toubroltd. for Bauxite over 2017.71 Acre or 816.56 Hectare in Village-Aliguna Sheet4, Tahasil-Kasipur, District-Rayagada, Forest Division-Rayagada, Odisha

Scale: 1:5,980

LEGEND

- Observation Point
- Forest Pillar
- ML Boundary Pillar
- Sijimal ML Boundary
- Patch Boundary
- Forest Plot(DLC)
- Forest Plot

CO-ORDINATES OF SCIP/DGPS OBSERVATION POINT			
DGPS OBSERVATION ID	EASTING	NORTHING	ELEVATION
22	722528.64	2156025.68	911.571
21	722983.52	2156037.66	1052.793
46	722989.24	2156002.87	1052.651
48	723149.21	2155919.83	1045.642
53	722767.33	2155910.86	1019.81
57	722531.42	2155744.35	928.258

CO-ORDINATES OF FOREST PILLAR			
Forest Pillar Id	UTM Easting	UTM Northing	Elevation
502	722801.661	2155969.208	837.21
503	722838.395	2155973.977	837.23
504	722840.210	2155931.545	837.23
505	722789.954	2155930.449	837.21

CO-ORDINATES OF FOREST PILLAR			
Forest Pillar Id	UTM Easting	UTM Northing	Elevation
502	722801.661	2155969.208	837.21
503	722838.395	2155973.977	837.23
504	722840.210	2155931.545	837.23
505	722789.954	2155930.449	837.21

Area Statement:-

Patch No	ROR Plot No	Tenant Name	Area in Acre	Area in Hectare
Patch-23	258P	Paradar(DLC)	0.250	0.101
Total Area			0.250	0.101

Land Schedule Proposed

Area	Area in Acre	Area in Hectare
Area in Acre	0.250	0.101
Area in Hectare	0.101	0.433
Total Area	0.250	0.433

Map No. DC-23/2017
Date: 02/12/2017
Auth. Signatory: [Signature]
REVENUE INSPECTOR
Tahasil Kasipur, District Rayagada

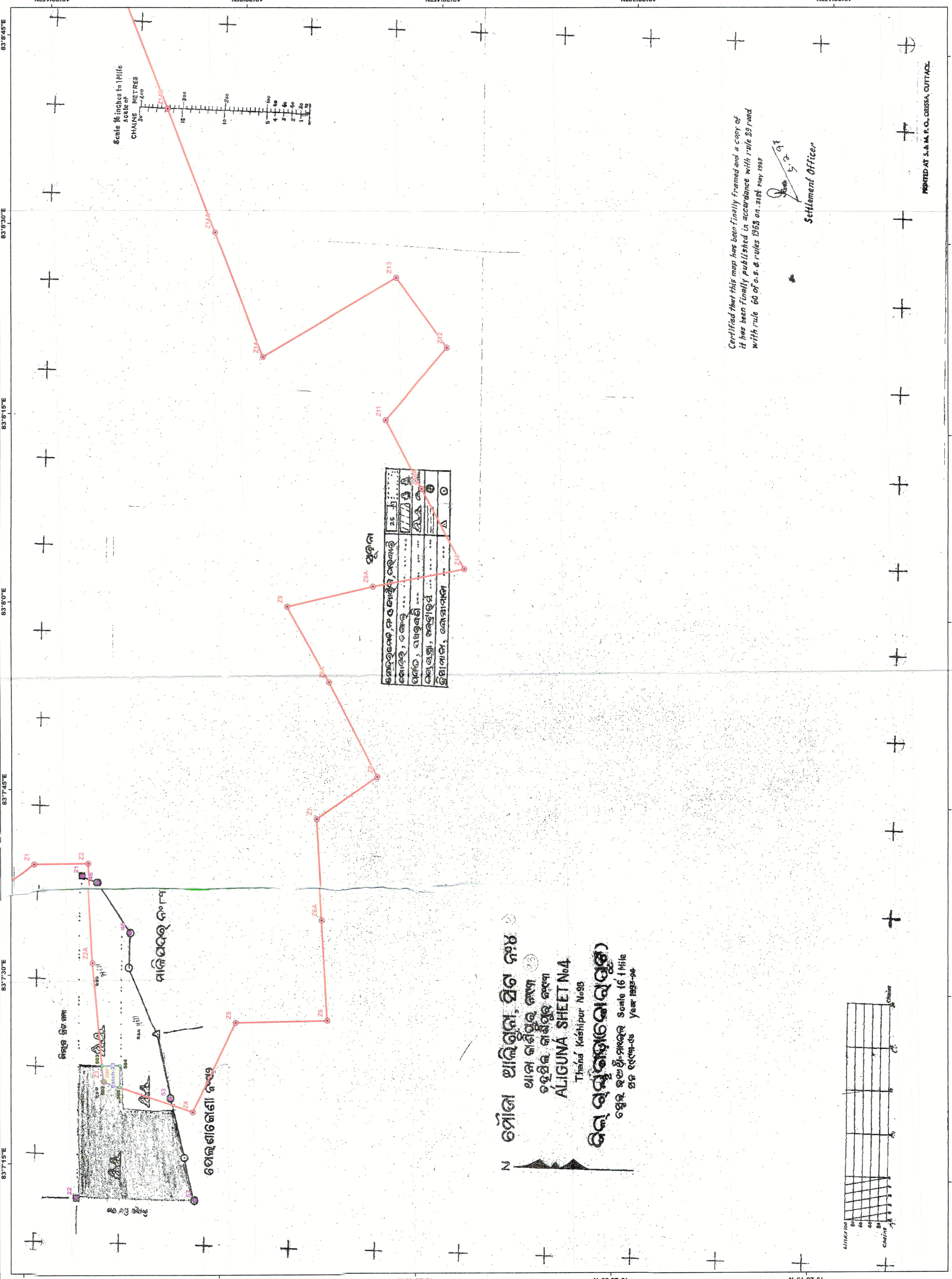

Certified that this map has been finally framed and a copy of it has been finally published in accordance with rule 89 read with rule 60 of O.S. & rules 1962 on 21st May 1993

5.2.1
Settlement Officer

ମୌଜା ଆଲିଗୁନା, ପିଟ ନଂ:୪
ଆନା ଗାଣିପୁର ଟାଣା
ହେସିଲ କାଶିପୁର ଟାଣା
ALIGUNA SHEET No.4
Thana Kasipur No-05
ଭଲ ବ୍ୟବହାରରେ ରଖାଯିବ
ସ୍କେଲ ୧:୫୯୮୦
ସନ ୧୯୯୩-୯୪



Map Showing DGPS Surveyed Co-ordinates and Boundary of Forest Area Proposed to be Diverted for M/s Larsen & Toubroltd. for Bauxite over 2017.71 Acre or 816.56 Hectare in Village-Dumerpadar S2, Tahasil-Kasipur, District-Rayagada, Forest Division-Rayagada, Odisha



LEGEND

- Observation Point
- Forest Pillar
- ML Boundary Pillar
- Sijmail ML Boundary
- Patch Boundary
- Forest Plot(DLC)

CO-ORDINATES OF SCIP/DGPS OBSERVATION POINT

DGPS OBSERVATION ID	UTM COORDINATES EASTING	NORTHING	LONGITUDE	ELEVATION	Height
32	721025.125	2156625.807	N19°30'38.33436"	988.326	923.951
33	720863.478	2156884.132	N19°30'28.51309"	962.039	927.262
35	720906.591	2156887.041	N19°30'45.08153"	923.738	888.953
36	721726.034	2156777.25	N19°30'53.94918"	914.251	849.483
34	720657.581	2156672.72	N19°30'38.13303"	964.868	920.115
12	721206.008	2156449.371	N19°30'30.48310"	992.658	927.885

CO-ORDINATES OF FOREST PILLAR

Forest Pillar Id	UTM COORDINATES Easting	NORTHING	LONGITUDE	Latitude
523	721207.636	2156609.187	83°6'28.333063"	19°30'35.686895"
524	721208.925	2156451.583	83°6'28.310814"	19°30'30.963451"
525	721286.105	2156535.488	83°6'31.63063"	19°30'33.260314"

Area Statement:-

Patch No	Roar Plot No	Tenant Name	Land Schedule Proposed Area in Hectare	DGPS Surveyed Area in Hectare	Area in Acre	Area in Hectare
Patch-25	435P	Parada(DLC)	1.560	0.631	1.508	0.610
Total Area			1.560	0.631	1.508	0.610

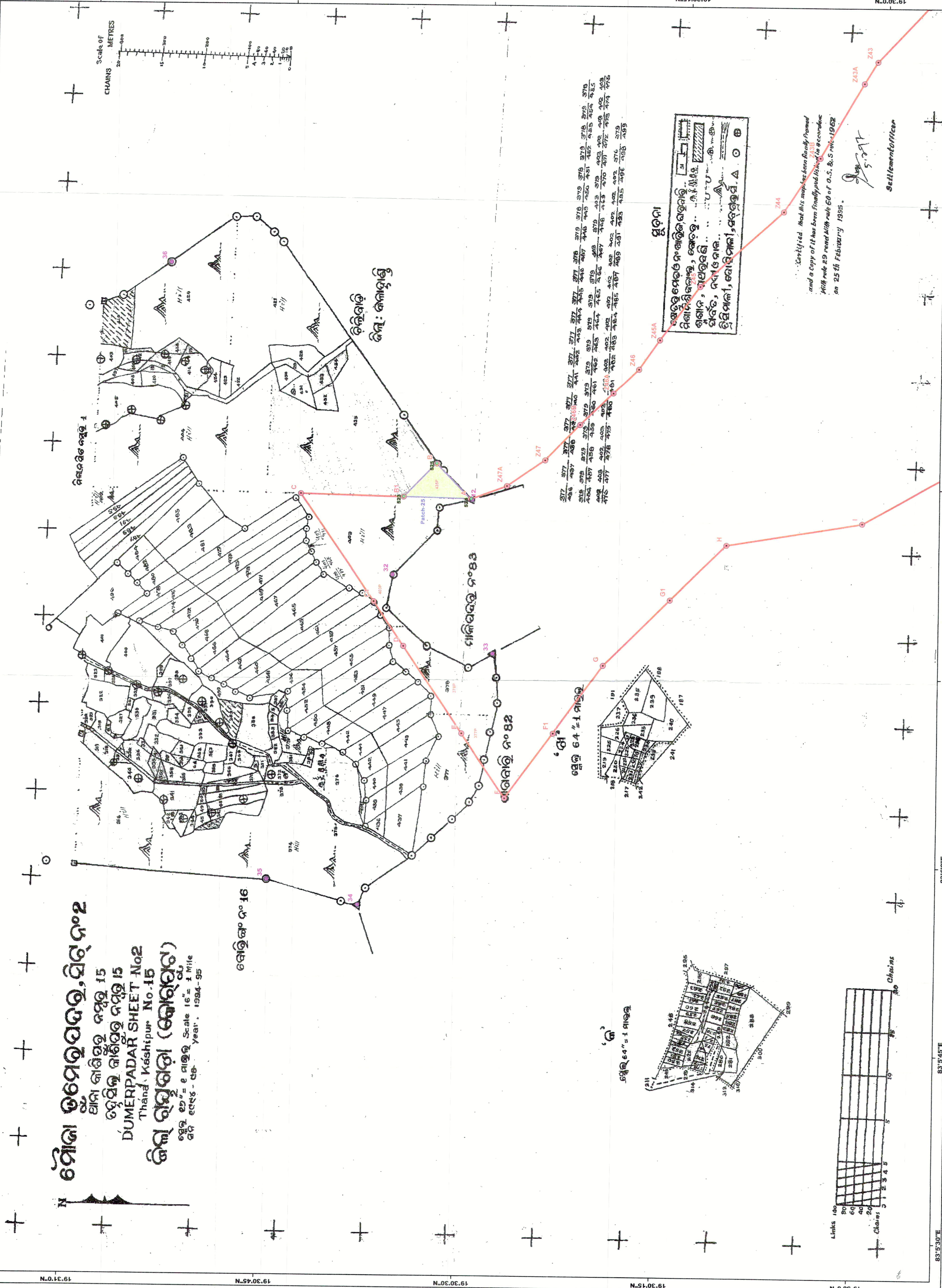

ଖୋର୍ଦ୍ଧା ନଂ ୧୬

ଖୋର୍ଦ୍ଧା ନଂ ୧୭

ଖୋର୍ଦ୍ଧା ନଂ ୧୮

ଖୋର୍ଦ୍ଧା ନଂ ୧୯

ଖୋର୍ଦ୍ଧା ନଂ ୨୦

ଖୋର୍ଦ୍ଧା ନଂ ୨୧

ଖୋର୍ଦ୍ଧା ନଂ ୨୨

ଖୋର୍ଦ୍ଧା ନଂ ୨୩

ଖୋର୍ଦ୍ଧା ନଂ ୨୪

ଖୋର୍ଦ୍ଧା ନଂ ୨୫

ଖୋର୍ଦ୍ଧା ନଂ ୨୬

ଖୋର୍ଦ୍ଧା ନଂ ୨୭

ଖୋର୍ଦ୍ଧା ନଂ ୨୮

ଖୋର୍ଦ୍ଧା ନଂ ୨୯

ଖୋର୍ଦ୍ଧା ନଂ ୩୦

ଖୋର୍ଦ୍ଧା ନଂ ୩୧

ଖୋର୍ଦ୍ଧା ନଂ ୩୨

ଖୋର୍ଦ୍ଧା ନଂ ୩୩

ଖୋର୍ଦ୍ଧା ନଂ ୩୪

ଖୋର୍ଦ୍ଧା ନଂ ୩୫

ଖୋର୍ଦ୍ଧା ନଂ ୩୬

ଖୋର୍ଦ୍ଧା ନଂ ୩୭

ଖୋର୍ଦ୍ଧା ନଂ ୩୮

ଖୋର୍ଦ୍ଧା ନଂ ୩୯

ଖୋର୍ଦ୍ଧା ନଂ ୪୦

ଖୋର୍ଦ୍ଧା ନଂ ୪୧

ଖୋର୍ଦ୍ଧା ନଂ ୪୨

ଖୋର୍ଦ୍ଧା ନଂ ୪୩

ଖୋର୍ଦ୍ଧା ନଂ ୪୪

ଖୋର୍ଦ୍ଧା ନଂ ୪୫

ଖୋର୍ଦ୍ଧା ନଂ ୪୬

ଖୋର୍ଦ୍ଧା ନଂ ୪୭

ଖୋର୍ଦ୍ଧା ନଂ ୪୮

ଖୋର୍ଦ୍ଧା ନଂ ୪୯

ଖୋର୍ଦ୍ଧା ନଂ ୫୦

ଖୋର୍ଦ୍ଧା ନଂ ୫୧

ଖୋର୍ଦ୍ଧା ନଂ ୫୨

ଖୋର୍ଦ୍ଧା ନଂ ୫୩

ଖୋର୍ଦ୍ଧା ନଂ ୫୪

ଖୋର୍ଦ୍ଧା ନଂ ୫୫

ଖୋର୍ଦ୍ଧା ନଂ ୫୬

ଖୋର୍ଦ୍ଧା ନଂ ୫୭

ଖୋର୍ଦ୍ଧା ନଂ ୫୮

ଖୋର୍ଦ୍ଧା ନଂ ୫୯

ଖୋର୍ଦ୍ଧା ନଂ ୬୦

ଖୋର୍ଦ୍ଧା ନଂ ୬୧

ଖୋର୍ଦ୍ଧା ନଂ ୬୨

ଖୋର୍ଦ୍ଧା ନଂ ୬୩

ଖୋର୍ଦ୍ଧା ନଂ ୬୪

ଖୋର୍ଦ୍ଧା ନଂ ୬୫

ଖୋର୍ଦ୍ଧା ନଂ ୬୬

ଖୋର୍ଦ୍ଧା ନଂ ୬୭

ଖୋର୍ଦ୍ଧା ନଂ ୬୮

ଖୋର୍ଦ୍ଧା ନଂ ୬୯

ଖୋର୍ଦ୍ଧା ନଂ ୭୦

ଖୋର୍ଦ୍ଧା ନଂ ୭୧

ଖୋର୍ଦ୍ଧା ନଂ ୭୨

ଖୋର୍ଦ୍ଧା ନଂ ୭୩

ଖୋର୍ଦ୍ଧା ନଂ ୭୪

ଖୋର୍ଦ୍ଧା ନଂ ୭୫

ଖୋର୍ଦ୍ଧା ନଂ ୭୬

ଖୋର୍ଦ୍ଧା ନଂ ୭୭

ଖୋର୍ଦ୍ଧା ନଂ ୭୮

ଖୋର୍ଦ୍ଧା ନଂ ୭୯

ଖୋର୍ଦ୍ଧା ନଂ ୮୦

ଖୋର୍ଦ୍ଧା ନଂ ୮୧

ଖୋର୍ଦ୍ଧା ନଂ ୮୨

ଖୋର୍ଦ୍ଧା ନଂ ୮୩

ଖୋର୍ଦ୍ଧା ନଂ ୮୪

ଖୋର୍ଦ୍ଧା ନଂ ୮୫

ଖୋର୍ଦ୍ଧା ନଂ ୮୬

ଖୋର୍ଦ୍ଧା ନଂ ୮୭

ଖୋର୍ଦ୍ଧା ନଂ ୮୮

ଖୋର୍ଦ୍ଧା ନଂ ୮୯

ଖୋର୍ଦ୍ଧା ନଂ ୯୦

ଖୋର୍ଦ୍ଧା ନଂ ୯୧

ଖୋର୍ଦ୍ଧା ନଂ ୯୨

ଖୋର୍ଦ୍ଧା ନଂ ୯୩

ଖୋର୍ଦ୍ଧା ନଂ ୯୪

ଖୋର୍ଦ୍ଧା ନଂ ୯୫

ଖୋର୍ଦ୍ଧା ନଂ ୯୬

ଖୋର୍ଦ୍ଧା ନଂ ୯୭

ଖୋର୍ଦ୍ଧା ନଂ ୯୮

ଖୋର୍ଦ୍ଧା ନଂ ୯୯

ଖୋର୍ଦ୍ଧା ନଂ ୧୦୦

ଖୋର୍ଦ୍ଧା ନଂ ୧୬

ଖୋର୍ଦ୍ଧା ନଂ ୧୭

ଖୋର୍ଦ୍ଧା ନଂ ୧୮

ଖୋର୍ଦ୍ଧା ନଂ ୧୯

ଖୋର୍ଦ୍ଧା ନଂ ୨୦

ଖୋର୍ଦ୍ଧା ନଂ ୨୧

ଖୋର୍ଦ୍ଧା ନଂ ୨୨

ଖୋର୍ଦ୍ଧା ନଂ ୨୩

ଖୋର୍ଦ୍ଧା ନଂ ୨୪

ଖୋର୍ଦ୍ଧା ନଂ ୨୫

ଖୋର୍ଦ୍ଧା ନଂ ୨୬

ଖୋର୍ଦ୍ଧା ନଂ ୨୭

ଖୋର୍ଦ୍ଧା ନଂ ୨୮

ଖୋର୍ଦ୍ଧା ନଂ ୨୯

ଖୋର୍ଦ୍ଧା ନଂ ୩୦

ଖୋର୍ଦ୍ଧା ନଂ ୩୧

ଖୋର୍ଦ୍ଧା ନଂ ୩୨

ଖୋର୍ଦ୍ଧା ନଂ ୩୩

ଖୋର୍ଦ୍ଧା ନଂ ୩୪

ଖୋର୍ଦ୍ଧା ନଂ ୩୫

ଖୋର୍ଦ୍ଧା ନଂ ୩୬

ଖୋର୍ଦ୍ଧା ନଂ ୩୭

ଖୋର୍ଦ୍ଧା ନଂ ୩୮

ଖୋର୍ଦ୍ଧା ନଂ ୩୯

ଖୋର୍ଦ୍ଧା ନଂ ୪୦

ଖୋର୍ଦ୍ଧା ନଂ ୪୧

ଖୋର୍ଦ୍ଧା ନଂ ୪୨

ଖୋର୍ଦ୍ଧା ନଂ ୪୩

ଖୋର୍ଦ୍ଧା ନଂ ୪୪

ଖୋର୍ଦ୍ଧା ନଂ ୪୫

ଖୋର୍ଦ୍ଧା ନଂ ୪୬

ଖୋର୍ଦ୍ଧା ନଂ ୪୭

ଖୋର୍ଦ୍ଧା ନଂ ୪୮

ଖୋର୍ଦ୍ଧା ନଂ ୪୯

ଖୋର୍ଦ୍ଧା ନଂ ୫୦

ଖୋର୍ଦ୍ଧା ନଂ ୫୧

ଖୋର୍ଦ୍ଧା ନଂ ୫୨

ଖୋର୍ଦ୍ଧା ନଂ ୫୩

ଖୋର୍ଦ୍ଧା ନଂ ୫୪

ଖୋର୍ଦ୍ଧା ନଂ ୫୫

ଖୋର୍ଦ୍ଧା ନଂ ୫୬

ଖୋର୍ଦ୍ଧା ନଂ ୫୭

ଖୋର୍ଦ୍ଧା ନଂ ୫୮

ଖୋର୍ଦ୍ଧା ନଂ ୫୯

ଖୋର୍ଦ୍ଧା ନଂ ୬୦

ଖୋର୍ଦ୍ଧା ନଂ ୬୧

ଖୋର୍ଦ୍ଧା ନଂ ୬୨

ଖୋର୍ଦ୍ଧା ନଂ ୬୩

ଖୋର୍ଦ୍ଧା ନଂ ୬୪

ଖୋର୍ଦ୍ଧା ନଂ ୬୫

ଖୋର୍ଦ୍ଧା ନଂ ୬୬

ଖୋର୍ଦ୍ଧା ନଂ ୬୭

ଖୋର୍ଦ୍ଧା ନଂ ୬୮

ଖୋର୍ଦ୍ଧା ନଂ ୬୯

ଖୋର୍ଦ୍ଧା ନଂ ୭୦

ଖୋର୍ଦ୍ଧା ନଂ ୭୧

ଖୋର୍ଦ୍ଧା ନଂ ୭୨

ଖୋର୍ଦ୍ଧା ନଂ ୭୩

ଖୋର୍ଦ୍ଧା ନଂ ୭୪

ଖୋର୍ଦ୍ଧା ନଂ ୭୫

ଖୋର୍ଦ୍ଧା ନଂ ୭୬

ଖୋର୍ଦ୍ଧା ନଂ ୭୭

ଖୋର୍ଦ୍ଧା ନଂ ୭୮

ଖୋର୍ଦ୍ଧା ନଂ ୭୯

ଖୋର୍ଦ୍ଧା ନଂ ୮୦

ଖୋର୍ଦ୍ଧା ନଂ ୮୧

ଖୋର୍ଦ୍ଧା ନଂ ୮୨

ଖୋର୍ଦ୍ଧା ନଂ ୮୩

ଖୋର୍ଦ୍ଧା ନଂ ୮୪

ଖୋର୍ଦ୍ଧା ନଂ ୮୫

ଖୋର୍ଦ୍ଧା ନଂ ୮୬

ଖୋର୍ଦ୍ଧା ନଂ ୮୭

ଖୋର୍ଦ୍ଧା ନଂ ୮୮

ଖୋର୍ଦ୍ଧା ନଂ ୮୯

ଖୋର୍ଦ୍ଧା ନଂ ୯୦

ଖୋର୍ଦ୍ଧା ନଂ ୯୧

ଖୋର୍ଦ୍ଧା ନଂ ୯୨

ଖୋର୍ଦ୍ଧା ନଂ ୯୩

ଖୋର୍ଦ୍ଧା ନଂ ୯୪

ଖୋର୍ଦ୍ଧା ନଂ ୯୫

ଖୋର୍ଦ୍ଧା ନଂ ୯୬

ଖୋର୍ଦ୍ଧା ନଂ ୯୭

ଖୋର୍ଦ୍ଧା ନଂ ୯୮

ଖୋର୍ଦ୍ଧା ନଂ ୯୯

ଖୋର୍ଦ୍ଧା ନଂ ୧୦୦

DGPS Survey Conducted and Map Prepared by :-
 Spatial Planning And Analysis Research Centre Pvt. Ltd.,
 E/11, Infocity, Chandaka Industrial Estate,
 Bhubaneswar - 751024.

Map Showing DGPS Surveyed Co-ordinates and Boundary of Forest Area Proposed to be Diverted for M/s Larsen & Toubro Ltd. for Bauxite over 2017.71 Acre or 816.56 Hectare in Village-Katibhata S1, Tahasil-Kasipur, District-Rayagada, Forest Division-Rayagada, Odisha

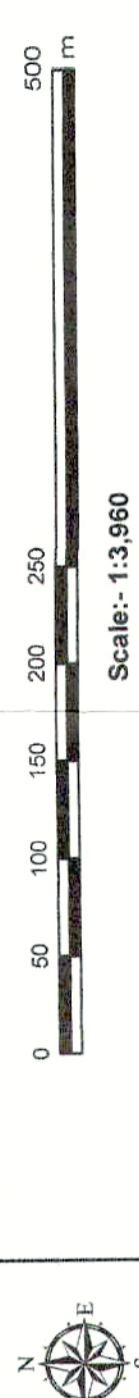

LEGEND

- Observation Point
- Forest Pillar
- M.L. Boundary Pillar
- Sijimal M.L. Boundary
- Patch Boundary
- Forest Plot(DLC)
- Forest Plot

DGPS OBSERVATION POINT		GEOGRAPHIC CO-ORDINATES		Elevation	Height
ID	EASTING	NORTHING	LATITUDE	LONGITUDE	
99	722723.786	2155278.669	N19°28'46.80055"	E83°07'18.90479"	837.928
107	723043.172	2154672.038	N19°28'26.94985"	E83°07'29.59611"	843.5
110	723142.293	2155558.852	N19°28'55.74143"	E83°07'33.37016"	1035.468
99	723070.477	2155641.689	N19°28'58.44858"	E83°07'30.94321"	1032.016
124	722109.864	2154688.42	N19°28'41.93359"	E83°06'57.56186"	820.021
103	723151.13	2155133.332	N19°28'41.93359"	E83°07'33.46251"	859.718
526	722955.459	2155549.480	N19°28'26.967408"	E83°07'18.90479"	837.928
527	723075.570	2155558.081	N19°28'26.967408"	E83°07'18.90479"	837.928
528	723142.797	2155552.403	N19°28'55.74143"	E83°07'33.37016"	1035.468
529	723343.540	2155507.736	N19°28'40.28861"	E83°07'30.94321"	1032.016
531	723282.468	2155475.736	N19°28'35.140181"	E83°07'30.94321"	1032.016
532	722961.428	2155446.221	N19°28'26.967408"	E83°07'18.90479"	837.928

CO-ORDINATES OF FOREST PILLAR		GEO-GRAPHIC COORDINATES	
Forest Pillar Id	UTM Easting	UTM Northing	Latitude
526	722955.459	2155549.480	N19°28'26.967408"
527	723075.570	2155558.081	N19°28'26.967408"
528	723142.797	2155552.403	N19°28'55.74143"
529	723343.540	2155507.736	N19°28'40.28861"
531	723282.468	2155475.736	N19°28'35.140181"
532	722961.428	2155446.221	N19°28'26.967408"

Area Statement:-		Land Schedule Proposed		DGPS Surveyed	
Patch No	RoR Plot No	Area in Hectare	Area in Acre	Area in Hectare	Area in Acre
Patch-26	1	13.000	5.261	11.257	4.856
Total Area		13.000	5.261	11.257	4.856

APPROVED
 REFERENCE INSPECTOR
 SUPERVISOR
 SUPERVISOR
 SUPERVISOR

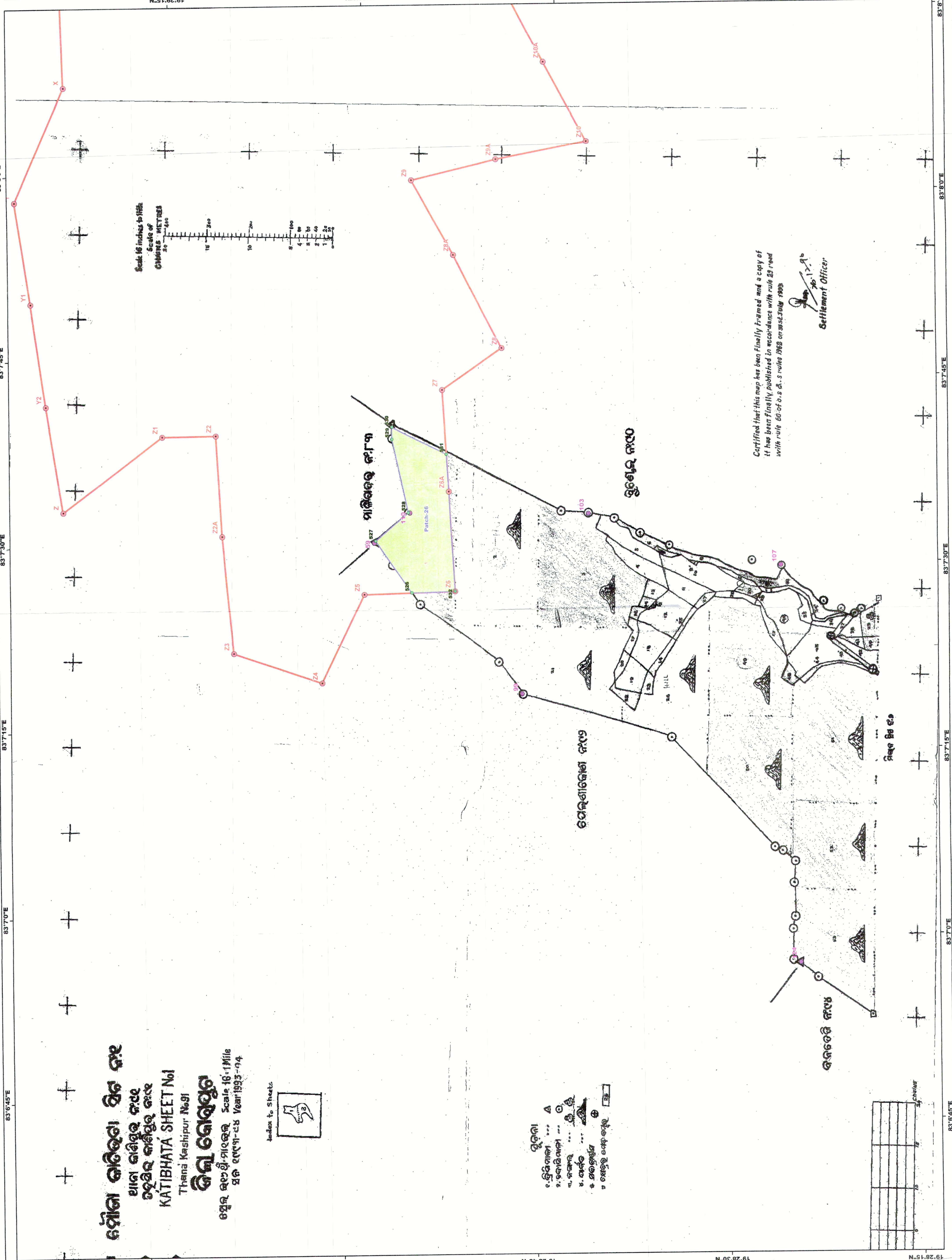

ଶୌଚିତ୍ର କାଟିଭତା ସିନ କାସିପୁର
 ଥାନା କାଟିଭତା ଗଡ଼ଜାତ
 ଉତ୍କଳ ବିଭାଗ
KATIBHATA SHEET No.1
 Thana Kasipur No.91
କିମ୍ପା ଗୋଷ୍ଠୀ
 ସ୍କେଲ୍ ୧:୫୦୦୦୦ Scale 1:50,000
 ପ୍ରଥମ ପାଠ୍ୟ ୧୯୯୩-୯୪ Year 1993-94

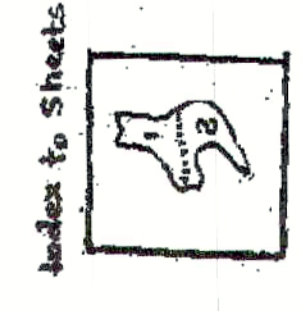

- ସୂଚନା**
- ୧. ଶୁଣାମାଳା
 - ୨. ଚାକାମାଳା
 - ୩. ଚାକା
 - ୪. ଚାକା
 - ୫. ଚାକା
 - ୬. ଚାକା

Certified that this map has been finally framed and a copy of it has been finally published in accordance with rule 83 read with rule 60 of G.S.O. 5 rules 1988 on 23.04.1993

[Signature]
 Settlement Officer

Map Showing DGPS Surveyed Co-ordinates and Boundary of Forest Area Proposed to be Diverted for M/s Larsen & Toubroltd. for Bauxite over 2017.71 Acre or 816.56 Hectare in Village-Kutamala S1, Tahasil-Kasipur, District-Rayagada, Forest Division-Rayagada, Odisha

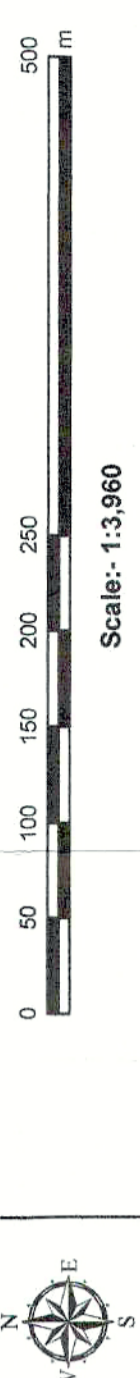

Scale: 1:3,980

LEGEND
 Observation Point
 Forest Pillar
 M.L. Boundary Pillar
 Sijmali M.L. Boundary
 Patch Boundary
 Forest Plot(DLC)
 Forest Plot

CO-ORDINATES OF SCD/DGPS OBSERVATION POINT

DGPS OBSERVATION ID	UTM CO-ORDINATES	GEOGRAPHIC CO-ORDINATES	Elevation	Height
	EASTING	NORTHING	LATITUDE	LONGITUDE
122	726134.14	2156307.96	N19°29'16.25361"	E83°09'16.25361"
119	725722.406	2156749.875	N19°29'33.41914"	E83°09'02.32686"
148	726398.33	2156086.348	N19°29'11.63560"	E83°09'25.21560"
37	725541.882	2156873.333	N19°29'37.50538"	E83°08'56.19287"
137	725229.189	2156578.14	N19°29'28.03588"	E83°08'45.34575"
157	725202.629	2156012.282	N19°29'09.64976"	E83°08'44.19342"

CO-ORDINATES OF FOREST PILLAR

Forest Pillar Id	UTM COORDINATES	GEOGRAPHIC COORDINATES	Latitude	Longitude
	Easting	Northing	Latitude	Longitude
533	725256.372	2156618.096	83°08'46.295432"	19°29'29.323522"
534	725299.447	2156625.891	83°08'47.775483"	19°29'29.559443"
535	725303.269	2156610.510	83°08'47.643744"	19°29'29.551237"
536	725341.701	2156614.786	83°08'48.962029"	19°29'29.673985"
537	725846.589	2156228.828	83°08'36.1983"	19°29'16.427850"
538	725947.691	2156152.680	83°08'39.795173"	19°29'13.911302"
539	726194.206	2156142.080	83°08'16.241389"	19°29'13.468524"
540	726232.003	2156026.257	83°08'19.487226"	19°29'09.686885"
541	726439.019	2156033.564	83°08'26.587029"	19°29'09.837912"
542	726402.549	2156088.991	83°08'25.380716"	19°29'11.654778"
543	726238.624	2156144.357	83°08'19.765057"	19°29'13.521721"
544	726174.074	2156237.465	83°08'17.582290"	19°29'16.575077"
545	726094.423	2156252.995	83°08'14.238689"	19°29'21.782900"
546	725893.658	2156265.416	83°08'05.333000"	19°29'27.862900"
547	725893.658	2156265.416	83°08'05.333000"	19°29'27.862900"
548	725699.862	2156298.395	83°08'03.236687"	19°29'26.209200"
549	725543.111	2156283.591	83°08'04.235096"	19°29'27.510338"
550	725393.682	2156276.571	83°08'03.358011"	19°29'23.944423"

Area Statement:-

Patch No	RoR Plot No	Land Schedule Proposed		DGPS Surveyed	
		Area in Hectare	Area in Acre	Area in Hectare	Area in Acre
1	Pahada(DLC)	13.000	5.281	13.229	5.354
2	Pahada(DLC)	10.000	4.047	10.081	4.080
3	Pahada(DLC)	10.000	4.047	10.034	4.061
4	Pahada(DLC)	7.000	2.833	7.059	2.857
5	Pahada(DLC)	12.700	5.140	12.401	5.019
6	Pahada(DLC)	10.000	4.047	10.228	4.139
7	Pahada(DLC)	10.150	4.108	10.295	4.166
8P	Pahada(DLC)	8.000	3.238	6.826	2.762
9P	Pahada(DLC)	2.900	1.174	3.796	1.536
10P	Pahada(DLC)	0.650	0.344	1.230	0.488
11P	Pahada(DLC)	5.400	2.185	4.824	1.952
12	Pahada(DLC)	10.000	4.047	10.256	4.150
13	Pahada(DLC)	10.000	4.047	10.279	4.160
14P	Pahada(DLC)	9.000	3.642	8.822	3.570
Total Area		119.000	48.159	119.361	48.309



RESEARCHER
 SUNJER
 REFERENCE NO. 10/2017
 Date: 07/02/2017
 Map No. FD-314
 Auth. Section
 10/10/17

Tahasil Kasipur
 District Rayagada

DGPS Survey Conducted and Map Prepared by :-
 Spatial Planning And Analysis Research Centre Pvt. Ltd.,
 E/11, Infocity, Chandaka Industrial Estate,
 Bhubaneswar - 751024.

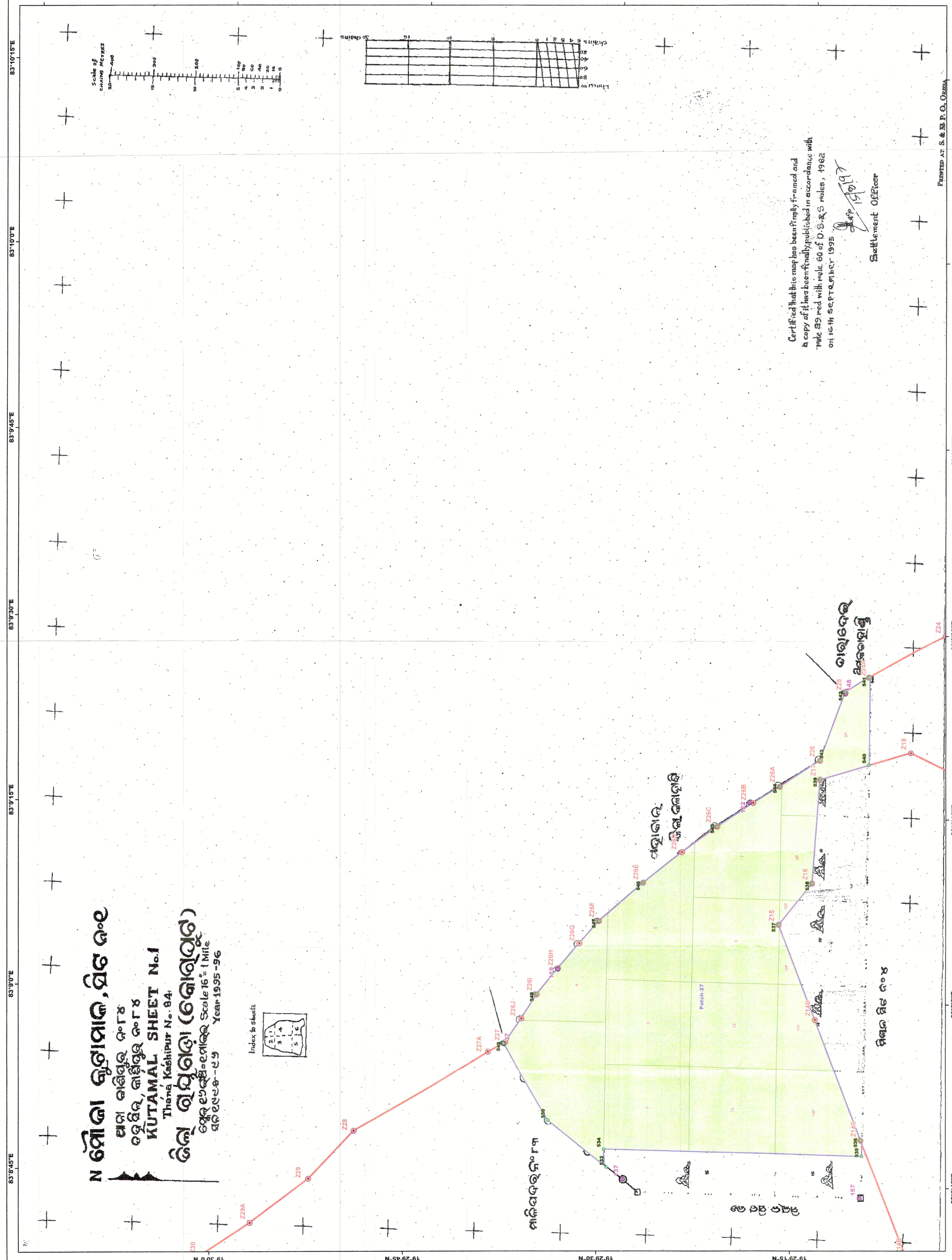

Certified that this map has been finally framed and a copy of it has been finally published in accordance with rule 29 read with rule 60 of O.S.S. rules, 1962 on 15th September 1995.

Settlement Officer

Map Showing DGPS Surveyed Co-ordinates and Boundary of Forest Area Proposed to be Diverted for M/s Larsen & Toubro Ltd. for Bauxite over 2017.71 Acre or 816.56 Hectare in Village-Kutamala S2, Tahasil-Kasipur, District-Rayagada, Forest Division-Rayagada, Odisha

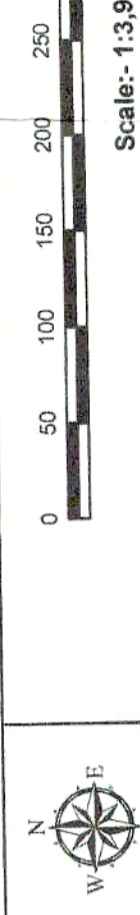

Scale: 1:33,960

LEGEND
 Observation Point
 Forest Pillar
 ML Boundary Pillar
 Sijimal ML Boundary
 Patch Boundary
 Forest Plot(DLC)
 Forest Plot

DGPS OBSERVATION ID	EASTING	NORTHING	LATITUDE	LONGITUDE	Elevation	Height
137	725229.169	2155578.14	N19°29'28.03558"	E83°08'45.34575"	1194.774	1130.039
142	724609.413	2155593.748	N19°29'09.28791"	E83°08'23.84948"	1148.1	1083.36
144	724027.027	2156042.47	N19°29'11.10761"	E83°08'03.90536"	1117.395	1052.65

Forest Pillar Id	UTM COORDINATES		GEO-GRAPHIC COORDINATES	
	Easting	Northing	Longitude	Latitude
CO-ORDINATES OF FOREST PILLAR				
Patch-28				
551	725201.645	2156543.447	83°04' 387.306"	19°29'26.918865"
552	725201.730	2156214.922	83°04' 249.441"	19°29'16.238159"
553	725000.088	2156211.726	83°03' 335.649"	19°29'16.216142"
554	725002.206	2156008.344	83°03' 321.037"	19°29'09.603143"
555	724736.201	2155968.388	83°02' 196.699"	19°29'03.27684"
556	724623.680	2156003.197	83°02' 342.916"	19°29'03.56315"
557	724784.034	2156123.107	83°02' 800.932"	19°29'13.419464"
558	724873.712	2156183.270	83°02' 900.995"	19°29'15.342323"
559	724878.088	2156289.123	83°02' 610.624"	19°29'16.446131"

Area Statement:-

Patch No	Roat Plot No	Tenant Name	Land Schedule Proposed		DGPS Surveyed	
			Area in Hectare	Area in Acre	Area in Hectare	Area in Hectare
Patch-28	17	Parada(DLC)	11.130	4.504	11.117	4.469
	19	Parada(DLC)	12.250	4.958	12.170	4.925
Total Area			23.380	9.462	23.286	9.404



Revenue Inspector
 District Rayagada

Settlement Officer

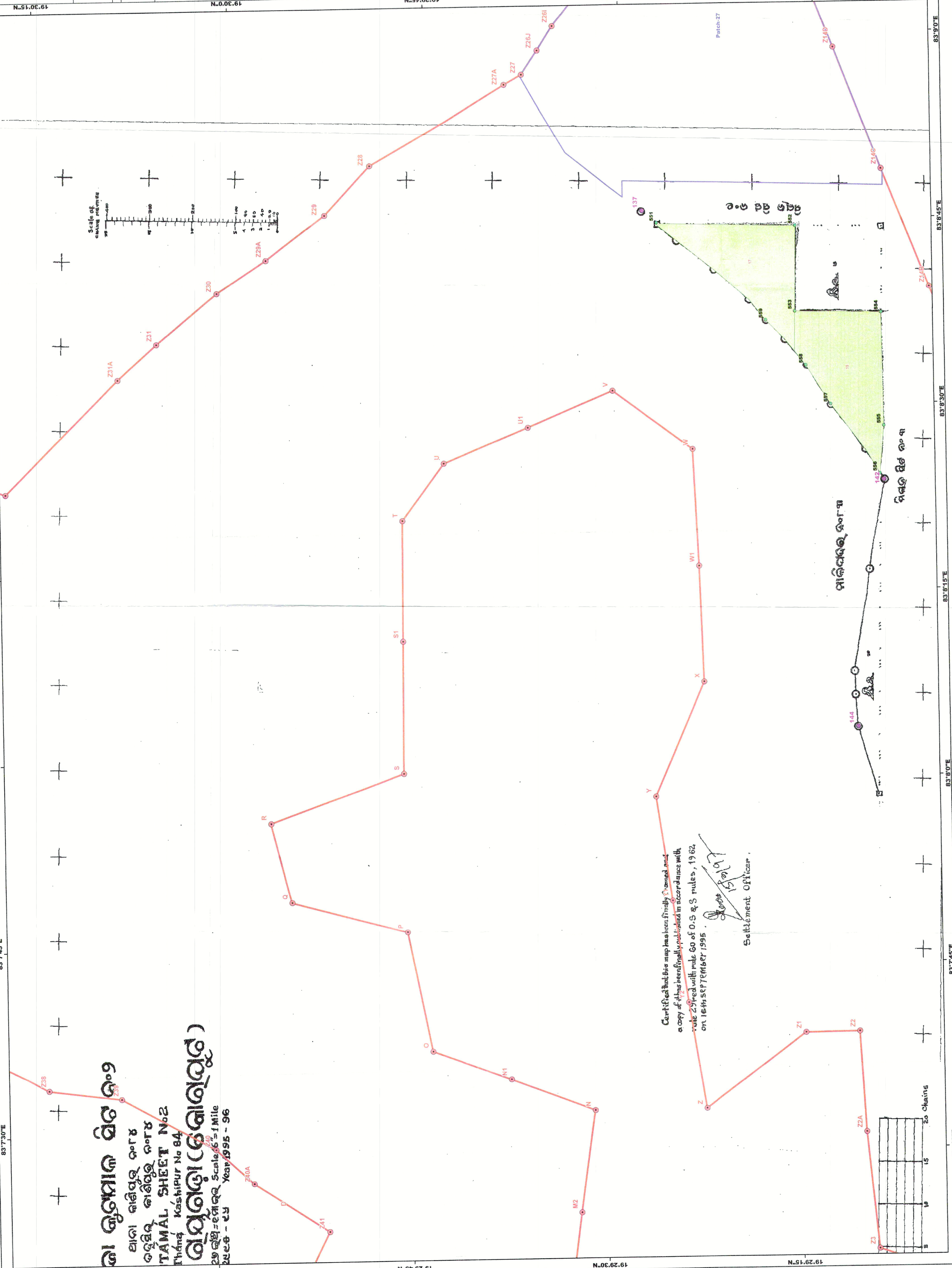

ଜାତୀୟ ମାପ
 ଜାତୀୟ ମାପ
TAMAL SHEET No.2
 Tahasil Kasipur No 84
ଜାତୀୟ ମାପ
 Scale 1:33,960
 Year 1995 - 96

Certified that this map has been finally examined and a copy of the same has been published in accordance with the Survey Act with rule 60 of O.S. & S. rules, 1962 on 16th SEPTEMBER 1995.
 Settlement Officer

1	2	3	4	5	6	7	8	9	10	11	12	13	14	15	16	17	18	19	20
---	---	---	---	---	---	---	---	---	----	----	----	----	----	----	----	----	----	----	----

