

# Upgradation of 4 - Lane with Paved shoulder of Bhiwani - Bawani khera - Hansi road section of NH 148B Under Bharatmala Pariyojana in the State of Haryana on EPC Mode: Georeferenced (DGPS) Map under Forest Division Hisar

**Segment- 28**

76°0'10"E

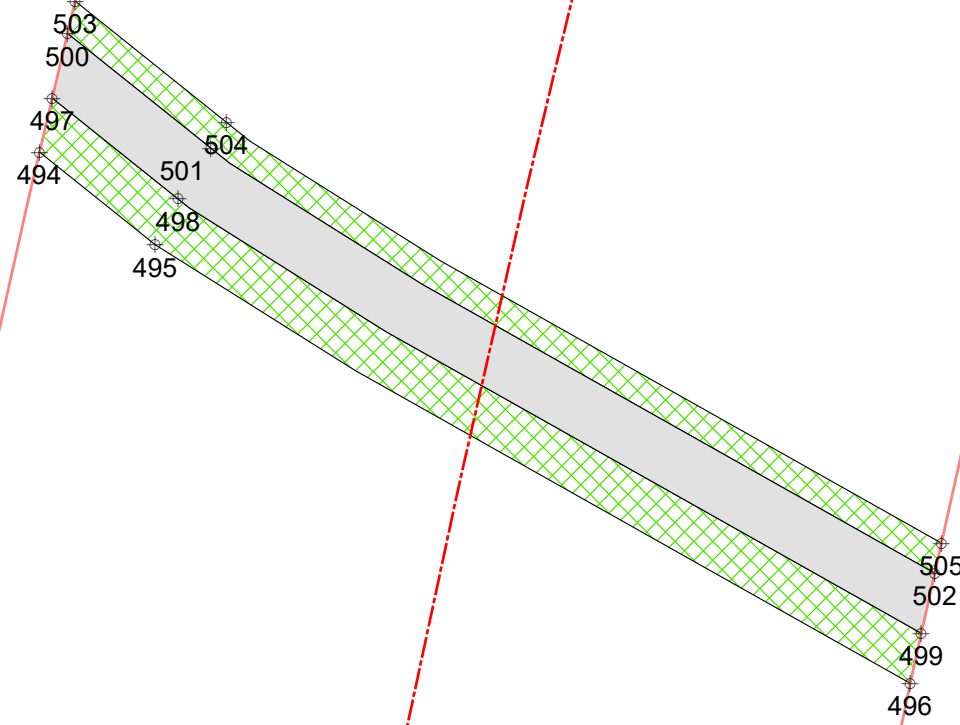

**Forest Area Coordinates  
(Generated in GIS)**

Id	Latitude	Longitude
494	29° 3' 53.918" N	76° 0' 10.832" E
495	29° 3' 53.760" N	76° 0' 11.030" E
496	29° 3' 53.009" N	76° 0' 12.323" E
497	29° 3' 54.011" N	76° 0' 10.853" E
498	29° 3' 53.838" N	76° 0' 11.069" E
499	29° 3' 53.095" N	76° 0' 12.342" E
500	29° 3' 54.122" N	76° 0' 10.880" E
501	29° 3' 53.925" N	76° 0' 11.125" E
502	29° 3' 53.197" N	76° 0' 12.365" E
503	29° 3' 54.177" N	76° 0' 10.893" E
504	29° 3' 53.970" N	76° 0' 11.152" E
505	29° 3' 53.249" N	76° 0' 12.377" E

●38+300

76°0'10"E

**Legend**

- ⊕ GPS ID
- Chainage
- PROW
- Road Centreline
- Existing Road
- Protected Forest to be Diverted
- Forest Land Already Diverted
- Water Body

  
 Project Director  
 NHAI, PIU-BHIWANI

0      12.5      25      50 Meters

# Upgradation of 4 - Lane with Paved shoulder of Bhiwani - Bawani khera - Hansi road section of NH 148B Under Bharatmala Pariyojana in the State of Haryana on EPC Mode: Georeferenced (DGPS) Map under Forest Division Hisar

Segment- 29

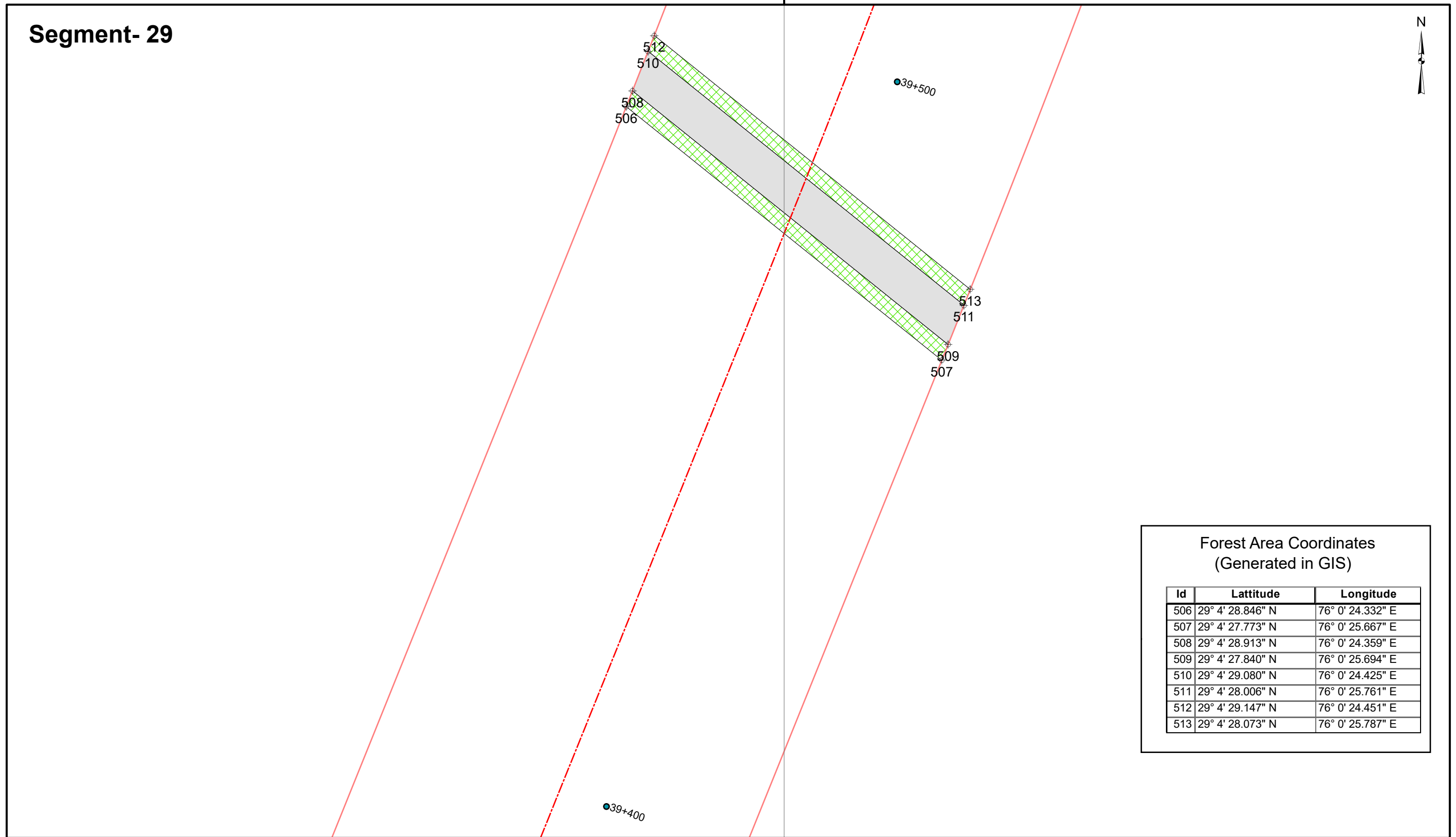

**Forest Area Coordinates  
(Generated in GIS)**

Id	Lattitude	Longitude
506	29° 4' 28.846" N	76° 0' 24.332" E
507	29° 4' 27.773" N	76° 0' 25.667" E
508	29° 4' 28.913" N	76° 0' 24.359" E
509	29° 4' 27.840" N	76° 0' 25.694" E
510	29° 4' 29.080" N	76° 0' 24.425" E
511	29° 4' 28.006" N	76° 0' 25.761" E
512	29° 4' 29.147" N	76° 0' 24.451" E
513	29° 4' 28.073" N	76° 0' 25.787" E

**Legend**

	GPS ID		Existing Road
	Chainage		Protected Forest to be Diverted
	PROW		Forest Land Already Diverted
	Road Centreline		Water Body

Project Director  
 NHAI, PIU-BHIWANI



# Upgradation of 4 - Lane with Paved shoulder of Bhiwani - Bawani khera - Hansi road section of NH 148B Under Bharatmala Pariyojana in the State of Haryana on EPC Mode: Georeferenced (DGPS) Map under Forest Division Hisar

**Segment- 30**

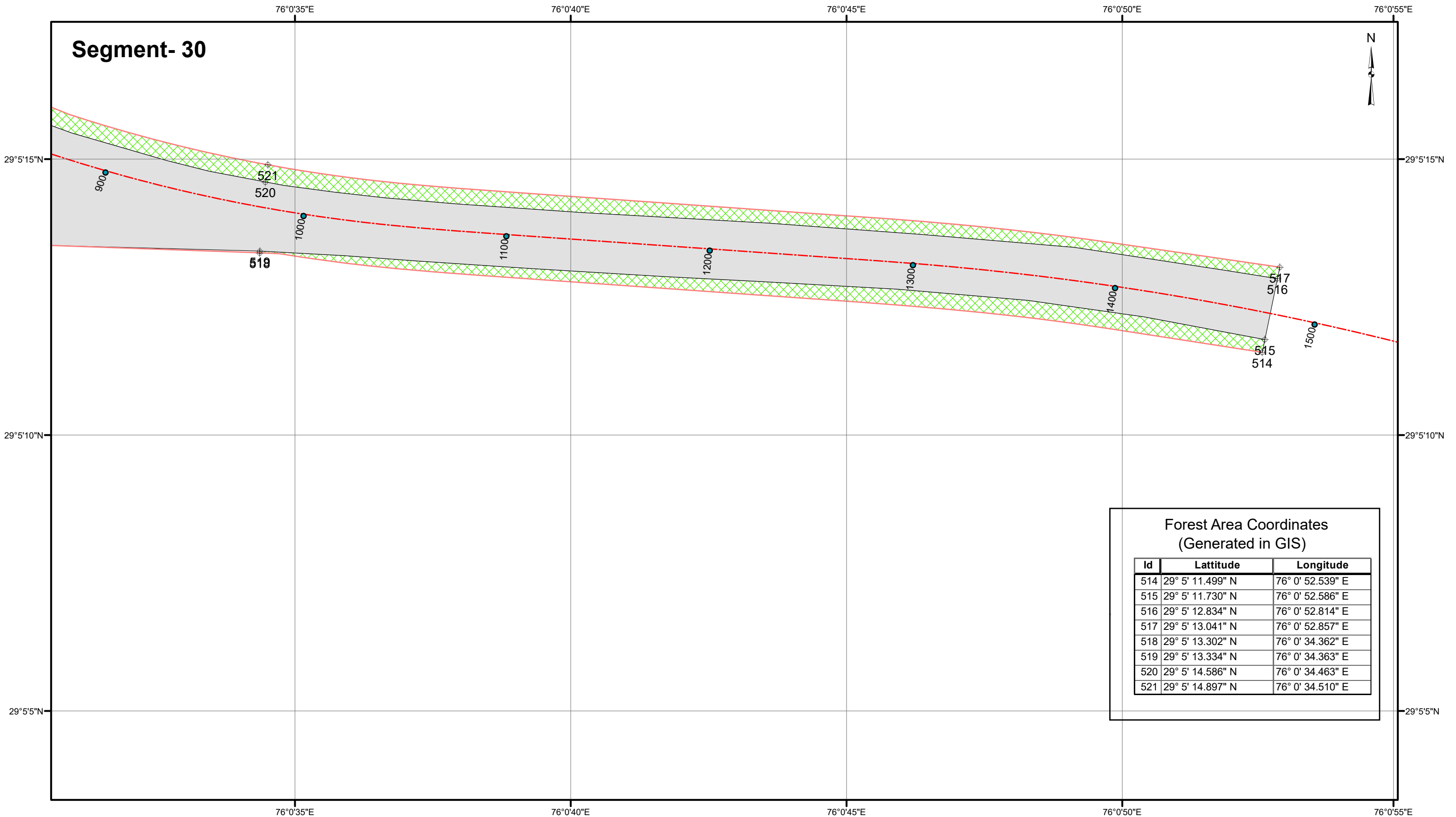

**Forest Area Coordinates  
(Generated in GIS)**

Id	Lattitude	Longitude
514	29° 5' 11.499" N	76° 0' 52.539" E
515	29° 5' 11.730" N	76° 0' 52.586" E
516	29° 5' 12.834" N	76° 0' 52.814" E
517	29° 5' 13.041" N	76° 0' 52.857" E
518	29° 5' 13.302" N	76° 0' 34.362" E
519	29° 5' 13.334" N	76° 0' 34.363" E
520	29° 5' 14.586" N	76° 0' 34.463" E
521	29° 5' 14.897" N	76° 0' 34.510" E

**Legend**

- GPS ID
- Existing Road
- Chainage
- Protected Forest to be Diverted
- PROW
- Forest Land Already Diverted
- Road Centreline
- Water Body

  
 Project Director  
 NHAI, PIU-BHIWANI

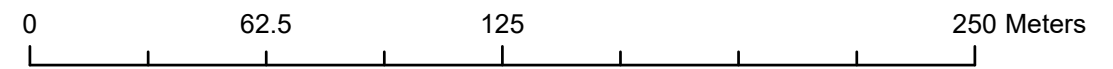



# Upgradation of 4 - Lane with Paved shoulder of Bhiwani - Bawani khera - Hansi road section of NH 148B Under Bharatmala Pariyojana in the State of Haryana on EPC Mode: Georeferenced (DGPS) Map under Forest Division Hisar

**Segment- 30**

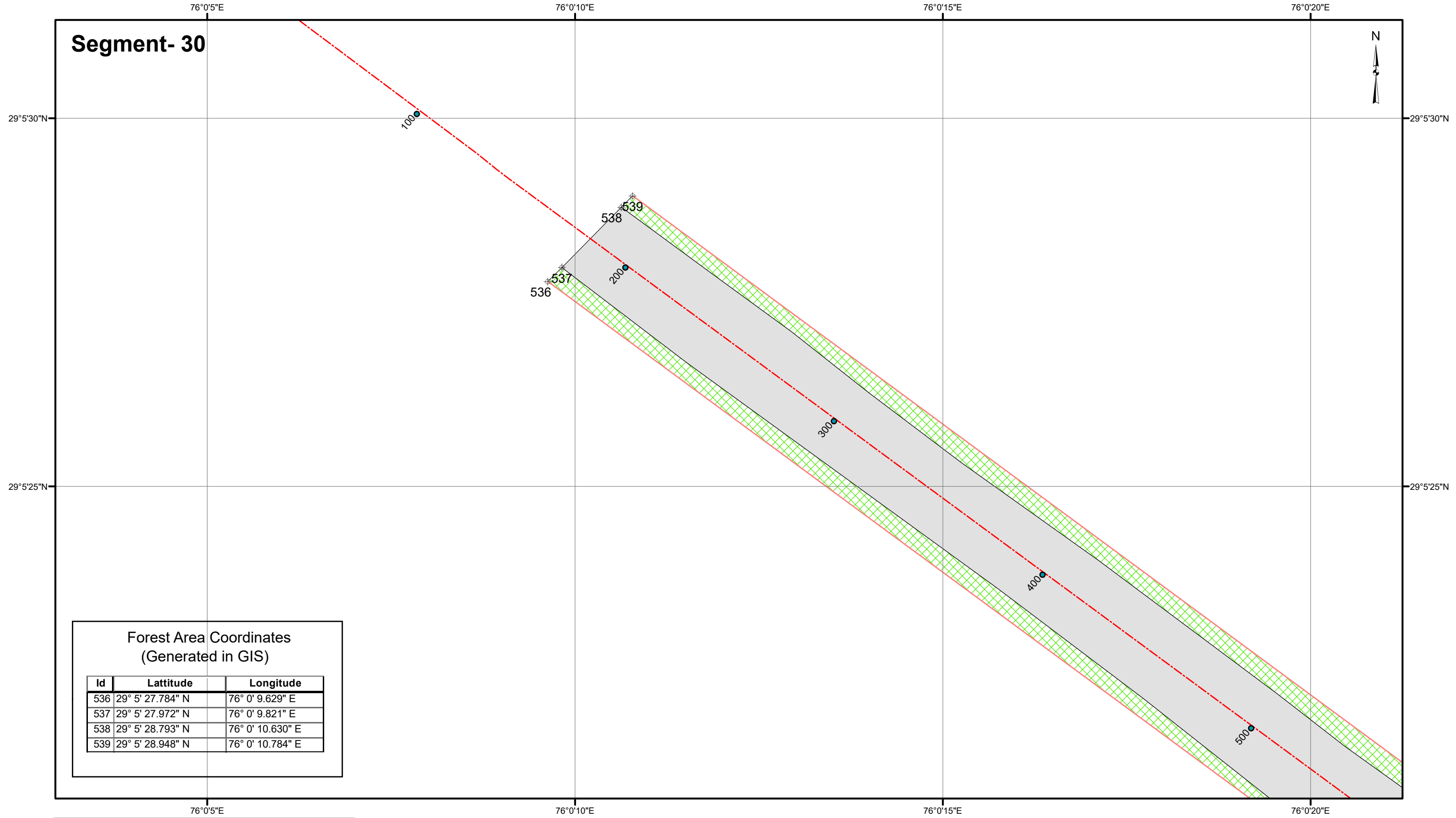

**Forest Area Coordinates  
(Generated in GIS)**

Id	Latitude	Longitude
536	29° 5' 27.784" N	76° 0' 9.629" E
537	29° 5' 27.972" N	76° 0' 9.821" E
538	29° 5' 28.793" N	76° 0' 10.630" E
539	29° 5' 28.948" N	76° 0' 10.784" E

**Legend**

- ⊕ GPS ID
- Chainage
- PROW
- Road Centreline
- Existing Road
- Protected Forest to be Diverted
- Forest Land Already Diverted
- Water Body

  
 Project Director  
 NHAI, PIU-BHIWANI

