

Part of River Yamuna, Rampurghat
 Khasra no. 390/285/153
 Mauza 7 Mohal Rampur Ghat, Tehsil Paonta Sahib

LOI in Favour of Mr. Yogeshwar, Ward 3, Nalagarh, District Solan, HP

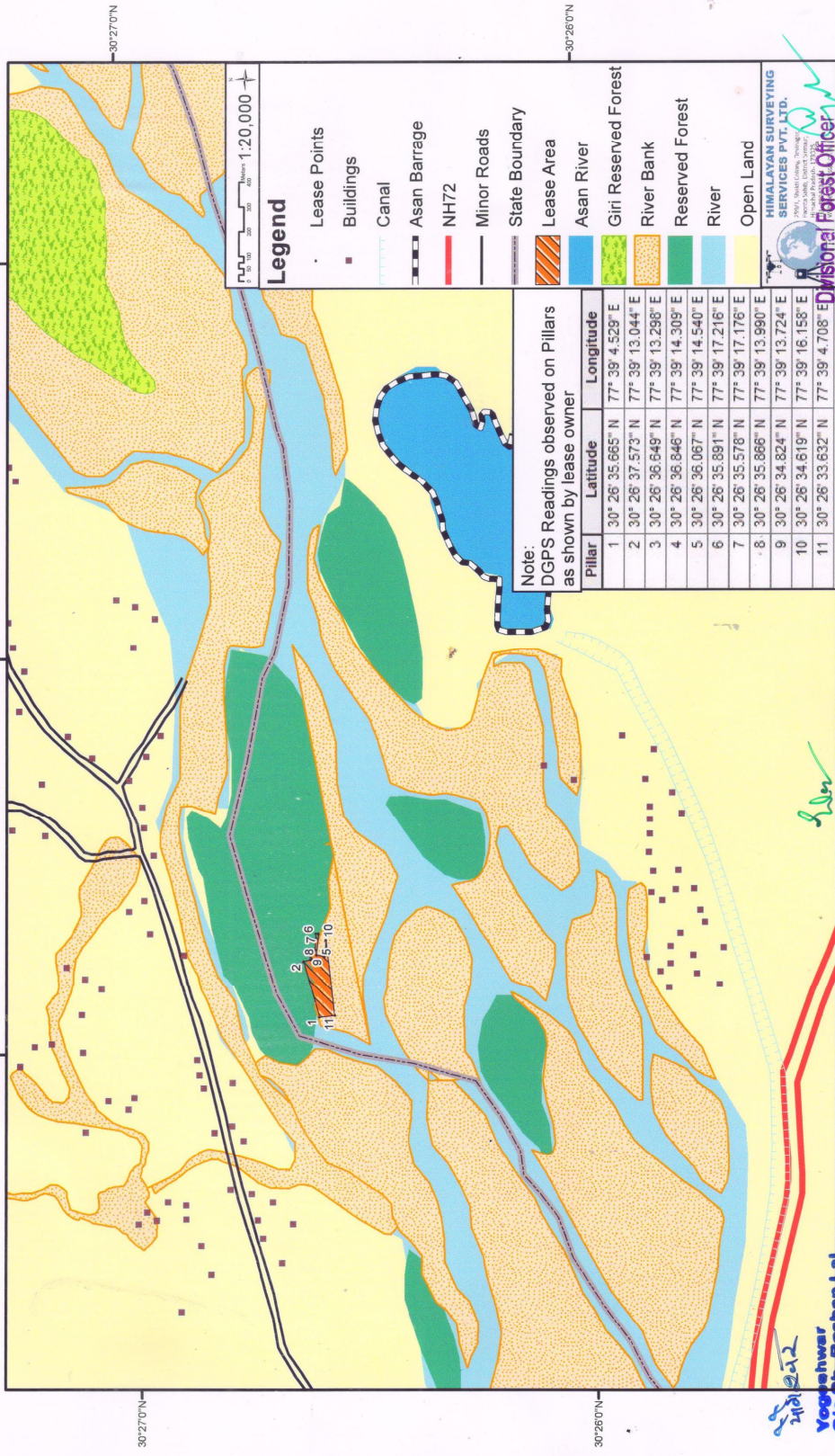

Note:
 DGPS Readings observed on Pillars
 as shown by lease owner

Pillar	Latitude	Longitude
1	30° 26' 35.665" N	77° 39' 4.529" E
2	30° 26' 37.573" N	77° 39' 13.044" E
3	30° 26' 36.649" N	77° 39' 13.298" E
4	30° 26' 36.846" N	77° 39' 14.309" E
5	30° 26' 36.067" N	77° 39' 14.540" E
6	30° 26' 35.891" N	77° 39' 17.216" E
7	30° 26' 35.578" N	77° 39' 17.176" E
8	30° 26' 35.866" N	77° 39' 13.990" E
9	30° 26' 34.824" N	77° 39' 13.724" E
10	30° 26' 34.619" N	77° 39' 16.158" E
11	30° 26' 33.632" N	77° 39' 4.708" E

Legend

- Lease Points
- Buildings
- Canal
- Asan Barrage
- NH72
- Minor Roads
- State Boundary
- Lease Area
- Asan River
- Giri Reserved Forest
- River Bank
- Reserved Forest
- River
- Open Land

HIMALAYAN SURVEYING
 SERVICES PVT. LTD.
 2001, Gurgaon, Haryana
 122002
 Divisional Forest Officer
 Paonta Sahib (H.P.)

Range Forest Officer
 Paonta Forest Range

Yogeshwar
 S/o Sir. Roshan-Lal
 W. No. 3, Nalagarh
 Distt. Solan (H.P.)

Paonta Sahib (H.P.)