

85°10'2"E

85°10'3"E

85°10'4"E

Project Proposal of IOCL on SH-74 Rd by Vinita kumari in Vashiali Dist.



25°52'38"N

25°52'38"N

25°52'37"N

25°52'37"N

25°52'36"N

25°52'36"N

25°52'35"N

25°52'35"N

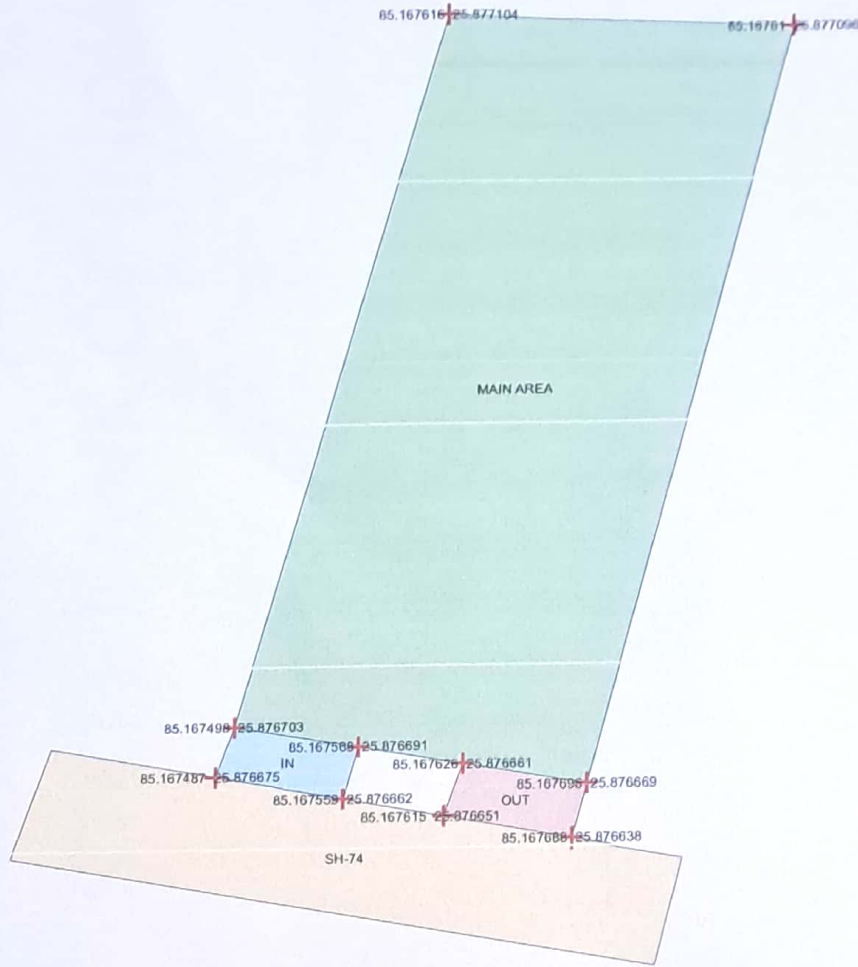

Index

- + GPS Location
- IN
- OUT
- SH-74
- MAIN AREA



पिनिता कुमारी