

## Site Inspection report of DCF

Date of Inspection : 01.07.2022

For the purpose of construction of retail outlet, a proposal for diversion of 0.0225 ha forest land has been submitted by Shri Birbal Yadav under the Forest Conservation Act, 1980. The site has been inspected in the presence of the user-agency. The proposed retail outlet is on Ara-Buxar Road (NH-84) – which is declared as Protected Forest vide Government of Bihar notification no.189E/190E, dated 16.02.1994. The retail outlet is proposed to be established on Khata no: 783, Khesra no: 667, Thana no: 327, Thana: Udwananagar, District: Bhojpur on personal land. For building access roads (entry/exit) connecting the retail outlet with the National Highways, the proposal has been submitted to divert the forest land falling adjacent to the said site road. There are no trees present on the site. As per the measurement made on the field, the total land proposed to be required for entry and exit path of the fuel station is 0.0225 ha.

There is no rare/endangered/unique species of flora and fauna found in the proposed area. Neither any archaeological/heritage site / defense establishment is present near the proposed outlet. There is no National Park/ Wildlife Sanctuary situated in and around the proposed site.

On the date of inspection, it was found that no work in violation of the Forest Conservation Act, 1960 has been carried out. The proposed forest area for diversion is the barest minimum and necessary for the development of transport sector.

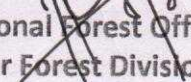
  
Divisional Forest Officer,  
Bhojpur Forest Division, Ara.



भोजपुर जिला अंतर्गत कारीसाथ मौजा के खाता संख्या-783 खेसरा संख्या-667 थाना संख्या-327 थाना-  
उदवंतनगर में NH-84 बक्सर आरा पथ के किनारे IOCL का रिटेल आउटलेट खोलने हेतु

वन (संरक्षण) अधिनियम, 1980 के अंतर्गत वन भूमि उपयोग का स्थल गणना विवरणी-

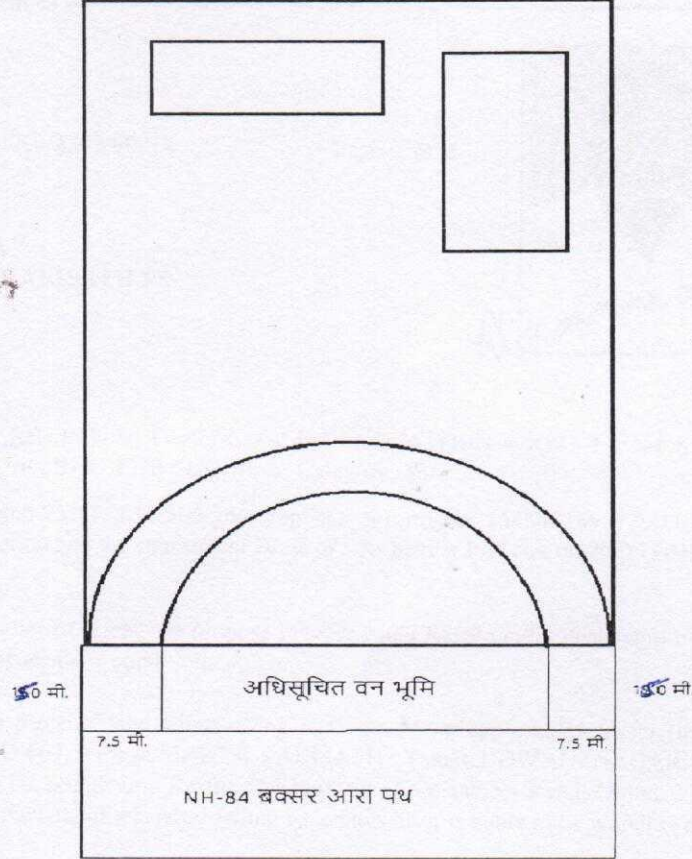

उपयोजन की विवरण-

(क) प्रवेश पथ - 7.5 मी. चौड़ाई \* लंबाई 15.00 मी. = 112.5 वर्ग मी.

(ख) निकास पथ - 7.5 मी. चौड़ाई \* लंबाई 15.00 मी. = 112.5 वर्ग मी.

कुल उपयोजित होने वाली वन भूमि - प्रवेश(क) + निकास (ख) = 225 वर्ग मी.

अर्थात कुल 0.0225 हे.

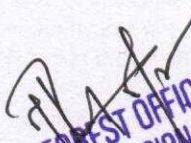
  
DIVISIONAL FOREST OFFICER  
BHOJPUR FOREST DIVISION, ARA

बीरबल यादव  
(बीरबल यादव)