

SITE PLAN SHOWING THE UNIT OF
 DHAN GURU NANAK WEIGH BRIDGE
 AT VILL. ALIKAN ON KHAIREKAN MATTAR ROAD.
 ROAD ID = 5656, K.M. 15.935 L.H.S. IN SIRSA DISTT.

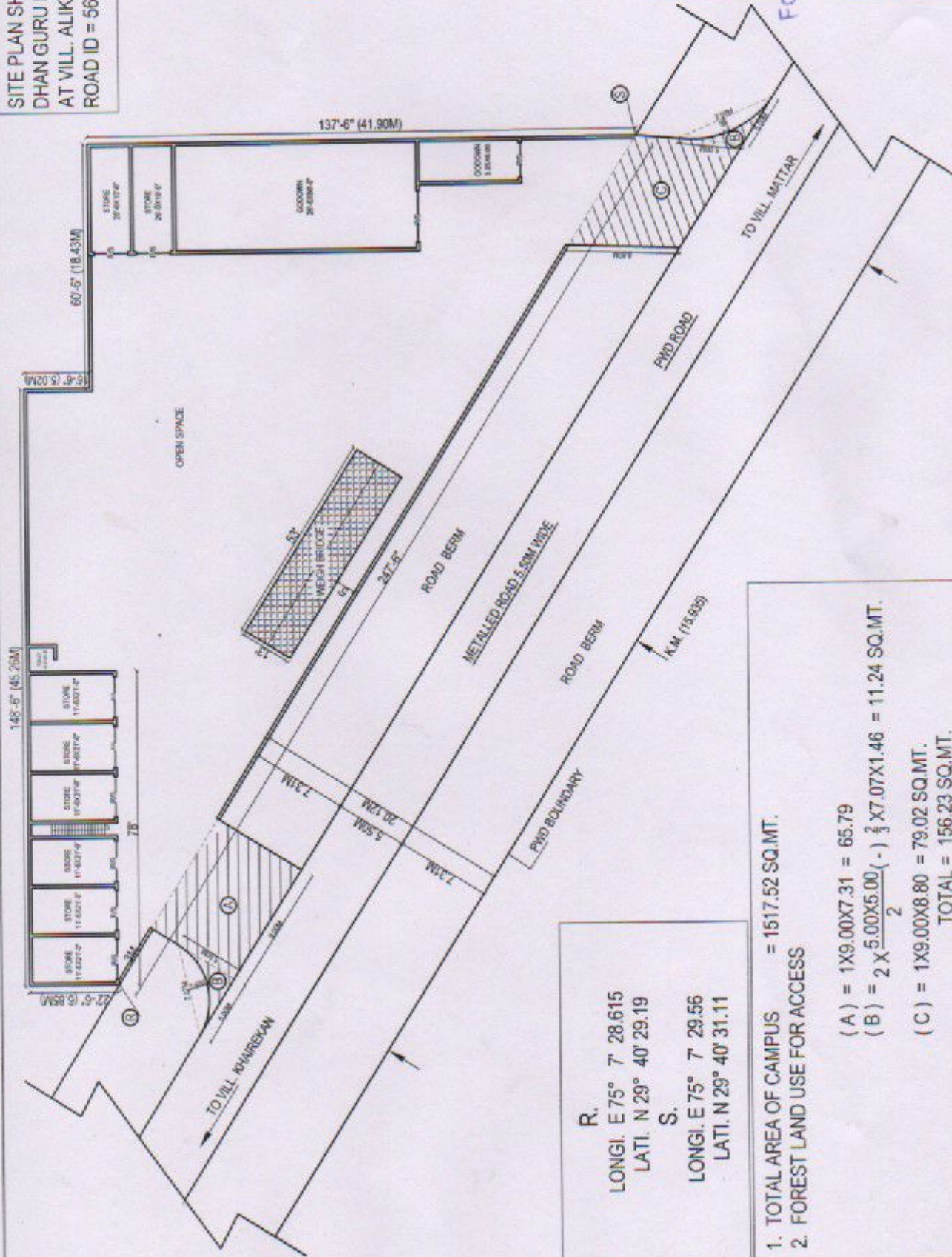

R.
 LONGI. E 75° 7' 28.615
 LATI. N 29° 40' 29.19
 S.
 LONGI. E 75° 7' 29.56
 LATI. N 29° 40' 31.11

1. TOTAL AREA OF CAMPUS = 1517.52 SQ.MT.
 2. FOREST LAND USE FOR ACCESS

$$(A) = 1 \times 9.00 \times 7.31 = 65.79$$

$$(B) = 2 \times \frac{5.00 \times 5.00}{2} (-) \frac{1}{3} \times 7.07 \times 1.46 = 11.24 \text{ SQ.MT.}$$

$$(C) = 1 \times 9.00 \times 8.80 = 79.02 \text{ SQ.MT.}$$

TOTAL = 156.23 SQ.MT.
 OR = 0.0156 HECT.

APPLICANT SIGN.

For Dhan Gurunanak Dharankanta
(Signature) Prop.

ARCHITECT SIGN.

Phone: 2281
Ar. R.S. CHUGH
 Regd. Architect

New M.C. Complex
 Old Hospital Road, SIRSA

Regd No 62391