

## Compensary Afforestation Scheme for double degraded area

Diversion of 3.788 ha. PF land for Road widening and Strengthening of Udwada Railway Station to Pardi, Paria, rohina and Dhahadmal Road Km.0/0 to 11/40 in favour of executive engineer Panchayat road and building Division in Valsad, District of Gujarat.

Detailed scheme of Compensatory Afforestation for degraded area 8.00 ha. to be carried out in lieu of 3.788 ha. of Protected forest land to be diverted in Valsad district.

### 1. Details of degraded land.

Village	Anklas
Taluka	Umargam
Range	Sanjan
District	Valsad
Division	Valsad South
Survey No	372pt
Area to be afforested	8.00 Ha.
Working circle	Production

### 2. Description of Area.

Soil type	Braun-Muram
Topography	Flat
Slope	Medium
Whether the area is bearing any root stock of Vegetation	Yes

### 3. Name of Plantation Programme:-

Compensatory Afforestation Scheme for Degraded Area.

### 4. Schedule of Plantation Programme:-

(i)	The Compensatory Afforestation on degraded area would be started by Dy.Conservator of Forest Valsad Division as early as possible after the proposal is formally approved.
(ii)	Compensatory Afforestation will be done in 8.00 ha.area. The total afforestation cost will be about <b>Rs.36,33,600/-</b> executive engineer Panchayat road and building Division has given an undertaking to pay the cost of Compensatory Afforestation as per the prevailing wages (including the price escalation and supervision charges).



## 5. Technical Details:-

Technical details of Compensatory Afforestation are as Follows:

Sr. No.	Details	Specifications																
a	General Details	The C.A. will be taken under Compensatory Afforestation for double land on degraded Forest Areas. The prevailing wage rate is 310.40 per day.																
b	Spacement	3 X 3 mtr., 1111 plants per ha.																
c	Species to be planted (No. of plants per ha.)	<table> <tr> <td>Khair</td><td>200</td><td rowspan="6">Minimum planting height will be 100 cm. at the time of planting. However it will vary for different species.</td></tr> <tr> <td>Kadayo</td><td>100</td></tr> <tr> <td>Bael</td><td>100</td></tr> <tr> <td>Bamboo, Harde, Sadad 150+100+150</td><td>400</td></tr> <tr> <td>Bahedo, Arjun Sadad, Haldu 50+100+100</td><td>250</td></tr> <tr> <td>Tandol, Simul, Kukar, Toon, Bhilamo, Anjan, Kansar, Padad</td><td>61</td></tr> <tr> <td colspan="2"><b>Total</b></td><td><b>1111</b></td></tr> </table>	Khair	200	Minimum planting height will be 100 cm. at the time of planting. However it will vary for different species.	Kadayo	100	Bael	100	Bamboo, Harde, Sadad 150+100+150	400	Bahedo, Arjun Sadad, Haldu 50+100+100	250	Tandol, Simul, Kukar, Toon, Bhilamo, Anjan, Kansar, Padad	61	<b>Total</b>		<b>1111</b>
Khair	200	Minimum planting height will be 100 cm. at the time of planting. However it will vary for different species.																
Kadayo	100																	
Bael	100																	
Bamboo, Harde, Sadad 150+100+150	400																	
Bahedo, Arjun Sadad, Haldu 50+100+100	250																	
Tandol, Simul, Kukar, Toon, Bhilamo, Anjan, Kansar, Padad	61																	
<b>Total</b>		<b>1111</b>																
d	Nursery Technique	Nine months old polypot raised plants will be planted at the onset of monsoon.																
e	Site Preparation	The malformed rootstock present in the area will be cutback & the site will be cleaned in the month of Nov-Dec. Alignment & pit digging 45 x 45 x 45 cms. will be carried out in the month of Dec-Jan.																
f	Plantation Method	Polypot raised plants will be planted during monsoon.																
g	Soil & Moisture Conservation Works	(i) Pucca structure like Check dam, check wall, retaining wall (ii) Contour trenches 2.00 x 0.45 x 0.30. 300 Nos/ha. will be dug along the contour line. the dug out soil will be heaped on the down ward side. Gully plugging & Nala Banding using the loose stone available in the area will be carried out as per requirement. Seeds of Jatropha, Agave plants ...etc. will be planted during monsoon in the upper side of nala as per suitability.																
h	Protection Trench	Barbed wire fencing, Seed sowing And planting of cuttings of Ipomea/Glarcidia along the fence																
i	Silvicultural Operations	1 <sup>st</sup> year three weeding soil working. Support watering will be provided if needed.																



		2 <sup>nd</sup> year two weeding soil working. 3 <sup>rd</sup> year one weeding soil working.
j	Maintenance	It is proposed to maintain the Plantation up to ten years.
k	Subsequent silvicultural Operation	Cleaning, cutbacks, thinning etc. (as per species specific requirement) will be carried out at the age as per prescribed in the working plan.
l	Proposed monitoring mechanism	<p>(i) A plantation register is to be maintained.</p> <p>(ii) Monitoring is to be done as per the following norms. Forester – 100% RFO – 100% ACF – 20% DCF – 10%</p> <p>(iii) The results of survival etc. are maintained in the plantation register on a periodical basis, which is updated at the end of September and March each year.</p> <p>(iv) The collar girth is also to be reordered at the end of each year.</p> <p>(v) At the end of maintenance period, the area is aimed at full stocking and pole crop girth for all the species, except bamboo.</p> <p>(vi) Bamboo would be of the harvestable size by the end of 4<sup>th</sup> year.</p> <p>(vii) Third party monitoring mechanism is also in the State and if the plantation is in the sample selected, it will also be monitored by the third party selected for this purpose.</p>
m	Regeneration cleaning	Cut-back and promotion of root suckers.
n	Silviculture & other activities	Only afforestation aimed plantation will be taken up, as the area falls under degraded forest land.

  
Dy. Conservator of Forest  
Valsad South

The Compensatory Afforestation scheme at the cost of Rs.36,33,600/- is technically and administrative approved by the undersigned.

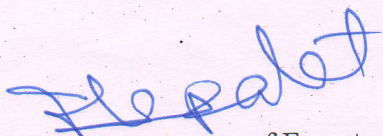
  
Dy. Conservator of Forest  
Valsad South



**Compensatory Afforestation Scheme for double degraded area under FCA proposal**  
**Diversion of 3.788 ha. PF land for Road widening and Strengthening of Udwada Railway Station to**  
**Pardi,Paria,rohina and Dhahadmal Road Km.0/0 to 11/40 in favour of executive engineer Panchayat**  
**road and building Division in Valsad,District of Gujarat.**

Daily wages Rs.310.40

Spacemnts = 3 m x 3 m				
1111 seedling / Ha				
1st year replacement 10 % = 111 seedling /ha				
2nd year replacement 20 % = 111+111 seedling /ha				
3rd year replacement 10 % = 111 seedling /ha				
Total Seedlings = 1333 seedling /ha				
Polypot size : 15 cm x 25 cm x 200				
Item of work	Qty.	Labour	Material	Total
1	2	3	4	5
<b>0 year</b>				
Nursery				
(a) Cost of soil, ,manure, seeds, water, fertillizer, insecticides, implements, rent of lands. Shade, etc. (including 10 % for casuality replacement)	1222	0	1830	1830
(b) labour : Preparation of beds, filling and arranging of bags,showing of seeds, watering shifting, weeding etc.	1222	4478	232	4710
(c ) Seedling cost for casuality replacement in one year old (20%)	222	1416	422	1838
(d) Seedling cost for casuality replacement in two year old (10%)	111	708	211	919
<b>Total</b>		<b>6602</b>	<b>2695</b>	<b>9297</b>
<b>2. Area Development ( Land Preparation )</b>				
(a) Survey, cutback and promotion of root suckers		3364	0	3364
(b) Aligment and digging of pits 0.45 X 0.45 X 0.45	1111@ 6.00	9715	0	9715
<b>Total</b>		<b>13079</b>	<b>0</b>	<b>13079</b>
(a) Natural fertilizer (Neem cake/ Castor cake)	1111 @ 5.00	0	9910	9910
<b>Total</b>		<b>0</b>	<b>9910</b>	<b>9910</b>
<b>3. SMC Works</b>				
(a) Check wall/ retaining wall /checkdem (all pucca only)	L.S.	11952	23726	35678
(b) Contour trench 2 M x 45 Cm x 30 Cm as per Rs.17.00/rmt (300 trench)	600 rmt.	9097	0	9097
<b>Total</b>		<b>21049</b>	<b>23726</b>	<b>44775</b>



<b>4. Protection</b>				
(a) Barbed wire fencing	L.S.	3568	35678	39246
(b) Seed sowing and planting of cuttings of Ipomea/ Glarcidia along the fence		1110	477	1587
<b>Total</b>		<b>4678</b>	<b>36155</b>	<b>40833</b>
<b>Sub Total of 0 year</b>		<b>45408</b>	<b>72486</b>	<b>117894</b>
<b>1st Year</b>				
(a) Maintenance of nursery (April to June)	1222	3434	343	3777
(b) Transport of seedling for plantation	1111	18594	389	18983
(c) Planting with khamna of Min 1 m dia	1111	5791	0	5791
(d) Transport of seedling for casualty replacement	111	201	44	245
(e) 3 weeding cum soil working	1111	23583	0	23583
(f) Support watering 5 times @ 3.25		14430	20706	35136
(g) Protection / tending operation		4649	0	4649
(h) Tending to natural vegetation		1167	0	1167
(i) Contingency		0	1167	1167
<b>Total for 1st year</b>		<b>71849</b>	<b>22649</b>	<b>94498</b>
<b>2nd Year</b>				
(a) 2 weeding & soil working		12669	0	12669
(b) 20 % Casually replcement, transport and planting	111+111	211	1049	1260
(c) Natural fertilizer (neem cake / caster cake ) etc.	Rs.5/ plant	0	11711	11711
(d) Support watering 3 times @ 3.25		9377	13459	22836
(e) Protection / tending operation		5060	0	5060
<b>Total for 2nd year</b>		<b>27317</b>	<b>26219</b>	<b>53536</b>
<b>3rd Year</b>				
(a) 2 weeding & soil working		13372	0	13372
(b) 10 % Casually replcement, transport and planting	111	112	566	678
(c) Natural fertilizer, neem cake etc.	Rs.5/ plant	0	12838	12838
(d) Support watering 1 times @ 3.25		3367	4831	8198
(e) Protection & maintenance of fencing / tending operation	L.S.	8743	0	8743
<b>Total for 3rd year</b>		<b>25594</b>	<b>18235</b>	<b>43829</b>
<b>4thYear</b>				
(a) 1 weeding & soil working		7384	0	7384
(b) Protection & Maintenance of fencing/ Tending operation	L.S.	7298	0	7298
<b>Total for 4th year</b>		<b>14682</b>	<b>0</b>	<b>14682</b>



<b>5thYear</b>				
Protection & maintenance of fencing/ tending operation	L.S.	7785	0	7785
<b>Total for 5th year</b>		<b>7785</b>	<b>0</b>	<b>7785</b>
<b>6thYear</b>				
Protection & maintenance of fencing/ tending operation	L.S.	8271	0	8271
<b>Total for 6th year</b>		<b>8271</b>	<b>0</b>	<b>8271</b>
<b>7thYear</b>				
Protection & maintenance of fencing/ tending operation	L.S.	8758	0	8758
<b>Total for 7th year</b>		<b>8758</b>	<b>0</b>	<b>8758</b>
<b>8thYear</b>				
Protection & maintenance of fencing/ tending operation	L.S.	9243	0	9243
<b>Total for 8th year</b>		<b>9243</b>	<b>0</b>	<b>9243</b>
<b>9thYear</b>				
Protection & maintenance of fencing/ tending operation	L.S.	9730	0	9730
<b>Total for 9th year</b>		<b>9730</b>	<b>0</b>	<b>9730</b>
<b>10thYear</b>				
Protection & maintenance of fencing/ tending operation	L.S.	10217	0	10217
<b>Total for 10th year</b>		<b>10217</b>	<b>0</b>	<b>10217</b>
<b>SUB TOTAL :</b>		<b>238854</b>	<b>139589</b>	<b>378443</b>
The Cost of Supervision/subsequential silvicultureal Operations	20%	47771	27918	75689
		<b>286625</b>	<b>167507</b>	<b>454132</b>

**Note :-**

- (1) Seed sowing along fencing towards the inner side, and also in the plot.  
 (2) Planting of cutting of ipomea//Glarcidia along the fencing towards outer side.

Compensatory afforestation will be done in 1.00 ha. Area.

**Total Cost Rs. :4,54,200/-**

Compensatory afforestation will be done in Total 8.00 ha. Area.

**Total Overall Cost Rs. :36,33,600/-**



The Map showing The Detail of Degraded Forest Land Identified of Compensatory Afforestation against. The proposal for Diversion for forest land for the proposed forest land for road widening and strengthening of Udvada railway station to Pardi,pariya,Rohina and Dhagadmal road K.m.0/0 to 11.40 in favour of Executive Engineer,Road & Building Division in Valsad District of Gujarat.

Village : Anklas, Taluka : Umargam Dist : Valsad  
Forest Division ; Valsad south Rage : Sanjan

R.F.Survey No.372<sub>pt.</sub>

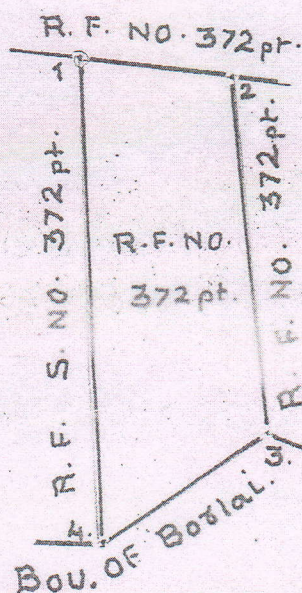

- ① N 20° 13' 00.90" E 72° 57' 28.44"
- ② N 20° 12' 59.29" E 72° 57' 33.67"
- ③ N 20° 12' 47.08" E 72° 57' 32.40"
- ④ N 20° 12' 44.86" E 72° 57' 25.26"

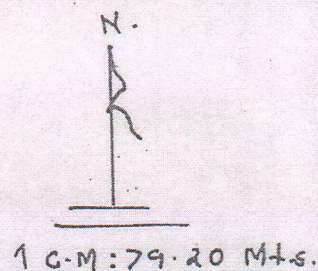

#### REFERENCE

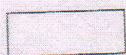

Forest Area



Area to be taken for compensatory afforestation area 8.00 Ha.

*H. S. Patel*  
(H. S. Patel)  
Dy. Conservator of Forests  
Valsad South



## CERTIFICATE

This is to certify that the Compensatory Afforestation Model is developed as M-3,ha.8.00 of Rupees:36,33,600=00, as suggested by the Range Forest Officer Sanjan,vide letter.No:A/JMN/188 Dt.05/09/2019 and the technical sanctioned is accorded for the same.

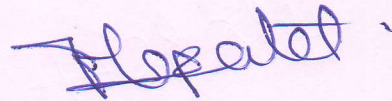

(H.S.Patel)

Dy.Conservator of Forests

Valsad South