

SEAM L2			
Year	PANEL NO	DEVEP (MT)	RESERVE PRODUCTION (MT)
Y3	T-1	DEV	0.034
	P-1	DEV	0.150
Y3	P-2	DEV	0.178
	DEV		0.350

INDEX	DESCRIPTION
---	BLOCK / M.L / PROJECT BOUNDARY
MASSE 34	BOREHOLE DRILLED BY M.E.C.L
SSM 25	BOREHOLE DRILLED BY G.S.I
▲	INCLINES
⊙	AIR-SHAFT
⊕	INFRASTRUCTURES AREA
▭	PANEL LAYOUT
—	NALA
—	DOLERITE DYKE
—	EFFECTIVE THICKNESS CONTOUR
—	FLOOR CONTOUR
—	SEAM GRADIENT
—	UNWORKABLE SEAM (<1.20 m)
—	PANEL BARRIER
—	MAIN HEADING
—	GALLERY
—	DEPILLARING

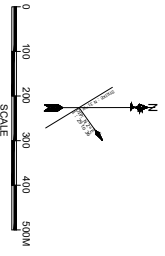

**MIN MEC CONSULTANCY PVT. LTD.**  
 NEW DELHI, PH: 29534777, 29535881  
 DOCUMENT NO: 2023/06/001, PROJECT NO: 2023/06/001

**Client:** **Min Mec Consultancy Pvt. Ltd.**  
**Project:** **Mining Plan and Mine Closure Plan (1st Modification) OF SAHAPUR EAST COAL MINE**

**Drawn by:** B.R. Mishra  
**Checked by:** R.K. Choudhary, I.A.M.E.  
**Approved by:** B.D. Sharma, I.P.C.  
**SCALE:** 1:4000 **DATE:** June, 2025





# Plan / Plate 22

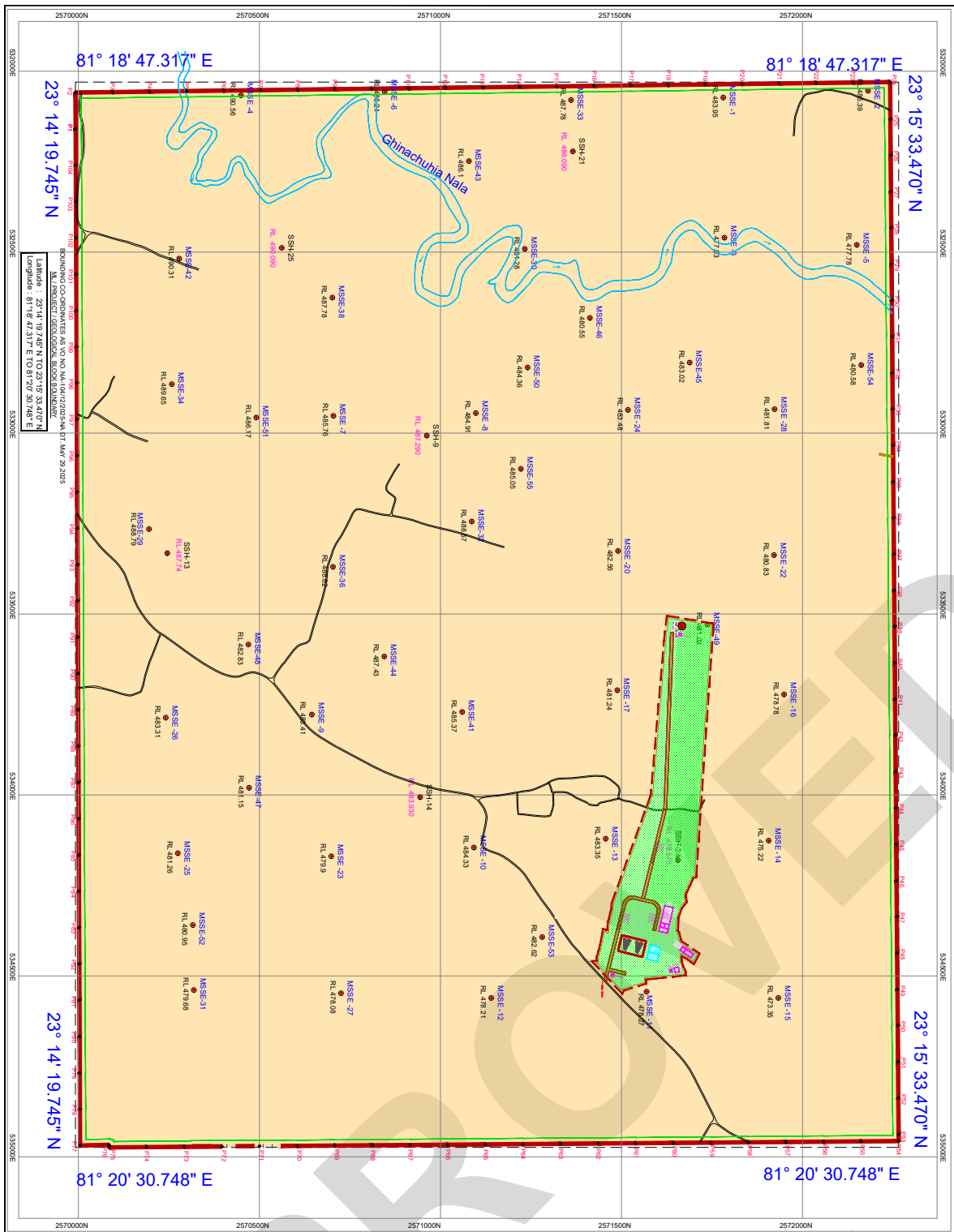

**INDEX :-**

- BLOCK I.M. / PROJECT BOUNDARY
- BOUNDARY / PILLAR AS PER VO
- 17.25 M SAFETY BANNER
- BENCHMARK DRILLED BY M.E. C.I.
- BENCHMARK DRILLED BY G.S.I
- REDUCED LEVEL IN METER
- ABANDONED INCLINE
- ABANDONED AIR SHAFT
- ABANDONED FACILITIES
- GREEN BELT
- WATER BODY

Type	Land Use Proposed	Area (sq. m)	Total Area (sq. m)	Percentage (%)
Open Cast	328	138	328	42.07
Overhead	328	138	328	42.07
Storage	328	138	328	42.07
Other	328	138	328	42.07
<b>Total</b>	<b>1312</b>	<b>552</b>	<b>1312</b>	<b>42.07</b>

**CLIENT:** MIN MEC CONSULTANCY PVT. LTD.  
 NEW DELHI, PH. 29534777, 29535881  
 (COMPANIES) Registered Office, Corporate No. UVA1794499/VA01/AN/02/001/2017  
 As per Section 13(1) of the Companies Act, 2013  
 Approved Company

**CLIENT:** Miners' Advisory Private Limited  
 As per Section 13(1) of the Companies Act, 2013  
 Approved Company

**APPROVED BY:** B.D. Sharma (P.O.)  
 DATE: June 2025

# Additional Plan / Plates-23

