

TYPICAL CROSS SECTION - 1
2 LANE CARRIAGEWAY - (EXISTING ROAD WIDENING)

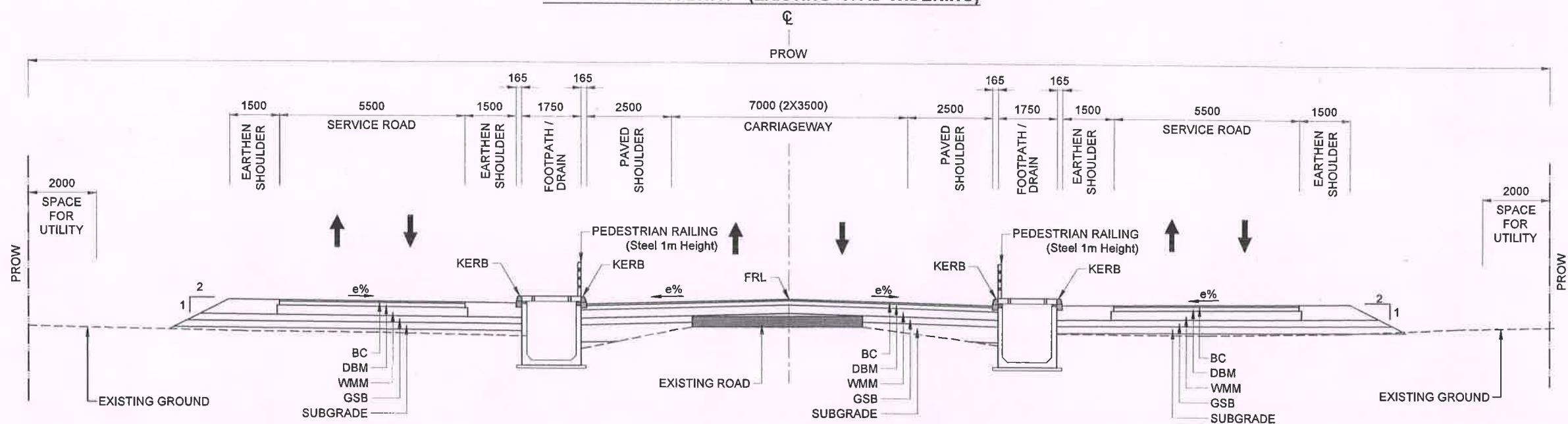

TYPICAL CROSS SECTION - 2
2 LANE CARRIAGEWAY WITH SERVICE ROAD - (BUILT-UP AREA)

NOTE:

1. ALL DIMENSIONS ARE IN MM UNLESS OTHERWISE NOTED.
2. ALL CROSS-SECTIONS ARE DRAWN IN THE DIRECTION OF INCREASING STATIONS, i.e., LOOKING UP STATION.
3. ALL CROSS-SECTIONS DEPICT PROPOSED ROAD CONFIGURATIONS.
4. FOR SUPER ELEVATION (e%) APPLICATION REFER TO PROFILE DRAWING SERIES.
5. FOR PAVEMENT TIE-IN AND PROPOSED PAVEMENT DETAILS REFER TO PAVEMENT STRUCTURE DRAWING SERIES.
6. FOR ACTUAL WIDTH OF CARRIAGEWAY/SHOULDER/AUXILIARY LANE REFER TO ROAD PLAN & PROFILE DRAWING SERIES.



**National Highways
Authority of India
(NHAI)**



Louis Berger

CONSULTANCY SERVICES FOR PREPARATION OF DPR FOR DEVELOPMENT OF ECONOMIC CORRIDORS, INTER CORRIDORS, FEEDER ROUTES TO IMPROVE THE EFFICIENCY OF FREIGHT MOVEMENT IN INDIA UNDER BHARATMALA PARIYOJANA
LOT 3/ ANDHRA PRADESH, KARNATAKA, GOA & KERALA / PACKAGE 1

AURAD - BIDAR ROAD (NH-161A)
TYPICAL CROSS SECTION - SHEET 01

DRAWN: RA
DESIGNED: AD
CHECKED: VA
APPROVED: KM

DATE: FEBRUARY 2020
SCALE: NTS

FINAL DPR

DRAWING NO:
4800182-CI-RD-AB_TCS-07-001

REV.
R0

Plot Date: 16 December, 2020 - 4:06 PM

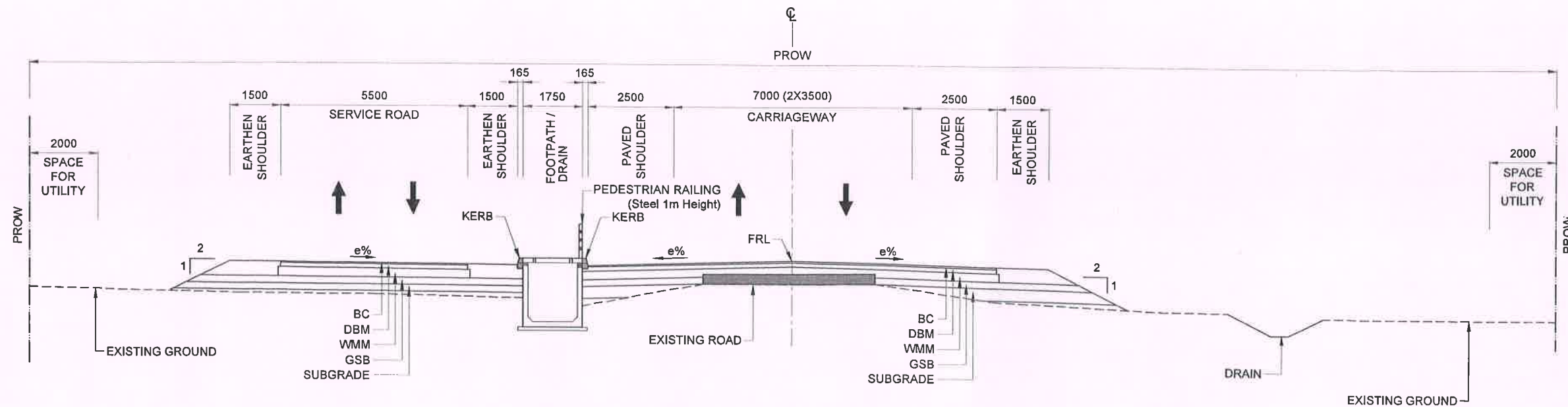

TYPICAL CROSS SECTION - 2A
2 LANE CARRIAGEWAY WITH LHS SERVICE ROAD - (BUILT-UP AREA)

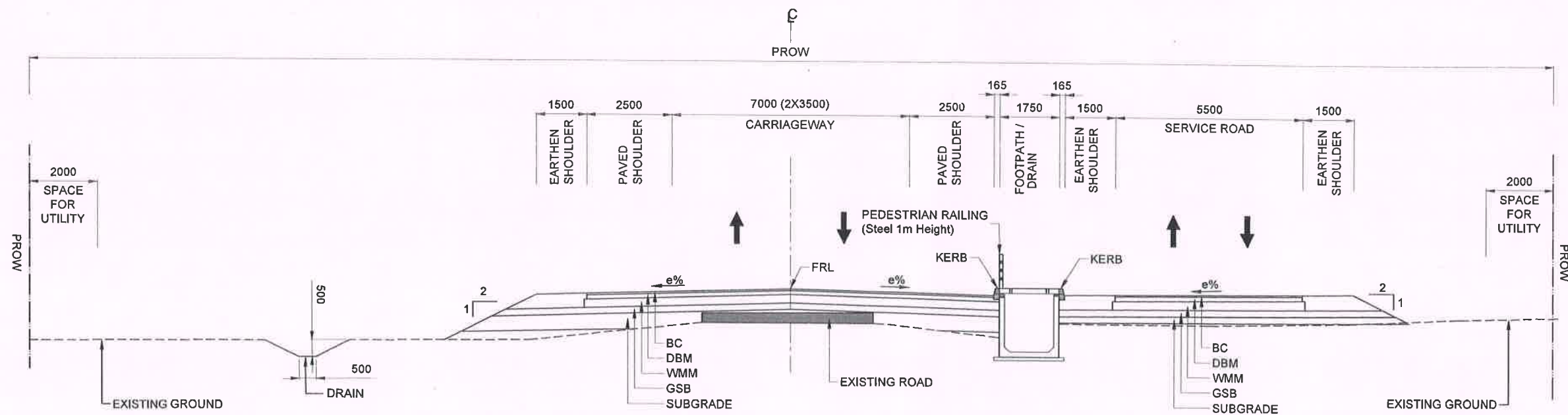

TYPICAL CROSS SECTION - 2B
2 LANE CARRIAGEWAY WITH RHS SERVICE ROAD - (BUILT-UP AREA)

NOTE:

1. ALL DIMENSIONS ARE IN MM UNLESS OTHERWISE NOTED.
2. ALL CROSS-SECTIONS ARE DRAWN IN THE DIRECTION OF INCREASING STATIONS, i.e., LOOKING UP STATION.
3. ALL CROSS-SECTIONS DEPICT PROPOSED ROAD CONFIGURATIONS.
4. FOR SUPER ELEVATION (e%) APPLICATION REFER TO PROFILE DRAWING SERIES.
5. FOR PAVEMENT TIE-IN AND PROPOSED PAVEMENT DETAILS REFER TO PAVEMENT STRUCTURE DRAWING SERIES.
6. FOR ACTUAL WIDTH OF CARRIAGEWAY/SHOULDER/AUXILIARY LANE REFER TO ROAD PLAN&PROFILE DRAWING SERIES.

REV. NO.	DATE	DESCRIPTION	APPROD
R0	FEB 2020	FINAL DPR SUBMISSION	KM



**National Highways
 Authority of India
 (NHA)**



Louis Berger

CONSULTANCY SERVICES FOR PREPARATION OF DPR FOR DEVELOPMENT OF ECONOMIC CORRIDORS, INTER CORRIDORS, FEEDER ROUTES TO IMPROVE THE EFFICIENCY OF FREIGHT MOVEMENT IN INDIA UNDER BHARATMALA PARIYOJANA
 LOT 3/ ANDHRA PRADESH, KARNATAKA, GOA & KERALA / PACKAGE 1

AURAD - BIDAR ROAD (NH-161A)
TYPICAL CROSS SECTION - SHEET 01

DRAWN: RA
 DESIGNED: AD
 CHECKED: VA
 APPROVED: KM

DATE: FEBRUARY 2020
 SCALE: NTS

FINAL DPR

DRAWING NO:
 4800182-CI-RD-AB_TCS-07-001

REV.
 R0