

Name of District	Name of Taluka	Name of Village	Design Chainage (Km)		Length (m)	ROW (m)	Khasra No.	Type of Land	Nature of Land	Required Area In (Ha.)
			From	To						
Sawai Madhopur	Chautha ka Barwada	Torda	267+667	267+941	274	100	24	Govt	Forest	1.0122

LEGEND

Acquired Reserved Forest Area		District Boundary	
Proposed Center line		Village Boundary	
Proposed Right of Way		Forest Boundary	
		GPS Point	

Scale - 1:4000

Manager (Tech.)
NHAI PIU-Sawai Madhopur
[Signature]

NOTES:
1. All Dimensions are in Meters Except Kilometer Stones.

CLIENT:

NATIONAL HIGHWAYS AUTHORITY OF INDIA
(Ministry of Road, Transport & Highways)
Government of India
G - 5 & 6, Sector - 10, New Delhi - 110075

CONSULTANT:

FEEDBACK INFRA
Making Infrastructure Happen

The information contained herein is Confidential & Property of Feedback Infra Private Limited and not for Publication. The Information is Furnished on the Understanding that no part thereof shall be Copied or Communicated to a Third Party without Authorisation in Writing from Feedback Infra Private Limited

Drawn by:	D.J.	<i>[Signature]</i>
Designed by:	K.P.	<i>[Signature]</i>
Checked by:	R.M.	<i>[Signature]</i>
Approved By:	P.R.	<i>[Signature]</i>
Scale:	1:4000	
Date:	August - 2019	

STATUS:	FEASIBILITY REPORT	
PROJECT:	"Diversion of forest land for development of (Greenfield Highway) from Firozpur Jhirka (Ch. 79.394 Km) to Itawa (Ch. 284.000 Km) Section of NH-148N (Total Length 204.606km) under Bharatmala Pariyojana (Lot-4/ Package-4) in Rajasthan State"	
TITLE:	Proposed Alignment on Revenue map Village- Torda (Sawai madhopur District)	
DRG NO:	FIP/LHW/LOT-4/M-01	REV: R-0
		SHEET: 01 of 01

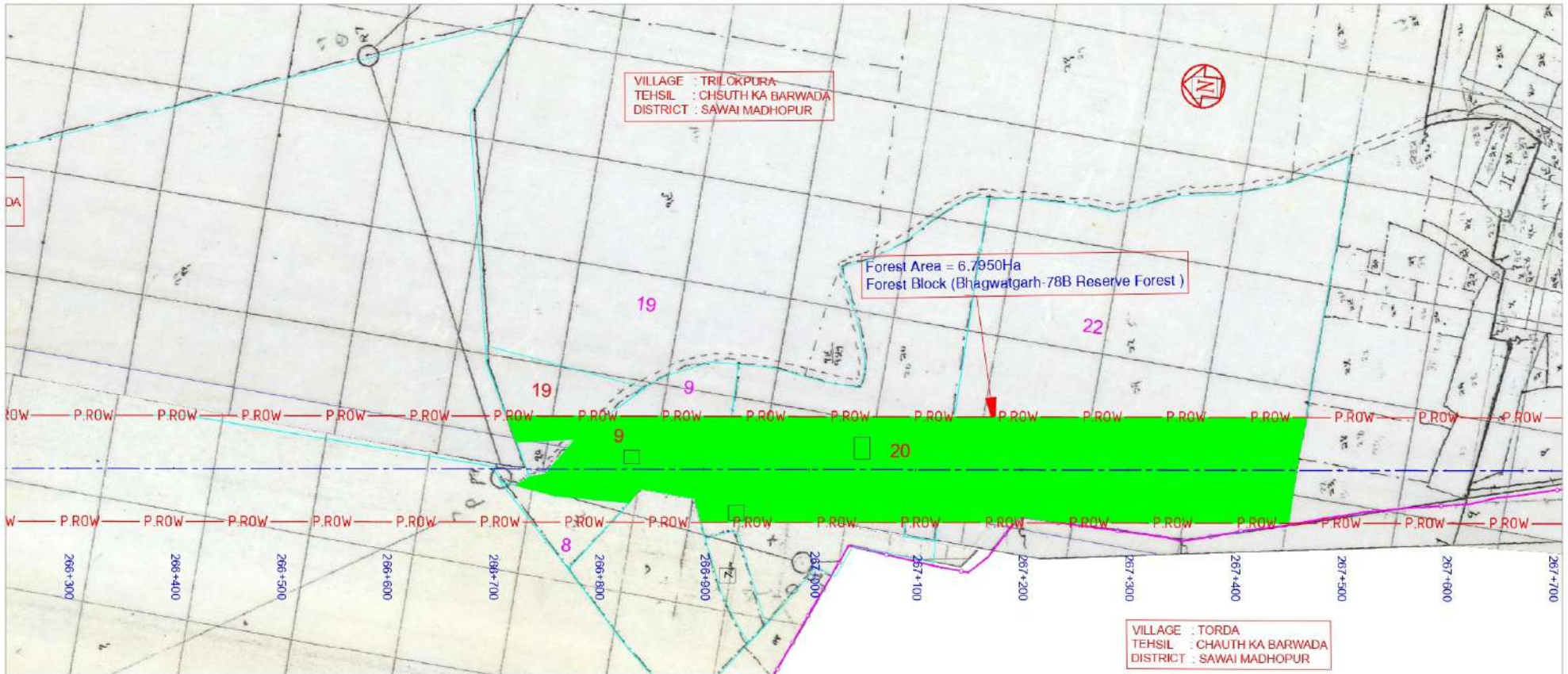

Name of District	Name of Taluka	Name of Village	Design Chainage (Km)		Length (m)	ROW (m)	Khasra No.	Type of Land	Nature of Land	Required Area In (Ha.)
			From	To						
Sawai Madhopur	Chautha ka Barwada	Trilokpura	266+714	266+808	94	100	19	Govt	Forest	0.1718
Sawai Madhopur	Chautha ka Barwada	Trilokpura	266+723	266+926	203	100	9	Govt	Forest	1.0028
Sawai Madhopur	Chautha ka Barwada	Trilokpura	266+886	267+090	204	100	5	Govt	Forest	1.1601
Sawai Madhopur	Chautha ka Barwada	Trilokpura	266+923	267+137	214	100	20	Govt	Forest	1.1613
Sawai Madhopur	Chautha ka Barwada	Trilokpura	267+121	267+469	348	100	22	Govt	Forest	3.2990
Total										6.7950

LEGEND

Acquired Reserved Forest Area		District Boundary	
Proposed Center line		Village Boundary	
Proposed Right of Way		Forest Boundary	
		GPS Point	

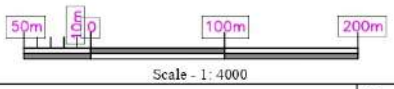

Manager (Tech.)
NHAI PIU-Sawai Madhopur
[Signature]

NOTES:
1. All Dimensions are in Meters Except Kilometer Stones.

CLIENT:
 NATIONAL HIGHWAYS AUTHORITY OF INDIA
(Ministry of Road, Transport & Highways)
Government of India
G - 5 & 6, Sector - 10, New Delhi - 110075

CONSULTANT:
FEEDBACK INFRA
Making Infrastructure Happen

The information contained herein is Confidential & Property of Feedback Infra Private Limited and not for Publication. The Information is Furnished on the Understanding that no part thereof shall be Copied or Communicated to a Third Party without Authorisation in Writing from Feedback Infra Private Limited

Drawn by:	D.J. <i>[Signature]</i>
Designed by:	K.P. <i>[Signature]</i>
Checked by:	R.M. <i>[Signature]</i>
Approved By:	P.R. <i>[Signature]</i>
Scale:	1:4000
Date:	August - 2019

STATUS:	FEASIBILITY REPORT		
PROJECT:	"Diversion of forest land for development of (Greenfield Highway) from Firozpur Jhirka (Ch. 79.394 Km) to Itawa (Ch. 284.000 Km) Section of NH-148N (Total Length 204.606km) under Bharatmala Pariyojana (Lot-4/Package-4) in Rajasthan State"		
TITLE:	Proposed Alignment on Revenue map Village- Trilokpura (Sawai madhopur District)		
DRG NO.:	FIP/LHW/LOT-4/VM- VM-01	REV.:	R-0
		SHEET:	01 of 01

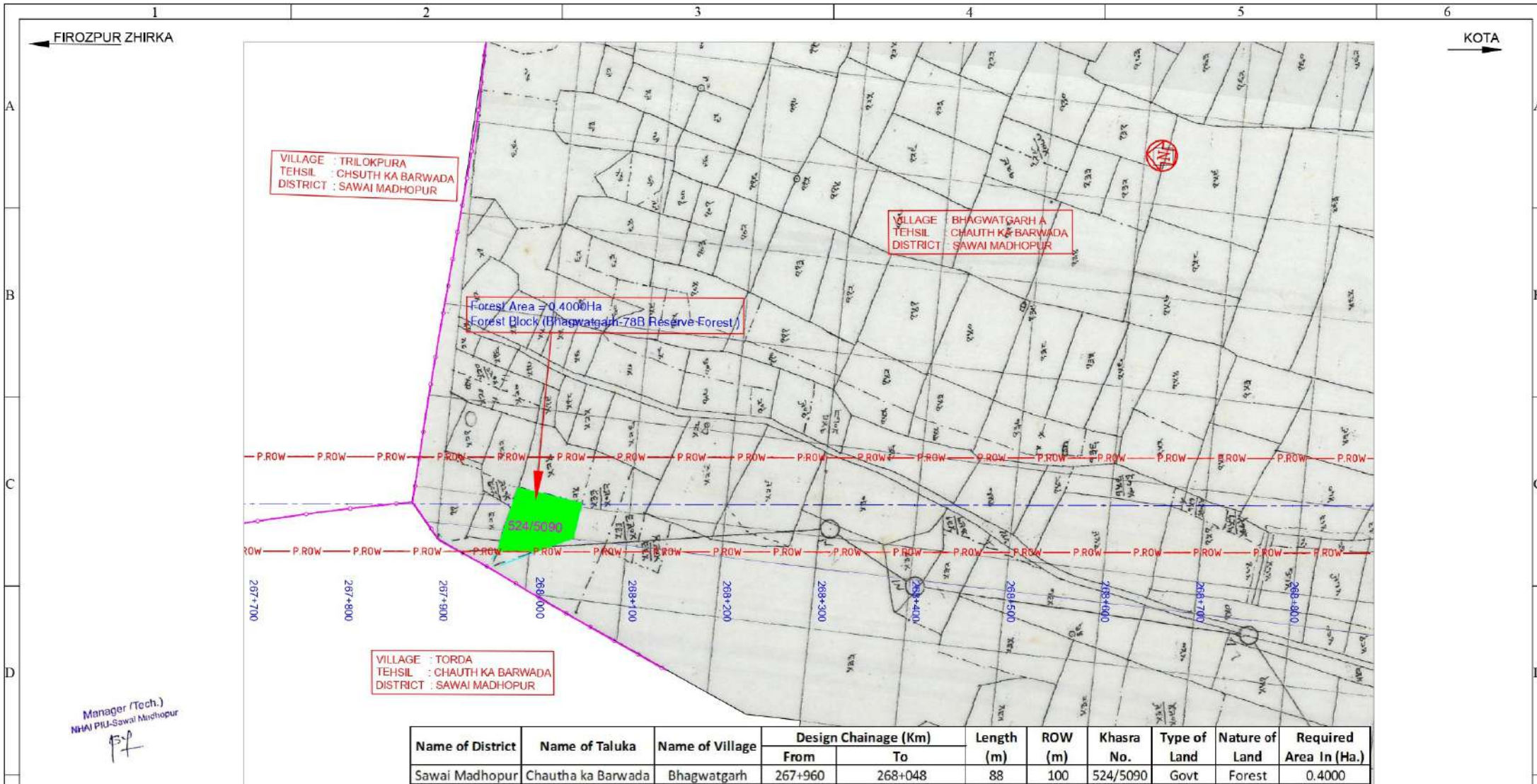

Name of District	Name of Taluka	Name of Village	Design Chainage (Km)		Length (m)	ROW (m)	Khasra No.	Type of Land	Nature of Land	Required Area In (Ha.)
			From	To						
Sawai Madhopur	Chautha ka Barwada	Bhagwatgarh	267+960	268+048	88	100	524/5090	Govt	Forest	0.4000

Manager (Tech.)
NHAI PIU-Sawai Madhopur
B.P.

LEGEND	
Acquired Reserved Forest Area	
Proposed Center line	
Proposed Right of Way	
District Boundary	
Village Boundary	
Forest Boundary	
GPS Point	

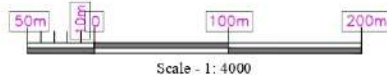

NOTES:
1. All Dimensions are in Meters Except Kilometer Stones.

CLIENT:
 NATIONAL HIGHWAYS AUTHORITY OF INDIA
(Ministry of Road, Transport & Highways)
Government of India
G - 5 & 6, Sector - 10, New Delhi - 110075

CONSULTANT:
FEEDBACK INFRA
Making Infrastructure Happen

The information contained herein is Confidential & Property of Feedback Infra Private Limited and not for Publication. The Information is Issued on the Understanding that no part thereof shall be Copied or Communicated to a Third Party without Authorisation in Writing from Feedback Infra Private Limited

Drawn by:	D.J. Dwyer
Designed by:	K.P. [Signature]
Checked by:	R.M. [Signature]
Approved By:	P.R. [Signature]
Scale:	1:4000
Date:	August - 2019

STATUS:	FEASIBILITY REPORT	
PROJECT:	"Diversion of forest land for development of (Greenfield Highway) from Firozpur Jhirka (Ch. 79.394 Km) to Itawa (Ch. 284.000 Km) Section of NH-148N (Total Length 204.606km) under Bharatmala Pariyojana (Lot-4/ Package-4) in Rajasthan State"	
TITLE:	Proposed Alignment on Revenue map Village- Bhagwatgarh (Sawai madhopur District)	
DRG NO:	FIPL/HW/LOT-4/M-01	REV: R-0
		SHEET: 01 of 02

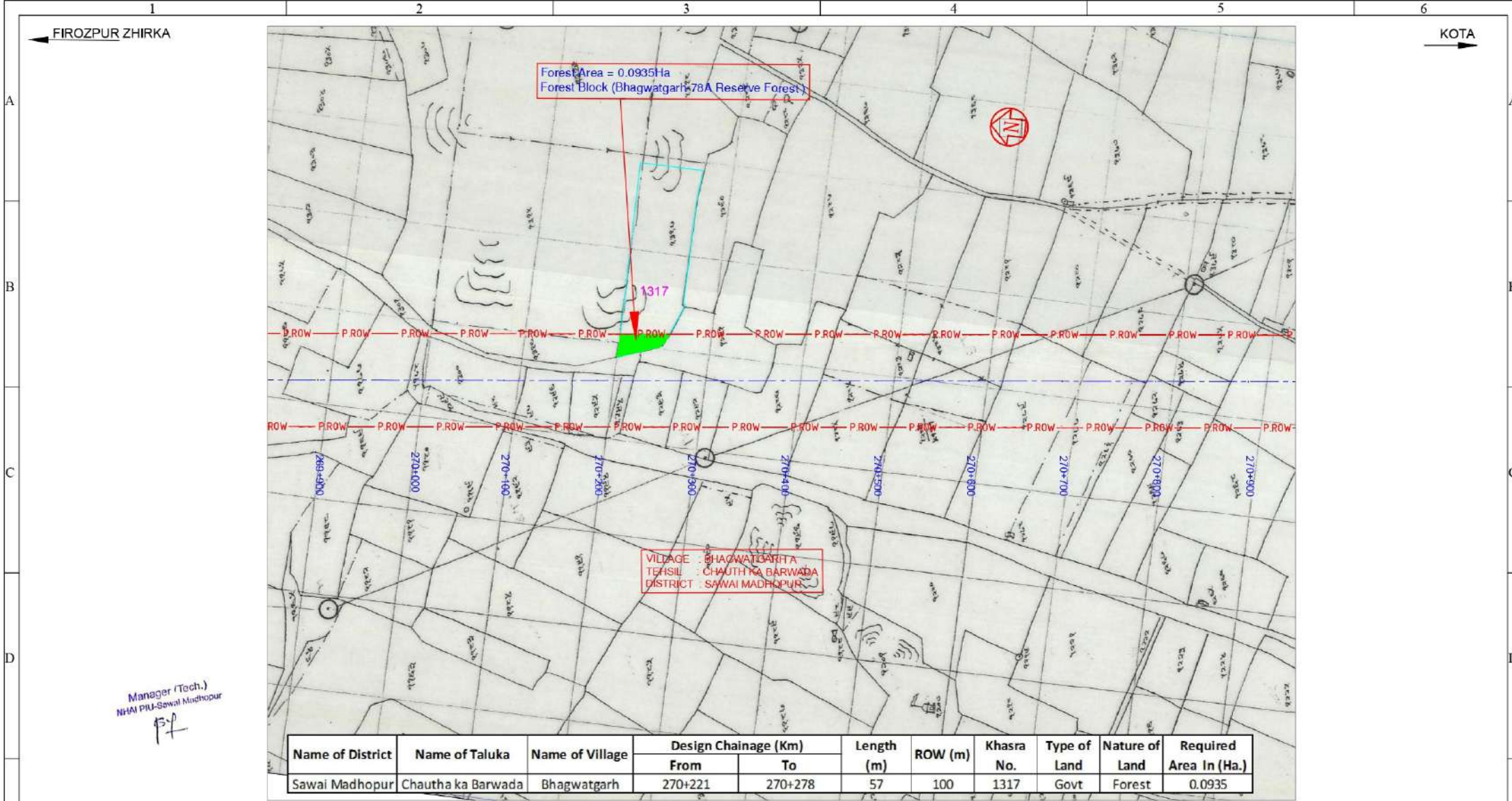

Manager (Tech.)
NHAI PIU-Sawai Madhopur
P.S.

Name of District	Name of Taluka	Name of Village	Design Chainage (Km)		Length (m)	ROW (m)	Khasra No.	Type of Land	Nature of Land	Required Area In (Ha.)
			From	To						
Sawai Madhopur	Chautha ka Barwada	Bhagwatgarh	270+221	270+278	57	100	1317	Govt	Forest	0.0935

LEGEND	
Acquired Reserved Forest Area	
Proposed Center line	
Proposed Right of Way	
District Boundary	
Village Boundary	
Forest Boundary	
GPS Point	



NOTES:
1. All Dimensions are in Meters Except Kilometer Stones.

CLIENT:
 NATIONAL HIGHWAYS AUTHORITY OF INDIA
(Ministry of Road, Transport & Highways)
Government of India
G - 5 & 6, Sector - 10, New Delhi - 110075

CONSULTANT:
FEEDBACK INFRA
Making Infrastructure Happen
The information contained herein is Confidential & Property of Feedback Infra Private Limited and not for Publication. The Information is furnished on the Understanding that no part thereof shall be Copied or Communicated to a Third Party without Authorisation in Writing from Feedback Infra Private Limited

Drawn by: D.J.
Designed by: KP.
Checked by: R.M.
Approved By: P.R.
Scale: 1:4000
Date: August - 2019

STATUS: FEASIBILITY REPORT
PROJECT: "Diversion of forest land for development of (Greenfield Highway) from Firozpur Jhirka (Ch. 79.394 Km) to Itawa (Ch. 284.000 Km) Section of NH-148N (Total Length 204.606km) under Bharatmala Pariyojana (Lot-4/ Package-4) in Rajasthan State"
TITLE: Proposed Alignment on Revenue map
Village- Bhagwatgarh (Sawai madhopur District)
DRG NO: FIPL/HW/LOT-4/M-01
REV: R-0
SHEET: 02 of 02

REV	DATE	DESCRIPTION OF REVISIONS	BY